

RUNNING BOARD

Components:

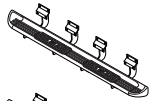

Driver Side Running Board Assembly
Qty. 1
(Brackets already attached)

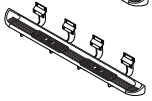

Passenger Side Running Board Assembly
Qty. 1
(Brackets already attached)

Hardware:



M8 Self
Tightening
Screw
Qty 24



M8 Lock
Washers
Qty 24



M8 Flat
Washers
Qty 6

1. Remove contents from box and check for damage. Verify all the parts from the list above are present. Please read instructions completely before starting.

2. Beginning on the passenger side, position each Bracket snug up under the Rocker Panel, level the step plate and clamp the Brackets to the pinch weld.

3. Mark the center of the Bracket's bottom holes and the upper right hole on the Pinch Weld and then drill pilot holes using a 17/64" dia. drill bit thru the Pinch Weld.

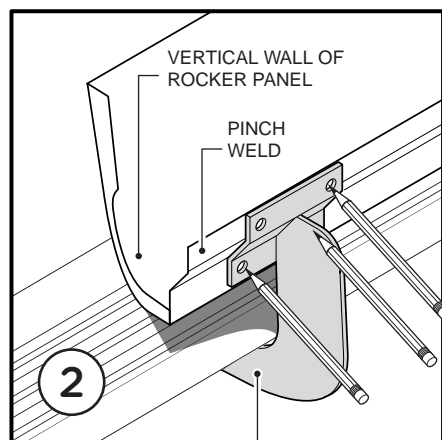

BRACKET

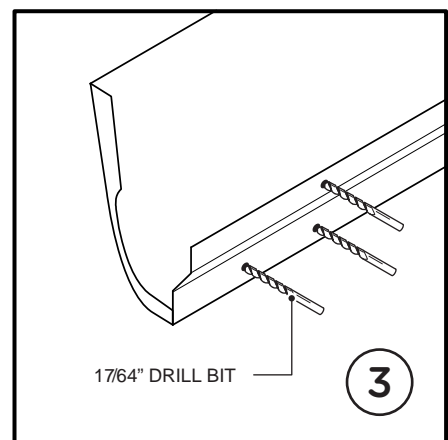

17/64" DRILL BIT

4. Secure each Bracket to the Pinch Weld using three (3) M8 Self Tightening Screws, three (3) M8 Lock Washers and three (3) M8 Flat Washers per bracket.

Repeat these steps for driver side installation. When all hardware is in place, everything must be tightened. See Page 1 for Torque Specifications.

