



AUTOMOTIVE PRODUCTS,

INSTALLATION INSTRUCTIONS

STYLIZED RUNNING BOARD

APPLICATION:

2011-2016 Ford Explorer

PART NUMBER:

28-21170, 28-21175

ITEM	QUANTITY	DESCRIPTION	TOOLS NEEDED
1	2	RUNNING BOARDS	13MM SOCKET
2,3	2	TOP FRONT MOUNT BRACKET, DRIVER(2) AND PASSENGER(3)	13MM WRENCH
4,5	2	BOTTOM FRONT MOUNT BRACKET, DRIVER(4) AND PASSENGER(5)	18MM SOCKET
6,7	2	REAR MOUNT BRACKET, DRIVER(6) AND PASSENGER(7)	18MM WRENCH
8	3	M12 BOLT PLATES	DRILL
9	4	M8 BOLT PLATES	RATCHET
10	1	M10 BOLT PLATE	TORQUE WRENCH
11	3	M12 FLAT WASHER (YELLOW ZINC)	CENTER PUNCH
12	3	M12 SPLIT LOCK WASHER (YELLOW ZINC)	3/8"-7-16" DRILL BIT
13	3	M12 HEX NUT (YELLOW ZINC)	SOCKET EXT.
14	4	M8 HEX HEAD BOLT (YELLOW ZINC)	
15	8	LARGE M8 FLAT WASHER (YELLOW ZINC)	
16	8	M8 SPLIT LOCK WASHER (YELLOW ZINC)	
17	8	M8 HEX NUT (YELLOW ZINC)	
18	8	M8 SQUARE HEAD BOLT (YELLOW ZINC)	
19	12	SMALL M8 FLAT WASHER (YELLOW ZINC)	
20	8	M8 NYLOCK NUT (YELLOW ZINC)	
21	1	M10 FLAT WASHER (YELLOW ZINC)	
22	1	M10 SPLIT LOCK WASHER (YELLOW ZINC)	
23	1	M10 HEX NUT (YELLOW ZINC)	
24	4	M8 FISH WIRE	
25	3	M12 PLASTIC RETAINER	
26	1	M10 PLASTIC RETAINER	

ANTI-SEIZE LUBRICANT MUST BE USED ON ALL STAINLESS STEEL FASTENERS TO PREVENT THREAD DAMAGE AND GALLING

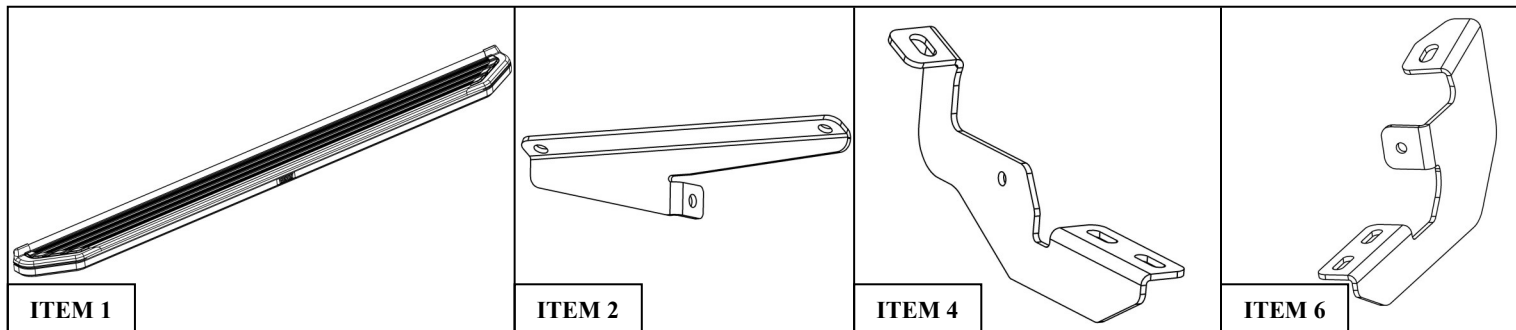

PROCEDURE

1. Remove contents from box, verify if all parts listed are present and free from damage.
Carefully read and understand all instructions before attempting installation.
Failure to identify damage before installation could lead to a rejection of any claim.
2. Unsecure the driver side rocker panel trim by releasing the plastic retainers along the bottom using a pair of small screwdrivers. With the doors open remove the two forward most retainers by sliding them down and off of the plastic rocker panel trim. See Figures 1 and 2.

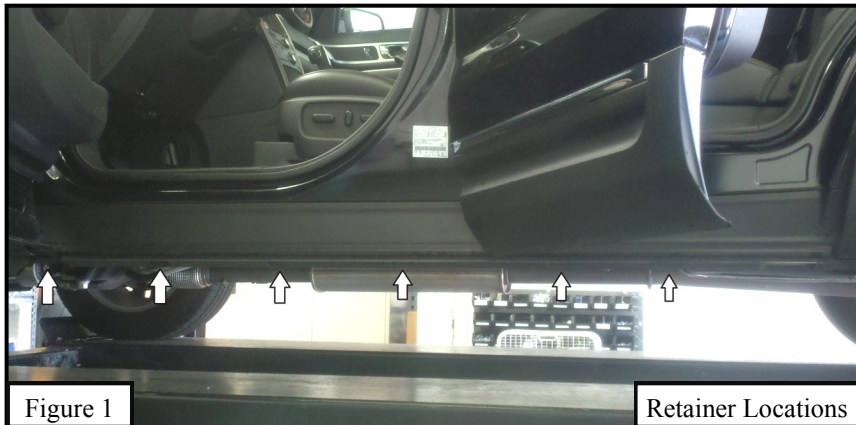

3. **For front driver and front passenger sides only:** Insert (2) M8 bolt plates, with the help of the provide M8 fish wire, through a hole and through the two slots no longer covered by the plastic retainers. Slight trimming of the plastic is recommended to add clearance for nuts and washers. See Figure 3.
4. Insert (1) M10 bolt plate into the front driver side slot under the vehicle. See Figure 4. **NOTE:** Front passenger side uses M12 bolt plate. Refer to Figure 5. Use a clear plastic retainer to prevent losing the bolt plate in the body while installing the bracket. **NOTE:** Some models have additional sheet metal within the uni-body on the driver side front slot. Installation of bolt plate requires inserting the bolt plate threaded end first and pulling the bolt into an appropriate position with a magnet prior to installing the plastic retainer.

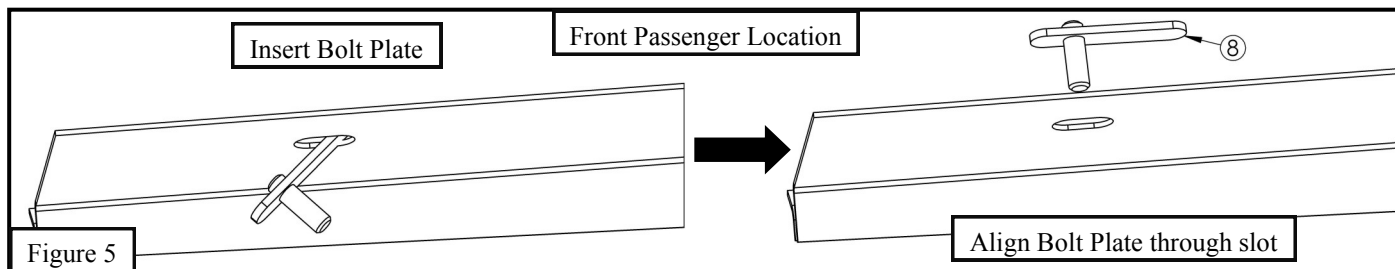
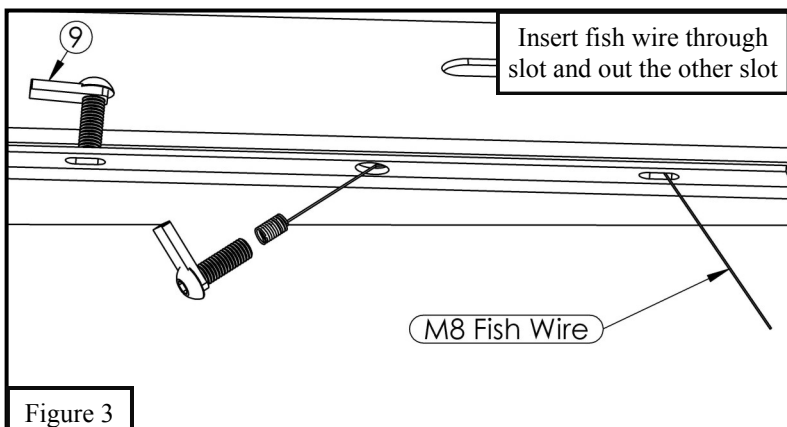

Westin Automotive Products, Inc.
320 W. Covina Blvd
San Dimas, Ca. 91773

- Take the top passenger side bracket and attach it to the bottom using (1) M8 hex head bolt, (2) large M8 flat washers, (1) M8 lock washer, and (1) M8 hex nut. **See Figures 6 and 7.**

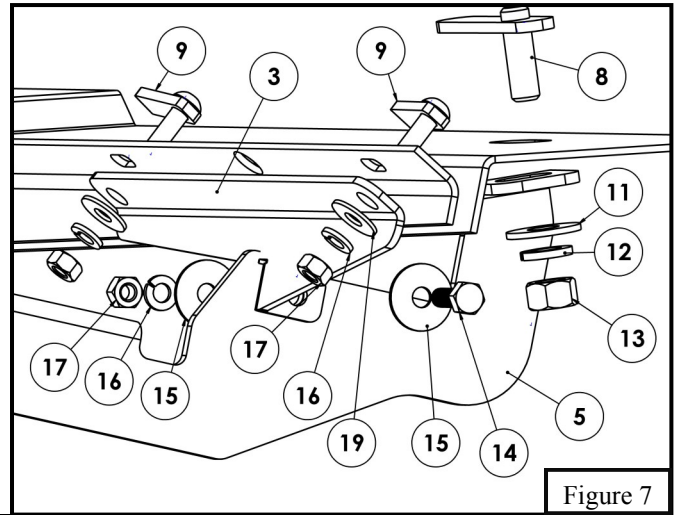
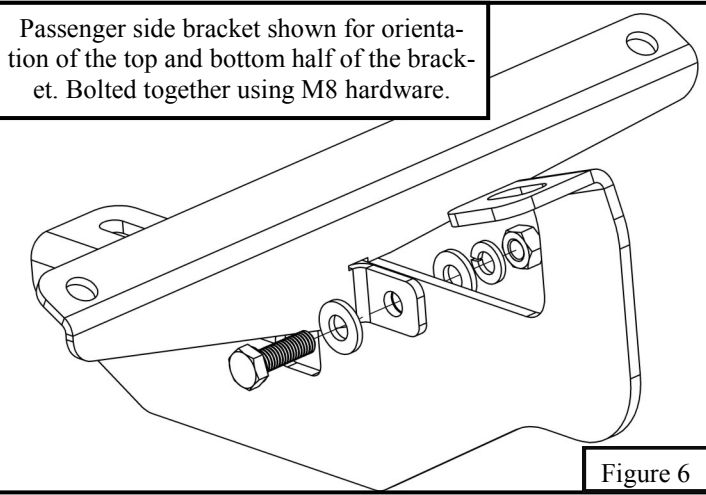

- Lift the rocker panel trim away from the body and install the driver side front bracket over the two previously installed M8 bolt plates and M10 bolt plate for front driver front and M12 bolt plate for other mount locations. Secure front driver M10 bolt plate using (1) M10 flat washer, (1) M10 split lock washer and (1) M10 hex nut. For other mount locations secure the M12 bolt plate using (1) M12 flat washer, (1) M12 split lock washer, (1) M12 hex nut. For the front driver/passenger secure the remaining M8 bolt plates using (2) M8 split lock washers, (2) M8 hex nuts and (2) small M8 flat washers. The running board mount surface faces the rear of the vehicle. **See Figure 8.** Do not tighten fully at this time.
- Insert (1) M12 bolt plate into the rear driver side slot under the vehicle using a M12 plastic retainer. Use the rear bracket to line up where the pinch weld must be drilled such that the bracket will be square and level. The step bar cradle faces the front of the vehicle. Center punch and drill a 3/8"-7/16" hole. **See Figure 9.**

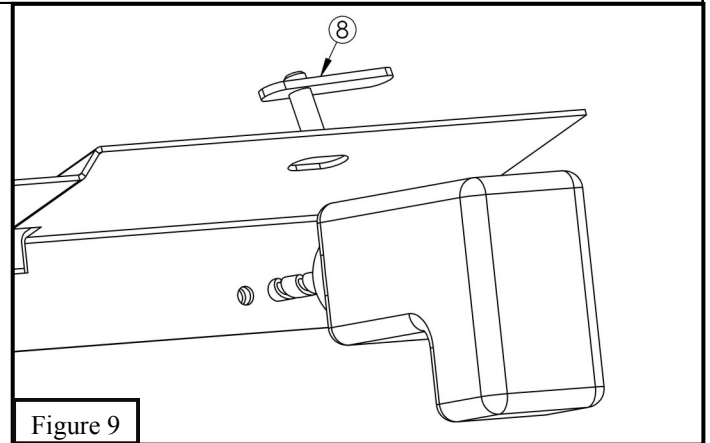
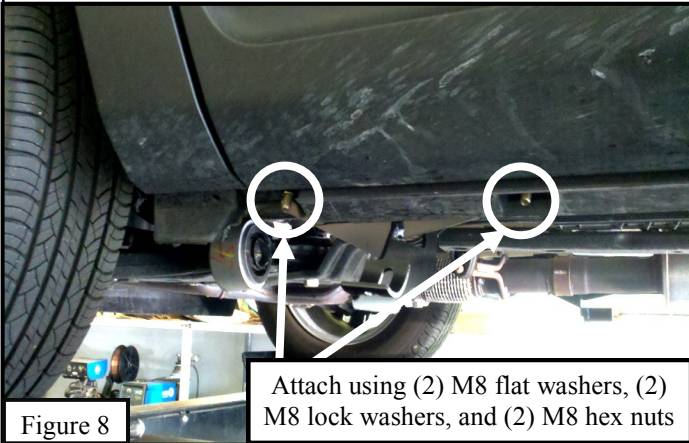

- Install passenger side rear bracket and secure using (1) M12 flat washer, (1) M12 split lock washer, (1) M12 hex nut, (1) M8 hex head bolt, (2) large M8 flat washers, (1) M8 split lock washer and (1) M8 hex nut. **See Figure 9.** Do not tighten fully at this time.
- Take the passenger side running board and place (4) M8 square head bolts in the grooves underneath the board, then align with the mounting brackets and attach using (4) M8 flat washers, and (4) M8 nylock nuts. Do not fully tighten at this time. **See Figure 10.**
- Repeat steps 2-9 for driver side.
- Align and adjust the step bars as needed then fully tighten all hardware at this time. Torque all M12 hardware to 50-55 ft lbs, M8 to 30-35.



Westin Automotive Products, Inc.
320 W. Covina Blvd
San Dimas, Ca. 91773

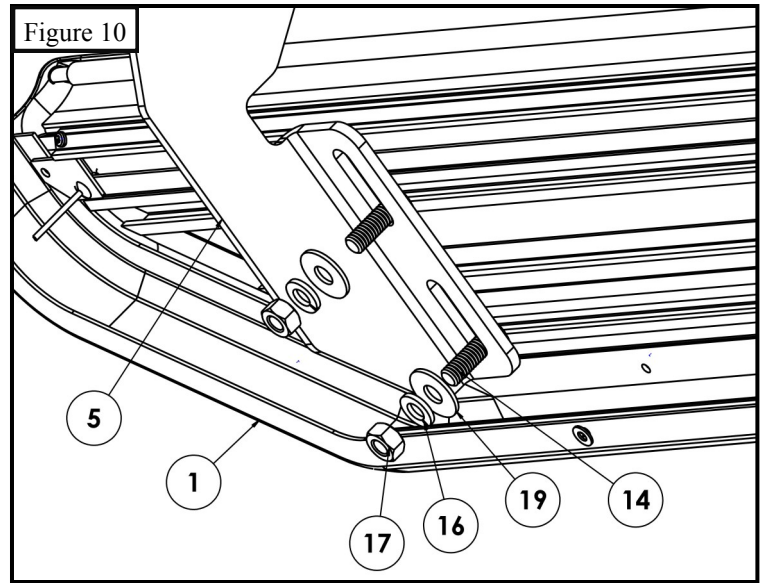
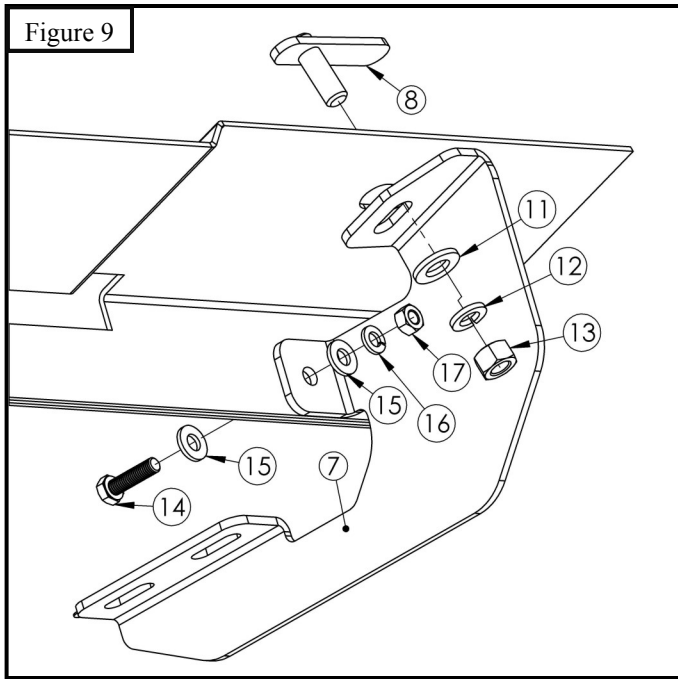

INSTALLATION COMPLETE



Care Instructions

- REGULAR WAXING IS RECOMMENDED. DO NOT USE ANY TYPE OF POLISH OR WAX THAT MAY CONTAIN ABRASIVES.
- STAINLESS STEEL PRODUCTS CAN BE CLEANED WITH MILD SOAP AND WATER. STAINLESS STEEL POLISH SHOULD BE USED TO POLISH SMALL SCRATCHES.
- GLOSS BLACK FINISHES SHOULD BE CLEANED WITH MILD SOAP AND WATER.



Westin Automotive Products, Inc.
320 W. Covina Blvd
San Dimas, Ca. 91773

Thank you for choosing Westin products
for additional installation assistance please call
Customer Service (800) 793-7846
www.westinautomotive.com

Westin

SIGNATURE OF QUALITY

AUTOMOTIVE PRODUCTS, INC.



WARNING



Failure to follow these instructions could lead to death, personal injury, and / or property damage.

FASTENERS:

All Westin supplied fasteners must be utilized and installed in accordance with the installation instructions and apply torque to the specifications as defined. **DOUBLE CHECK ALL FASTENERS BEFORE INITIAL USE, AND PERIODICALLY IN THE FUTURE TO ENSURE PROPER FUNCTION AND SAFETY.**

DRILLING:

Most Westin products do not require drilling for installation. If drilling is defined as required, use caution when drilling a vehicle. **FAILURE TO REVIEW AN AREA TO BE DRILLED MAY RESULT IN PERSONAL INJURY AND/OR INJURY TO OTHERS AS WELL AS VEHICLE DAMAGE.**

EYE PROTECTION:

ALWAYS WEAR SAFETY GLASSES OR GOGGLES DURING THE INSTALLATION PROCESS TO AVOID PERSONAL INJURY.

MAXIMUM TOWING/CARRYING CAPACITY:

The Westin Receiver Hitches will have a visible tow rating label affixed directly on the product. User should never exceed the vehicle manufacturers maximum tow and weight rating regardless of the capacity of the hitch. **FAILURE TO FOLLOW THESE GUIDELINES WILL VOID THE WESTIN WARRANTY AND MAY RESULT IN PERSONAL INJURY AND/OR INJURY TO OTHERS AS WELL AS VEHICLE DAMAGE.**

Westin
SIGNATURE OF QUALITY

Westin Automotive Products, Inc.
320 W. Covina Blvd
San Dimas, Ca. 91773