



SIGNATURE OF QUALITY

AUTOMOTIVE PRODUCTS,

INSTALLATION INSTRUCTIONS

HDX RUNNING BOARD

APPLICATION:

2015 - 2017 Ford F-150 Regular Cab / Super Cab

2017 Ford F-250/350 Regular Cab / Super Cab

PART NUMBER:

57-53925, 57-53935

ITEM	QUANTITY	DESCRIPTION	TOOLS NEEDED
1,2	2	RUNNING BOARD, PASSENGER (1) AND DRIVER (2)	13MM SOCKET
3	2	MOUNTING BRACKET A	13MM WRENCH
4	2	MOUNTING BRACKET B	5/16" DRILL BIT
5	4	UNIVERSAL BRACKET	TRANSFER PUNCH
6	2	BOOT SCRAPER	SILICONE
7	4	M8 CARRIAGE BOLT	RATCHET EXT.
8	8	M8 HEX HEAD BOLT	RATCHET
9	24	M8 FLAT WASHER	TORQUE WRENCH
10	24	M8 LOCK WASHER	
11	8	M8 U-NUT	
12	16	M8 HEX NUT	
13	12	POLY RETAINER	
14	4	M9.5 EXTERNAL TOOTH LOCK WASHER	
15	4	M9.5 HEX HEAD SELF TAP SCREW	

ANTI-SEIZE LUBRICANT MUST BE USED ON ALL STAINLESS STEEL FASTENERS TO PREVENT THREAD DAMAGE AND GALLING

PROCEDURE

1. Remove contents from box, verify if all parts listed are present and free from damage.
Carefully read and understand all instructions before attempting installation.
Failure to identify damage before installation could lead to a rejection of any claim.
2. Identify driver and passenger side running boards and install M8 u-nut clips (Item 11) to the underside of the boards. **See Figure 1.**
3. Locate three mount locations at each side of the rocker panel. **See Figure 3.**
4. Place (1) poly retainer (Item 13) on each threaded stud. **See Figure 3.**
Important: Poly retainer must be used to insulate and prevent the contact between bracket (made of steel) and rocker panel (made of aluminum). Contact between these two materials creates corrosion.
5. Mount (1) Universal Bracket (Item 5) on Bracket A (Item 3) and Bracket B (Item 4) using the hardware on **Figure 4.**
6. Install mounting brackets on the rocker panel (**Figure 5**) using the hardware on **Figure 4** and follow **Figure 6** for placement brackets order. *Do not fully tighten at this time.*
7. Take the drivers side running board and place it onto the mounting bracket cradles; align the running board with the mounting holes in the brackets and attach using (4) M8 hex head bolts (Item 8), (4) M8 lock washers (Item 10), and (4) M8 large flat washers (Item 9). **See Figure 2.** *Do not fully tighten at this time.*
8. Align and adjust the running board as needed then fully tighten all hardware at this time: M8 hardware to 15-18 ft-lbs.
9. Repeat steps 4 - 8 for the passenger side.

Westin Automotive Products, Inc.
320 W. Covina Blvd
San Dimas, Ca. 91773

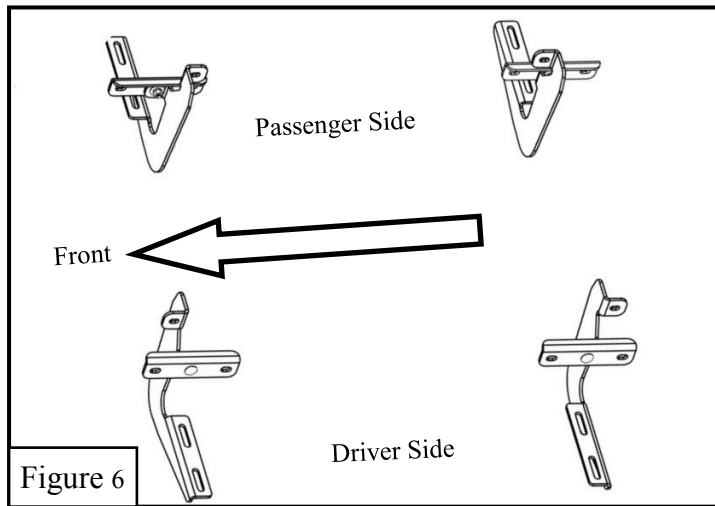
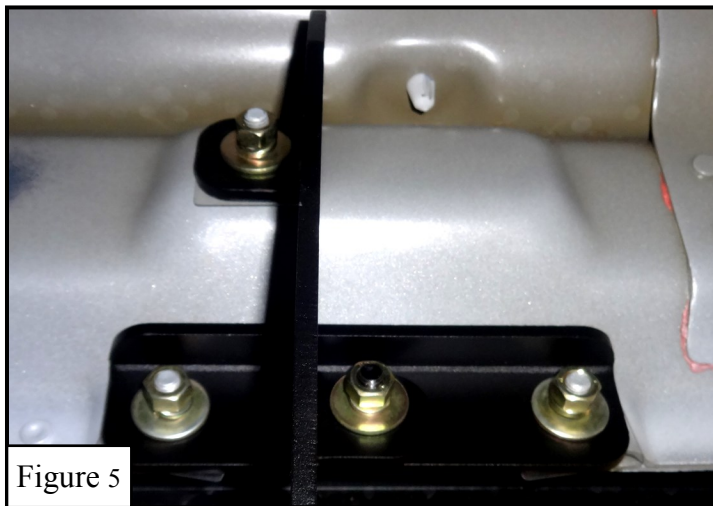
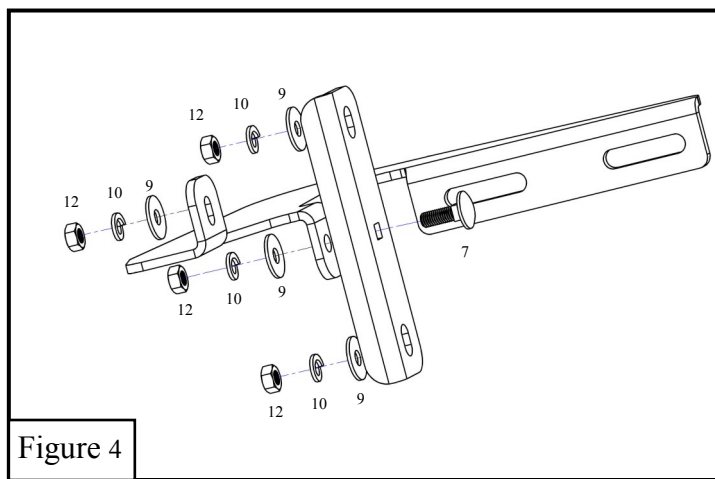
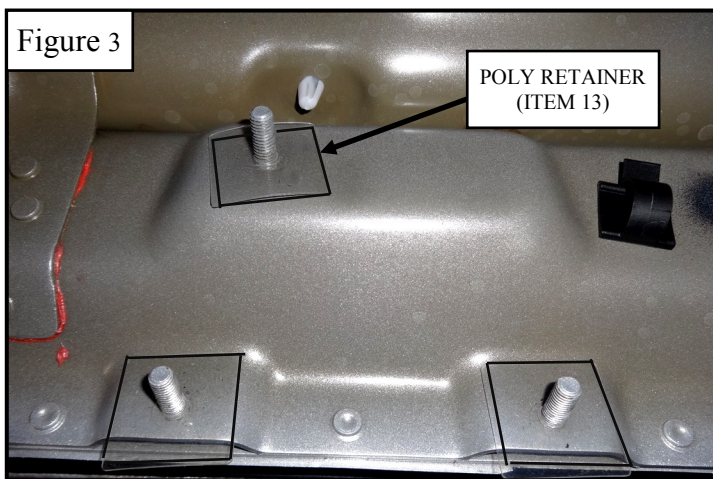
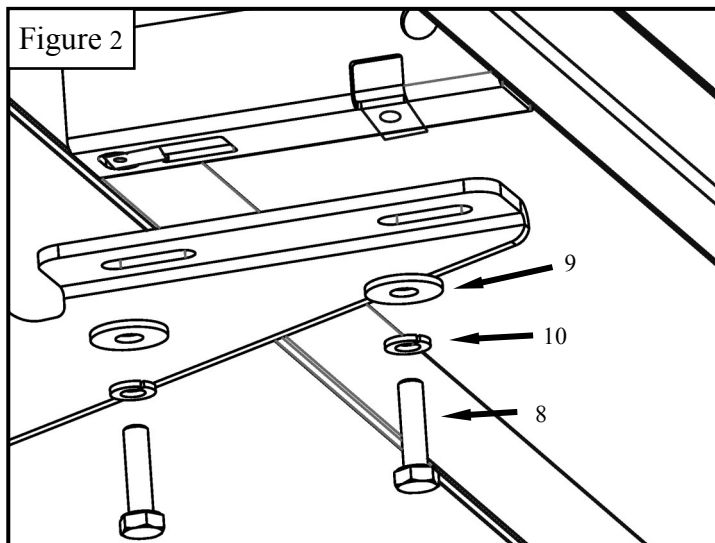
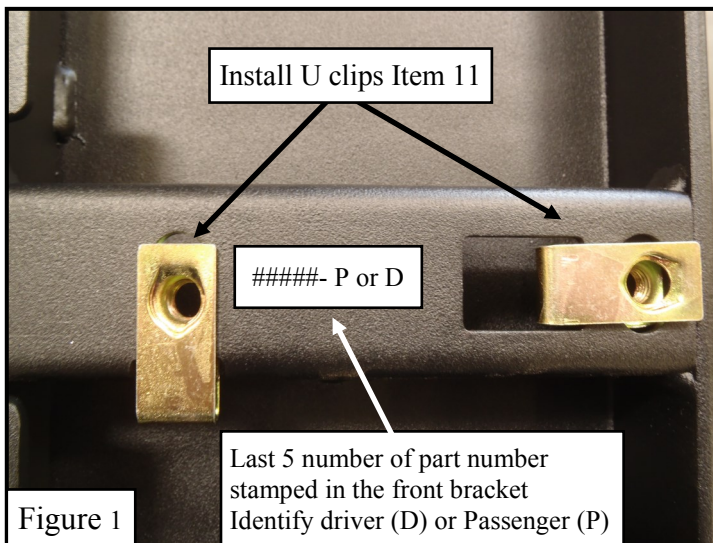
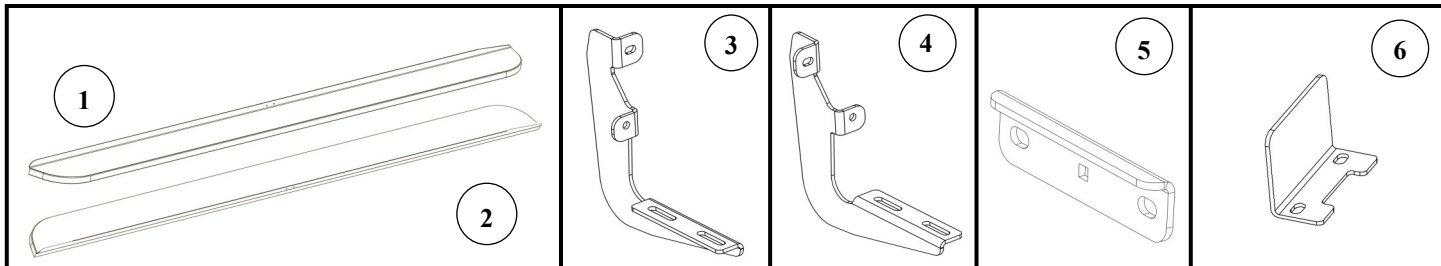

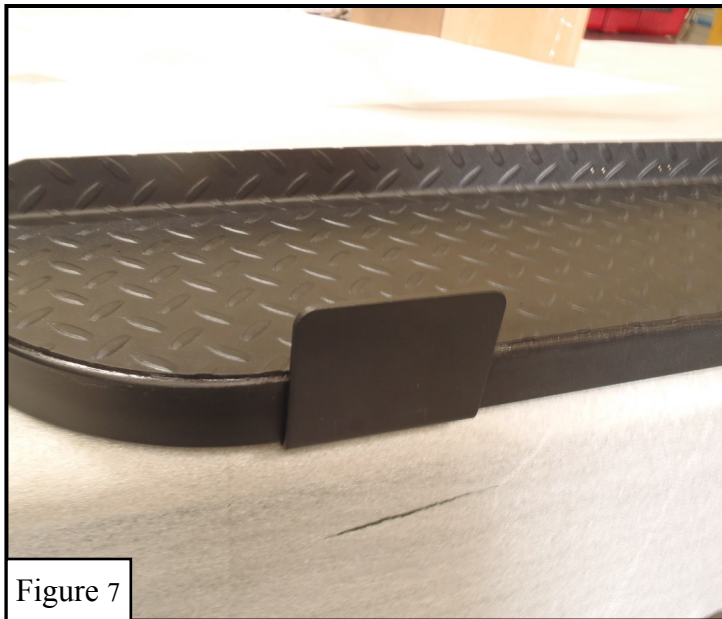

Figure 7

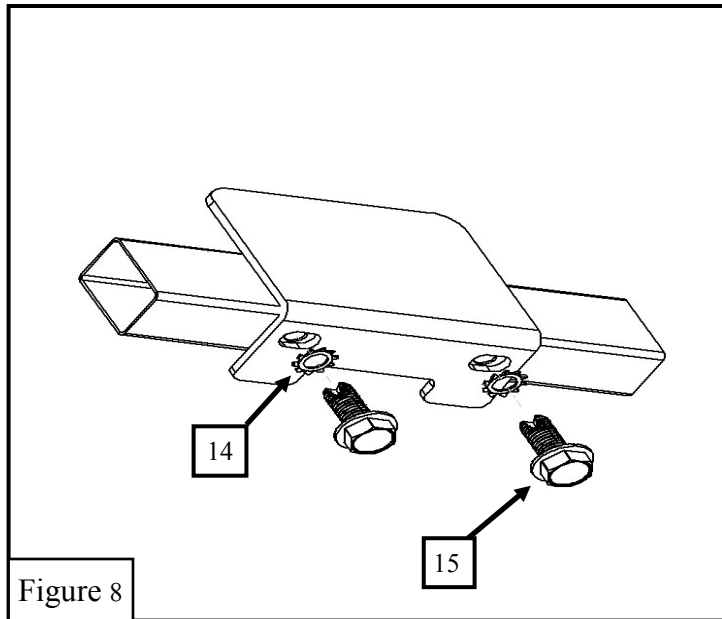
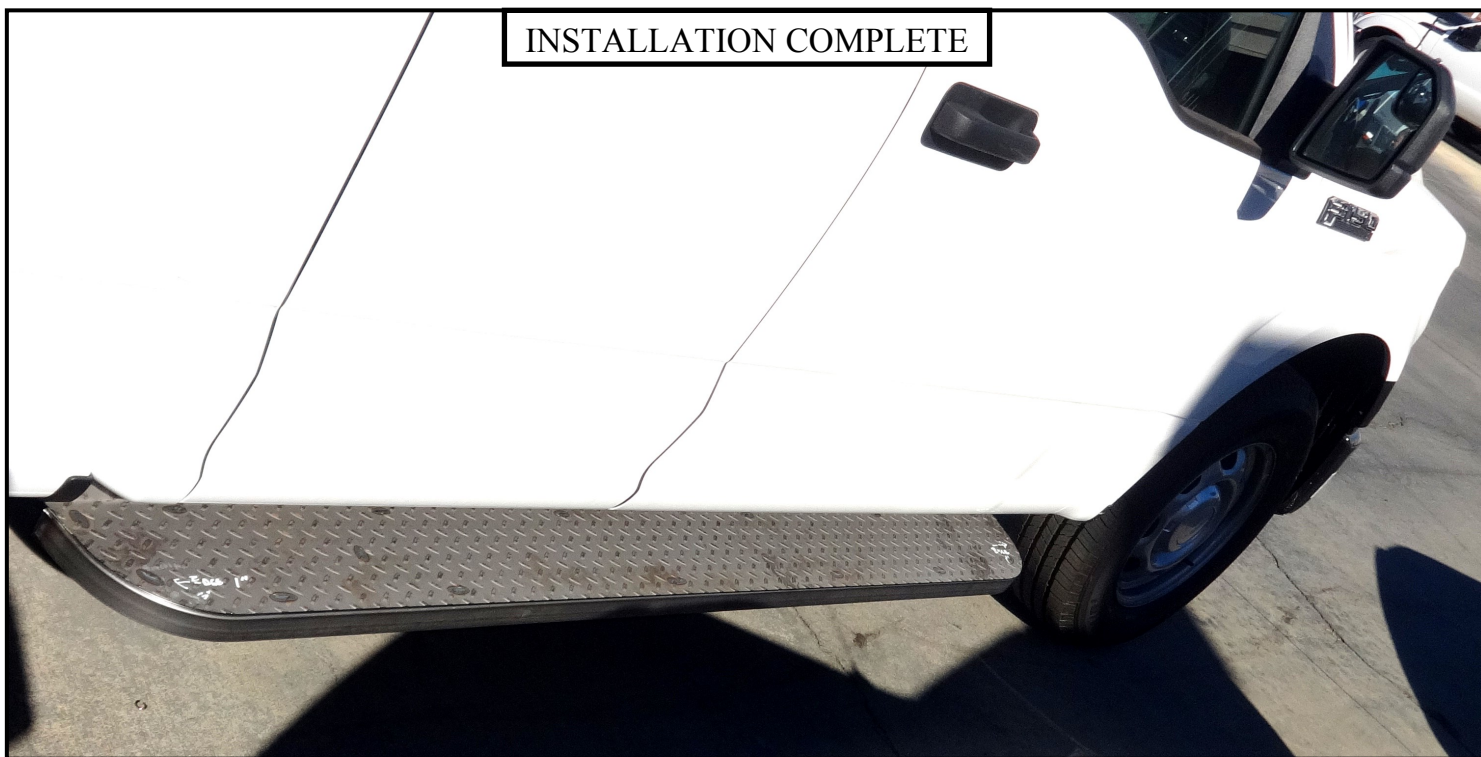

Figure 8

Boot scraper (OPTIONAL) can be installed anywhere on the underside front edge of the running board. Place the boot scraper (Item 6) on the underside of the running board rail. Then mark the position that it will be installed using a transfer punch. Remove the boot scraper; then using a 5/16" drill bit align it with the previously made marks and drill through the bottom of the rail on the running board. Thread in (2) 9.5mm hex head self tapping screws (Item 15). Remove the screws and add some silicone sealant in the holes to prevent rust. Attach the boot scraper (Item 6) using (2) 9.5mm hex flange head self threading screw (Item 15) and (2) 9.5mm external toothed lock washers (Item 14). **(Figure 8)** Torque all M9.5 hardware to 18 ft-lbs.



CARE INSTRUCTIONS

- REGULAR WAXING IS RECOMMENDED. DO NOT USE ANY TYPE OF POLISH OR WAX THAT MAY CONTAIN ABRASIVES.
- STAINLESS STEEL PRODUCTS CAN BE CLEANED WITH MILD SOAP AND WATER. STAINLESS STEEL POLISH SHOULD BE USED TO POLISH SMALL SCRATCHES.
- GLOSS BLACK FINISHES SHOULD BE CLEANED WITH MILD SOAP AND WATER.



Westin Automotive Products, Inc.
320 W. Covina Blvd
San Dimas, Ca. 91773

Thank you for choosing Westin products
for additional installation assistance please call
Customer Service (800) 793-7846
www.westinautomotive.com



SIGNATURE OF QUALITY

AUTOMOTIVE PRODUCTS, INC.



WARNING



Failure to follow these instructions could lead to death, personal injury, and / or property damage.

FASTENERS:

All Westin supplied fasteners must be utilized and installed in accordance with the installation instructions and apply torque to the specifications as defined. **DOUBLE CHECK ALL FASTENERS BEFORE INITIAL USE, AND PERIODICALLY IN THE FUTURE TO ENSURE PROPER FUNCTION AND SAFETY.**

DRILLING:

Most Westin products do not require drilling for installation. If drilling is defined as required, use caution when drilling a vehicle. **FAILURE TO REVIEW AN AREA TO BE DRILLED MAY RESULT IN PERSONAL INJURY AND/OR INJURY TO OTHERS AS WELL AS VEHICLE DAMAGE.**

EYE PROTECTION:

ALWAYS WEAR SAFETY GLASSES OR GOGGLES DURING THE INSTALLATION PROCESS TO AVOID PERSONAL INJURY.

MAXIMUM TOWING/CARRYING CAPACITY:

The Westin Receiver Hitches will have a visible tow rating label affixed directly on the product. User should never exceed the vehicle manufacturers maximum tow and weight rating regardless of the capacity of the hitch. **FAILURE TO FOLLOW THESE GUIDELINES WILL VOID THE WESTIN WARRANTY AND MAY RESULT IN PERSONAL INJURY AND/OR INJURY TO OTHERS AS WELL AS VEHICLE DAMAGE.**



Westin Automotive Products, Inc.
320 W. Covina Blvd
San Dimas, Ca. 91773