



**IMPORTANT WARRANTY & INSTALLATION
INSTRUCTIONS ATTACHED**

*Please Forward All Attached Information to Consumer
Warranty Not Valid Unless Returned to Volant Performance*

PROTECT YOUR PROOF OF PURCHASE



**For Full-Color Installation Instructions, Please Visit:
VOLANTPERFORMANCE.COM and Search by Part Number**

Please be sure to review the enclosed instructions prior to beginning the installation process. If you have any questions about the enclosed parts, instructions or encounter a problem during installation:
CALL VOLANT PERFORMANCE TECHNICAL ASSISTANCE AT 909.481.3888



Volant Performance Exhaust System Installation
Cat-Back Exhaust System
Silverado/ Sierra/ Denali 1500 6.2L 2011-13
Single Side Exit w/ 4.0" Slash Cut Tips
PN 54523

Please take time to read and understand these installation instructions.

We recommend that the installation of this system be performed by a qualified service center or professional muffler installer who has the necessary equipment, tools and experienced personnel. However, if you decide to perform this install, the use of a hoist and an additional person will be required.

CAUTION: Never work on a hot exhaust system. Allow time for the vehicle to cool. Always wear eye protection when working under a vehicle.

Please confirm that all parts are present before beginning the factory exhaust system removal and Volant Exhaust system installation.

Bill of Materials:

7	INS5264	I-SHEET (NOT SHOWN)	1
6	18DR7008	BOX (NOT SHOWN)	1
5	20FF7030	HARDWARE KIT	1
4	16SE4399	HEADPIPE	1
3	16SE4307	TAILPIPE ASSEMBLY	1
2	16SE3027	VOLANT SINGLE WALL / SLASH CUT TIP	1
1	16SE2025	MUFFLER ASSEMBLY	1
ITEM	PART NUMBER	DESCRIPTION	QTY.

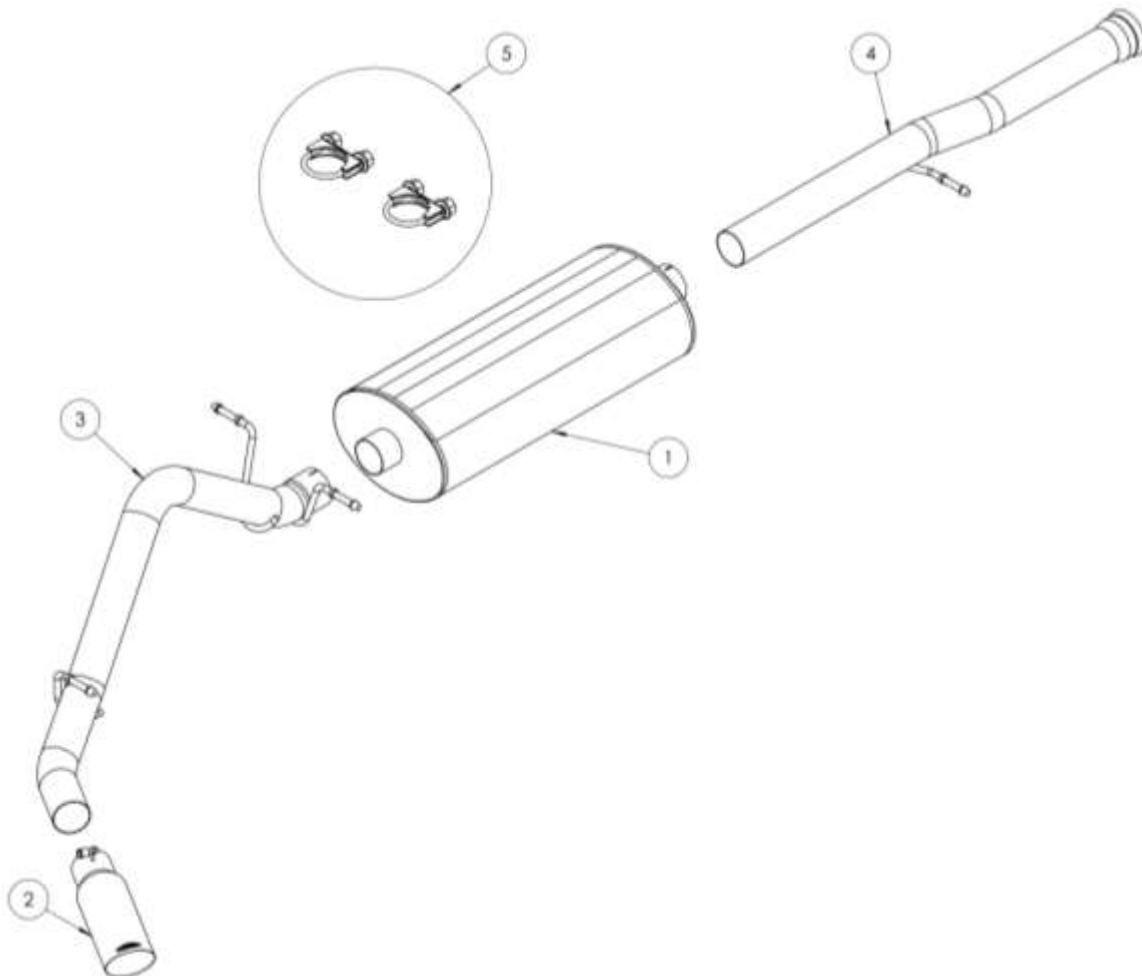

Removal of Stock System:

- 1) Open cover next to rear license plate and use vehicle key to remove lock and access to spare tire removal shaft (See Fig. A)
- 2) Use the spare tire removal kit from your vehicle and place the square end into the spare tire removal shaft then turn the wrench counter clock wise to lower the spare tire.
- 3) Mark tailpipe 3.25" rearward of the 2nd hanger after main tunnel muffler. Place a chain style cutter around the tailpipe at mark and cut the tailpipe at this location. (See Fig. B & C)
A reciprocating saw may also be used.
- 4) Remove the rearmost hanger from the grommet using grommet pullers or similar device. (See Fig. D)
- 5) Remove the tailpipe section from the vehicle by lifting the tailpipe over the rear axle and backwards under the rear bumper.
- 6) Use a 15mm socket to loosen the spherical clamp at the front of the headpipe, then remove the hanger at the headpipe location and the hangers after the muffler. Remove the tunnel muffler section away from the vehicle. This completes the removal of the stock system. (See Fig's E, F, G & H)



FIG. A



FIG. B



FIG. C



FIG. D



FIG. E



FIG. F



FIG. G



FIG. H

Installation of Volant Exhaust System:

NOTE: The supplied double edge clamps in this system will crush and permanently deform the exhaust piping as they are tightened. **DO NOT** tighten these clamps any more than is necessary to lightly hold the exhaust components in place, until the very end of this installation process. It will be difficult or impossible to make any positional or rotational adjustments to the exhaust system after these clamps have been tightened down.

VERY IMPORTANT: Align all clamps so that the open edge of the clamp bracket is parallel and aligned with the notch in the pipe, and the outside edge of the clamp bracket is approximately 1/8" from the end of the pipe expansion. (See Fig. 1) Failure to properly position or orient the clamps could result in a weak clamping load, or even a potential leak at the clamp joints.

IMPORTANT: Make sure that the small drain holes in the muffler are facing down when the muffler is installed. (See Fig. 2)

- 1) Locate the Volant Head Pipe assembly and slide the spherical joint onto the factory pipe. Reuse the factory spherical clamp and loosely snug the spherical joint. Insert the hanger into the factory grommet. (See Fig's J, K & L)

Note: Using a soapy solution on the grommet hole will make the job easier.

- 2) Slide the muffler onto the Head Pipe and pre-tighten the clamp. (See Fig's M and N) Slide a supplied 3" clamp over the inlet of the muffler.

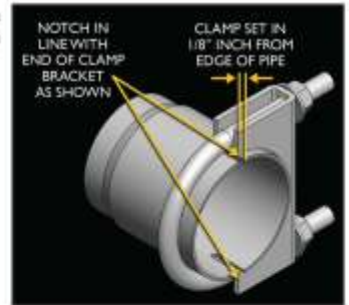

FIG. 1



FIG. 2



FIG. J



FIG. K



FIG. L



FIG. M



FIG. N

3) Locate the Tailpipe. From the rear of the vehicle slide the pipe over the axle while holding the rear differential vent hose out of the way. Insert the pipe over the muffler exit and place the hangers into the factory grommets. (See Fig's O, P & Q) Slide a supplied 3" clamp over the inlet of the Tailpipe. **Note: Using a soapy solution on the grommet hole will make the job easier.**



FIG. O

4) Locate the straight tip assembly, which has a clamp built into it. Slide the clamp end of the tip onto the end of the tailpipe. (See Fig. R) Rotate the tip until the logo is centered on the top side of the tip. (See Fig. S) Snugly tighten the clamp as shown using a 15mm socket and ratchet, making sure to only tighten the clamp enough to hold the tip in place on the tailpipe. (See Fig. T)



FIG. P

5) Visually inspect the exhaust system position, tip alignment, clamp orientation and position, and exhaust pipe clearance. Make any necessary adjustments at the slip joints.

6) Starting from the front of the exhaust system, tighten the factory spherical clamp to **21 ft-lbs** and tighten all nuts on clamps to **35 ft-lbs** using a torque wrench. Torque tip clamp to **45 ft-lbs**.



FIG. Q

7) Replace the spare tire to the pre-removal condition.

8) It is **STRONGLY SUGGESTED** that all clamps be checked and re-tightened (if necessary) to the recommended torque after initial road testing of the vehicle, as thermal cycling has occurred on the system. Please wait until system has fully cooled to conduct this process.

This completes the side exit installation.



FIG. R



FIG. S



FIG. T

NOTE: During cold weather start-ups, you may experience an exhaust sound that is deeper and louder in tone than usual. This is temporary and will diminish to normal levels once your engine has reached its normal operating temperature.

NOTE: Immediately following the installation of your exhaust system, you may experience a trace of smoke after initial start-up. DO NOT be alarmed. The smoke is caused by the burning of a small amount of forming oil residue used in the manufacturing process.