



INSTALLATION MANUAL

UWS-TBTD

Level of Difficulty

Easy

Installation difficulty levels are based on time and effort involved and may vary depending on the installer level of expertise, condition of the vehicle and proper tools and equipment.

Parts List

Item	Qty	Description
1	2	UWS Fascia tie-down
2	6	Well Nut, 1/4"-20 x 9/16"
3	6	Flanged button-head screw, 1/4"-20

Tools Required

Drill	4" C-clamp (qty: 2)
Drill bit, 9/32"	T-handle hex key, 5/32"
Drill bit, 31/64"	

Torque Specifications

Metric	M6 bolt	3 ft-lbs.
	M8 bolt	7 ft-lbs.
	M10 bolt	16 ft-lbs.
	M12 bolt	28 ft-lbs.
SAE	1/4" bolt	3 ft-lbs.
	5/16" bolt	7 ft-lbs.
	3/8" bolt	16 ft-lbs.
	7/16" bolt	20 ft-lbs.
	1/2" bolt	28 ft-lbs.

Use above torque setting unless otherwise noted

Maintenance

Mild automotive detergent may be used to clean the product. Do not use dish detergent, abrasive cleaners, abrasive pads, wire brushes or other similar products that may damage the finish.

For polished, gloss and other smooth finishes, polish may be used to clear small scratches and scuffs on the finish.

⚠ DANGER

Danger of explosion. Do not use this product for storing or transporting flammables, explosives, hazardous materials or hazardous waste, such as containers of gasoline, solvents, gun powder, dynamite, propane tanks, acetylene tanks or cutting torches. Using this product to transport dangerous materials may lead to serious injury and/or property damage.

Do not use as a handhold or rail. This product is not designed to support the weight of individuals entering or exiting a vehicle, truck bed, or running board. Using this product as a handhold or rail may result in serious injury and/or property damage.

⚠ WARNING

Never exceed the products rated capacity of 50 pounds.

Do not use this product to transport items that may pose a hazard to pedestrians, vehicles, or property if dislodged while the vehicle is moving. Ensure all items are securely fastened and properly contained to prevent accidents or injuries

This product can reduce the driver's ability to clearly see roadways, vehicular or pedestrian traffic and other objects through the rear and side windows of the vehicle, which may cause an accident. Extra precaution should be taken when driving a vehicle with this product.

Do not interfere with factory-installed safety equipment.

Product Photo

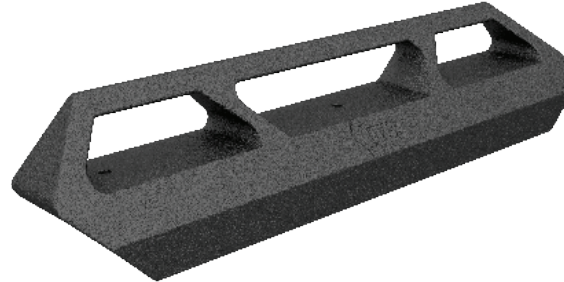

NOTICE

Before you begin installation, read all instructions thoroughly.

Proper tools will improve the quality of installation and reduce the time required.

To help prevent damage to the product or vehicle, refer to the specified torque specifications when securing hardware during the installation process.

Do not use this product for purposes other than those for which they were designed. Never modify this product.

Consult your dealer if you have any questions regarding the installation, operation, use and limits of this product.

Treat or seal all fasteners and exposed metal in any holes drilled in vehicle to prevent corrosion.

Product Registration and Warranty

UWS stands behind our products with industry-leading warranties. To get copies of the product warranties, register your purchase or provide feedback, visit: warranty.curtgroup.com/surveys

Step 1

Center the tie down on the side of the toolbox, ensuring it is pressed firmly against the end of the box.

Secure it in position using two 4" C-clamps.

With the tie down clamped in position, use a drill with a 9/32" bit to pilot drill the three mounting hole locations through the top panel of the toolbox lid.

Note: If your toolbox is already installed on your vehicle, it will need to be removed to allow the rail to be clamped prior to drilling the mounting holes.

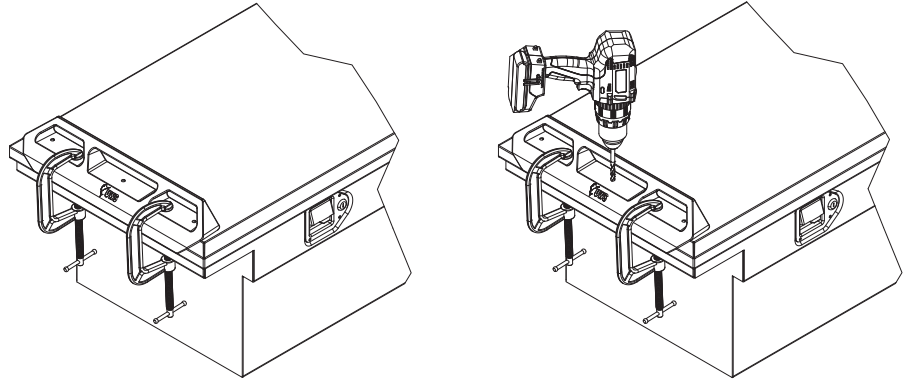

Step 2

After transferring the mounting positions to the box with the pilot drill in step one, remove the clamps and tie down from the box.

Using a 31/64" drill bit, enlarge the three pilot holes to allow the well nuts to be installed. Care should be taken to ensure the holes are not drilled oversize as it may prevent the well nuts from properly expanding during installation.

With all three holes enlarged to 31/64", firmly press a rubber well nut into each mounting location.

Note: The UWS lid is reinforced with foam. Ensure the holes are free of foam which may prevent the well nuts from seating in the holes.

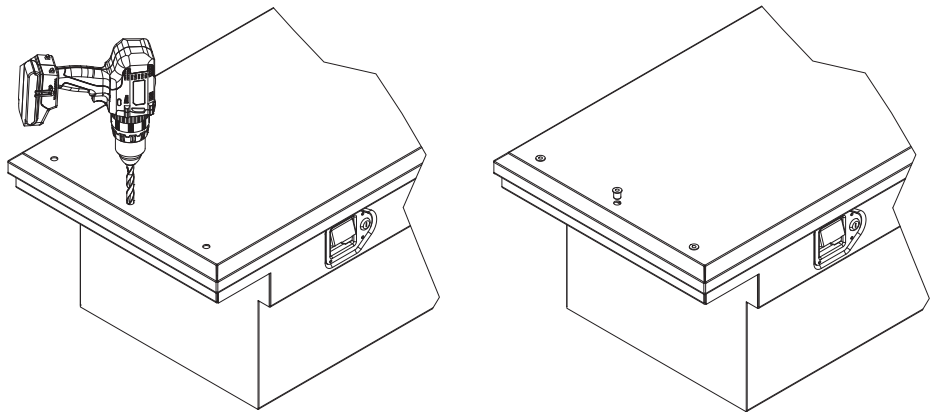

Step 3

Place the UWS tool box tie-down over the well nut locations and loosely install all the 1/4" flanged button-head bolts.

Using a 5/32 T-handle hex key, securely tighten the flanged button-head screws using caution not to overtighten.

Repeat steps 1 through 3 on the opposite side of the toolbox.

Congratulations on the installation of your new UWS crossover truck tool box tie downs.

