

! IMPORTANT

READ BEFORE YOU BEGIN INSTALLATION

IT IS CRITICAL FOR YOUR SAFETY THAT YOU CAREFULLY READ AND FOLLOW THE SAFETY CAUTIONS AND INSTALLATION INSTRUCTIONS BOTH PRIOR TO AND DURING INSTALLATION.

USER SAFETY CAUTION

During installation, be mindful of the potential for sharp edges on the product or vehicle. Taking proper safety precautions helps ensure a safe and smooth installation process.



Always wear protective gloves and handle components with care to reduce the risk of injury.

TEMPERATURE SURFACE CAUTION

During high temperatures or extended sun exposure, surfaces of this product may become hot to the touch, posing a risk of burns or injury. Use caution when handling the product in hot weather and allow time for it to cool before contact.



Always check surface temperature before use to ensure safe handling conditions.

FASTENER TORQUE CAUTION

All fasteners must be tightened to the specified torque values provided in the installation instructions to ensure proper fit and safe operation of the tonneau cover. Under- or over-tightening can lead to product failure, potential damage to your vehicle, injury, or safety hazards while driving.

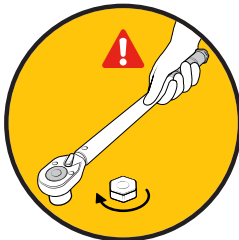

Always use a calibrated torque wrench and follow the specifications in the installation instructions.

PINCH POINT SAFETY CAUTION

This tonneau cover may create pinch points when closing or operating near solid surfaces such as the truck bed rails or tailgate. To prevent injury, keep hands, fingers, and other body parts clear of moving parts during operation.



Always operate the cover slowly and with caution to ensure safe and proper use.

! IMPORTANT

READ BEFORE YOU BEGIN INSTALLATION

IT IS CRITICAL FOR YOUR SAFETY THAT YOU CAREFULLY READ AND FOLLOW THE SAFETY CAUTIONS AND INSTALLATION INSTRUCTIONS BOTH PRIOR TO AND DURING INSTALLATION.

ENTRAPMENT SAFETY WARNING

This tonneau cover does not feature a manual release mechanism from inside the truck bed. To prevent the risk of entrapment, never allow anyone to be inside the bed of the truck when the cover is closed.

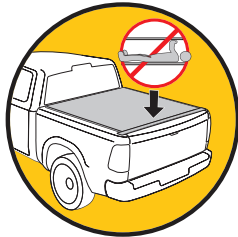

Always ensure the area is clear before closing the cover, and keep the cover securely latched when not in use to avoid accidental closure.

COVER ATTACHMENT WARNING

A partially rolled up or unsecured cover may detach during transit, risking vehicle or property damage and personal injury.

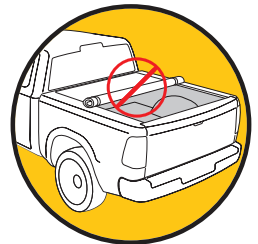

Always verify the tonneau cover is properly secured before operating the vehicle.

CARGO TRANSPORT WARNING

When transporting cargo that is taller than the truck bed, the cover must be fully rolled open and securely fastened with both retainer straps. An unsecured cover can detach while driving, risking vehicle or property damage and personal injury.



Never operate the vehicle with a partially rolled up cover.

COVER POSITION WARNING

Before operating the vehicle, always verify the tonneau cover is either fully rolled open and secured with both retainer straps or fully rolled closed and securely latched down.

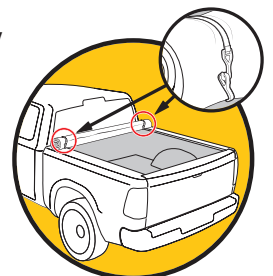

Never operate the vehicle if the tonneau cover is not properly secured.

NOTE: It is important that all the areas where the bed cover mounts to the truck are clean and free of debris before installation.

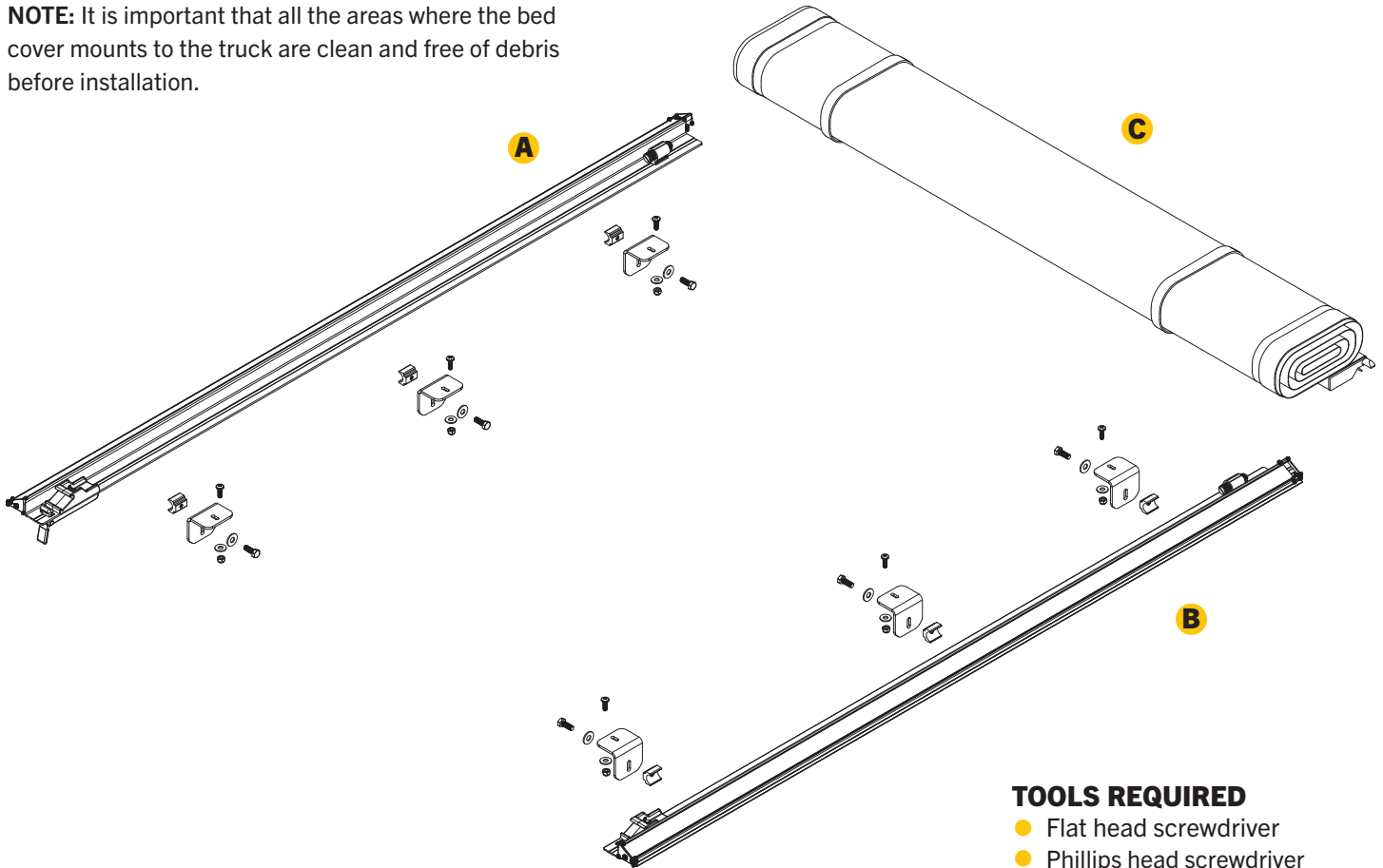

PARTS INCLUDED IN YOUR KIT:

- A** 1x Driver side rail
- B** 1x Passenger side rail
- C** 1x Cover assembly
- D** Bulkhead seal

PARTS INCLUDED IN HARDWARE BAG:

- E** 6x Anchor block
- F** 6x Screw, 5/16-18 x 7/8"
- G** 6x Washer, 5/16"
- H** 6x Formed bracket
- I** 2x Corner block seal
- J** 6x Screw pan head, 1/4-20 x 3/4"
- K** 6x Hex nut, 1/4-20 nylon locking
- L** 6x Washer, 1/4"

TOOLS REQUIRED

- Flat head screwdriver
- Phillips head screwdriver
- 1/2" Wrench or socket
- 7/16" Wrench or socket
- 3/8" Ratchet drive

TOOLS RECOMMENDED

- Scissors/utility knife
- Isopropyl alcohol

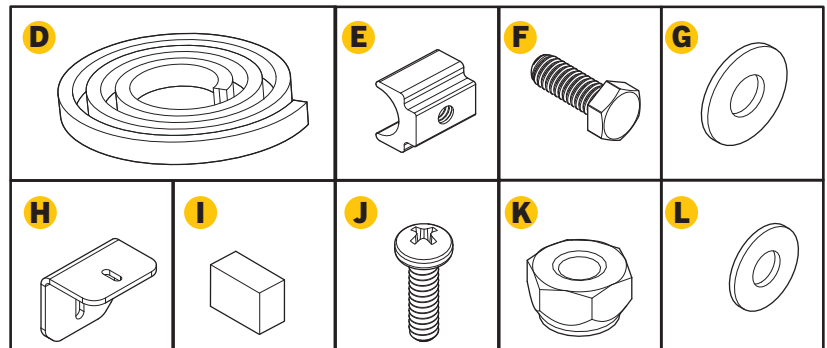

1 The serial number for the cover is located here.

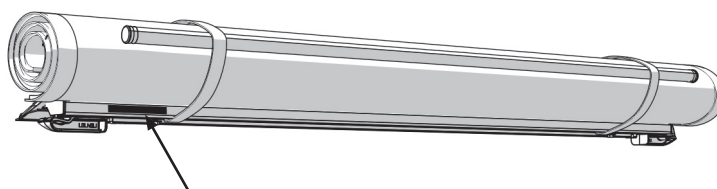

For future reference, write it here:

2 Install the bulkhead weather seal (D) to the truck's front bulkhead. Clean the area where the seal will go with soap and water to remove dirt and debris. Then clean the area with isopropyl alcohol to remove wax or grease and to evaporate any remaining water, allow the surface to dry. Then position the seal and apply pressure to the entire seal to make sure the adhesion is good. Trim end of seal with scissors so the ends fit flush against the bed caps.

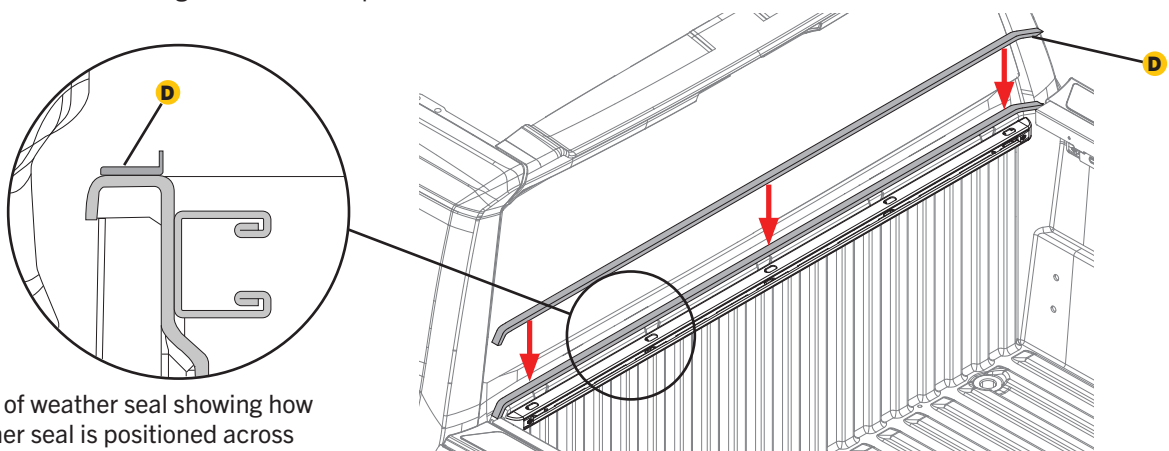

Side view of weather seal showing how the weather seal is positioned across the truck's bulkhead

Top view of truck showing how the weather seal is positioned across the truck's bulkhead.

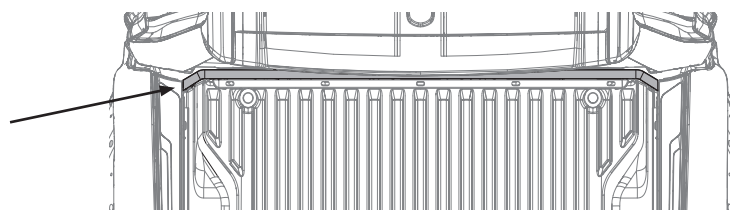

3 Install the block seals (I) in the corners where the front bulkhead seal (D) meets the side rail.

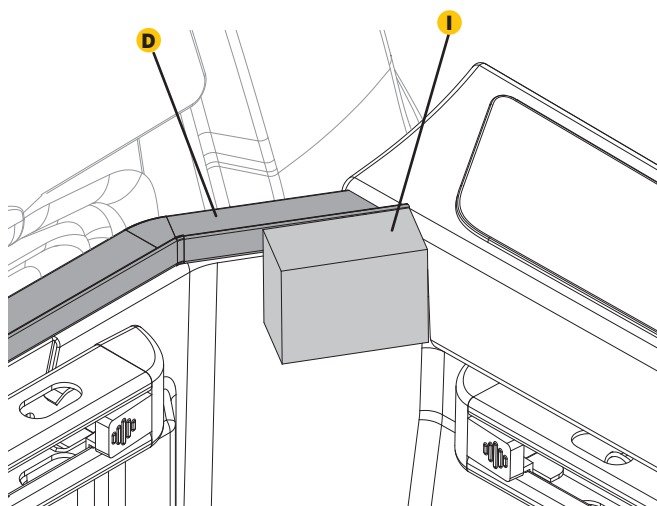
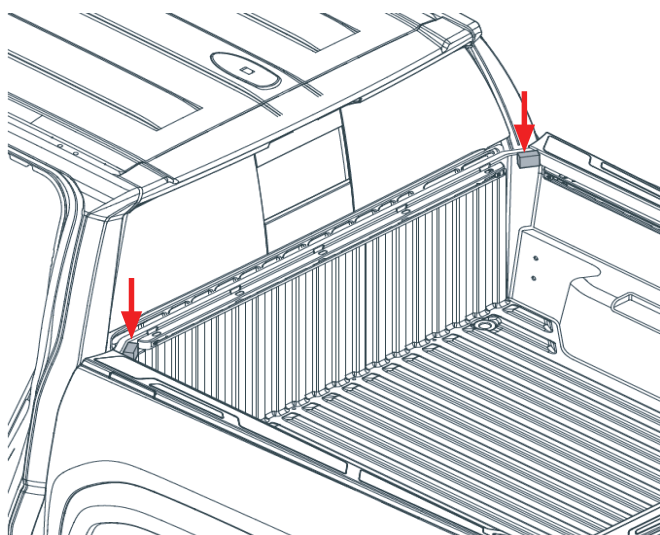

4 Remove cargo rail end plugs: Begin by pushing in on the end plug tab and at the same time push the end plug out of the rail.

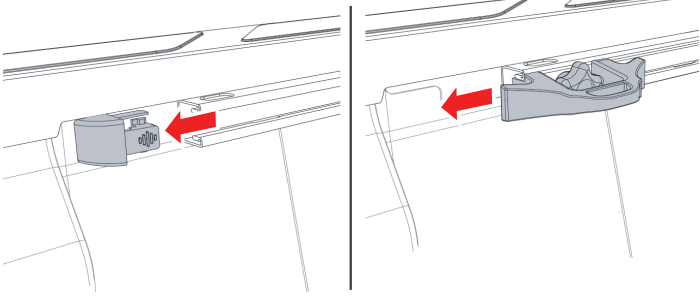

5 Install 3 anchor blocks (E) into the accessory rail from the tailgate end. Then put the end cap back into the tailgate end of the accessory rail. Repeat installation for driver side.

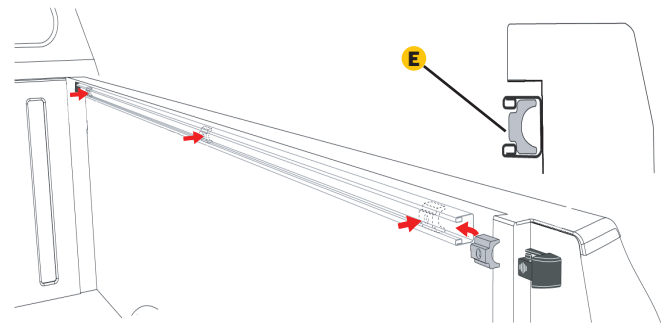

6 Reinstalling cargo tie-downs: If tie-downs are going to be used, install the tie-downs now. Depress knob and turn cleat. Driver side shown repeat for passenger side.

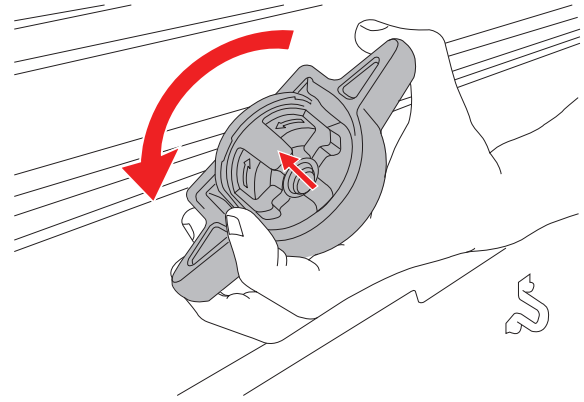
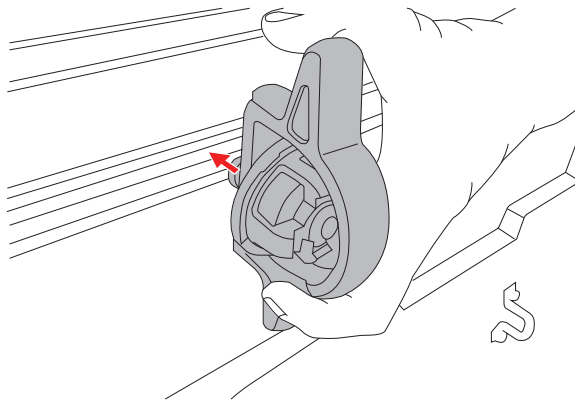

7 Attaching the formed brackets: Begin by aligning the formed brackets (H) with the anchor blocks (E). Make sure the holes on the brackets align with the corresponding holes on the anchors.

Fastening: Use 5/16" x 7/8" long screws (F) along with 5/16" washers (G) to attach the formed brackets to the anchor blocks. Insert the screws through the aligned holes on the brackets and anchors, placing washers between the screw heads and the brackets for secure attachment.

Positioning: Inside each cargo rail, position the brackets and anchors as follows: Ensure there is one bracket at the cab, one in the middle, and one at the tailgate of the cargo rail. Repeat the same process for both the driver side and the passenger side of the cargo rail.

Leave fasteners loose: It's important to leave all fasteners loose at this stage. This allows for adjustments to be made later on to ensure proper alignment and fitment of the side rails (A) and (B) to the brackets.

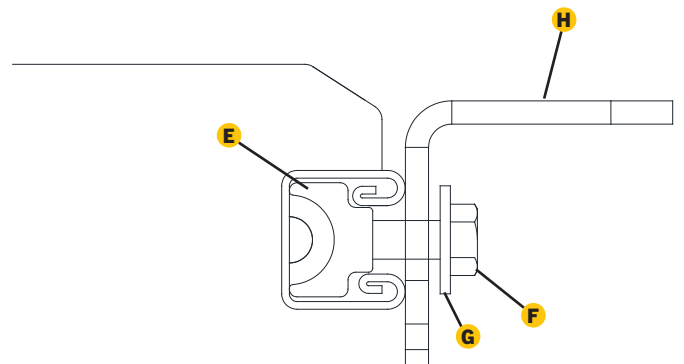
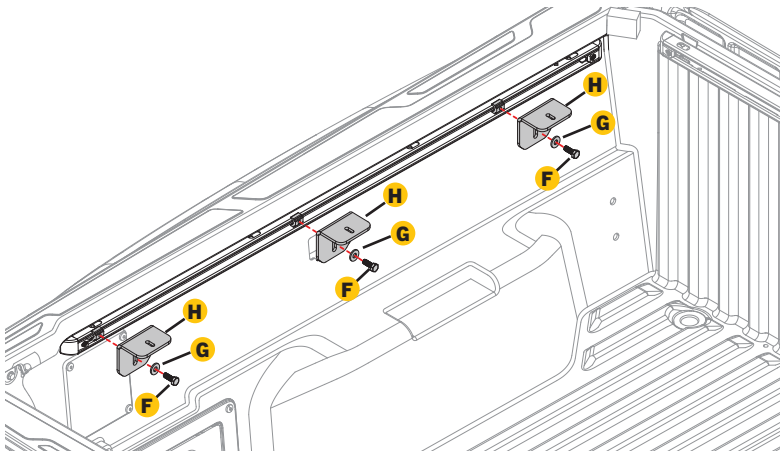

8 To attach the side rails to the formed brackets, follow these steps:

Positioning: Place the side rails (A) and (B) onto the formed brackets (H) that you have previously attached to the cargo rail anchors. Ensure that the side rails are positioned securely and aligned properly with the formed brackets.

Fastening: Use 1/4" x 3/4" screws (J) along with 1/4" washers (L) and 1/4" nylon locking nuts (K) to fasten the side rails to the formed brackets. Insert the screws through the holes in the side rails and brackets, placing washers between the screw heads and the side rails for added stability. Secure the screws with the nylon locking nuts.

Leave fasteners loose: At this stage, it's crucial to leave all fasteners loose. This allows for adjustments to be made later on to ensure proper alignment and fitment of the side rails. Tightening the fasteners prematurely may make adjustments difficult.

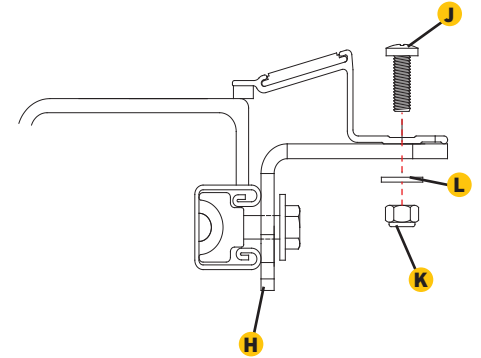
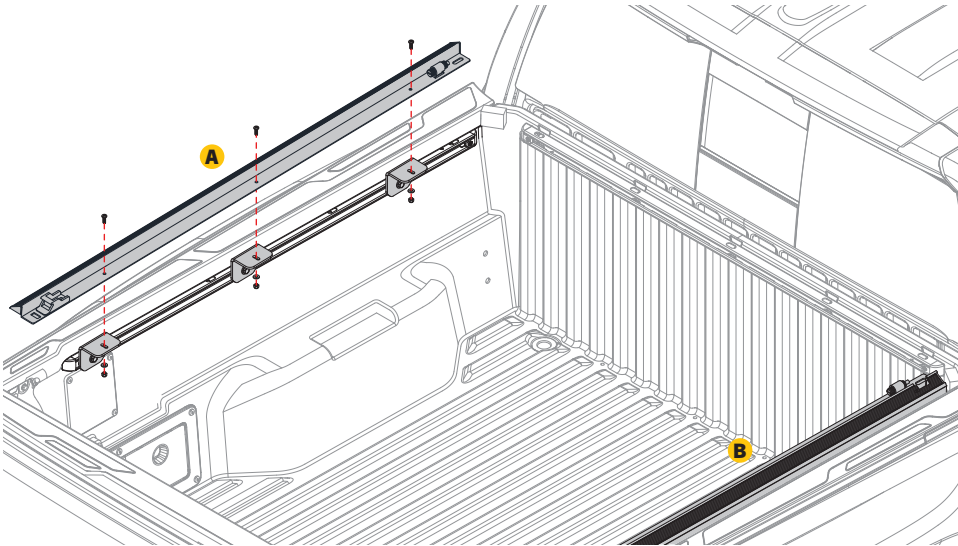

9 Position assembled side rails from the closed tailgate: With the truck's tailgate closed, position the end of each rail approximately 1/2" away from the rear corner of the truck bed. This positioning helps ensure proper alignment of the rail system and allows for clearance when opening and closing the tailgate.

Repeat for passenger rail: Repeat the entire process to install the passenger rail on the opposite side of the truck bed. Follow the same steps to position brackets, align anchor blocks, fasten rail brackets, and position the end of the rail.

Driver Side Rail Shown
Image is showing the correct side rail position from the tailgate.

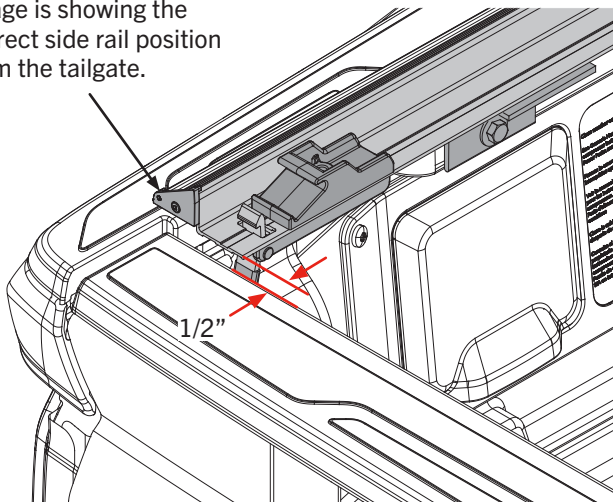

Passenger Side Rail Shown
Image is showing the correct side rail position from the tailgate.

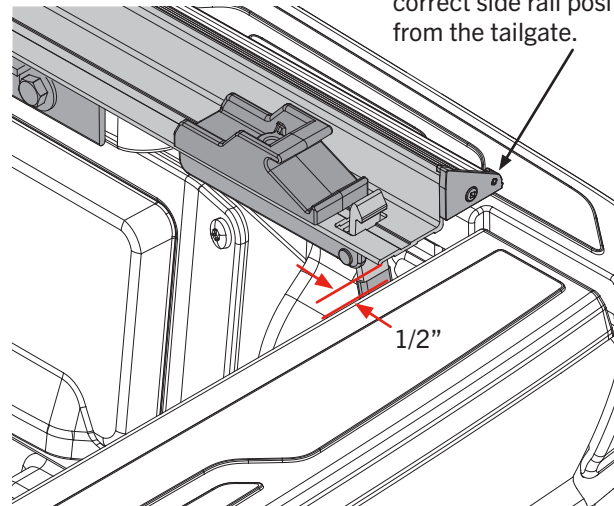

10 Positioning the side rails (A) and (B) from the bed caps at the tailgate end of the truck bed: At this point, the side rails should already be spaced correctly fore and aft (lengthwise), focusing now on the side-to-side spacing at the tailgate end.

Measuring the proper placement: Use a tape measure to help place the side rails 2" from the inside edge of the truck's plastic bed cap. The goal is to have equal spacing on both sides to ensure symmetry and proper alignment.

Secure the side rails (A) and (B): Once the rails are correctly aligned with equal spacing on both sides at the tailgate end, proceed to tighten any loose hardware on the rear brackets. Apply downward pressure on the rails while tightening the fasteners to ensure proper sealing.

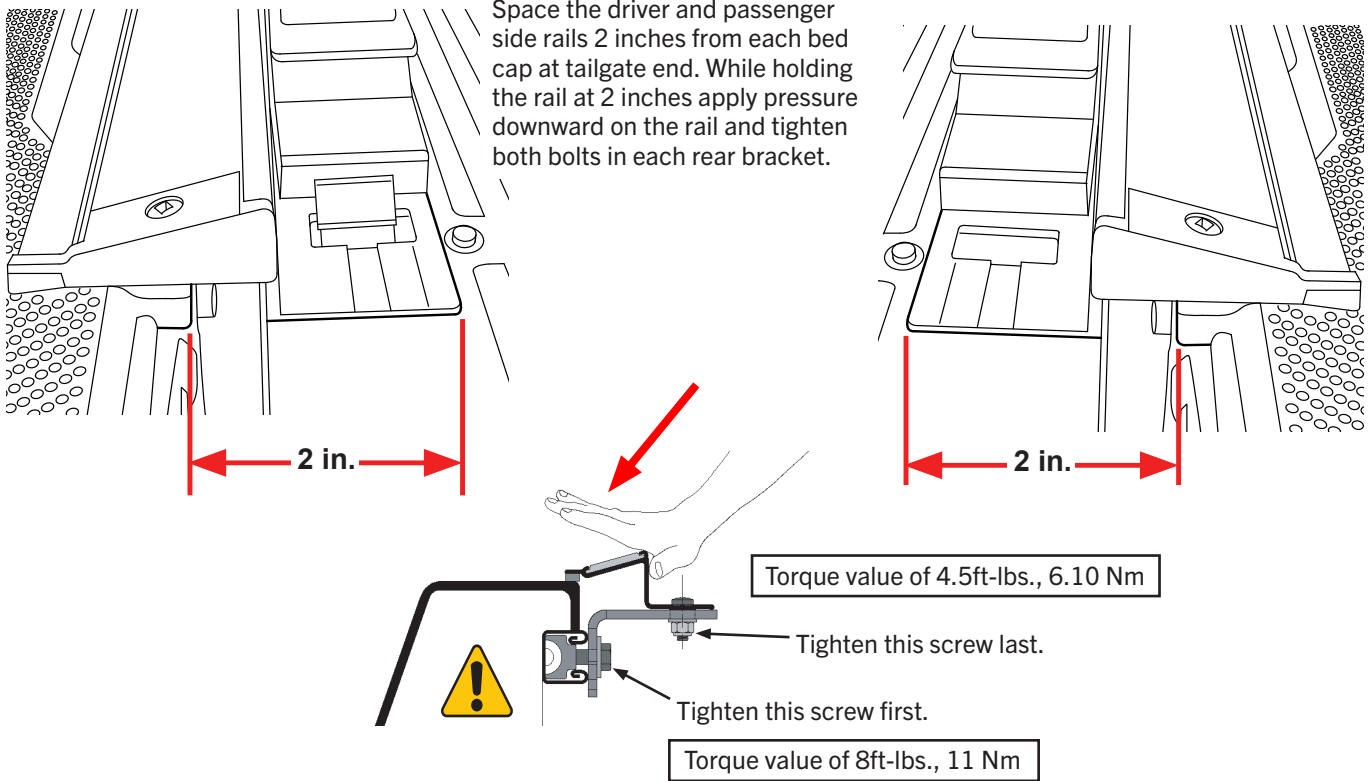

11 Positioning the side rails (A) and (B) from the bed caps at the cab end of the truck bed: At this point, the side rails should already be spaced correctly fore and aft (lengthwise), focusing now on the side-to-side spacing at the cab end.

Measuring the proper placement: Use a tape measure to help place the side rails 2-5/8" from the inside edge of the trucks plastic bed cap. The goal is to have equal spacing on both sides to ensure symmetry and proper alignment.

Secure the side rails (A) and (B): Once the rails are correctly aligned with equal spacing on both sides at the cab end, proceed to tighten any loose hardware on the front brackets. Apply downward pressure on the rails while tightening the fasteners to ensure proper sealing.

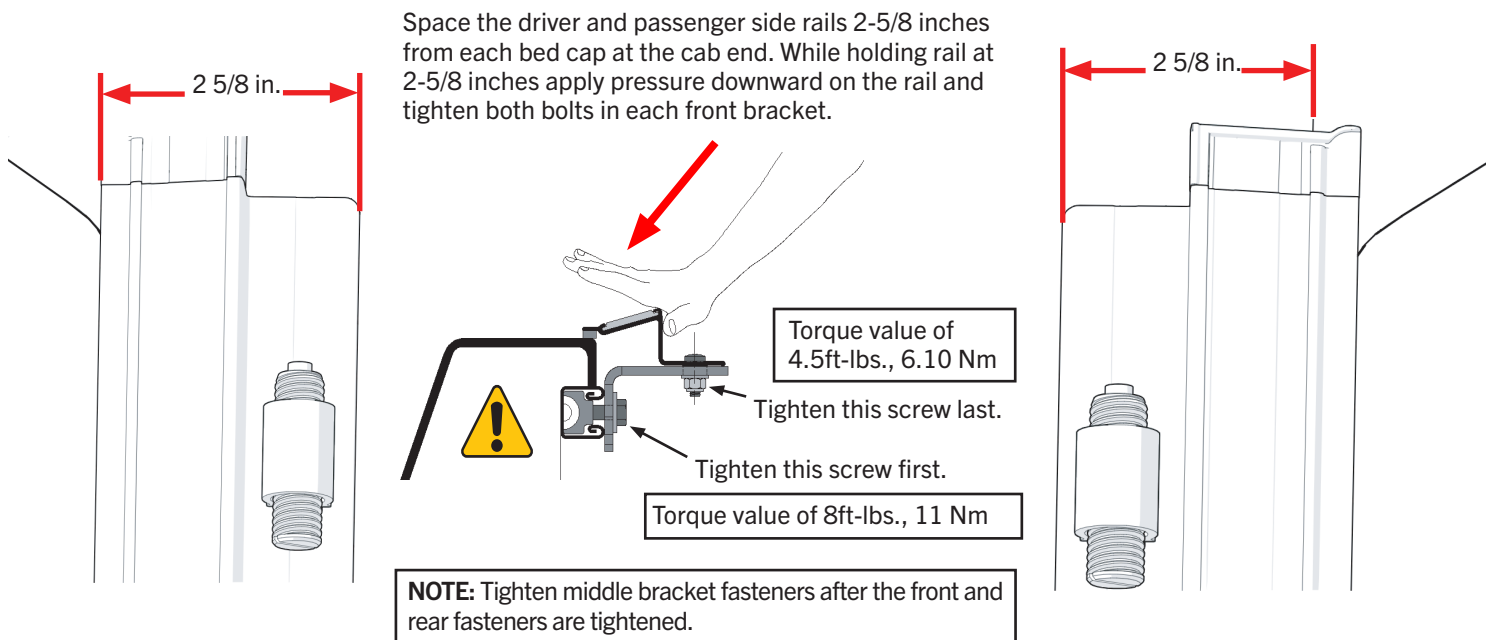

12 Place the cover (C) on the side rails towards the front of the truck bed (near the cab). The front header seal is designed to help shed water and should sit on top of the bulkhead.

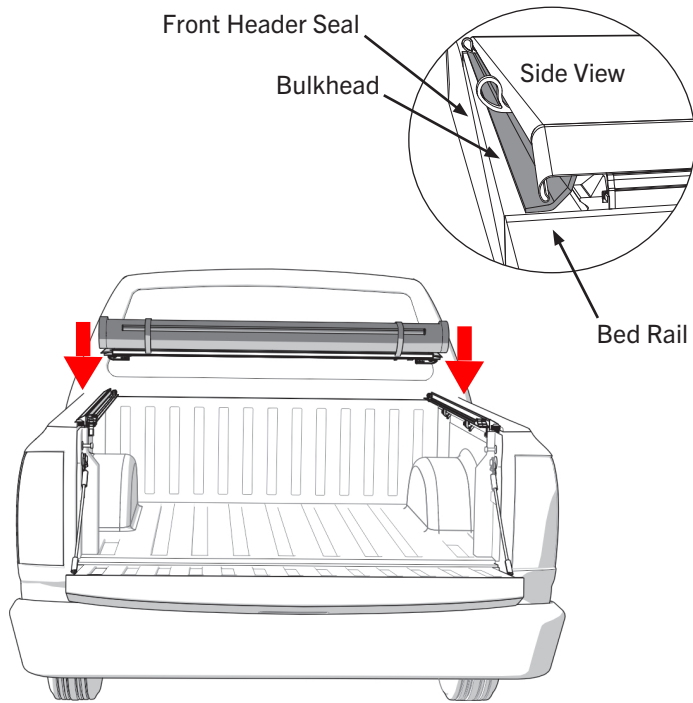

13 To connect the cover assembly (C) to the side rails (A & B) follow these steps: Slide the right and left header guides into the locked position. Ensure that the header guides are aligned properly with the side rails. **Listen for a clicking sound:** As you slide the header guides into place, you should hear a clicking sound. This clicking sound indicates that the header guides have securely attached to the side rails.

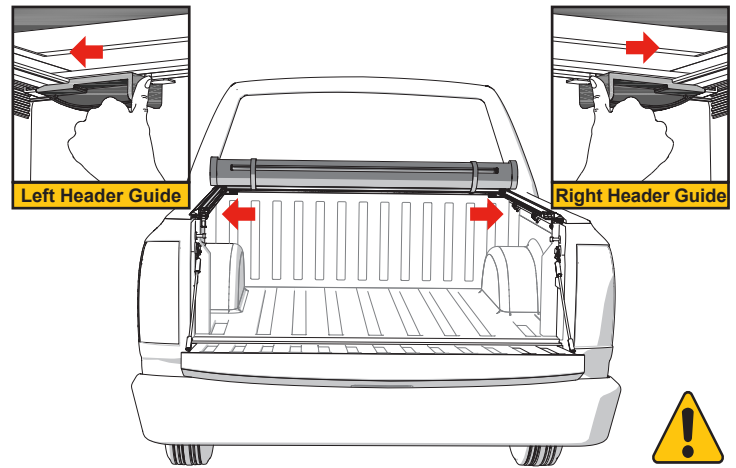

NOTE: If both retainer hooks are properly connected to the retainer loops, you may drive with the cover in the open position.

14 Disengage the retainer hooks from the retainer loops: Locate the retainer hooks that secure the cover in place when closed. Disengage these hooks from the retainer loops by releasing them. **Unroll the cover towards the tailgate:** Once the retainer hooks are disengaged, carefully unroll the cover towards the tailgate of the vehicle. Ensure that the cover is properly aligned and secured in place before driving.

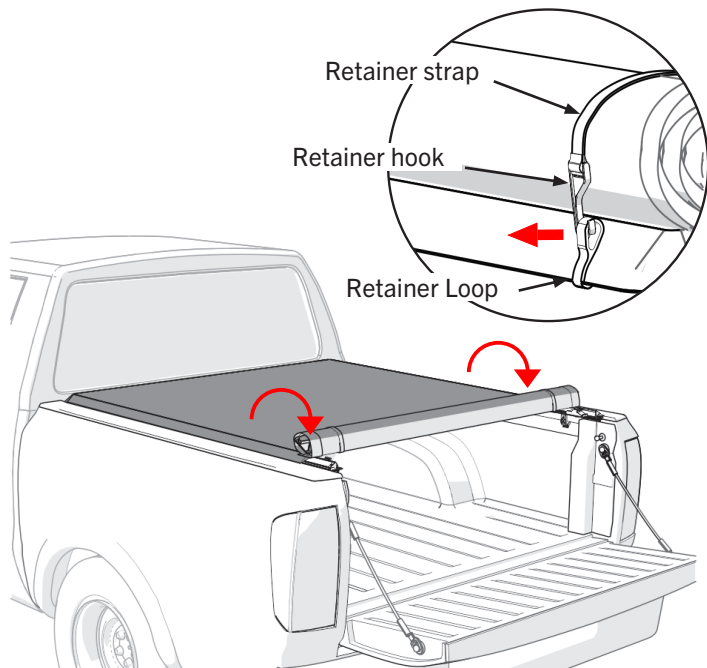

15 To latch and secure the cover properly, follow these steps: Place the rear header into the header stops. Locate the header stops on both side rails. These stops are designed to hold the rear header in place. Ensure that the rear header is positioned correctly within these stops. **Rotate the rear header downwards:** Once the rear header is positioned correctly within the header stops, rotate it downwards. As you rotate it, you should feel the cover latch into place. This indicates that the cover is securely fastened and ready for use.

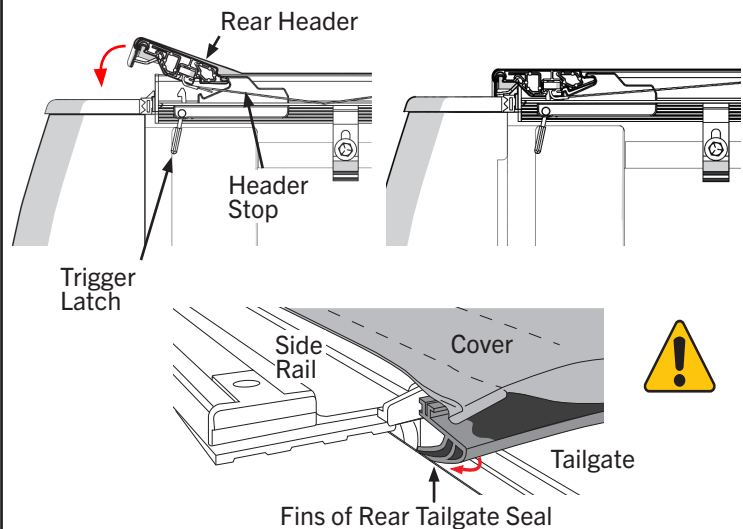

NOTE: When you close the tailgate, it pushes the fins toward the inside of the bed with the rest of the seal partially on top of the tailgate.

16 Once the cover is closed, grab the fabric flap and evenly pull it over the hook track engaging the loop to the hook.

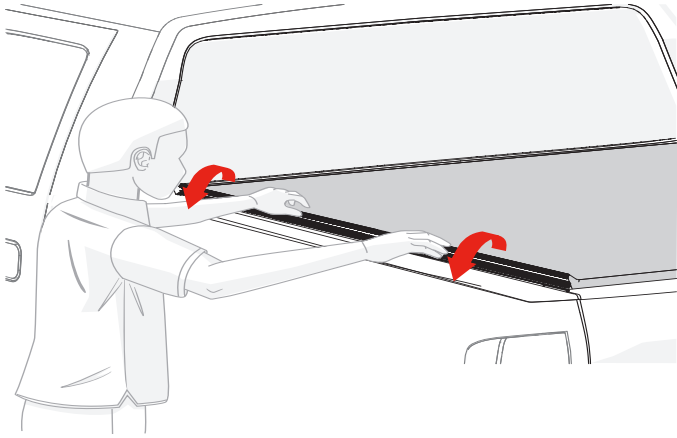

17 With both sides of the hook and loop engaged, use the palms of your hand to firmly push the loop strip into the hook track. Do this to both driver and passenger sides. **You are ready to drive with the cover in the closed position.**

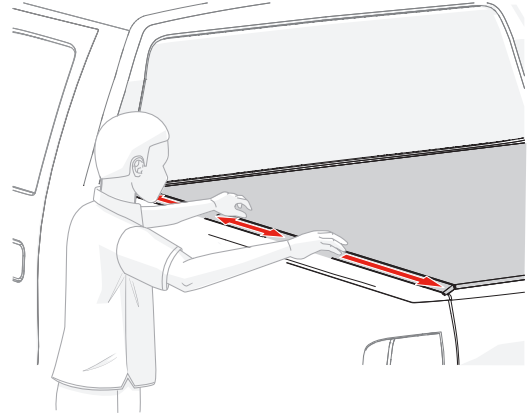

HOOK AND LOOP MUST ALWAYS BE ADJUSTED AFTER ROLLING COVER CLOSED!

OPENING THE COVER

To drive with the cover in the open position, pull the latch towards you to release the cover (located on driver side rail). Roll the cover toward the cab of the truck, making sure that both sides roll evenly. Secure the cover by placing both retainer hooks into the retainer loops. **You are ready to drive with the cover in the open position.**

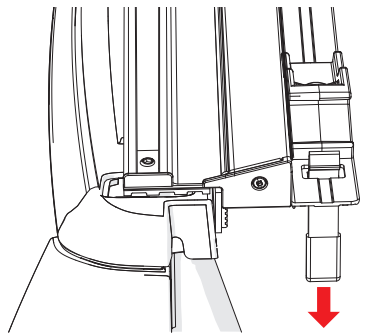

Pull Latch

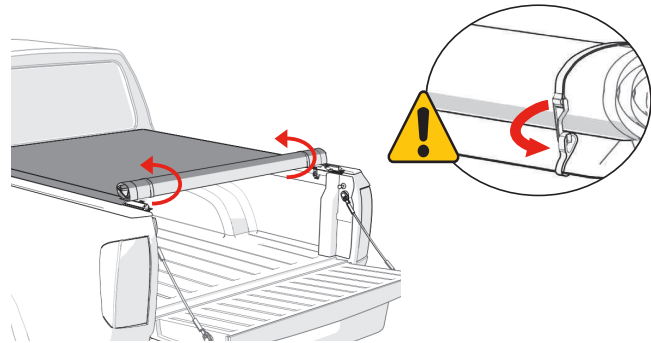

AUTOMATIC TENSION CONTROL ADJUSTMENT

The cover is equipped with Automatic Tension Control. This helps compensate for material expansion and contraction caused by extreme temperature changes. Proper tension allows the cover to look and perform at its best. While preset at the factory, you can check cover tension after installation as well as seasonally.

If the cover feels too tight or too loose when opening or closing it, adjust the tension during the warmest part of the day. With the cover closed, release the hook and loop fastener from both side rails near the cab. Check compression of both spring plungers against the front header per Detail C. Roll the cover open and make adjustments. Repeat until satisfactory tension has been achieved.

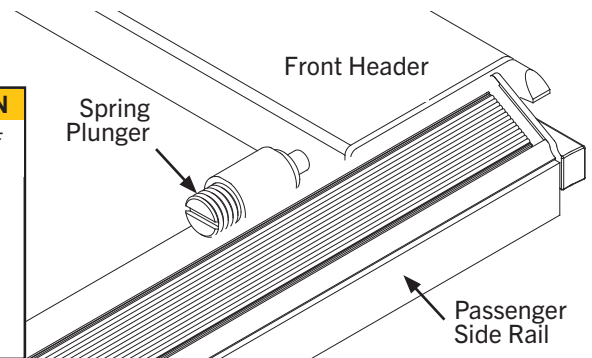
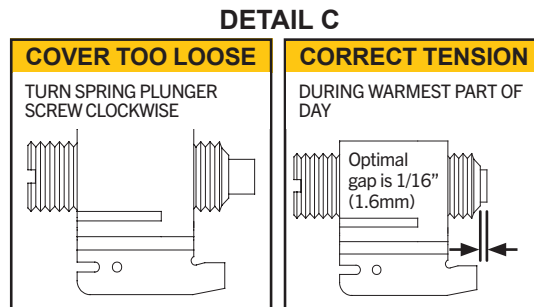

NOTE: Adjust tension in small increments. Slight adjustments will gain significant results.

LIMITED LIFETIME WARRANTY

WARRANTY COVERAGE

This truck bed cover is warranted against defects in materials or workmanship as follows. This warranty is void if the product has been damaged in an accident, or due to neglect, unforeseeable use, improper installation, improper servicing, or other cause not arising out of defects in material or workmanship.

LIMITED LIFETIME WARRANTY ON HARD PARTS

All hardware included with your truck bed cover, including rails, clamps and bows carry a limited lifetime warranty, subject to the terms below.

LIMITED LIFETIME WARRANTY FOR FABRIC

The fabric on your truck bed cover carries a limited lifetime warranty, subject to the terms below.

WARRANTY IS NOT TRANSFERABLE

The warranty is to the initial consumer purchasing the truck bed cover and it is not transferrable to a subsequent end user. Proof of purchase may be required to enforce these warranty rights.

WARRANTY CONDITIONS

Failure to follow these warnings and care instructions will void the warranty:

- Clean with mild automotive soap and water only.
- Do not use conditioners that contain silicone or petroleum.
- The tonneau cover must be secured at all points when the vehicle is in motion. When not fully closed with the rear latch engaged the cover must be completely rolled up and secured at the cab with both provided retainer straps attached. Do NOT drive with the bed cover in a partially open position.
- Cargo should not contact the tarp at any point. Protrusions in the tarp will stress the fabric. Cargo may also shift while traveling causing it to press against the fabric and damage it.
- Check rail clamps for tightness after a week of driving following the installation of the cover and periodically thereafter.
- Do NOT roll the cover into the rear cab window. Do NOT stow the cover against the cab of the truck.
- If the cover is going to be rolled open for an extended amount of time, periodically re-roll the cover and secure the retainer straps to ensure the cover doesn't rest against the cab of the truck.
- Before opening, the cover must be free of all foreign materials including snow and ice.
- Do NOT tow your vehicle from the rear with the cover on your vehicle. If towing from the rear is required, the cover MUST be removed from the vehicle and properly stored.

WARRANTY PERFORMANCE

If all warranty conditions are met, a defective truck bed cover, tarp, or hardware component will either be repaired or replaced (at our option). We reserve the right, for any warranty, to substitute a newer model of bed cover having similar form and function, to offer a warranty discount on an entire replacement system, and/or provide remedies other than those mentioned in this document.

WARRANTY PROCESS

A Return Material Authorization number must be obtained from our Customer Service Department prior to returning any product. We may require the original item to be returned postage prepaid for final determination. Shipping charges will apply for any repair or replacement. Other than postage or shipping charges, no charge will be made for repair or replacement under this warranty.

This warranty gives you specific legal rights. As a consumer, you may also have additional rights and remedies under the laws of your state.

WARRANTY REGISTRATION

Warranty registration must be on file and/or proof of original purchase (detailed and dated receipt) required for warranty to be effective.

Register online at <https://realtruck.com/truxedo-warranty/>

**REGISTER
YOUR
WARRANTY
ONLINE**





SAFETY INSTRUCTIONS

- DO NOT place objects on or against cover or framework.
- DO NOT tie cargo to truck bed cover framework.
- DO NOT attempt to drive with the cover in the partially open position.
- DO NOT operate vehicle with objects on top of the cover.
- NEVER allow children or pets to occupy pickup box while cover is closed.
- Cover is not airtight. Special care is required to keep cargo clean and dry.
- Tonneau covers won't prevent theft of contents inside truck box.
- The cover assembly (tarp) must be rolled fully open and secured with retainer straps when towing vehicle backwards.
- If the cover is going to be rolled open for an extended amount of time, periodically re-roll the cover and secure the retainer straps to ensure the cover doesn't rest against the cab of the truck.
- A fully rolled cover in the open position must always be secured with retainer straps.

TROUBLESHOOTING TIPS

WRINKLES ON THE FABRIC AFTER ROLLING COVER CLOSED

- Pull the fabric taut from each side. For best results, the help of a second person pulling on the opposite side is preferable.

SAGGING FABRIC BETWEEN THE CROSS BOWS

- Adjustment to automatic tension control may be required.

WIND LIFTS UP THE EDGE OF THE FABRIC

- Make sure to engage the hook and loop on the driver and passenger side rails after closing the cover. This may need to be done periodically when taking long trips.

FABRIC FLUTTERS EXCESSIVELY WHEN DRIVING

- Check cover tension, refer to the Automatic Tension Control section.
- Make sure hook and loop fasteners are set. See Step 16 - 17.

SNOW AND ICE ACCUMULATION ON THE FABRIC

- Use broom or brush to remove loose snow and ice. DO NOT use sharp or pointed tools to remove snow and ice.
- Direct sunlight will help melt snow and ice off the fabric.

TONNEAU COVER WILL NOT LATCH

- Check side rails to make sure they are level. See Steps 8 - 11.
- Make sure the header seal is not caught between side rails & header.
- Check the position of side rails on the pickup box. They may be positioned too low. See Steps 8 - 11.
- Make sure the cover has proper tension, refer to the Automatic Tension Control section.

FABRIC IS TOO TIGHT OR TOO LOOSE

- See Automatic Tension Control section to adjust tension.

FABRIC HAS SHIFTED TOO FAR TO ONE SIDE

- Unlatch the cover at the tailgate, release the hook and loop along both sides, go to the shorter side of the tarp and tug. The fabric will slide in the aluminum headers. Pull on the shorter side until the tarp appears centered on the whole system. Latch the cover and secure the hook and loop down both sides. Repeat if more adjustment is needed.

COVER CARE AND MAINTENANCE

- Clean with soap and water. The cover can be treated with any vinyl protectant specifically made for tonneau covers.
- It is recommended that you periodically check that the cover is securely attached to your truck bed. Inspect the clamps and front header guide slides to ensure they were properly installed and have not come loose during operation.
- It is recommended that you periodically inspect and service the rear latch closure. Clean away any excess dirt or grime.
- Covers that are used frequently or are subject to vibrations and impacts from rough roadways may require adjustment.

FAQ

WHY IS THERE A HOLE PUNCHED AT THE REAR OF THE PASSENGER SIDE RAIL OF THE TRUXEDO LO PRO, DEUCE AND PRO X15 BUT NO LATCH?

All side rails are punched identically to keep them uniform, to ensure manufacturing efficiency and to reduce tooling costs. By doing this, TruXedo can build and ship more covers while maintaining competitively priced products of the highest quality.

WHY IS MY COVER HOLDING WATER AFTER IT RAINS?

Water pooling on the cover is normal because our cross bows are not arched. Since they are designed to sit flat some water may accumulate on the top of the cover. Once you drive your truck, the water will shed from the cover. Make sure to retighten the hook and loop fasteners along the length of the bed.

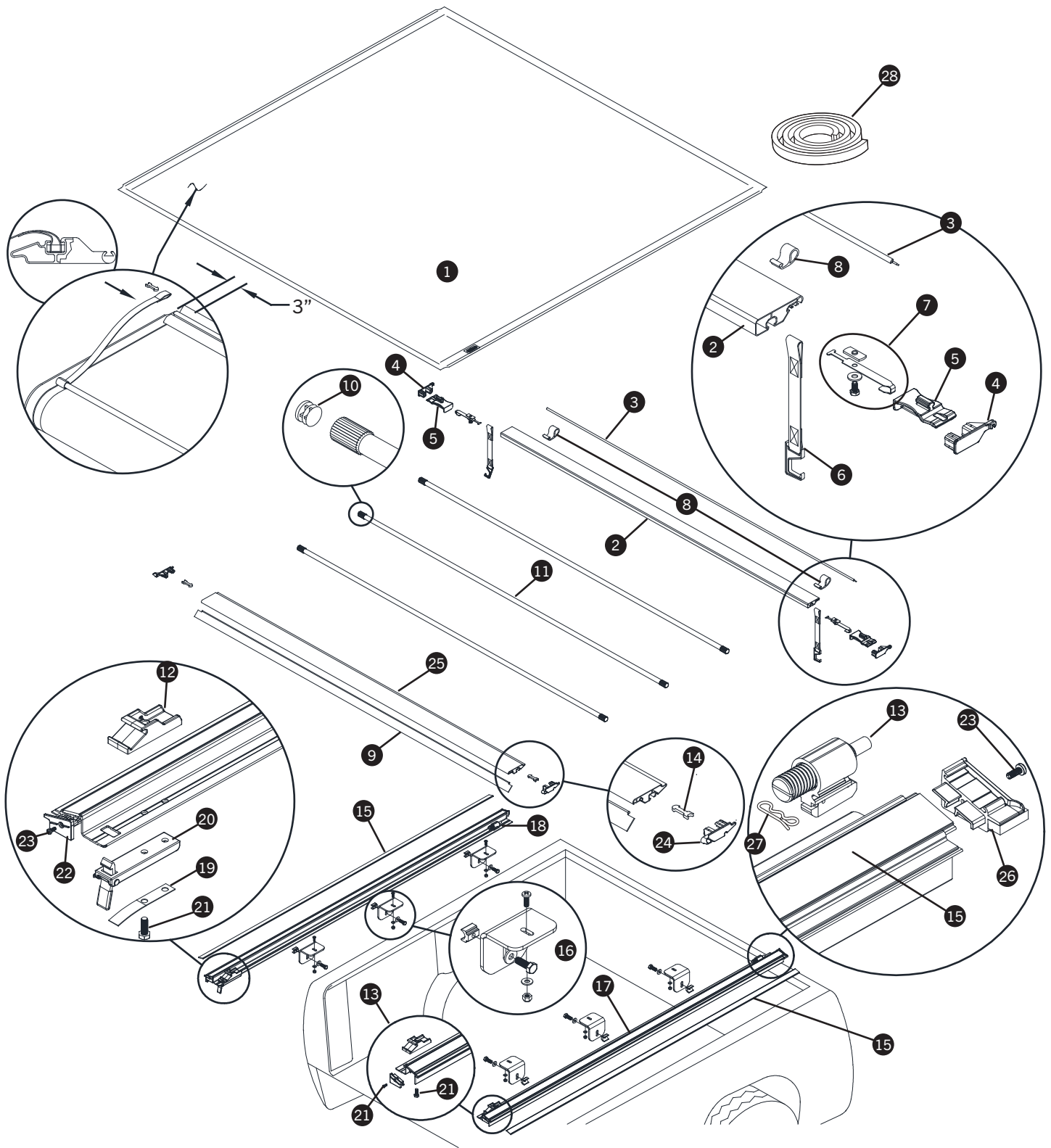

Replacement Parts

1	*	Replacement Cover	11	*	Aluminum Cross Tubes	21	1702926	Cap Screw, 5/16" x 7/8"
2	*	Black Front Header	12	1704187	Header Stop	22	1118700	Rear Side Rail End Plugs (Set of Two)
3	*	Header Seal Front	13	1115356	Tension Control Housing & Spring Tension	23	1706547	Square Head Screw (#1 Drive)
4	1117540	Front Header End Plugs (Set of two)	14	1705787	Header Insert Retainer Clip	24	1117467	Rear Header End Plugs XLP (Set of Two)
5	1704707	Header Guide	15	*	Hook and Loop Fasteners	25	*	Black Rear Header
6	*	Retainer Strap	16	1119134	Bracket and Hardware (1)	26	1118701	Front Rail End Plugs (Set of Two)
7	1117594	Header Guide Retainer Assembly	17	*	Rail, Passenger's Side	27	1707003	Pin, Hitch_1/16" Dia. x 1-5/16" Long
8	*	Extruded Retainer Loop	18	*	Rail, Driver's Side	28	1118237	Bulkhead Seal
9	*	Header Seal Rear	19	1705727	Flat Spring, 5/8" x 3 7/8"			
10	1705052	End Plug, 1" OD	20	1704213	Latch Assembled			

*Please specify length or make and model of vehicle.