

# INSTALLATION INSTRUCTIONS

## CUSTOMER SERVICE

Phone: 877-878-9336 • 8:00 am - 5:00 pm Mon - Fri CT

Email: [customersupport@truxedo.com](mailto:customersupport@truxedo.com)



**PARTS INCLUDED  
 IN YOUR KIT:**

- A** Driver side rail
- B** Passenger side rail
- C** Cover assembly
- D** Bulkhead seal

**PARTS INCLUDED IN HARDWARE BAG:**

- E** 6x Anchor block
- F** 6x Screw 5/16-18 x 7/8"
- G** 6x Washer, 5/16"
- H** 6x Formed braket
- I** 2x Corner block seal
- J** 6x Screw pan head 1/4-20 x 3/4"
- K** 6x Hex nut 1/4-20 nylon locking
- L** 6x Washer, 1/4"

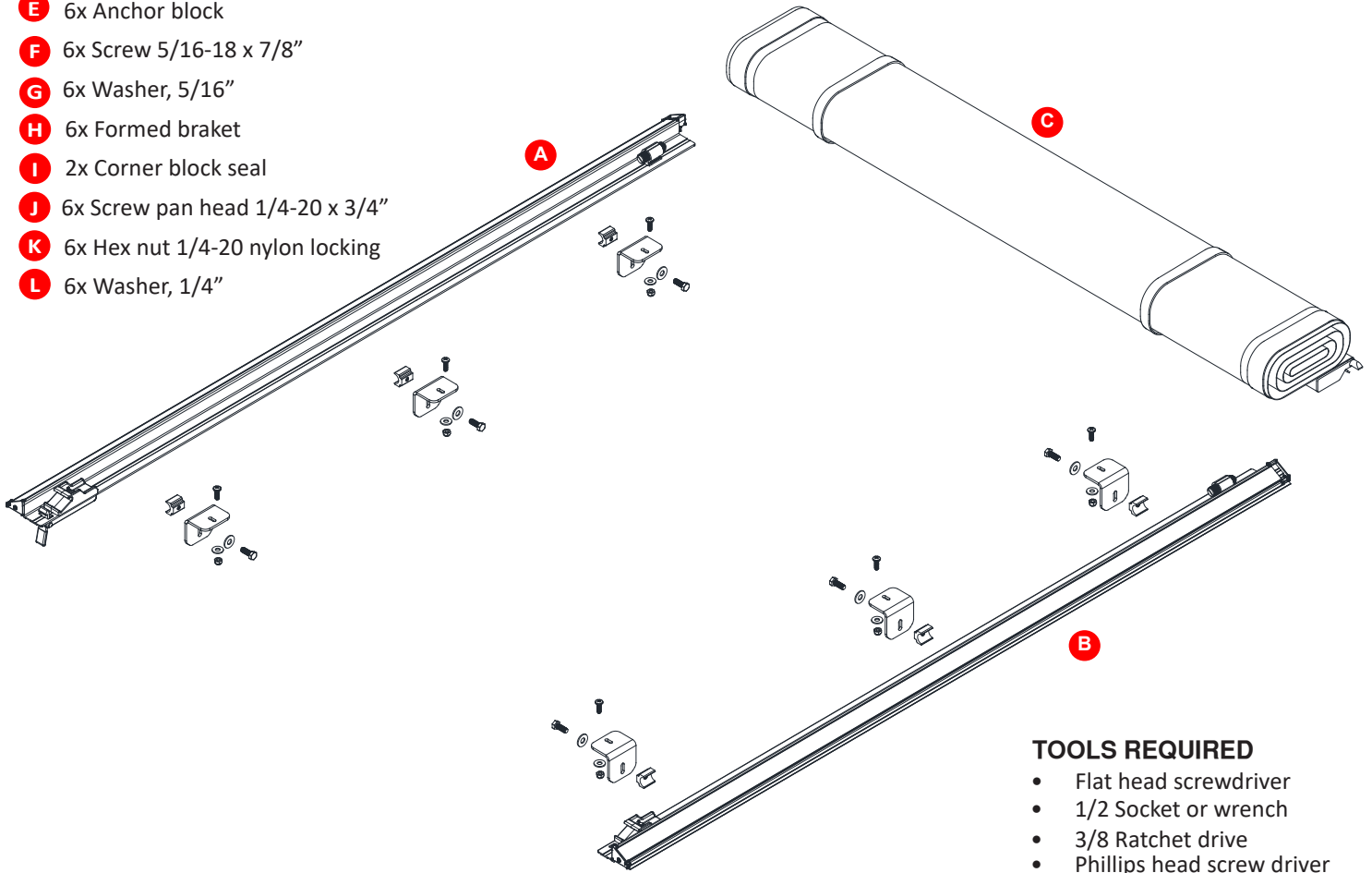

**TOOLS REQUIRED**

- Flat head screwdriver
- 1/2 Socket or wrench
- 3/8 Ratchet drive
- Phillips head screw driver
- 7/16 socket or wrench

**TOOLS RECOMMENDED**

- Isopropyl alcohol
- Scissors/utility knife

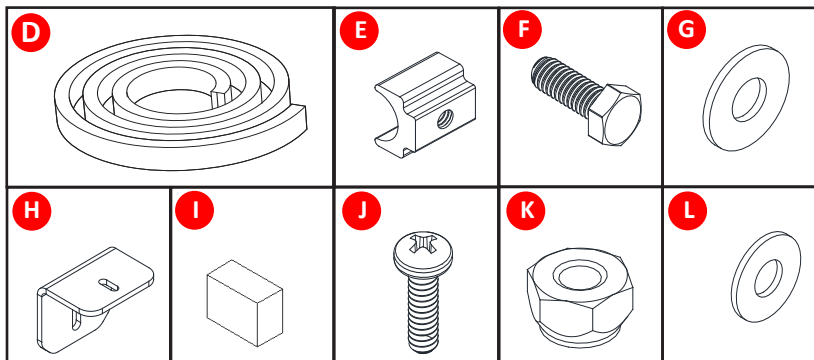

**1** The serial number for the cover is located here.

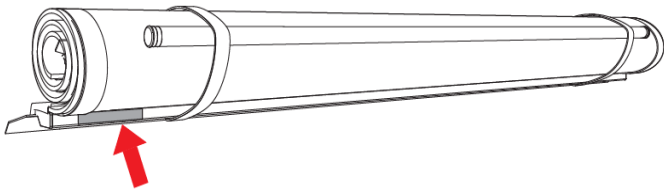

For future reference, write it here:

\_\_\_\_\_.

**2** It is important that all areas where the bed cover mounts are clean and free of debris prior to installing.



**3** Install the bulkhead weather seal (D) to the truck's front bulkhead. Clean the area where the seal will go with soap and water to remove dirt and debris. Then clean the area with isopropyl alcohol to remove wax or grease and to evaporate any remaining water, allow the surface to dry. Then position the seal and apply pressure to the entire seal to make sure the adhesion is good. Trim end of seal with scissors so the ends fit flush against the bed caps.

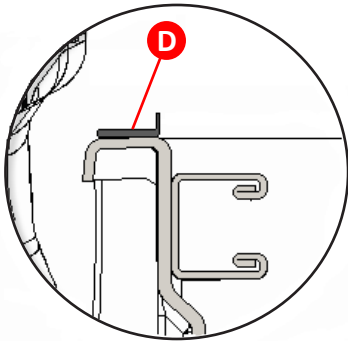

Side view of weather seal showing how the weather seal is positioned across the truck's bulkhead

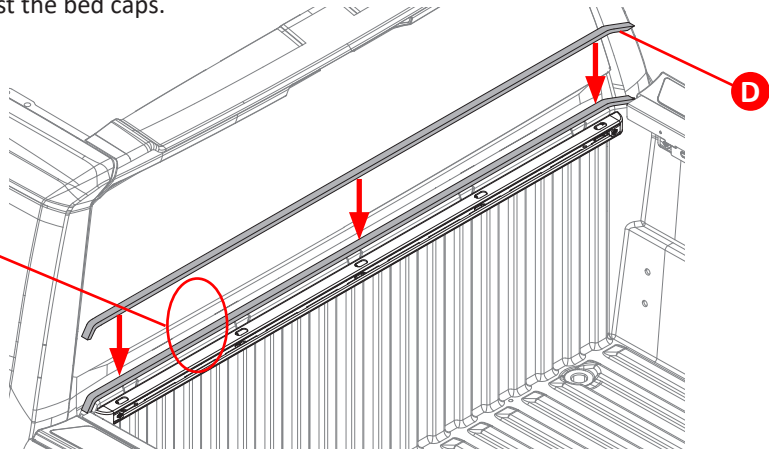

Top view of truck showing how the weather seal is positioned across the truck's bulkhead.

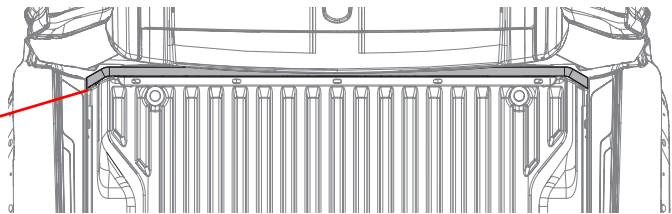

**4** Install the block seals (I) in the corners where the front bulkhead seal (D) meets the side rail.

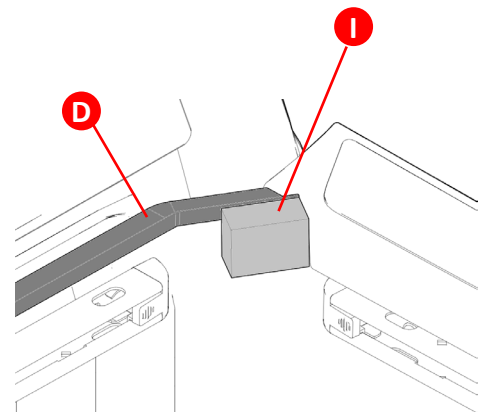
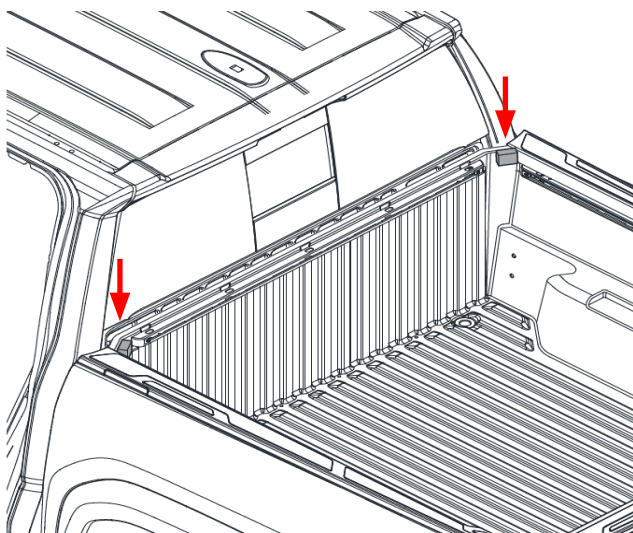

**5 Remove cargo rail end plugs:** Begin by pushing in on the end plug tab and at the same time push the end plug out of the rail.

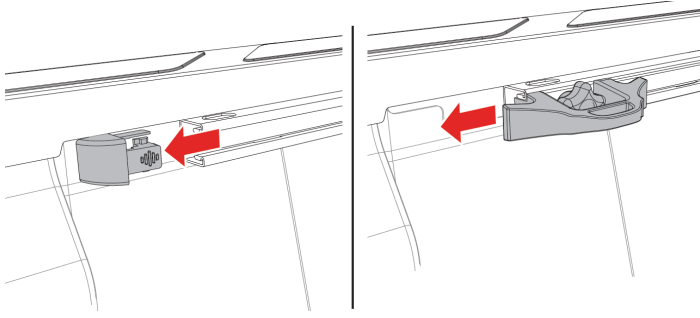

**6 Install 3 anchor blocks (E) into the accessory rail from the tailgate end.** Then put the end cap back into the tailgate end of the accessory rail. Repeat installation for drive side.

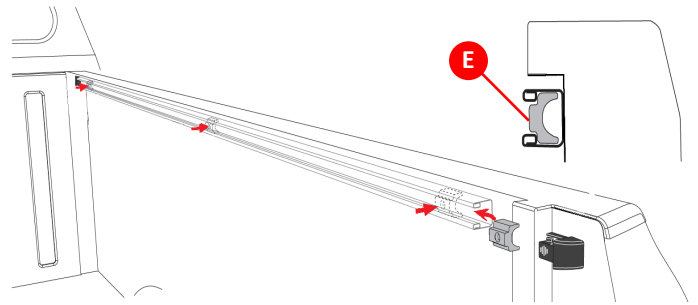

**7 Reinstalling cargo tie-downs:** If tie-downs are going to be used, install the tie-downs now. Depress knob and turn cleat. Driver side shown repeat for passenger side.

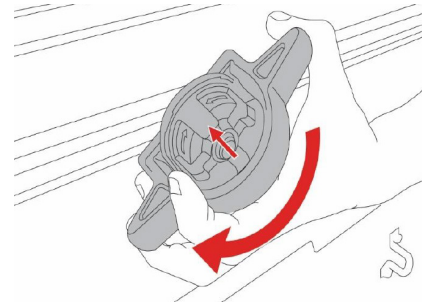
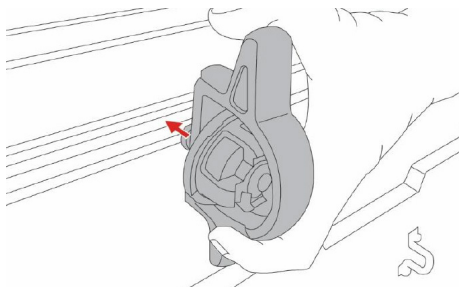

**8 Attaching the formed brackets:** Begin by aligning the formed brackets (H) with the anchor blocks (E). Make sure the holes on the brackets align with the corresponding holes on the anchors.

**Fastening:** Use 5/16 x 7/8" long screws (F) along with 5/16 washers (G) to attach the formed brackets to the anchor blocks. Insert the screws through the aligned holes on the brackets and anchors, placing washers between the screw heads and the brackets for secure attachment.

**Positioning:** Inside each cargo rail, position the brackets and anchors as follows: Ensure there is one bracket at the cab, one in the middle, and one at the tailgate of the cargo rail. Repeat the same process for both the driver side and the passenger side of the cargo rail.

**Leave fasteners loose:** It's important to leave all fasteners loose at this stage. This allows for adjustments to be made later on to ensure proper alignment and fitment of the side rails (A) and (B) to the brackets.

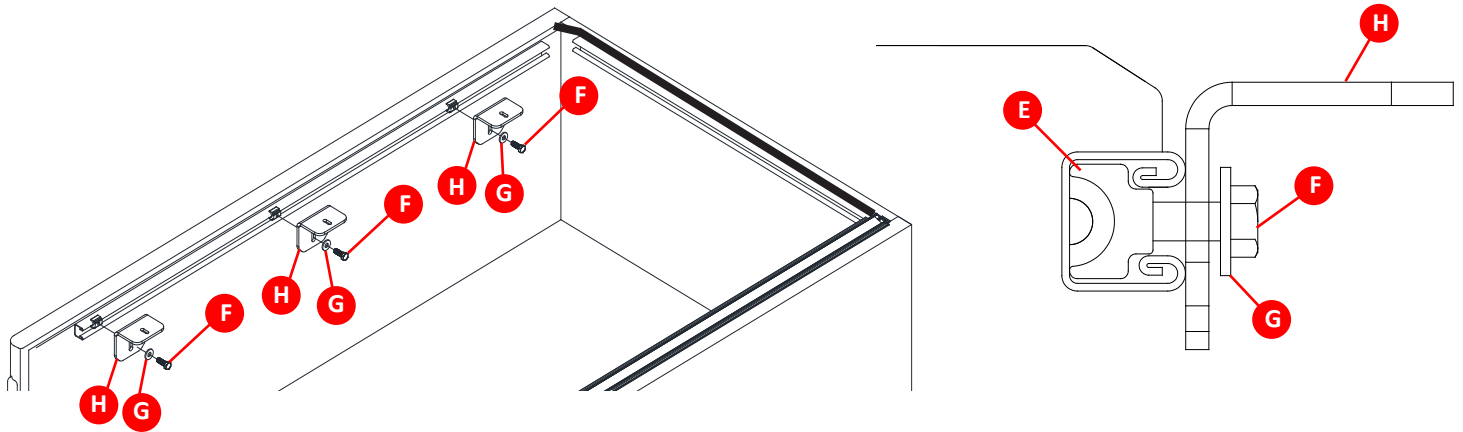

**9 To attach the side rails to the formed brackets, follow these steps:**

**Positioning:** Place the side rails (A) and (B) onto the formed brackets (H) that you have previously attached to the cargo rail anchors. Ensure that the side rails are positioned securely and aligned properly with the formed brackets.

**Fastening:** Use 1/4 x 3/4" screws (J) along with 1/4 washers (L) and 1/4" nylon locking nuts (K) to fasten the side rails to the formed brackets. Insert the screws through the holes in the side rails and brackets, placing washers between the screw heads and the side rails for added stability. Secure the screws with the nylon locking nuts.

**Leave fasteners loose:** At this stage, it's crucial to leave all fasteners loose. This allows for adjustments to be made later on to ensure proper alignment and fitment of the side rails. Tightening the fasteners prematurely may make adjustments difficult.

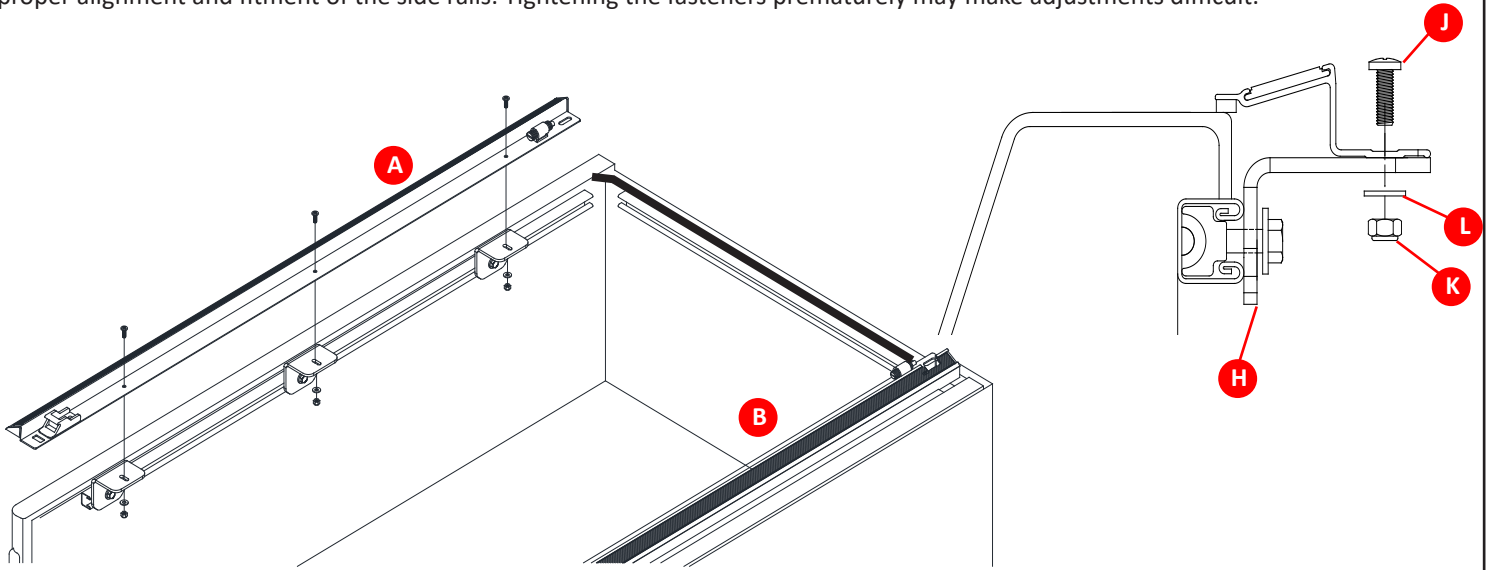

**10 Position assembled side rails from the closed tailgate:** With the truck's tailgate closed, position the end of each rail approximately 1/2" away from the rear corner of the truck bed. This positioning helps ensure proper alignment of the rail system and allows for clearance when opening and closing the tailgate.

**Repeat for passenger rail:** Repeat the entire process to install the passenger rail on the opposite side of the truck bed. Follow the same steps to position brackets, align anchor blocks, fasten rail brackets, and position the end of the rail.

**Driver Side Rail Shown**

Image is showing the correct side rail position from the tailgate.

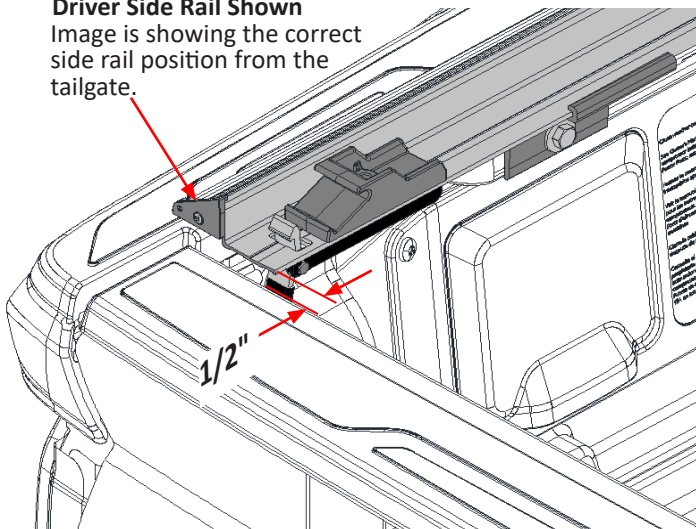

**Passenger Side Rail Shown**

Image is showing the correct side rail position from the tailgate.

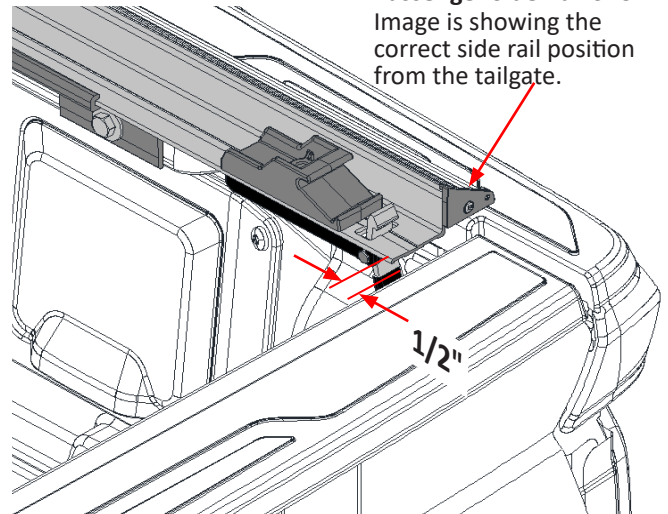

**11** **Positioning the side rails (A) and (B) from the bed caps at the tailgate end of the truck bed:** At this point, the side rails should already be spaced correctly fore and aft (lengthwise), focusing now on the side-to-side spacing at the tailgate end.

**Measuring the proper placement:** Use a tape measure to help place the side rails 2" from the inside edge of the truck's plastic bed cap. The goal is to have equal spacing on both sides to ensure symmetry and proper alignment.

**Secure the side rails (A) and (B):** Once the rails are correctly aligned with equal spacing on both sides at the tailgate end, proceed to tighten any loose hardware on the rear brackets. Apply downward pressure on the rails while tightening the fasteners to ensure proper sealing.

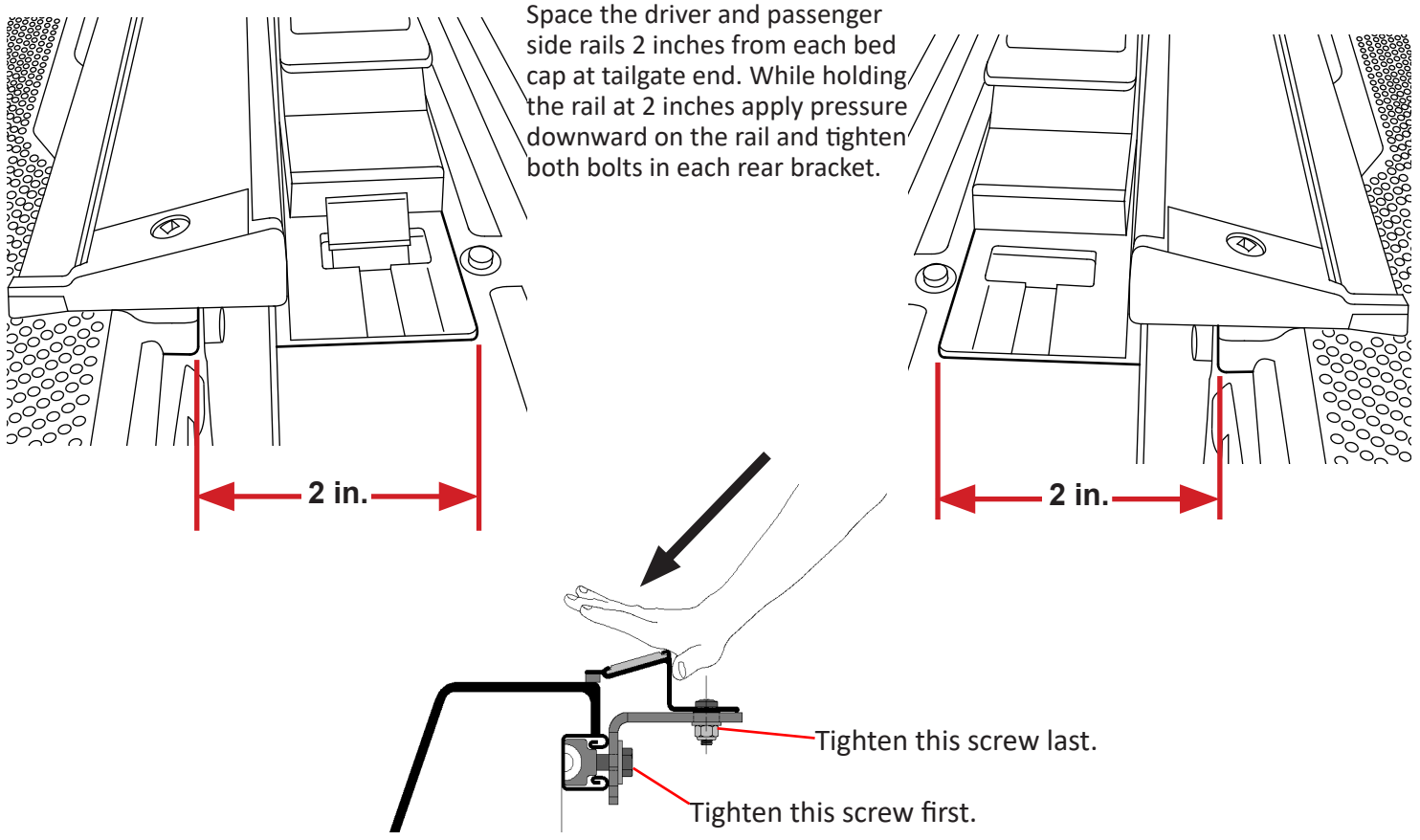

**12** **Positioning the side rails (A) and (B) from the bed caps at the cab end of the truck bed:** At this point, the side rails should already be spaced correctly fore and aft (lengthwise), focusing now on the side-to-side spacing at the cab end.

**Measuring the proper placement:** Use a tape measure to help place the side rails 2-5/8" from the inside edge of the trucks plastic bed cap. The goal is to have equal spacing on both sides to ensure symmetry and proper alignment.

**Secure the side rails (A) and (B):** Once the rails are correctly aligned with equal spacing on both sides at the cab end, proceed to tighten any loose hardware on the front brackets. Apply downward pressure on the rails while tightening the fasteners to ensure proper sealing.

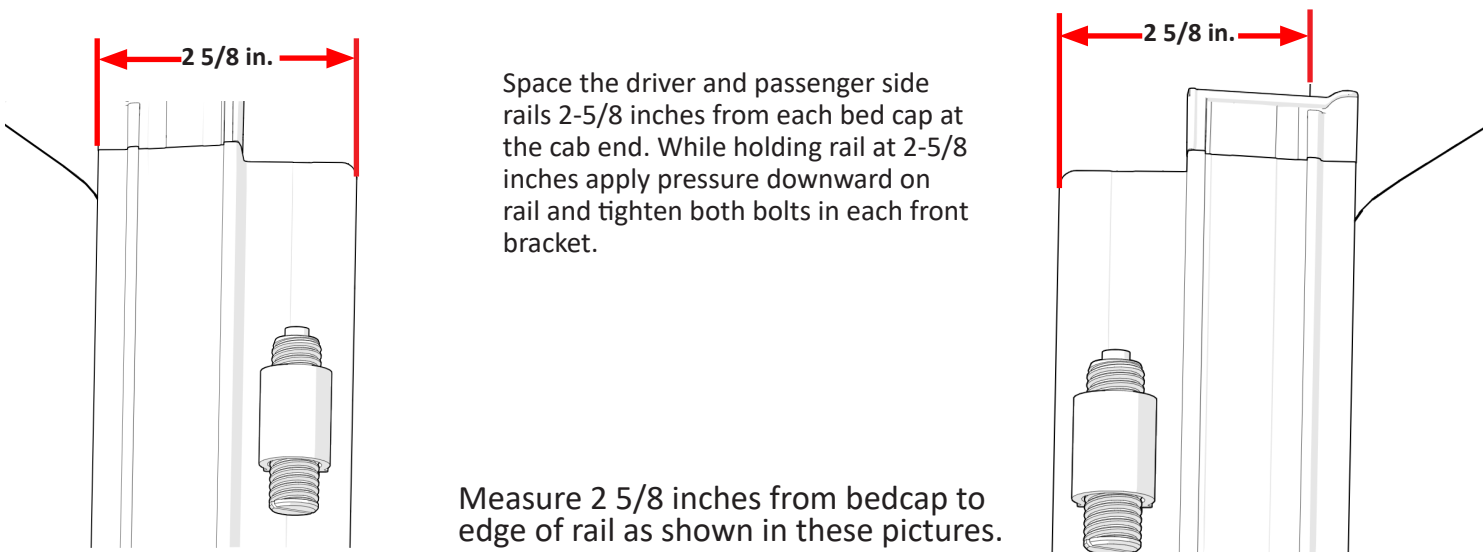

**13** Place the cover (C) on the side rails towards the front of the truck bed (near the cab). The front header seal is designed to help shed water and should be sitting on top of the bulkhead.

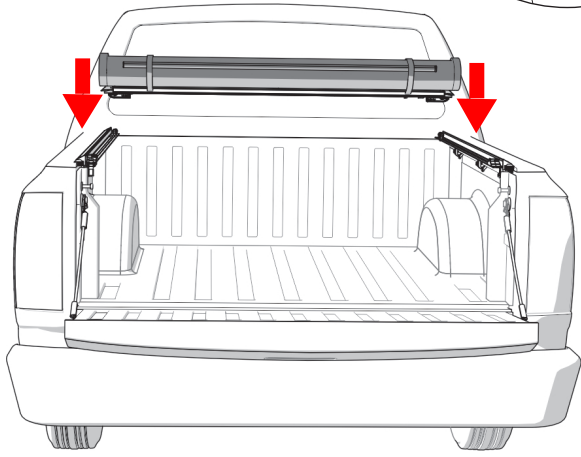
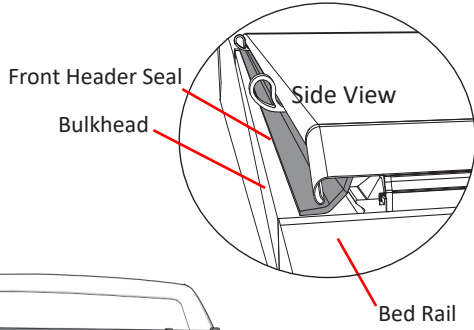

**14** To connect the cover assembly (C) to the side rails (A & B) follow these steps: Slide the right and left header guides into the locked position: Ensure that the header guides are aligned properly with the side rails.

**Listen for a clicking sound:** As you slide the header guides into place, you should hear a clicking sound. This clicking sound indicates that the header guides have securely attached to the side rails.

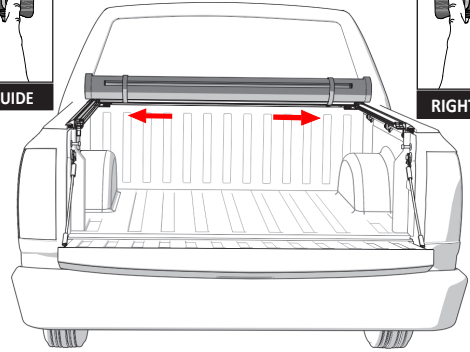
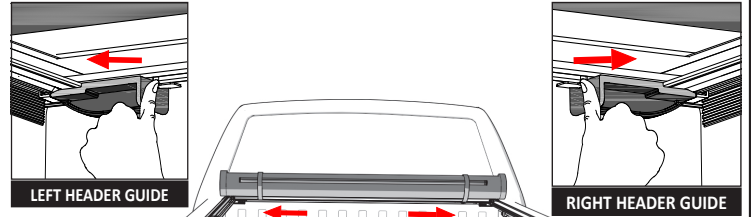

**NOTE:** If both retainer hooks are properly connected to the retainer loops, you may drive with the cover in the open position.

### TO DRIVE WITH THE COVER IN THE CLOSED POSITION

**15** Disengage the retainer hooks from the retainer loops: Locate the retainer hooks that secure the cover in place when closed. Disengage these hooks from the retainer loops by releasing them.

**Unroll the cover towards the tailgate:** Once the retainer hooks are disengaged, carefully unroll the cover towards the tailgate of the vehicle. Ensure that the cover is properly aligned and secured in place before driving.

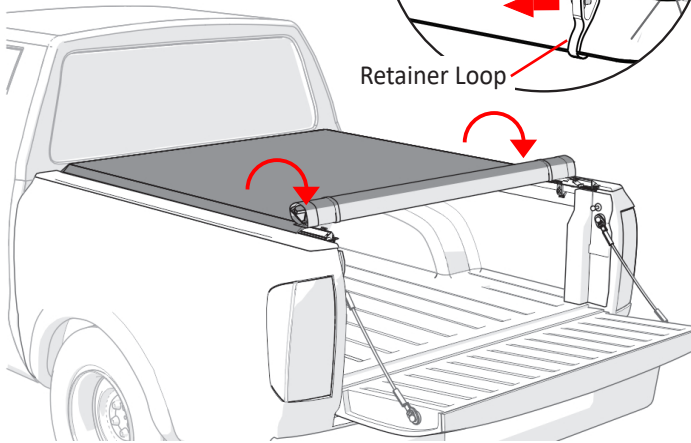
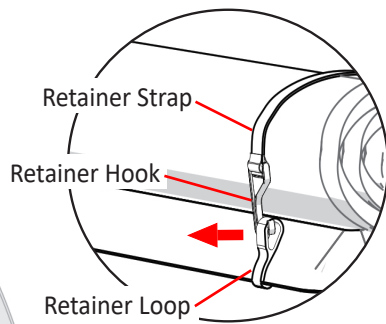

**16** To latch and secure the cover properly, follow these steps:

Place the rear header into the header stops: Locate the header stops on both side rails. These stops are designed to hold the rear header in place. Ensure that the rear header is positioned correctly within these stops.

**Rotate the rear header downwards:** Once the rear header is positioned correctly within the header stops, rotate it downwards. As you rotate it, you should feel the cover latch into place. This indicates that the cover is securely fastened and ready for use.

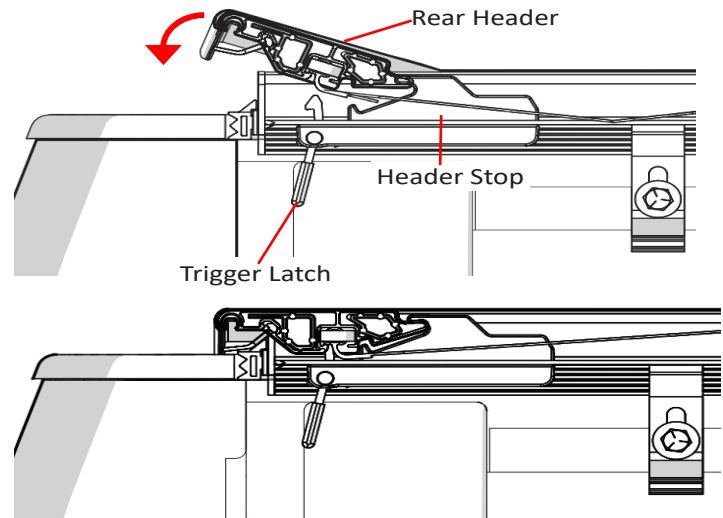

**NOTE:** We recommend closing the tailgate first and then closing the cover.

**17** To ensure proper installation and safety before driving, follow these steps:

**Listen for a clicking sound:** After securing the cover and placing the rear header into the header stops, listen for a clicking sound. This sound indicates that the cover is correctly installed and securely fastened.

**Secure the hook and loop fastener along the entire length of both side rails:** After confirming the cover is properly installed, proceed to secure the hook and loop fastener along the entire length of both side rails. Simply run your hands down both sides of the cover to achieve this. This helps to ensure that the cover remains firmly in place while driving, preventing it from coming loose or flapping in the wind and causing possible damage. **You are ready to drive with the cover in the closed position.**

**NOTE:** If the tailgate has a key lock, the cover is secured until the tailgate is unlocked and opened.

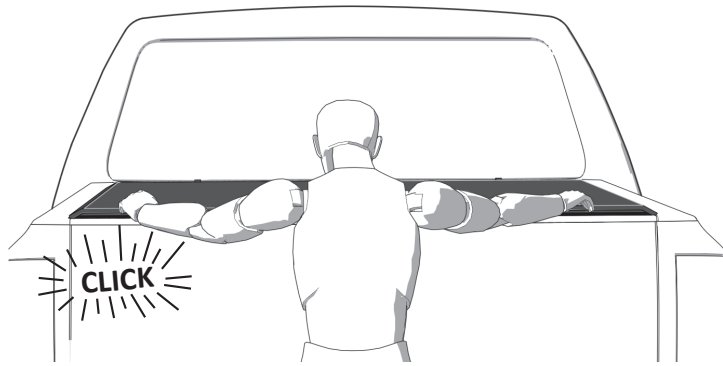

**COVER IN THE OPEN POSITION**

To drive with the cover in the open position, follow these steps:

**Release the cover latch:** Located on the driver side rail, there is a latch. Pull this latch towards you to release the cover.

**Roll the cover toward the cab of the truck:** Once the latch is released, start rolling the cover toward the cab of the truck. Ensure that both sides roll evenly to prevent any misalignment or damage to the cover.

**Secure the cover:** After rolling the cover towards the cab, secure it by placing both retainer hooks into the retainer loops. This ensures that the cover remains stable and in place while driving with the cover open.

**Ready to drive:** Once the cover is securely fastened with the retainer hooks in the retainer loops, you are ready to drive with the cover in the open position.

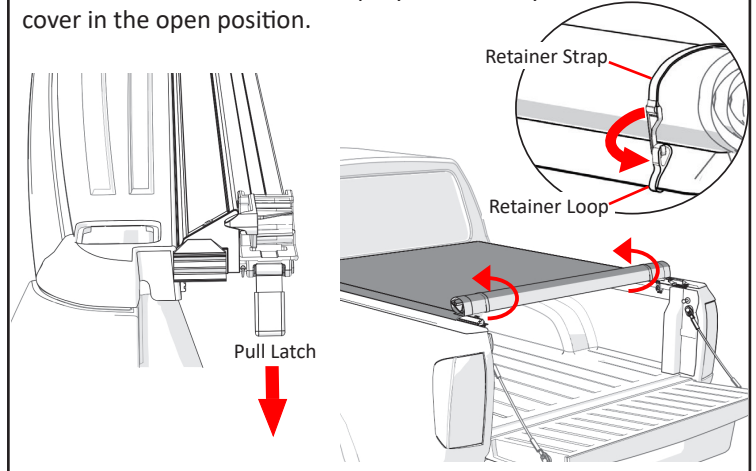

**AUTOMATIC TENSION CONTROL ADJUSTMENT**

Lo Pro is equipped with Automatic Tension Control. This helps compensate for material expansion and contraction caused by extreme temperature changes. Proper tension allows the cover to look and perform at its best. While preset at the factory, you can check cover tension after installation as well as seasonally.

If the cover feels too tight or too loose when opening or closing it, adjust the tension during the warmest part of the day. With the cover closed, release the hook and loop fastener from both side rails near the cab. Check compression of both spring plungers against the front header per Detail C. Roll the cover open and make adjustments. Repeat until satisfactory tension has been achieved.

**COVER TOO LOOSE**

TURN SPRING PLUNGER SCREW CLOCKWISE

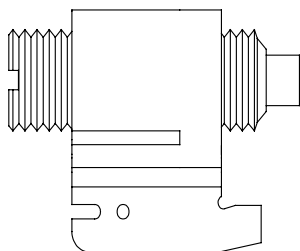

**CORRECT TENSION**

DURING WARMEST PART OF DAY

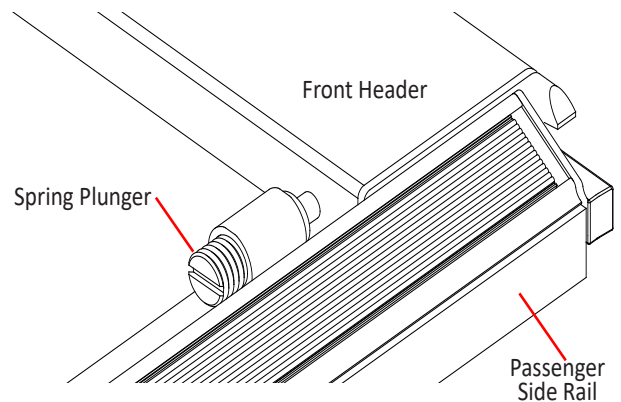
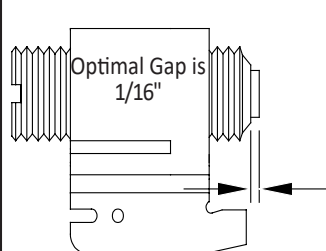

**NOTE:** Adjust tension in small increments. Slight adjustments will gain significant results.



# LIMITED LIFETIME WARRANTY

## WARRANTY COVERAGE

This truck bed cover is warranted against defects in materials or workmanship as follows. This warranty is void if the product has been damaged in an accident, or due to neglect, unforeseeable use, improper installation, improper servicing, or other cause not arising out of defects in material or workmanship.

## LIMITED LIFETIME WARRANTY ON HARD PARTS

All hardware included with your truck bed cover, including rails, clamps and bows carry a limited lifetime warranty, subject to the terms below.

## LIMITED LIFETIME WARRANTY FOR FABRIC

The fabric on your truck bed cover carries a limited lifetime warranty, subject to the terms below.

## WARRANTY IS NOT TRANSFERABLE

The warranty is to the initial consumer purchasing the truck bed cover and it is not transferrable to a subsequent end user. Proof of purchase may be required to enforce these warranty rights.

## WARRANTY CONDITIONS

Failure to follow these warnings and care instructions will void the warranty:

- Clean with mild automotive soap and water only.
- Do not use conditioners that contain silicone or petroleum. The cover can be treated with any vinyl protectant specifically made for tonneau covers.
- The tonneau cover must be secured at all points when the vehicle is in motion. When not fully closed with the rear latch engaged the cover must be completely rolled up and secured at the cab with both provided retainer straps attached. DO NOT drive with the bed cover in a partially open position.
- Cargo should not contact the tarp at any point. Protrusions in the tarp will stress the fabric. Cargo may also shift while traveling causing it to press against the fabric and damage it.
- Do NOT tie cargo to truck bed cover framework.
- Check rail clamps for tightness after a week of driving following the installation of the cover and periodically thereafter.
- Do NOT roll the cover into the rear cab window. Do NOT stow the cover against the cab of the truck.
- If the cover is going to be rolled open for an extended amount of time, periodically re-roll the cover and secure the retainer straps to ensure the cover doesn't rest against the cab of the truck.
- Before opening, the cover must be free of all foreign materials including snow and ice.
- Do NOT tow your vehicle from the rear with the cover on your vehicle. If towing from the rear is required, the cover MUST be removed from the vehicle and properly stored.

## WARRANTY PERFORMANCE

If all warranty conditions are met, a defective truck bed cover, tarp, or hardware component will either be repaired or replaced (at our option). We reserve the right, for any warranty, to substitute a newer model of bed cover having similar form and function, to offer a warranty discount on an entire replacement system, and/or provide remedies other than those mentioned in this document.

## WARRANTY PROCESS

A Return Material Authorization number must be obtained from our Customer Service Department prior to returning any product. We may require the original item to be returned postage prepaid for final determination. Shipping charges will apply for any repair or replacement. Other than postage or shipping charges, no charge will be made for repair or replacement under this warranty. This warranty gives you specific legal rights. As a consumer, you may also have additional rights and remedies under the laws of your state.

## WARRANTY REGISTRATION

Warranty registration must be on file and/or proof of original purchase (detailed and dated receipt) required for warranty to be effective.

Please register online at <https://realtruck.com/truxedo-warranty>

REGISTER  
YOUR  
WARRANTY  
ONLINE



## **SAFETY INSTRUCTIONS**

- DO NOT place objects on or against cover or framework.
- DO NOT tie cargo to truck bed cover framework.
- DO NOT attempt to drive with the cover in the partially open position.
- DO NOT operate vehicle with objects on top of the cover.
- NEVER allow children or pets to occupy pickup box while cover is closed.
- Cover is not airtight. Special care is required to keep cargo clean and dry.
- Tonneau covers won't prevent theft of contents inside truck box.
- If the cover is going to be rolled open for an extended amount of time, periodically re-roll the cover and secure the retainer straps to ensure the cover doesn't rest against the cab of the truck.
- A fully rolled cover in the open position must always be secured with retainer straps.

## **TROUBLESHOOTING TIPS**

### **WRINKLES ON THE FABRIC AFTER ROLLING COVER CLOSED**

- Pull the fabric taut from each side. For best results, the help of a second person pulling on the opposite side is preferable.

### **SAGGING FABRIC BETWEEN THE CROSS BOWS**

- Adjustment to automatic tension control may be required.

### **WIND LIFTS UP THE EDGE OF THE FABRIC**

- Make sure to engage the hook and loop on the driver and passenger side rails after closing the cover. This may need to be done periodically when taking long trips.

### **FABRIC FLUTTERS EXCESSIVELY WHEN DRIVING**

- Check cover tension, refer to the Automatic Tension Control section.
- Make sure hook and loop fasteners are set. See Step 17.

### **SNOW AND ICE ACCUMULATION ON THE FABRIC**

- Use broom or brush to remove loose snow and ice. DO NOT use sharp or pointed tools to remove snow and ice.
- Direct sunlight will help melt snow and ice off the fabric.

### **TONNEAU COVER WILL NOT LATCH**

- Check side rails to make sure they are level. See Steps 9 thru 12.
- Make sure the header seal is not caught between side rails & header.
- Check the position of side rails on the pickup box. They may be positioned too low. See Steps 9 thru 12.
- Make sure the cover has proper tension, refer to the Automatic Tension Control section.

### **FABRIC IS TOO TIGHT OR TOO LOOSE**

- See Automatic Tension Control section to adjust tension.

### **FABRIC HAS SHIFTED TOO FAR TO ONE SIDE**

- Unlatch the cover at the tailgate, release the hook and loop along both sides, go to the shorter side of the tarp and tug.

## **COVER CARE AND MAINTENANCE**

- Clean with soap and water. The cover can be treated with any vinyl protectant specifically made for tonneau covers.
- It is recommended that you periodically check that the cover is securely attached to your truck bed. Inspect the clamps and front header guide slides to ensure they were properly installed and have not come loose during operation.
- It is recommended that you periodically inspect and service the rear latch closure. Clean away any excess dirt or grime.
- Covers that are used frequently or are subject to vibrations and impacts from rough roadways may require adjustment.

## **FAQ**

### **WHY IS THERE A HOLE PUNCHED AT THE REAR OF THE PASSENGER SIDE RAIL OF THE TRUXEDO LO PRO, DEUCE AND PRO X15 BUT NO LATCH?**

All side rails are punched identically to keep them uniform, to ensure manufacturing efficiency and to reduce tooling costs. By doing this, TruXedo can build and ship more covers while maintaining competitively priced products of the highest quality.

### **WHY IS MY COVER HOLDING WATER AFTER IT RAINS?**

Water pooling on the cover is normal because our cross bows are not arched. Since they are designed to sit flat some water may accumulate on the top of the cover. Once you drive your truck, the water will shed from the cover. Make sure to retighten the fasteners along the length of the bed.

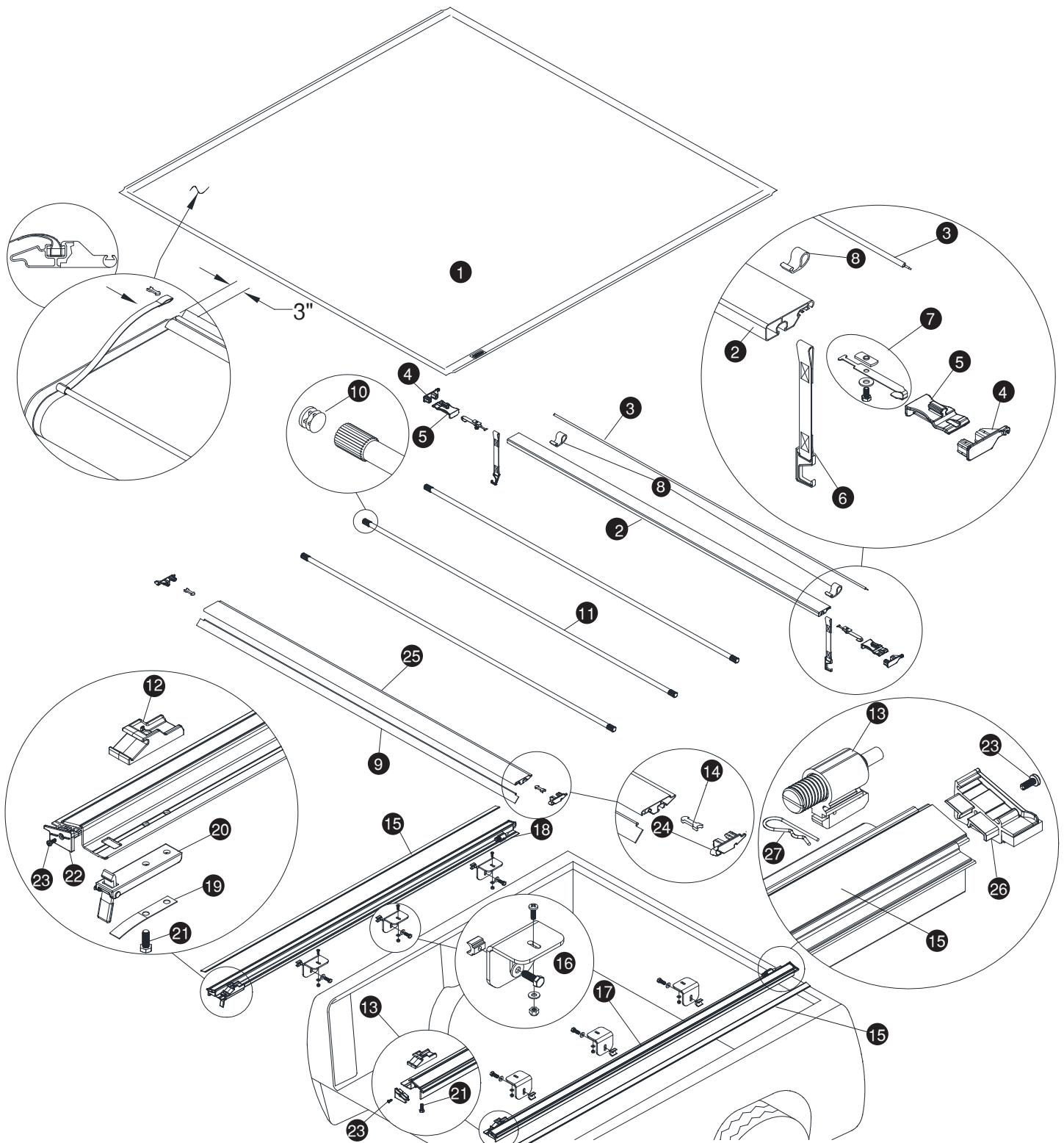

### Replacement Parts

1	*	Replacement Cover	11	*	Aluminum Cross Tubes	19	1705727	Flat Spring, 5/8" x 3 7/8"
2	*	Black Front Header	12	1704187	Header Stop	20	1704213	Latch Assembled
3	*	Header Seal Front	13	1115356	Tension Control Housing & Spring Tension	21	1702926	Cap Screw, 5/16" x 7/8"
4	1117540	Front Header End Plugs (Set of Two)	14	1705787	Header Insert Retainer Clip	22	1118700	Rear Side Rail End Plugs w/Seal XLP (Set of Two)
5	1704707	Header Guide	15	*	Hook and Loop Fasteners	23	1706547	Square Head Screw (#1 Drive)
6	*	Retainer Strap	16	1119134	Bracket and Hardware (1)	24	1117467	Rear Header End Plugs XLP (Set of Two)
7	1117594	Header Guide Retainer Assembly	17	*	Rail, Passenger's Side	25	*	Black Rear Header
8	*	Extruded Retainer Loop	18	*	Rail, Driver's Side	26	1118701	Front Rail End Plugs w/Seal (Set of Two)
9	*	Header Seal Rear				27	1706766	Hitch Pin, Driver Side
10	1705052	End Plug, 1" OD					1706832	Hitch Pin, Passenger Side

\* Please specify length or make and model of vehicle.