

NOTE: It is important that all areas where the bed cover mounts are clean and free of debris prior to installing.

TOOLS REQUIRED

- Flat head screwdriver
- 1/2" wrench or socket
- Isopropyl alcohol

TOOLS RECOMMENDED

- Spring clamps
- Scissors/utility knife

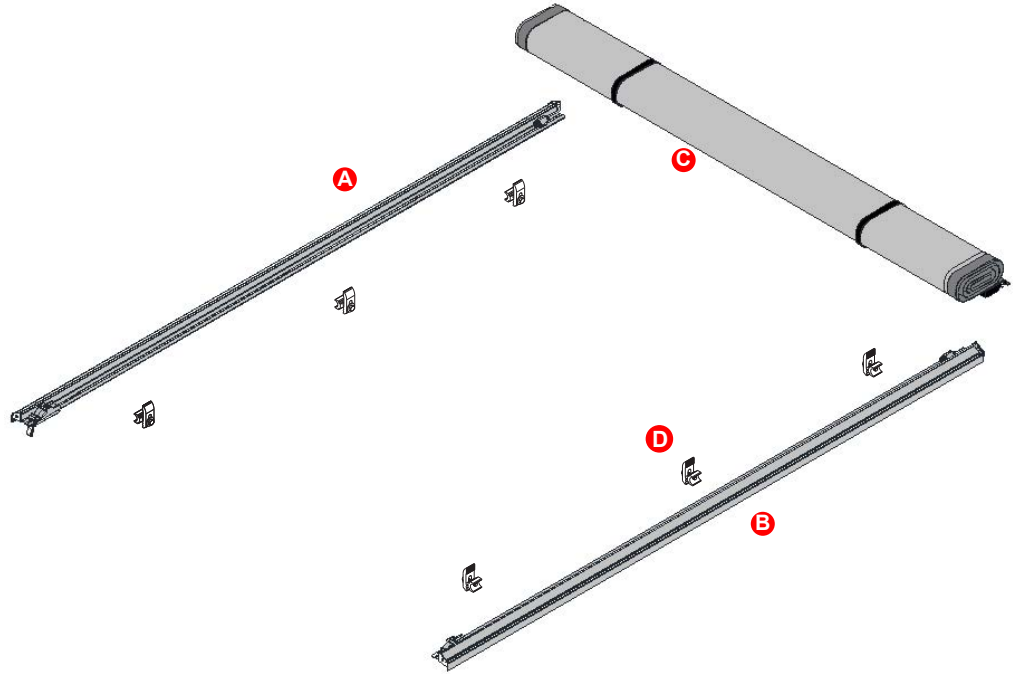

PARTS INCLUDED IN YOUR KIT:

- A** Driver side rail
- B** Passenger side rail
- C** Cover assembly
- D** 6x Male clamp ends
- E** 6x Female clamp ends
- F** 6x Flat washers
- G** 6x Cap screws
- H** 2x Front corner seals
- I** 2x End plug seals
- J** 2x End plug seals
- K** Bulkhead seal (on select make/models)
- L** 2x Hex nuts
- M** 2x Plastic washers
- N** 2x Square head bolts

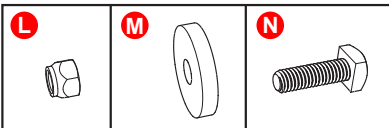
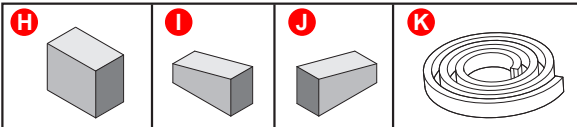
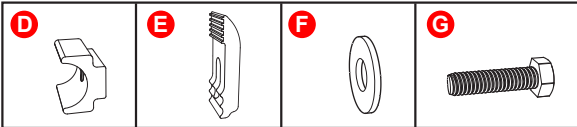

1 The serial number for the cover is located here.

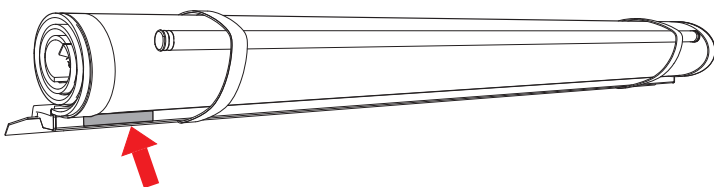

For future reference, write it here:

2 Remove the rear cargo rail end plugs and remove the cargo tie-downs if installed.

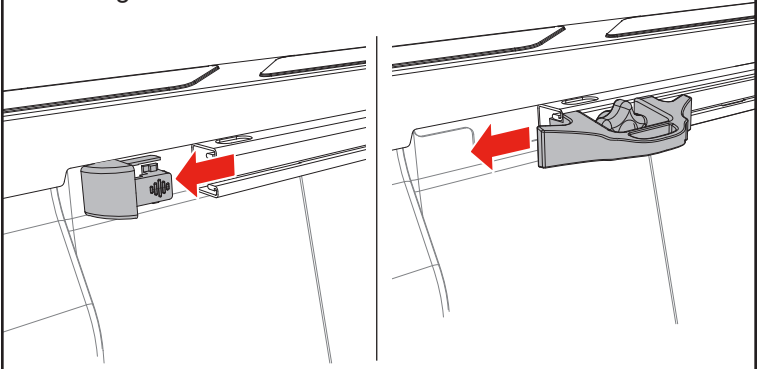

- 3** Assemble the clamps by placing a cap screw (G) and a flat washer (F) through the female clamp end (E) then through the male clamp end (D), as shown below. There are 6 clamps in total, 3 per side rail.

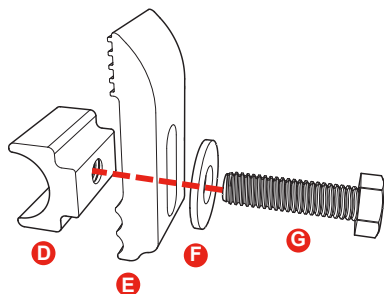

- 4** Slide the assembled clamps into the cargo rail. Space them evenly, leaving approximately 8" on each end of the cargo rail. Reinstall the tie-down cleats and the cargo rail end plugs.

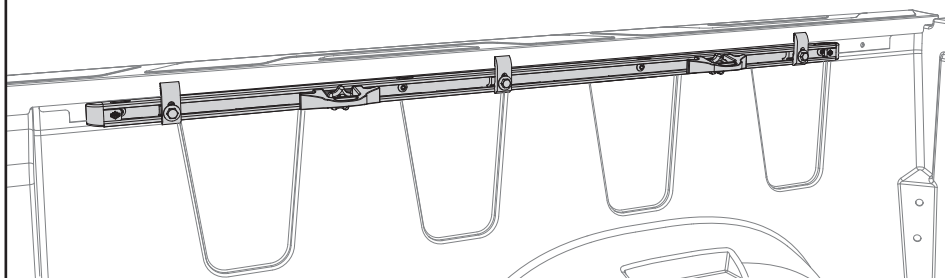
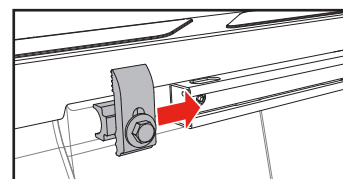

- 5** Clean the area where the seal will go with soap and water to remove dirt and debris. Then clean the area with isopropyl alcohol to remove wax or grease and to evaporate any remaining water, allow the surface to dry. Attach the front corner seals (H) by peeling the white paper backing off and attaching the seals to the front corners as shown. Front corner seals should sit 1/8" above the bed caps. Apply pressure to the entire seal to make sure the adhesion is good.

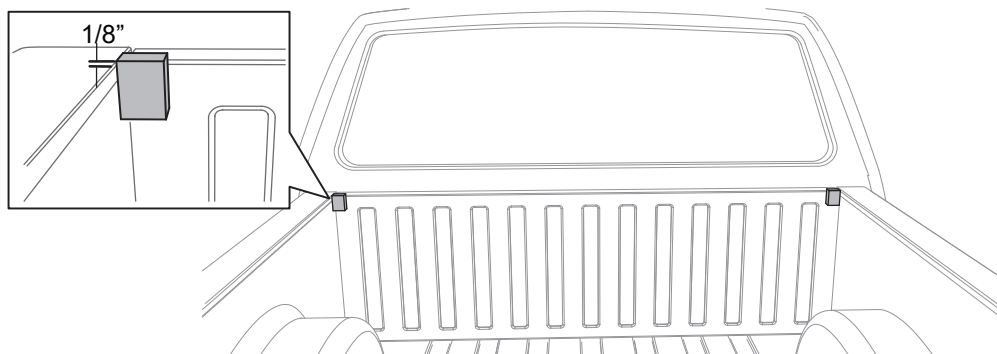

- 6** Clean the area where the seal will go with soap and water to remove dirt and debris. Then clean the area with isopropyl alcohol to remove wax or grease and to evaporate any remaining water, allow the surface to dry. Attach the end plug seals (I and J) to the front of the driver and passenger side rails (A and B). Apply pressure to the entire seal to make sure the adhesion is good.



- 7** Position the driver side rail (A) to the inside of the truck's bed rail. Adjust the rail vertically so that the seal is flush with the truck bed caps. The front edge of the rails will be 3/8" back from the bulkhead.

Adjust the rail vertically so that the top edge of seal is flush with the truck bed caps.

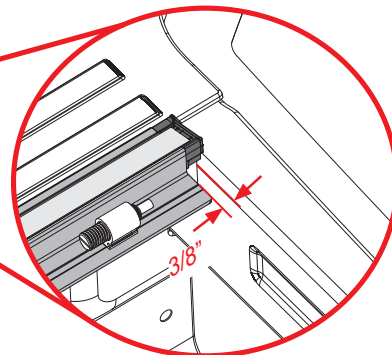
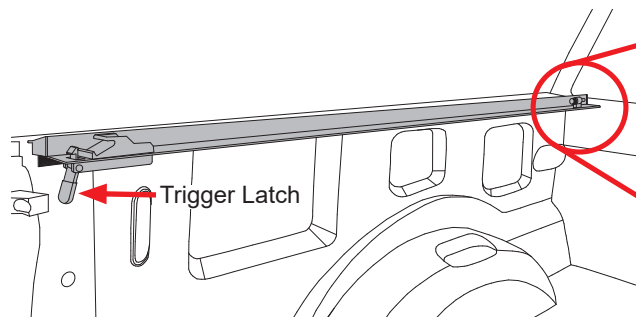
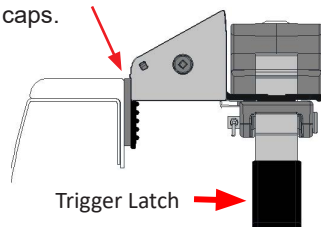

NOTE: The trigger latch is on the driver side rail only.

- 8** To secure the side rails (A and B) in place hand tighten the clamps (D-G) installed on the cargo rail.

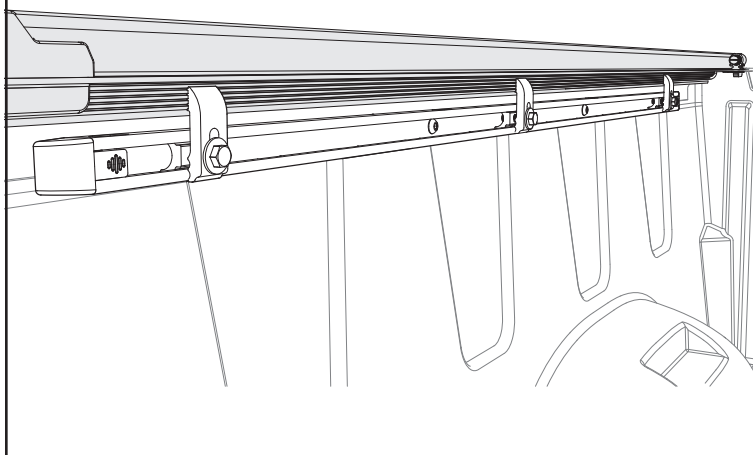

- 9** For optimal latching performance and cover fit, the side rails (A and B) should be level with the truck bed caps and not tilted up or down. Tighten all clamps with a 1/2" wrench or socket.

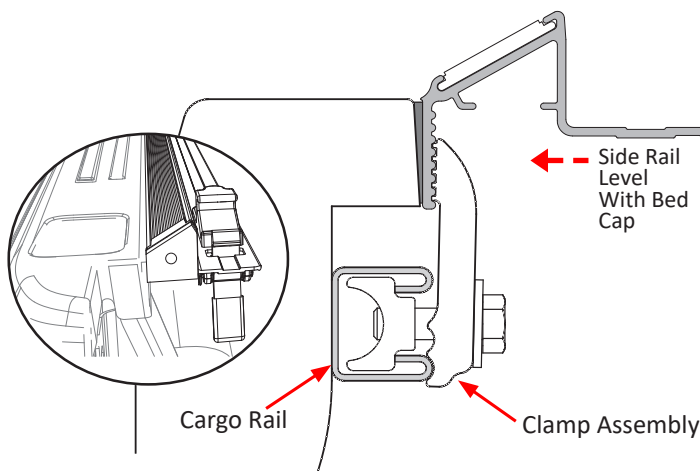

- 10** If your truck has factory bed caps you will need to install the bulkhead seal (K) provided. Clean the area where the seal will go with soap and water to remove dirt and debris. Then clean the area with isopropyl alcohol to remove wax or grease and to evaporate any remaining water, allow the surface to dry. Then peel the backing paper off and adhere the seal from one bed rail edge to the other. Remove any excess with scissors or a utility knife. Apply pressure to the entire seal to make sure the adhesion is good.

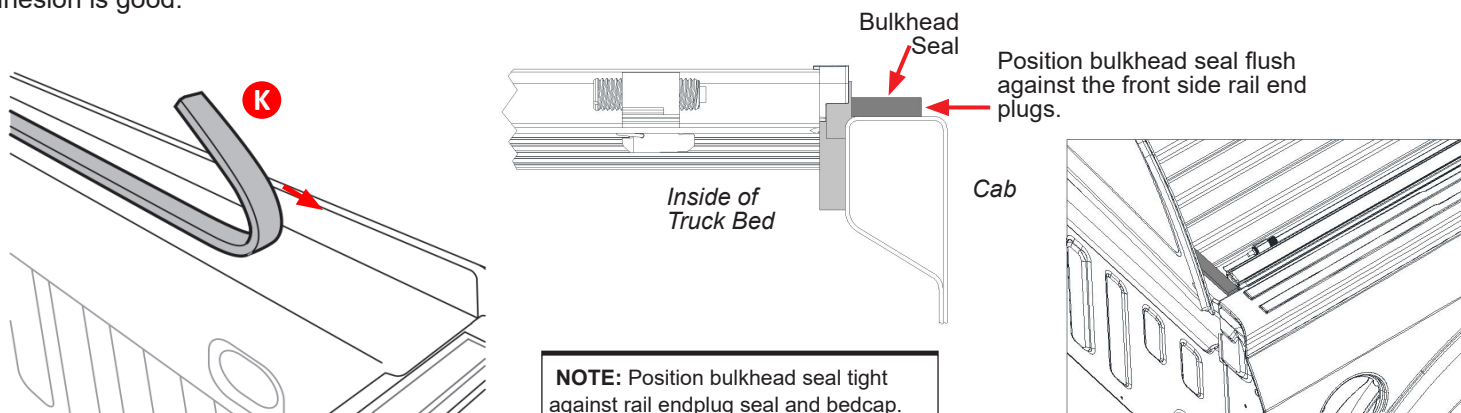

- 11** Many truck tailgates, when closed, have corner gaps that allow moisture to enter the truck bed. Apply the end plug seals (I and J) to the side rail end plugs and truck bed corners to block moisture from entering the truck bed at the tailgate.

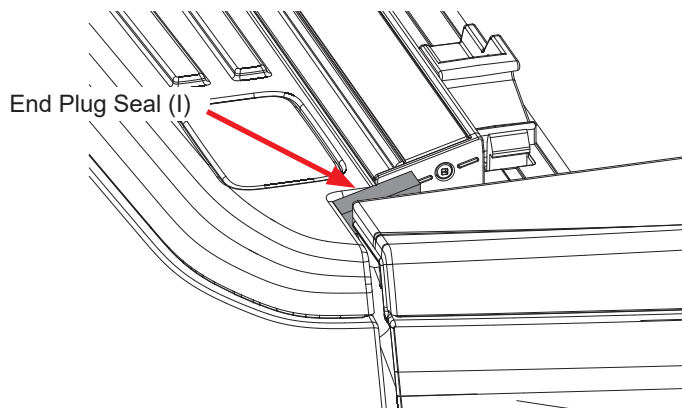

Driver Side Shown

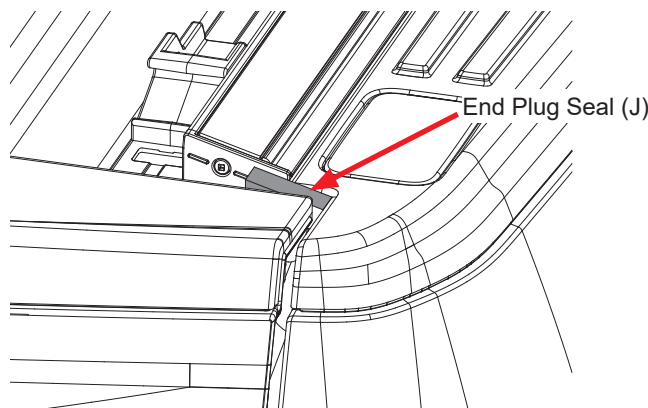

Passenger Side Shown

NOTE: If moisture does enter at the tailgate area then generally the moisture will run down the tailgate and out through the bottom of the tailgate and away from the truck.

- 12** On the cover assembly (C), identify the driver and passenger front header end plugs. Remove both plugs by pulling them outward as shown below.

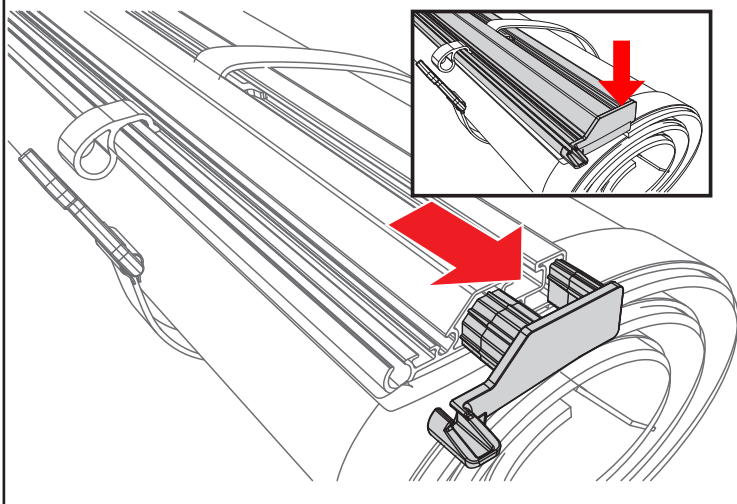

- 13** Install the bolts (L) by sliding them into the header as shown below. Do this on both driver and passenger sides. Then reinstall both end plugs.

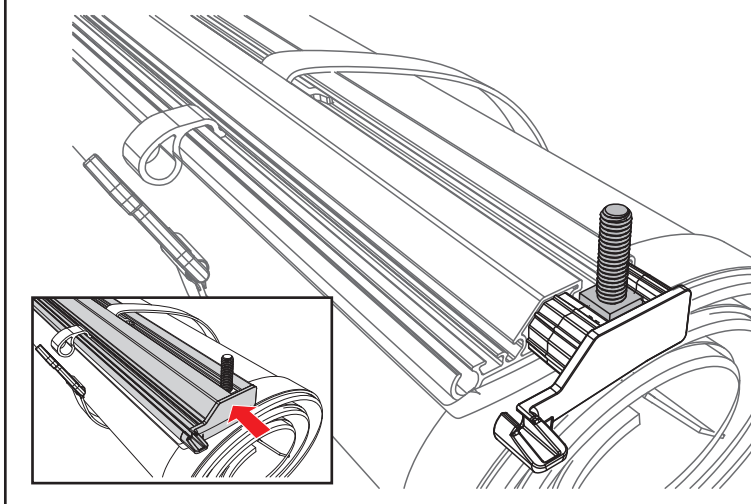

- 14** Place the cover (C) on the side rails towards the front of the truck bed (near the cab). The front header seal is designed to help shed water and should sit on top of the bulkhead.

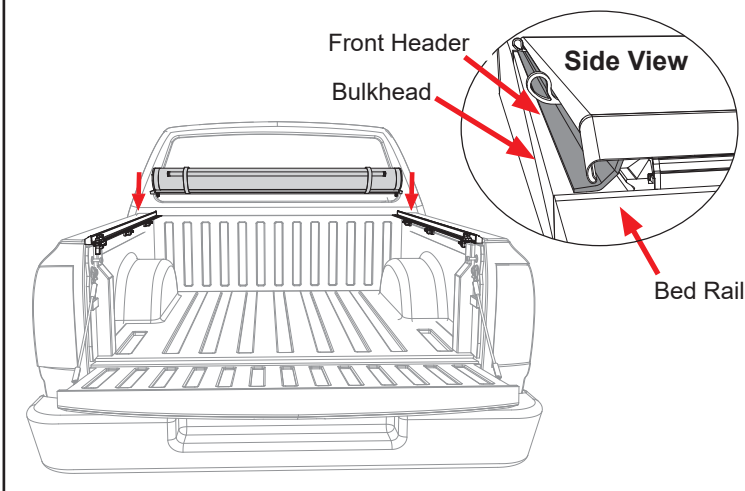

- 15** To connect the cover assembly (C) to the side rails (A and B), place the bolt (L) through the oblong hole in the side rails. Secure the cover assembly by installing a washer (M) and a hex nut (N) underneath the side rails at the cab with a 1/2" socket. Tighten the nut until resistance is felt, then back off the nut by a 1/4-1/2 turn.

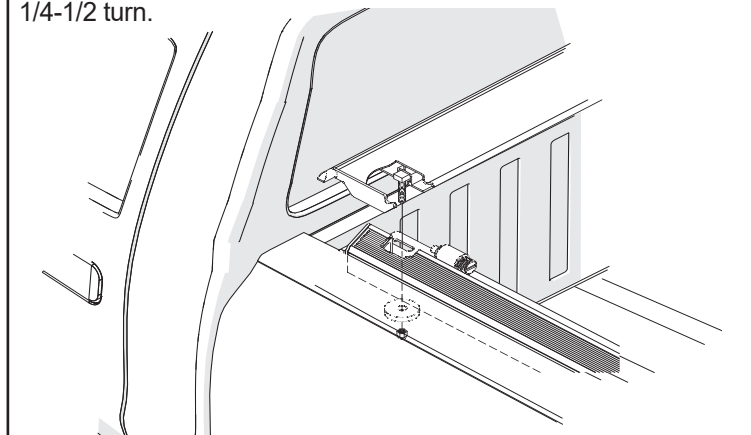

- 16** Disengage the retainer hooks from the retainer loops and unroll the cover towards the tailgate.

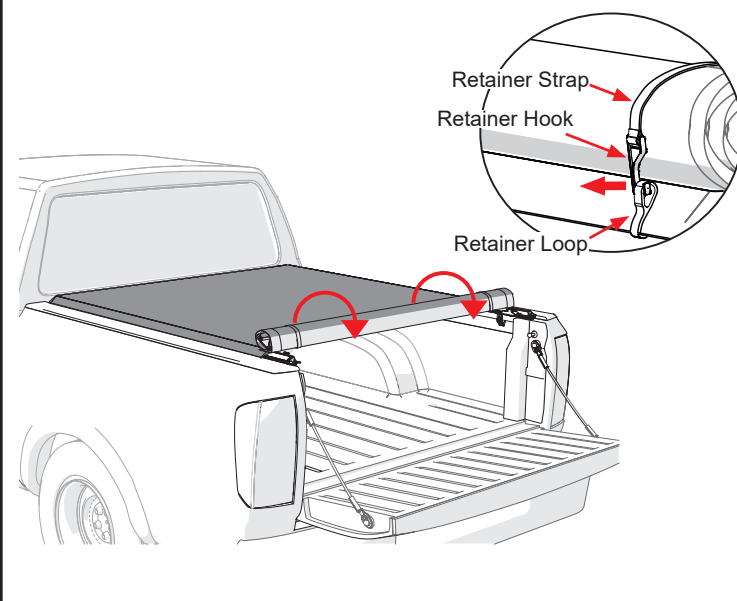

- 17** Place the rear header into the header stops which are located on both side rails. Rotate the rear header downwards until you feel the cover latch in place. **A clicking sound will indicate a correctly installed cover.**

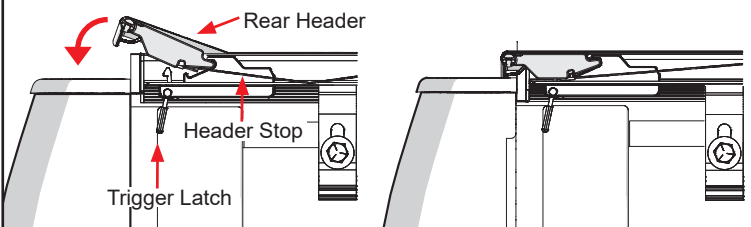

Preferred method of closure: Close tailgate, then close cover on top of the tailgate. This method will not work with some truck applications. Use the alternative method instead.

Alternative method of closure: Close and latch the cover, then close the tailgate with the seal inside the tailgate. It will take a little time to train the seal to close on the inside.

- 18** Once the cover is closed, grab the fabric flap and evenly pull it over the hook track engaging the loop to the hook.

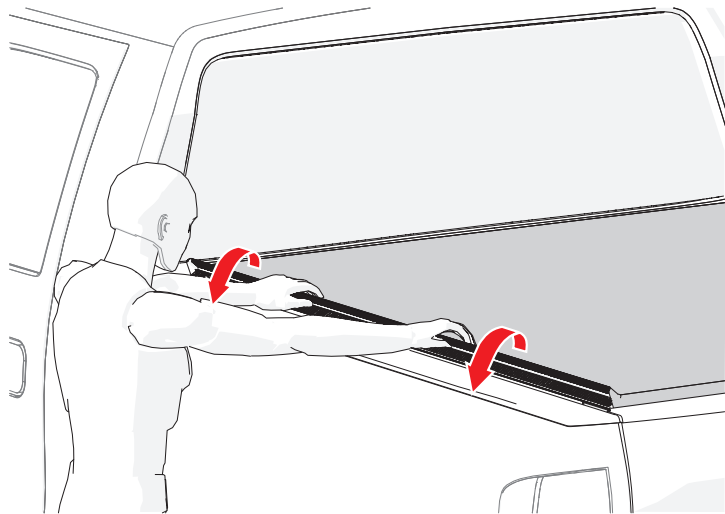

- 19** With both sides of the hook and loop engaged, use the palms of your hand to firmly push the loop strip into the hook track. Do this to both driver and passenger sides. **You are ready to drive with the cover in the closed position.**

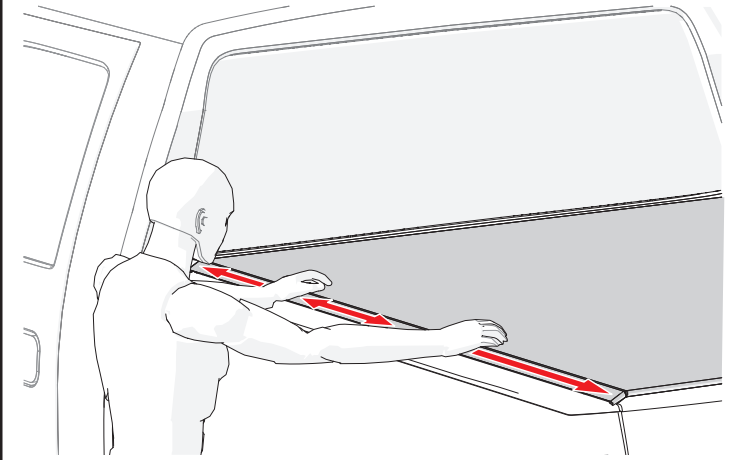

HOO K AND LOOP MUST ALWAYS BE ADJUSTED AFTER ROLLING COVER CLOSED!

OPENING THE COVER

To drive with the cover in the open position, pull the latch towards you to release the cover (located on driver side rail). Roll the cover toward the cab of the truck, making sure that both sides roll evenly. Secure the cover by placing both retainer hooks into the retainer loops. **You are ready to drive with the cover in the open position.**

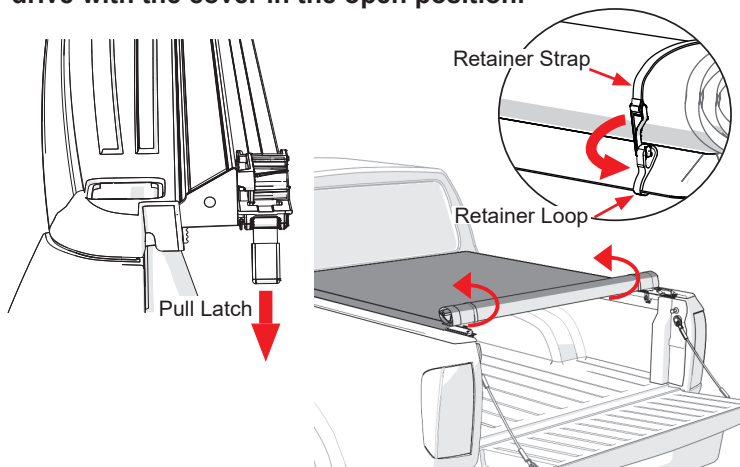

REMOVING THE COVER

To remove the cover from the side rails, unfasten the hex nut (N) and washer (M) from underneath the side rails at the cab. Do this on both the driver and passenger side. Carefully lift the cover off the side rails.

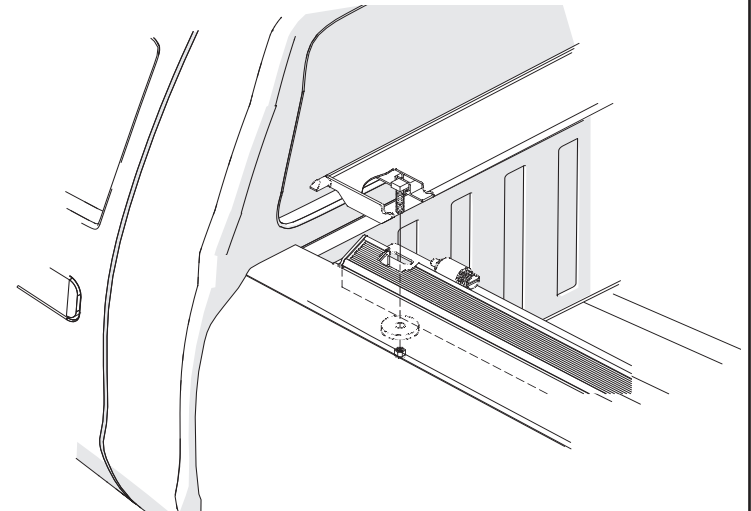

AUTOMATIC TENSION CONTROL ADJUSTMENT

Lo Pro is equipped with Automatic Tension Control. This helps compensate for material expansion and contraction caused by extreme temperature changes. Proper tension allows the cover to look and perform at its best. While preset at the factory, you can check cover tension after installation as well as seasonally.

If the cover feels too tight or too loose when opening or closing it, adjust the tension during the warmest part of the day. With the cover closed, release the hook and loop fastener from both side rails near the cab. Check compression of both spring plungers against the front header per Detail C. Roll the cover open and make adjustments. Repeat until satisfactory tension has been achieved.

DETAIL C

COVER TOO LOOSE

TURN SPRING PLUNGER SCREW CLOCKWISE

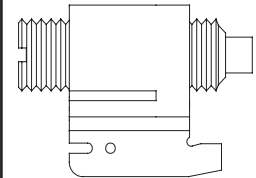

CORRECT TENSION

DURING WARMEST PART OF DAY

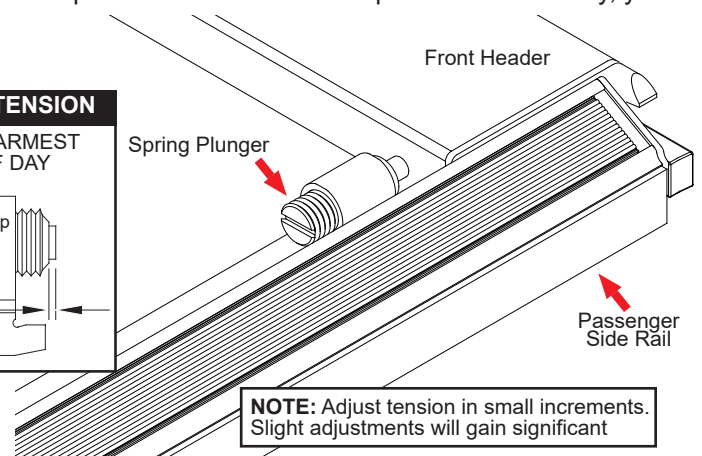
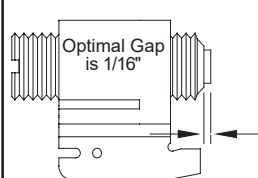

NOTE: Adjust tension in small increments. Slight adjustments will gain significant

WARRANTY DURATION

TruXedo®, Inc. ("TruXedo") offers a LIFETIME warranty on Lo Pro, Deuce and Pro X15. Warranty is limited to original purchaser of truck bed cover and is nontransferable. The warranty registration must be on file and/or proof of original purchase (detailed and dated receipt) required for warranty service.

WARRANTY CONDITIONS

This warranty is against defective materials or workmanship. The warranty is void if the product has been damaged by accident, unreasonable use, neglect, improper service/installation/removal, modifications, normal wear and tear or other causes not arising out of defective materials or workmanship. Consequential and incidental damages are not covered under this warranty. TruXedo's obligation under this warranty is limited to repairing or at its option, replacing any part that is returned, transportation prepaid, to Yankton, South Dakota, if the product is, in our judgement, defective. All materials must be accompanied by an RMA (Return Material Authorization) number requested by and authorized in advance of returning the materials. TruXedo shall not be liable or responsible to supply or pay labor to replace any part found defective, nor shall it be liable for any damages of any kind or nature to person, product, or property.

- Please register the warranty online at truxedo.com
- Direct all warranty claims to TruXedo at **877-878-9336**
- For available installation videos, visit the TruXedo **YouTube** channel

**REGISTER
YOUR
WARRANTY
ONLINE**



The Following Conditions will Void Warranty:

- **Wind Whip Damage** – The cover must be secured at all points when the vehicle is in motion. An unsecured cover will flap, resulting in damage to the vinyl fabric.
- **Improper Cleaning** – Never use silicone, petroleum, or citrus based products on the bed cover. The vinyl cover can be hand washed with mild soap and water or cleaned in a car wash. Thoroughly rinse the cover to remove any soap residue. The cover can be treated with any vinyl protectant specifically made for tonneau covers.
- **Overloading of cargo** – Cargo should not contact the tarp at any point. Protrusions in the tarp will stress the vinyl fabric. Cargo may also shift while traveling causing it to press against the vinyl fabric and damage it.

OWNER/USER RESPONSIBILITIES

It is the responsibility of the owner/user to read this manual and comply with the operating procedures. The owner/user is also responsible for inspecting the TruXedo cover and for having parts repaired or replaced when worn or damaged. Failure to follow safety instructions and warning labels could result in failure of your cover system and/or personal injury.

IMPORTANT OPERATING TIPS

- DO NOT roll cover into rear cab window. DO NOT stow against cab.
- After closing the cover, the operator must secure the hook and loop by running their hand down the driver and passenger side rails, pushing down on the cover material.
- If the side rails are tipping, adjust the clamps in order to level the side rails and ensure a proper fit.
- The tonneau cover must be free of foreign material including snow and ice before rolling open or closed.



SAFETY INSTRUCTIONS

- DO NOT place objects on or against cover or framework.
- DO NOT tie cargo to truck bed cover framework.
- DO NOT attempt to drive with the cover in the partially open position.
- DO NOT operate vehicle with objects on top of the cover.
- NEVER allow children or pets to occupy pickup box while cover is closed.
- Cover is not airtight. Special care is required to keep cargo clean and dry.
- Tonneau covers won't prevent theft of contents inside truck box.
- The cover assembly (tarp) must be rolled fully open and secured with retainer straps when towing vehicle backwards.
- If the cover is going to be rolled open for an extended amount of time, periodically re-roll the cover and secure the retainer straps to ensure the cover doesn't rest against the cab of the truck.
- A fully rolled cover in the open position must always be secured with retainer straps.

TROUBLESHOOTING TIPS

- **WRINKLES ON THE VINYL FABRIC AFTER ROLLING COVER CLOSED**
 - Pull the vinyl fabric taut from each side. For best results, the help of a second person pulling on the opposite side is preferable.
- **SAGGING VINYL FABRIC BETWEEN THE CROSS BOWS**
 - Adjustment to automatic tension control may be required. See automatic tension control section.
- **WIND LIFTS UP THE EDGE OF THE VINYL FABRIC**
 - Make sure to engage the hook and loop on the driver and passenger side rails after closing the cover. This may need to be done periodically when taking long trips.
- **VINYL FABRIC FLUTTERS EXCESSIVELY WHEN DRIVING**
 - Check cover tension. See automatic tension control section.
 - Make sure hook and loop fasteners are set. See Step 18 and 19.
- **SNOW AND ICE ACCUMULATION ON THE VINYL FABRIC**
 - Use broom or brush to remove loose snow and ice. DO NOT use sharp or pointed tools to remove snow and ice.
 - Direct sunlight will help melt snow and ice off the vinyl fabric.
- **TONNEAU COVER WILL NOT LATCH**
 - Check side rails to make sure they are level. See Step 9.
 - Make sure the header seal is not caught between side rails & header.
 - Check the position of side rails on the pickup box. They may be positioned too low. See Step 9.
 - Make sure the cover has proper tension.
- **VINYL FABRIC IS TOO TIGHT OR TOO LOOSE**
 - See automatic tension control section.
- **VINYL FABRIC HAS SHIFTED TOO FAR TO ONE SIDE**
 - Unlatch the cover at the tailgate, release the hook and loop along both sides, go to the shorter side of the tarp and tug. The vinyl fabric will slide in the aluminum headers. Pull on the shorter side until the tarp appears centered on the whole system. Latch the cover and secure the hook and loop down both sides. Repeat if more adjustment is needed.

COVER CARE AND MAINTENANCE

- Never use silicone, petroleum, or citrus based products on the bed cover. The vinyl cover can be hand washed with mild soap and water or cleaned in a car wash. Thoroughly rinse the cover to remove any soap residue. The cover can be treated with any vinyl protectant specifically made for tonneau covers.
- It is recommended that you periodically check that the cover is securely attached to your truck bed. Inspect the clamps and front header guide slides to ensure they were properly installed and have not come loose during operation.
- It is recommended that you periodically inspect and service the rear latch closure. Clean away any excess dirt or grime.
- Covers that are used frequently or are subject to vibrations and impacts from rough roadways may require adjustment.

FAQ

- **WHY IS THERE A HOLE PUNCHED AT THE REAR OF THE PASSENGER SIDE RAIL OF THE TRUXEDO LO PRO, DEUCE AND PRO X15 BUT NO LATCH?**

All side rails are punched identically to keep them uniform, to ensure manufacturing efficiency and to reduce tooling costs. By doing this, TruXedo can build and ship more covers while maintaining competitively priced products of the highest quality.
- **WHY IS MY COVER HOLDING WATER AFTER IT RAINS?**

Water pooling on the cover is normal because our cross bows are not arched. Since they are designed to sit flat some water may accumulate on the top of the cover. Once you drive your truck, the water will shed from the cover. Make sure to retighten the hook and loop fasteners along the length of the bed.

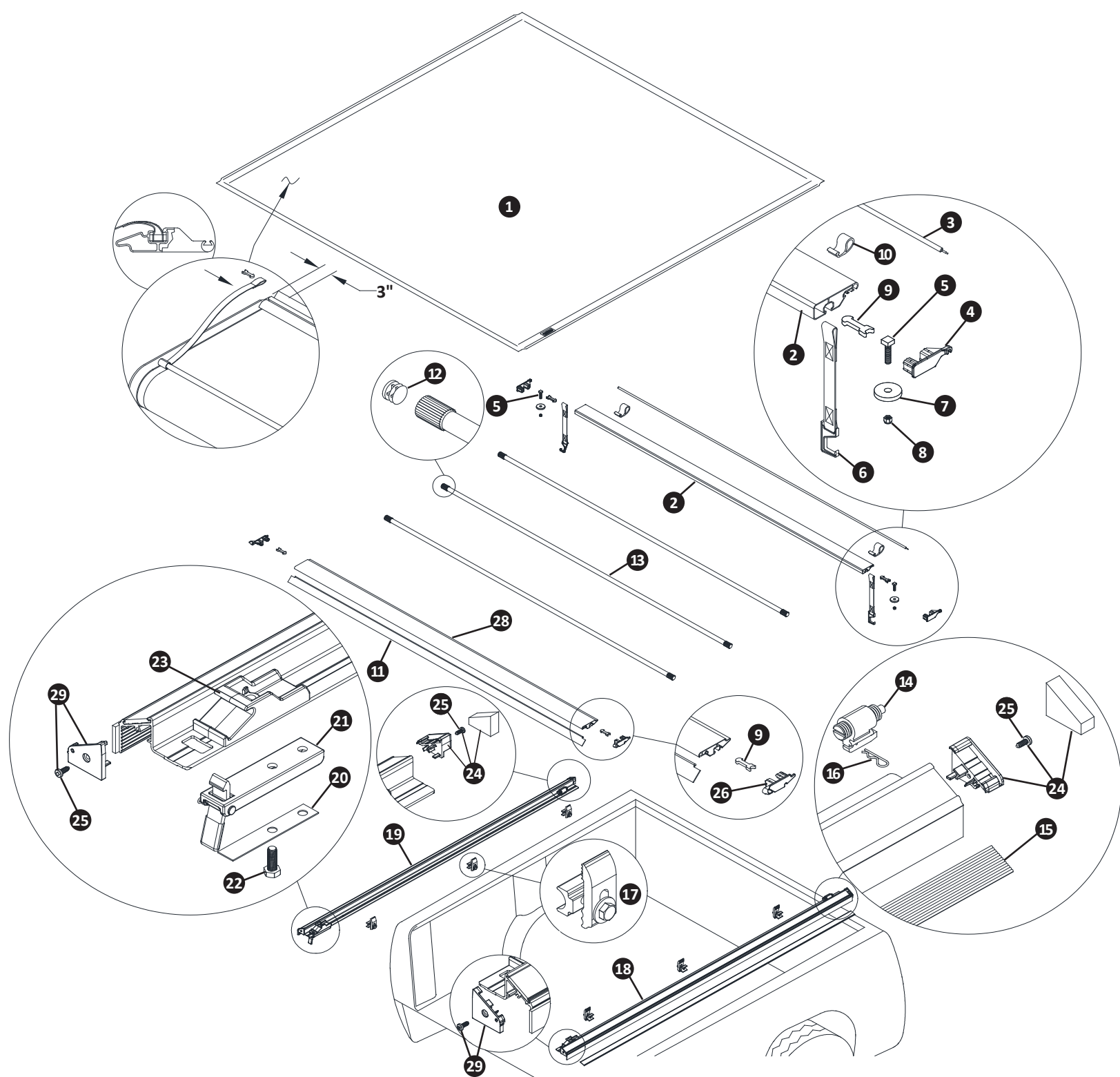

TRUXEDO® LO PRO REPLACEMENT PARTS

- 1 * TruXedo® Lo Pro Replacement Cover
- 2 * Black Front Header
- 3 * Header Seal Front
- 4 1118915 Front Header End Plugs (Set of Two)
- 5 1703455 Sq. Hd. Cap Screw 3/8" x 1 1/2"
- 6 * Retainer Strap
- 7 1115745 Washer Plastic 1/4" x 1.50 Dia.
- 8 1701580 Hex Lock Nut, 3/8"-16
- 9 1115354 Header Insert Retainer Arrow
- 10 * Extruded Retainer Loop

- 11 * Header Seal Rear
- 12 1705052 End Plug, 1" OD
- 13 * Black Bow
- 14 1115356 Tension Control
- 15 * Hook and Loop Fasteners
- 16 1703332 Hitch Pin, 1/16" x 1 5/16"
- 17 1706843 Aluminum Clamp Assy
- 18 * Side Rail, Passenger's Side
- 19 * Side Rail, Driver's Side

- 20 1705727 Flat Spring, 5/8" x 3 7/8"
- 21 1704213 Latch Assembled
- 22 1702926 Cap Screw, 5/16" x 7/8"
- 23 1704187 Header Stop
- 24 1118950 Front Side Rail End Plugs (Set of Two)
- 25 1705629 Square Drive Head Screw (#1 Drive)
- 26 1117467 Rear Header 08 End Plugs (Set of Two)
- 28 * Black Rear Header
- 29 1118951 Rear Side Rail End Plugs (set of Two).

* Please specify length or make and model of vehicle.