

20903 **08-12 TOYOTA** **SEQUOIA**



20903 **08-12 TOYOTA** **SEQUOIA**

1 PC BILLET INSERT

Recommended Tools:

Drill & 1/8 Drill Bit
Phillips Screw Drivers
5/16 Wrench or Nut Driver
Cut Off Wheel/Jig Saw
Angle Grinder/File
Vice Grip Pliers

Parts List / Hardware:

1	Billet Inserts	2	6/32 Nylon Lock Nuts
4	#8 Flat Nuts	2	6/32 x 1/2" Machine Screws
8	#8x3/4" Screws	2	#10 Washers
2	Factory Plastic Clips		

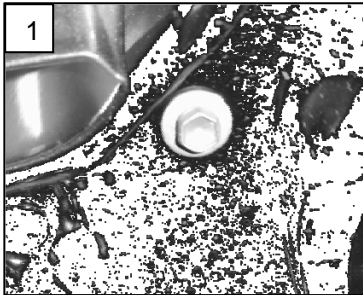

STEP 1: Read and understand all instructions before attempting the install of this grille. Be sure that the package of hardware matches the hardware list as listed above. Next, test fit the T-REX grille to the vehicles factory openings. You are now ready for the install:

STEP 2: Open the hood of the vehicle. Remove the factory bolts holding the factory grille to the hood supports. Remove the two 10mm screws holding the hood latch to the grille. Remove all remaining bolt holding the grille to the hood supports (1). There are 12 bolts total. Pry the top of the grille away from the hood using a soft tool. Removing the grille shell is going to take quite a bit of pressure. There is a clip

in each corner of the grille that will break. New replacements are provided in the hardware.

STEP 3: Now that the grille is removed from the vehicle; place grille down on a soft surface. You will need to cut the center section from the grille. Cut the two main horizontal bars and the small vertical bars that encompass the outside of the two main bars (2). With the center removed from the grille; cut the lower edge of the grille shell out (3). This will allow the lower grille brackets to mount to the lower steel support. Using the angle grinder; smooth the cut edges.



STEP 4:

Install the grille into the factory shell. If the grille does not fit properly, trim the previously cut areas to achieve proper fitment. With the insert centered; secure the grille tabs using vise grip pliers. With the grille secured; drill a hole into the plastic and metal using the existing bracket holes as a reference (4). Secure each top tabs using a screw and flat nut. The lower brackets will secure to the lower steel bar using only the screws. Remove the factory steel hood latch bracket from the factory grille. Install onto the billet bracket welded to the billet grille using the machine screws, washer and nylon lock nuts (5).

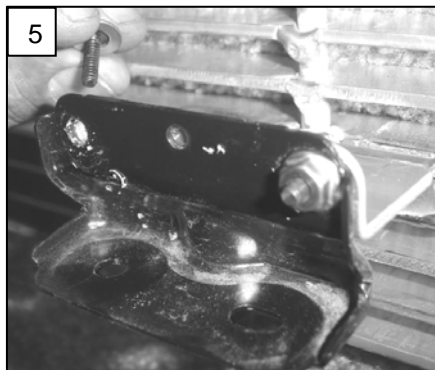
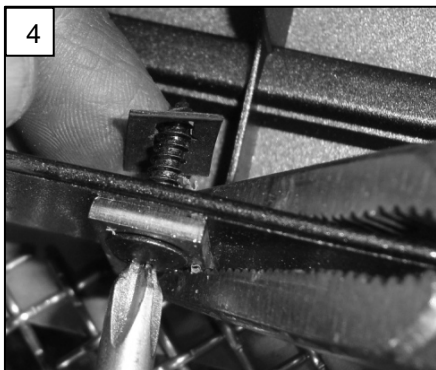

STEP 5:

Replace the clip in each corner of the grille shell and reinstall the shell. Reinstall the factory bolt into factory positions. Reinstall the hood latch mechanism and enjoy.

Thank you for purchasing your T-Rex grille. 07-15-08