

INSTALL INSTRUCTIONS FOR 75-5121

PART#: 75-5121 / 75-5121D

Vehicle Application

YEAR: 2018-2019

MAKE: Jeep

MODEL: Wrangler JL

ENGINE: 3.6L

Tools Required

- Ratchet/Wrench
- 8mm & 10mm Socket
- Panel Popper
- Crescent Wrench
- Phillips Screwdriver
- Scissors

Note: Approximate Install Time: 1 Hr
00 Mins.

S&B Filter Maintenance

KF-1057 Cotton Cleanable : If the enclosed filter is RED, it came pre-oiled from the factory. [Click here](#) for exact oil amount required for cleaning.

KF-1057D Dry Extendable : If the enclosed filters is WHITE, it is a disposable filter and should be discarded once it reaches capacity. This filter does not require oil.

Note: This intake kit may not fit with the following Aftermarket

Parts installed:

- Body Lift or Lowering Kit
- Custom Hood
- Throttle Body Spacer / Upgrade
- Aftermarket turbocharger

CARB Status - EXEMPT

CARB EO # D-590-18

*Legal for use in CA and other states adopting CA emissions Standards.

Before You Start

- Please read the entire product guide before proceeding.
- Ensure all parts are present.
- If you are missing any of the components, call our customer support at (909) 947-0015.
- Do not work on your vehicle while the engine is hot.
- Make sure the engine is turned off and the vehicle is in Park or the Parking Brake is set.

Related Products

- Cotton Cleanable Filter (KF-1057)
- Dry Extendable Filter (KF-1057D)
- Cleaning & Oiling Kit (88-0008)
- Filter Wrap (WF-1057)

Operation in Snow and Rain

If you are driving in heavy snowfall or extreme rain conditions, you should always check for accumulated snow and water on the air filter following your OE recommendations for driving in these conditions. The following is recommended after operating the vehicle up to 100 miles in heavy snowfall or extreme rain: At the earliest opportunity, open the hood and check the airbox and filter. If any snow has accumulated, make sure to remove the snow from the filter, box, and inlet. It is okay if the filter is a little wet. Wet filters will normally dry out on their own. If the filter is dripping wet, it should be replaced with another filter that is not wet. Do not reuse the dripping wet filter until it has naturally dried.

Air Box Plug Testing

Stock intake boxes are a significant contributor to poor airflow which is why S&B designs custom air boxes with secondary and/or enlarged openings. With that said, S&B recognizes the benefits of cooler air, so we have included a plug to seal off the opening if so desired. For optimal performance, we recommend that the intake be used without the end cap except in conditions of extreme heatwave.

Performance Testing

- After your installation is complete engage parking brake and start your engine. Listen for abnormal noises. If an air leak is detected, re-inspect hoses and connections as they may need to be repositioned and tightened
- S&B FILTERS recommends that you keep your OE intake system in the event it is required in the future.
- In order to maintain your warranty, all connections and components must be checked periodically for alignment and for proper tension on all connections. Failure to do so may void your warranty.
- Use only S&B FILTERS cleaning and oil products to service your filter. Using any other brand oil and or cleaners on your S&B air filter may void your warranty.

Warning!

If your vehicle has a Vehicle Emission Control Information decal affixed to the factory airbox, a new replacement label must be obtained and installed in a readily visible position in the engine compartment in order to remain CARB compliant. Failure to do so will prevent the vehicle from passing a smog check. Replacement labels can be ordered from your local dealership. Regulations state that the VECI label shall not be affixed to any equipment which is easily detached from the vehicle. Label placement, under the hood on a painted surface is recommended.

Emission Standard

The California Air Resource Board (CARB) requires that an E.O. identification label be applied to the vehicle in order to pass a smog check inspection when a Performance Intake Kit has been installed. You must place the E.O. label provided on or near the intake kit after installation so that a smog check technician can easily verify the E.O. number. Check the status of the exemption process by looking up a specific part number at www.sbfilters.com. The CARB Exemption number and/or status is listed under the Product Details section for each part number. If the status shows as "Pending," CARB has yet to issue an exemption. Products that have not been issued an EO number are street legal in most states, but may not be used on emission controlled vehicles in the state of California and are for off-road use only. If you purchased your kit from S&B Filters directly, we will automatically mail you your Exemption Sticker when it is issued to us. If you purchased your kit from an authorized S&B Filters Dealer, log onto our web site and register to receive your Exemption Sticker.

EXPLODED VIEW

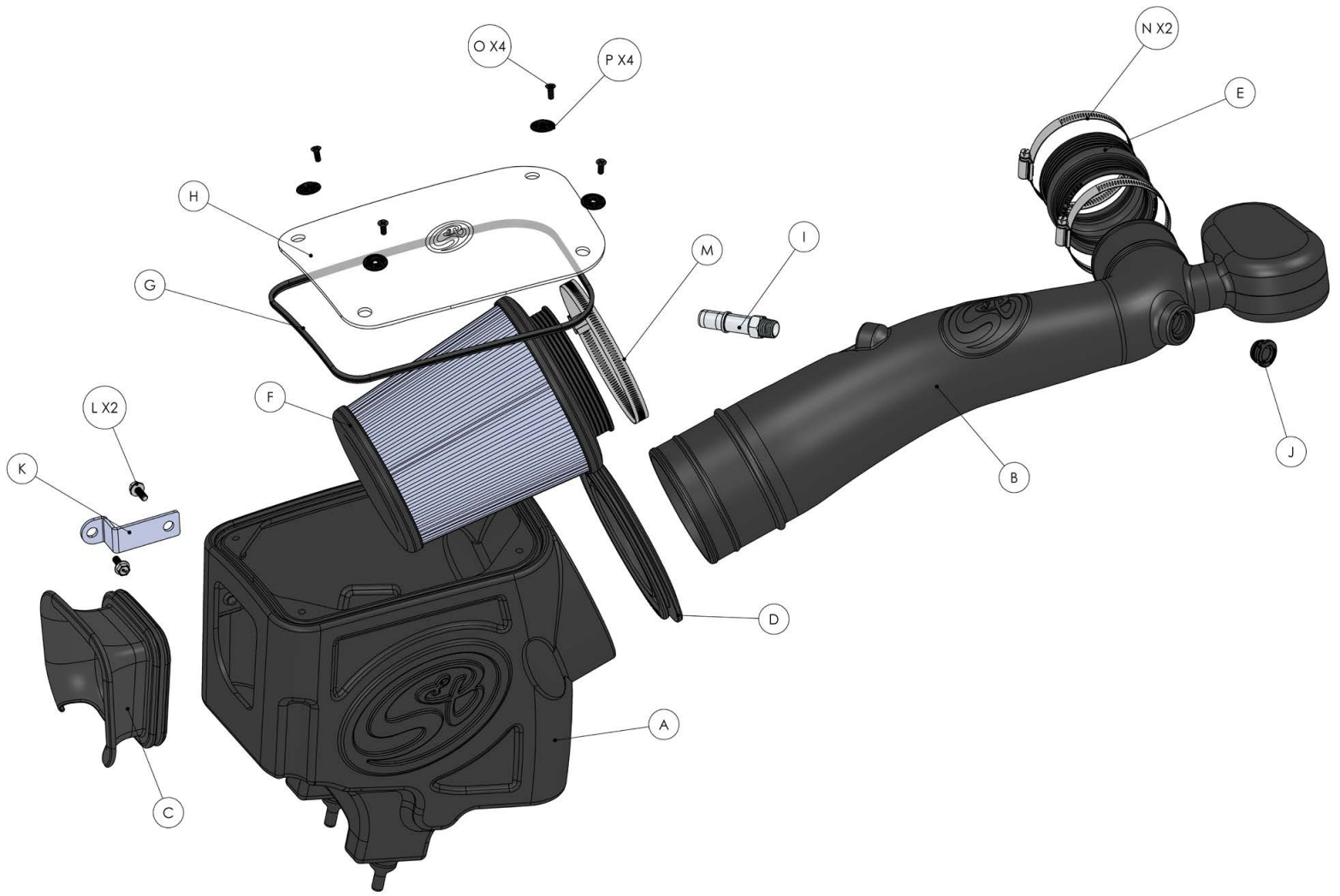

PARTS LIST

ITEM	QTY	DESCRIPTION	PART NUMBER
A	1	INTAKE BOX	AI1339B-00
B	1	INTAKE TUBE	AI1339-00
C	1	FENDER SEAL	AI2108C-00
D	1	TUBE SEAL	AI1650C-00
E	1	COUPLER	AI1601C-00
F	1	AIR FILTER	KF-1057
G	1	LID SEAL, 31"	AI1766-07
H	1	CLEAR LID	AI2120-00
I	1	QUICK CONNECT, FITTING TO 3/8" NPT	AI1701-00
J	1	IAT SENSOR GROMMET	AI1948C-00
K	1	BRACKET	AI2113-CT
L	2	BOLTS, FLANGE, M6 X16MM	AI2014-00
M	1	HOSE CLAMP #80	AG1010-00
N	2	HOSE CLAMP #56	AG1007-00
O	4	LID SCREW, 10-24	AI2005-00
P	4	LID WASHER, #10	AI2006-00

AM0451-00 REV-C 11/07/2018

HARDWARE PACKS
HP1583-00
AG1007-00
HP1585-00
AI2113-00
AI2014-00
HP1586-00
AI1701-00
AI1948C-00
LHP0004-00
AI2005-00
AI2006-00
HP1584-00
AI2120-00
AI1766-07

INSTALLATION STEPS

STEP 1

With the ignition switched off and the parking brake set. Disconnect the negative battery cable on the passenger side.

IMPORTANT: Failure to disconnect the battery for a minimum of 2 hours may cause the Check Engine Light to illuminate upon completion of the installation or subsequent operation. DO NOT SKIP THIS STEP!

Tools Required: Ratchet, 10mm Socket/Wrench.



STEP 2

Press down on the plastic clip to disengage the lock on the fitting then pull away to disconnect the CCV hose



STEP 3

Disconnect the electrical harness from the IAT sensor



STEP 4

Disconnect the three harness clips attached to the stock intake tube.

Tools Required: Panel Popper

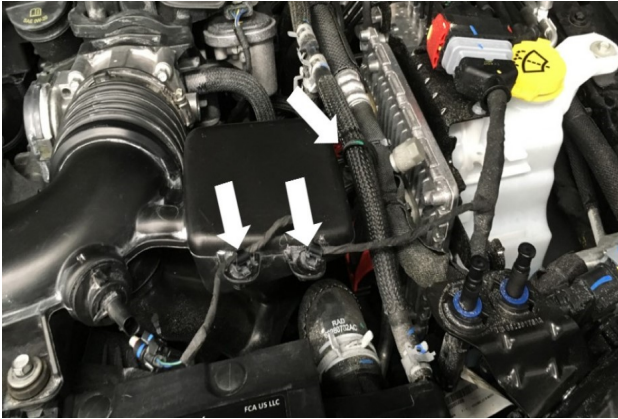

STEP 5

Remove the two bolts securing the stock intake tube to the fan shroud.

Tools Required: Ratchet, 10mm Socket/Wrench

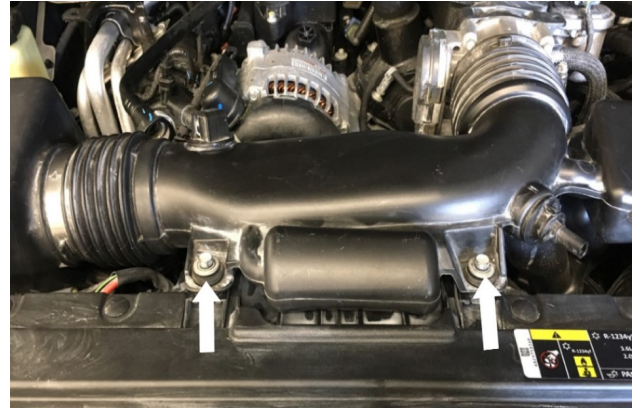

STEP 6

Loosen the hose clamp at the throttle body then pull the intake tube out and away from the throttle body.

Tools Required: Ratchet, 8mm Socket/Wrench



STEP 7

Remove the bolt securing the stock intake box to the fender.

Tools Required: Ratchet, 10mm Socket/Wrench



STEP 8

Lift the stock intake box to unseat the prongs from the grommets then remove the stock intake assembly from the vehicle.



STEP 9

Check to make sure the two grommets are still in place. Adjust and reinstall if necessary.



STEP 10

Remove the bolt securing the two battery tray brackets together.

Tools Required: Ratchet, 10mm Socket/Wrench



STEP 11

Install the IAT Sensor Grommet (J) into the Intake Tube (B).



STEP 12A

Note the position of the IAT sensor on the stock intake tube. Turn the sensor counterclockwise to unlock then pull out.



STEP 12B

Install the IAT sensor into the Intake Tube (B). Make sure the sensor is installed in the same position as the stock intake tube.



STEP 13

Install the Quick Connect Fitting (I) into the Intake Tube (B) until finger tight then with a Wrench tighten the fitting an additional one to two complete turns.

IMPORTANT: Do not over tighten, as the Quick Connect Fittings can break or the threaded inserts may strip!

Tools Required: Crescent Wrench



STEP 14

Install the Coupler (E) with the two #56 Hose Clamps (N) onto the Intake Tube (B) then tighten the hose clamp closest to the intake tube. Do not over tighten. Leave the hose clamp for the throttle body loose.

Tools Required: Ratchet, 8mm Socket/Wrench



STEP 15

Install the Tube Seal (D) onto the Intake Box (A).



STEP 16

Install the Tube Seal (D) onto the Intake Box (A).



STEP 17

Install the Lid Seal (G) onto the groove on top of the Intake Box (A). Cut away any excess lid seal.

Tools Required: Scissor



STEP 18

Install and tighten the Bracket (K) with the M6 Bolt (L) onto the Intake Box (A). Do not overtighten.

Tools Required: Ratchet, 10mm Socket/Wrench



STEP 19

Align the prongs on the Intake Box (A) with the two grommets then push down on the intake box to fully seat the prongs.



STEP 20

Align the mounting hole and secure the Bracket (K) to the battery tray bracket with the M6 Bolt (L). Position the Fender Seal (C) up against the fender then tighten. Do not overtighten.

Tools Required: Ratchet, 10mm Socket/Wrench

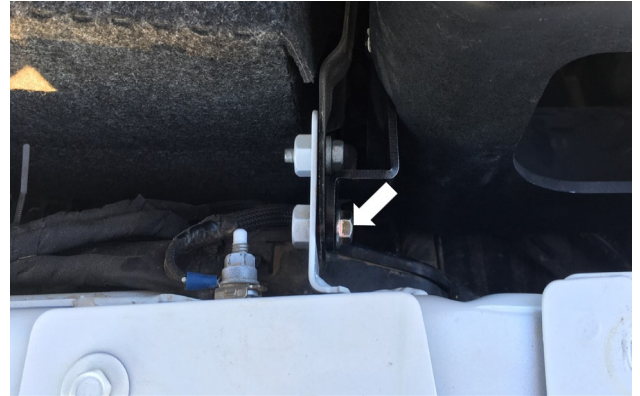

STEP 21A

Install the Intake Tube (B) into the Intake Box (A) first then rotate the intake tube onto the throttle body.



STEP 21B

Tighten the #56 Hose Clamp (N). Do not overtighten.

Tools Required: Ratchet, 8mm Socket/Wrench



STEP 22

Connect the IAT electrical harness into the IAT sensor

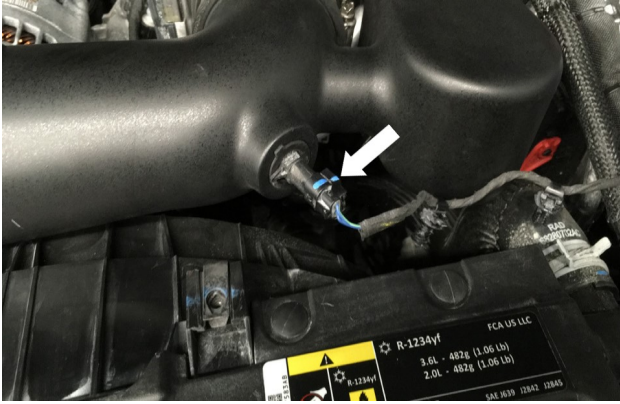

STEP 23

Connect the CCV hose into the Quick Connect Fitting (I). You should hear a snapping sound when the CCV hose is fully secured

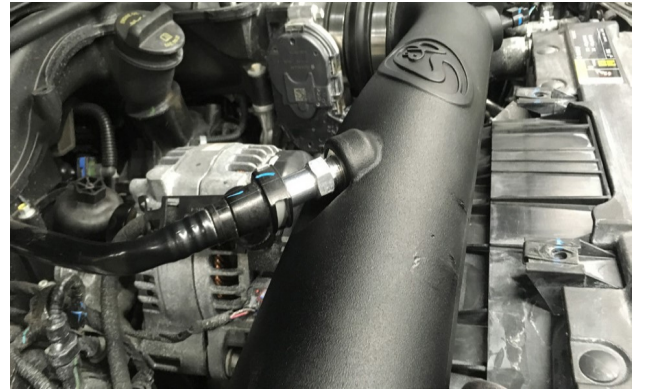

STEP 24

Install the Air Filter (F) and #80 Hose Clamp (M) onto the Intake Tube (B) then tighten the hose clamp. Do not overtighten.

Tools Required: Ratchet, 8mm Socket/Wrench



STEP 25

Remove the protective covering from the Clear Lid (H)



STEP 26

Install the Clear Lid (H) onto the Intake Box (A) then install and tighten the Lid Screws and Washer (O & P). Do not overtighten.

Tools Required: Screwdriver



STEP 27

Inspect your installation, make sure the kit is properly positioned and all fasteners are secured. S&B Filter recommends keeping all stock parts in case you would ever need to reinstall the stock intake. Affix the ID label near the intake kit. The installation is now complete.

