

E-SERIES

STANDARD AND XT SERIES

2021+ Nissan Navara NP300

INSTALLATION SHEET

Any damaged or missing parts?

Parts will be shipped to you directly.

Call 1-800-952-7655 Mon-Fri - 8am - 5pm EST

or email info@rollnlock.com

Note: Installation is the same for both standard track and XT Series track.

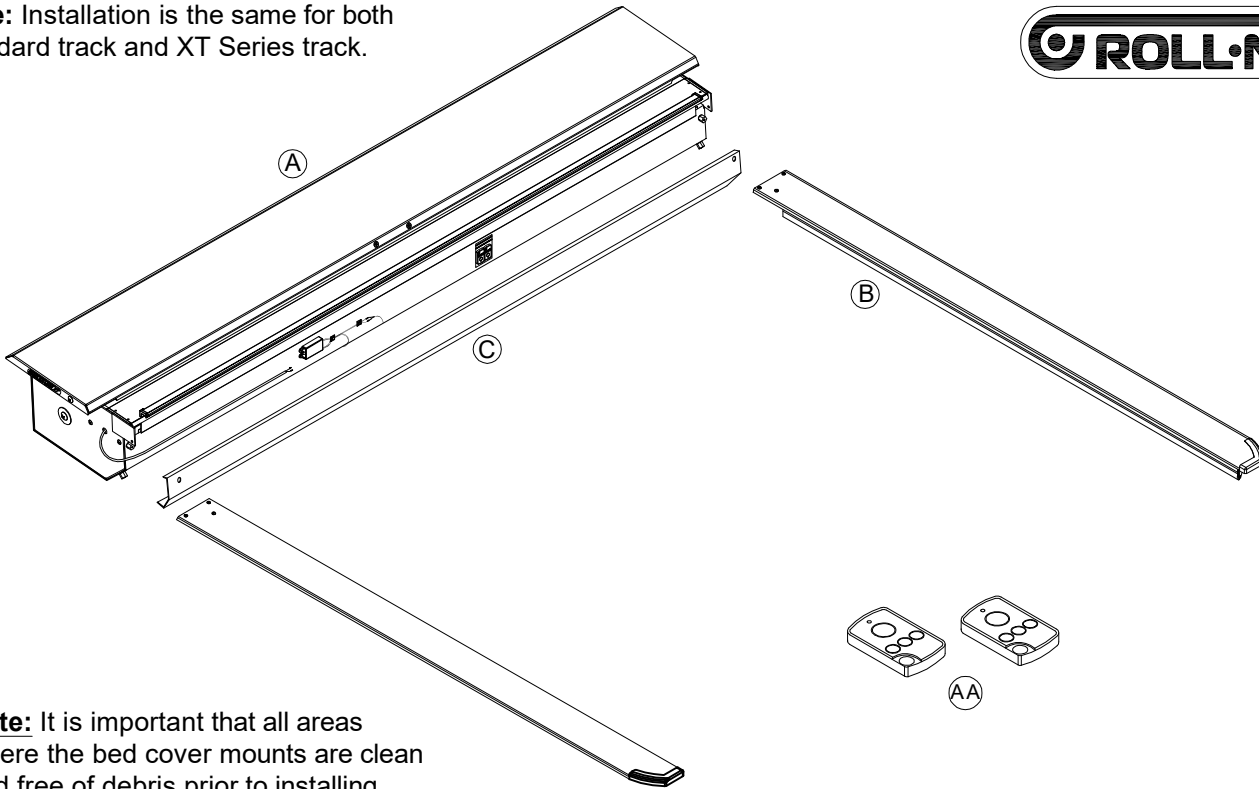

Note: It is important that all areas where the bed cover mounts are clean and free of debris prior to installing.

TOOLS PROVIDED

- 1/4" Allen wrench
- 303 Vinyl protector

TOOLS REQUIRED

- 3mm drill bit
- 13mm drill bit
- Drill with Phillips head
- Phillips screwdriver
- 7/16" wrench
- Tape measure

PARTS INCLUDED IN YOUR KIT

- | | |
|--------------------------------|--|
| (A) 1x Housing | (M) 4x Rubber washer |
| (B) 2x Track | (N) 2x 1/4-20 Lid screw (Taped to lid) |
| (C) 1x Cargo shield | (O) 5x #8 x 1 1/4" Self tapping screw |
| (D) 1x Tailgate extrusion | (P) Foam tape (Bulkhead) |
| (E) 2x Drain tube | (Q) 1x Override cable |
| (F) 4x "O" Bed clamps | (R) 1x Power wire/connectors |
| (G) 2x "O" Bed clamp with bolt | Which includes: 1x Fuse holder |
| (H) 6x 5/16" Socket cap screw | 1x Power wire |
| (I) 6x 5/16" Lock washer | 10x Zip ties |
| (J) 6x Cargo nut | (AA) 2x Remotes (Taped to housing) |
| (K) 6x #10-24 x 1/2" Screw | |
| (L) 4x 1/4-20 x 3/8" Screw | |

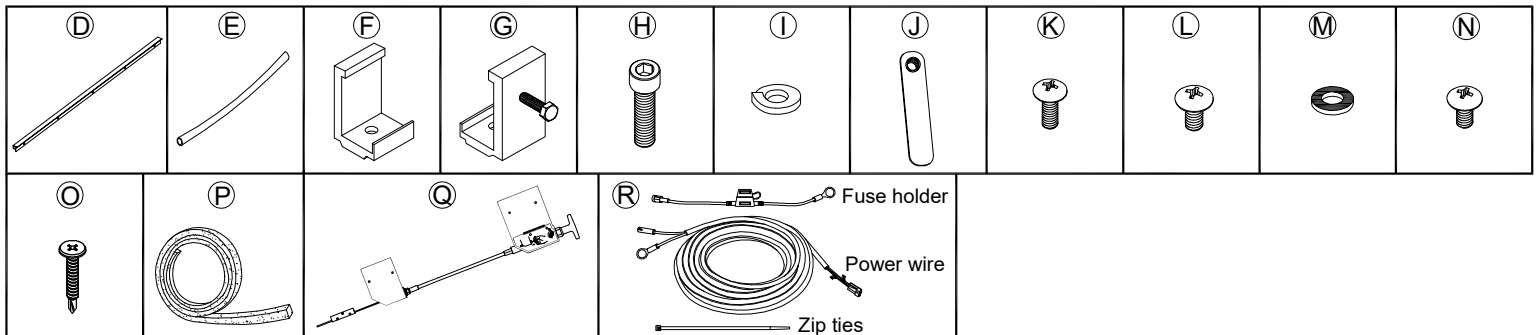

1a If no bedliner present
proceed to Step 1

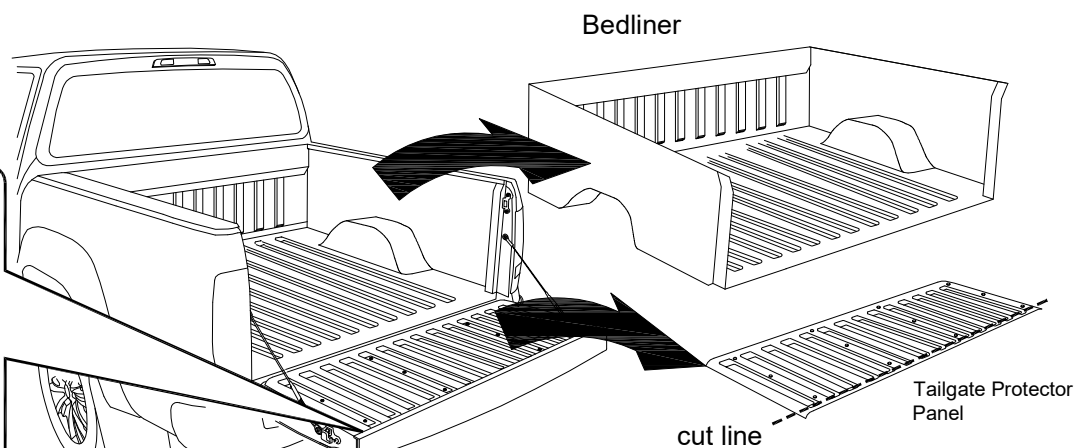
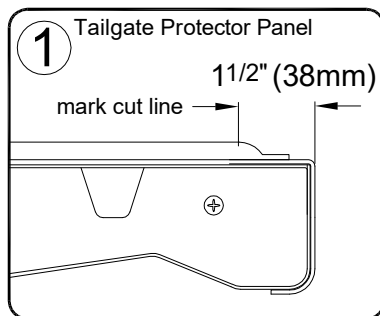

1b

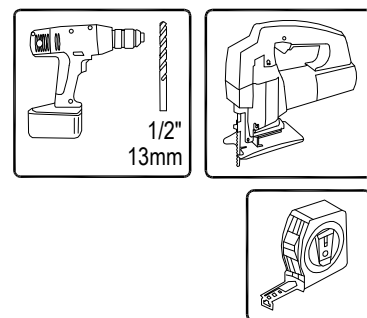
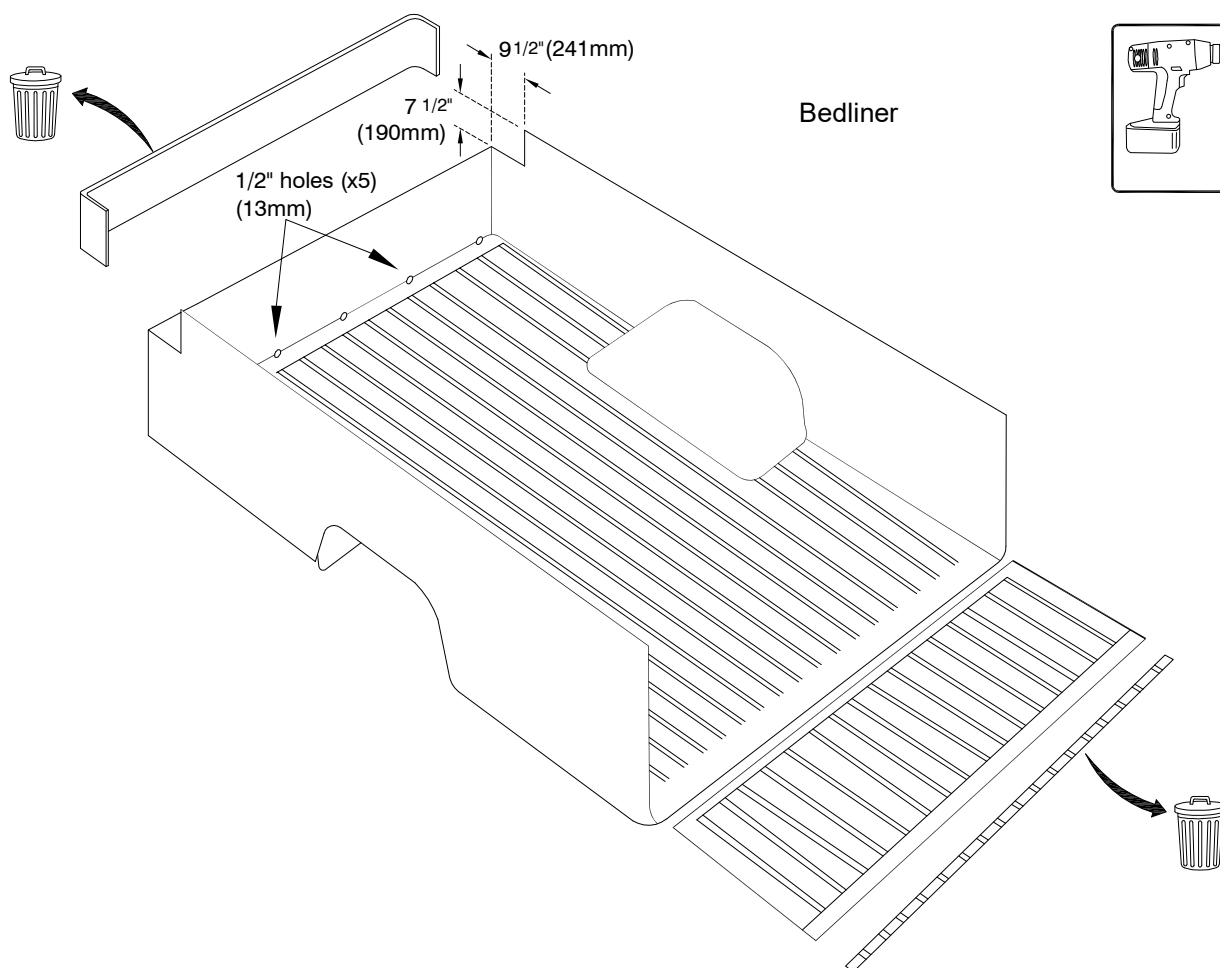

1b

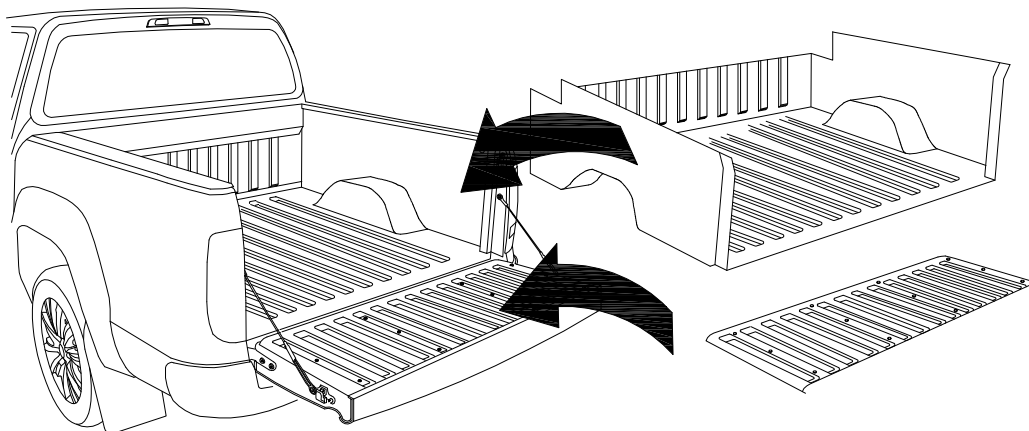

1

Remove Utility Channel on
driver and passenger side.

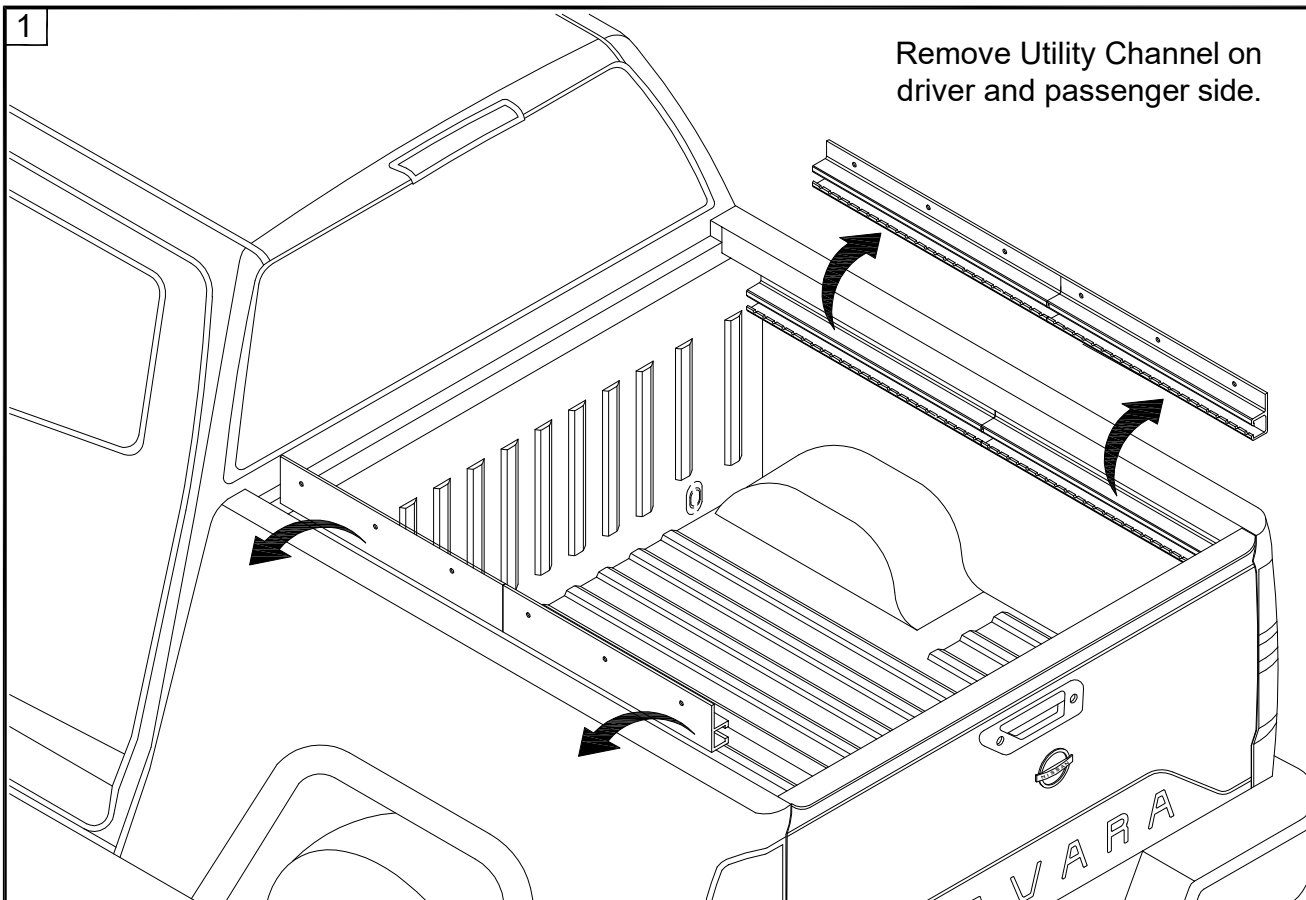

2

Peel paper from foam tape (P)
and stick to bulkhead some
cutting might be needed.

Sticky

(P)

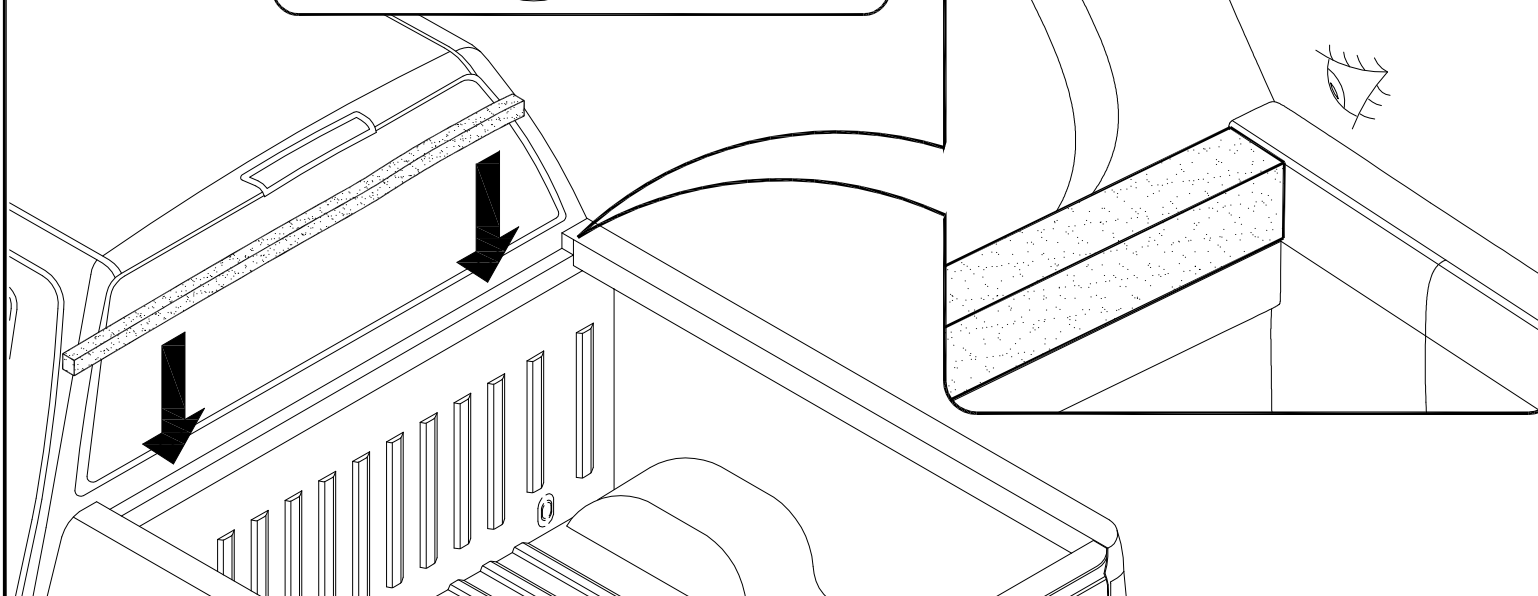

3

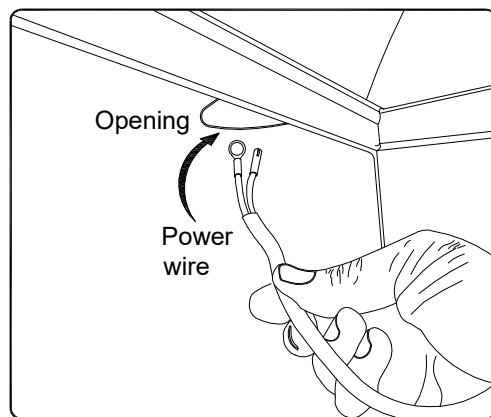

Feed end of power wire (R) through opening on drivers side of truck cap, continue feeding down through the side panel to the ground. Leave 2 feet of power wire in the truck bed.

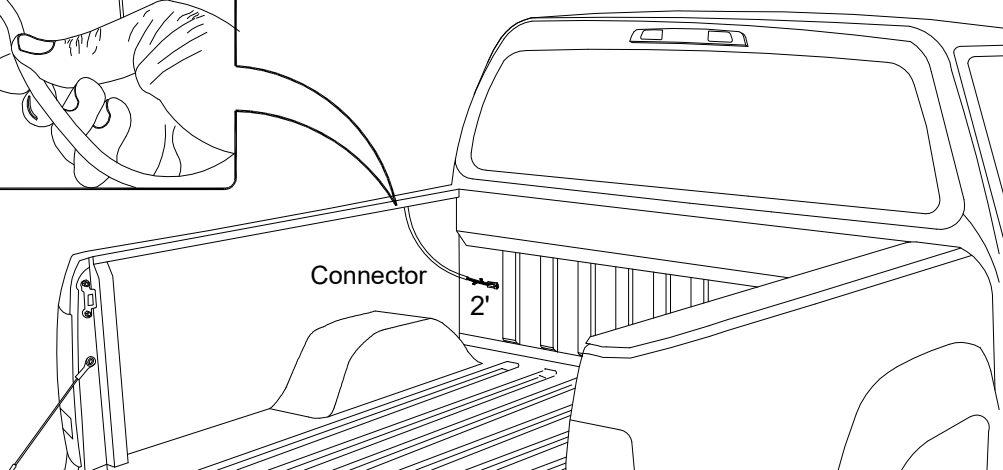

4

Feed power wire under the truck securing to an existing wire harness leading to the battery with supplied zip ties.

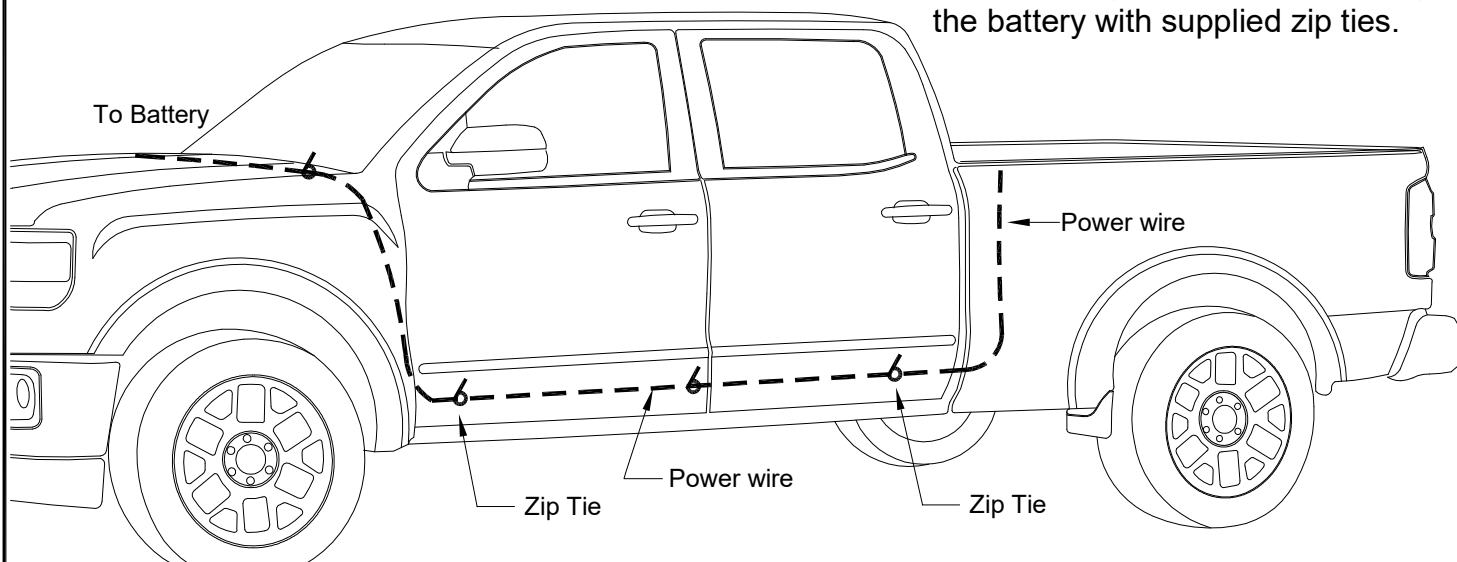

5 Connect the fuse holder (1) to the white wire (2).

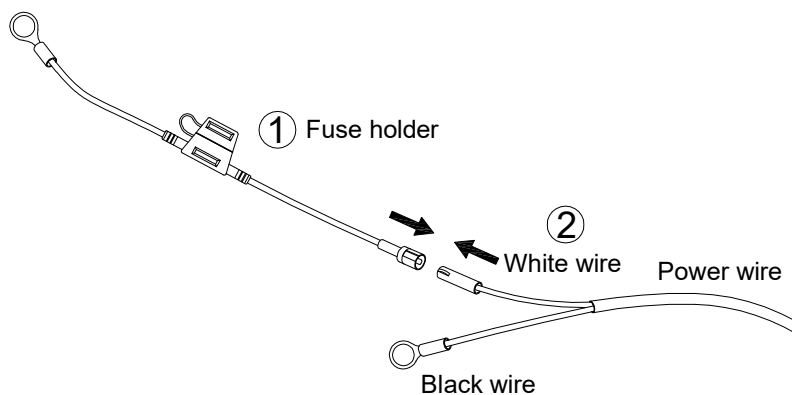

Connect the red fuse holder ring to positive terminal (1) and the black/terminal ring to negative terminal (2) of battery.

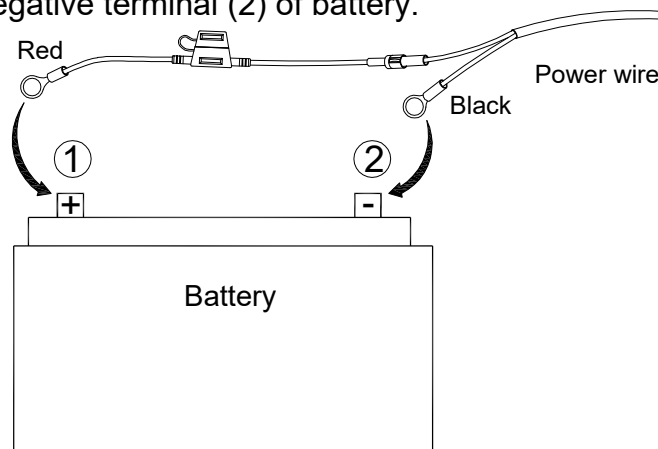

6

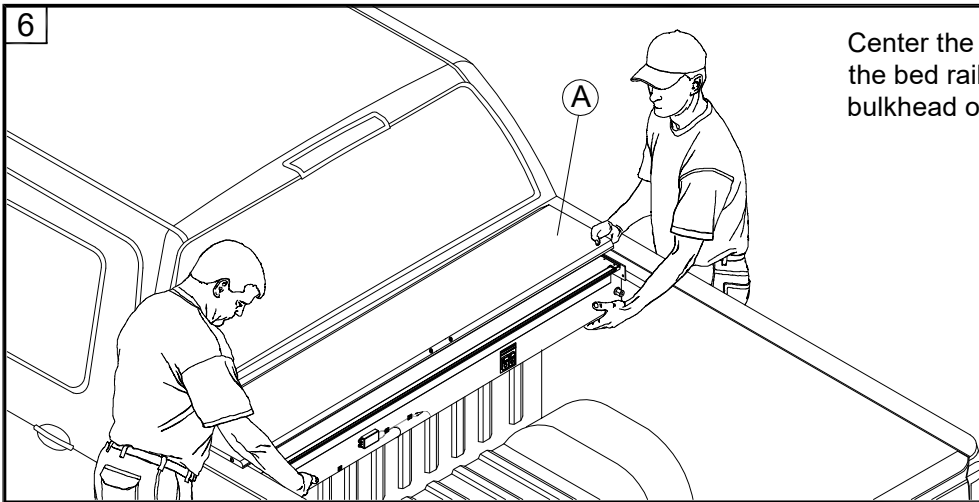

Center the housing (A) between the bed rails, and up against the bulkhead on driver and passenger side.

7

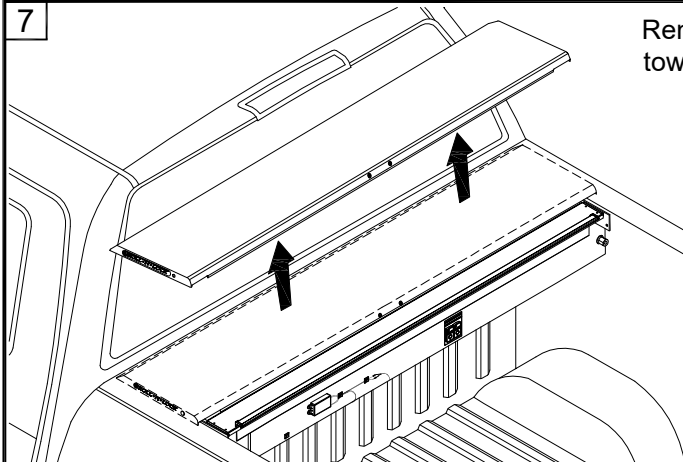

Remove lid from housing (A) by pushing toward cab (1) and up (2) on driver and passenger side.

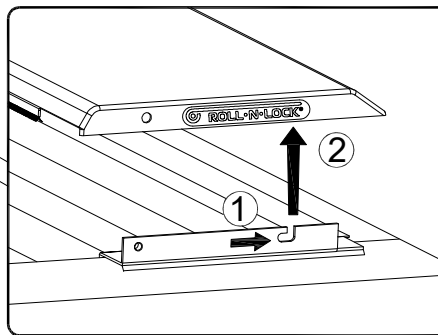

8

(1) Align tracks (B) onto the housing stem. (2) Make sure the edge of the tracks butt up against housing on driver and passenger side. (3) **Note: Do Not** remove the piece of cardboard until tracks are installed.

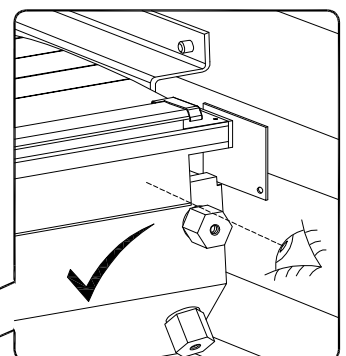
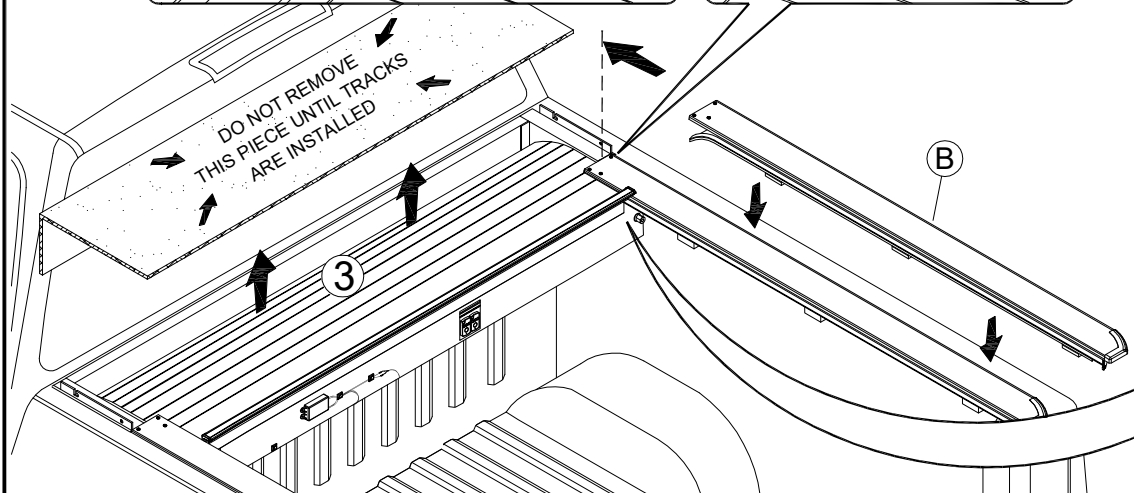
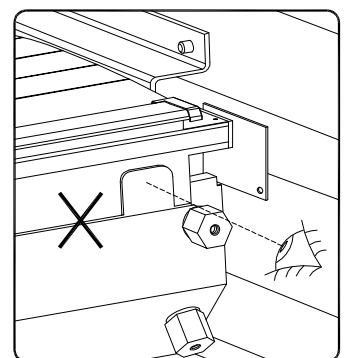
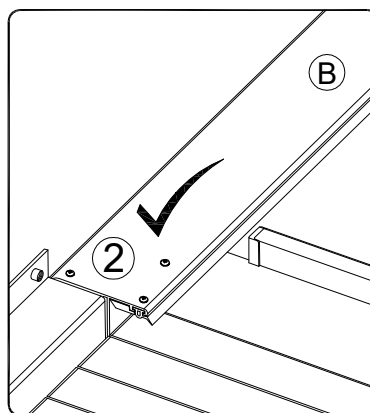
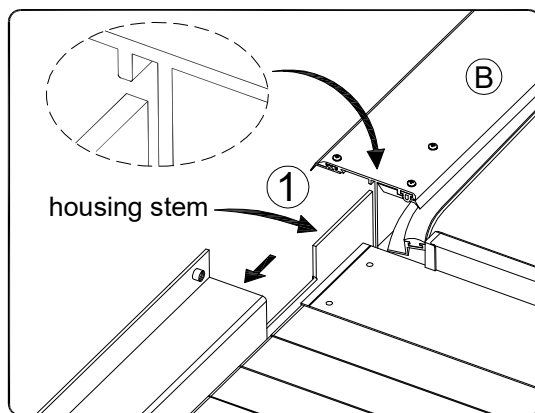

- 9 Loosely attach U bed clamps (F) to the pre-installed track clamps using 5/16" socket cap screw (H) and 5/16" lock washer (I) on driver and passenger side.

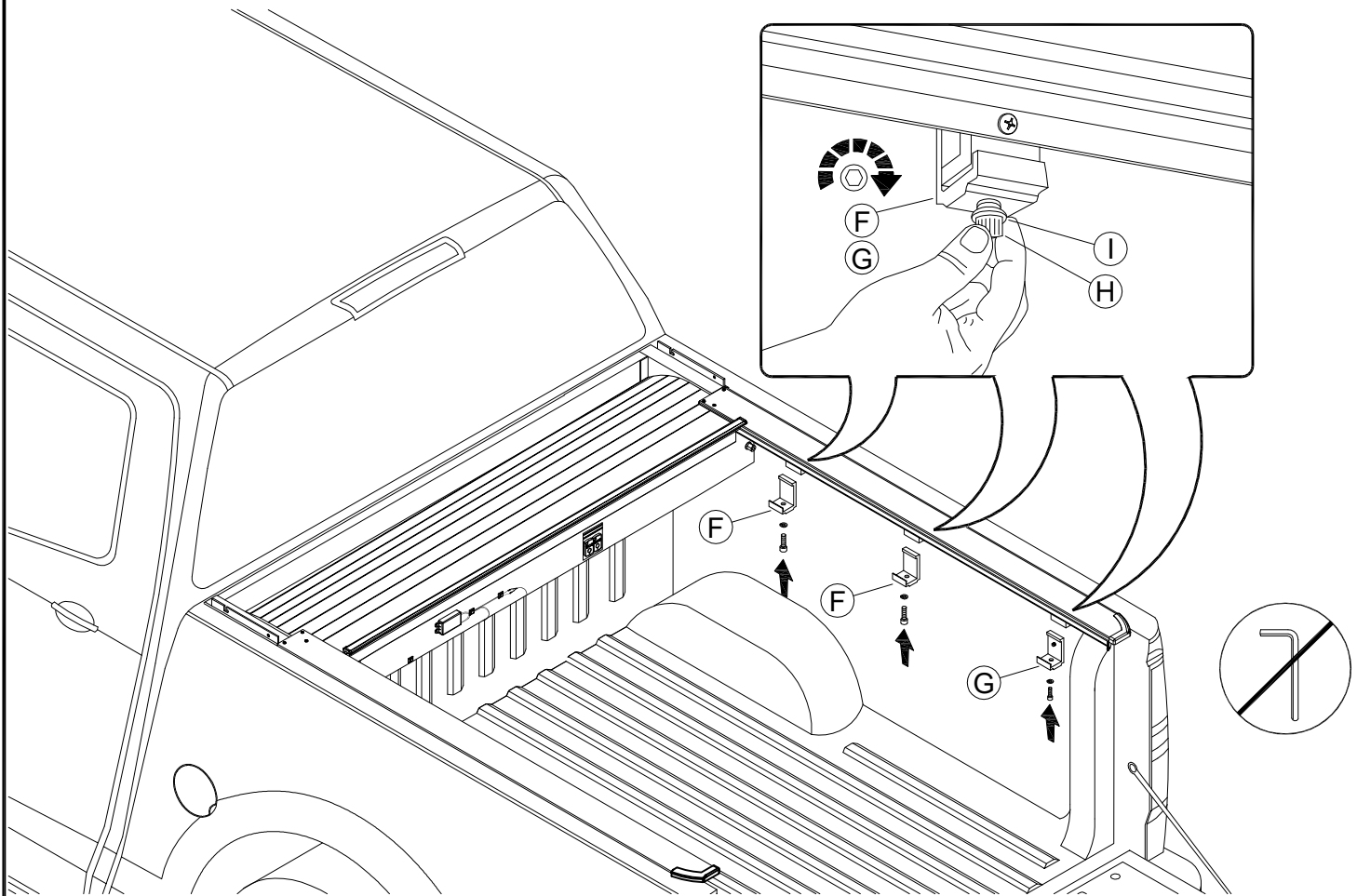

- 10 Secure tracks (B) to housing stem (1) on driver and passenger side using cargo nut (J) and #10-24 screw (K) using Phillips screwdriver.

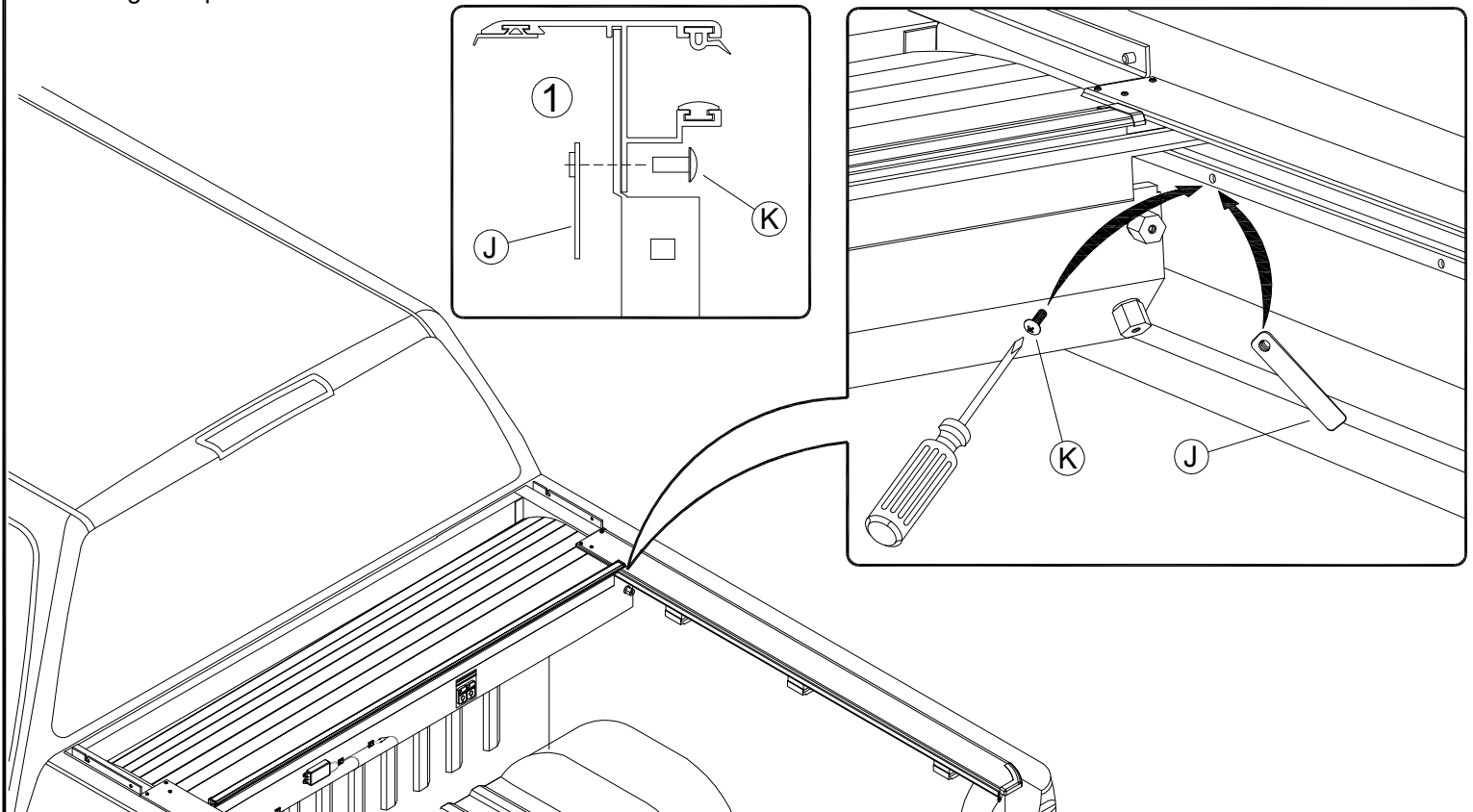

- 11 (1) Carefully hold the tailgate extrusion (D) square to the tailgate, use a 3mm drill bit to predrill holes. (2) Use (5) #8 x 3/4" self tapping screw (O) to secure the center hole, move to each end, press the assembly to the top of the tailgate making it conform to the contour of the tailgate, and secure it in place.

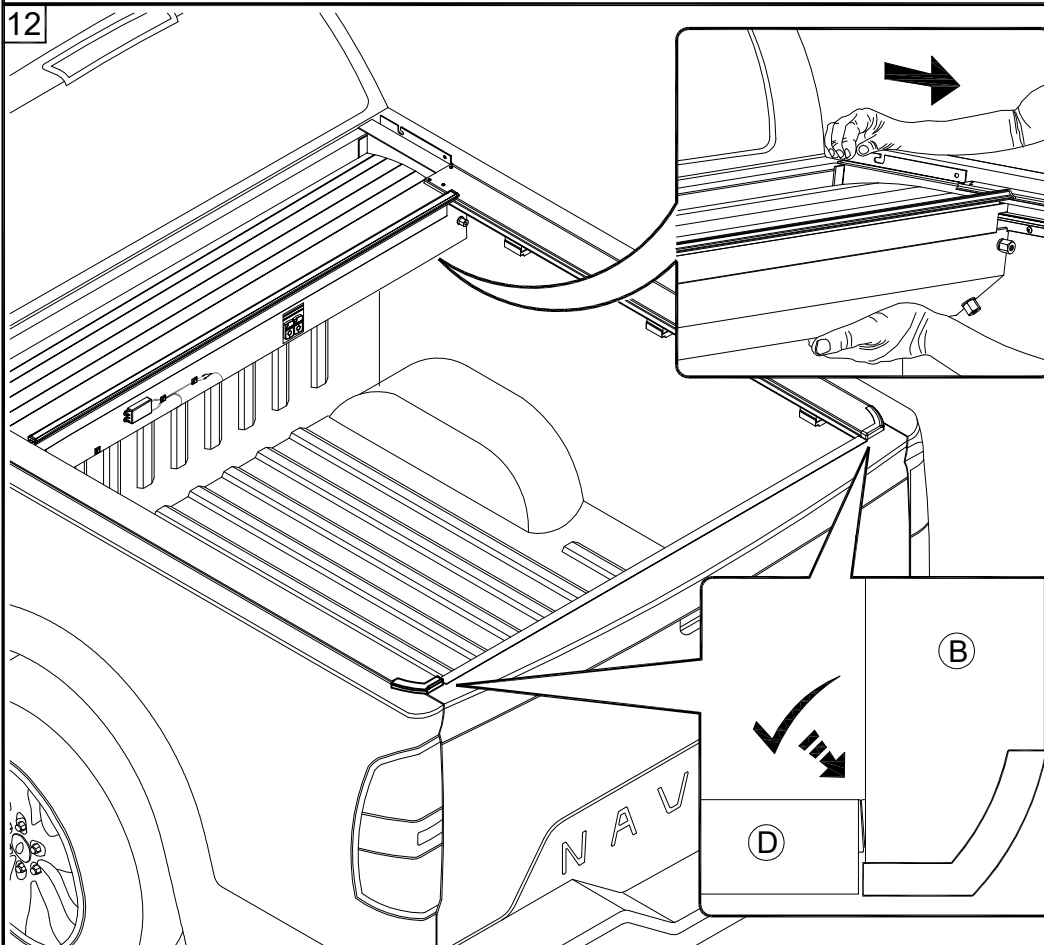
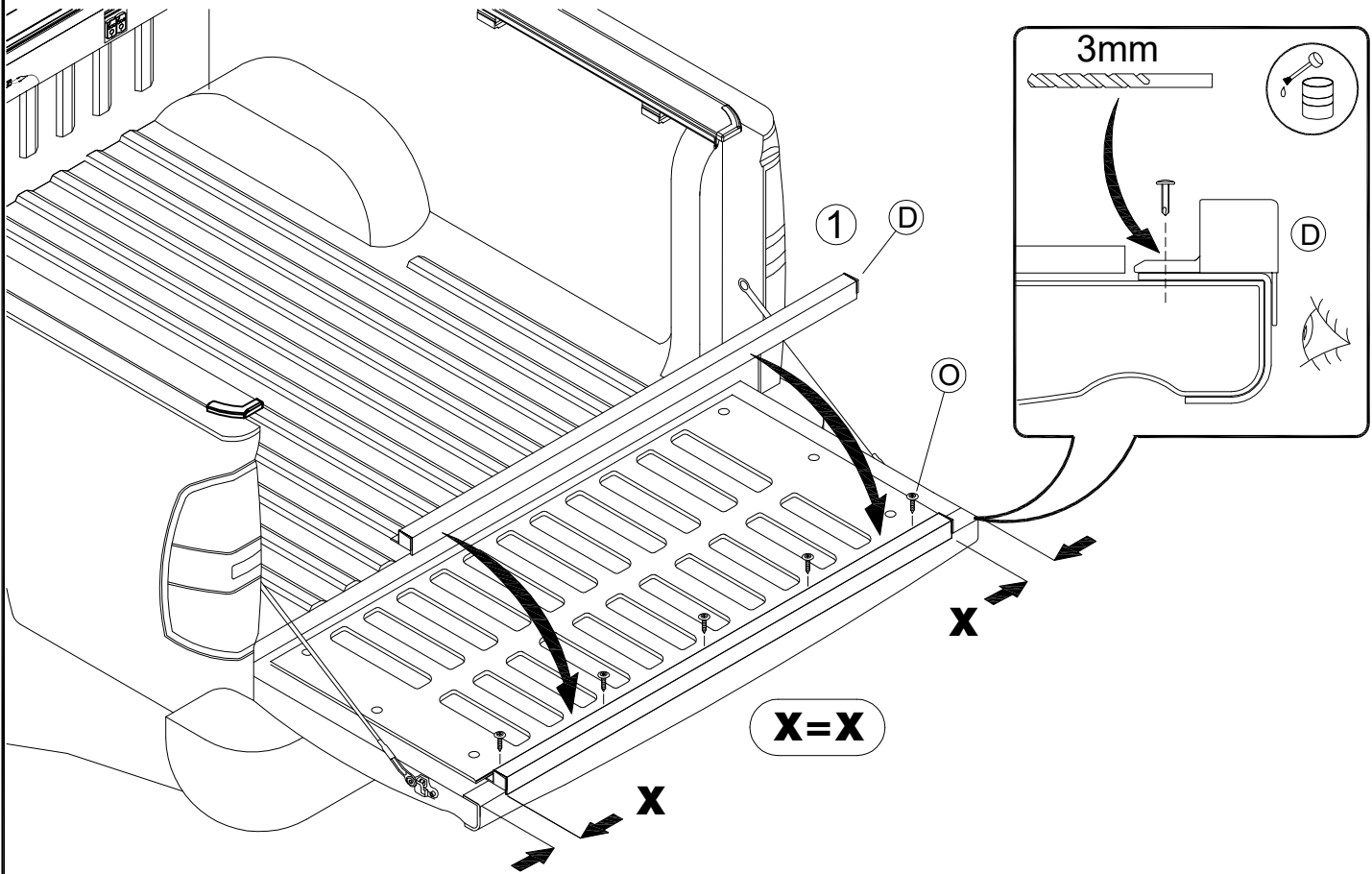

Close tailgate, shift the housing (A) back so the end of the tracks (B) are up against the tailgate on driver and passenger side.

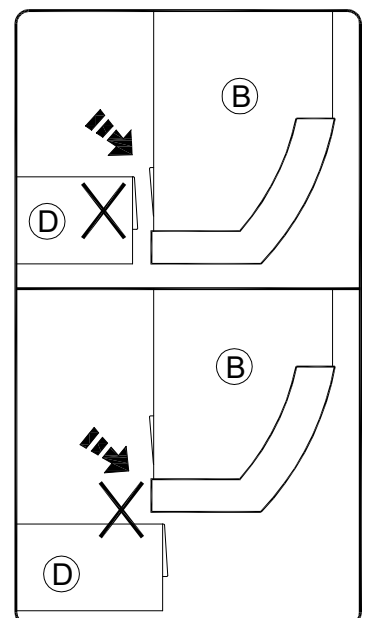



IMPORTANT



Alignment of Track (B) and Tailgate Extrusion (D) on driver and passenger side.

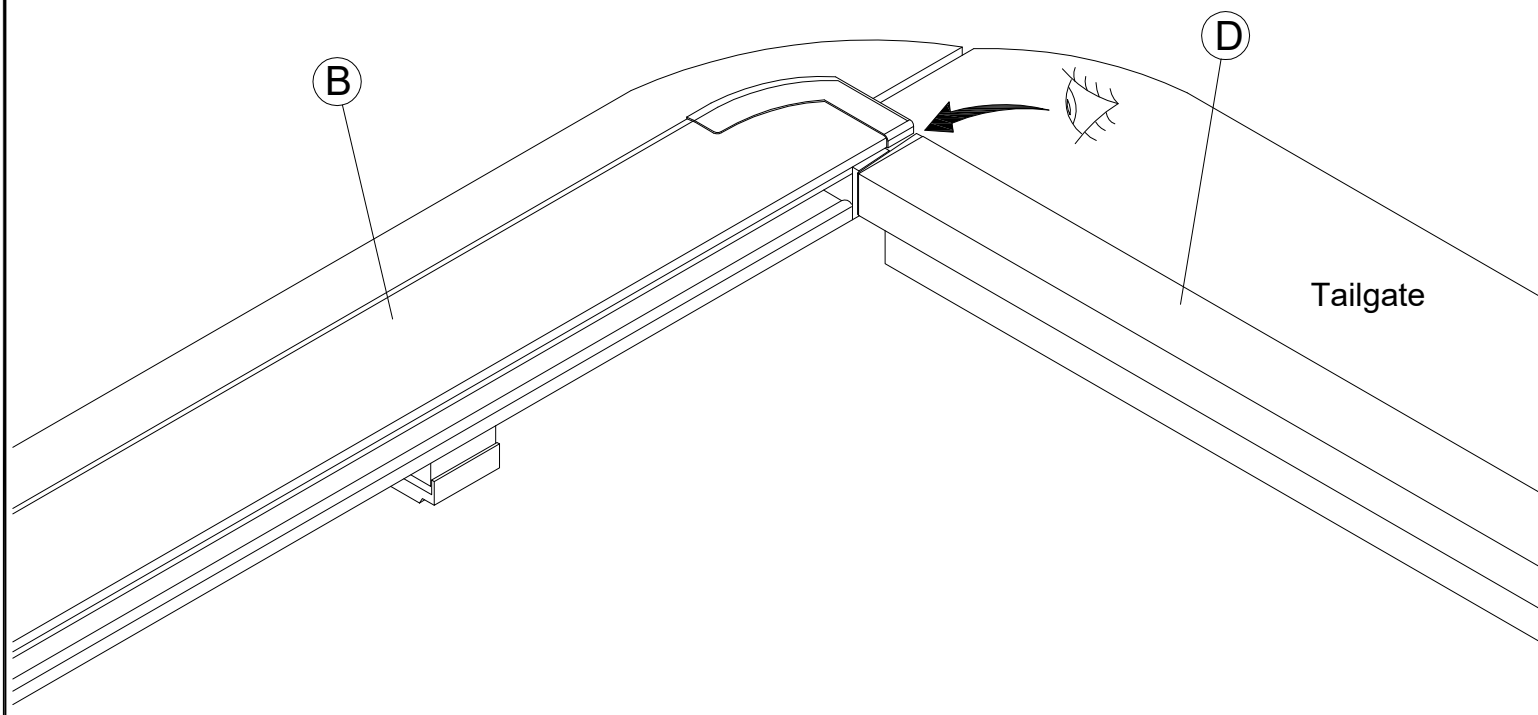

Once tracks (B) are correctly spaced and adjusted to the correct height, tighten bed clamps (F) and (G) using a 1/4" Allen wrench (1) on driver and passenger side. **Note:** When tight there may be a gap between the clamps, **do not over-tighten**. **If needed:** Tighten 1/4-20 bolt on back clamp (G) to level tracks (2).

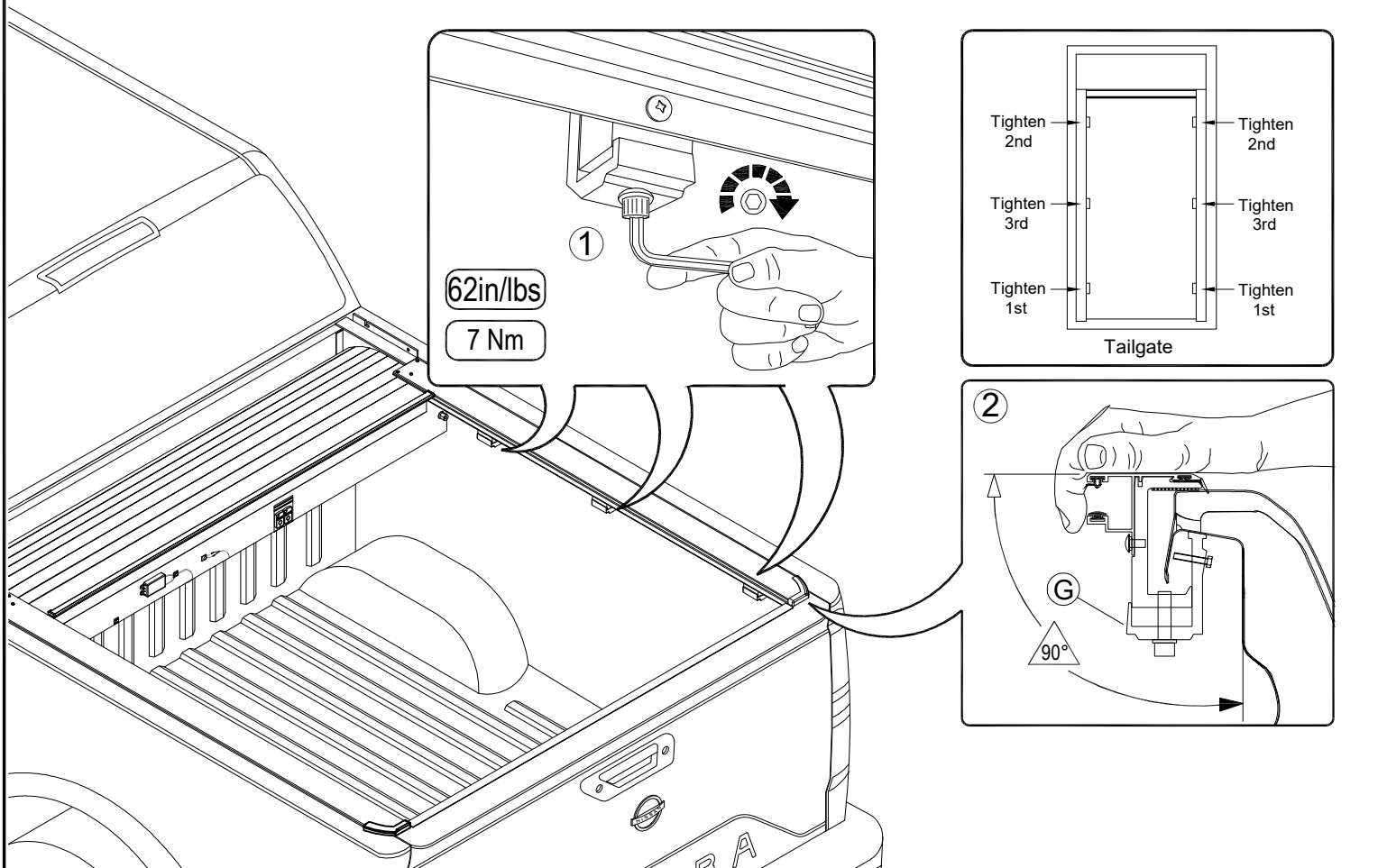

15

Replace lid on housing (A) by lining the pin with the slot and pushing down (1) and toward tailgate (2). Then install the 1/4" lid screws (N) (3) on driver and passenger side.

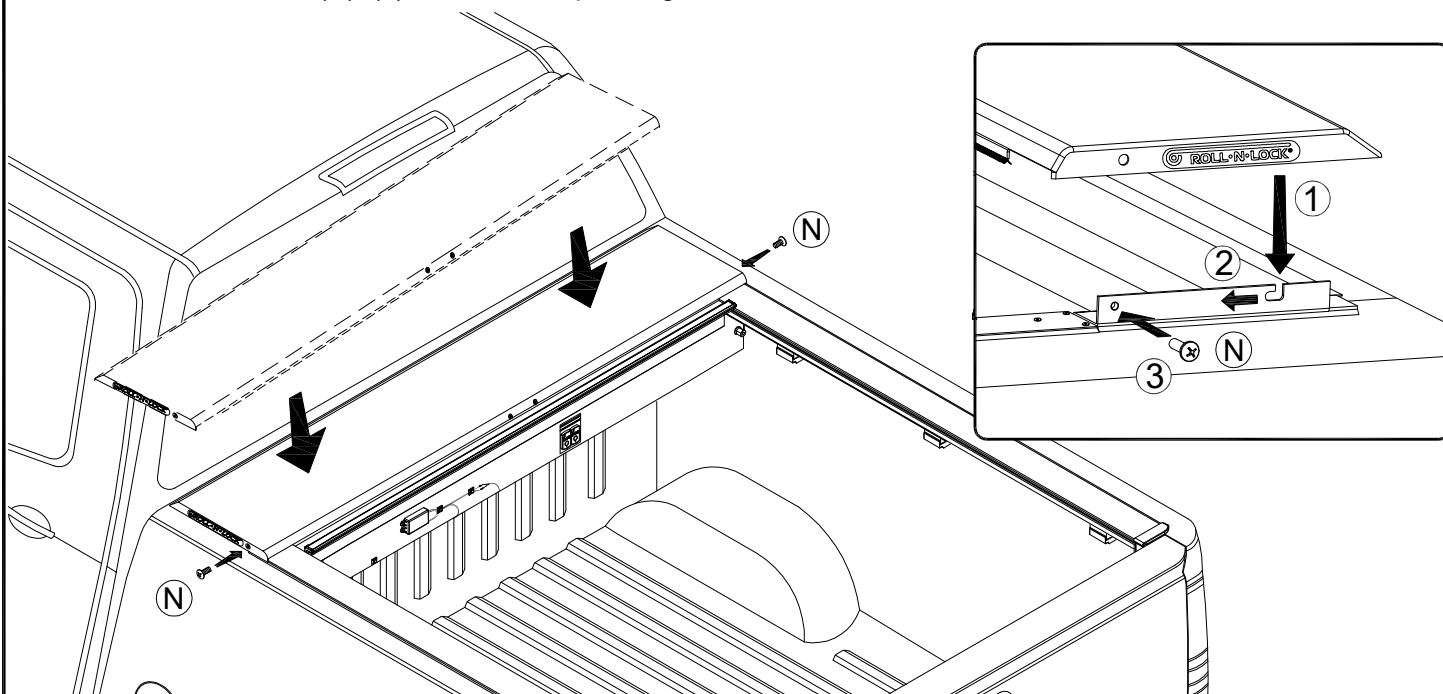

16

Drill 1/2" hole (1) through bulkhead as shown on driver and passenger side. **DO NOT** drill through the truck cab. Insert one end of the drain tube (E) through the drilled 1/2" hole and feed toward the ground and insert the other end onto the housing fitting. Make sure the drain tubes (E) are **NOT** aligned with or through the cab vents on driver and passenger side.

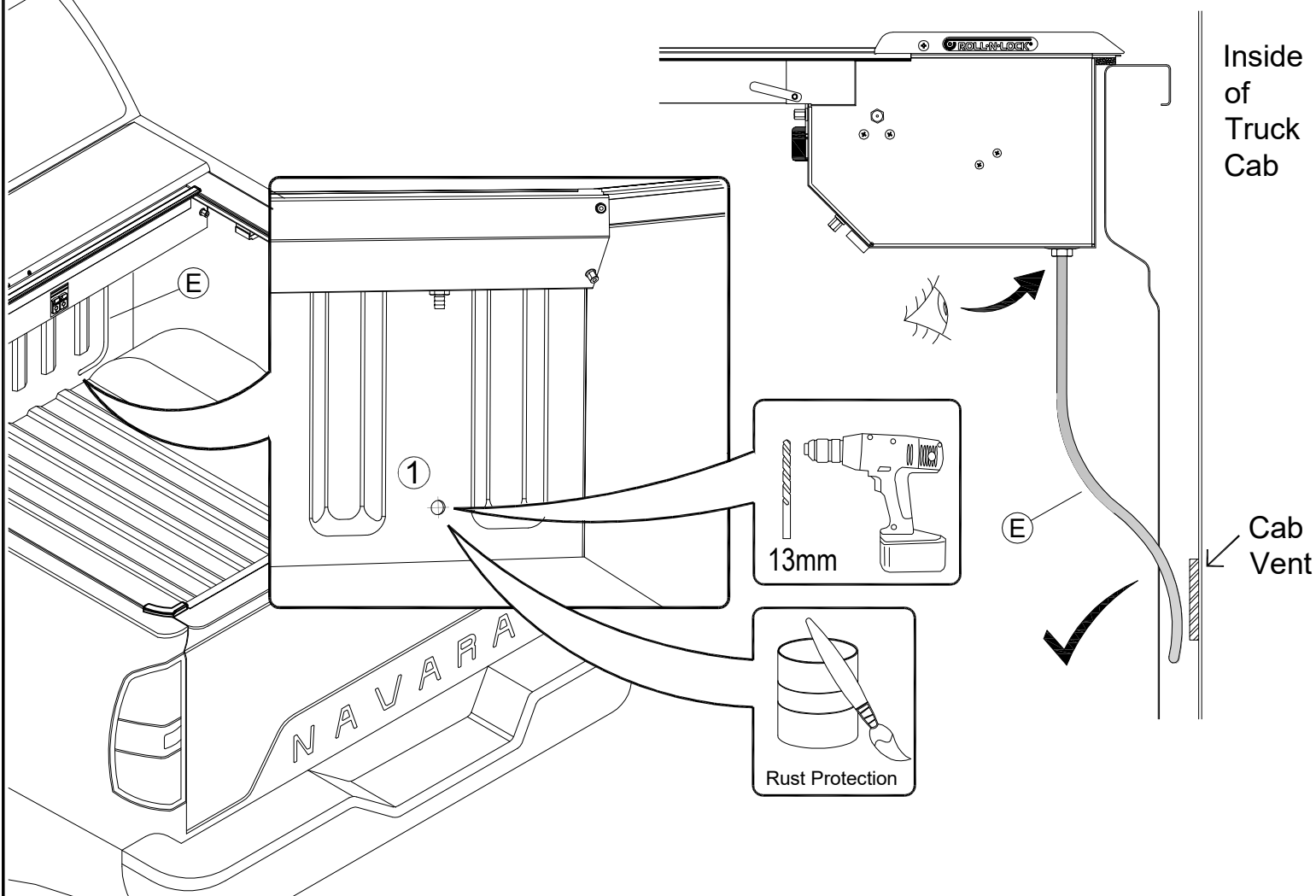

17 Powering the unit:

A

Unwrap light wires (1) from motor wire (2).

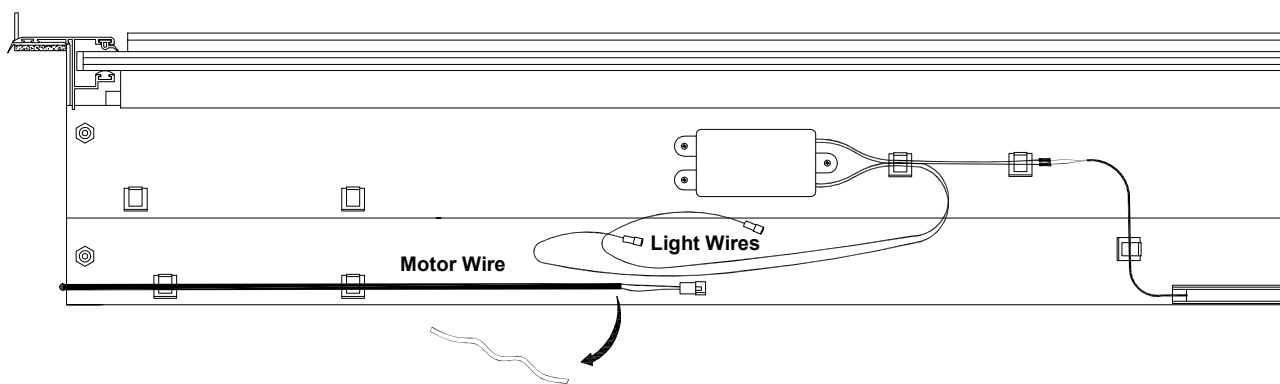

B

Bring power wire (1) around and attach onto cable mounting clips (2) the front of the unit.

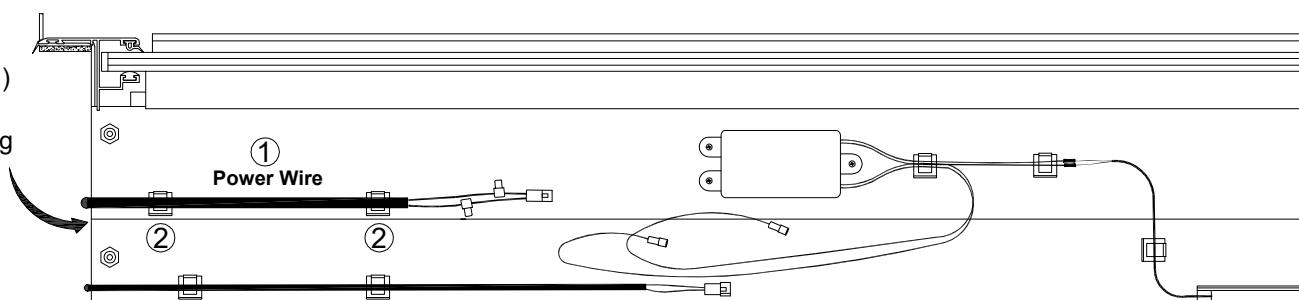

C

Plug power wire connector (1) into motor wire connector (2).

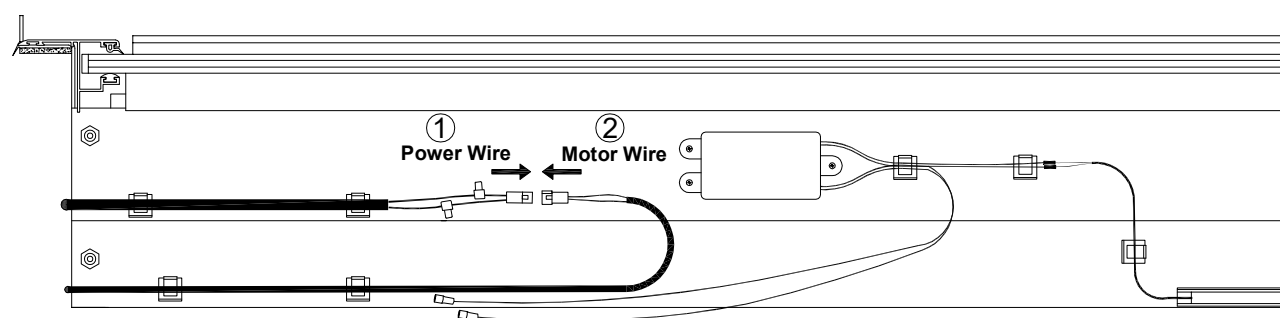

D

Plug black light wire connector (1) into black power wire connector and plug red light wire connector (2) into white power wire connector.

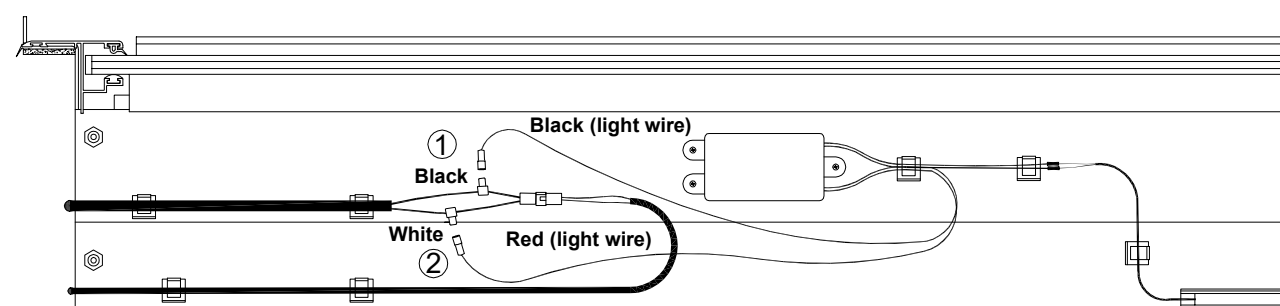

E

Position motor wire connection.

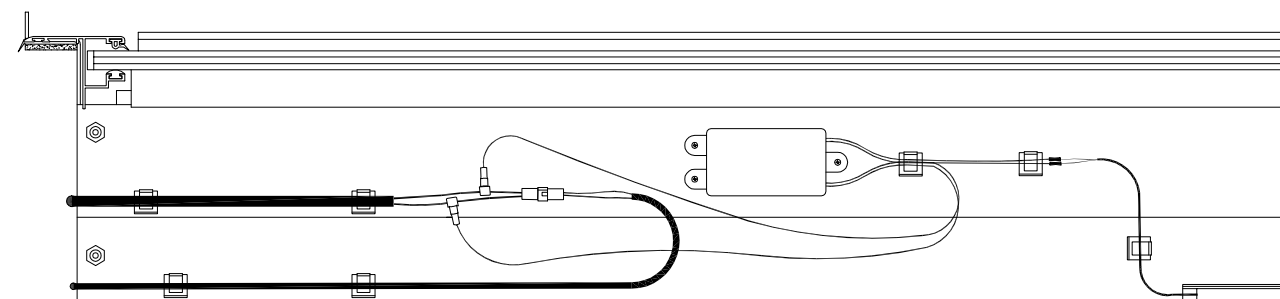

18 Remove remotes (AA) from housing.

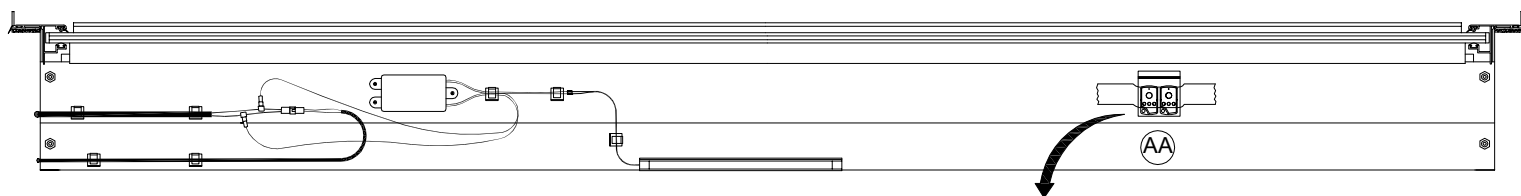

OPERATING THE SYSTEM

- Push the large button to run cover.
- Push the large button to stop the cover.
- Cover will stop automatically at tailgate and housing.

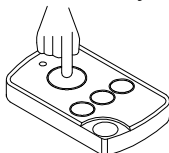

- Push the small button to turn light on.
- Push the small button to turn light off.
- Light will automatically turn off in three minutes.

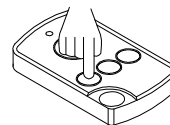

19 Attached cargo shield (C) with the slots at the bottom of the housing (A) using two black rubber washers (M) and two 1/4-20 x 3/8" screws (L) on driver and passenger side.

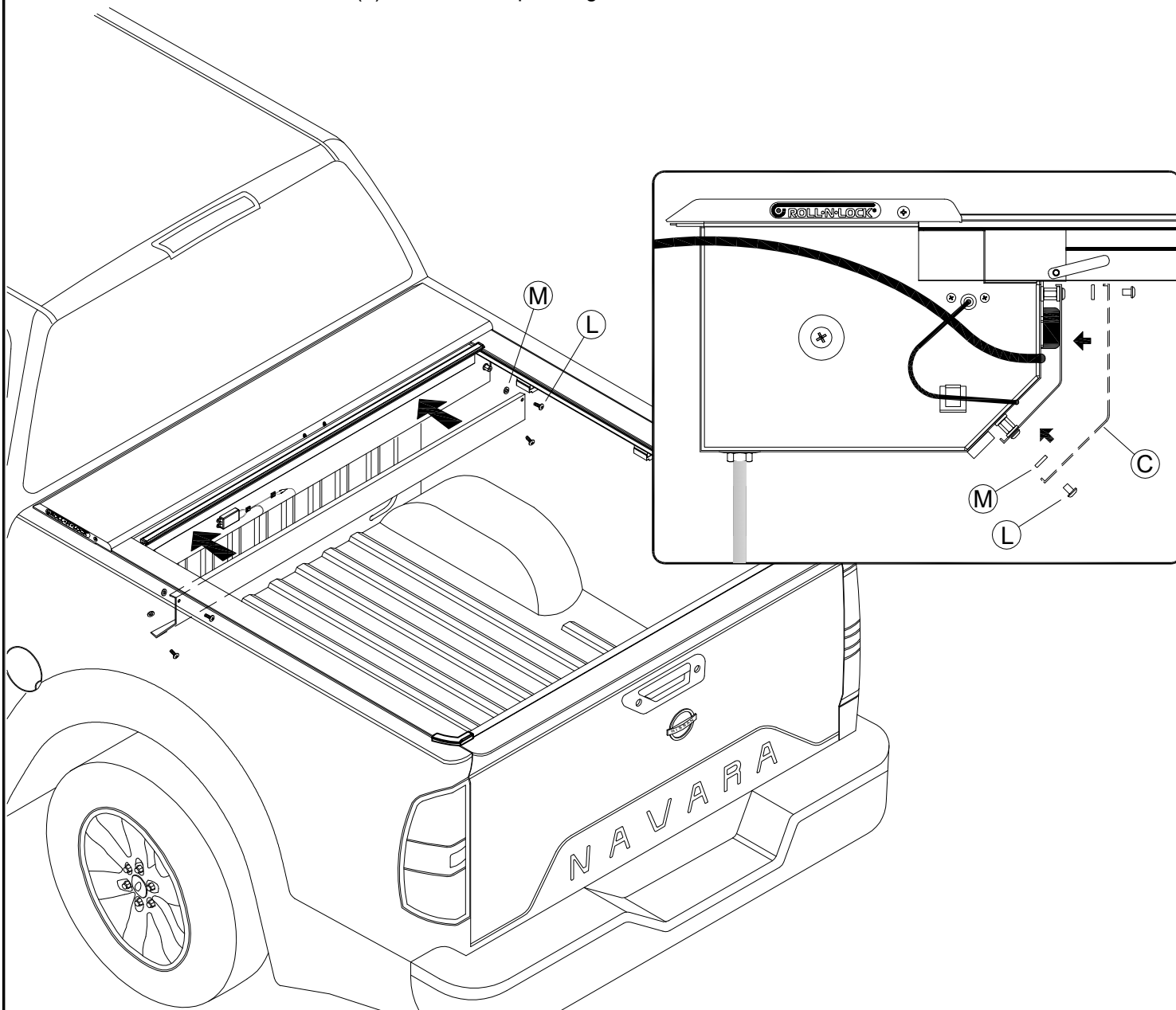

20 Override cable installation.

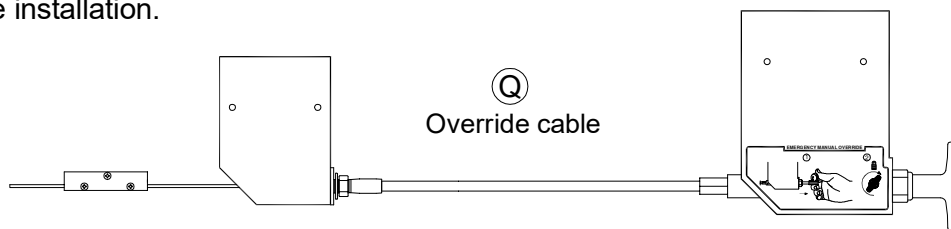

Attach small bracket (1) through the slotted holes using two cargo nuts (J) and two 10-24 screws (K) toward the front of the track.

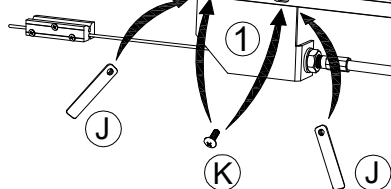

Attach large bracket (2) through the slotted holes using two cargo nuts (J) and two 10-24 screws (K) toward the back of the track.

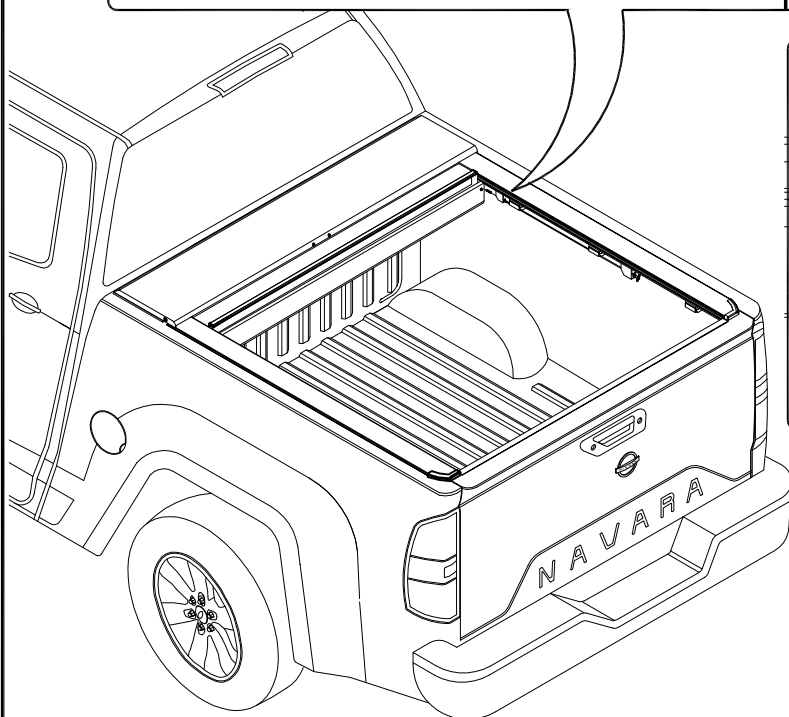
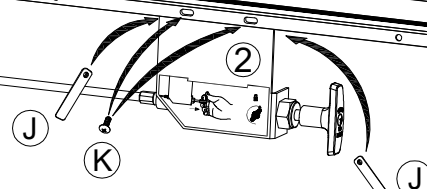

Loosen top screw (3), pull the soft cable from the housing taught through the cable coupler and tighten screw.

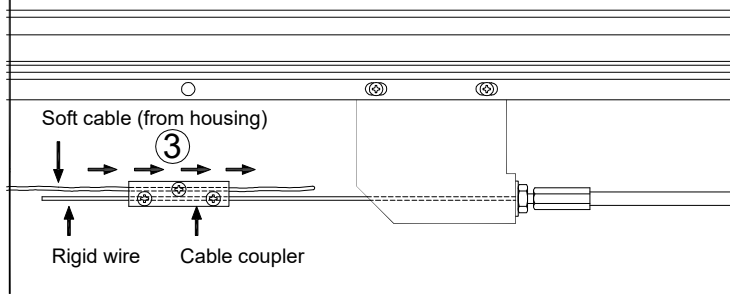

Key bracket (1) and (2) into slot on the back of the track (B).

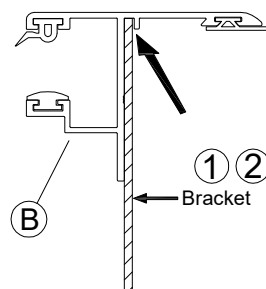

Operating the override cable - **Use only when the cover is not operating remotely.**

(1) Pull the lever and (2) turn to lock in place, the cover will operate manually.

To go back using the cover remotely, unlock the lever and push back to lock cover.

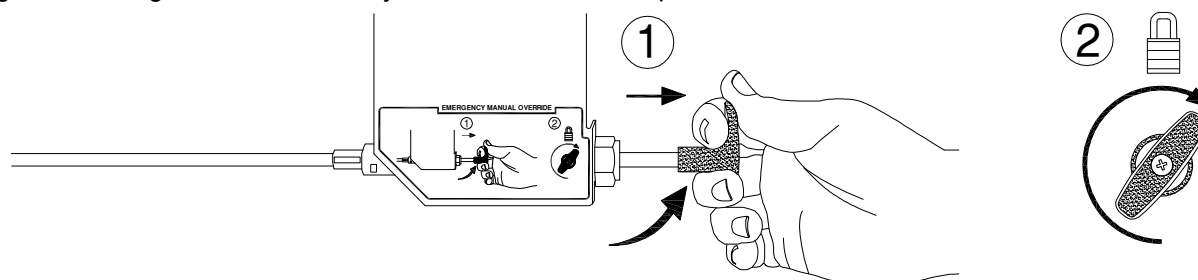

IMPORTANT NOTICE

This bed cover may retract to the full open position very quickly resulting in any objects placed on top of the bed cover to fall off the bed cover or become trapped inside of the bed cover carrier. Do not place ANY objects on top of the bed cover when attempting to close. Failure to follow the instruction may result in damage to your vehicle, belongings or bed cover. To avoid injury keep all body parts clear of the bed cover and carrier when opening.

LIMITED WARRANTY

WARRANTY COVERAGE

This truck bed cover is warrantied against defects in materials or workmanship as follows. This warranty is void if the product has been damaged in an accident, or due to neglect, unforeseeable use, improper installation, improper servicing, or other cause not arising out of defects in material or workmanship.

This truck bed cover carries a limited warranty for five (5) years from the original date of purchase, subject to the terms below.

WARRANTY IS NOT TRANSFERABLE

The warranty is to the initial consumer purchasing the truck bed cover and it is not transferrable to a subsequent end user. Proof of purchase may be required to enforce these warranty rights.

WARRANTY CONDITIONS

Failure to follow these care and use instructions will void the warranty:

- Clean with mild automotive soap and water only. Do not use any strong chemicals or cleaners. Lubrication of the rails with silicone or petroleum-based products will void the warranty.
- Cargo must be secured at all points when the vehicle is in motion. Failure to adequately secure the cover can result in damage and will void the warranty.
- Check all clamps and retention mechanisms for tightness after a week of driving following installation (or re-installation) of the cover and periodically thereafter.
- Before opening, the cover must be free of all foreign materials including snow and ice.
- Do NOT tow your vehicle from the rear with the cover on your vehicle. If towing from the rear is required, the cover MUST be removed from the vehicle and properly stored.

WARRANTY PERFORMANCE

If all warranty conditions are met, a defective truck bed cover or hardware component will either be repaired or replaced (at our option). We reserve the right, for any warranty, to substitute a newer model or bed cover having a similar form and function, to offer a warranty discount on an entire replacement system, and/or provide remedies other than those mentioned in this document.

WARRANTY RETURN

A Return Material Authorization number must be obtained from our Customer Service Department prior to returning any product. We may require the original item to be returned postage prepaid for final determination. Shipping charges will apply for any repair or replacement. Other than postage or shipping charges, no charge will be made for repair or replacement under this warranty.

This warranty gives you specific legal rights. As a consumer, you may also have additional rights and remedies under the laws of your state.

Register online at <https://rollnlock.com/warranty-registration>

REGISTER
YOUR
WARRANTY
ONLINE



COVER CARE AND MAINTENANCE

Hard Tops

Clean with mild automotive soap and water only. Do NOT use any strong chemicals or cleaners. Use of wax or polish is not recommended.

Maintenance

It is recommended that you periodically check that the cover is securely attached to your truck bed. Inspect the clamps and front mounting bolts to ensure they were properly installed and have not come loose or knocked out of adjustment during operation. Covers that are used with high frequency or that are subject to the vibrations and impact from rough roadways can cause the cover to require adjustment.

IMPORTANT: NEVER spray any lubricant into the tracks. THIS WILL VOID YOUR WARRANTY. Lubricants, especially silicone or petroleum-based, will attract dirt and debris which will lead to slow operation and will degrade the gaskets over time. If the tracks feel a little 'sticky', you may spray some 303 Aerospace Protectant® inside the track and wipe with a clean rag to remove any dirt or debris that has built up.

Housing Drains

To ensure proper drainage, it is recommended that the canister housing be checked and cleared of any leaves, twigs or other debris that may obstruct the drain tubes.

To remove the lid, first, make sure the Roll-N-Lock cover is fully closed at the tailgate. Remove the Phillips head screw on each side of the lid and slide the lid slightly forward toward the cab to disengage the set pins. Once free, the lid can be lifted and removed from the canister. DO NOT ALLOW THE COVER TO RETRACT WITH THE LID REMOVED. This could allow the cover to retract too far into the canister causing damage to the cover.

SAFETY INSTRUCTIONS

- DO NOT place objects on or against the cover or framework.
- DO NOT tie cargo to truck bed cover framework.
- DO NOT operate the vehicle with objects on top of the cover body.
- NEVER allow children or pets to occupy the truck bed while the cover is closed.
- The cover is not airtight. Special care is required to keep cargo clean and dry.
- Bed covers won't prevent theft of contents inside the truck box.

TROUBLESHOOTING TIPS

Cover jumps when running.

- Check track connection at housing.

Cover drags running forward and back.

- Spray 303® on a rag and wipe the top gasket in the track.

Cover binds when closing.

- Check track to track measurement.

Track tips up or down.

- Tighten bolt on back clamp to level track.

Cover does not run.

- Check connection at the battery.

Light does not work.

- Check plug-in connection.