

Part # 1119051

## Components and Hardware:

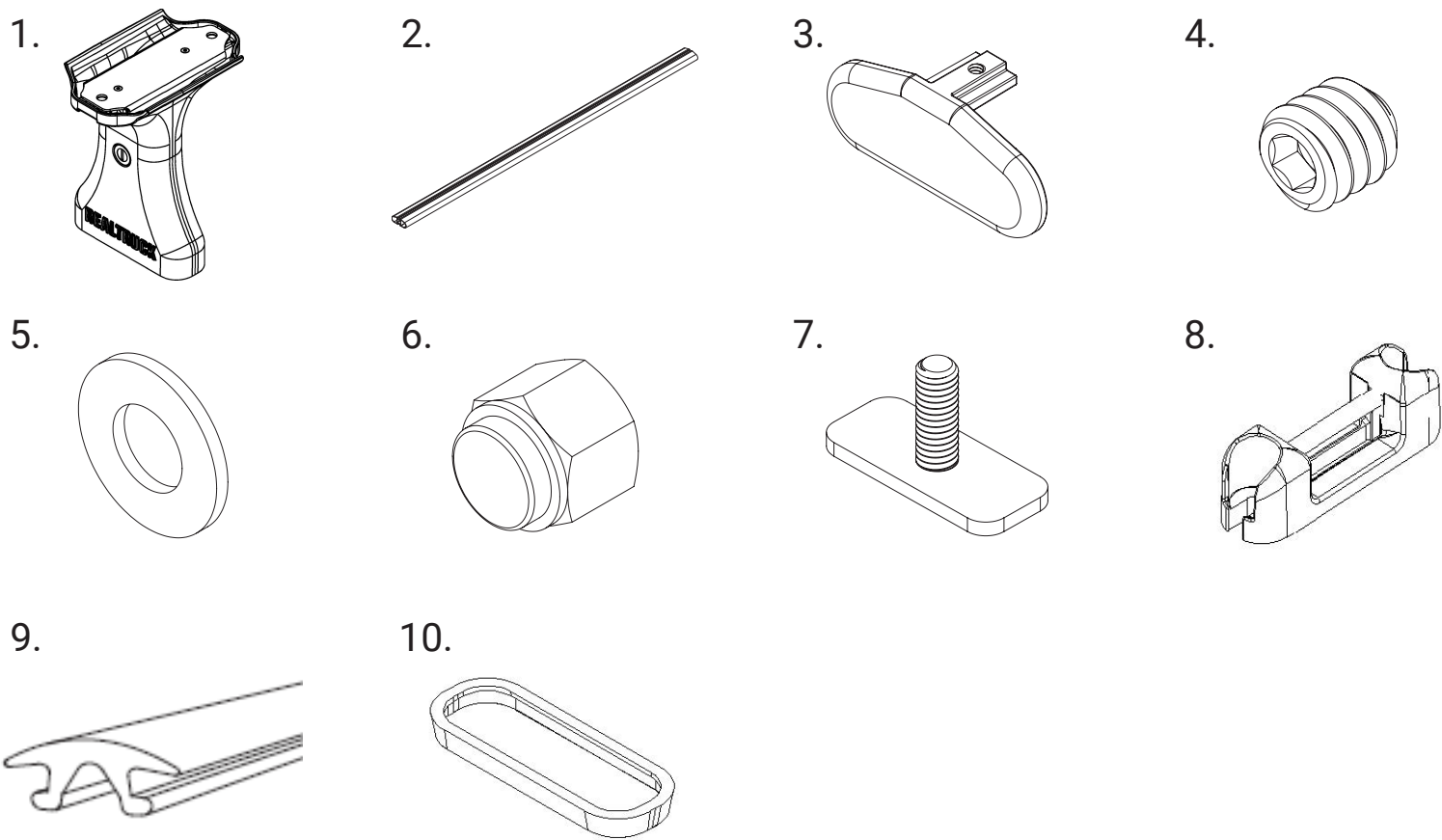

## Components and Hardware:

1. Upright Assembly.....	(4)
2. Crossbar .....	(2)
3. Crossbar End Plug .....	(4)
4. Set Screw 1/4"-20 x .25 .....	(8)
5. Washer 5/16" .....	(16)
6. Cap Nut 5/16"-18 .....	(16)
7. T-Bolt 1" .....	(16)
8. Tie Down.....	(4)
9. Channel Guard .....	(2)
10. Molded Weather Seal .....	(4)

## Tools for Installation:

- 1/2" Wrench or Socket
- 1/8" Allen Key (Provided)
- Scissors or Cutting Tool

## RealTruck Elevate Base Rack

1. Install the Tie Downs (#8) onto the t-slot compatible rails. Remove the t-slot compatible rail end plug. Slide two T-Bolts (#7) into each adapter rail. Space the T-Bolts (#7) so they align with the slots on Tie Downs (#8).

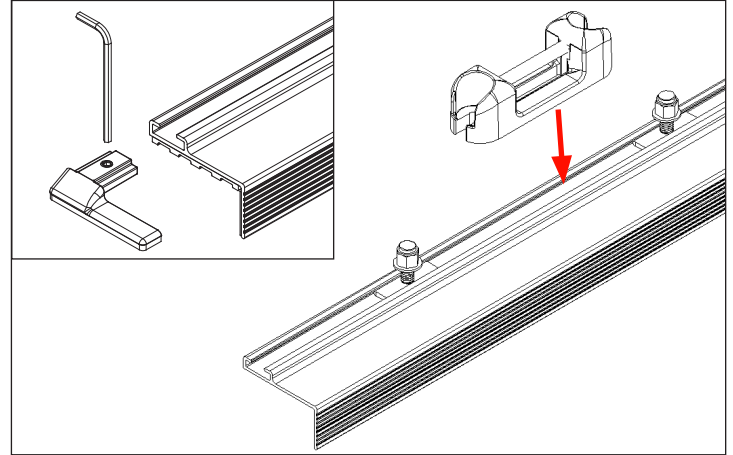

2. Reinstall the rail end plugs. Install Washers (#5) and Cap Nuts (#6) for the Tie Downs (#8). Position the Tie Downs (#8) in desired location and torque the Cap Nuts (#6) to secure the Tie Downs (#8). Do not overtighten. **Space front and rear Tie Downs (#8) as far apart as possible to support the load.**

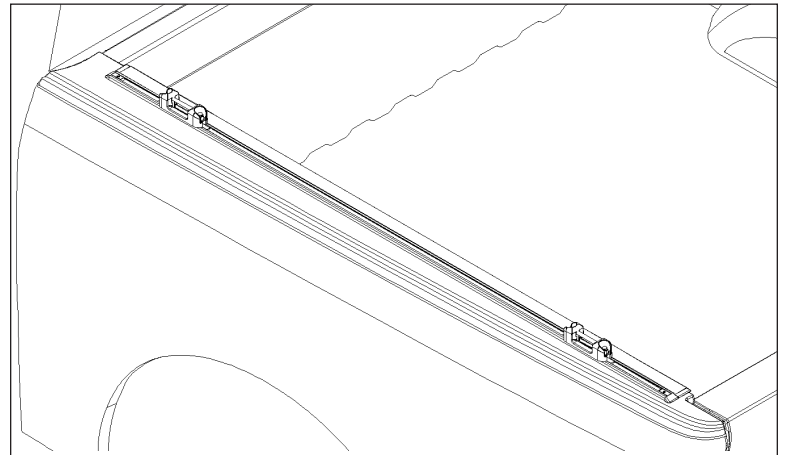
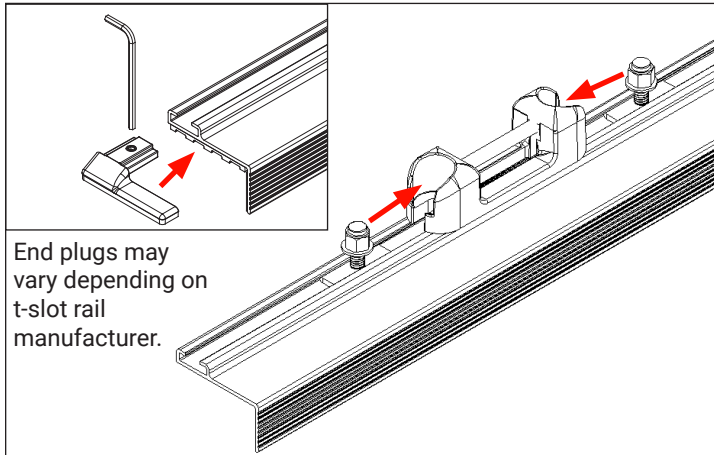

3. Install the Molded Weather Seal (#10) to the bottom of the Upright Assemblies (#1).

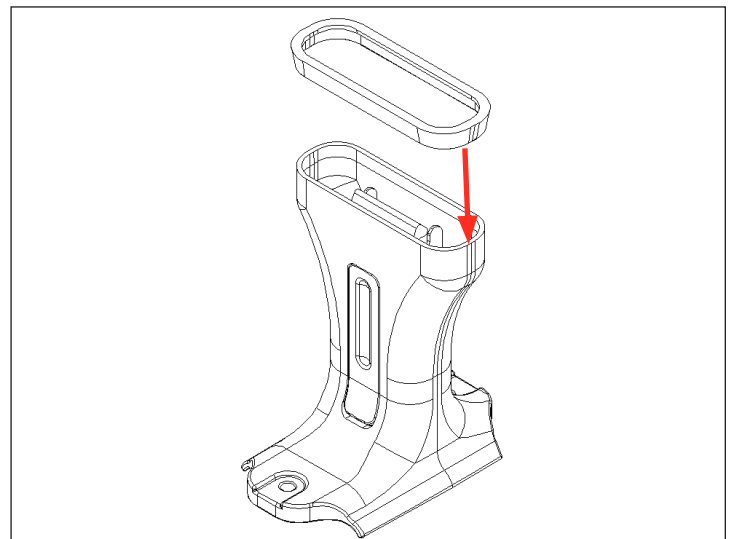

## RealTruck Elevate Base Rack

4. Insert two T-Bolts (#7) into the bottom t-slot of each end of the Crossbar (#2). Repeat on the second Crossbar (#2).

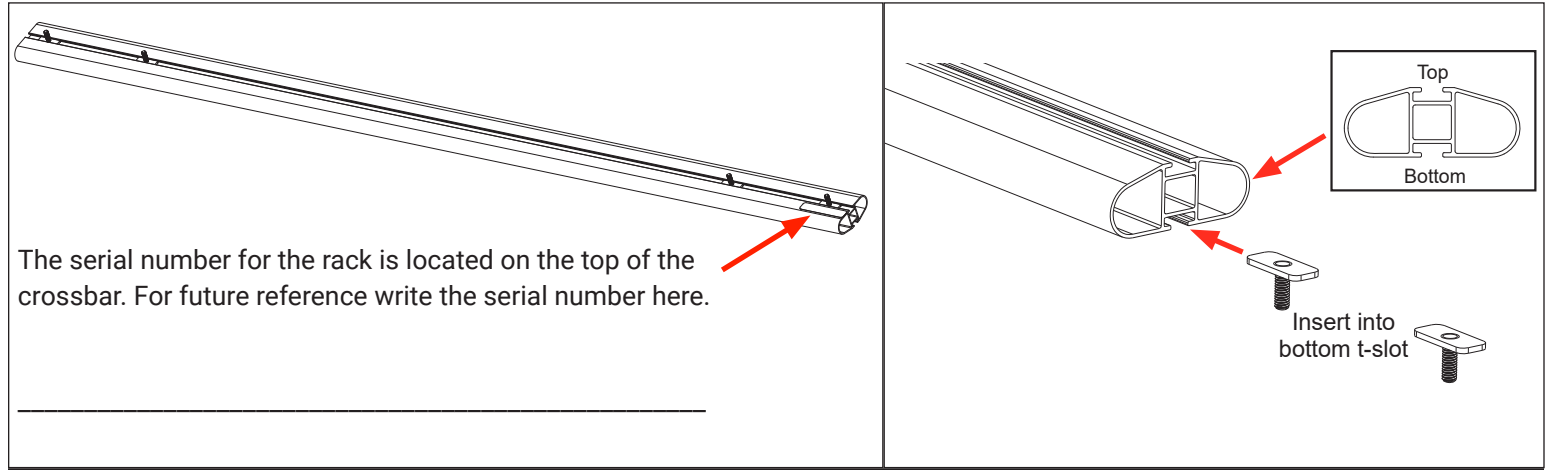

5. Install any t-slot compatible accessories. Then install all 4 Crossbar End Plugs (#3) with Set Screws (#4).

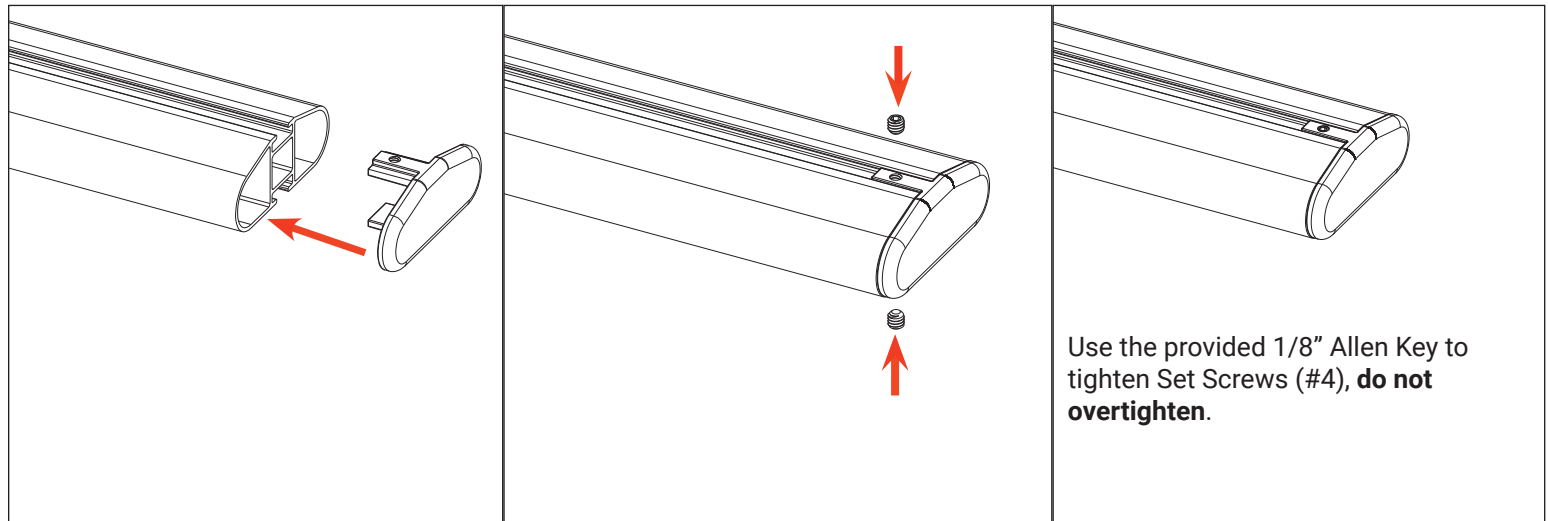

6. Install the Upright Assemblies (#1) onto Crossbar (#2). Install Washers (#5) and Cap Nuts (#6) onto T-Bolts (#7). Finger tighten for now.

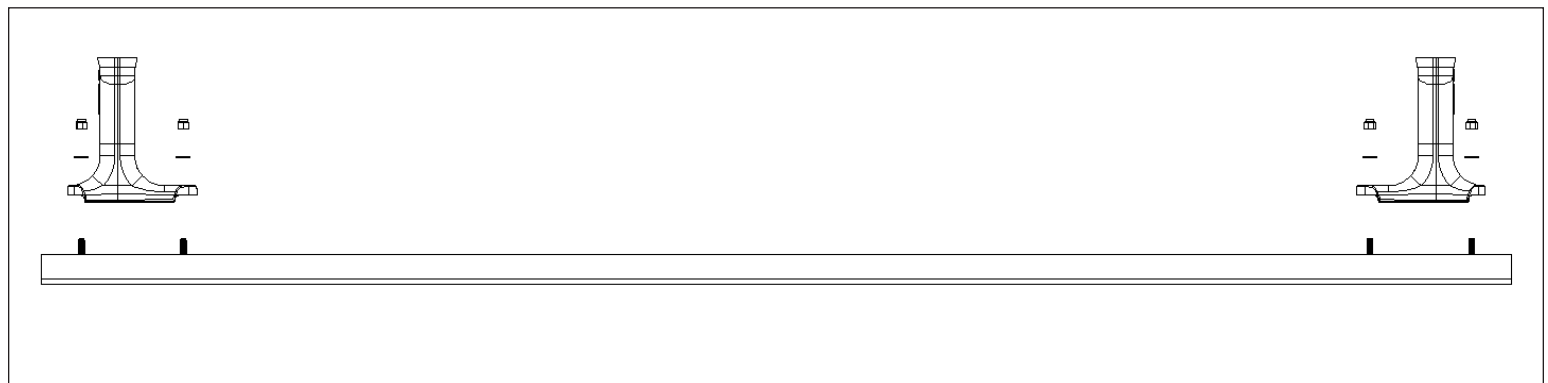

## RealTruck Elevate Base Rack

7. Start the Channel Guard (#9) at one end of the Crossbar (#2), once started you should be able to press the Channel Guard (#9) down the channel to the other End Plug (#3). Install Channel Guard (#9) into the t-slot channel of both Crossbars (#2). Cut off any excess Channel Guard (#9). If no accessories are installed, the Channel Guard (#9) can reduce wind noise.

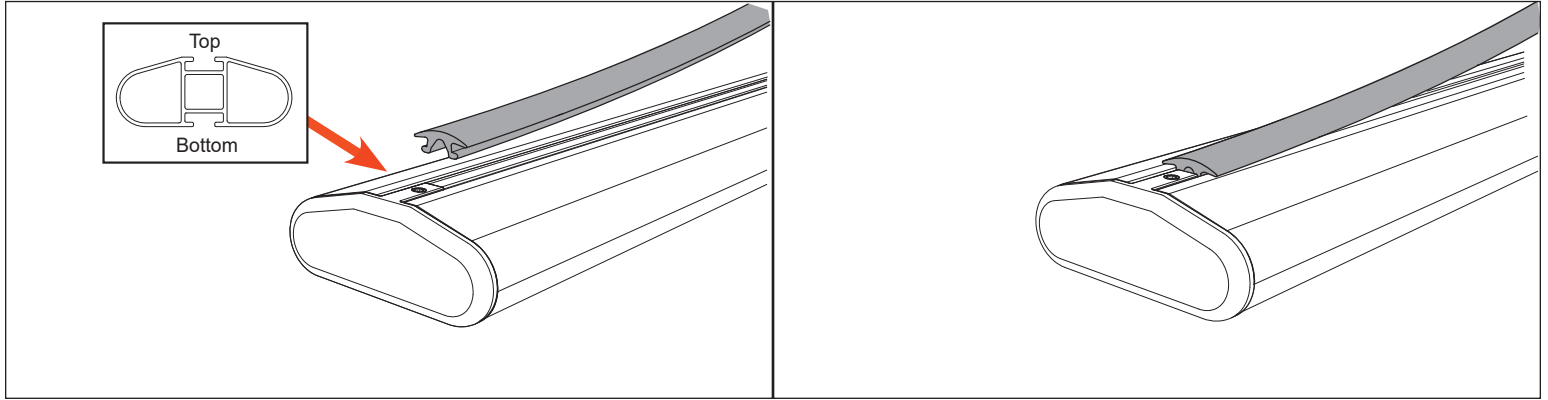

8. Once you have the Channel Guard (#9) installed into the Crossbar (#2), take the Crossbars (#2) and Upright Assemblies (#1) and latch them onto Tie Downs (#8).

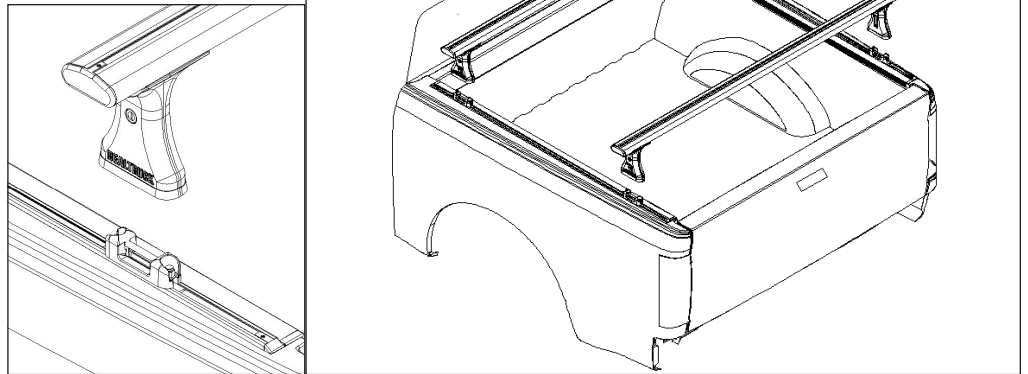

9. Once you have centered the Crossbars (#2) with the Upright Assemblies (#1), torque the Cap Nuts (#6) to secure the Crossbars (#2) to the Upright Assemblies (#1). Try to make sure the Crossbars (#2) move as little as possible left to right when securing the hardware. **Do not overtighten.**

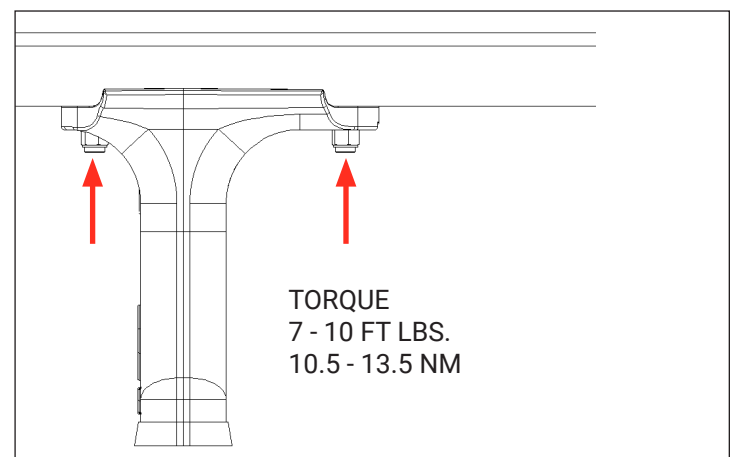

## RealTruck Elevate Base Rack

### SYSTEM GUIDELINES FOR REALTRUCK ELEVATE BASE RACK

Review all instructions, guidelines, and warranty information before installing or using RealTruck Elevate Base Rack

- Check state and local laws for compliance with oversized loads.
- Adapt speed and care of the vehicle to the load being carried.
- Be conscious of load weight, a high center of gravity is a rollover risk.
- All loads change the vehicle's driving behavior and responsiveness.
- Do not use RealTruck Elevate Base Rack for anything other than its intended purpose.
- Do not exceed the maximum load capacity (load capacity does change by terrain).
- Do not drive without the rails properly installed and fasteners torqued to specification.
- Know the overall height of every load. Be vigilant of low clearances.
- RealTruck Elevate Base Rack works with most inside mount truck bed covers.
- RealTruck Elevate Base Rack do NOT increase the load rating of the vehicle.

### REALTRUCK ELEVATE BASE RACK LOAD RATING

The RealTruck Elevate Base Rack is rated for 750 lbs. static weight capacity (max. load in a fixed or stationary position), 500 lbs. on-road weight capacity and 250 lbs. off-road weight capacity.

### WARRANTY

See [RealTruck.com](https://www.RealTruck.com) for warranty info.