



## INSTALLATION INSTRUCTIONS FOR MOUNTING

LUVERNE GRILL GUARDS WITH THE FOLLOWING MODEL NOS.:  
331510/331513 & 341510/341513 ON:

2015 AND NEWER CHEVROLET COLORADO  
2015 AND NEWER GMC CANYON

1. READ THE INSTRUCTIONS COMPLETELY AND CHECK TO MAKE SURE THAT ALL OF THE REQUIRED PARTS ARE ON HAND BEFORE STARTING THE INSTALLATION. THE CARTON SHOULD CONTAIN:
  - (1) OUTER RING PACKAGE
    - (1) OUTER RING ASSEMBLY
  - (1) UPRIGHT/BRACKET PACKAGE:
    - (1) ASSEMBLED UPRIGHT, LH
    - (1) ASSEMBLED UPRIGHT, RH
    - (1) MOUNTING BRACKET, LH
    - (1) MOUNTING BRACKET, RH
    - (1) MOUNTING BRACKET BRACE, LH
    - (1) MOUNTING BRACKET BRACE, RH
    - (1) FASTENER PACKAGE
    - (1) CUSTOMER SERVICE PACKAGE

### **REFER TO FIGS. 1, 2, 3 & 4 FOR GUARD ASSEMBLY INSTRUCTIONS 2-14**

2. ON THE LEFT SIDE OF THE VEHICLE, LOOSEN AND REMOVE THE THREE BOTTOM SCREWS THAT HOLD THE WHEEL WELL LINER TO THE VEHICLE. THIS WILL ALLOW EASIER ACCESS TO REMOVE AND INSTALL FASTENERS.
3. LOOSEN AND REMOVE THE BOLTS AND TOW HOOK FROM THE END OF THE FRAME.
4. INSTALL THE LEFT HAND MOUNTING BRACKET (ITEM #4) AND THE LEFT HAND MOUNTING BRACKET BRACE (ITEM #6) TO THE OUTSIDE OF THE FRAME RAIL. FASTEN WITH THE M12 X 1.75 X 90mm BOLTS (ITEM #14), M12 X 1.75 SERRATED FLANGE NUTS (ITEM #22) LEAVE LOOSE AT THIS TIME.
5. INSERT THE FRAME NUT (ITEM #23) INTO THE HOLE ON THE INSIDE OF THE FRAME AND FASTEN THE MOUNTING BRACKET BRACE (ITEM #6) TO THE SIDE OF THE FRAME WITH THE 1/2"-13 X 1-1/2" HEX BOLT (ITEM #15), 1/2" FLAT WASHER (ITEM #27) AND 1/2" LOCK WASHER (ITEM #24). MAKE SURE THAT RECESSED PORTION OF THE NUT SEATS IN THE OUTSIDE HOLE. LEAVE LOOSE AT THIS TIME.
6. INSTALL THE 1/2"-13 X 1-1/2" HEX HEAD CAP SCREW (ITEM #15) AND 1/2" SERRATED FLANGE NUT (ITEM #19) THAT FASTEN THE MOUNTING BRACKET BRACE TO THE MOUNTING BRACKET. LEAVE LOOSE AT THIS TIME.
7. REPEAT STEP #2 - #6 ON THE RIGHT SIDE.



(A LUVERNE Company)

1200 E. Birch St.

Brandon, SD 57005

202846 SHEET 1 OF 5 19MAY15

8. INSTALL THE UPRIGHTS (ITEM #2 & #3) TO THE MOUNTING BRACKETS (ITEM #4 & #5) WITH THE 1/2"-13 X 3" CARRIAGE BOLTS (ITEM #13), 1/2" SAE FLAT WASHER (ITEM #25) AND THE 1/2"-13 ACORN NUTS (ITEM #20).
9. LOWER THE RING ASSEMBLY (ITEM #1) DOWN BEHIND THE UPRIGHTS AND INSTALL IN THE SLOTS OF THE UPRIGHTS AS SHOWN IN FIG. 1 & 2. INSTALL THE 7/16"-14 X 1-1/4" HEX HEAD CAP SCREWS (ITEM #16) AND 7/16" FLAT WASHERS (ITEM #26). INTO THE 7/16"-14 CAPTIVE NUTS (ITEM #21) IN THE UPRIGHT MOUNTING PLATES. MAKE SURE THE UPRIGHTS ARE CENTERED AND PARALLEL WITH THE BARS IN THE RING AND TIGHTEN.
10. CHECK THAT THE GRILL GUARD IS CENTERED ON THE GRILLE AND THE REAR OF THE UPRIGHT CUTOUT IS APPROXIMATELY 1/4"-1/2" AWAY FROM THE FACE OF THE BUMPER.
11. TIGHTEN THE 1/2"-13 ACORN NUTS (ITEM #20) ON THE 1/2"-13 X 3" CARRIAGE BOLTS (ITEM #13), FASTENING THE MOUNTING BRACKETS TO UPRIGHTS.
12. TIGHTEN THE 1/2"-13 X 1-1/2" HORIZONTAL BOLTS (ITEM #15) THAT FASTEN THE MOUNTING BRACKET TO THE MOUNTING BRACKET BRACE AND THE 1/2"-13 X 1-1/2" BOLTS (ITEM #15), THAT FASTEN THE MOUNTING BRACKET BRACE TO THE FRAME AND THE M12 X 1.75 X 90mm BOLTS (ITEM #14) THAT FASTEN THE MOUNTING BRACKET AND MOUNTING BRACKET BRACE TO THE TOW HOOK BRACKET.
13. INSTALL THE UPRIGHT CAPS (ITEMS #11 & #12). FASTEN WITH THE 1/4"-20 X 3/8" BUTTON HEAD SCREWS (ITEM #18).
14. REINSTALL THE THREE WHEEL WELL LINER SCREWS.



(A LIVERNE Company)

1200 E. Birch St.

Brandon, SD 57005

202846 SHEET 2 OF 5 19MAY15

**SERVICE PARTS LIST**

ITEM	PART NO.	QTY	DESCRIPTION
1	202847	1	RING WELDMENT - CHROME
1	202853	1	RING WELDMENT - BLACK
2	202830	1	UPRIGHT WELDMENT - LH, CHROME
2	202851	1	UPRIGHT WELDMENT - LH, BLACK
3	202831	1	UPRIGHT WELDMENT - RH, CHROME
3	202852	1	UPRIGHT WELDMENT - RH, BLACK
4	202837	1	MOUNTING BRACKET - LH
5	202838	1	MOUNTING BRACKET - RH
6	202842	1	MOUNTING BRACKET BRACE - LH
7	202843	1	MOUNTING BRACKET BRACE - RH
8	202038	2	TAPPING BAR - 11.500"
9	202518	2	TAPPING BAR - 16.000"
10	107416	2	RUBBER EXTRUSION
11	102507	1	UPRIGHT END CAP - RH
12	102508	1	UPRIGHT END CAP - LH
13	107231	4	ROUND HEAD BOLT - 1/2"-13 X 3", SST
14	106928	4	HEX HEAD SCREW - M12 X 1.75 X 90mm, ZP
15	100088	4	HEX HEAD SCREW-1/2"-13 x 1-1/2", ZP
16	105939	4	HEX HEAD SCREW-7/16"-14 x 1-1/4", ZP
17	103715	10	SELF TAPPING SCREW - 1/4"-20 X 5/8"
18	105286	2	BUTTON HEAD SCREW - 1/4"-20 X 3/8"
19	100123	2	SERRATED FLANGE NUT - 1/2"-13
20	104994	4	ACORN NUT - 1/2"-13, SST
21	100083	4	NUT CAPTIVE - 7/16"-14, BLK
22	100794	4	SERRATED FLANGE NUT - M12 X 1.75
23	109871	2	MOUNTING BRACKET BRACE NUT - 1/2"-13
24	100121	2	LOCK WASHER - 1/2", ZP
25	104995	4	FLAT WASHER - SAE, 1/2", SST
26	103286	4	FLAT WASHER - 7/16", SST
27	100118	2	FLAT WASHER - 1/2", ZP
28	105293	4	TUBE PLUG - Ø1.25
29	105303	2	DECAL - MATTE BLACK, 1 X 10
30	100252	1	DECAL - LOGO, 1 X 3



(A LIVERNE Company)

1200 E. Birch St.

Brandon, SD 57005

202846 SHEET 5 OF 5 19MAY15

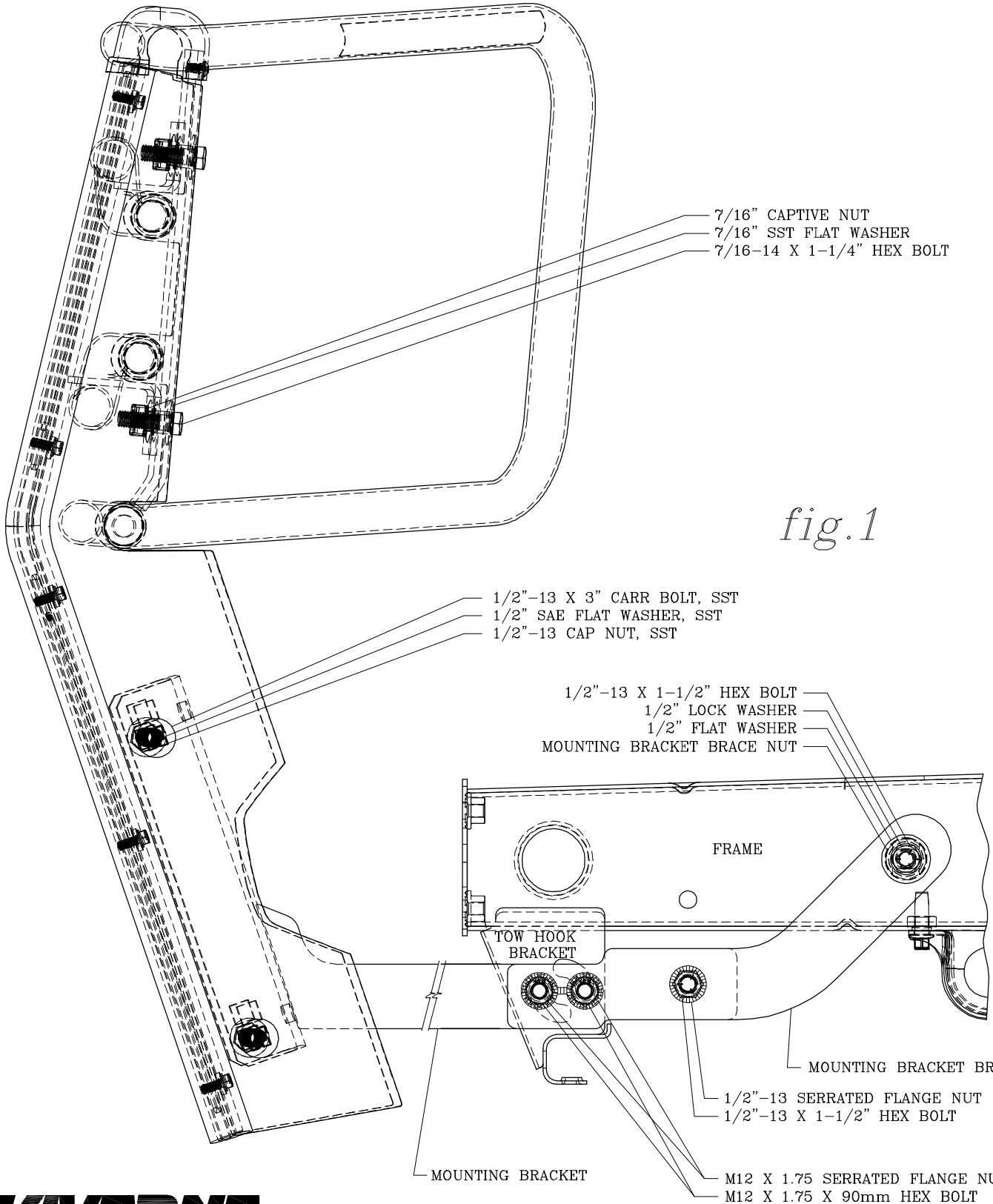

fig.1



(A LIVERNE Company)

1200 E. Birch St.

Brandon, SD 57005

SERVICE PARTS LIST

MODEL NO. - 331510/331513  
 MODEL NO. - 341510/341513

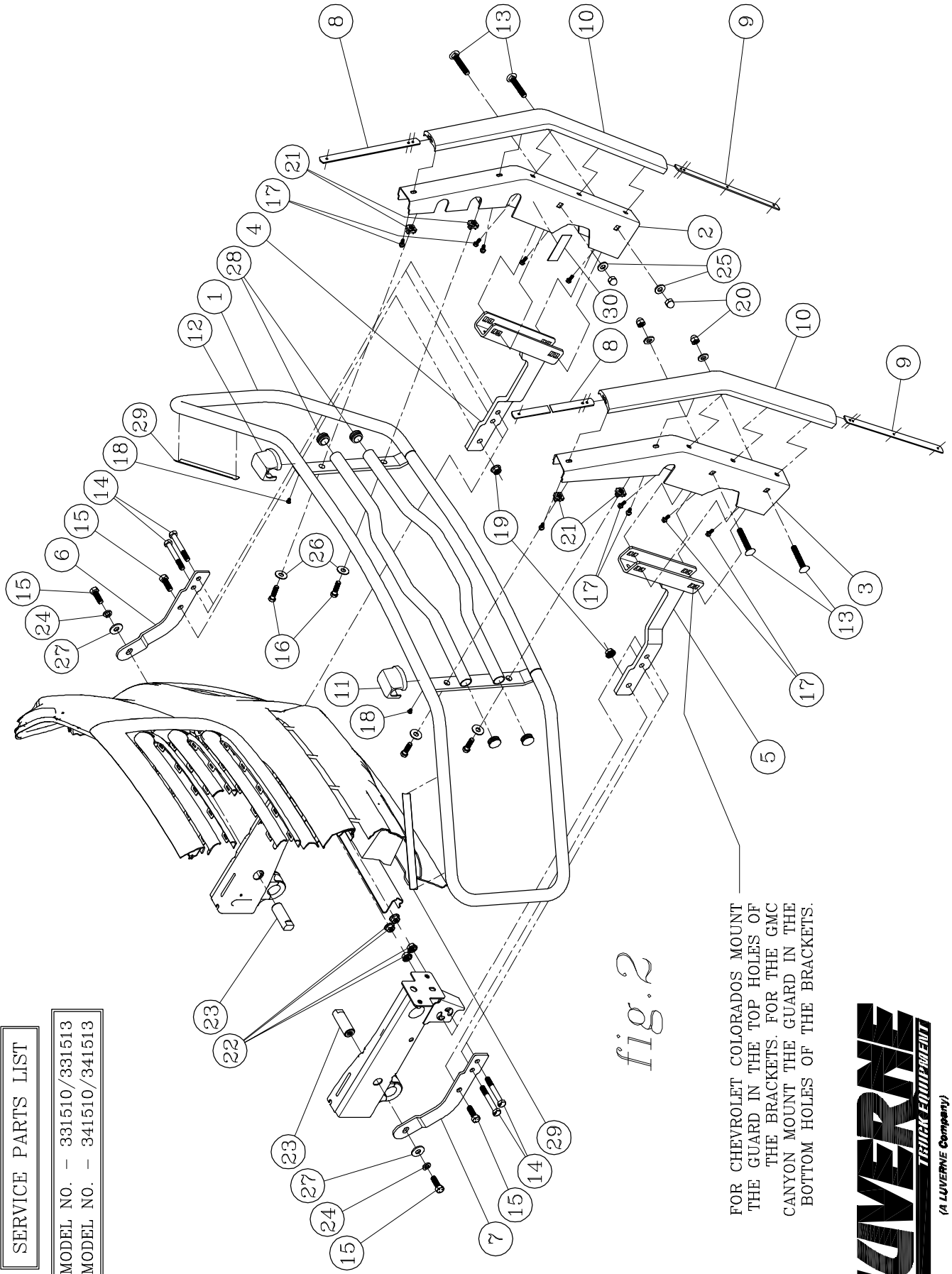

fig. 2

FOR CHEVROLET COLORADOS MOUNT  
 THE GUARD IN THE TOP HOLES OF  
 THE BRACKETS. FOR THE GMC  
 CANYON MOUNT THE GUARD IN THE  
 BOTTOM HOLES OF THE BRACKETS.

**LAVERNE**  
 (A LUYERNE Company)  
 TRUCK EQUIPMENT

1200 E. Birch St.

Brandon, SD 57005