



## INSTALLATION INSTRUCTIONS FOR MOUNTING

LUVERNE GRILL GUARD WITH THE FOLLOWING MODEL NO.:  
331332/202175 & 341332/202197 ON:  
2010 AND NEWER DODGE RAM 2500 & 3500

1. READ THE INSTRUCTIONS COMPLETELY AND CHECK TO MAKE SURE THAT ALL OF THE REQUIRED PARTS ARE ON HAND BEFORE STARTING THE INSTALLATION. THE INSTALLATION REQUIRES:

- (1) RING PACKAGE:
  - (1) CENTER RING ASSEMBLY
- (1) UPRIGHT/BRACKET PACKAGE:
  - (1) UPRIGHT ASSEMBLY, RH
  - (1) UPRIGHT ASSEMBLY, LH
  - (2) TOP MOUNTING BRACKETS
  - (1) BOTTOM MOUNTING BRACKETS, LH
  - (1) BOTTOM MOUNTING BRACKETS, RH
  - (2) UPRIGHT COVERS (**CHROME GUARDS ONLY**)
  - (1) HARDWARE PACKAGE
  - (1) CUSTOMER SERVICE PACKAGE

### **REFER TO SHEETS #1 - #6 FOR GUARD ASSEMBLY & INSTALLATION INSTRUCTIONS 2-12**

2. IF YOUR VEHICLE HAS FACTORY TOW HOOKS, REMOVE THEM. IF NOT PROCEED TO STEP #3.
3. INSTALL THE TOP MOUNTING BRACKETS (ITEM #4) TO THE PLATES ON THE END OF THE FRAME USING THE FOUR 3/8"-16 X 1-3/4" WASHER HEAD BOLTS (ITEM #13) AND THE FOUR 3/8"-16 FLANGE NUTS (ITEM #17). IF YOU HAVE TOW HOOKS, REINSTALL THEM AT THIS TIME AS SHOWN IN *Fig. 1*. HAND TIGHTEN ONLY AT THIS TIME.
4. UNDER AND BEHIND THE BUMPER, LOOSEN AND REMOVE THE LOWER INSIDE NUTS THAT HOLD THE BUMPER TO THE PLATES ATTACHED TO THE FRAME. (**DO NOT REMOVE THE NUTS FROM THE BOLTS FASTENING THE BUMPER TO THE FRAME, THE MOUNTING BRACKETS WILL REST AGAINST THE FACE OF THESE NUTS.**) INSTALL THE BRACKETS (ITEM #5 & #6) ON THE STUDS WHERE THE NUTS WERE REMOVED AND ON THE THREADED ENDS OF THE BOLTS MOUNTING THE BUMPER TO THE FRAME. INSTALL TWO M12 X 1.75 SERRATED FLANGE NUTS (ITEM #16) ON THE ENDS OF THE THREADED FRAME BOLTS AND ONE M12 X 1.75 SERRATED FLANGE NUTS (ITEM #16) ON THE BUMPER PLATE BOLTS. TIGHTEN TO 65 FT LBS.

**NOTE:** IF YOU HAVE A DIESEL ENGINE, 2010-2013 OR A GAS ENGINE 2013 THERE ARE NO HOLES IN THE LOWER FASCIA, SO THEY WILL HAVE TO BE DRILLED. IN THE CENTER OF THE DEPRESSED AREA OF THE LOWER PLASTIC AIR DAM, MARK OUT THE CENTERS OF TWO 1" DIAMETER HOLES 28-5/8" ON CENTER DOWN AT THE BOTTOM OF THE DEPRESSION. DRILL THROUGH THE AIR DAM WITH A 1" DIAMETER HOLE SAW. YOU CAN VERIFY THE LOCATION OF THE HOLES BEFORE DRILLING BY MOUNTING AN UPRIGHT ON THE TOP MOUNTING BRACKET AND CHECKING TO SEE THAT THE HOLE IN THE UPRIGHT PLATE LINES UP WITH THE HOLE IN THE FASCIA.



(A LUVERNE Company)

1200 E. Birch St.

Brandon, SD 57005

202641 SHEET 1 OF 4 09MAY13

5. SET THE UPRIGHT ASSEMBLIES (ITEM #2) AND (ITEM #3) ONTO THE UPPER MOUNTING BRACKETS SO THAT THE TOP MOUNTING BRACKET IS ON THE INSIDE OF THE UPRIGHT, INSTALL TWO 7/16"-14 X 1-1/4" STAINLESS HEX HEAD BOLTS (ITEM #12) INTO THE SIDE OF THE UPRIGHTS AND INTO THE TOP MOUNTING BRACKETS (ITEM #4) **NOTE: IF THE BOLTS DO NOT ALREADY HAVE THREADLOCKER IT IS RECOMMENDED THAT YOU USE SOME LOCTITE 242 OR 243 THREADLOCKER ON THESE FASTENERS).**
6. ON THE 1/2" X 6" BOLTS (ITEM #11), INSTALL A 1/2" FLAT WASHER (ITEM #19) AND INSERT IT THROUGH THE HOLES IN THE BOTTOM MOUNTING BRACKETS FROM THE BACK SIDE. INSTALL ANOTHER FLAT WASHER (ITEM #19) AND A 1/2"-13 FLANGE NUT (ITEM #15). INSTALL ANOTHER FLANGE NUT (ITEM #15) FACING FORWARD AND ANOTHER FLAT WASHER (ITEM #19). WITH THE END OF THE BOLT THROUGH THE LOWER MOUNTING PLATE IN THE UPRIGHT, INSTALL A FLAT WASHER (ITEM #19) AND A 1/2"-13 FLANGE NUT (ITEM #15). SEE *Fig. 1*.
7. INSTALL THE RING (ITEM #1) BY LOWERING IT DOWN FROM THE TOP AND BEHIND THE UPRIGHTS, TAKING CARE NOT TO SCRAPE THE ENDS OF THE RING AGAINST THE SIDE OF THE VEHICLE.) AND SLIDE THE RING INTO THE NOTCHES OF THE UPRIGHTS. FASTEN WITH THE UPRIGHT COVERS (**CHROME GUARDS ONLY**) (ITEM #10), 7/16"-14 X 1-1/4" HEX BOLTS (ITEM #12) AND 7/16" FLAT WASHERS (ITEM #20) INTO THE 7/16"-14 CAPTIVE NUTS (ITEM #18) IN THE UPRIGHT MOUNTING PLATES. FINGER TIGHTEN ONLY AT THIS TIME.
8. CHECK THAT THE GRILL GUARD IS CENTERED AND VERTICAL ON THE BUMPER AND THE UPRIGHTS ARE STRAIGHT UP AND DOWN WITH EQUAL GAP BETWEEN THE RING BAR AND THE INSIDE OF THE UPRIGHT. THEN TIGHTEN THE FOUR 7/16"-14 X 1-1/4" HEX BOLTS (ITEM #12), SECURING THE RING TO THE UPRIGHTS.
9. TIGHTEN THE EIGHT BOLTS (ITEM #13) SECURING THE TOP MOUNTING BRACKETS (ITEM #4) TO THE FRAME.
10. MAKING SURE THAT THE GRILLE GUARD IS STRAIGHT UP AND DOWN, TIGHTEN THE FOUR BOLTS (ITEM #12) SECURING THE UPRIGHTS TO THE TOP MOUNTING BRACKETS (ITEMS #4).
11. ADJUST THE TWO LOWER STUDS TO MAKE SURE THE GRILLE GUARD IS STRAIGHT UP AND DOWN AND TIGHTEN ALL OF THE FLANGE NUTS (ITEM #15).
12. INSTALL THE CHROME OR BLACK HOT TOPPERS (ITEM #22 OR #23) ON THE FOUR 7/16" STAINLESS STEEL HEX BOLTS (ITEM #12) THAT ATTACH THE UPRIGHTS TO THE TOP MOUNTING BRACKETS. THERE ARE SOME RARE OCCASIONS WHERE EVEN THOUGH THE NUT OR BOLT IS AN AMERICAN STANDARD FASTENER, THE HOT TOPPER® MAY NOT ACHIEVE A FRICTION FIT. IN THIS CASE WE RECOMMEND USING A NAPA CLEAR SILICONE (NAPA AUTO PART # 765-1481) TO ACHIEVE A SECURE FITMENT. **DO NOT USE ADHESIVE PRODUCTS TO MOUNT HOT TOPPERS®.** THE NAPA PRODUCT RECOMMENDED WILL ALLOW FOR AN EASIER REMOVAL IF SERVICE IS PERFORMED. SIMPLY FILL THE COVER WITH THE NECESSARY AMOUNT OF SILICONE TO ACHIEVE A FIRM HOLD ON THE FASTENER, YET BEWARE THAT THE SILICONE WILL EXPAND WHEN IT SETS UP, SO DON'T OVER FILL THE PART. A LITTLE LESS GOES A LONG WAY.



(A LUVERNE Company)

1200 E. Birch St.

Brandon, SD 57005

202641 SHEET 2 OF 4 09MAY13

**SERVICE PARTS LIST**

ITEM	PART NO.	QTY	DESCRIPTION
1	202171	1	RING WELDMENT - CHROME
1	202196	1	RING WELDMENT - BLACK
2	202483	1	UPRIGHT WELDMENT – CHROME, LH
2	202496	1	UPRIGHT WELDMENT – BLACK, LH
3	202484	1	UPRIGHT WELDMENT – CHROME, RH
3	202497	1	UPRIGHT WELDMENT – BLACK, RH
4	202187	2	MOUNTING BRACKET - TOP
5	202637	1	MOUNTING BRACKET – BOTTOM, LH
6	202638	1	MOUNTING BRACKET – BOTTOM, RH
7	201122	4	TAPPING BAR – 13.000”
8	202489	1	RUBBER EXTRUSION – MACHINED, LH, 34.000”
9	202490	1	RUBBER EXTRUSION – MACHINED, RH, 34.000”
10	202547	2	UPRIGHT COVERS ( <b>CHROME GUARDS ONLY</b> )
11	108566	2	HEX HEAD SCREW - 1/2”-13 X 6”, FT, ZP
12	105939	8	HEX HEAD SCREW – 7/16-14” X 1-1/4”, SST
13	107211	8	HEX WSHR HEAD SCREW – 3/8”-16 X 1-3/4”, BLK ZP
14	103715	12	SELF TAPPING SCREW – 1/4”-20 X 5/8”
15	100123	14	SERRATED FLANGE NUT – 1/2”-13 , ZP
16	100794	6	SERRATED FLANGE NUT – M12 X 1.75, ZP
17	100181	8	SERRATED FLANGE NUT – 3/8”-16 , ZP
18	100083	8	CAPTIVE NUT – 7/16”-14
19	100118	8	FLAT WASHER – 1/2”, ZP
20	103286	4	FLAT WASHER – 7/16”, SST
21	100252	1	DECAL – LOGO, 1 X 3
22	108562	4	HOT TOPPERS – HTD420 - CHROME
23	108563	4	HOT TOPPERS – HTB420 - BLACK



(A LUPERNE Company)

1200 E. Birch St.

Brandon, SD 57005

**SERVICE PARTS LIST**

MODEL NO. - 331332/202175  
 MODEL NO. - 341332/202197

REPLACE FACTORY  
 BUMPER NUTS  
 WITH ITEM #16

DO NOT REMOVE  
 THE FACTORY  
 BUMPER NUTS

28.625

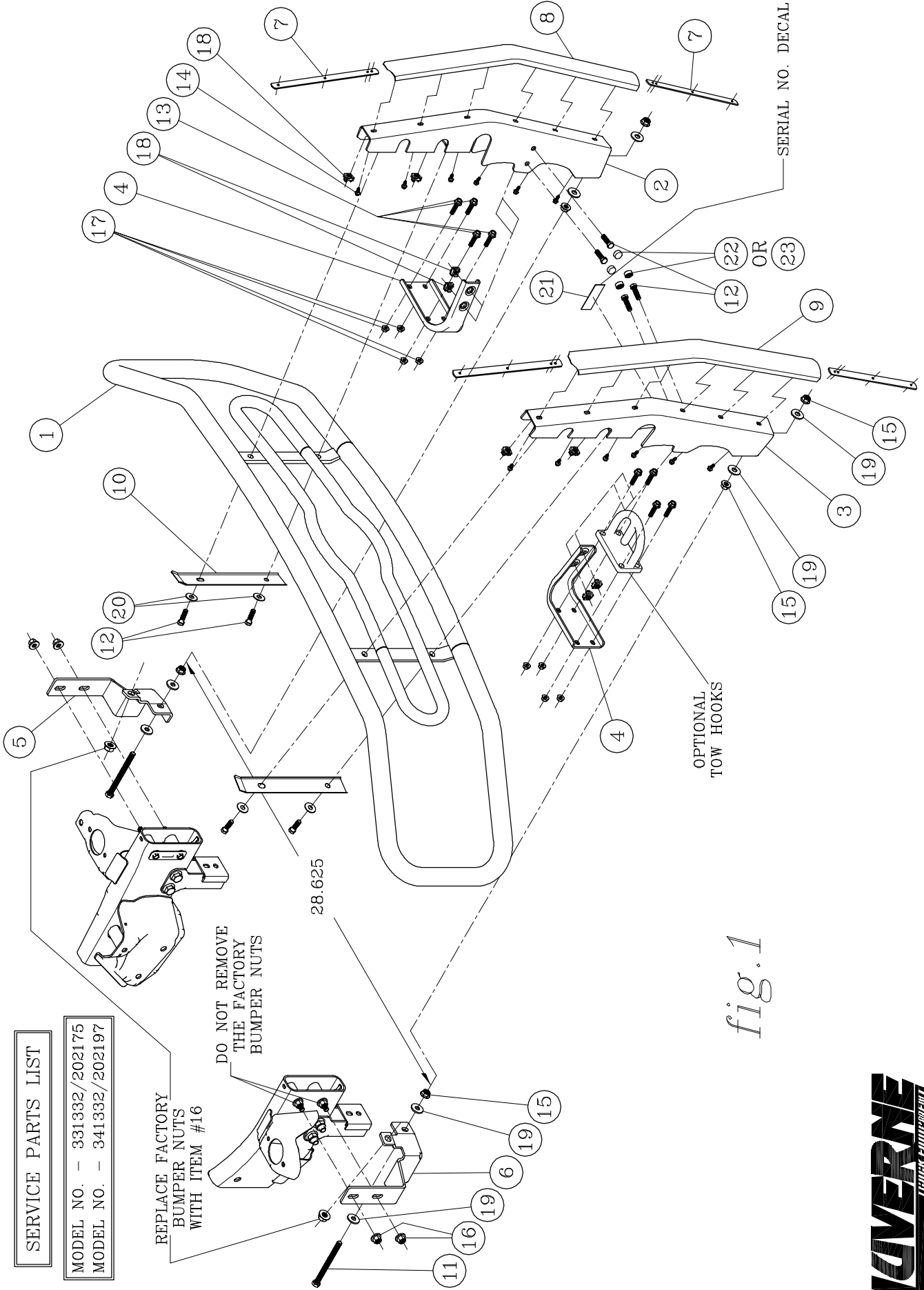

*fig.1*



1200 E. Birch St.  
 Brandon, SD 57005