



INSTALLATION INSTRUCTIONS

HAVOC HS2

NERF BAR WITH STEP

HPG-001047

2019-2023 FORD RANGER SUPERCREW

FRONT

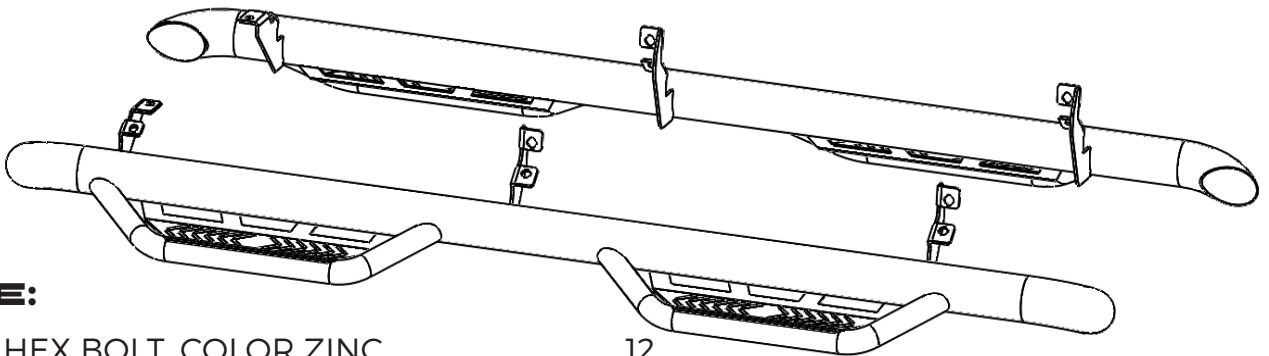

HARDWARE:

- M10-1.5 X 25MM HEX BOLT, COLOR ZINC.....12
- M10 X 25MM OD FLAT WASHER, COLOR ZINC.....12
- M10 SPLIT LOCK WASHER, COLOR ZINC.....12

STEP 1:

VERIFY YOU HAVE RECEIVED ALL PARTS TO YOUR STEPS. STARTING ON THE DRIVER SIDE LOCATE THE MOUNTING LOCATIONS UNDERNEATH THE TRUCK ON THE INSIDE ROCKER PANEL. YOU WILL NEED TO REMOVE THE BLACK PLASTIC PLUGS COVERING THE M10 THREADED INSERTS.

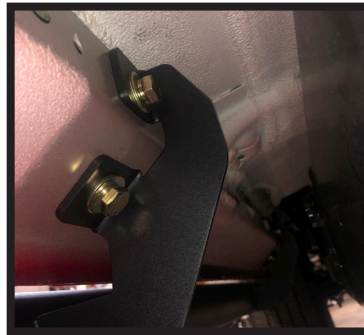

STEP 2:

IT IS ALWAYS RECOMMENDED TO USE A HELPER WHEN LIFTING BARS INTO PLACE. IF INSTALLING BY YOURSELF, START AT THE MIDDLE BRACKET. INSTALL M10-1.5 X 25MM HEX BOLTS, M10 X 25MM OD FLAT WASHERS & M10 X 25MM OD FLAT WASHERS THROUGH THE SLOTS OF THE UPPER & LOWER FLANGES OF THE BRACKET INTO THE THREADED LOCATIONS ON THE TRUCK. **DO NOT FULLY TIGHTEN AT THIS TIME.**

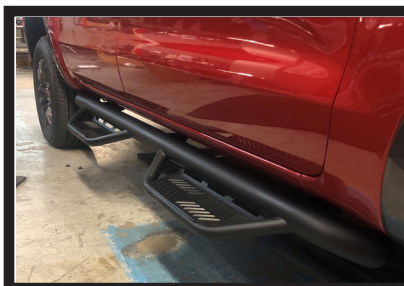
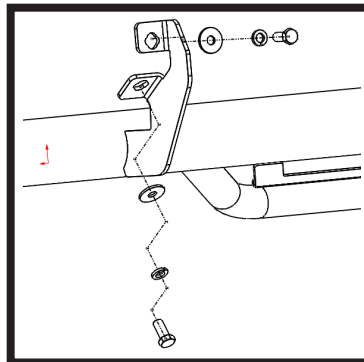
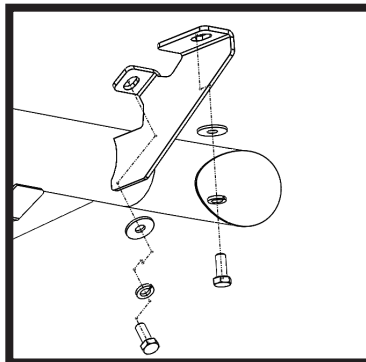

STEP 3:

REPEAT STEP 2 FOR THE 1ST AND 3RD BRACKET. ONCE YOU HAVE INSTALLED ALL THE HARDWARE, STARTING AT THE MIDDLE, FULLY TIGHTEN ALL HARDWARE TO APPROX. 20 FT LBS.

STEP 4:

REPEAT STEPS 2 THROUGH 3 ON THE OTHER SIDE OF THE VEHICLE. **REMEMBER DO NOT FULLY TIGHTEN HARDWARE** UNTIL YOU HAVE INSTALLED ALL THE HARDWARE IN ALL 3 BRACKETS. ONCE ALL THE HARDWARE HAS BEEN INSTALLED, FULLY TIGHTEN ALL HARDWARE TO 20 FT LBS.

STEP 5:

DOUBLE CHECK THAT ALL HARDWARE HAS BEEN FULLY TIGHTENED ON BOTH SIDES OF TRUCK. IF AT ANY TIME DURING THE INSTALLATION YOU HAVE ANY QUESTIONS OR CONCERNS. PLEASE CALL OR EMAIL US AT THE INFORMATION LISTED BELOW. ENJOY YOUR NEW HAVOC HS2 NERF STEPS.