

## ROAD DEFENDER SERIES

### GRILLE GUARD ASSEMBLY INSTRUCTIONS

PART NO. 5160 2007-2014 CHEVY 1500 AVALANCHE, TAHOE & SUBURBAN 2/4WD

Do not attempt to install this product on any vehicle other than the one it is designed for and listed above!

#### PARTS LIST

<u>QTY</u>	<u>PART DESCRIPTION</u>	<u>QTY</u>	<u>PART DESCRIPTION</u>
10	3/8" X 1 1/4" HEX BOLT	2	516030 SIDE PLATE
10	3/8" LOCK WASHER	1	ST3006 3" X 35 3/4" BOTTOM STEP TUBE
4	3/8" HEX NUT	1	TT5160 2" X 35 3/4" TOP TUBE
4	3/8" FLAT WASHER	1	CP5160 35 3/4" CENTER PLATE

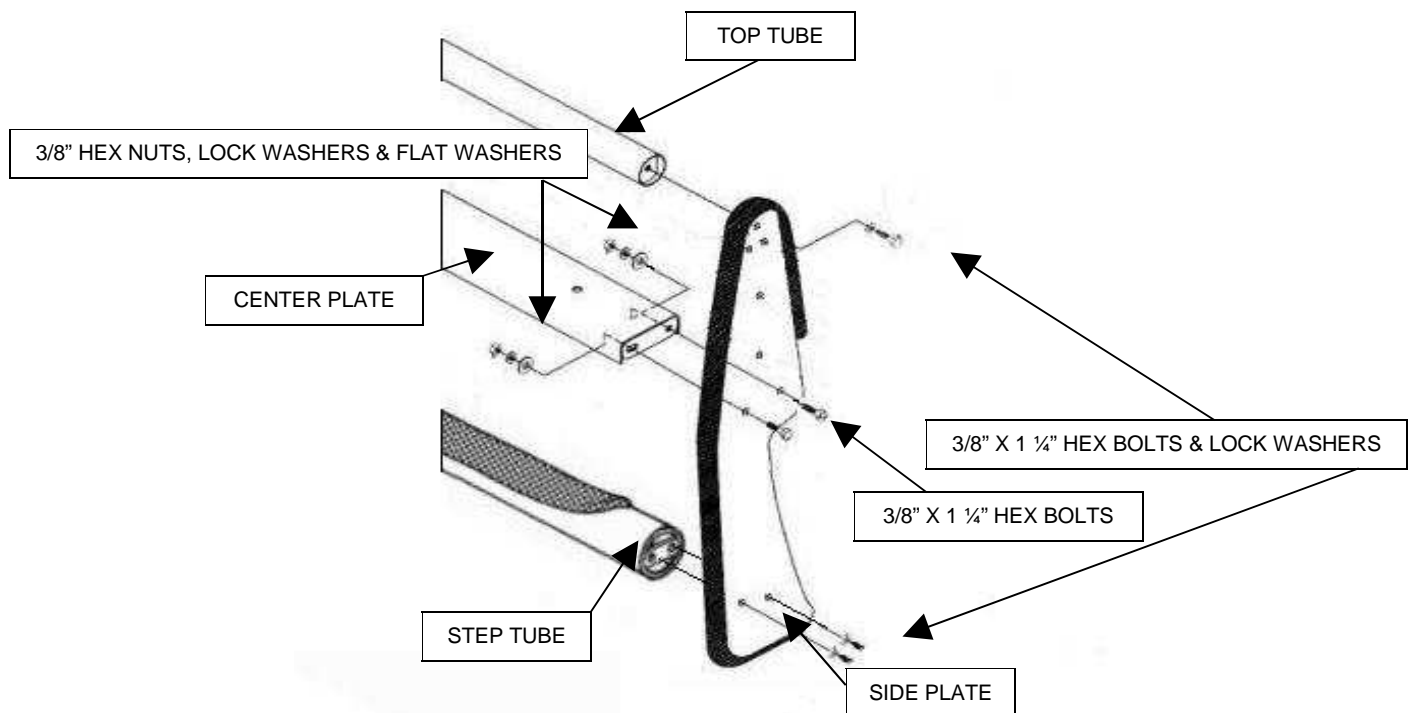

#### ASSEMBLY INSTRUCTIONS

##### READ THE ASSEMBLY INSTRUCTIONS COMPLETELY BEFORE YOU BEGIN

**STEP 1:** BEGIN THE GRILLE GUARD ASSEMBLY BY LAYING THE COMPONENTS OUT ON A PROTECTIVE SURFACE.

**STEP 2:** POSITION THE GRILLE GUARD SIDE PLATES WITH THE FRONT EDGE DOWN AND THE TOP TUBE AND BOTTOM STEP TUBE BETWEEN THE SIDE PLATES. NOTE: THERE ARE TWO TABS WELDED OFF CENTER ON THE TOP TUBE. POSITION THE TOP TUBE BETWEEN THE SIDE PLATES WITH THE TABS OFF CENTER TO THE PASSENGER SIDE OF THE VEHICLE.

**STEP 3:** ATTACH THE TOP TUBE TO THE SIDE PLATES USING (2) 3/8" X 1 1/4" HEX BOLTS AND (2) LOCK WASHERS. DO NOT TIGHTEN.

**STEP 4:** ATTACH THE BOTTOM STEP TUBE TO THE SIDE PLATES USING (4) 3/8" X 1 1/4" HEX BOLTS AND (4) LOCK WASHERS. DO NOT TIGHTEN.

**STEP 5:** POSITION THE CENTER PLATE BETWEEN THE GRILLE GUARD SIDE PLATES, WITH THE **SLOTTED HOLES** IN THE CENTER PLATE DOWN. ATTACH THE CENTER PLATE TO THE SIDE PLATES USING (4) 3/8" X 1 1/4" HEX BOLTS, (4) FLAT WASHERS, (4) LOCK WASHERS AND (4) HEX NUTS. DO NOT TIGHTEN.

**STEP 6:** ALIGN THE GRILLE GUARD ASSEMBLY, AND TIGHTEN ONLY THE CENTER PLATE AND STEP TUBE NUTS AND BOLTS.

## ROAD DEFENDER SERIES

### GRILLE GUARD INSTALLATION INSTRUCTIONS

PART NO. 5160 2007-2010 CHEVY 1500 AVALANCHE, TAHOE & SUBURBAN 2/4WD

Do not attempt to install this product on any vehicle other than the one it is designed for and listed above!

### PARTS LIST

<u>QTY</u>	<u>PART DESCRIPTION</u>	<u>QTY</u>	<u>PART DESCRIPTION</u>
6	1/4" X 3/4" HEX BOLT	12	1/2" HEX NUT
6	1/4" FLAT WASHER	12	1/2" LOCK WASHER
6	1/4" HEX NUT	2	1602 LOWER BRACKET
2	5/16" X 1" BUTTON HEAD BOLT	2	1604 LOWER BRACKET
2	5/16" FLAT WASHER	1	16031 DRIVER UPPER BRACKET
2	5/16" LOCK NUT	1	16032 PASSENGER UPPER BRACKET
12	1/2" X 1 1/2" HEX BOLT	2	1122LP LICENSE PLATE BRACKET
24	1/2" FLAT WASHER		

### INSTALLATION INSTRUCTIONS

**READ THE INSTALLATION INSTRUCTIONS COMPLETELY BEFORE YOU BEGIN.**

**STEP 1:** BEGINNING WITH THE **DRIVER SIDE** REMOVE THE (4) SCREWS AND 5M HEX BOLT SECURING THE SPLASH SHIELD. **PHOTO #1**

**STEP 2:** LOCATE AND REMOVE THE PLASTIC TOW HOOK COVER FROM THE LOWER BUMPER FASCIA. **PHOTO #2**

REPEAT THE ABOVE STEPS FOR THE PASSENGER SIDE.

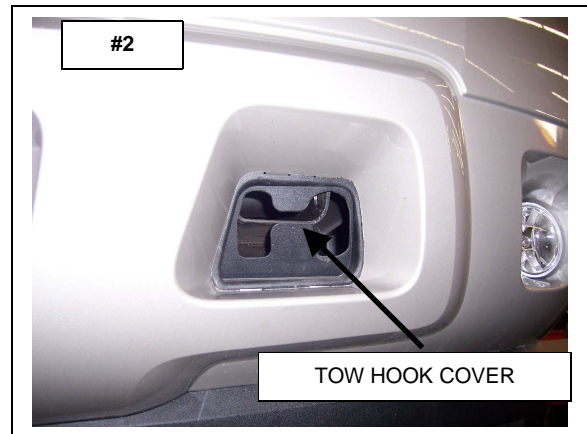
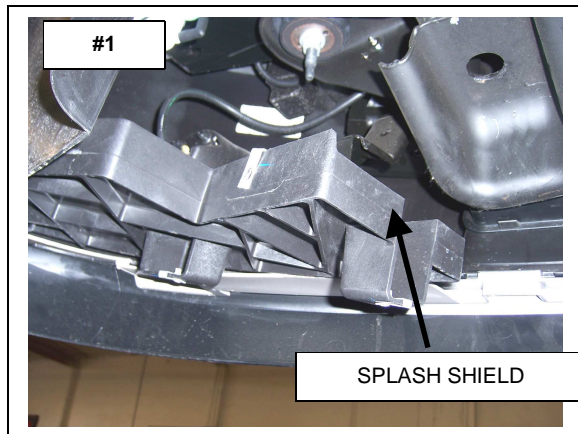

**STEP 3:** LOCATE THE TWO HOLES IN THE LEFT SIDE OF THE **DRIVER SIDE** FRAME RAIL. POSITION ONE OF THE 1602 LOWER MOUNTING BRACKETS UP TO THE FRAME, AND ATTACH THE BRACKET TO THE FRAME USING (2) ½" X 1 ½" HEX BOLTS, (4) FLAT WASHERS, (2) LOCK WASHERS AND (2) HEX NUTS. DO NOT TIGHTEN. **PHOTO #3**

**STEP 4:** LOCATE THE SINGLE HOLE IN THE RIGHT SIDE OF THE **DRIVER SIDE** FRAME RAIL. POSITION ONE OF THE 1604 LOWER MOUNTING BRACKETS UP TO THE FRAME, AND ATTACH THE BRACKET TO THE FRAME AND TO THE 1602 BRACKET USING (2) ½" X 1 ½" HEX BOLTS, (4) FLAT WASHERS, (2) LOCK WASHERS AND (2) HEX NUTS. DO NOT TIGHTEN. **PHOTO #4**

**STEP 5:** LOCATE THE SINGLE HOLE IN THE RIGHT SIDE OF THE **PASSENGER SIDE** FRAME RAIL. POSITION THE REMAINING 1602 LOWER MOUNTING BRACKET UP TO THE FRAME, AND ATTACH THE BRACKET TO THE FRAME USING (1) ½" X 1 ½" HEX BOLT, (2) FLAT WASHERS, (1) LOCK WASHER AND (1) HEX NUT. DO NOT TIGHTEN.

**STEP 6:** LOCATE THE TWO HOLES IN THE LEFT SIDE OF THE **PASSENGER SIDE** FRAME RAIL. POSITION THE REMAINING 1604 LOWER MOUNTING BRACKET UP TO THE FRAME, AND ATTACH THE BRACKET TO THE FRAME AND TO THE 1602 BRACKET USING (3) ½" X 1 ½" HEX BOLTS, (6) FLAT WASHERS, (3) LOCK WASHERS AND (3) HEX NUTS. DO NOT TIGHTEN.

**NOTE: IF YOUR VEHICLE IS EQUIPPED WITH FACTORY TOW HOOKS, ATTACH THE LOWER BRACKETS TO THE FRAME USING THE TOW HOOKS AND TOW HOOK FASTENERS.**

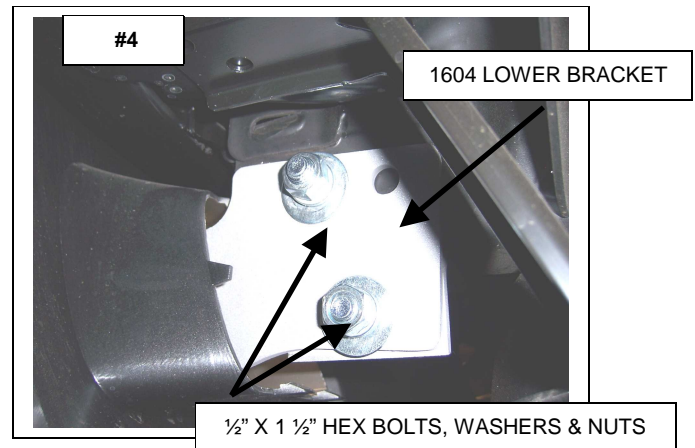
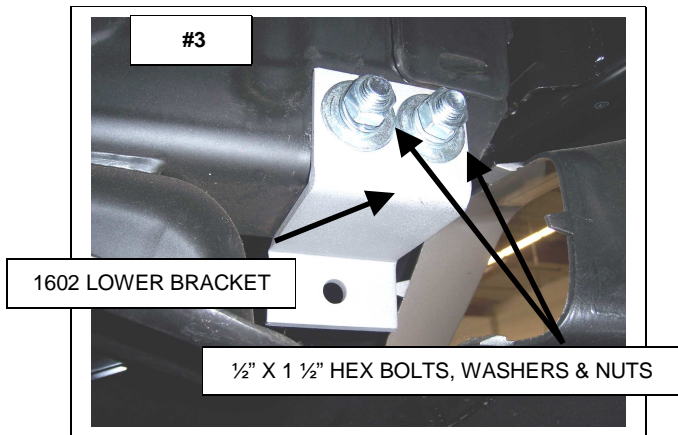

**STEP 7:** ATTACH THE GRILLE GUARD ASSEMBLY TO THE OUTSIDE OF THE LOWER MOUNTING BRACKETS USING (4) 1/2" X 1 1/2" HEX BOLTS, (8) FLAT WASHERS, (4) LOCK WASHERS AND (4) HEX NUTS. DO NOT TIGHTEN. **PHOTO #5**

**STEP 8:** OPEN THE HOOD, LOCATE AND REMOVE THE (2) 5M HEX BOLTS SECURING THE RADIATOR SHROUD. **PHOTO #6**

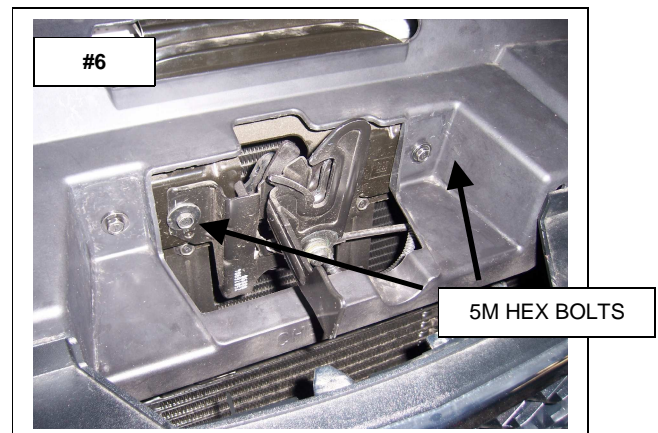
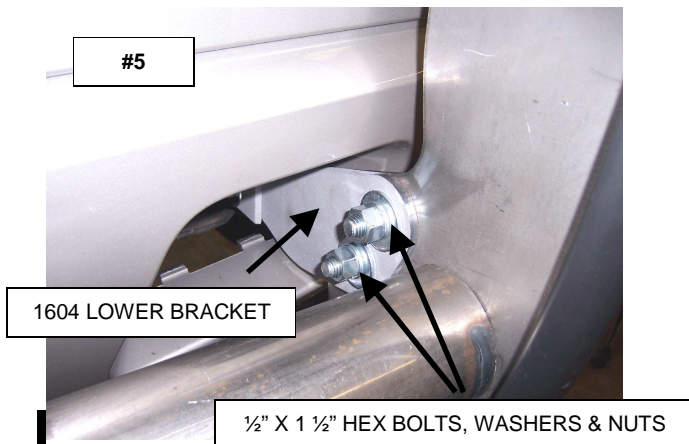

**STEP 9:** ATTACH THE UPPER BRACKETS TO THE RADIATOR SHROUD USING THE (2) FACTORY 5M HEX BOLTS AND TO THE GRILLE GUARD TOP TUBE USING (2) 5/16" X 1" BUTTON HEAD BOLTS, (2) FLAT WASHERS AND (2) LOCK NUTS. DO NOT TIGHTEN. **PHOTO #7**

**STEP 10:** TIGHTEN THE TOP TUBE AND ALL MOUNTING BRACKET NUTS AND BOLTS. REATTACH THE FASCIA AND SPLASH SHIELDS.

IF YOU'RE STATE LAW REQUIRES A FRONT LICENSE PLATE, ATTACH THE 1122LP BRACKETS, AND LICENSE PLATE TO THE GRILLE GUARD CENTER PLATE USING THE 1/4" HEX BOLTS, WASHERS AND NUTS SUPPLIED. **PHOTO #8**

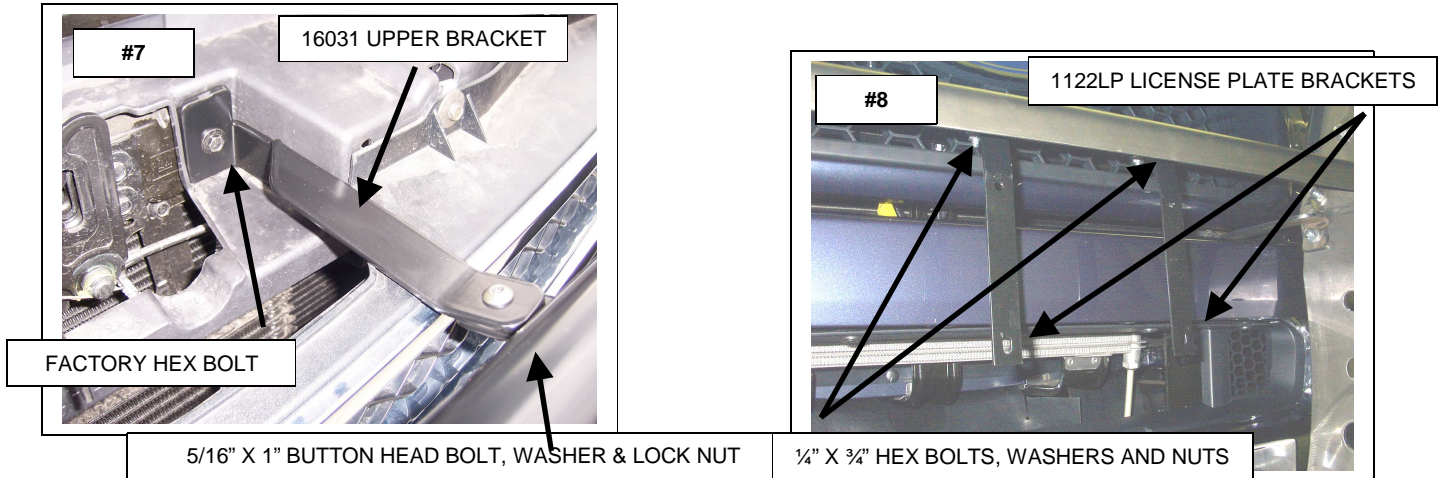

**FOR TECHNICAL OR WARRANTY INFORMATION CALL:  
TOLL FREE (888) 427-4466 FAX (714) 672-0278  
GO RHINO! Products® 591 W. Apollo St. Brea, CA 92821**