

# Rear Bumper with Tire Carrier, JL

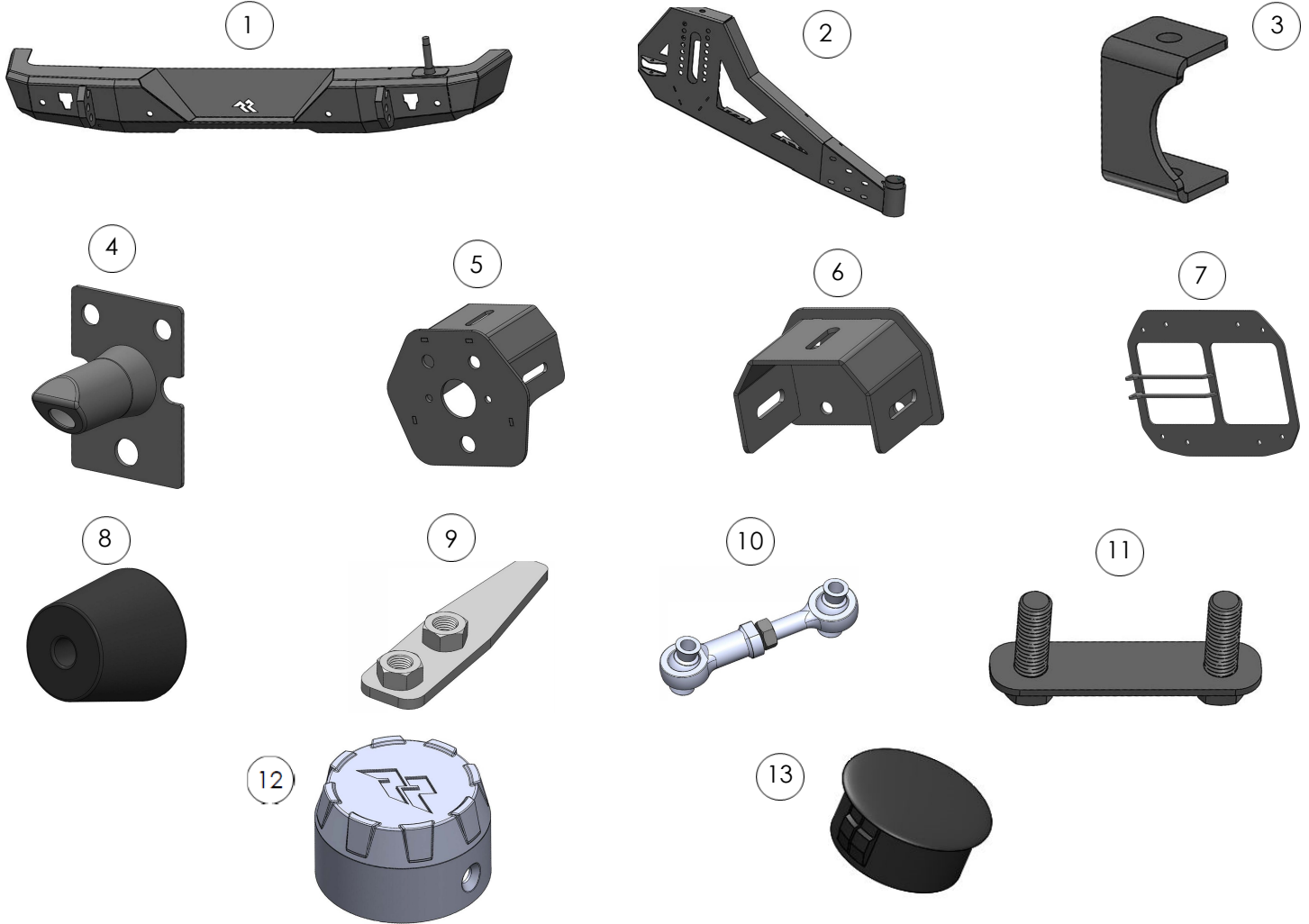

## Components

- |  |   |
|--|---|
| 1. Bumper with Spindle.....(1)             | 8. Rubber Bumper.....(2)                          |
| 2. Carrier Assembly.....(1)                | 9. Pass Side Nut Plate.....(1)                    |
| 3. Back Up Sensor Retainer.....(4)         | 10. M10 Rod End Kit.....(1)                       |
| 4. Camera Cover.....(1)                    | 11. Wheel Bracket Side Carrier Bolt Plate.....(2) |
| 5. Wheel Stud Base Plate.....(1)           | 12. Spindle Cap.....(1)                           |
| 6. Carrier Side Base Plate Bracket.....(1) | 13. Plastic Sensor Plug.....(2)                   |
| 7. Tailgate Plate.....(1)                  |   |

**OMIX-ADA® TECHNICAL SUPPORT**

PHONE: M-F 8am - 5pm EST 1-800-449-6649 | EMAIL: techsupport@omix-ada.com

FOR WARRANTY INFORMATION VISIT: [www.Omix-Ada.com](http://www.Omix-Ada.com)

# Rear Bumper with Tire Carrier, JL

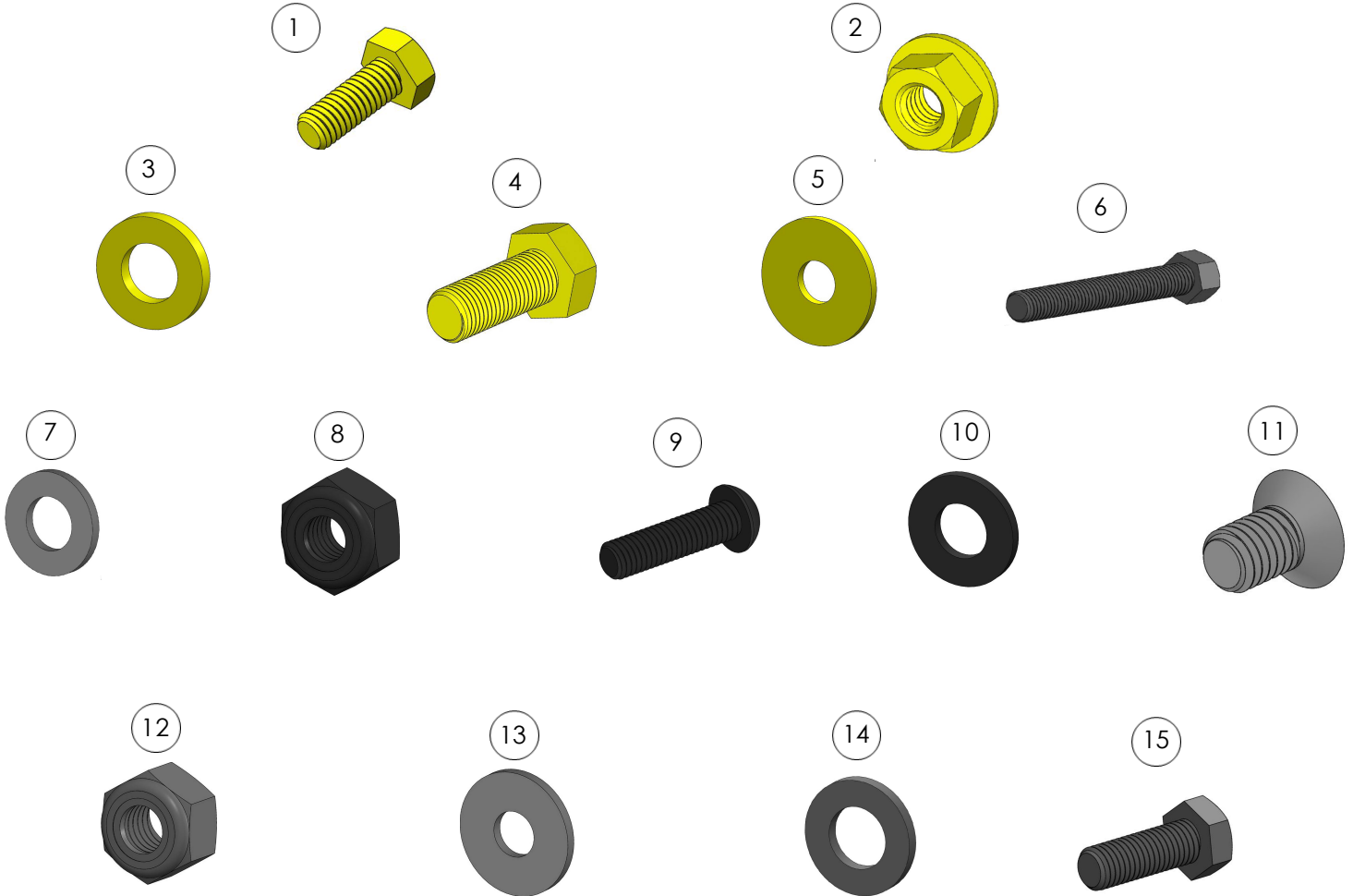

## Components

- |                                      |                                       |
|--------------------------------------|---------------------------------------|
| 1. M6-1x16mm Bolt.....(8)            | 9. M8x30.1.25mm Button Head.....(8)   |
| 2. M6-1 Serrated Flange Nut.....(8)  | 10. M8 Flat Washer.....(6)            |
| 3. M6 Flat Washer.....(8)            | 11. M6x8mm Spindle Set Screw.....(1)  |
| 4. M14-1.5x35 Bolt.....(8)           | 12. M12 Nylock Nut.....(7)            |
| 5. M14 OD Flat Washer.....(8)        | 13. M12 Flat Washer.....(4)           |
| 6. M10x60x1.25 Hex Head Bolt.....(2) | 14. M12 OD Flat Washer.....(6)        |
| 7. M10 Flat Washer.....(4)           | 15. M12x35x1.75 Hex Head Bolt.....(3) |
| 8. M10 Nylock Nut.....(2)            |                                       |

**OMIX-ADA® TECHNICAL SUPPORT**

PHONE: M-F 8am - 5pm EST 1-800-449-6649 | EMAIL: techsupport@omix-ada.com

FOR WARRANTY INFORMATION VISIT: [www.Omix-Ada.com](http://www.Omix-Ada.com)



OMIX-ADA, Inc.

460 HORIZON DR. SUITE 400 | SUWANEE, GA 30024 | PHONE: 770-614-6101 | FAX: 770-614-6069 | info@omix-ada.com

## Rear Bumper with Tire Carrier, JL

1. Remove spare tire from the tailgate. Unplug the rear sensor and tag light harness from underneath the vehicle. Remove the two wire loom retainers attached to the vehicle. Remove factory hardware holding the bumper on the vehicle. With assistance, lift bumper up and away from the vehicle. The two bumper brackets will need to be removed from the frame. Remove the rear sensors from the OE bumper if equipped.

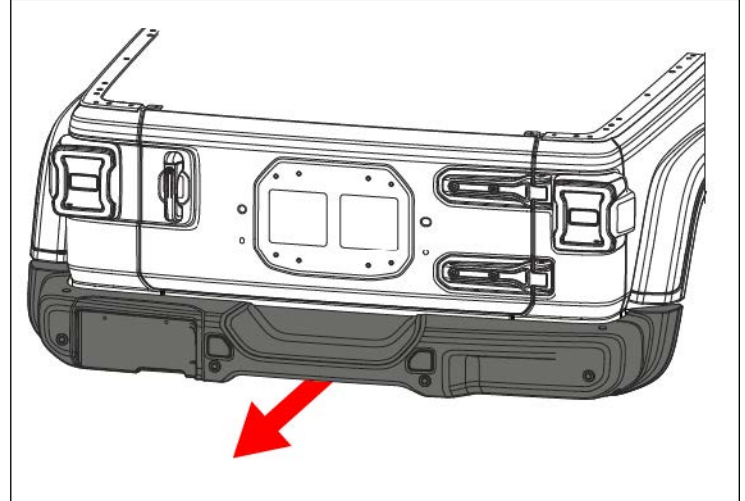

2. Using T25 Torx drive, remove two screws securing the lug stud assembly to the factory tire carrier. Remove the lug stud assembly, including backup camera, and set aside for later use.

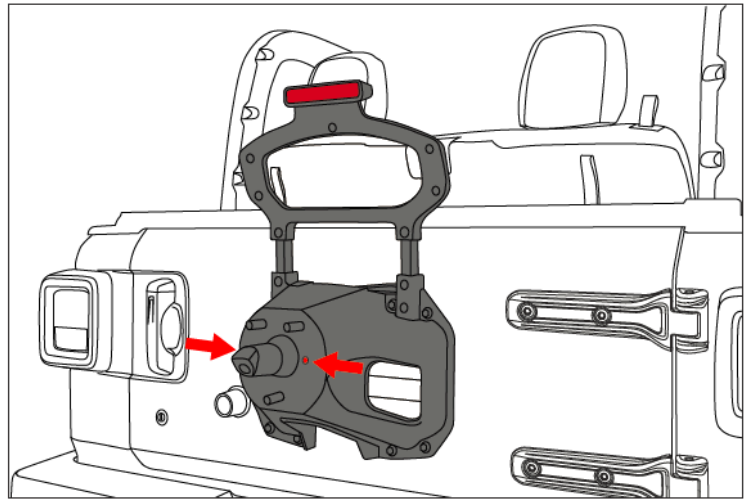

3. Using 13mm socket, remove eight factory bolts securing the spare tire mount. Remove wires for the third brake light and backup camera.

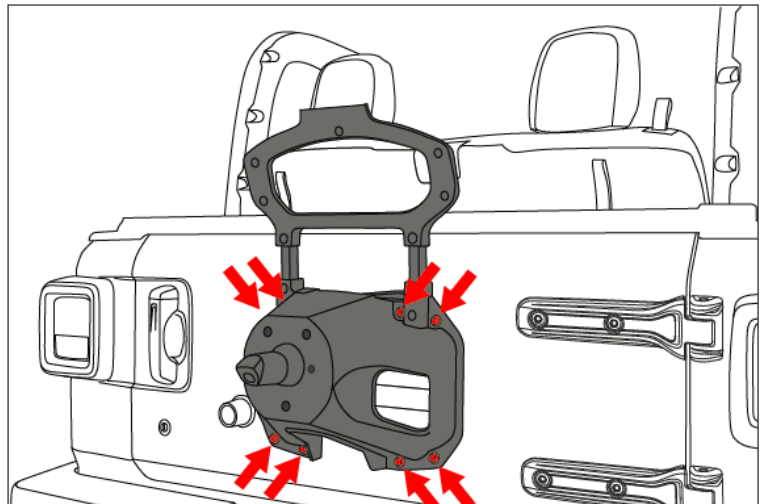



OMIX-ADA, Inc.

460 HORIZON DR. SUITE 400 | SUWANEE, GA 30024 | PHONE: 770-614-6101 | FAX: 770-614-6069 | info@omix-ada.com

# Rear Bumper with Tire Carrier, JL

4. Pre-install the rear backup sensors to the HD Rear Bumper if equipped. (The OE inner and outer rings will not be used in the HD bumper) With the sensor locked into the grooves of the bumper place the rear bracket against the back of the sensor. Use the M6 hardware to mount the bracket. Repeat for all if applicable. Route the wire harness so it won't be pinched during installation. If vehicle not equipped with backup sensors, install supplied plastic sensor plug.



Plastic Sensor Plug

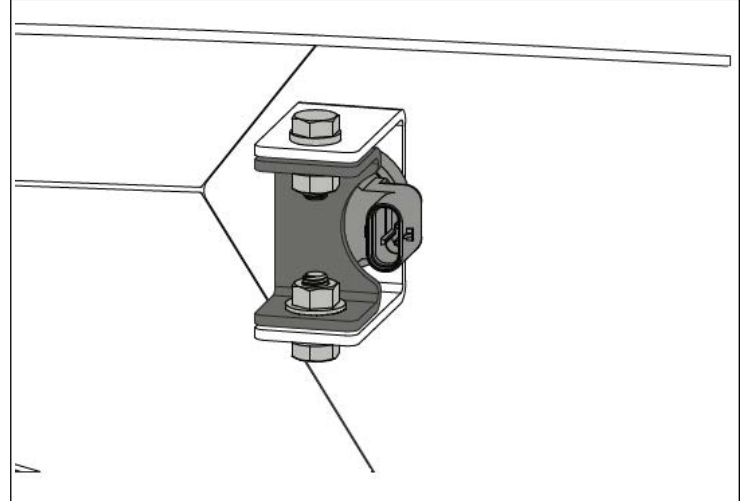

5. Install the passenger side nut plate into the passenger side frame rail. (Clean any dirt and debris) Make sure the nut plate sits flat and threaded nuts are accessible through the holes underneath the frame.

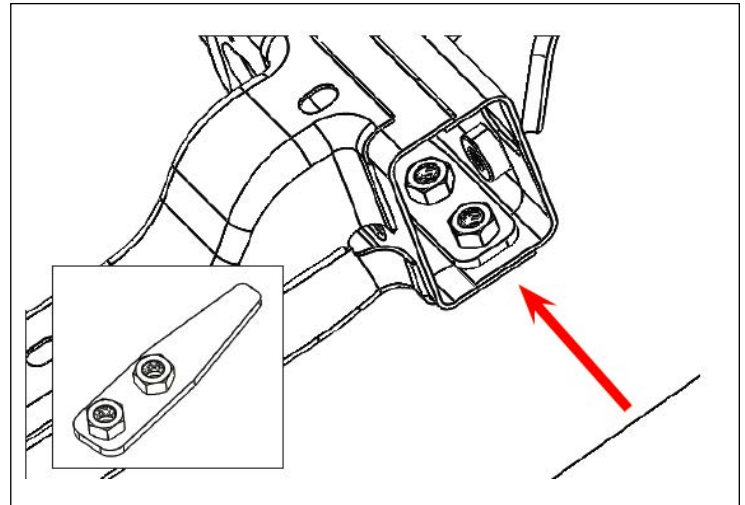

6. It's recommended to place painter's tape to the lower corners of the body to avoid damage to the paint during installation. With assistance, lift and place the bumper to the frame rails. Thread M14 bolt and washer into the side of the frame rails.

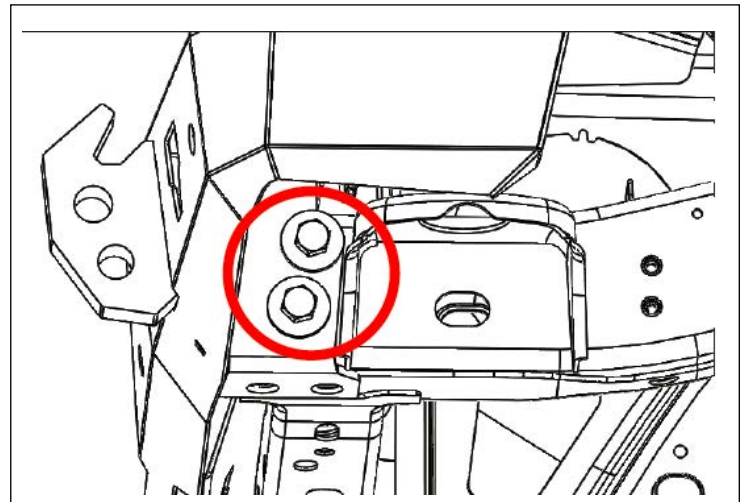
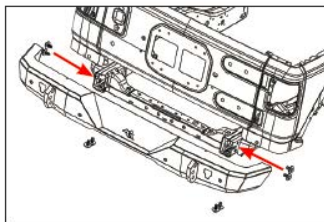



OMIX-ADA, Inc.

460 HORIZON DR. SUITE 400 | SUWANEE, GA 30024 | PHONE: 770-614-6101 | FAX: 770-614-6069 | info@omix-ada.com

## Rear Bumper with Tire Carrier, JL

7. Install M14 bolt and washer to the underside of the frame rails. May require moving the nut plate to assure proper alignment. Adjust the bumper level to the body of the vehicle. Once in the desired position tighten all hardware (4 bottom frame bolts and 4 side frame bolts) in an alternating pattern. Avoid using power or air tools. Tighten to 60ft-lbs torque to secure the bumper to the vehicle.

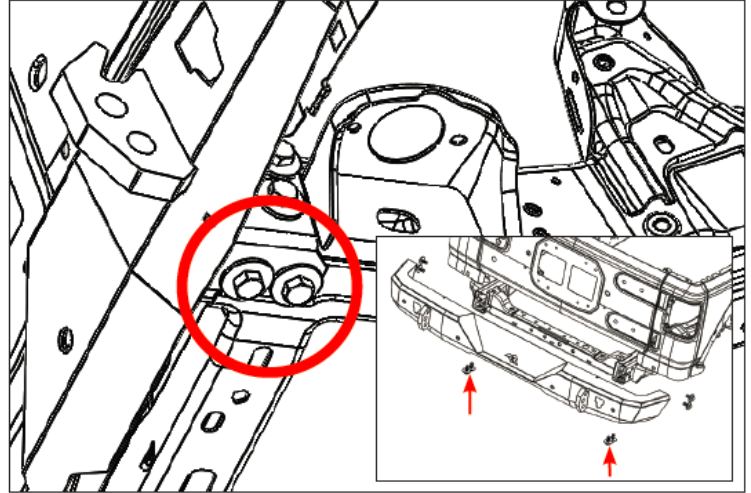

8. If applicable, plug backup sensor wiring harness together. Assure none of the wires are pinched or excessively tight. Use zip ties to secure low hanging or loose wires to the bumper and vehicle.

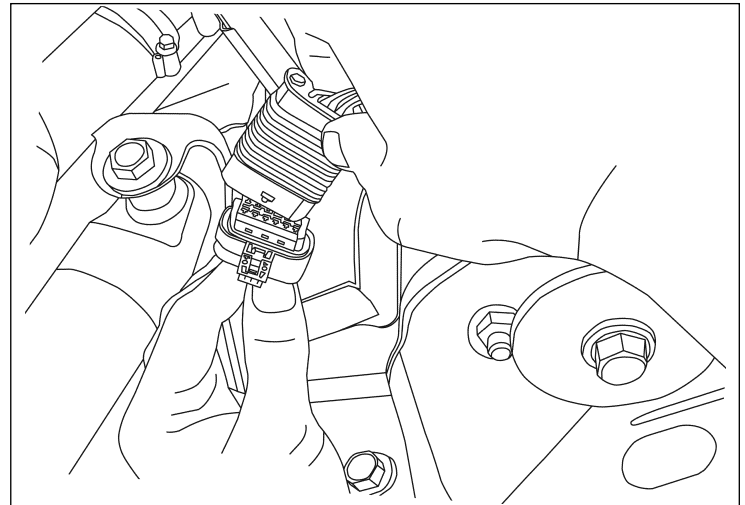

9. Install tailgate plate using M8 button head bolt and flat washer. **Note:** Tailgate plate tie rod attaching tab will be oriented to the driver side. Attach the two rubber bumpers using M8 button head bolts as shown in illustration.

Notice in the illustration the position of the rubber bumpers.

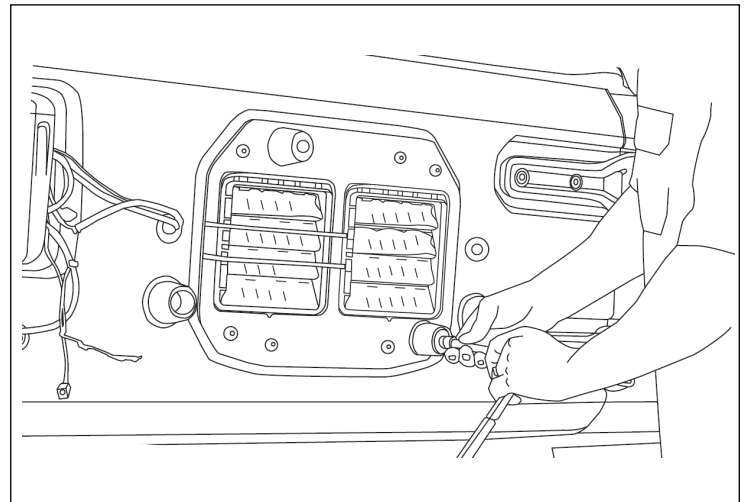



OMIX-ADA, Inc.

460 HORIZON DR. SUITE 400 | SUWANEE, GA 30024 | PHONE: 770-614-6101 | FAX: 770-614-6069 | info@omix-ada.com

# Rear Bumper with Tire Carrier, JL

10. Remove the passenger side taillight to allow room for tire carrier.

**NOTE:** In the interior of the vehicle remove the plastic cover to expose the plastic bolt attaching the taillight. Remove bolt which will release the taillight from the body of the vehicle. Unplug taillight and set the assembly aside.

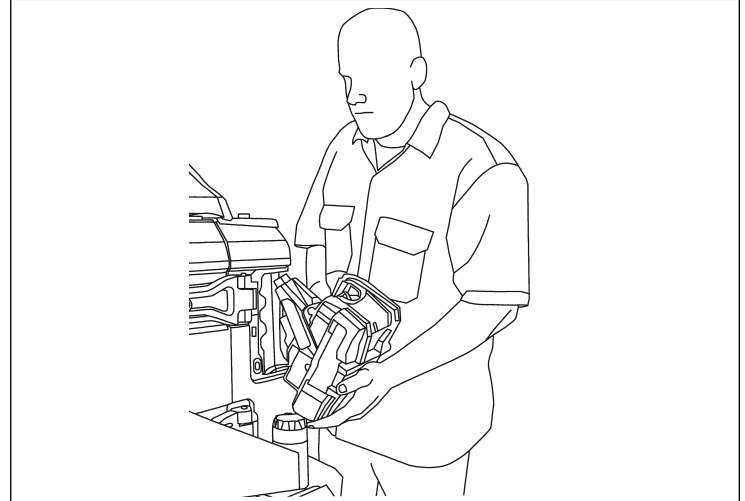

11. Grease both bearings.

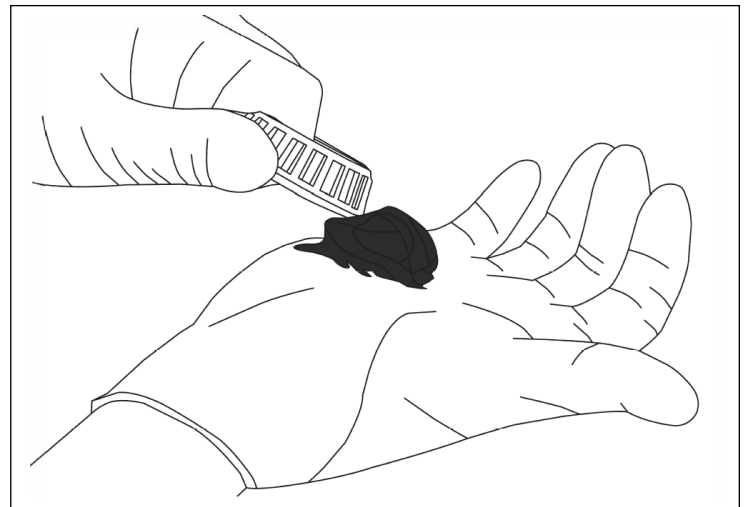

12. Remove E-coating from the spindle, use lacquer or paint thinner.

- Seat both bearing races into the swing-out tire carrier (both bearing races should be preinstalled into the tire carrier(A))
- Install bearing into the lower half of the housing(B)
- Install rubber seal to the bottom of housing, secure seal, may need to lightly tap with a hammer. Install tire carrier over the spindle(C)
- Install bearing(D)
- Place the large washer over spindle(E)
- Tighten castle nut. Tighten nut snug, back off a quarter turn. Swing tire carrier and assure it's secure. Tighten or loosen castle nut to the desired feel. Insert cotter pin to secure castle nut(F)
- Install bearing cap using set screw. We encourage using a thin bead of RTV to the bearing cap to create a water-tight seal(G)

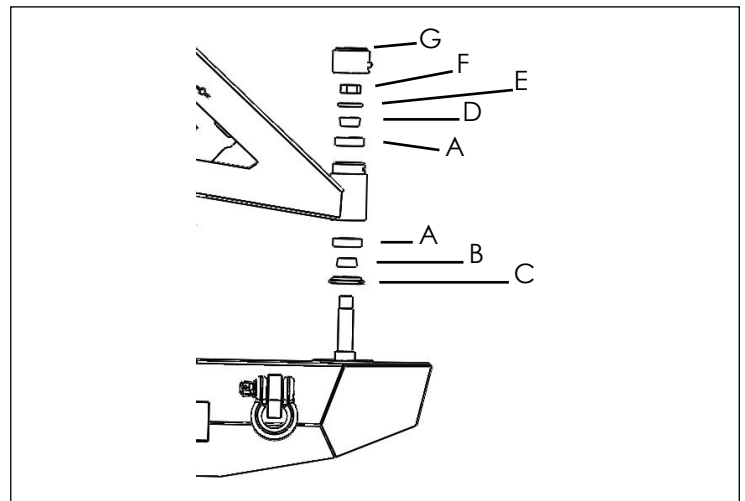



OMIX-ADA, Inc.

460 HORIZON DR. SUITE 400 | SUWANEE, GA 30024 | PHONE: 770-614-6101 | FAX: 770-614-6069 | info@omix-ada.com

## Rear Bumper with Tire Carrier, JL

13. To install the tire mount to the carrier, first determine desired height for spare tire. Install the two-bolt plates with M12 studs into the carrier.

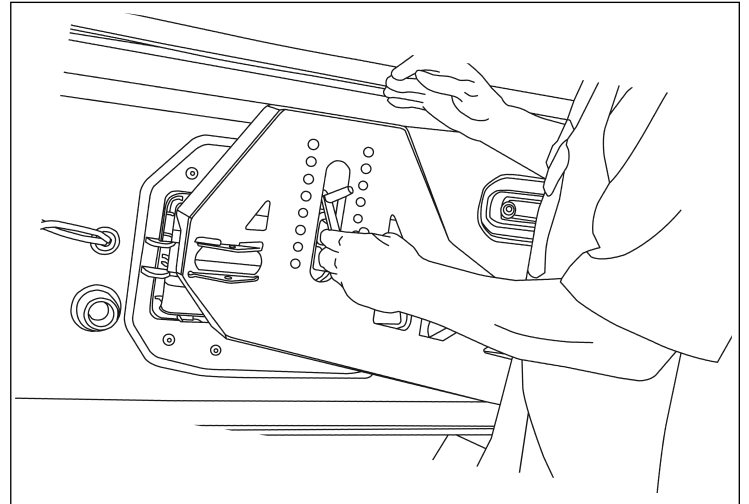

14. Install the tire mount base over the M12 studs to the carrier using flat washers and Nylock nuts. Tighten fully.

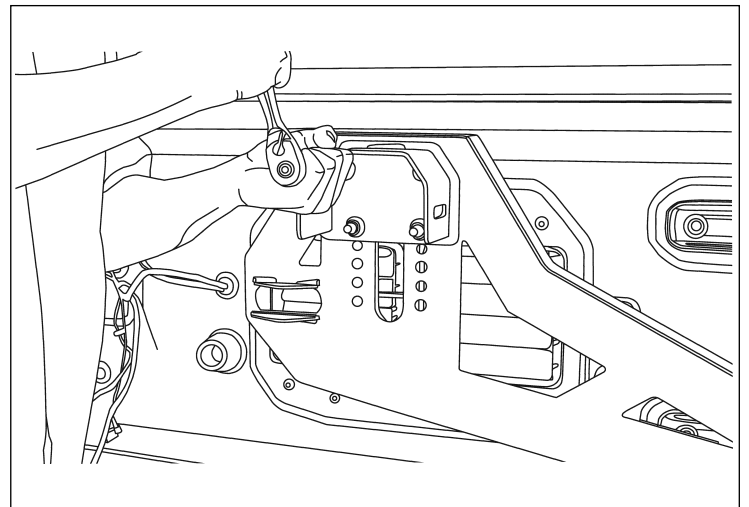

15. Place wheel stud bracket over the tire mount base. Use the three M12 X 35 bolts to attach with flat washers and Nylock nuts. The bolts install one at the top and two at the sides. **DO NOT fully tighten.**

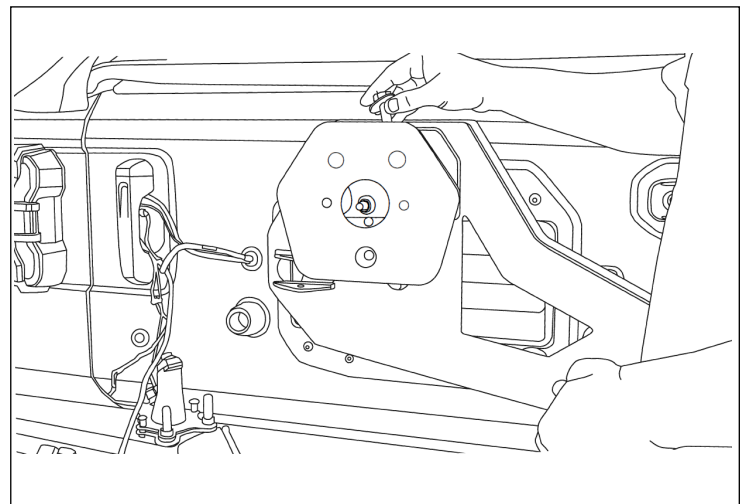



OMIX-ADA, Inc.

460 HORIZON DR. SUITE 400 | SUWANEE, GA 30024 | PHONE: 770-614-6101 | FAX: 770-614-6069 | info@omix-ada.com

## Rear Bumper with Tire Carrier, JL

16. Install the wheel stud assembly that was removed from the OE tire carrier. Use the OE star head screws to attach.

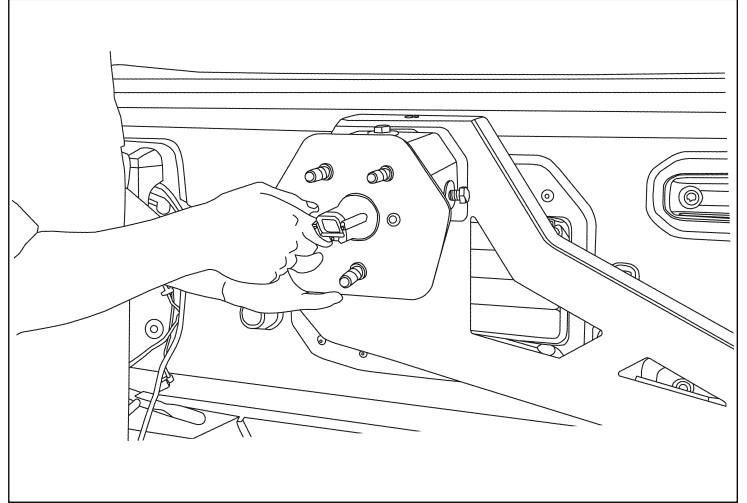

17. Slide the mount to the desired position according to the spare backspacing. This requires measuring the spare to determine the best position. Once in a position is determined, fully tighten all three bolts.

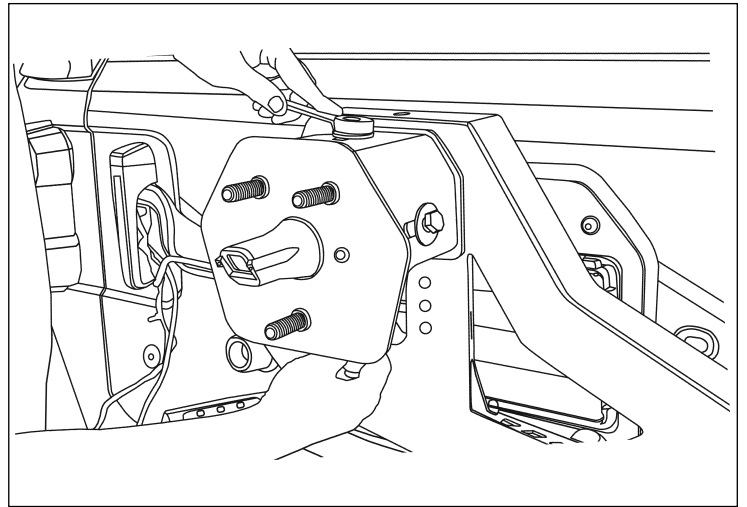

18. Route the backup camera wire through the tire carrier and wheel stud assembly. Plug-in camera, then attach using the three OE screws removed earlier.

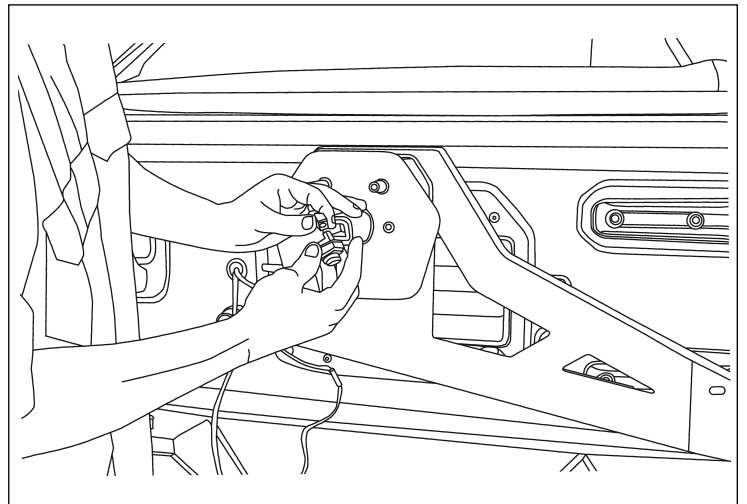





OMIX-ADA, Inc.

460 HORIZON DR. SUITE 400 | SUWANEE, GA 30024 | PHONE: 770-614-6101 | FAX: 770-614-6069 | info@omix-ada.com

## Rear Bumper with Tire Carrier, JL

19. Apply anti-seize to the stainless steel rod ends to avoid damage to the rod end. Thread them together.

Install thicker half of the tailgate linkage with M10 bolt with washers, high misalignment spacer, and nylock nut to the tailgate plate. **Do not tighten.** Make sure the backup camera wire does not get pinched by the linkage. Move wire above linkage.

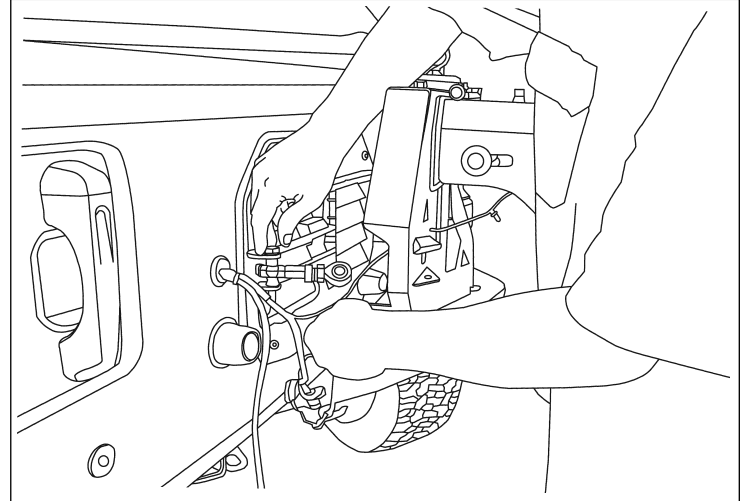

20. Attach the other side of the rod end to the tire carrier using the washers and misalignment spacers. Do not thread on the nut. Easily move the tailgate into the closed position. The rubber bumper should make contact with the carrier before closing. The tailgate should be roughly three inches from closing with the bumper coming in contact. This allows preload when the tailgate is completely closed and loaded with the weight of the tire. If this doesn't happen then remove the bolt to the rod end and adjust until this motion is achieved. Secure rod end with locking nut and fully tighten both bolts to the rod end.

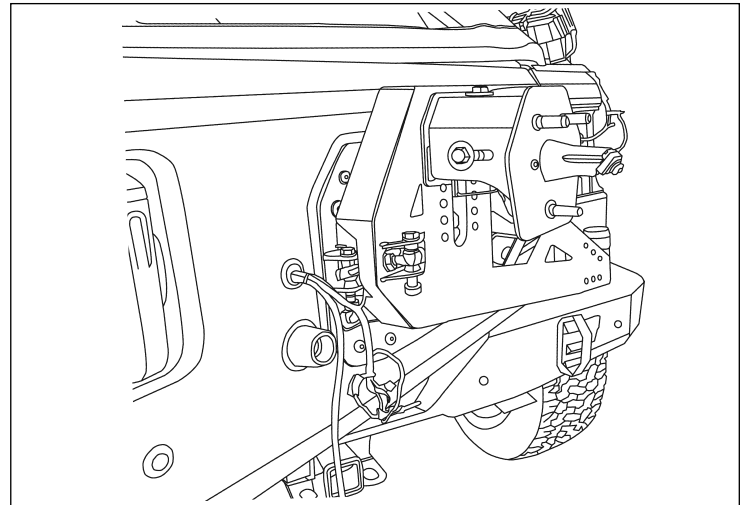

21. Reinstall the passenger side taillight. Requires the same procedure as step 10 in reverse. **DO NOT** overtighten plastic hardware, avoid damage to these plastic components.

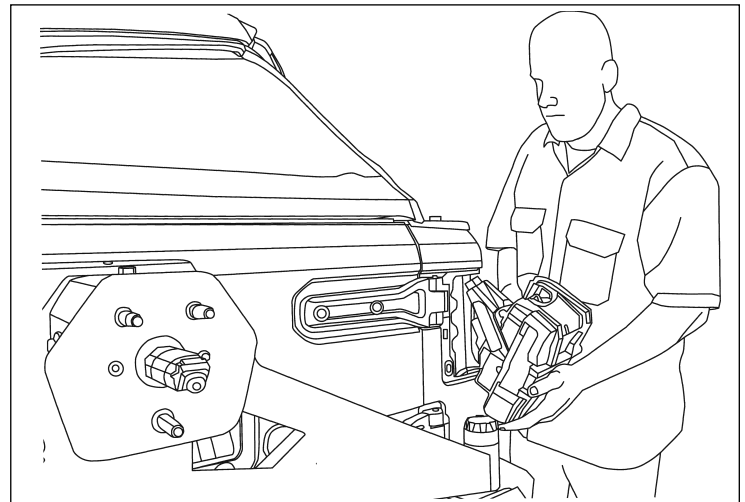



OMIX-ADA, Inc.

460 HORIZON DR. SUITE 400 | SUWANEE, GA 30024 | PHONE: 770-614-6101 | FAX: 770-614-6069 | info@omix-ada.com

## Rear Bumper with Tire Carrier, JL

22. Install the camera guard over the camera and studs.

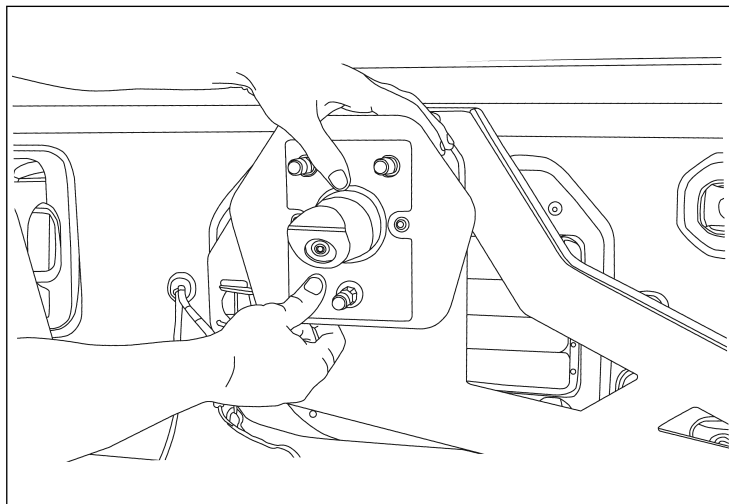

23. Install the spare tire to the carrier. With assistance, lift spare tire into position. Use the OE lug nuts to secure. Torque to 60 ft/lbs. We also suggest using a locking lug nut to assist against theft.

