



INSTALLATION MANUAL

LWF231BL1

Level of Difficulty

Moderate

Installation difficulty levels are based on time and effort involved and may vary depending on the installer level of expertise, condition of the vehicle and proper tools and equipment.

Parts List

Qty	Description
1	Driver side mounting plate
1	Passenger side mounting plate
1	Driver side mounting bracket
1	Driver side mounting bracket
1	License plate bracket
10	Hex nut, 1/2"-13
10	Hex lock nut, black, 1/2"-13
6	Carriage bolt, black, 1/2"-13 x 1-1/2", grade 5
4	Carriage bolt, black, 1/2"-13 x 2", grade 5
20	Flat washer, 1/2"
10	Flat washer, black, 1/2"
10	Lock washer, 1/2"
10	Hex head bolt, 1/2"-13 x 1-1/2", grade 5
4	Hex head bolt, 1/2"-13 x 1-3/4", grade 8
4	Button head bolt, black, 1/4"-20 x 3/4"
4	Kep nut, black, 1/4"-20
1	Winch plate

Tools Required

Torque wrench	Ratchet
SAE socket set	SAE wrenches
Metric socket set	Metric wrenches
Allen wrench, 5/32"	Socket extension

Torque Specifications

M12 bolt	59 ft-lbs.
1/2" bolt, grade 5	75 ft-lbs.
1/2" bolt, grade 8	110 ft-lbs.

Use above torque setting unless otherwise noted

Product Photo

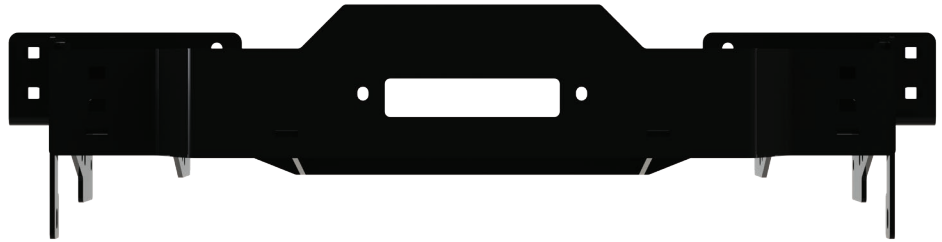

NOTICE

Visit www.ranchhand.com for a full-color copy of this instruction manual, as well as helpful videos, guides and much more!

Before you begin installation, read all instructions thoroughly.

Proper tools will improve the quality of installation and reduce the time required.

Periodic inspection of your product should be performed to ensure all hardware and / or components remain secure.

To help prevent damage to the product or vehicle, refer to the specified torque specifications when securing hardware during the installation process.

Maintenance

Mild automotive detergent may be used to clean the product. Do not use dish detergent, abrasive cleaners, abrasive pads, wire brushes or other similar products that may damage the finish.

Product Registration and Warranty

Ranch Hand stands behind our products with industry-leading warranties. To get copies of the product warranties, register your purchase or provide feedback, visit: warranty.curtgroup.com/surveys

Step 1

Locate the main wiring harness on the driver side frame and disconnect it, being careful not to damage the locking tabs.

Locate and disconnect the fog light wiring harnesses.

Step 2

Using a 15mm socket, remove the two (2) side bumper bracket bolts, one on each side.

Remove the plastic bumper inserts from around the tow hooks on each side.

Step 3

Using an 18mm socket, remove the eight (8) bolts securing the factory bumper, four on each side, and pull the bumper away from the truck slowly.

Note: While removing the bumper, carefully disconnect the bumper push clips and the clip for the engine block plug.

Step 4

Using an 18mm socket, remove the four (4) bolts securing each tow hook and remove the hooks.

Step 5

Remove the blocker brackets located on the bottom of the frame rails.

Step 6

Note: Before installing the mounting plates, make sure the top of the frame rails and the bottom sides of the mounting plates are clean and free of mud and dirt.

Insert 1/2" x 1-3/4" bolts through the top bracket holes of the mounting plates and into the frame.

Insert 1/2" x 1-1/2" bolts on the side rear bracket holes.

In the side front two holes, use the factory blocker bracket bolt tabs or 1/2" x 1-1/2" bolts.

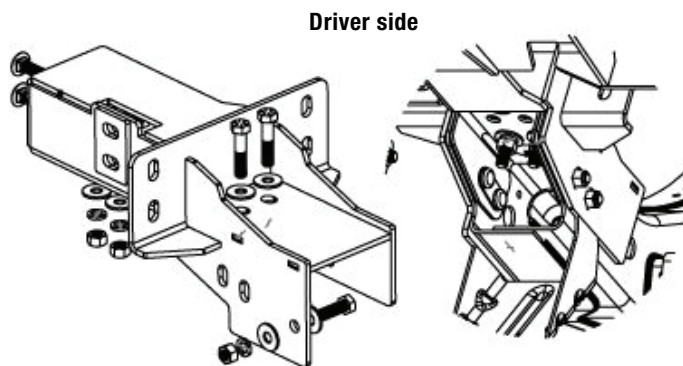

Step 7

Once brackets are installed, reinstall the factory bumper and reuse the factory bolts and nut tabs to secure it into the two inside holes.

Reinstall the side bumper brackets.

Step 8

Install the grill guard mounting brackets to the two outside bumper holes, securing them with the factory nut tab and bolts.

Step 9

Secure the grill guard by inserting 1/2" x 2" carriage bolts through top two holes of the grill guard into the mounting plates. Use 1/2" x 1-1/2" carriage bolts through the bottom holes.

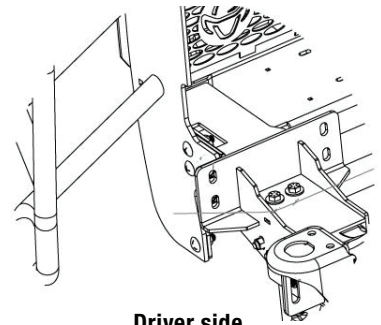
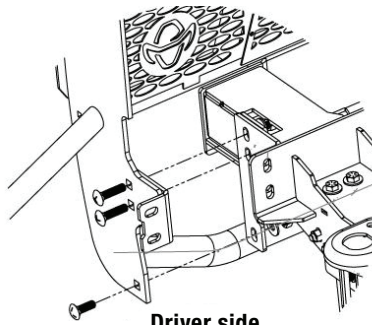

Step 10

Mount the winch plate to the bottom of the mounting brackets using 1/2" x 1-1/2" bolts and hardware. Hand tighten.

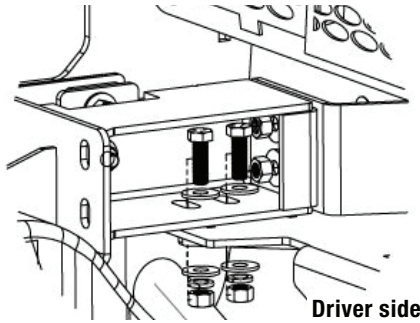

Step 11

From the front, insert 1/2" x 1-1/2" carriage bolts and hardware through the winch plate. Once in place, tighten all bolts and nuts.

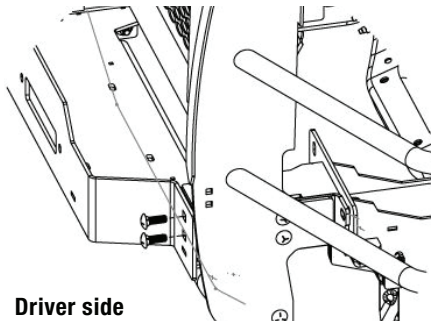

Step 12

Mount the fairlead and the license plate bracket to the front holes of the winch plate.

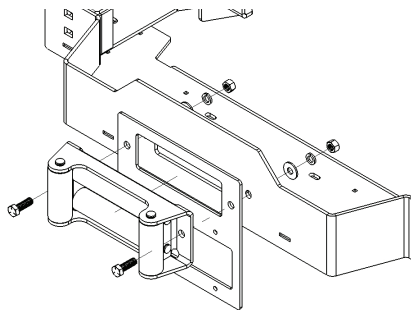

Step 13

Mount the winch to the four holes on the winch plate.

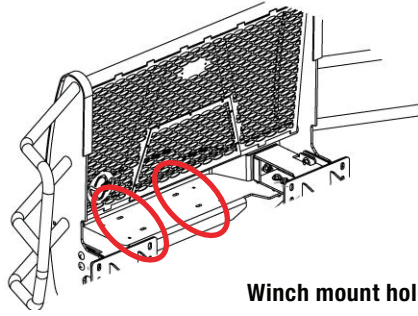

Winch mount holes

Step 14

If the vehicle does not have a camera, install the small insert using black button head bolts and nuts.

Step 15

Mount the license plate using 1/4" hardware.