

INSTALLATION GUIDE

PARTS

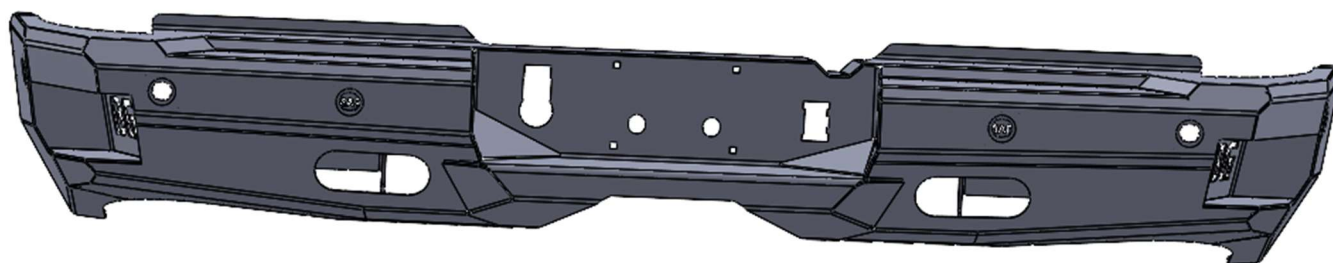

EXPLODED VIEW 1

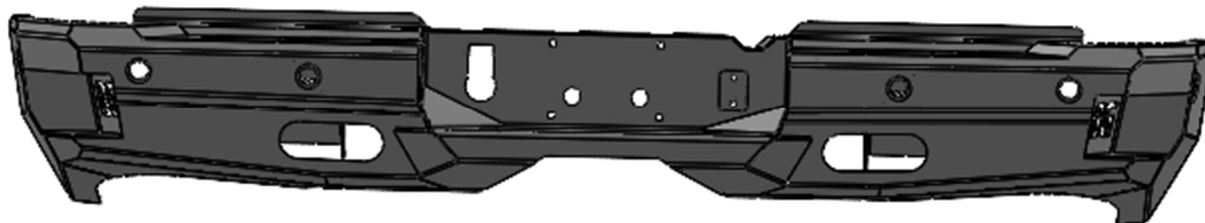
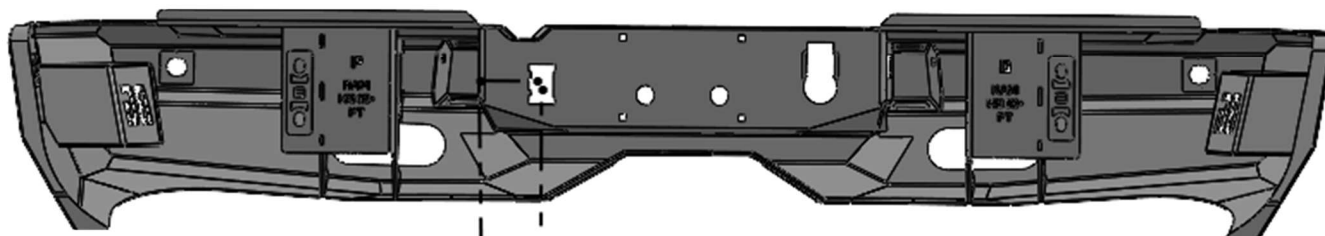

EXPLODED VIEW 2

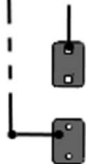
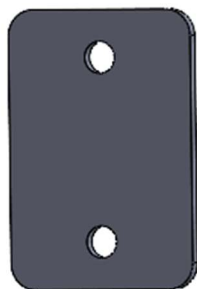

PORT COVER

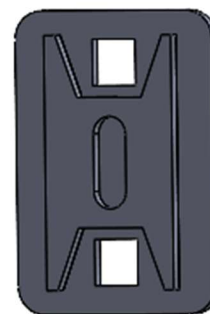

HARDWARE

FT-HK-LPR	<u>FT Rear Universal Kit</u>	<u>Qty</u>
	Plastic License Plate Nuts	4
	#14 x 5/8" Zinc License Plate Screw	4
	OVAL LED BACK-UP LIGHTS w/Rubber Grommet	2
	Plastic Wire Splices	4
	Red/Black wire - 16 GA. AWG	2'
FT-HK-DRH19	<u>FT Rear Mount Kit 2019+ RAM HD</u>	<u>Qty</u>
	1/2-13 x 1-1/2" Long, Grade 8 HB Zinc-Yellow	4
	1/2" Washer, Grade 8 Zinc-Yellow	8
	1/2"-13 Grade 8 Steel Serrated Flange Nut Zinc	4
	Sensors Bezels Part #68449575AA-001, 25AA, 24AA, 26AA, 23AA, 27AA	1
	Sensor Plug 9696 27mm	6
	1/4-20 (.093-.126: Panel Range) Zinc Electroplate Spring Steel Cage Nut	2
	1/4-20 x 5/8 Long, Stainless Steel SBHCS	2

PARKING SENSOR INSTALL (OPTIONAL)

1. If your vehicle is equipped with parking sensors, use the factory sensors and bezels to install in the six ports indicated below.

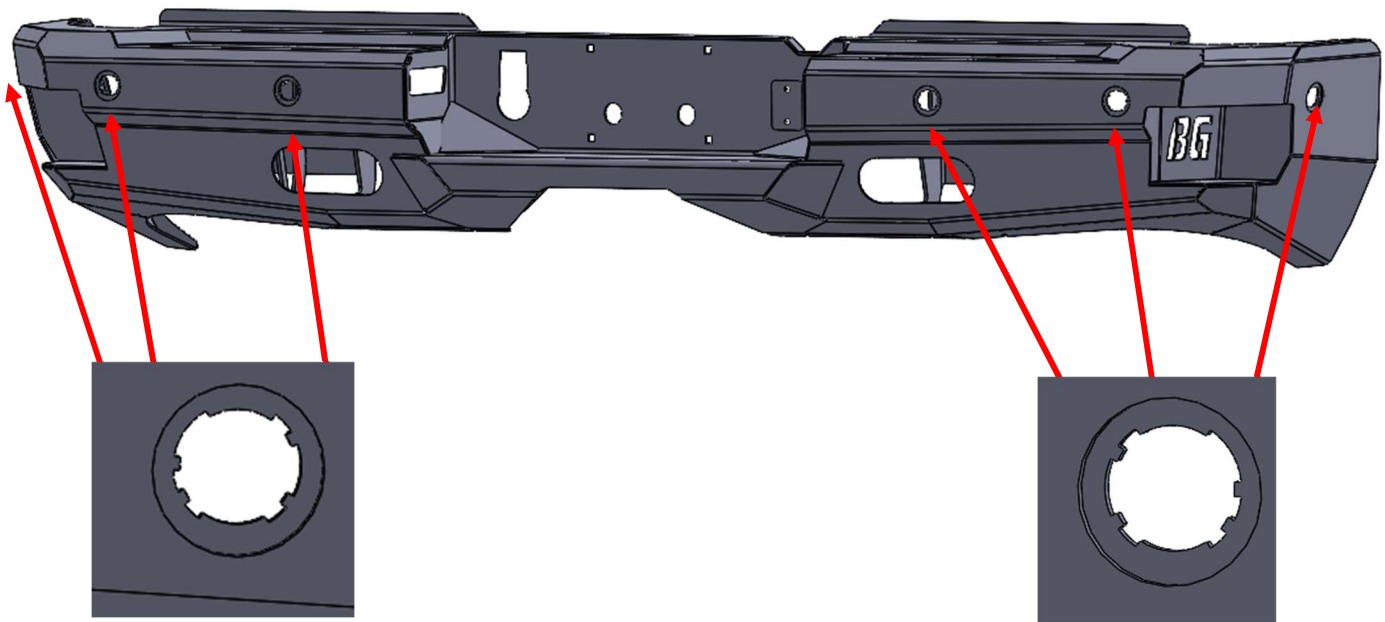

SENSOR PLUG INSTALL

1. If your vehicle is not equipped with parking sensors, install the provided plugs and install them into the parking sensor holes.



Parking sensor plug.

BUMPER INSTALL

1. Attach the bumper to both sides of the truck mounts with the included 1/2"-13 x 1-1/2" Yellow Zinc Grade 8 Hex Bolts.

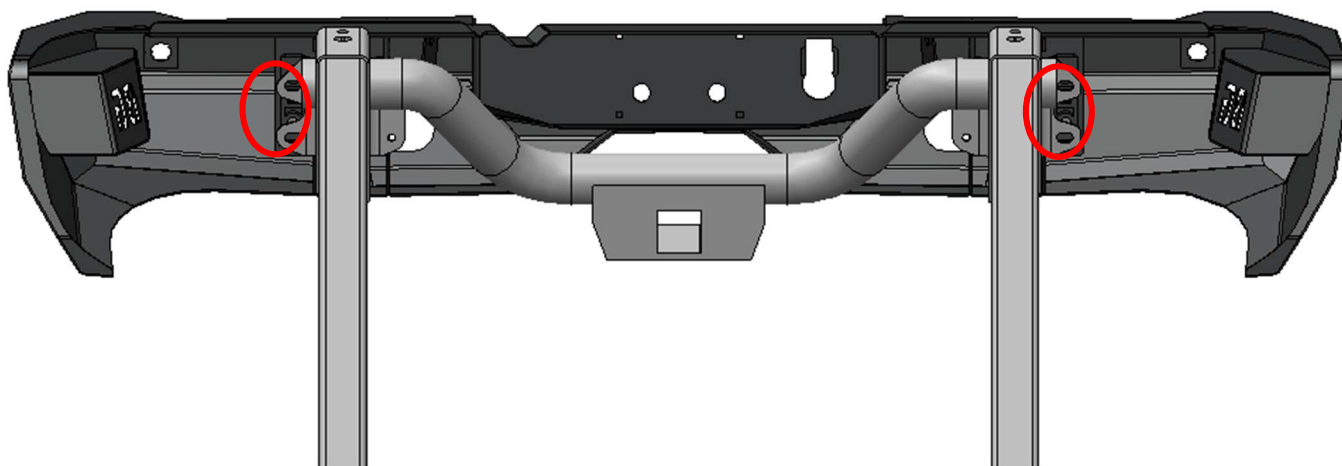

LICENSE PLATE INSTALLATION

1. Insert plastic license plate plastic nuts into bumper and mount license plate using the license plate screw and a power drill.

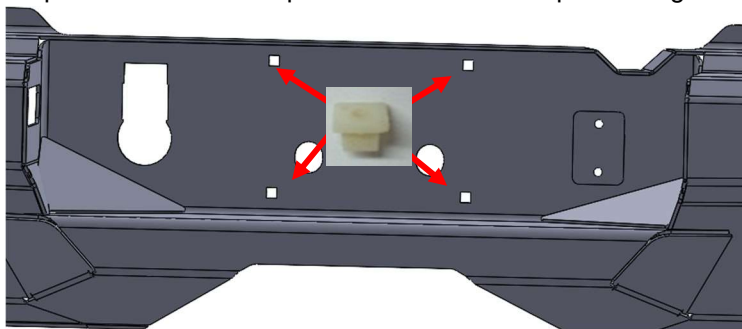

TRAILER CAMERA PORT COVER (OPTIONAL)

1. If not in use, use two - 1/4-20 x 5/8 screws and 2 cage nuts to attach the port cover.

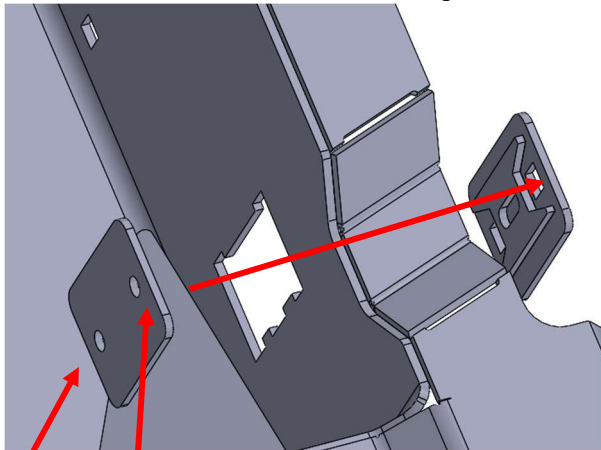

2x - 1/4-20 x 5/8 Long, Stainless Steel SBHCS



2x - 1/4-20 (.093-.126: Panel Range) Zinc Electroplate Spring Steel Cage Nut

TAG LIGHT INSTALL

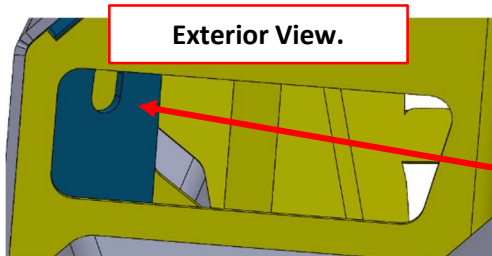

Exterior View.

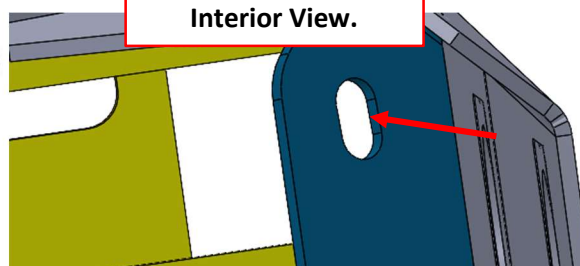
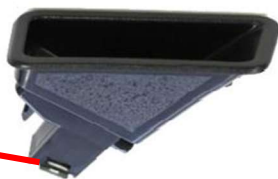

Interior View.

1. Insert OEM tag light through opening as shown, butting the attached clip nut to the slotted hole. The rim of the light should rest firmly against the outside edge of the hole.
2. Secure the clip nut to the mounting bracket with factory screw and connect wiring as before.

REVERSE LIGHT WIRING

1. Using the Red/Black wire - 16 GA. AWG and the plastic wire splices, wire in the OVAL LED BACK-UP LIGHTS to the trailer plug harness.
2. Connect the red wire to the (power+) of the 7 way trailer plug harness.
3. Connect the white wire to the (ground-) of the 7 way trailer plug harness.
4. Black wire will not be used.



SAFETY

THE SAFETY OF YOU AND OTHERS IS VERY IMPORTANT TO US!

To minimize this risk and make an informed decision about safety, it is important that you carefully read and follow the installation instructions we have provided.

We urge you to use your own good judgment and allow plenty of time for installation.

HAZARD CHECKLIST

1. Always wear personal protective equipment (PPE) such as: protective eye wear, gloves, close toed shoes, etc.
2. We recommend that you use a certified mechanic or shop for professional installation.
3. Always set emergency brakes on vehicle and use tire blocks to ensure vehicle stabilization.
4. Use caution when lifting, we recommend the use of equipment to help lift bumpers into place.
5. Use caution when using power tools such as air ratchet, etc.
6. Take caution when installing wiring.
7. Perform regular inspections of hardware, bolts, brackets, etc.
8. Rigid light brackets are specifically designed to fit Rigid lights, we do not guarantee off brand fitment.
9. Our winch mount is designed for Warn and Superwinch products. We do not guarantee off-brand fitment.

USE & RISK

Bodyguard Products LLC is not responsible for damage to our products, or other subsequent damage that might occur because of misuse or improper installation. While we do manufacture products that appear stronger than factory parts, our products should not be viewed or relied upon as life-saving devices in the event of a collision or rollover. We make no claims relating to airbag compatibility, crashworthiness, or sturdiness. It is the customer's responsibility to check with the vehicle manufacturer or auto dealer regarding airbag compatibility and automobile manufacturer's warranty before installing our products.

FINISHING UP

- Install shackles.
- Confirm that all hardware is tightened, and everything is secure.
- Secure wiring harnesses for lights and sensors.
- Test all lighting and wiring before using vehicle (fog lights, sensors, etc.).
- Periodically check that all hardware is tightened and that all wiring and connections are secure.
- Periodically check that all sensor plugs are secure.
- Routinely wash bumper to maintain the powder coat finish.

FEEDBACK

We'd love to hear from you!

Please send your pictures, testimonials, comments, or suggestions to us by email at info@bodyguardbumpers.com. We frequently use customer pictures for brochures and marketing materials, and we always welcome customer feedback to ensure quality improvements within our company. Thanks for your purchase; we appreciate your business very much!

Where **STRENGTH** Meets *Style!*™

