

Rugged Ridge XOR Rear Bumper, JK

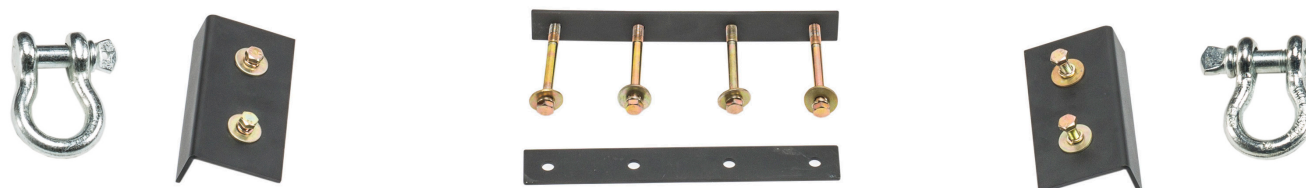

Components

- 1 - **Rear Bumper**
- 2 - Frame "L" Brackets
- 4 - M12 X 45 Hex Bolts
- 4 - M12 Flat Washer
- 4 - M12 Lock Washer
- 1 - Hitch Mount Plate
- 4 - M12 X 120 Hex Bolts
- 4 - M12 Flat Washer
- 4 - M12 Lock Washer

- 1 - **Logo Backing Plate**, not shown
- 2 - M6 X 20 Hex Bolts
- 2 - M6 Flat Washer
- 2 - M6 Lock Washer

- 2 - **D-Ring**

Light Option:

You can add 3" cube lights in provided opening of the bumper. Research and assure you wire the lights correctly to avoid damaging the electrical system of your Jeep. If you choose to add, mount cubes to bumper before installing bumper to the Jeep.

Style Option:

Behind the center logo of the bumper is a plate that can be removed and painted to match your Jeep or a bright accent color to give an additional attention to detail. Modify before installing bumper to the Jeep.

OMIX-ADA® TECHNICAL SUPPORT

PHONE: M-F 8am - 5pm EST 1-800-449-6649

FOR WARRANTY OR TECH CONCERNS EMAIL: webmaster@omixsupport.com

ATTN: STATE OF CALIFORNIA CONSUMERS

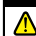
 **WARNING:** Cancer and Reproductive Harm - www.P65Warnings.ca.gov.

Rugged Ridge XOR Rear Bumper, JK

STEP 1:

Remove factory rear bumper and factory tow hook. For further assistance scan here with your smart phone to view video posted on youtube.



STEP 2:

To retain the OE tow hitch there needs to be some modifications done to the hitch to fit. On the OE hitch there are four welded nuts for the bolts that go through the frame crossbar. Each of the nuts need to be removed from the hitch. Use a cutting wheel and cut the welds off each nut to remove. Use the appropriate safety equipment to avoid injury. Most aftermarket hitch receiver kits do not have these nuts welded on and this step can be bypassed by simply removing the nuts and bolts.

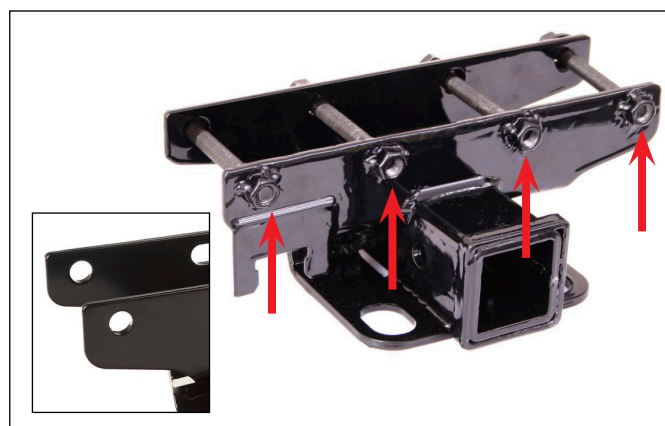

STEP 3:

With rear factory bumper removed clear inside frame rails of any debris. Also, apply painters tape to the body of your jeep. This will protect your paint from being scratched by the bumper moving during installation. Slide L-bracket (shown as A) into each frame rail with the flat side with the welded nuts facing the inner outer side.

Lift bumper to frame rails. It is best to have a assistant to lift and hold bumper in place. Thread M12 X 35 bolts with flat and locking washers into the welded nuts of the L-bracket. Do not tighten yet.

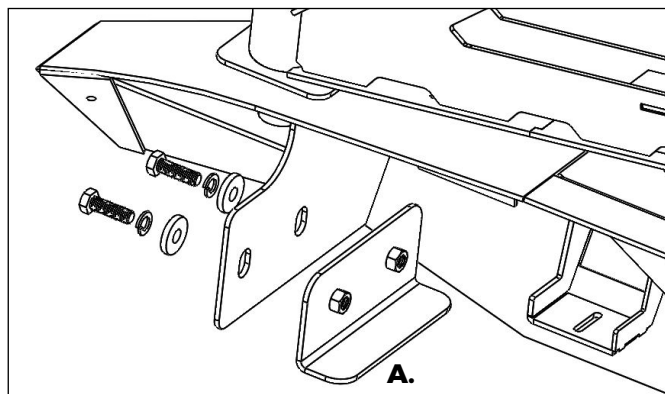

Rugged Ridge XOR Rear Bumper, JK

STEP 4:

Feed hitch mount plate through the back of the bumper hitch mounting area. If retaining the OE tow hitch left in place between the frame crossbar. Feed M12 X 120 bolts with flat and spring washers up and above the muffler to help assist feeding the bolt straight through the cross member. Thread bolt into the hitch mount plate that's inserted into the rear of the bumper.

Adjust bumper level to the body of the Jeep. Once in desired position tighten all hardware (4 hitch bolts and 4 side frame bolts) in a alternating pattern. **Avoid using power or air tools.** Tighten to 60ft lbs torque to secure the bumper to the Jeep.

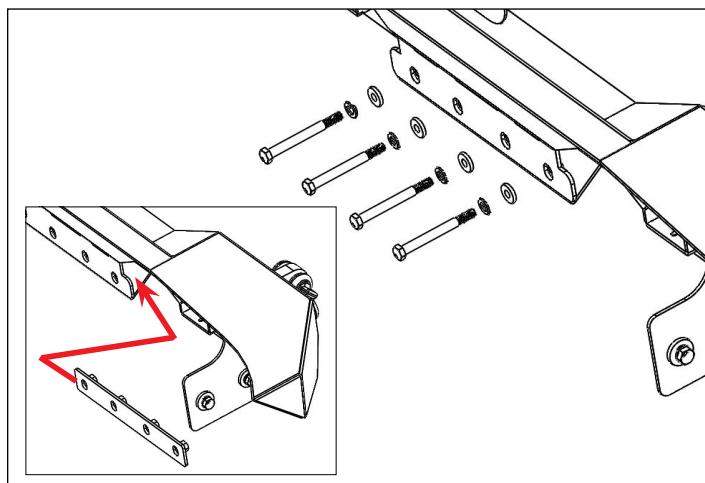

STEP 14:

Lastly install D-rings.

