



Toyota Pocket Style® Fender Flares Set of 4

Set Part #2803921
Rev-2 2/23/16

STEP 1 – PRIOR TO INSTALLATION

- A) Husky®** only approves installing the flares according to these written instructions with the hardware provided. **WARNING:** Failure to install according to these instructions will invalidate the warranty. This includes, but is not limited to using alternative installation methods, hardware, or materials. **DO NOT USE:** Loctite, SuperGlue, or similar products on the hardware or the flares.
- B) Fit:** Verify the fit of the flares to vehicle. (Some filing, sanding, or cutting may be necessary to ensure proper fit).
- C) Painting:** (Optional) if paint is desired it must be done prior to installing flares on vehicle. Clean outer surface with a good grade degreaser. **DO NOT USE LACQUER THINNER OR ENAMEL REDUCER AS A DEGREASER.** Wipe outer surface thoroughly with a tack rag prior to paint. Application of plastic adhesion promoter for ABS plastic as per your paint system manufacturer's recommendations is required. Paint flares using a high quality enamel, or polyurethane automotive paint. If painting edge trim (not recommended), use a flex additive.
- D) Performance:** Using larger Tires may increase the area required to turn the vehicle. Some Tire/Rim combinations may require lowering bump stops and or installing steering stops to prevent tire from contacting flare.
- E) Exhaust System:** Modifications may be necessary to maintain a minimum 4" clearance between flares and exhaust pipes. (Exhaust gases should not vent directly onto flares)
- F) Metal Protection:** All exposed fasteners and bare metal should be treated with rust resistant paint **BEFORE** installing flares. Spray inner fender wells with undercoating **AFTER** flare attachments have been completed.
- G) Decals:** Flares may interfere with existing decals on vehicle. If you wish, remove decals prior to installation of flares.
- H) Care & Cleaning:** Husky fender flares are built to last; any detergent you use to wash your vehicle is sufficient to clean the flare. Do not use any harsh abrasive detergents.

TOOLS FOR EASY INSTALLATION:

- Utility Knife
- Soft Wiping Cloth
- Pry Tool
- 10mm Socket
- Socket Wrench
- Drill
- 5/16" Drill Bit
- #2 Phillips Screw Driver
- 1/8" Drill Bit
- 1/2" Wrench
- Grease Pencil

PLEASE READ: Dirt and debris can become lodged between the fender flares and the vehicle's fenders, causing scratching and paint wear from vibration. Husky Liners is not responsible for any damage, and the installation of our fender flares is done with the buyer's understanding that this scratching and paint wear may occur.

LIMITED LIFETIME WARRANTY AGAINST ANY MANUFACTURING DEFECTS

- To claim a warranty, you must provide Proof of Purchase.

Included in Hardware Kit:

- | | | | | | | |
|---|--|--|---|---|--|---|
| 1. 
RV1-P009,
8x15x20mm
Retainer,
12 pcs | 2. 
SW1-0044,
14 x 1/2" Phillips
Truss Screw,
4 pcs | 3. 
SW1-0041,
5/16 x 18 x 1"
SS Torx Screw,
2 pcs | 4. 
SW1-0067,
5/16 x 18 x 3/8"
SS Torx Screw,
31 pcs | 5. 
NU1-0019,
5/16-18 Jam Fin.
Nylock Nut,
33 pcs | 6. 
WA1-0012,
.320 x .700 x .03
SS Washer,
35 pcs | 7. 
GP1-0025,
EX4008 Wiper
Style Edge Trim,
338 inches |
| 8. 
ET1-0002,
Edge Trim Tool,
1 pc | 9. 
SW1-0052,
T-45 Torx Bit,
1 pc | | | | | |

Components List:



Driver Side x1



Passenger Side x1



Driver Side x1



Passenger Side x1



Driver Side x1



Passenger Side x1

EDGE TRIM INSTALLATION

A. Peel two to three inches of red vinyl backing away from Edge Trim (GP1-0025) tape. Applying the adhesive side of the edge trim to the inner side of the flare, affix the edge trim to the top edge of the flare (the portion that comes in contact with the vehicle).

B. Press edge trim into place along the top edge of the flare in one-foot increments, pulling red vinyl backing free as you continue to work your way around the top edge of the flare.



Pocket Hardware Installation:



Put a Washer (WA1-0012) on each Bolt (SW1-0067).

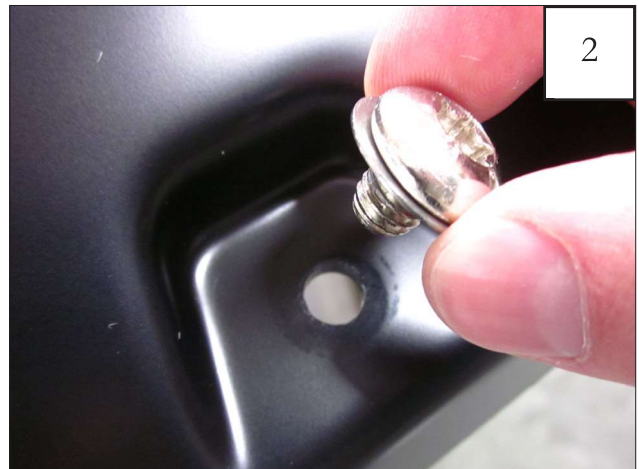

Put each Bolt/Washer combination through a pocket hole in the flare, Bolt head and Washer on the outside.



Place a Nut (NU1-0019) over the end of each Bolt and tighten, using a 1/2" wrench for the Nut and the supplied Torx Bit (SW1-0052) for the Bolt. Repeat for remaining pockets.

Front Flare Installation Procedures:



Using a 10mm socket, remove two factory screws located at the rear of the wheel well. Retain screws for reinstallation. **NOTE: Flare are meant to be installed with Factory Mud Flaps. Do not remove mud flap.**



Using a 10mm socket, remove two factory fasteners located at front of wheel well. Retain screws for reinstallation.



Position Front Flare on Fender temporarily. Reinstall factory screws through flare and into hole locations shown. **NOTE: Make sure the smaller diameter screw is re-installed into the same hole.** Tighten all factory screws.



Using a 5/16" bit, drill through holes located at the top center, bottom front and rear of the flare into the plastic where indicated.

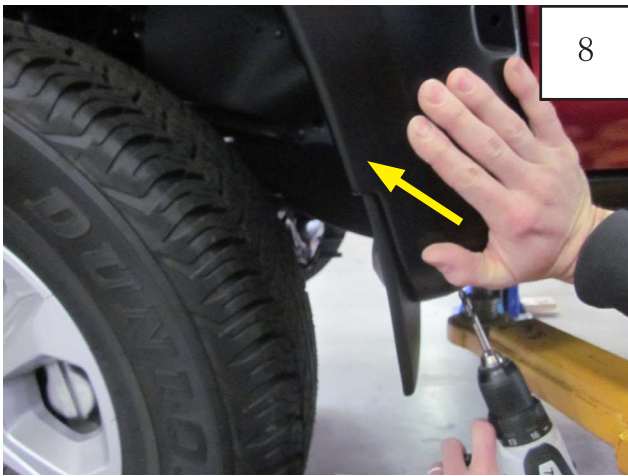

8

NOTE: When drilling the bottom rear hole of the front flare, push the flare forward and in towards the wheel well.



9

Install supplied bolt (SW1-0041) with one washer (WA1-0012) in bottom front hole of flare. Install an additional washer (WA1-0012) and nylock nut (NU1-0019) from backside of bumper cover. Tighten with 1/2" wrench.

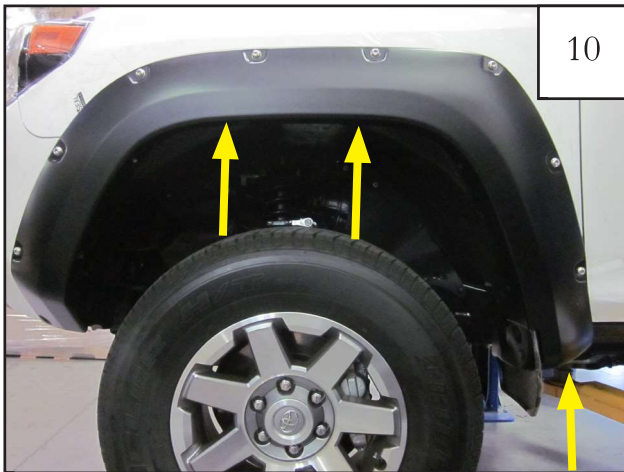

10

Install supplied push retainer (RV1-P009) into the remaining three holes drilled in the Step 7. Ensure flare is positioned properly, then apply inward pressure on the flare at each hole location while tightening each screw.



11

Installation Complete. Repeat process for other side of vehicle.

Rear Main Flare Installation Procedures:

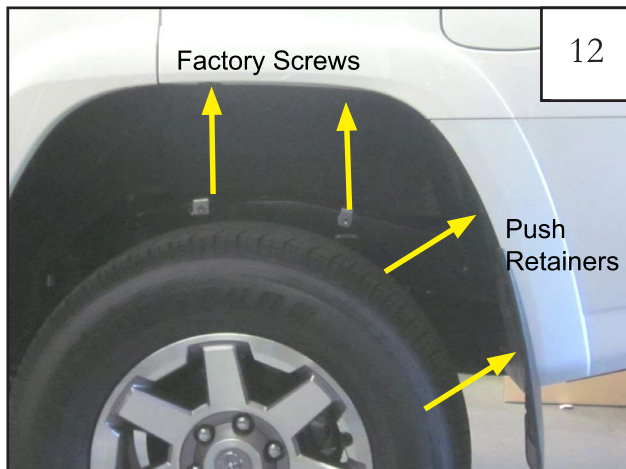

12

Remove two factory screws and two factory push retainers from the Rear Main Flare ONLY. Retain screws for reinstallation.



13

Remove factory Rear Main Flare by pulling the part away from the clips on both ends of the part, then grasp in the wheel well and pull off.

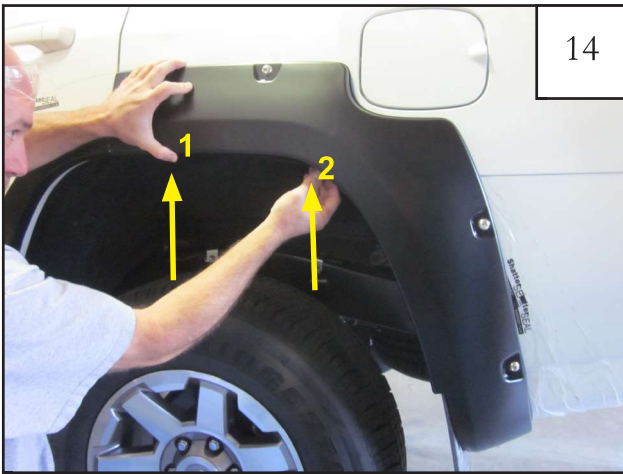

Position Flare and hand start two factory screws in to the top two holes in flare. Ensure flare is positioned properly, then apply inward pressure on the flare at each hole location while tightening each screw. *NOTE: Tighten screw at the front of the flare first.*

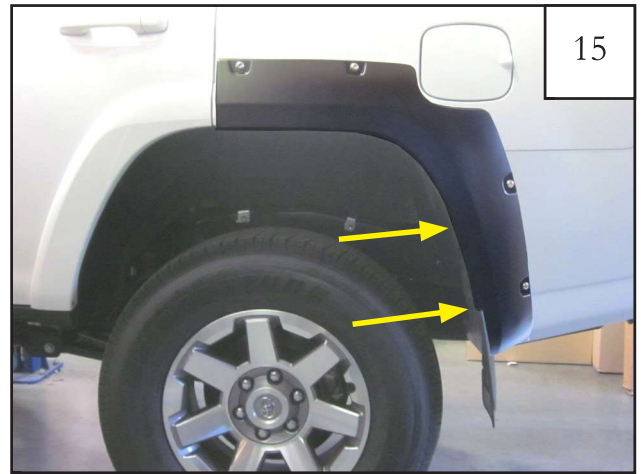

Install supplied push retainers (RV1-P009) in the two lower holes in the flare.



Drill a 5/16" hole in the lower rear hole location. *NOTE: Press inward on the flare when drilling to ensure proper hole location.*

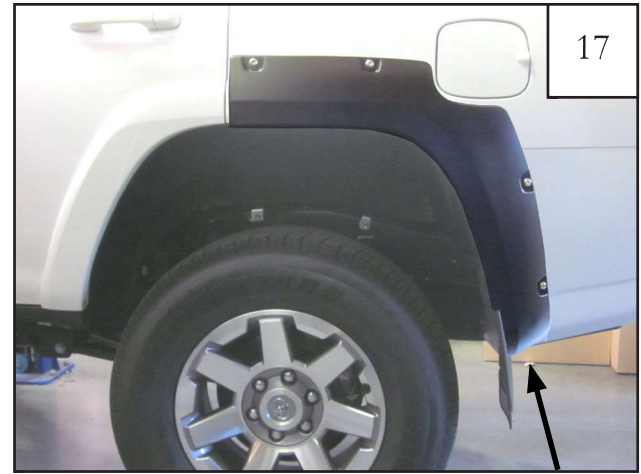

Install supplied push retainer (RV1-P009) into the lower rear hole.



Ensure flare is positioned properly, then apply inward pressure on the flare at each hole location while tightening each screw.

Rear Door Piece Installation Procedures:



NOTE: Clean factory door piece installation surfaces with a soft cloth and mixture of 50/50 water and isopropyl alcohol.

Before installing door piece over the factory flare, hold flare in position on the door and dry fit. Using a Grease Pencil, draw a line along the outer edge of the door piece onto the door to make it easier to line up when installing.

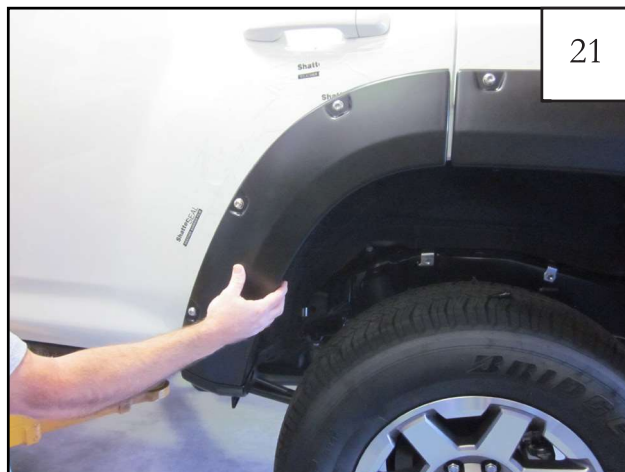

NOTE: You cannot remove the door piece once it has stuck to the vehicle.

Use the line drawn in step 19 as a guide. Align door piece with edge of door and carefully press into position on the door over the factory flare.



Align door piece with rear flare before drilling and installing screws.



Remove tape liner from all tape on back of door piece.

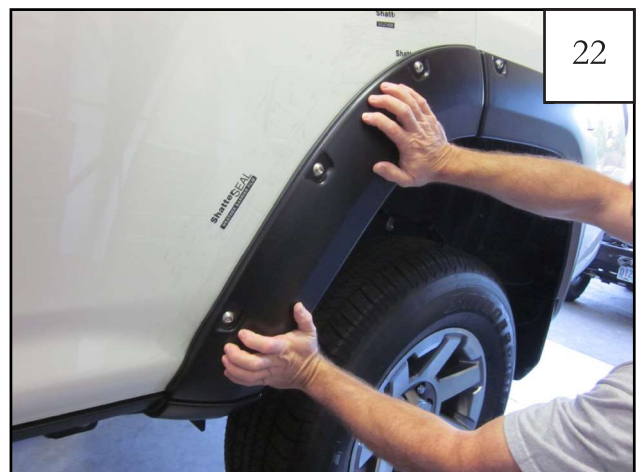

Apply pressure along the entire surface of the door piece to ensure all tape is adhered to the vehicle door. Apply 30 PSI to the taped areas for proper bond. Tape reaches maximum adhesive bond after 24 hours of contact.



Hold top of flare and drill pilot holes in door piece with 1/8" bit.

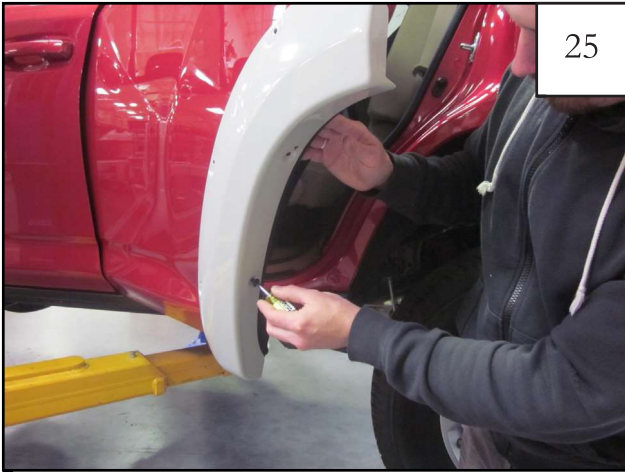

Install supplied Truss Head Screws (SW1-0044) into holes. Screws are attached to factory flare. **DO NOT OVER TIGHTEN SCREWS.**



Installation Complete.

Edge Trim Tool Procedures:



Using supplied Edge Trim Tool (ET1-0002), seat edge trim against vehicle by hooking curved end under edge trim at one end of flare. Next, slide around outer edge of flare to the other end.



Using flat end of supplied Edge Trim Tool (ET1-0002), seat edge trim against flare by inserting straight end between edge trim and flare at one end. Next, slide around entire edge to the other end.