

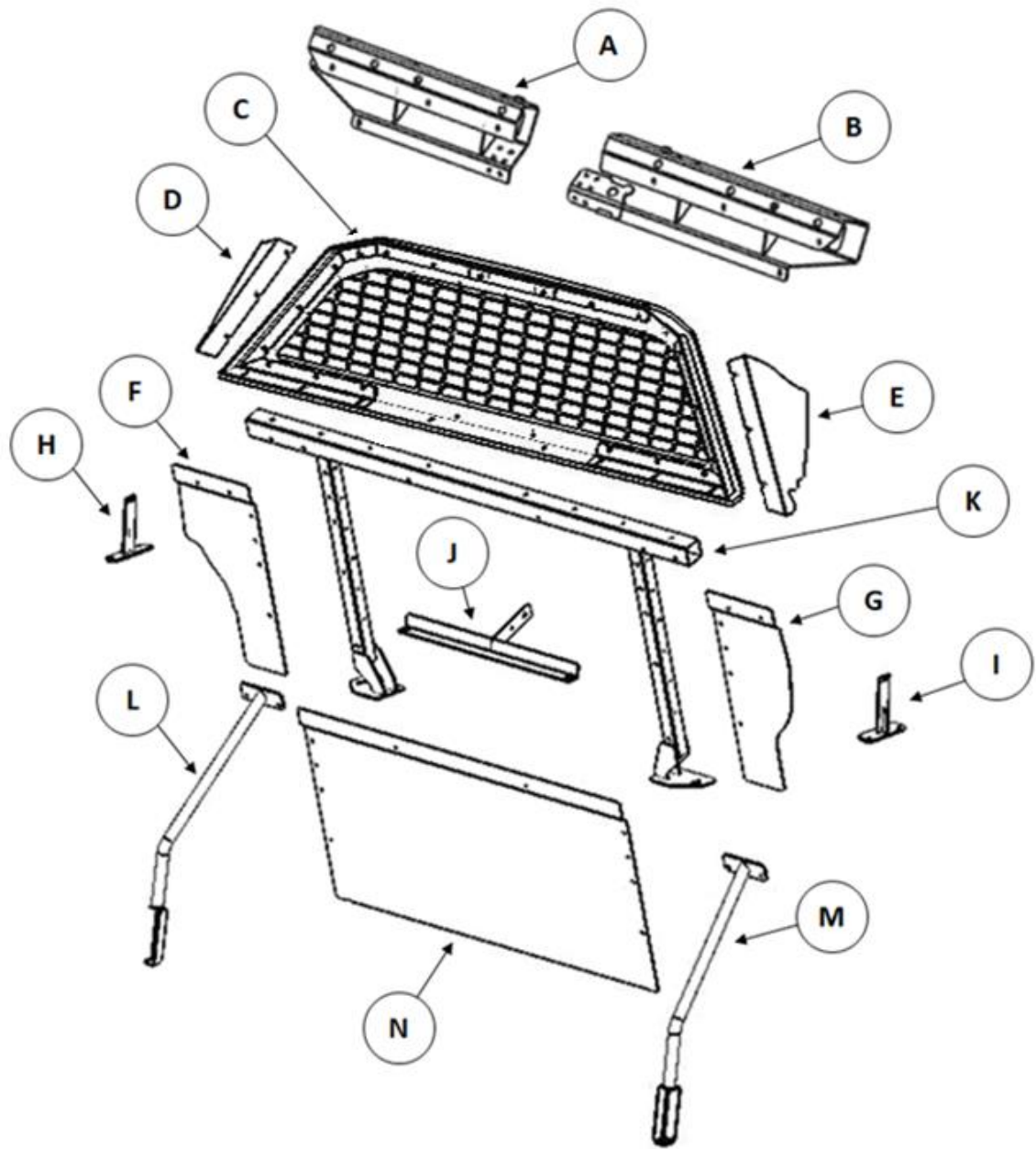

INSTALLATION INSTRUCTIONS FORD INTERCEPTOR SUV SEAT WITH CENTER BELT; 5UF1911



ITEM	QTY	DESCRIPTION	ITEM	QTY	DESCRIPTION
A	1	Seat Adapter Bracket (Left Side)	H	1	Seat Belt Bracket (Left Side)
B	1	Seat Adapter Bracket (Right Side)	I	1	Seat Belt Bracket (Right Side)
C	1	Rear Screen Window Assembly	J	1	Center Belt Bracket
D	1	Upper Filler Panel (Left Side)	K	1	Rear Cross Bar
E	1	Upper Filler Panel (Right Side)	L	1	Floor Strut (Left Side)
F	1	Closeout Panel (Left Side)	M	1	Floor Strut (Right Side)
G	1	Closeout Panel (Right Side)	N	1	Center Closeout Panel



PARTS INCLUDED IN THIS LIST:

Item	QTY	Description
1	8	Phillips Rounded Head Screw Number 6 X ½"
2	4	Countersink Screw Number 8 X ½"
3	37	Button Head Hex Drive Screw, ¼" – 20 X 1"
4	33	Split Lock Washer ¼"
5	37	Flat Washer ¼"
6	4	Locknut ¼" - 20
7	4	Hex Head Screw 5/16" – 18 X 1"
8	4	Flat Washer 5/16"
9	4	Serrated Flange Locknut 5/16" - 18
10	1	Hex Head Screw ½" – 13 X 1-1/2"
11	2	Flat Washer ½"
12	1	Nylon-Insert Locknut, ½" - 13
13	4	Button Head Hex Drive Screw M10 X 1.50MM X 35MM
14	4	Flat Washer M10
15	2	Socket Head Screw M12 X 1.75MM X 45MM
16	2	Split Lock Washer M12
17	2	Flat Washer M12

aedec

PRO-STRAINT®
Prisoner Safety Seats

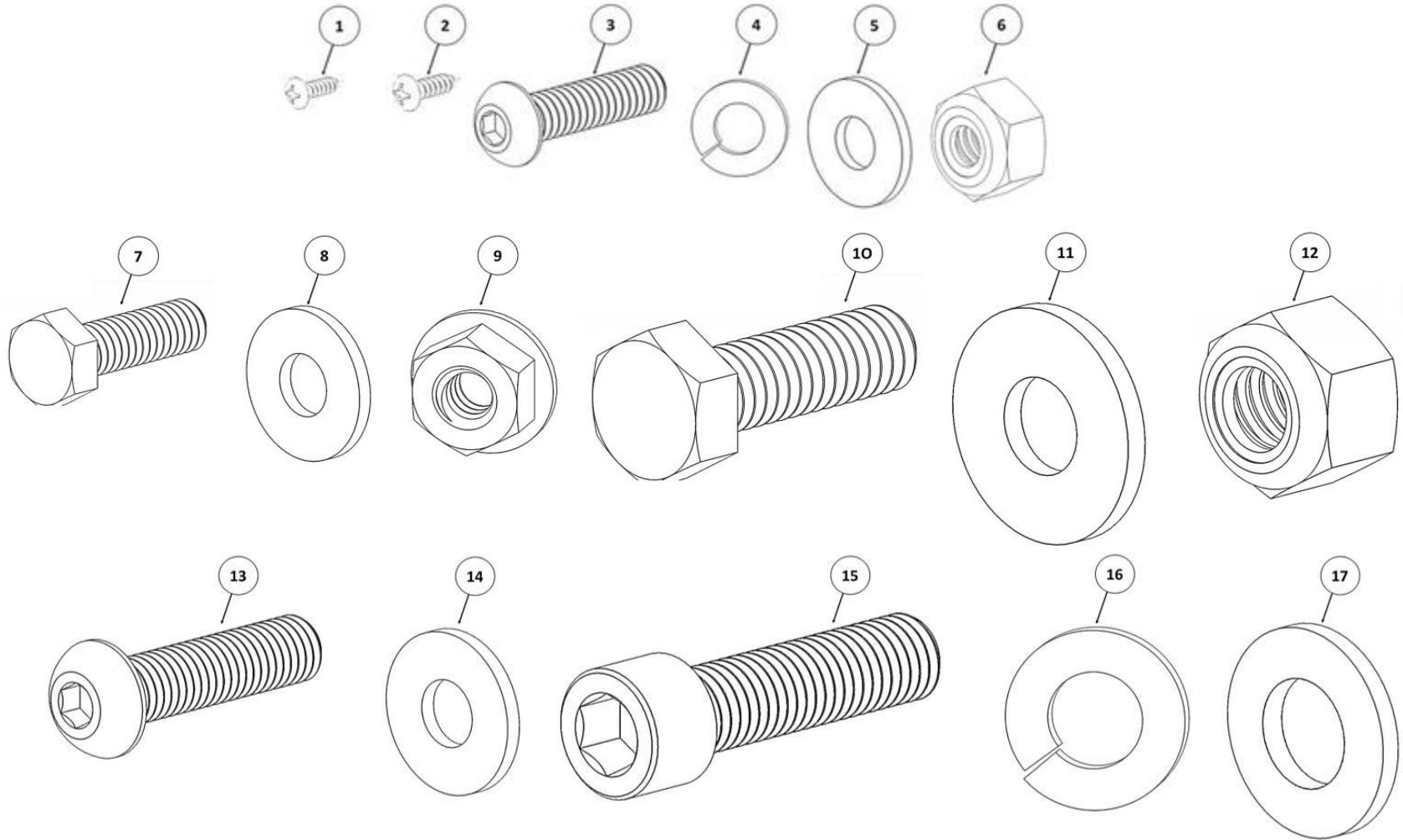

PARTS INCLUDED IN THIS LIST:

Item	QTY	Description
18	6	Hex Head Screw 5/16"-18 X 1"
19	6	Lock Washer 5/16"
20	12	Flat Washer 5/16"
21	6	Hex Nut

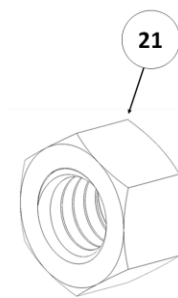
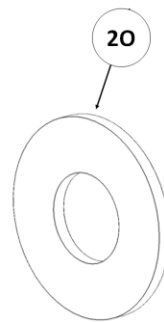
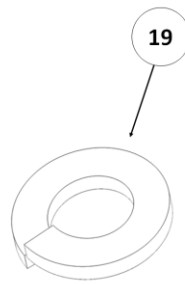
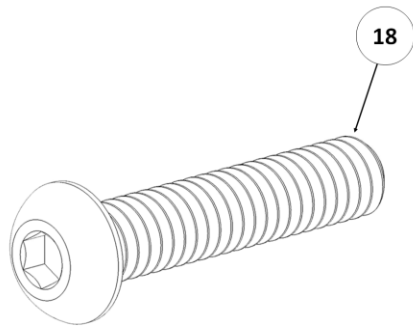

PARTS INCLUDED IN THIS LIST:

Item	QTY	Part Number	Description
22	4	MLP05-018	Round Base Magnet
23	2	MLP04-019	Center Belt
24	2	MLP04-0001	Shoulder Buckle Wand
25	2	MLP05-025	Buckle Cover Plate
26	1	ADUI20	Molded Prisoner Seat
27	2	MLP04-022	Waist Buckle

TOOLS NEEDED FOR INSTALLATION:

- ✓ Inch & Metric Wrench Set
- ✓ Inch & Metric Socket Set
- ✓ T45, T50, & T55 Torx Bit Socket
- ✓ 5/32" & 10MM Hex Bit Socket
- ✓ Ratchet & Ratchet Extension
- ✓ Tape Measure
- ✓ Cutoff Tool
- ✓ Razor Knife

ESTIMATED TIME FOR INSTALLATION: 1.5 – 2.0 Hours



**FORD INTERCEPTOR UTILITY SUV CENTER
BELT SYSTEM INSTALLATION
INSTRUCTIONS
5UF1911**

Important Notice: Read all instructions before starting the installation of the seat. Before drilling or installing any screw or fastener into the body of the vehicle it is imperative to ensure the drill bit or fastener will not penetrate any fuel line, fuel tank or brake lines.



INSTALLATION INSTRUCTIONS

PRODUCT SAFETY & LEGAL DISCLAIMER

- Read and understand all safety precautions and instructions before installing this product.
- **Review the product package and contents prior to beginning the installation.** We make every effort to provide a perfect product but we are human and a mistake may happen from time to time. Take care when opening the packaging and removing items. If a return is needed you will want to return the product in its original packaging if possible.
- This product is intended to be installed by a certified technician, therefore a certain level of competence and knowledge are assumed when reading these instructions.
- This instruction guide is provided as a GENERAL installation guide, some vehicles vary dimensionally and may require additional steps.
- **Make certain to completely unpack the contents of the shipping container. Unwrap all parts and inspect parts prior to installing.**
- Test fit the product on the vehicle prior to any third party modifications and or finishing. The manufacturer and distributors will not accept responsibility for third party charges, labor and or third part replacement modifications. Some modifications may void the factory warranty.
- Exercise due-diligence when installing this product. The manufacturer and distributors of this product will not accept any responsibility for vehicle damage or personal injury resulting from the installation of this product. Installation of this product is acceptance of this statement and releases the manufacturer/Distributors of this product from any direct or indirect liabilities.
- Careless installation and operation can result in serious injury or equipment damage.
- Once installation is complete, please return this guide along with other documentation included in this product back to the consumer for future reference. The manufacturer/distributors of this product do not guarantee this particular version will be available at a later date.
- All liability for installation and use rests with the owner/operator.



INSTALLATION INSTRUCTIONS

INJURY HAZARD

Please complete a shop and tool inspection prior to beginning the installation.

- Always make sure you have a clean, dry and well-lit work area.
- Always remove jewelry, loose fitting clothing and wear protective gloves and eye protection.
- Always use extreme caution when jacking or raising a vehicle for work. Set the emergency brake and use tire/wheel blocks and jack stands. Refer to the vehicle manufacturer handbook. Utilize the vehicle manufacturers designated lifting points.
- Always use appropriate and adequate care in lifting parts during disassembly and installation. Seek help in lifting heavy or large items into place. Utilize jacks and or lifting devices when available.
- Always ensure products are secure during disassembly and installation.
- Always wear eye protection and take steps to protect any exposed skin during the installations. Drilling, cutting and grinding plastic and metal may create flying particles that can cause injury.
- Always use extreme caution when drilling, cutting and or grinding on a vehicle. Thoroughly inspect the area to be drilled, cut or ground both on the bottom and top of the surface. Ensure no wires, exhaust or any type of liquid lines will or can be damaged while drilling, cutting or grinding. If objects that are not intended to be drilled or cut are in the way of the hole or cut, they will need to be relocated.
- Always assemble and tighten all fasteners per the installation instructions.
- Always route electrical cables carefully. Avoid moving parts, parts that may become hot and rough or sharp edges.
- Always insulate and protect all exposed wiring and electrical connections.

MAINTENANCE AND CARE

- Never use abrasive cleaners or polish compounds. Clean with a gentle soap and water.

INSTALLATION INSTRUCTIONS:

Step 1-Open the rear lift gate, and remove the rear cover from the load compartment, {Fig 1}.

Step 2-Remove the (2) OEM T55 Torx head screws, one per side, securing the front cover using a T55 Torx bit socket. Remove the front cover from the load compartment, {Fig 1}. Retain Torx head screws for later reinstallation.



INSTALLATION INSTRUCTIONS:

Step 3-Remove the foam filler from each side of the spare tire well, and the large foam filler from front area of the load compartment, {Fig 2}. There will be (2) OEM Hex head screws to hold a foam filler in, carefully remove the screws before attempting to remove the foam filler. Retain Hex head screws for later reinstallation. Once foam fillers have been removed, remove spare tire and cover. Retain all items for later reinstallation.

Note: Remove the electrical panel from the large foam filler. There may be 2 panels in select models. Retain electrical panel(s).

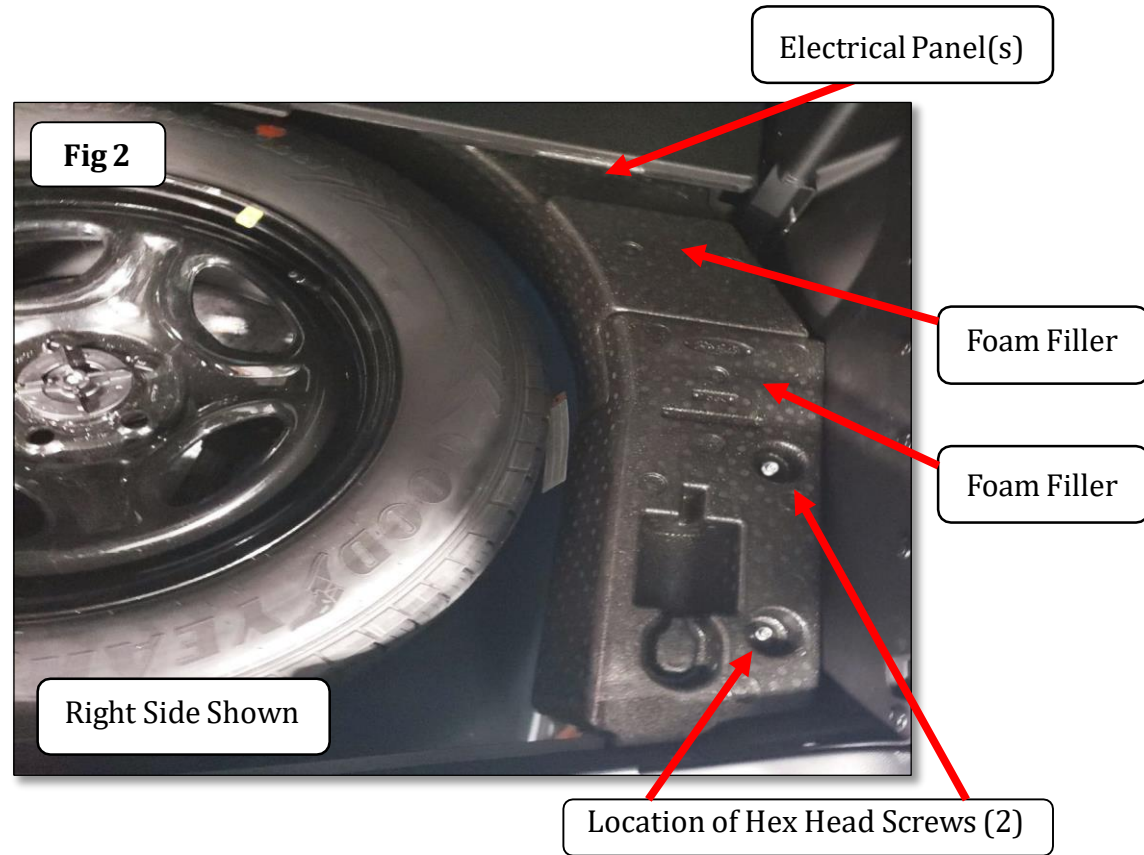

INSTALLATION INSTRUCTIONS:

Step 4-Remove 10 OEM nuts (2x-15MM, 8x-13MM) and/or screws securing the rear seat sections to the structure frame using a 13MM and 15MM socket. Remove the rear seat sections from rear of the vehicle, {Fig 3}. The OEM rear seat sections will not be reinstalled, handle/disposition accordingly.



INSTALLATION INSTRUCTIONS:

Step 5-On each side of the vehicle, unsnap the clips and remove the rear door sill plates, {Fig 4}. These will be retained for later reinstallation after modification.

Step 6-On each side of the vehicle, pull the rear door rubber weather stripping off the door opening to get it out of the way while removing the OEM shoulder belt while keeping the retractor in place, {Fig 4}.

You do NOT have to completely remove the weather stripping, just remove it until it is off the rear plastic trim.

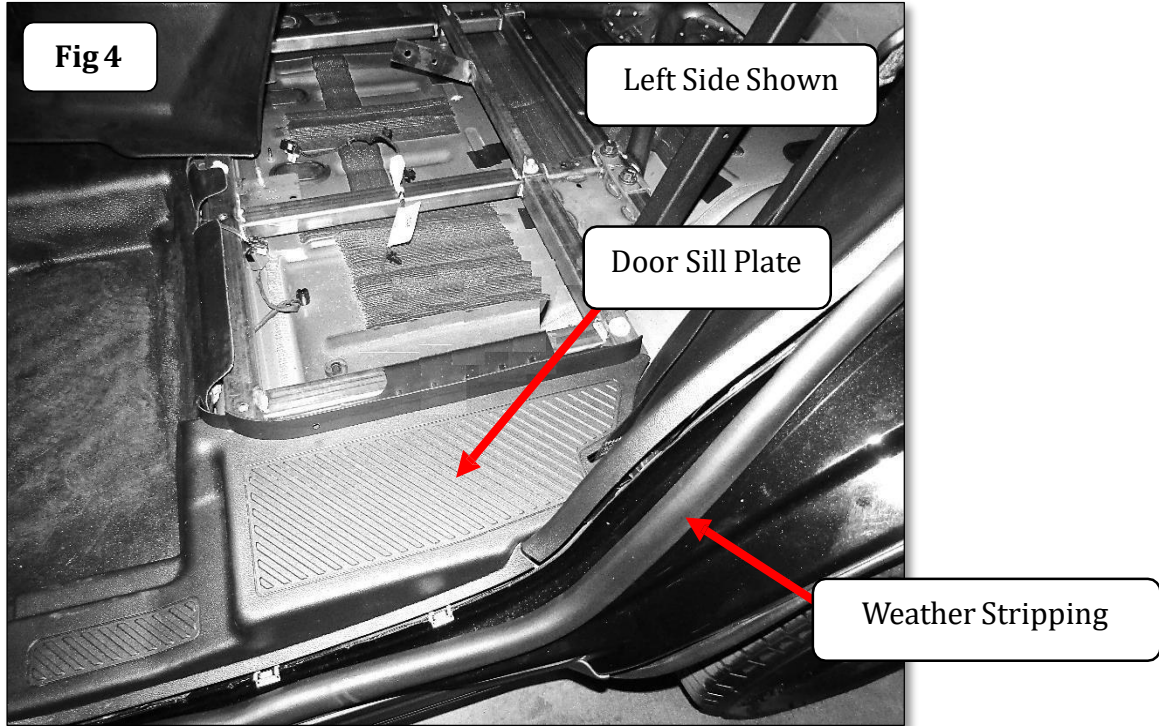

INSTALLATION INSTRUCTIONS:

Step 7-On each side of the vehicle, pull both plastic trim pieces away from the rear C-pillar. Start with the lower quarter trim.

Upon removal of lower quarter trim, (1) OEM 5/16" Hex head screw becomes accessible. Remove and retain screw for later reinstallation.

Remove the upper trim exposing the shoulder loop attachment and the retractor, {Fig 5}.

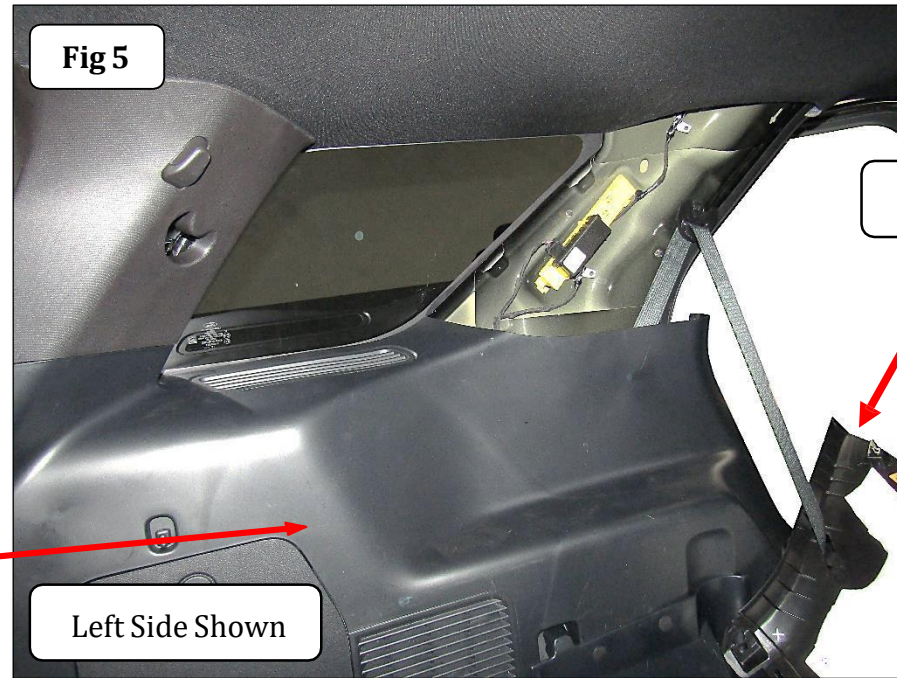

Lower Quarter Trim

Left Side Shown

C-Pillar Upper Trim

INSTALLATION INSTRUCTIONS:

Step 8-Using a 13MM socket remove the OEM 13MM Hex head screw from the floor anchor mount (may be discarded once removed), and the OEM 13MM Hex head screw and shoulder loop from the C-pillar, {Fig 6 & 7}. Remove the shoulder belt from the plastic upper trim and wrap any excess belt up and secure it to the retractor that is still attached to the vehicle. It is not necessary to remove the retractor from the vehicle. Simply secure the shoulder belt and retractor so that neither rattles when the vehicle trim is reattached later.

Note: If retractor is unplugged the electrical system will produce an Error code!

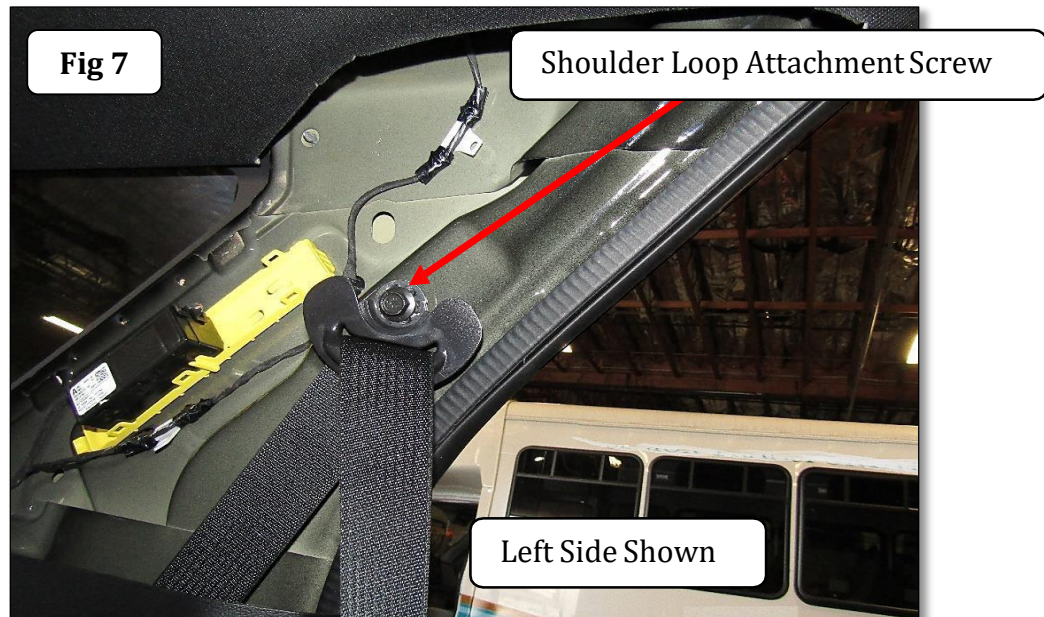
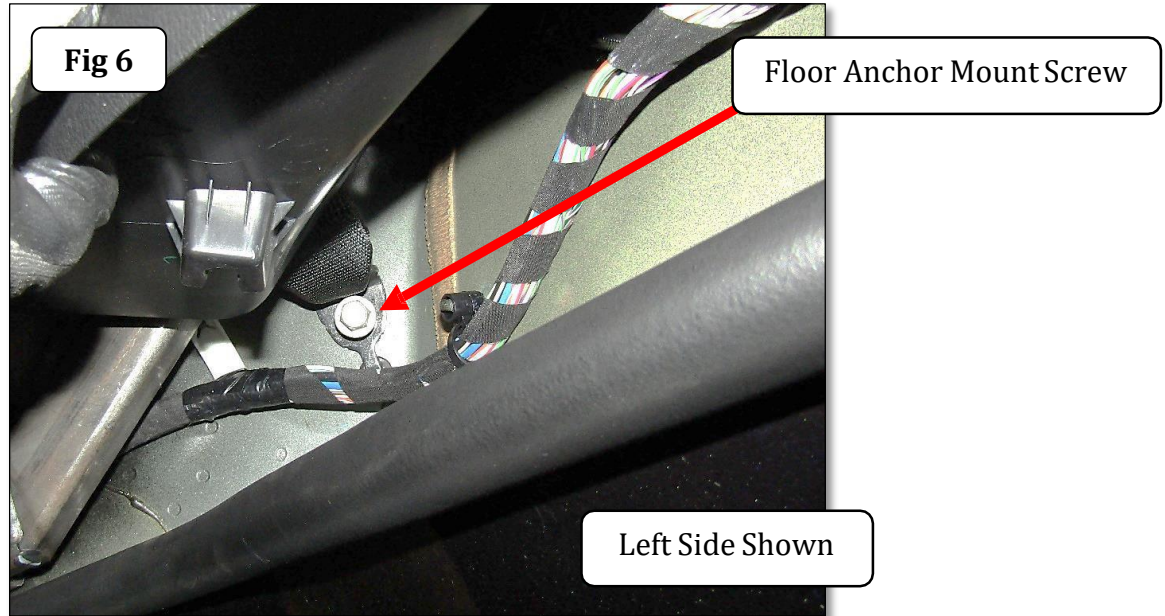

INSTALLATION INSTRUCTIONS:

Step 9-Insert the [Item 24] shoulder buckle wand through the slot in the upper plastic trim and attach the shoulder buckle anchor mount to the C-pillar using the OEM Shoulder Loop Attachment Screw and spacer (Note: OEM Shoulder Loop Attachment Screw, Buckle Anchor Mount, then OEM Spacer), {Fig 8}.

Note: During installation of Shoulder buckle make sure Plunger is facing toward the outside Of the car, on either side of the vehicle.

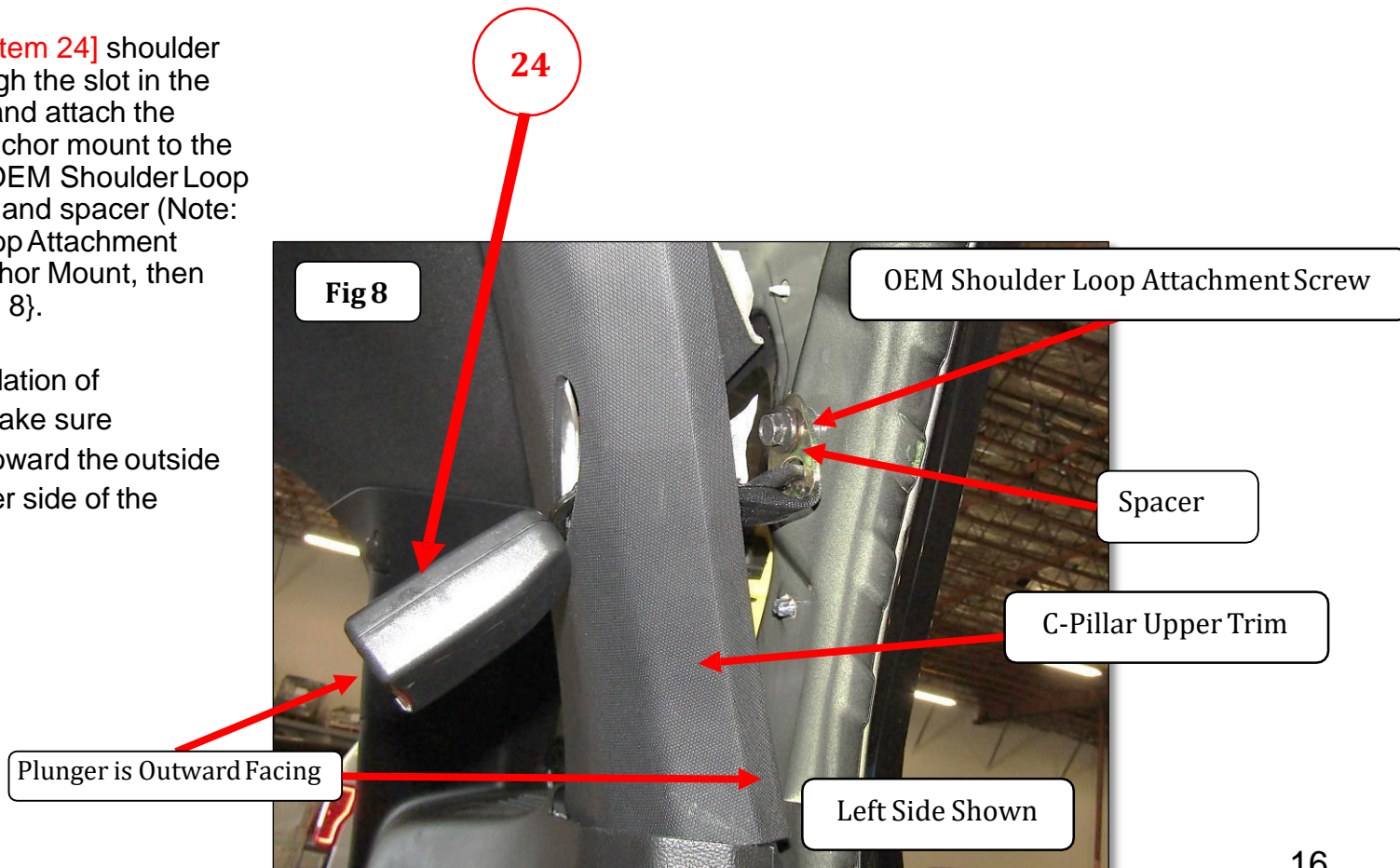

INSTALLATION INSTRUCTIONS:

Step 10-Securely tighten the OEM 13MM Head screw then reinstall the upper C-pillar trim and lower quarter trim panel, {Fig 9 }.

This is where the 5/16" Hex Head Screw is reinstalled. Repeat for the right side of the vehicle.

24

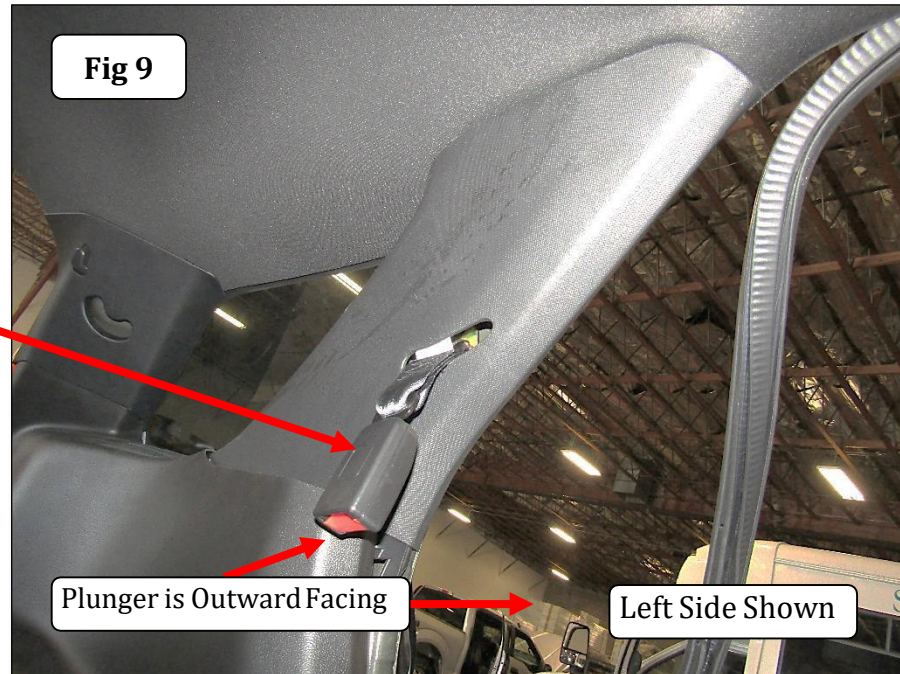

INSTALLATION INSTRUCTIONS:

Step 11-Position the rear crossbar in the vehicle, align the hole in each crossbar foot bracket with the OEM rear seat attachment holes in the structural frame and install (1) OEM seat 13MM Hex Head screw per side to secure the crossbar, {Fig 10}.

When inserting structural frame, align with OEM frame for best fit.

Insert all the screws but do not tighten until the crossbar has been properly seated in the frame or there may be problems with installation on either side of the crossbar.

Fig 10

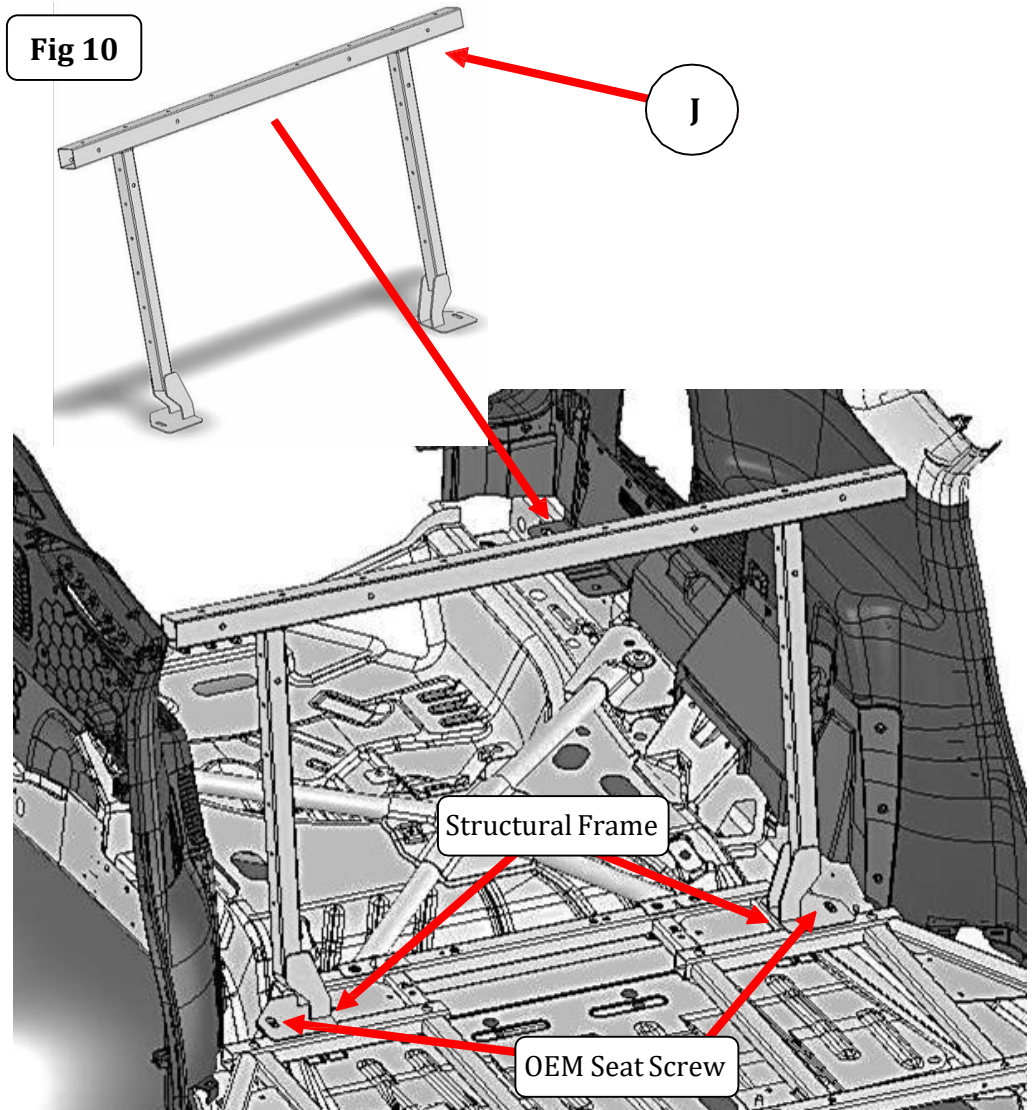

INSTALLATION INSTRUCTIONS:

Step 12-Install the center closeout panel first. Align the (2) holes in the top of the center closeout panel with the rivet-nuts installed in the rear crossbar main tube and attach the closeout panel to the crossbar main tube using (2) [Item 3] 1/4" - 20 X 1" Button head hex drive screws, (2) [Item 4] 1/4" lock washers, and (2) [Item 5] 1/4" flat washers, {Fig 11}. Do NOT tighten the screws until all panels have been installed or there may be problems with installation on either side of the vehicle.

Step 13-Next install the left side closeout panel. Align the (4) holes in the side of the closeout panel with the holes in the center closeout panel and the rivet-nuts installed in the vertical tube of the rear crossbar. Attach the left closeout panel and center closeout panel to the vertical tube of the rear crossbar using (4) [Item 3] 1/4" - 20 X 1" Button head screws, (4) [Item 4] 1/4" lock washers and (4) [Item 5] 1/4" flat washers, {Fig 11}. Do NOT tighten the screws until all panels have been installed. Repeat for the right side closeout panel.

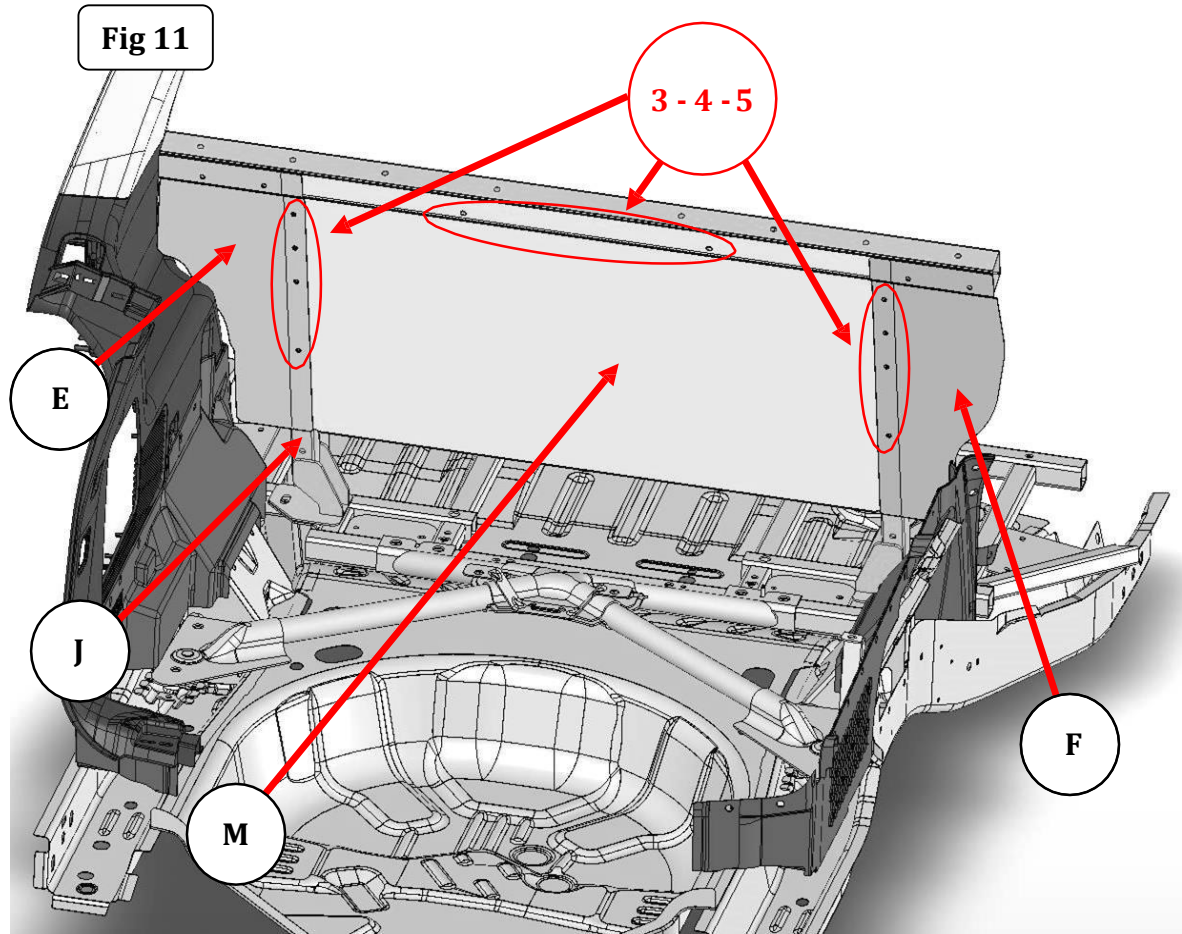

INSTALLATION INSTRUCTIONS:

Step 14-On each side of the vehicle, remove (1) OEM 18MM bolt securing the structural frame X-brace using an 18MM socket and ratchet.

Step 15- Align the hole in the foot bracket of each floor strut with the structural frame X-brace attachment hole and install (1) [Item 15] M12 X 1.75MM X 45MM socket head screw, (1) [Item 16] 12MM Split lock washer and (1) [Item 17] 12MM flat washer to secure the X-brace and each floor strut, {Fig 12}. Do not tighten the bolts until all components are seated correctly.

Step 16-Align the two holes in the bracket and attach the opposite end of each floor strut and closeout panel to the crossbar main tube using (2) [Item 3] ¼" X 1" button head screws, (2) [Item 4] ¼" lock washers, and (2) [Item 5] ¼" flat washers, {Fig 12}. Do not tighten the screws until all components are seated correctly.

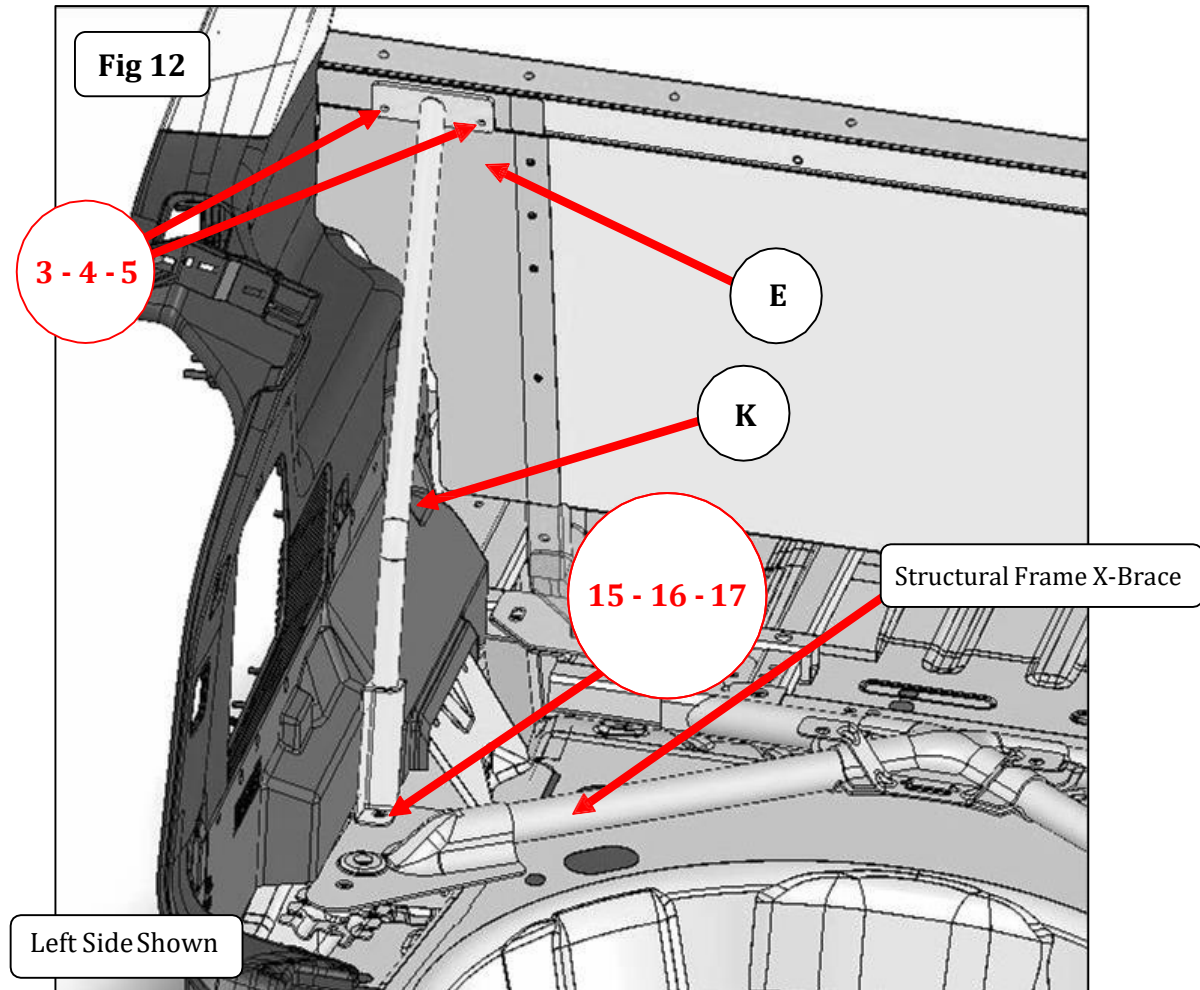

INSTALLATION INSTRUCTIONS:

Step 17-On each side of the vehicle, remove (1) OEM 13MM screw securing the structural frame to the floor of the vehicle using a 13MM socket and ratchet.

Step 18-Align the holes in the center belt bracket with the holes in the structural frame and reinstall the OEM screws, {Fig 13}. Securely tighten the screws.

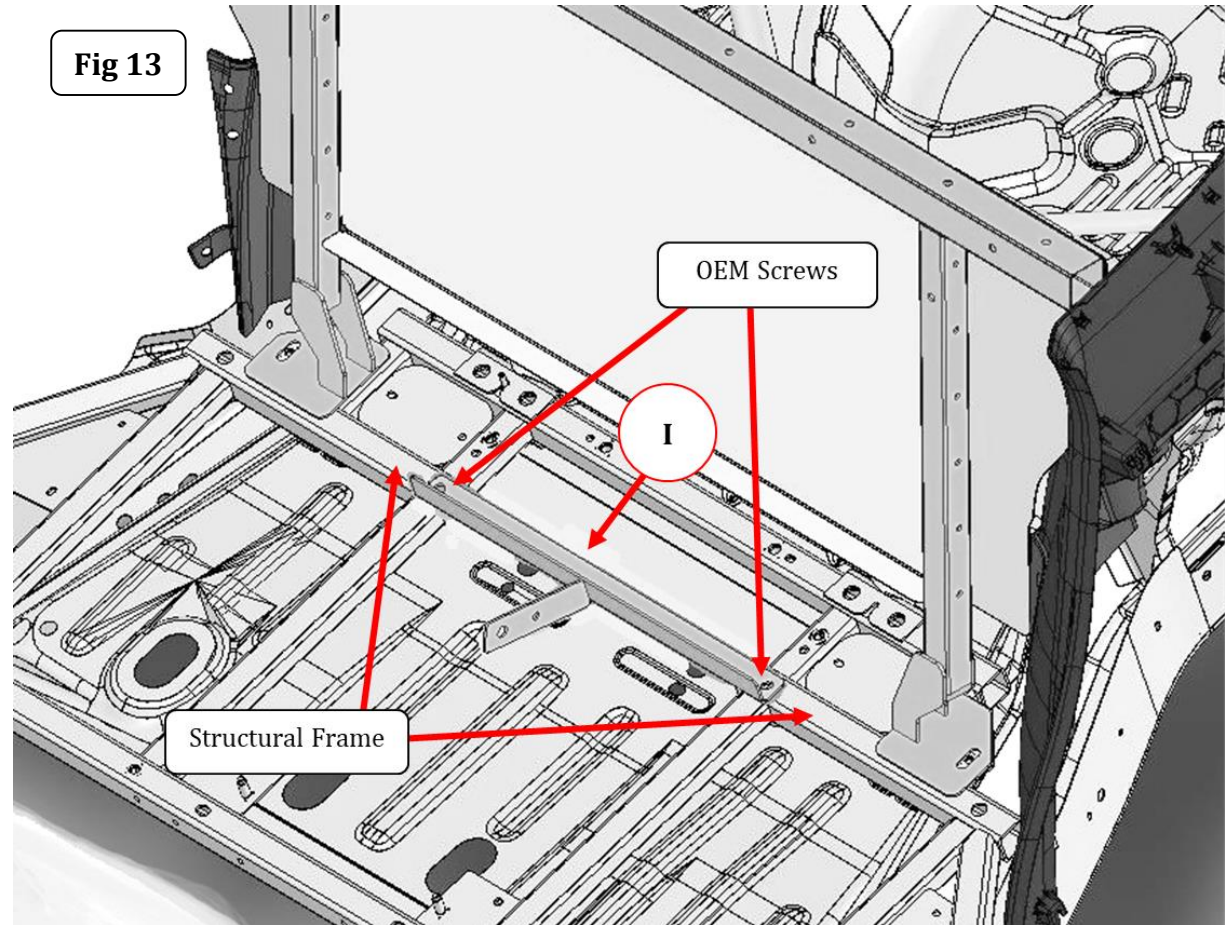

INSTALLATION INSTRUCTIONS:

Step 19-Using a T45 Torx bit socket remove the Torx head screw, seat belt buckle and wiring from each OEM rear seat section. Secure the (3) OEM seat belt buckles to the seat structural frame using cable tie wraps.

Note: The (3) OEM seat belt buckles must be reconnected to the wiring in the same position as when removed from the vehicle.

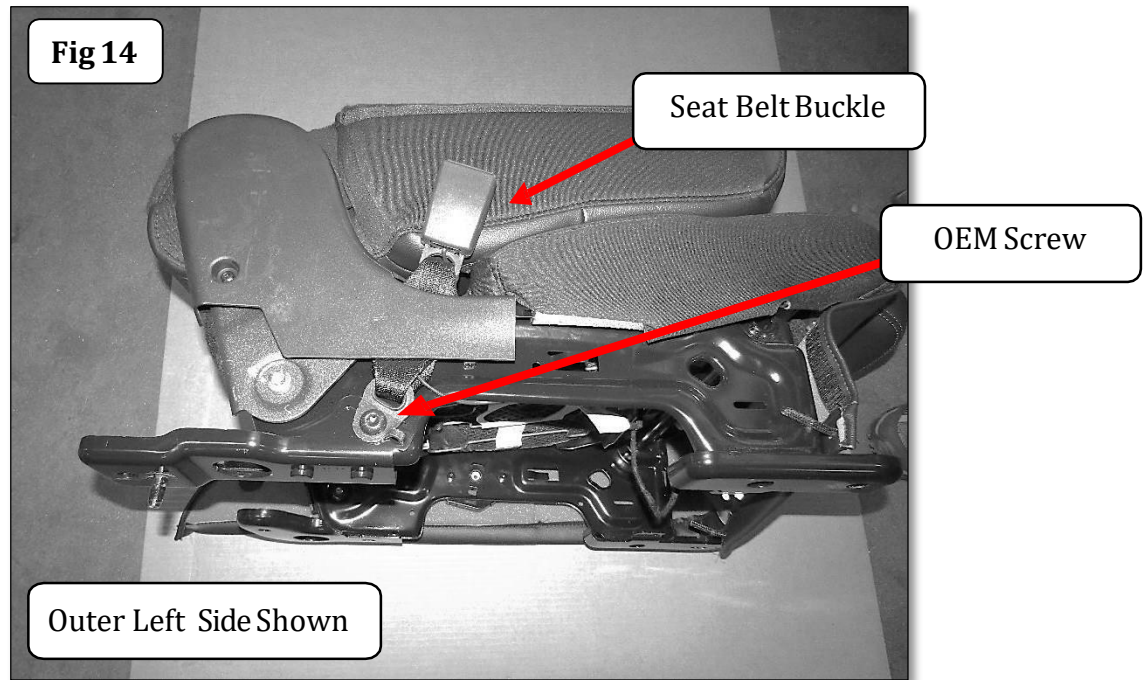

INSTALLATION INSTRUCTIONS:

Step 20-Attach each waist buckle [Item 27] to the outer belt buckle bracket using (2) [Item 3] ¼" - 20 X 1" button head screws, (2) [Item 5] ¼" flat washers and (2) [Item 6] ¼" - 20 lock nuts, {Fig 15}.

Note: Fully tightened the button head screws and nylon lock nuts, then loosen the lock nuts a full turn to allow the buckle to slide freely front to back and tilt slightly from side to side.

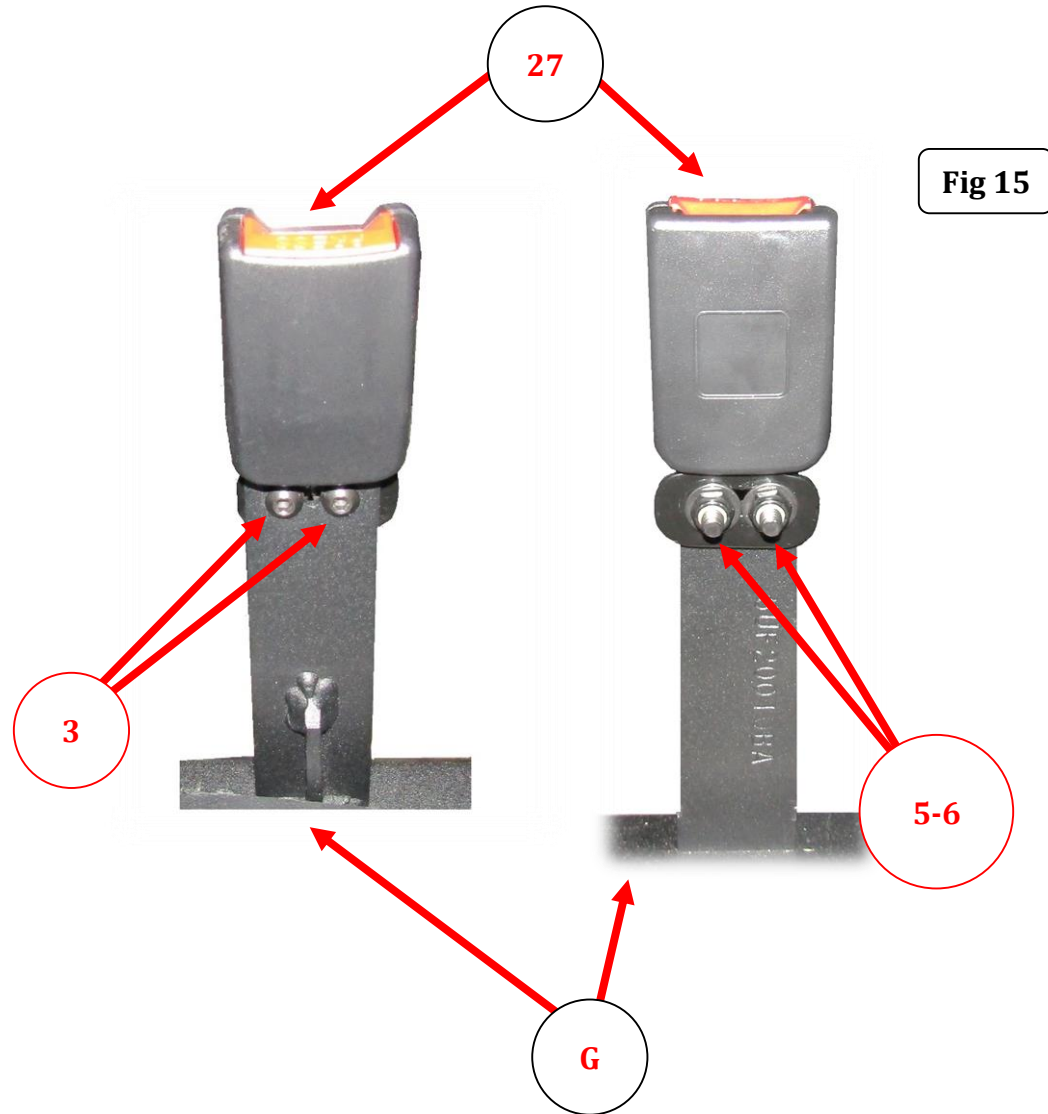

INSTALLATION INSTRUCTIONS:

Step 21-Align the holes in each outer seat belt bracket with the holes in the structural frame and install (2) [Item 7] Hex Head Screws 5/16" – 18 X 1" (2) [Item 8] 5/16" flat washers and (2) [Item 9] 5/16" serrated flange locknuts to secure the outer seat belt bracket to the structural frame, {Fig 16}. Securely tighten the nuts and screws.

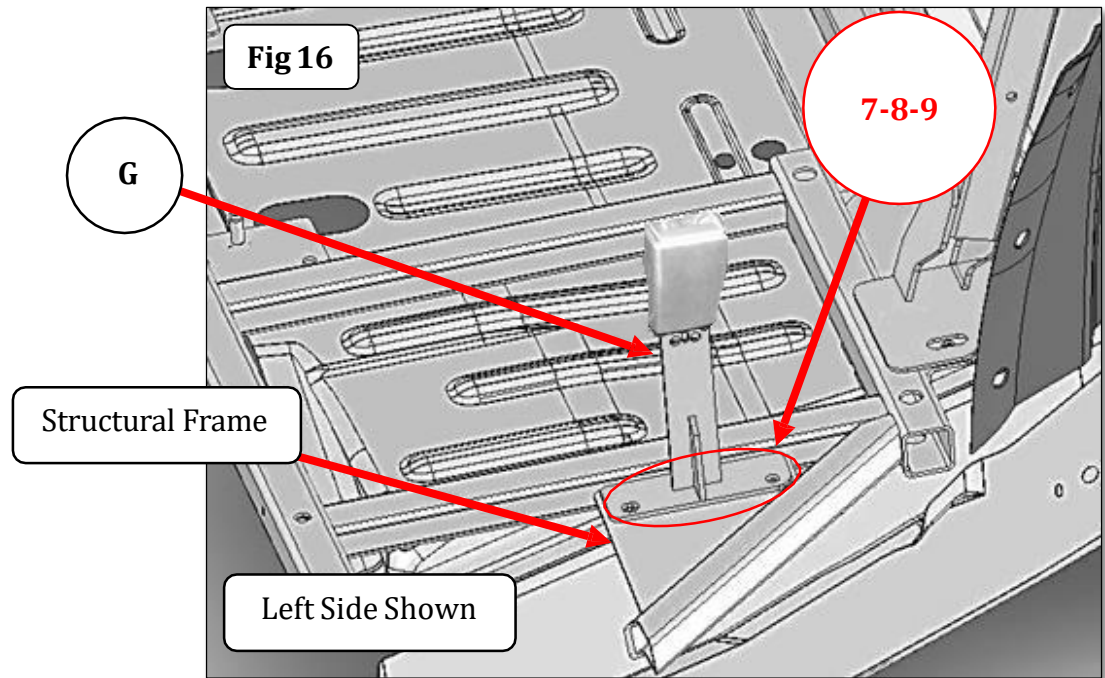

Step 22-A section in each rear door sill plate must be cut down and removed to allow clearance for the molded seat and outer seat belt bracket, {Fig 17}. Cut on dotted red line in diagram to remove the section from each door sill plate. Reinstall the rear door sill plates.

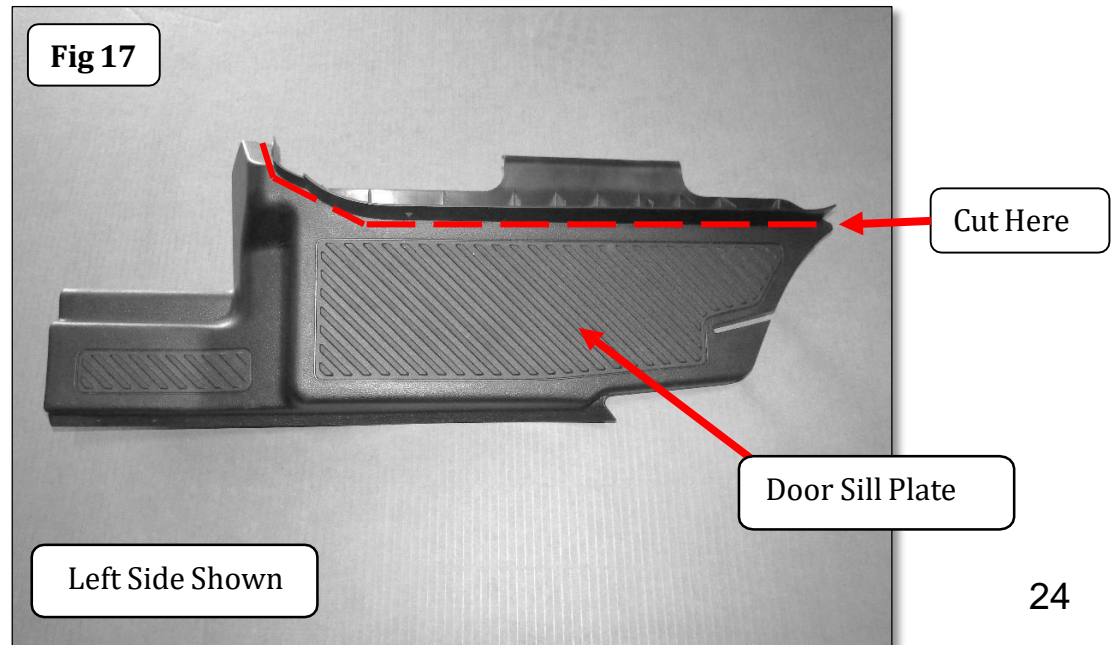

INSTALLATION INSTRUCTIONS:

Step 23-Align the holes in the left side seat adapter bracket with the holes in the bracket welded to the right side seat adapter bracket, {Fig 18}.

Install (6) [Item 18] 3/8" x 1 1/4" button head screws (12) [Item 19] 3/8" flat washers, (6) [Item 20] 3/8" lock washers and (6) [Item 21] 3/8" hex nuts to secure the left side bracket to the right side bracket.

Place the assembled seat adapter brackets on a flat surface, align and securely tighten the nuts and screws.

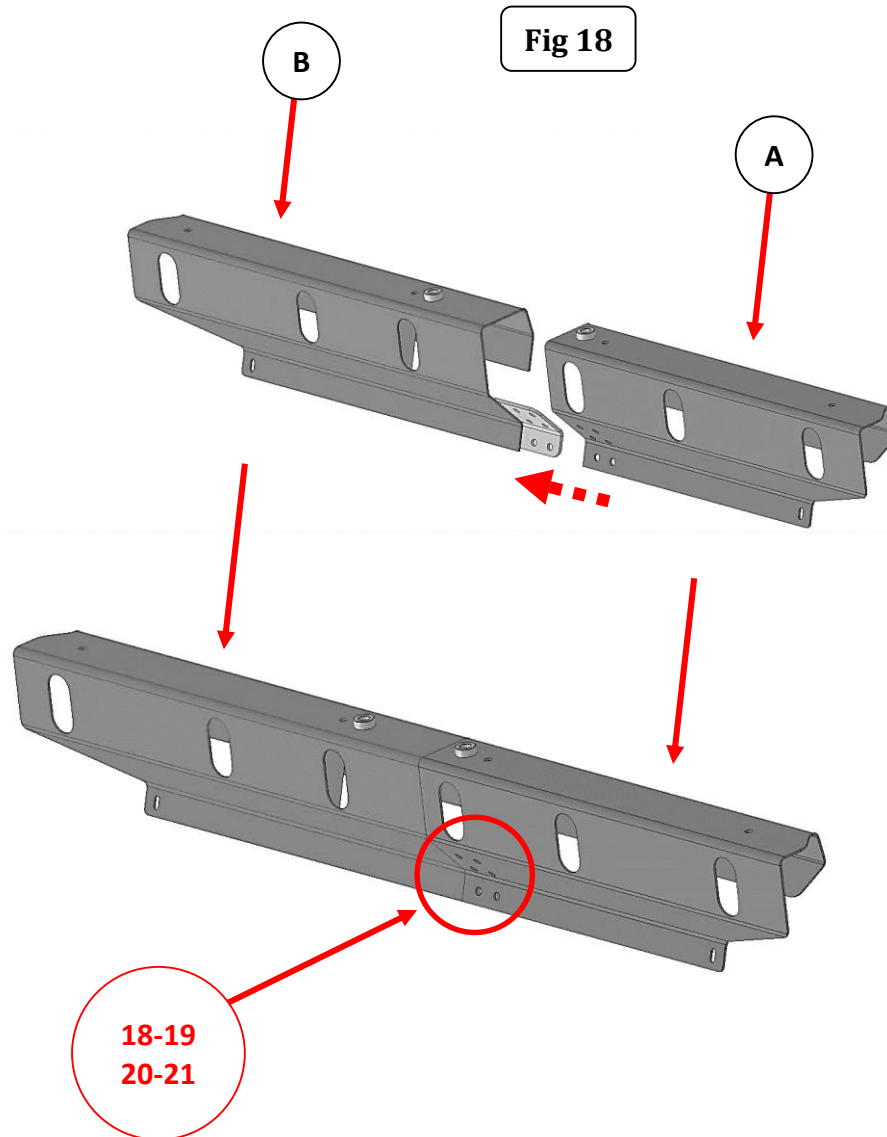
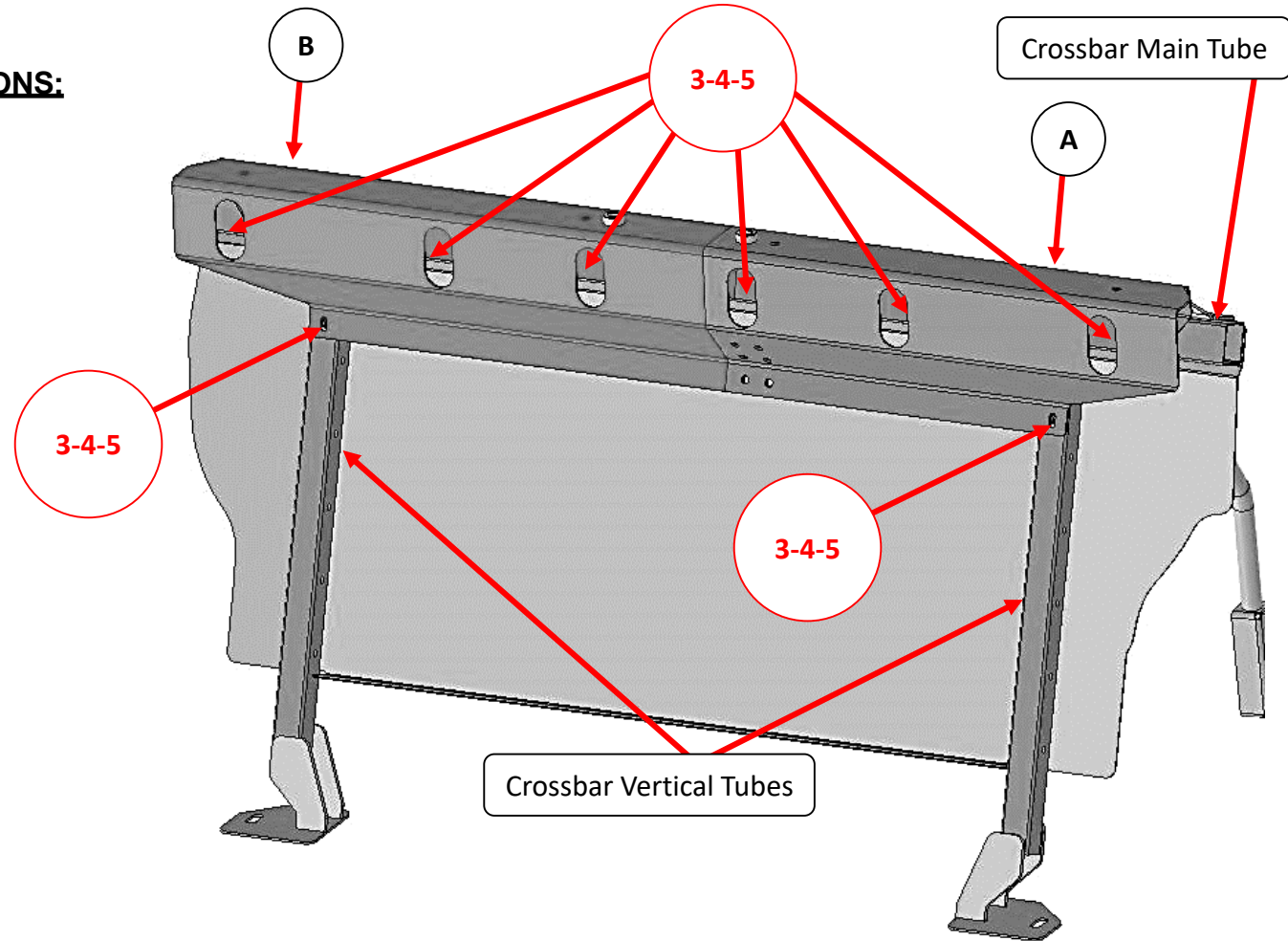

Fig 19

INSTALLATION INSTRUCTIONS:

Step 24-Align the holes in the seat adapter with the rivet-nuts installed in the crossbar main tube and crossbar vertical tubes, {Fig 19}.

Attach the seat adapter to the crossbar main tube using (8) [Item 3] 1/4" - 20 X 1" button head screws, (8) [Item 4] 1/4" lock washers, and (8) [Item 5] 1/4" flat washers. Securely tighten the screws.



INSTALLATION INSTRUCTIONS:

Step 25-Place the [Item 26] molded prisoner seat in the vehicle so the outer seat belt buckles protrude through the rectangular opening on each side of the seat. Align the holes in the top of the seat with the rivet-nuts installed in the crossbar and attach the top of the seat to the crossbar using (5) [Item 3] ¼" – 20 X 1" button head screws, (5) [Item 4] ¼" Split lock washers, and (5) [Item 5] ¼" flat washers, {Fig 20}.

Step 26-Align the holes in the base of the seat with the holes in the structural frame and attach the seat to the structural frame using (4) [Item 13] M10 X 1.50MM X 35MM button head screws and (4) [Item 14] M10 flat washers, {Fig 20}. Securely tighten the screws holding the top and base of the seat.

Fig 20

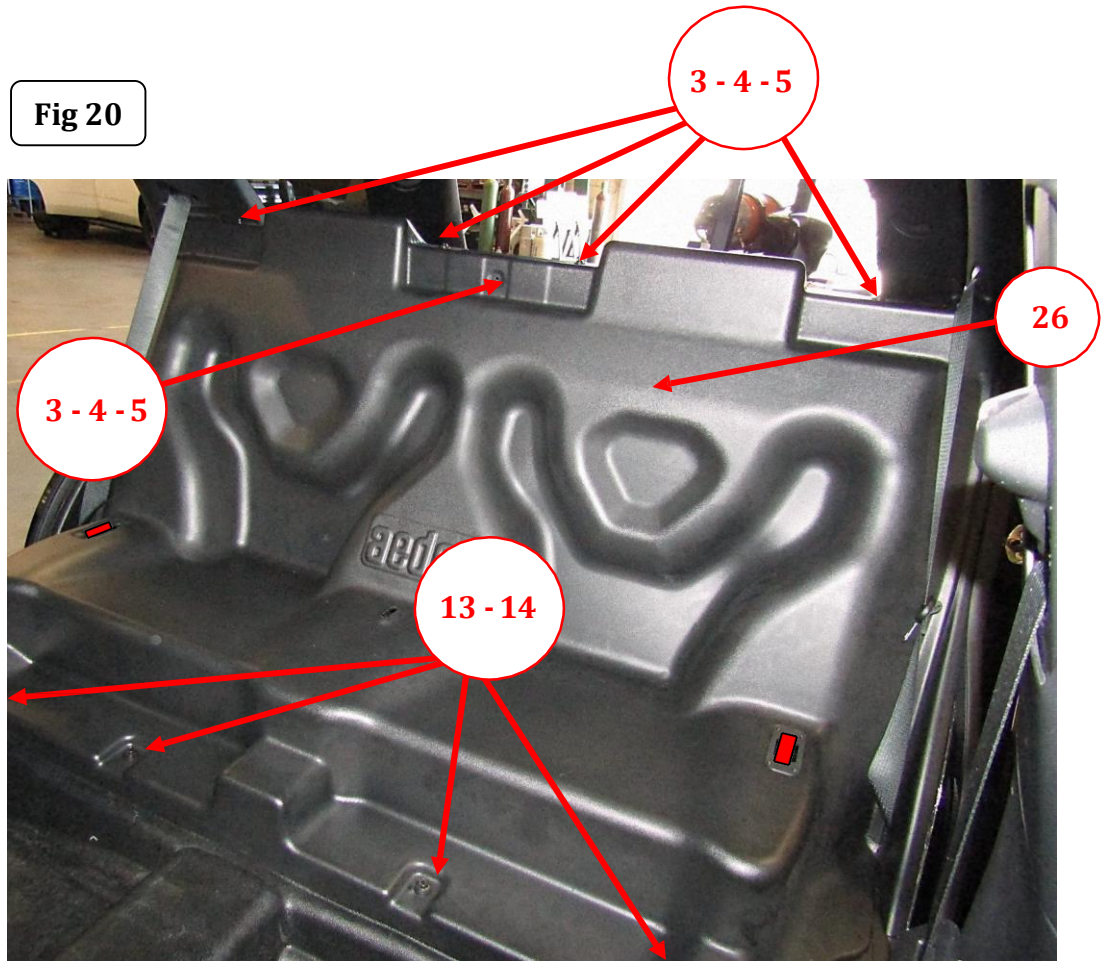

INSTALLATION INSTRUCTIONS:

Step 27- Loosen the (7) nuts and screws on each side of the rear screen window assembly. Align the three slots with the screws and slide the polycarbonate upper filler panel into position between the screen window frame and the window frame support bracket then retighten the nuts and screws, {Fig 21}. Repeat for the left side.

Note: Make sure to peel off and/or remove the protective film from the panels before installing.

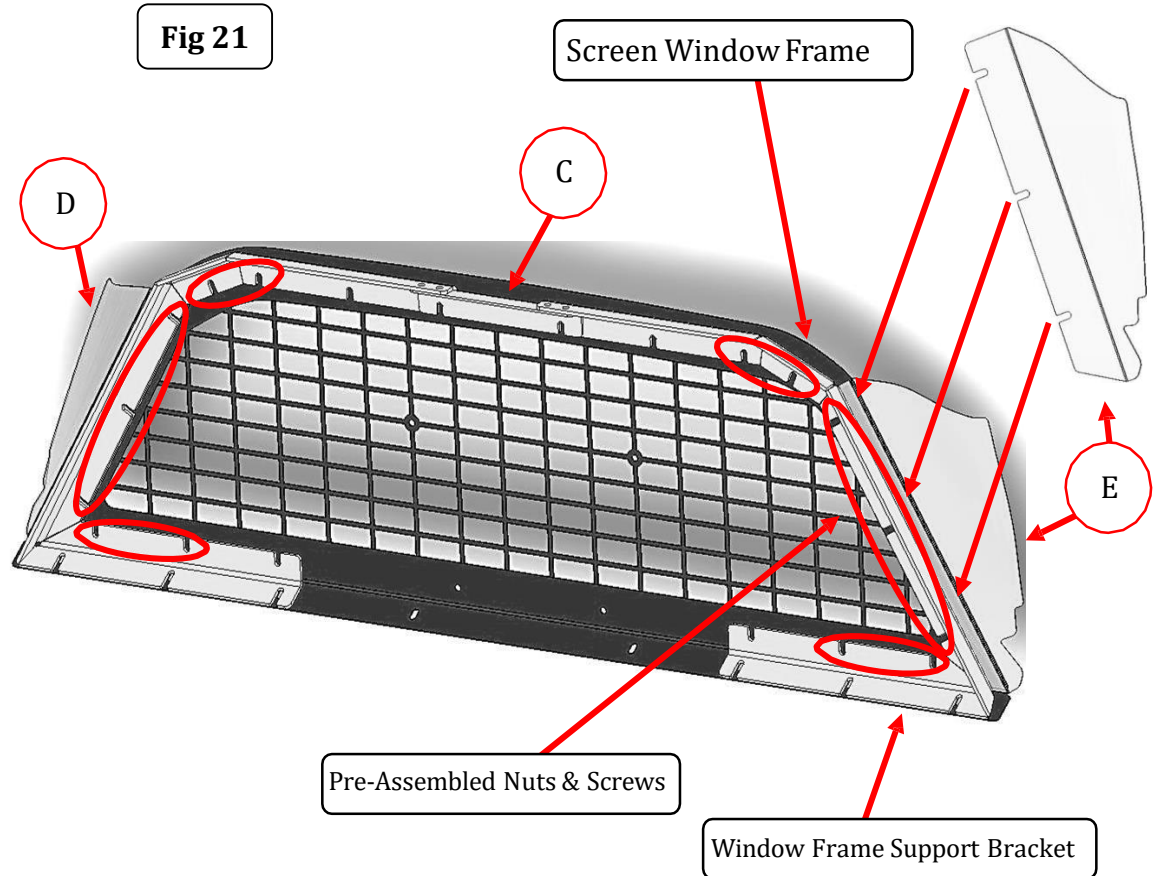

INSTALLATION INSTRUCTIONS:

Step 28- With assistance place the rear screen window and upper filler panel assembly through the cargo area of the vehicle. Attach the screen window frame and the window frame support bracket to the rear crossbar main tube using (8) [Item 3] ¼" - 20 X 1" button head screws, (8) [Item 4] ¼" lock washers, and (8) [Item 5] ¼" flat washers, {Fig 22}. Securely tighten the screws.

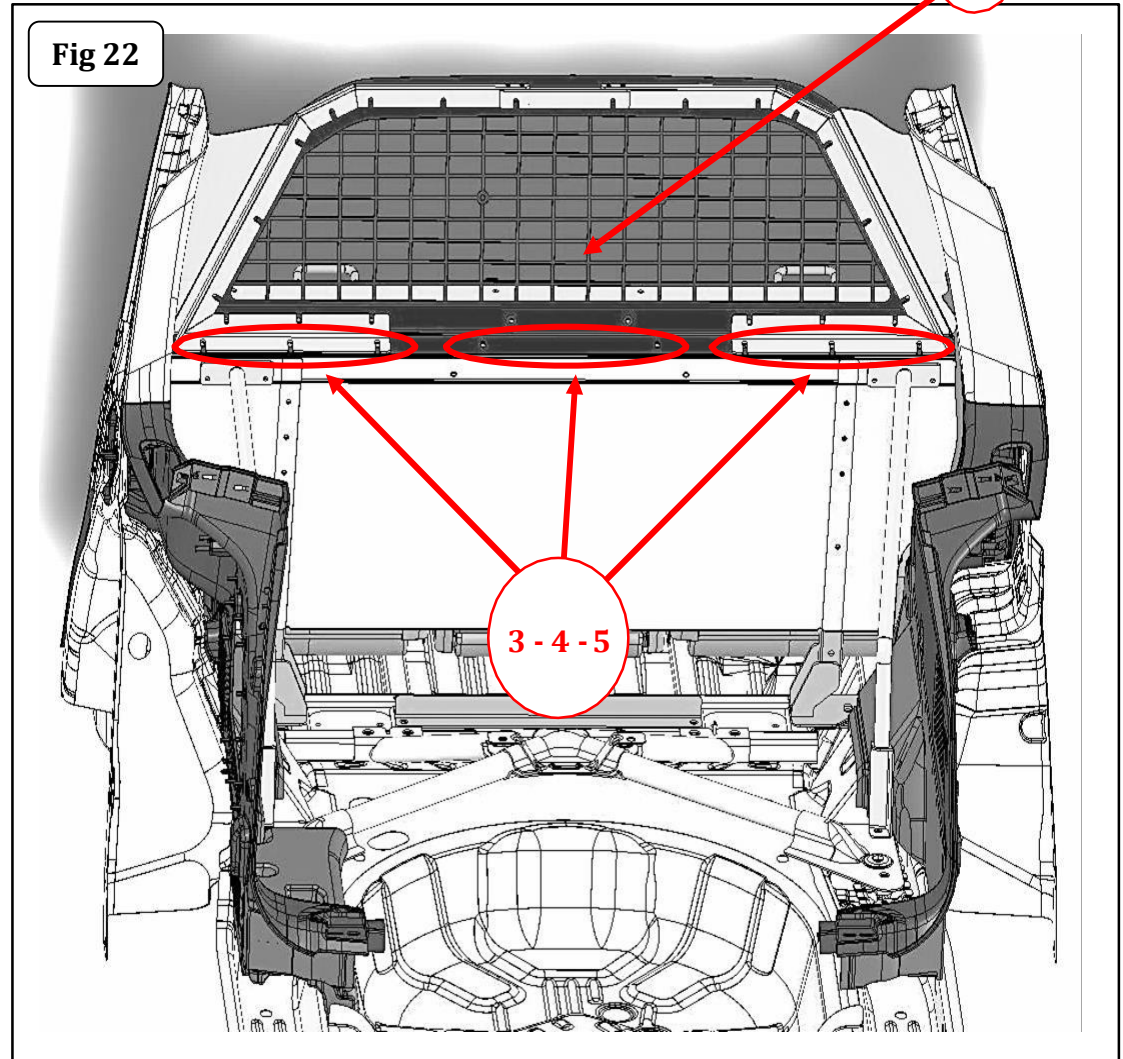

INSTALLATION INSTRUCTIONS:

Step 29-Install the center belts. One [Item 23] center belt goes on each side of the center belt bracket. The shorter (waist) belt should be on the inside while the longer (shoulder) belt will be on the outside, {Fig 23}. Attach the center belts to the center belt bracket using (1) [Item 10] ½" – 13 X 1 ½" hex head screw, (2) [Item 11] ½" flat washers and (1) [Item 12] ½" - 13 nylon-insert locknut, {Fig 24}. Securely tighten the nut and screw.

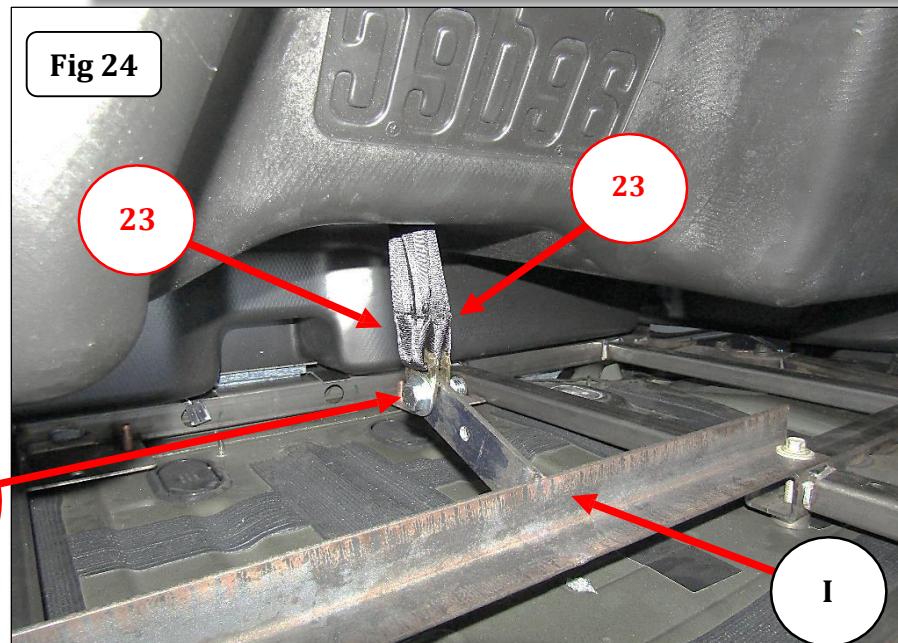
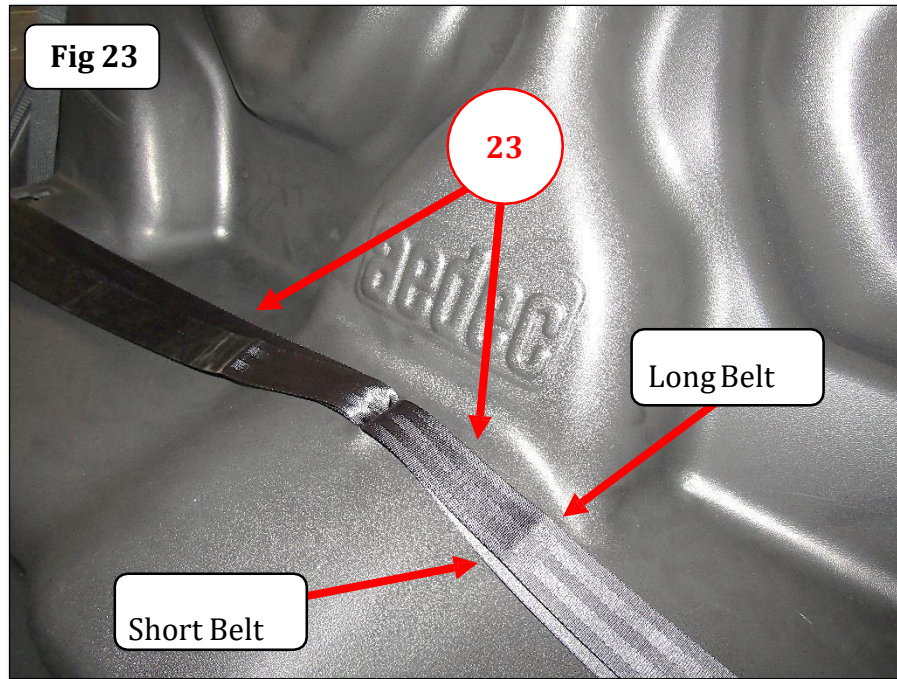

INSTALLATION INSTRUCTIONS:

Step 30-Attach the [Item 25] outer seat belt buckle cover plates to the molded seat using the [Item 1] Phillips Rounded Head Number 6 ½” screws provided (4 for each trim plate), {Fig 25}.

Note: The plunger should be facing outwards for proper installation.

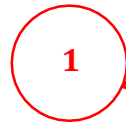
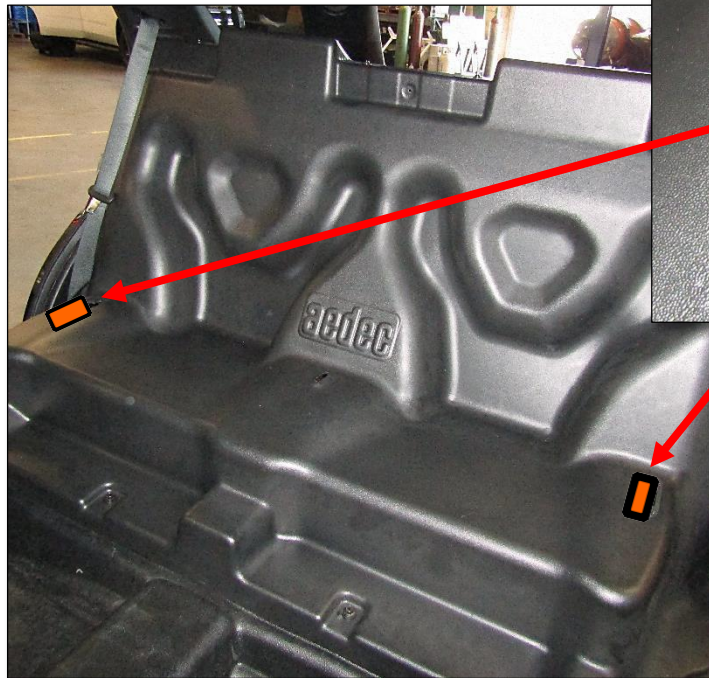
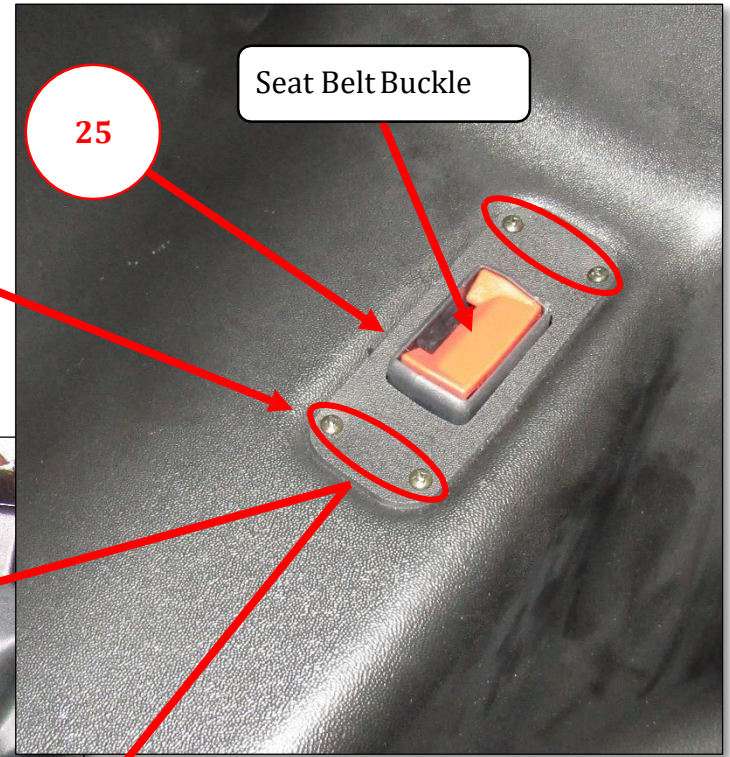

Fig 25



INSTALLATION INSTRUCTIONS:

Step 31-With the large foam filler removed, measure rearward from the front to the center of the Ford logo, cut off the front section of the large foam filler, {Fig 26}. A handsaw, or equivalent, is recommended as the method of cutting.

Once properly cut, reinstall into vehicle.

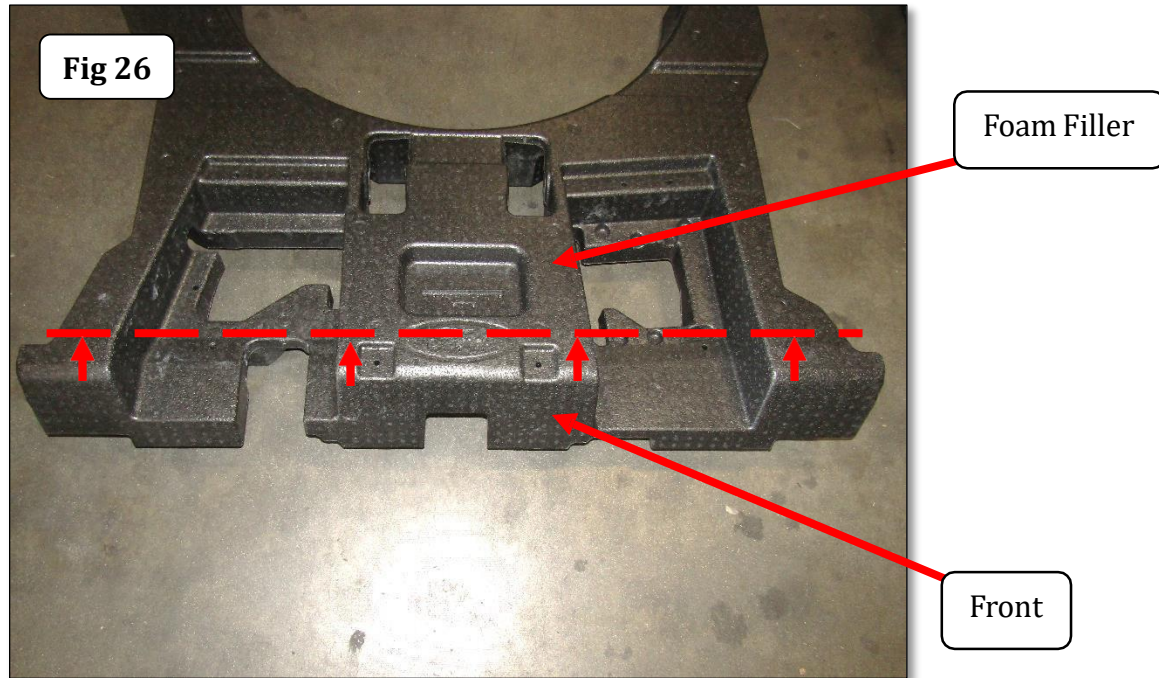

INSTALLATION INSTRUCTIONS:

Step 32-Reinstall the large foam filler and the foam filler from each side of the tire well, {Fig 27}. Reattach the electrical panel(s).

Step 33-Replace spare tire and cover.

Step 34-Reinstall the front cover and screws, then the rear cover in the load compartment, {Fig 28}.

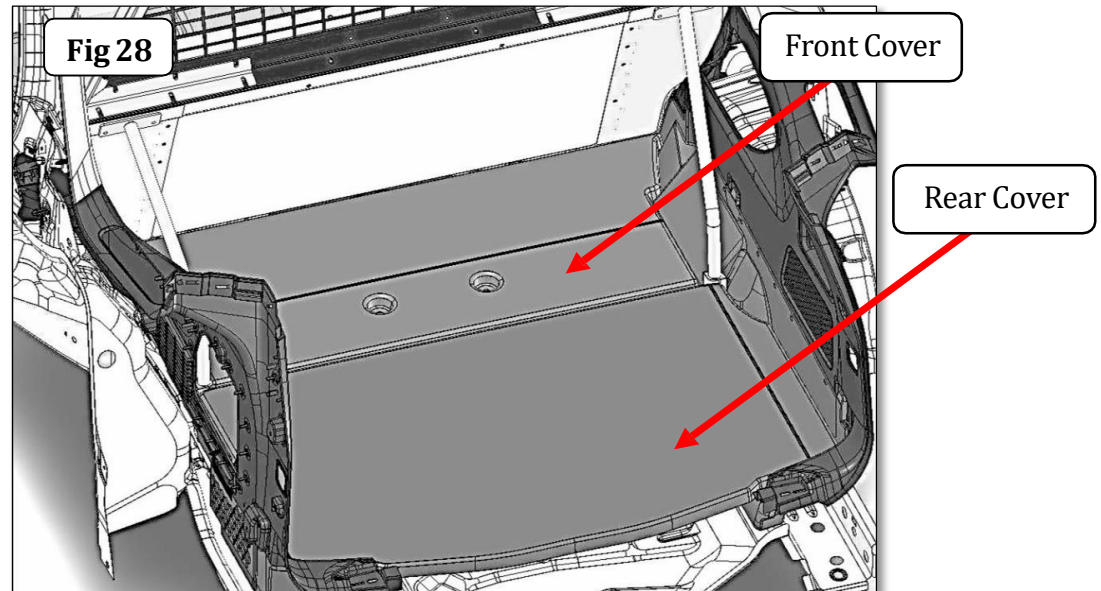
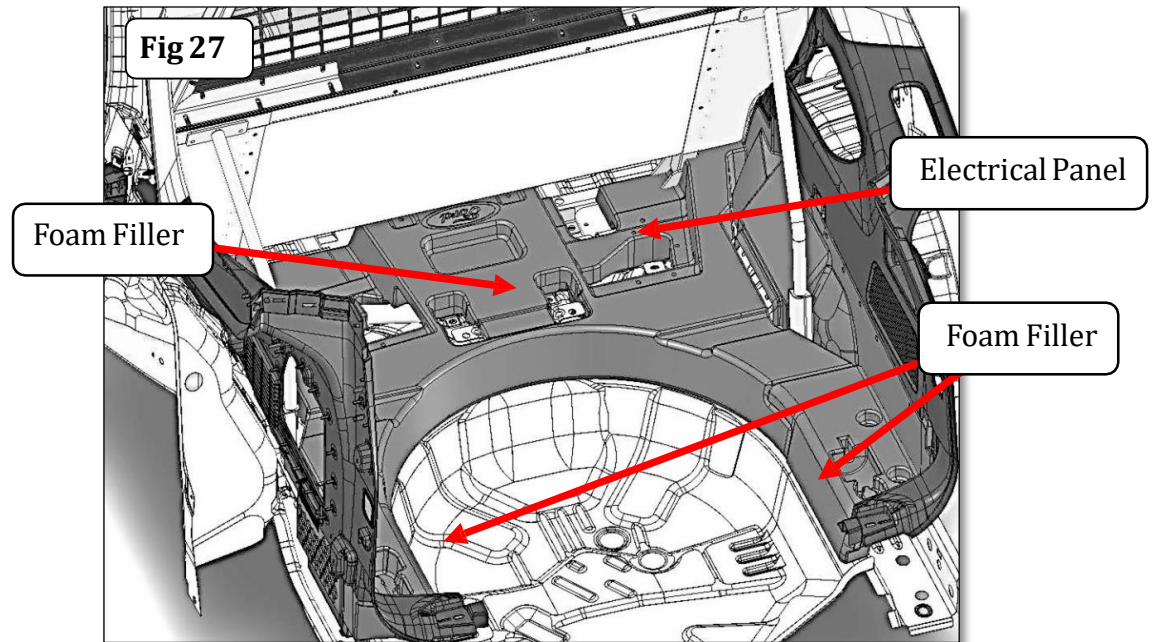

INSTALLATION INSTRUCTIONS:

Step 35-Using (1) [Item 2]
Countersink screw attach 1 [Item 22]
Round Base Magnet to Retainer
Cover located on the Center belt
assembly, {Fig 29 & 30}.

Note: Do not overtighten Countersink
screw.

***At this point assembly is complete.

Fig 29

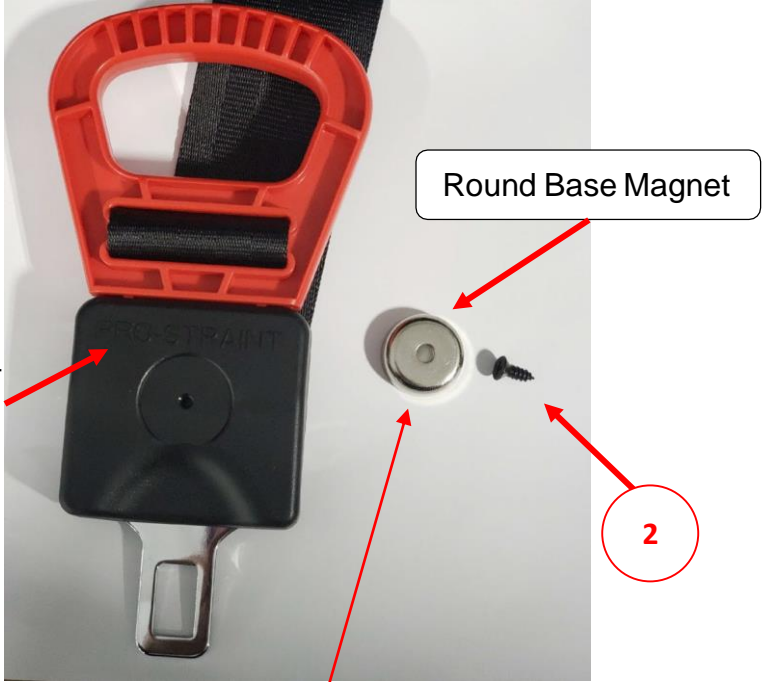

Fig 30

