

# **IMPORTANT**

## **READ BEFORE YOU BEGIN INSTALLATION**

**IT IS CRITICAL FOR YOUR SAFETY THAT YOU CAREFULLY READ AND FOLLOW THE SAFETY CAUTIONS AND INSTALLATION INSTRUCTIONS BOTH PRIOR TO AND DURING INSTALLATION.**

### **USER SAFETY CAUTION**

During installation, be mindful of the potential for sharp edges on the product or vehicle. Taking proper safety precautions helps ensure a safe and smooth installation process.

**Always wear protective gloves and handle components with care to reduce the risk of injury.**



### **TEMPERATURE SURFACE CAUTION**

During high temperatures or extended sun exposure, surfaces of this product may become hot to the touch, posing a risk of burns or injury. Use caution when handling the product in hot weather and allow time for it to cool before contact.

**Always check surface temperature before use to ensure safe handling conditions.**



### **FASTENER TORQUE CAUTION**

All fasteners must be tightened to the specified torque values provided in the installation instructions to ensure proper fit and safe operation of the tonneau cover. Under- or over-tightening can lead to product failure, potential damage to your vehicle, injury, or safety hazards while driving.

**Always use a calibrated torque wrench and follow the specifications in the installation instructions.**

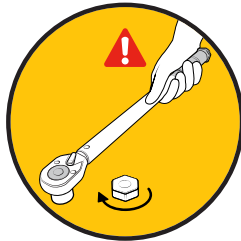

### **PINCH POINT SAFETY CAUTION**

This tonneau cover may create pinch points when closing or operating near solid surfaces such as the truck bed rails or tailgate. To prevent injury, keep hands, fingers, and other body parts clear of moving parts during operation.

**Always operate the cover slowly and with caution to ensure safe and proper use.**



# **IMPORTANT**

## **READ BEFORE YOU BEGIN INSTALLATION**

**IT IS CRITICAL FOR YOUR SAFETY THAT YOU CAREFULLY READ AND FOLLOW THE SAFETY CAUTIONS AND INSTALLATION INSTRUCTIONS BOTH PRIOR TO AND DURING INSTALLATION.**

### **ENTRAPMENT SAFETY WARNING**

This tonneau cover does not feature a manual release mechanism from inside the truck bed. To prevent the risk of entrapment, never allow anyone to be inside the bed of the truck when the cover is closed.

**Always ensure the area is clear before closing the cover, and keep the cover securely latched when not in use to avoid accidental closure.**



### **COVER ATTACHMENT WARNING**

A partially rolled up or unsecured cover may detach during transit, risking vehicle or property damage and personal injury.

**Always verify the tonneau cover is properly secured before operating the vehicle.**

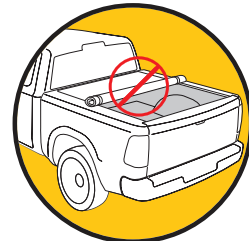

### **CARGO TRANSPORT WARNING**

When transporting cargo that is taller than the truck bed, the cover must be fully rolled open and securely fastened with both retainer straps. An unsecured cover can detach while driving, risking vehicle or property damage and personal injury.

**Never operate the vehicle with a partially rolled up cover.**



### **COVER POSITION WARNING**

Before operating the vehicle, always verify the tonneau cover is either fully rolled open and secured with both retainer straps or fully rolled closed and securely latched down.

**Never operate the vehicle if the tonneau cover is not properly secured.**

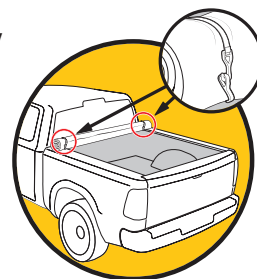



**TOYOTA TACOMA 2024+  
SRX & SR3 SOFT ROLL-UP  
INSTALLATION SHEET**

**Any damaged or missing parts?**

Parts will be shipped to you directly.

Call 855-427-4568, Mon - Fri, 8:00 a.m.- 9:00 p.m. EST,  
Sat 9:00 a.m. - 8:00 p.m. EST.

**NOTE:** It is important that all the areas where the bed cover mounts to the truck are clean and free of debris before installation.

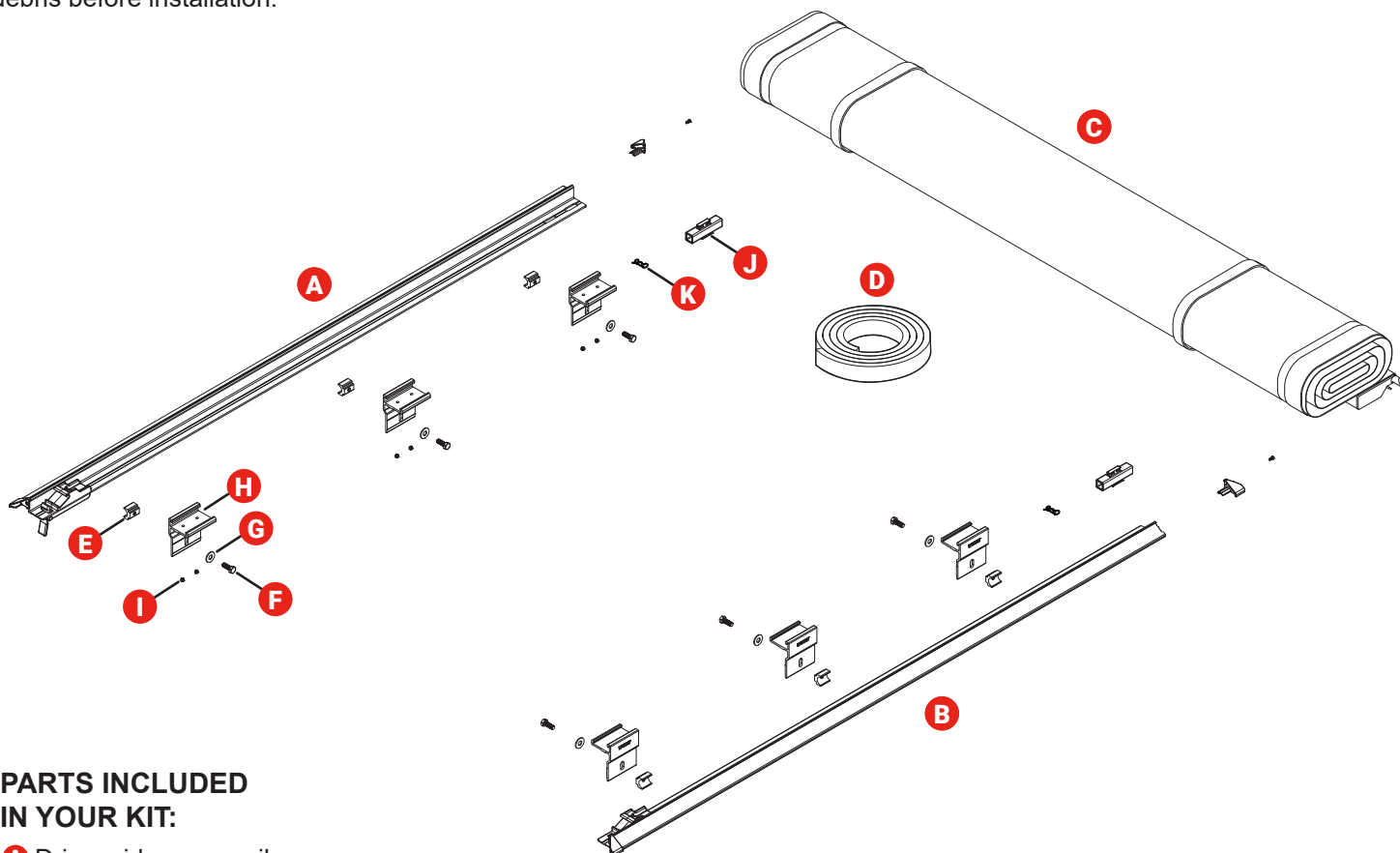

**PARTS INCLUDED  
IN YOUR KIT:**

- A** Driver side cover rail
- B** Passenger side cover rail
- C** Roll cover
- D** Bulkhead seal

**PARTS INCLUDED  
IN HARDWARE BAG:**

- E** 6x Anchor block
- F** 6x Screw 5/16-18 x 7/8"
- G** 6x Washer 5/16"
- H** 6x Rail attachment bracket
- I** 12x Set screw 1/4"
- J** 2x Tension block
- K** Hitch pin
- L** 2x Plastic washer
- M** 2x Square head cap screw
- N** 2x Nylock nut
- O** 2x Corner support block weather seal

**TOOLS REQUIRED**

- 9/16 Socket or wrench
- 1/2 Socket or wrench
- 3/8 Ratchet drive

**TOOLS PROVIDED**

- 1/8 Allen hex head wrench

**TOOLS RECOMMENDED**

- Isopropyl alcohol
- Scissors/utility knife

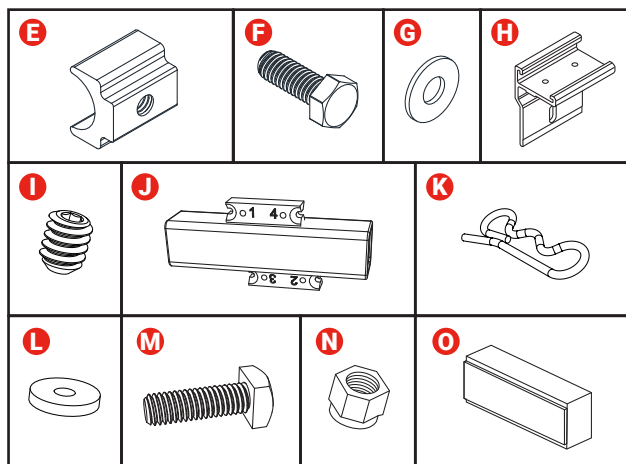

- 1** The serial number for the cover is located here.

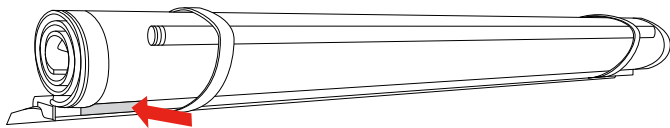

For future reference, write it here:

\_\_\_\_\_

- 2** It is important that all the areas where the bed cover mounts to the truck are clean and free of debris before installation.

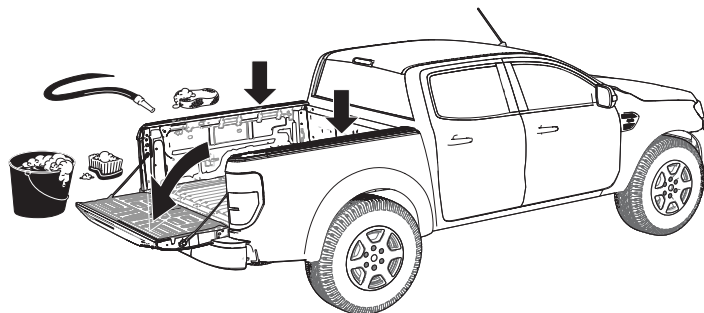

- 3** **Install the bulkhead weather seal (D) to the truck's front bulkhead:** Clean the area where the seal will go with soap and water to remove dirt and debris. Then clean the area with isopropyl alcohol to remove wax or grease and to evaporate any remaining water, allow the surface to dry. Then position the seal and apply pressure to the entire seal to make sure the adhesion is good.

**Install corner support block seals (O):** Peel off the protective layer to expose the adhesive surface of the weather seal. Apply the corner support block seals to the front corners of the truck bed. Position them carefully into the front corners of the truck bed, right under the bulkhead seal. Ensure that they are aligned properly and positioned where the bulkhead seal lacks support from the cargo rail. Do this at both front corners of the truck box.

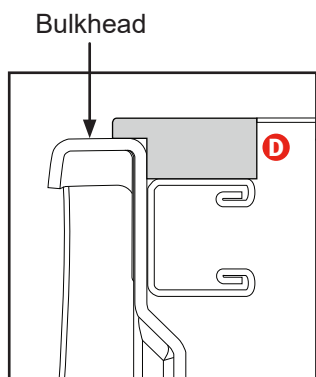

Side view of weather seal showing how the weather seal is positioned across the truck's bulkhead.

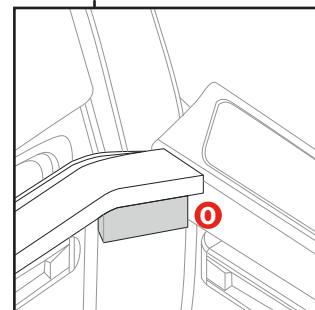
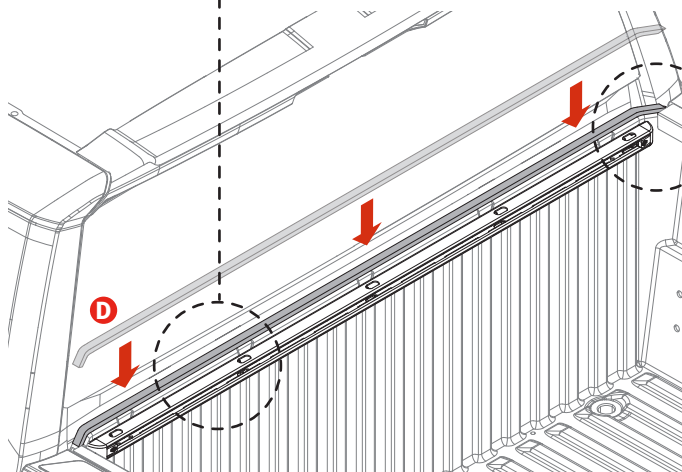

- 4** Remove cargo rail end plugs: Begin by pushing in on the end plug tab and at the same time push the end plug out of the rail.

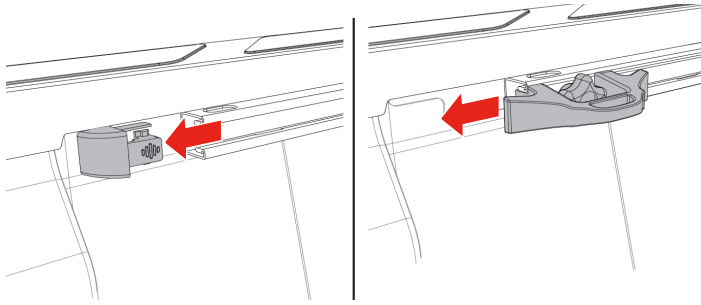

- 5** Install 3 anchor blocks (E) into the accessory rail from the tailgate end. Then put the end cap back into the tailgate end of the accessory rail. Repeat installation for drive side.

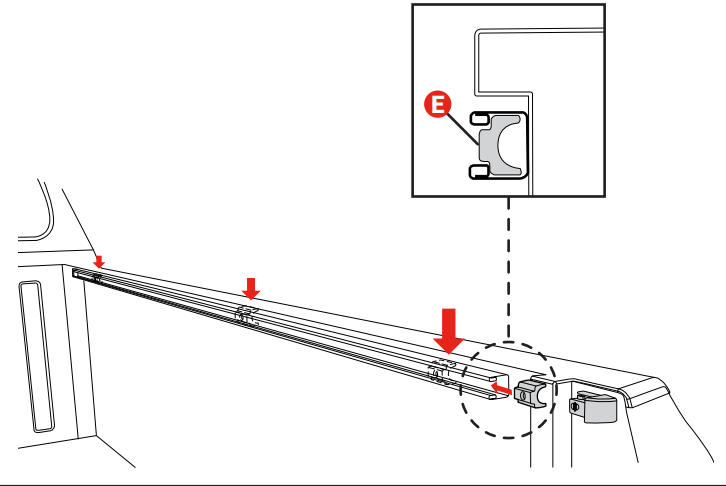

- 6** Install set screws (I) to rail brackets (H): Ensure you have the set screws (I), rail brackets (H), and Allen hex wrench required for installation.

**Identify components:** Confirm that you have the correct set screws and rail brackets. Each rail bracket should have two holes for inserting the set screws.

**Insert set screws:** Take the set screws (I) and insert them into both holes of each bracket (H) as shown in the provided image below. Be sure to place one set screw in each hole of the bracket. Use Allen hex wrench tool to assist with inserting screws.

**Leave set screws loose:** As instructed, leave the set screws loose at this time. Do not tighten them fully yet, as you may need to make adjustments later in the installation process.

**Repeat for each bracket:** Repeat the process of inserting set screws into both holes of each bracket until all brackets are equipped with set screws.

**Verify installation:** After inserting the set screws into the brackets, double-check to ensure that each set screw is properly seated in its respective hole and that they are all loose enough so the brackets can slide front to rear within the side rail.

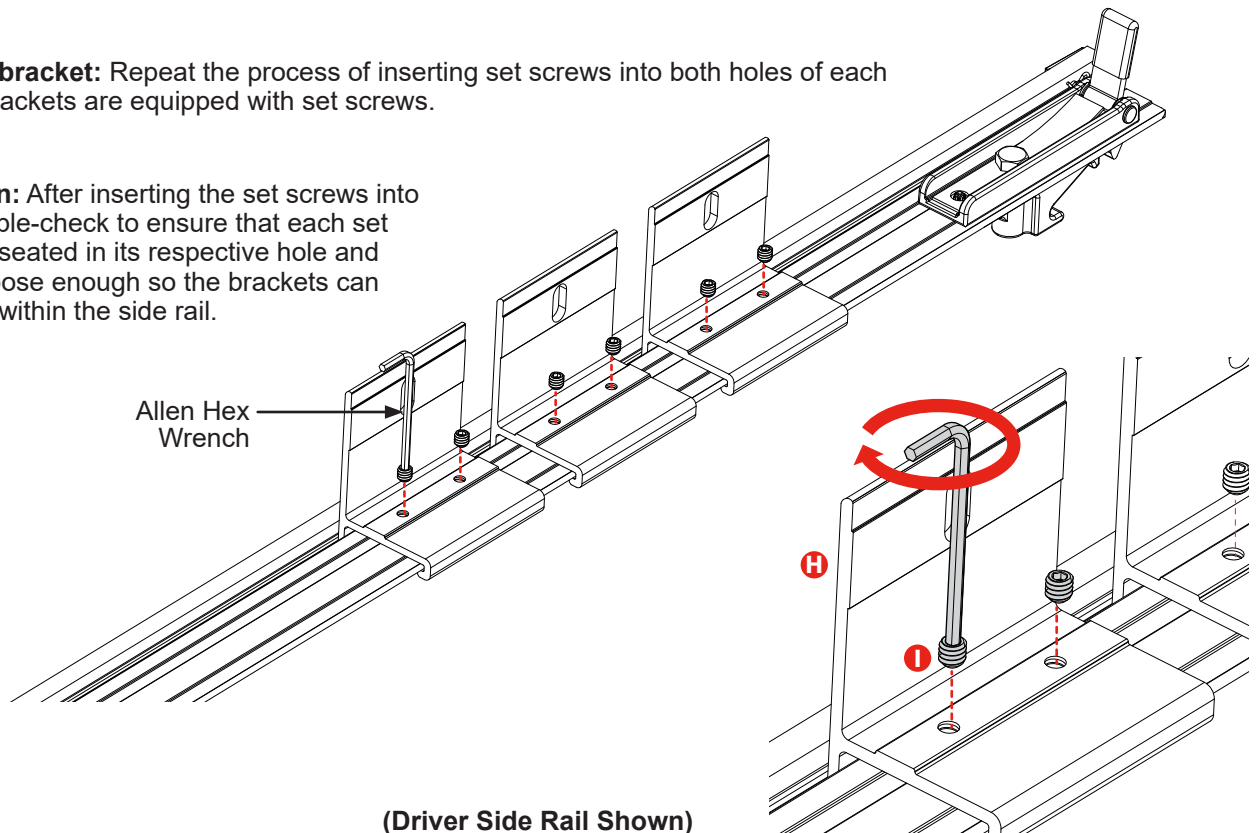

**7 Place assembled rails on bed caps:** Start by placing the assembled rails on top of the bed caps of the truck, ensuring that the fin seal is positioned on top. The fin seal helps to provide a secure fit and prevent water or debris from entering the truck bed.

**Position brackets fore and aft:** Inside each rail, position the brackets so there is one bracket at the front, one in the middle, and one at the rear of the cargo rail. Ensure that the brackets are aligned evenly along the length of the rail for optimal support.

**Align anchor blocks:** Check the positioning of the anchor blocks (E) that were previously installed in the cargo rail. Align these anchor blocks with the rail brackets that you have just positioned. Proper alignment ensures that the rail system attaches securely.

**Fasten rail Brackets to anchor blocks:** Use fastener (F) and washers (G) to fasten the rail brackets (H) securely to the anchor blocks (E). Insert the fasteners through the brackets and into the anchor blocks, ensuring a tight fit with the washers. This step ensures that the brackets are firmly attached to the trucks cargo rail.

**Position assembled side rails from the closed tailgate:**

With the truck's tailgate closed, position the end of each rail approximately 1/2" away from the rear corner of the truck bed. This positioning helps ensure proper alignment of the rail system and allows for clearance when opening and closing the tailgate.

**Repeat for passenger rail:** Repeat the entire process to install the passenger rail on the opposite side of the truck bed. Follow the same steps to position brackets, align anchor blocks, fasten rail brackets, and position the end of the rail.

**Double-check alignment and tightness:** Once both rails are installed, double-check the alignment of the brackets, anchor blocks, and end positioning of the rails. Ensure that all fasteners are tightened securely and that the rails are properly aligned. This step helps to ensure the stability and functionality of the installed rail system.

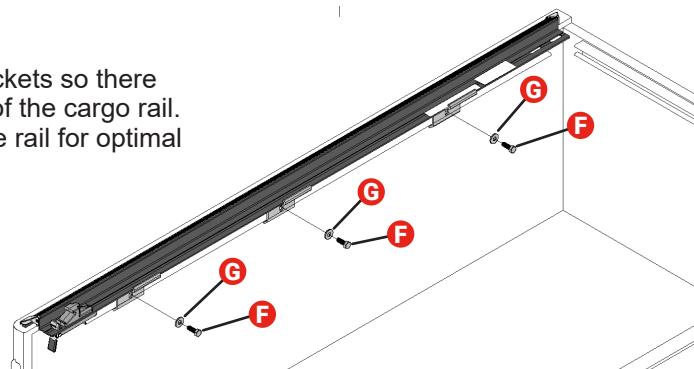

**Driver Side Rail Shown**

Image is showing the correct side rail position from the tailgate.

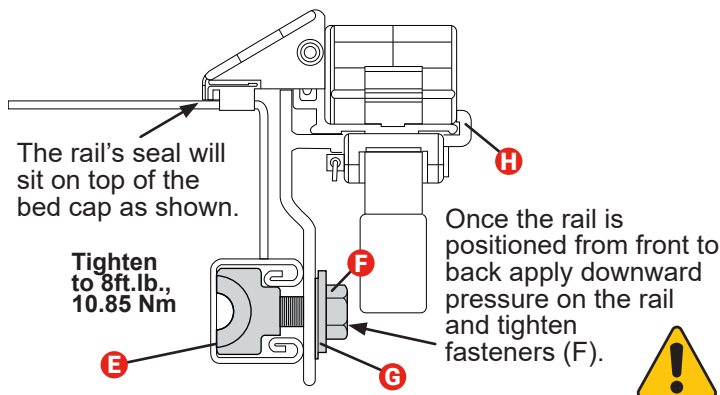
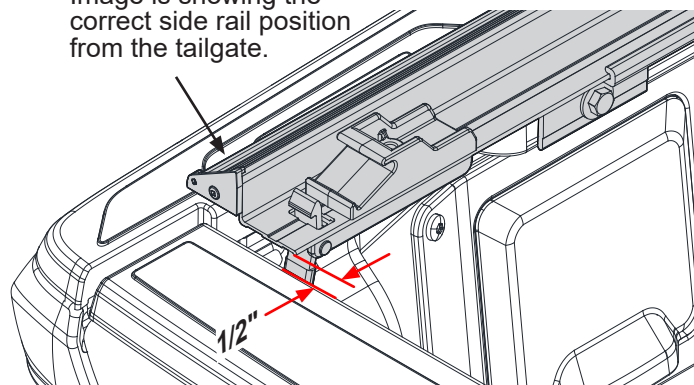

**8** The sets screws (I) can now be tightened into to the bottom side of the rail as shown below. Use the Allen hex wrench that has been supplied in the hardware bag to complete this step. Do this for each bracket.

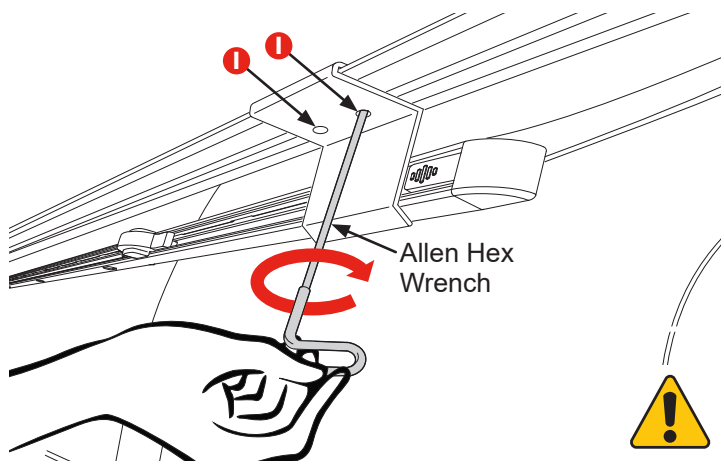

**9** Place the cover (C) on the side rails towards the front of the truck bed (near the cab). The front header seal is designed to help shed water and should be sitting on top of the bulkhead.

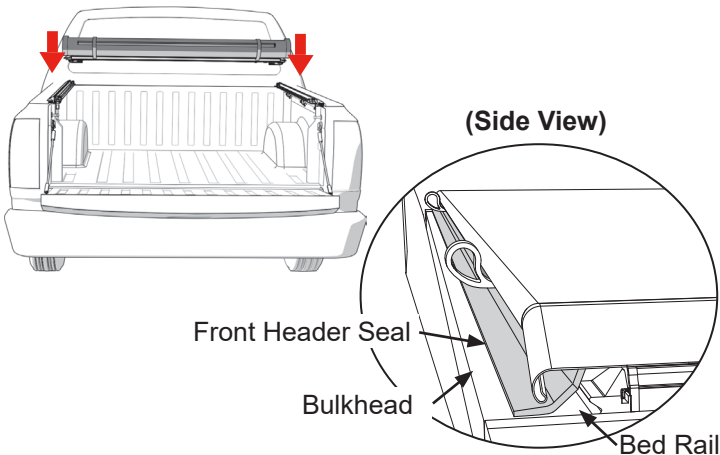



**10** **Install tension blocks (J), and hitch pins (K):** Gather the tension control blocks (J), and hitch pins (K). Place the tension block labeled with holes 2 & 3 into the rectangle hole found at the front end of the driver rail. The upper block, labeled with hole 4 will be positioned on the top towards the cab. Make sure tension blocks are pushed up against the front header.

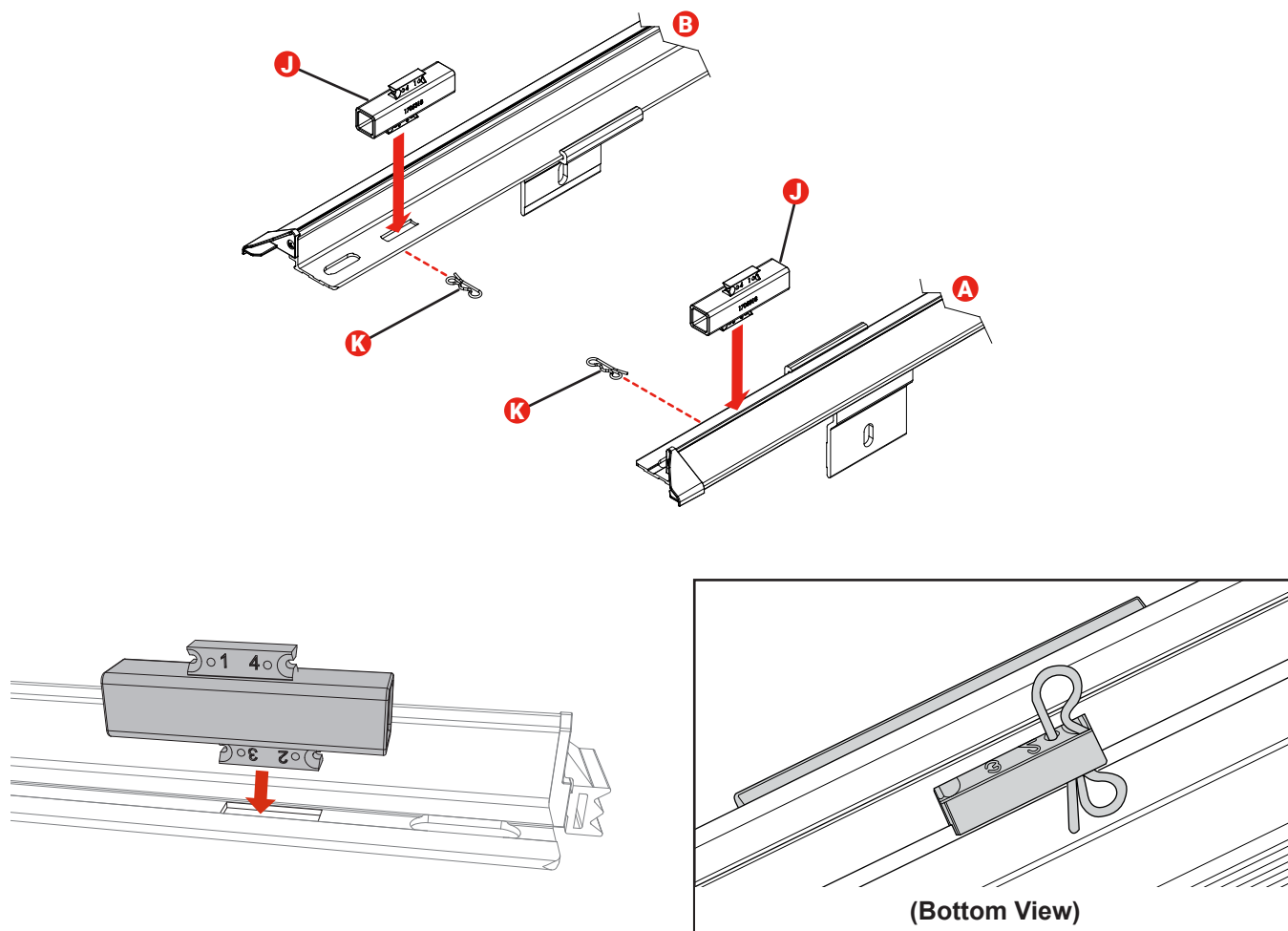

**11** **Installing square head attachment screws (N) into the cover assembly:** On the cover assembly (C), identify the driver and passenger front header end plugs. Remove both plugs by pulling them outward as shown below.

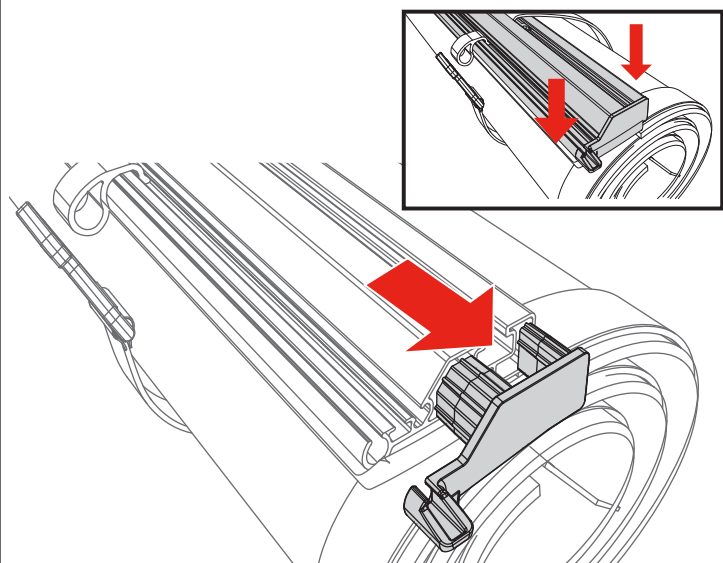

**12** Install the bolts (N) by sliding them into the header as shown below. Do this on both driver and passenger sides. Reinstall both end plugs as shown.

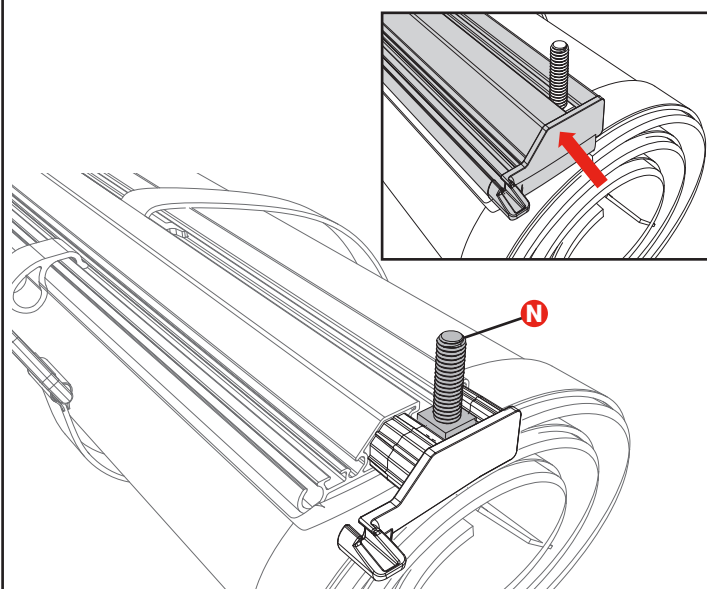

- 13** Place the cover (C) on the side rails (A & B) towards the front of the truck bed (near the cab). The front header seal is designed to help shed water and should be sitting on top of the bulkhead.

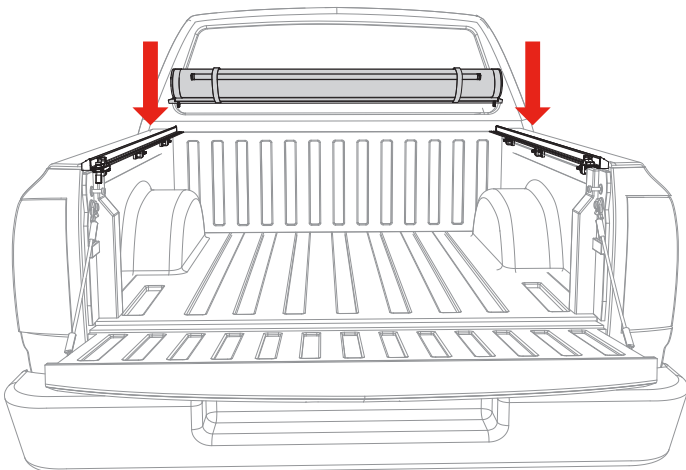

- 14** To connect the cover to the rails (A & B) thread the plastic washers (L) and hex nuts (N) onto the bolts (M) attached to the cover (C). Tighten with a 9/16" wrench or socket. Do **NOT** overtighten. Repeat this process on the other side of the cover.

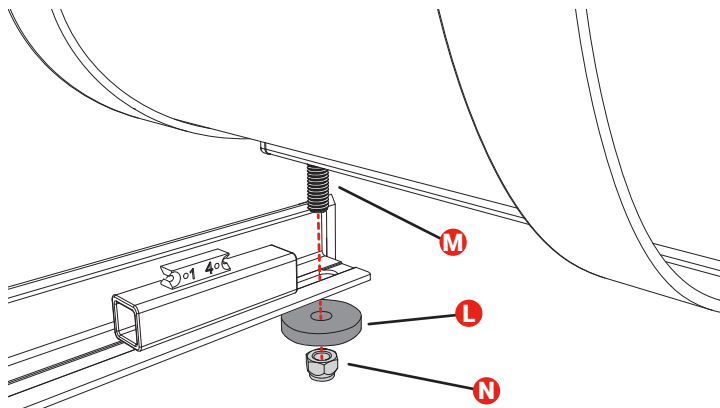

- 15** Unroll the cover (C) evenly towards the tailgate.

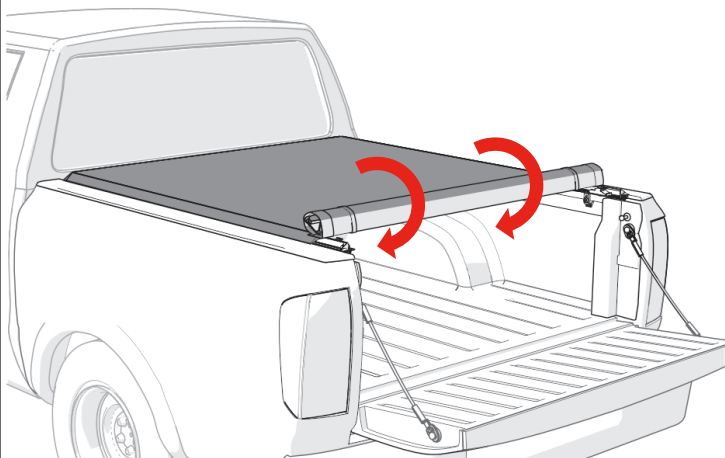

- 16** Place the rear header into the header stops which are located on both side rails (A & B). Rotate the rear header downwards until you feel the cover latch in place. A clicking sound will indicate a correctly installed cover.

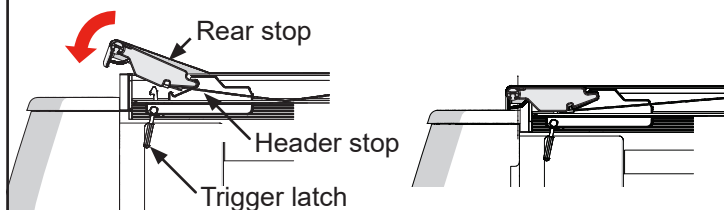

**Preferred method of closure:** Close tailgate, then close cover on top of the tailgate. This method will not work with some truck applications. Use alternative method instead.

**Alternative method of closure:** Close tailgate, then close cover on top of the tailgate. This method will not work with some truck applications. Use alternative method instead.



- 17** To secure the hook and loop grab the fabric and pull evenly over the hook track to engage the hook and loop.

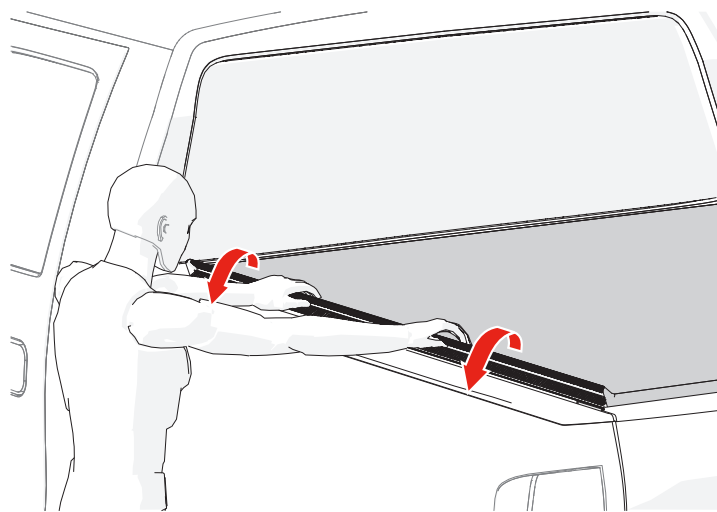

- 18** Once the side of the hook and loop are engaged, use the palms of your hand to firmly push the loop strip into the hook track the entire length of the cover. This will prevent wind from lifting the cover and causing possible damage. Do this on both driver and passenger sides.

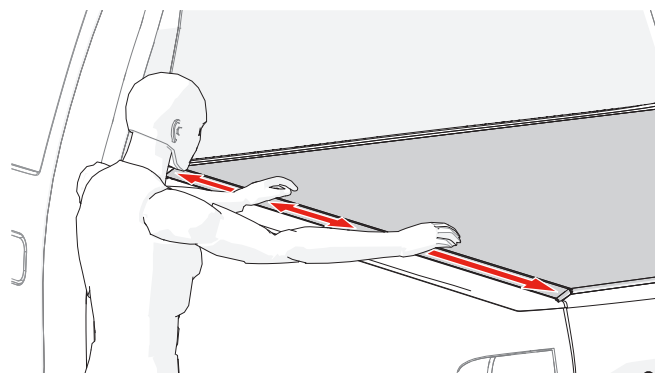

**HOO K AND LOOP MUST ALWAYS BE ADJUSTED AFTER ROLLING COVER CLOSED.**





## COVER IN THE CLOSED POSITION

You are ready to drive with the cover in the closed position.

**NOTE:** If the tailgate has a key lock, the cover is secured until the tailgate is unlocked and opened.

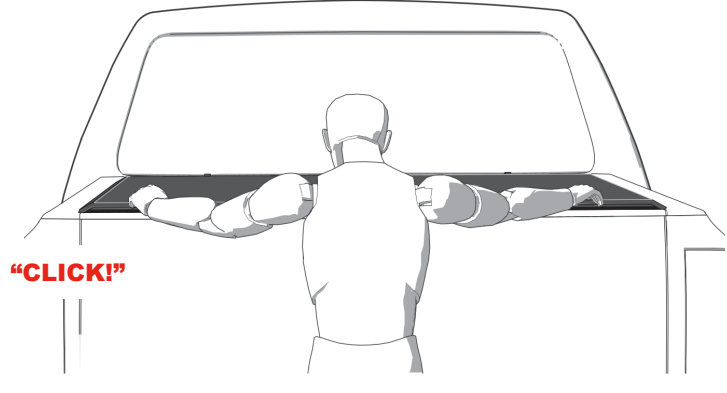

## COVER IN THE OPEN POSITION

To drive with the cover in the open position, pull the latch towards you to release the cover (located on driver side rail). Roll the cover toward the cab of the truck, making sure that both sides roll evenly. Secure the cover by placing both retainer hooks into the retainer loops **You are ready to drive with the cover in the opened position.**

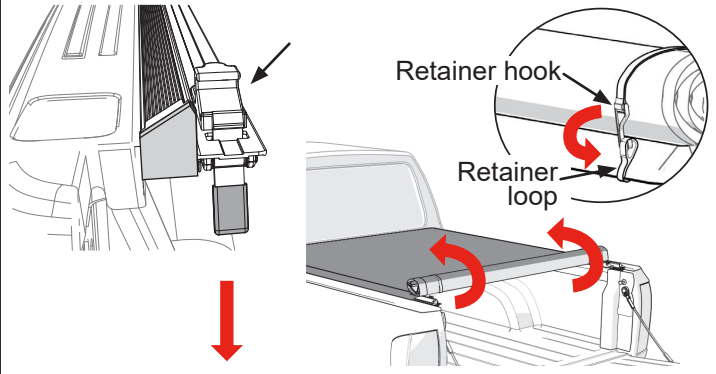

## FINE TUNING TENSION ADJUSTMENT BLOCKS

### SETTING COVER TENSION

- Roll the cover (C) open to adjust both tension blocks (K).
- Pull hitch pin (L & M) and rotate tension blocks (K) to the desired position.
- Replace hitch pin (L & M). **Driver and passenger blocks must always be in the same position.**
- Close cover and check adjustment. Repeat until satisfactory tension has been achieved.

**ATTENTION:** Proper tension allows the cover to look and perform at its best. If the cover feels too tight or too loose when opening or closing it, adjust the tension during the warmest part of the day.

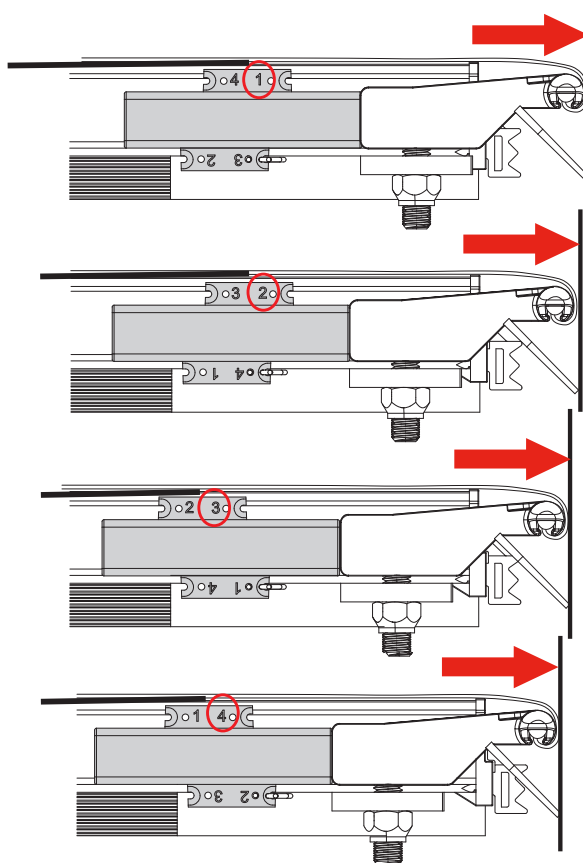

**Position 1** is set for maximum forward tension. The **NUMBER 1** is positioned on the top front. The hitch pin always goes into the bottom front hole.

**Position 2** is set for less forward tension. The **NUMBER 2** is positioned on the top front. The hitch pin always goes into the bottom front hole.

**Position 3** is set for less forward tension. The **NUMBER 3** is positioned on the top front. The hitch pin always goes into the bottom front hole.

**Position 4** is set for least forward tension. The **NUMBER 4** is positioned on the top front. The hitch pin always goes into the bottom front hole.

## **SAFETY INSTRUCTIONS**

- DO NOT place objects on or against the cover or framework.
- NEVER allow children or pets to occupy the pickup box while the cover is closed.

## **TROUBLESHOOTING TIPS**

### **WHY IS MY COVER HOLDING WATER AFTER IT RAINS?**

- Water pooling on the cover is normal because our cross bows are not arched. Since they are designed to sit flat some water may accumulate on the top of the cover. Once you drive your truck, the water will shed from the cover.
- Make sure to retighten the hook and loop fasteners along the length of the bed.

### **WRINKLES ON THE VINYL FABRIC AFTER ROLLING COVER CLOSED**

- Pull the vinyl fabric taut from each side. For best results, the help of a second person pulling on the opposite side is preferable.

### **SAGGING VINYL FABRIC BETWEEN THE CROSS BOWS**

- Adjustment to tension blocks may be required.

### **WIND LIFTS UP THE EDGE OF THE VINYL FABRIC**

- Make sure to engage the hook and loop on the driver and passenger side rails after closing the cover. This may need to be done periodically when taking long trips.

### **VINYL FABRIC FLUTTERS EXCESSIVELY WHEN DRIVING**

- Adjustment to tension blocks may be required.
- Make sure hook and loop fasteners are set. See Step 17-18.

### **SNOW AND ICE ACCUMULATION ON THE VINYL FABRIC**

- Use broom or brush to remove loose snow and ice. DO NOT use sharp or pointed tools to remove snow and ice.
- Direct sunlight will help melt snow and ice off the vinyl fabric.

### **TONNEAU COVER WILL NOT LATCH**

- Check side rails to make sure they are level. See Step 7.
- Make sure the header seal is not caught between side rails & header.
- Check the position of side rails on the pickup box. They may be positioned too low. See Step 7.
- Make sure the cover has proper tension. See fine tuning tension blocks section.

### **VINYL FABRIC IS TOO TIGHT OR TOO LOOSE**

- Adjustment to tension blocks may be required.

### **VINYL FABRIC HAS SHIFTED TOO FAR TO ONE SIDE**

- Unlatch the cover at the tailgate, release the hook and loop along both sides, go to the shorter side of the tarp and tug. The vinyl fabric will slide in the aluminum headers. Pull on the shorter side until the tarp appears centered on the whole system.
- Latch the cover and secure the hook and loop down both sides. Repeat if more adjustment is needed.

## **COVER CARE AND MAINTENANCE**

- Clean with mild automotive soap and water. Never use vinyl conditioners that contain silicon, petroleum, or citrus based products on your truck bed cover as they may crack and shrink the vinyl top surface.

## **IMPORTANT OPERATING TIPS**

- After closing the cover, the operator must secure the hook and loop by running their hand down the driver and passenger side rails, pushing down on the cover material.
- If the side rails are tipping, adjust the clamps in order to level the side rails and ensure a proper fit.

# LIMITED WARRANTY

## WARRANTY COVERAGE

This truck bed cover is warranted against defects in materials or workmanship as follows. This warranty is void if the product has been damaged in an accident, or due to neglect, unforeseeable use, improper installation, improper servicing, or other cause not arising out of defects in material or workmanship.

### LIMITED 2-YEAR WARRANTY ON HARD PARTS

All hardware included with your truck bed cover, including rails, clamps and bows carry a limited 2-year warranty, subject to the terms below.

### LIMITED 2-YEAR WARRANTY ON THE FABRIC

The fabric on your truck bed cover carries a limited warranty for two (2) years from the original date of purchase, subject to the terms below.

## WARRANTY IS NOT TRANSFERABLE

The warranty is to the initial consumer purchasing the truck bed cover and it is not transferable to a subsequent end user. Proof of purchase may be required to enforce these warranty rights.

## WARRANTY CONDITIONS

Failure to follow these warnings and care instructions will void the warranty:

- Clean with mild automotive soap and water only.
- Do not use conditioners that contain silicone or petroleum.
- The tonneau cover must be secured at all points when the vehicle is in motion. When not fully closed with the rear latch engaged the cover must be completely rolled up and secured at the cab with both provided retainer straps attached. Do NOT drive with the bed cover in a partially open position.
- Cargo should not contact the tarp at any point. Protrusions in the tarp will stress the vinyl fabric. Cargo may also shift while traveling causing it to press against the vinyl fabric and damage it.
- Check rail clamps for tightness after a week of driving following the installation of the cover and periodically thereafter.
- Do NOT roll the cover into the rear cab window. Do NOT stow the cover against the cab of the truck.
- If the cover is going to be rolled open for an extended amount of time, periodically re-roll the cover and secure the retainer straps to ensure the cover doesn't rest against the cab of the truck.
- Before opening, the cover must be free of all foreign materials including snow and ice.
- Do NOT tow your vehicle from the rear with the cover on your vehicle. If towing from the rear is required, the cover MUST be removed from the vehicle and properly stored.

## WARRANTY PERFORMANCE

If all warranty conditions are met, a defective truck bed cover, tarp, or hardware component will either be repaired or replaced (at our option). We reserve the right, for any warranty, to substitute a newer model of bed cover having similar form and function, to offer a warranty discount on an entire replacement system, and/or provide remedies other than those mentioned in this document.

## WARRANTY PROCESS

A Return Material Authorization number must be obtained from our Customer Service Department prior to returning any product. We may require the original item to be returned postage prepaid for final determination. Shipping charges will apply for any repair or replacement. Other than postage or shipping charges, no charge will be made for repair or replacement under this warranty.

This warranty gives you specific legal rights. As a consumer, you may also have additional rights and remedies under the laws of your state.

# WARRANTY REGISTRATION

Warranty registration must be on file and/ or proof of original purchase (detailed and dated receipt) required for warranty to be effective.

To register your warranty, please visit: <https://realtruck.com/warranty-registration>

**REGISTER  
YOUR  
WARRANTY  
ONLINE**



# REPLACEMENT PARTS

To order replacement parts, it is best to contact our Customer Service Department for assistance to ensure that you get the correct part for your vehicle application.

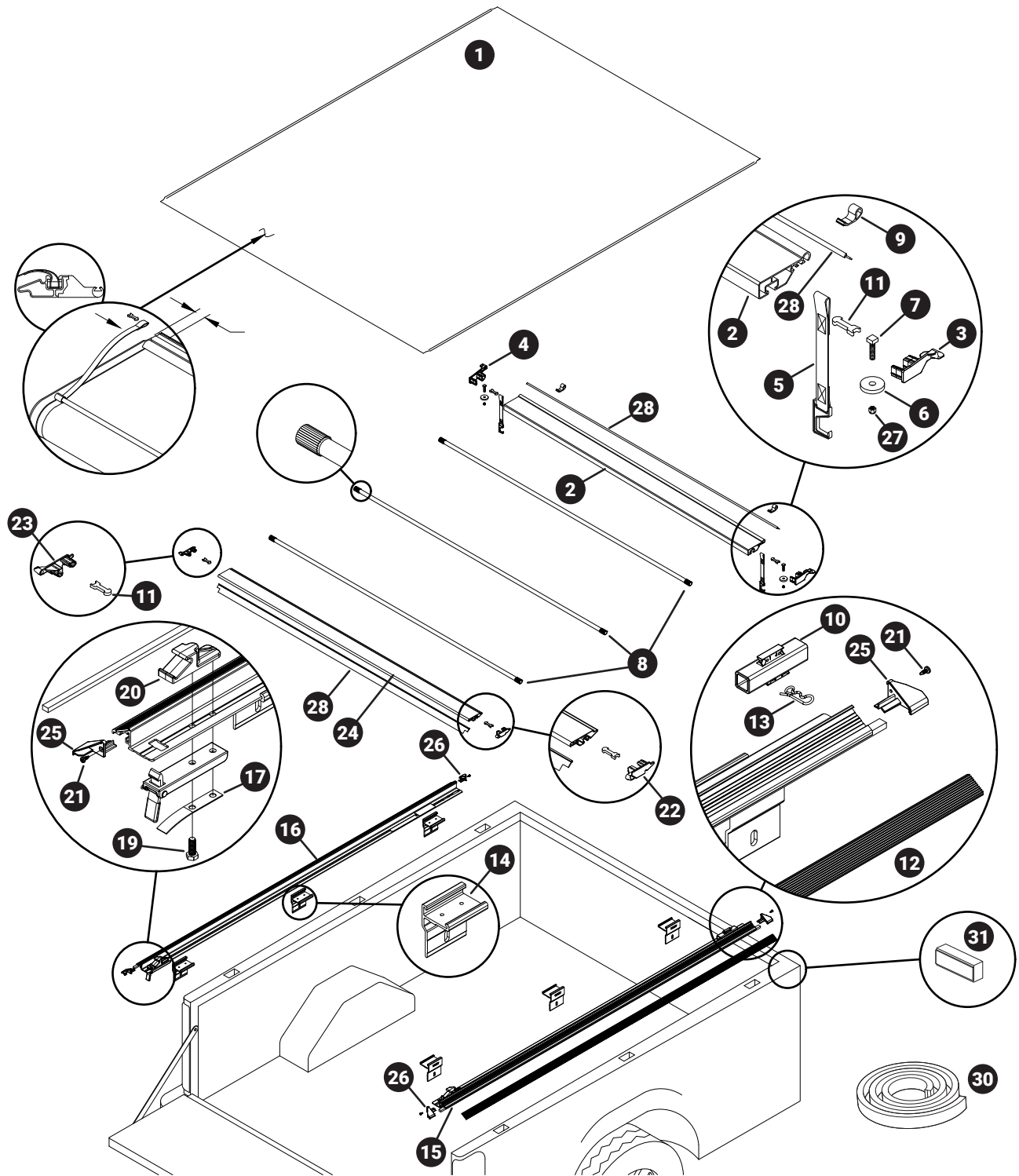

## REPLACEMENT PARTS

1	*	Replacement Cover	12	*	Hook Strip	23	1705404	Rear Header End Plug LH
2	*	Front Header	13	1707003	Hitch Pin	24	*	Rear Header
3	1705310	Front Header End Plug RH	14	1707207	Aluminum Clamp Single (1)	25	1706401	Side Rail End Plug RH
4	1705311	Front Header End Plug LH	15	*	Side Rail, Passenger's Side	26	1706400	Side Rail End Plug LH
5	*	Retainer Strap	16	*	Side Rail, Driver's Side	27	1701580	Hex Nut Full Nylon Lock
6	1115745	Plastic Washer	17	1705727	Flat Spring	28	*	Extruded Header Seal
7	1703455	Square Head Cap Screw	18	1704213	Latch Assembled	29	1706424	Four Corner Weather Seal Pack
8	*	Bow Assembly	19	1703455	Cap Screw	30	1119090	Bulkhead Seal
9	1705192	Retainer Loop	20	1705336	Header Stop	31	1116264	Corner Seal
10	1705318	Tension Adjustment Block	21	1706547	Self Drill Screw			
11	1705364	Header Insert Retainer Clip	22	1705405	Rear Header End Plug RH			

\* Please specify length or make and model of vehicle.