

# OWNER'S MANUAL

# GATOR

## TRUCK BED PROTECTION

HARD ROLL-UP TRUCK BED COVER

P/N 1118296 Rev A

## THREE YEAR WARRANTY

Gator Covers warrants this product to be free of defects in material and workmanship at the time of purchase by the original retail consumer. Gator Covers disclaim any other warranties, express or implied, including the warranty of fitness for a particular purpose or an intended use. If the product is found to be defective, Gator Covers may replace or repair the product at our option, when the product is returned prepaid, with the proof of purchase. Alteration to, improper installation, or misuse of this product voids the warranty. Gator Covers liability is limited to repair or replacement of products found to be defective, and specifically excludes liability for any incidental or consequential loss or damage.

### DIRECT ALL WARRANTY CLAIMS TO:

**Gator Covers**  
**2303 SE 17th St**  
**Ocala, FL 34471**

**Phone: 855-427-4568**  
**Fax: 352-433-2666**

## SAFETY INSTRUCTIONS

1. Do not place objects on or against cover or framework.
2. Do not tie cargo to truck bed cover framework.
3. **Never** allow children or pets to occupy pickup box while cover is closed.
4. Cover is not airtight. Special care is required to keep cargo clean and dry.
5. Fabric cover won't prevent theft of contents inside truck box.
6. Cover must be rolled fully open and secured with retainer straps when towing vehicle backwards.
7. **DO NOT** stow rolled cover against cab window.
8. **DO NOT ATTEMPT TO DRIVE WITH THE COVER IN THE PARTIALLY OPEN POSITION!**
9. **A FULLY ROLLED OPEN COVER MUST ALWAYS BE SECURED WITH RETAINER STRAPS.**
10. **DO NOT** operate vehicle with objects on top of the cover.

## OWNER/USER RESPONSIBILITIES

It is the responsibility of the owner/user to read this manual and comply with the operating procedures. The owner/user is also responsible for inspecting the cover, and for having parts repaired or replaced when worn or damaged.

Failure to follow safety instructions and warning labels could result in failure of your cover system and/or personal injury.

## MESSAGES TO INSTALLER

- Always wear safety glasses and/or other necessary protective equipment when installing your Truck bed cover.
- These instructions are complete for most pickup models. Additional instructions are included, if required for your truck. Please read entire manual before installing your truck bed cover.

## IMPORTANT OPERATING TIPS

- Truck bed cover must be free of foreign material including snow and ice before rolling cover open or closed.
- It is recommended to operate vehicle with cover rolled closed and latched for optimal fuel economy.
- Prolonged cold weather will make cover fabric stiff. Move vehicle with cover unrolled and latched into sun or indoors to warm the top surface.
- If cover has been stored in a rolled up state for a long period of time it may take few minutes for the cover to lay flat. The fabric material needs to relax to a flat state, this is normal.
- **DO NOT** roll cover into rear cab window. **DO NOT** stow against cab.

## COVER CARE AND MAINTENANCE

1. Cover surface can be hand washed with mild soap and water or cleaned in a car wash. Thoroughly rinse cover to remove any soap residue. **Never use vinyl conditioners that contain silicon, petroleum, or citrus based products on your truck bed cover as they may crack and shrink the vinyl top surface.**
2. It is recommended that you periodically check that the cover is securely attached to your truck bed. Inspect the clamps and front header guide slides to ensure they were properly installed and have not come loose during operation.
3. It is recommended that you periodically inspect and service the rear latch closures. Clean away any excess dirt or grime and lubricate with silicone spray. Ensure the latches move freely in and out to properly engage the side rail and provide performance with optimal security. Be careful not to overspray the cover.

## IMPORTANT INSTALLATION TIPS

- Modification of accessories such as bed liners (including spray in liners) may be necessary allowing the truck bed cover side rails to fit properly between the front bulkhead and tailgate of the truck bed.
- When placing the rolled up cover assembly on the side rails and installing it to the side rails (see step 7) the weight of the cover assembly may tilt or flex the rails downward. Simply push up on the rail when securing the header guides to the rail (see step 8).
- After the initial installation leave cover closed and latched for a 24 hour period. This will insure that the fabric has taken a complete set to the metal substrate.

## ADDITIONAL IMPORTANT OPERATING TIPS

### **INCORRECT METHOD** Of How To Open Cover To The Front.

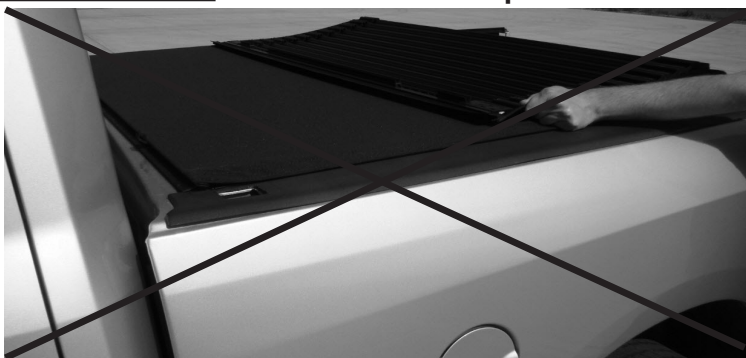

\*\*\*\*Do not slide a partially opened cover across the cover's surface.\*\*\*\*

\*\*\*\*Do not slide cargo across the cover's surface.\*\*\*\*

\*\*\*\*Do not store items on cover's surface.\*\*\*\*

### **CORRECT METHOD** Of How To Open Cover To The Front.



## ADDITIONAL IMPORTANT OPERATING TIPS

### AFTER INITIAL INSTALL

**Cover Tracking Marks:** The cover will experience slight tracking marks from dust deposited on the top surface even after the first initial roll out. If there is a heavy deposit of dust, simply use a wet rag to wipe the top surface of the cover clean.

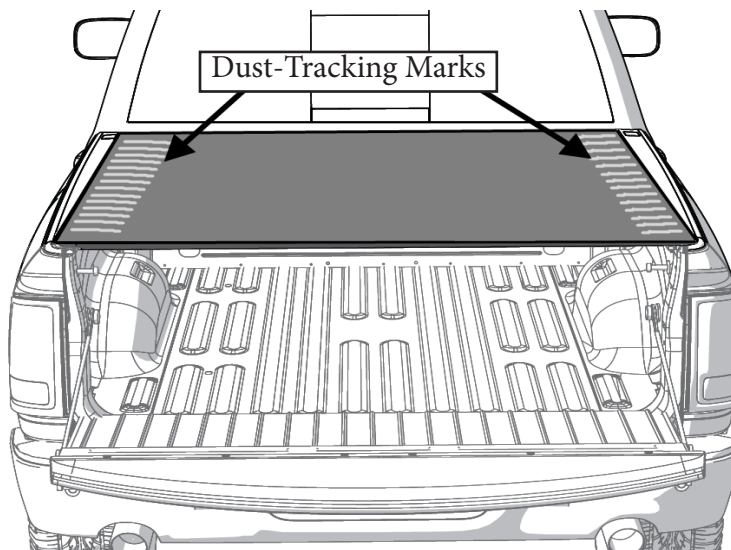

### DAY TO DAY USE

**Cover Tracking Mark Prevention:** All truck beds will accumulate road dust. This dust will accumulate on the side rails and adhere to the underside of the truck cover. When the truck cover is rolled open, the underside of the cover can deposit dust onto the top surface. To prevent dust-tracking marks, periodically clean the side rail surfaces, rubber slat end caps, and underside surface of the cover to remove dust build up. Plugging air holes and gaps in the truck box construction will also greatly reduce dust intrusion into the truck box. Periodically cleaning the top surface with soap and water will also help prevent dust-tracking marks.

### IMPORTANT OPERATING INSTRUCTIONS: SETTING THE HOOK AND LOOP BEFORE OPERATING VEHICLE.

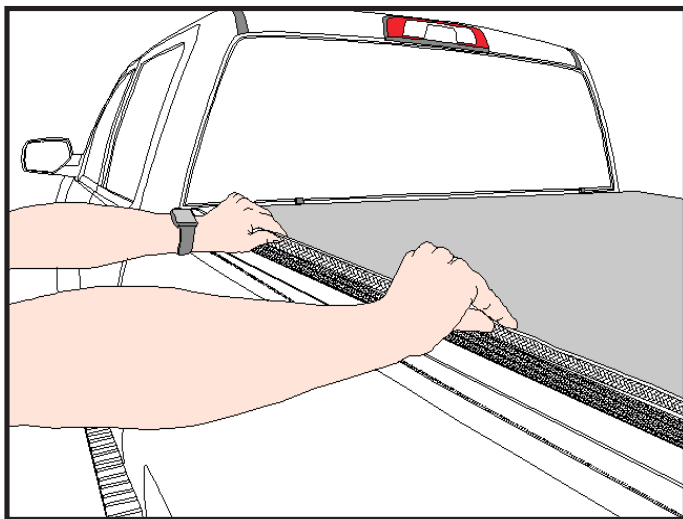

**Engaging Hook and Loop, Step One:** After rolling the cover closed, grab the fabric loop flap and evenly pull loop over the hook track engaging the loop to the hook track. **Avoid pulling fabric flap straight up.**

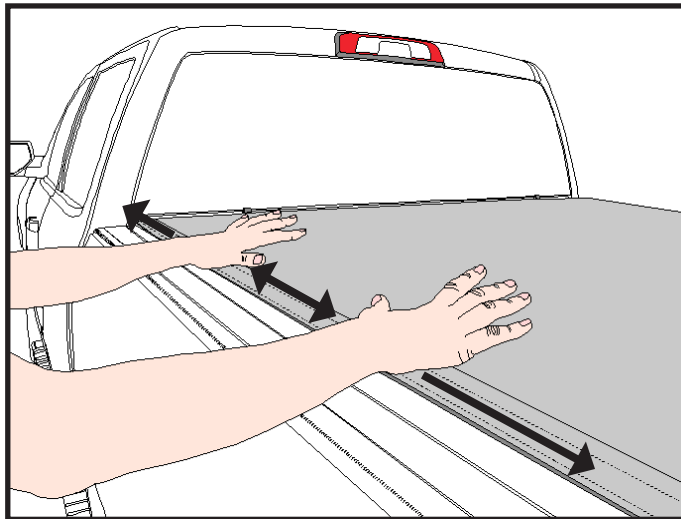

**Engaging Hook and Loop, Step Two:** With the cover closed and both hook and loop engaged, use the palms of your hand to firmly push the loop strip into the hook track. Do this to both driver and passenger side up and down the entire length of the loop seams.

**HOOK AND LOOP MUST ALWAYS BE SET AFTER ROLLING COVER CLOSED!**

## ADDITIONAL IMPORTANT SAFETY TIPS



### CAUTION HIGH TEMPERATURE

TOP SURFACE AND BOTTOM SURFACE CAN BECOME EXTREMELY HOT TO TOUCH WHEN EXPOSED TO BRIGHT SUN AND OR HEAT.  
**NEVER** ALLOW CHILDREN OR PETS TO SIT ON COVER WHEN CLOSED OR ROLLED TO THE CAB.



### CAUTION

ROLL COVER TIGHT. SECURE THE COVER APPROPRIATELY USING BOTH RETAINER STRAPS. **DO NOT** OVERTIGHTEN. **DO NOT** STOW COVER AGAINST CAB WINDOW.



### CAUTION

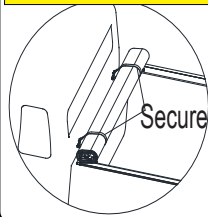

Before driving with cover open, **BOTH STRAPS MUST BE SECURED TO RETAINER LOOPS**. Failure to do so could cause accidental release of the cover, resulting in personal injury or property damage.

## Components

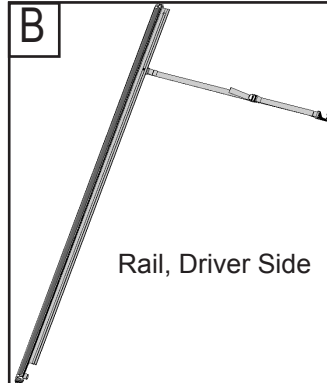
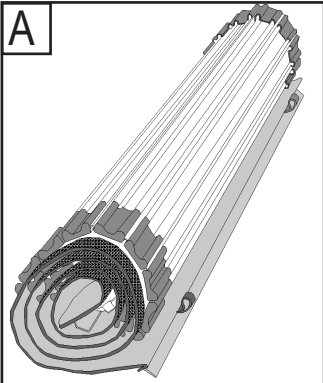

Rail, Driver Side

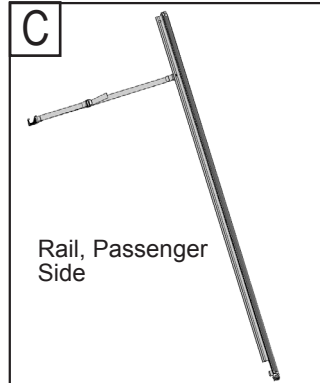

Rail, Passenger Side

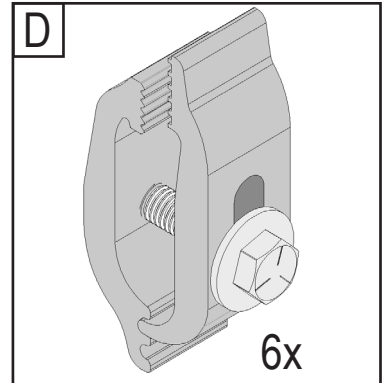

6x



Tools Required



1/2"



Correct

E

Read manual carefully before installing truck bed cover



## INSTALLATION

1:



Clean area before install.

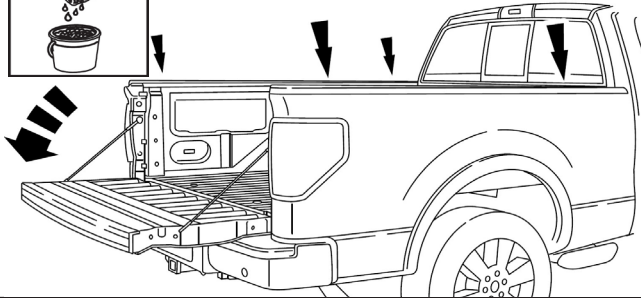

2:

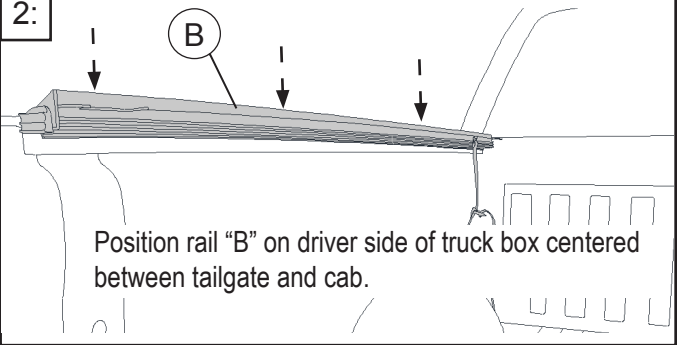

Position rail "B" on driver side of truck box centered between tailgate and cab.

3:

REAR (Tailgate)

Align rail so foam is compressed equally on both sides.

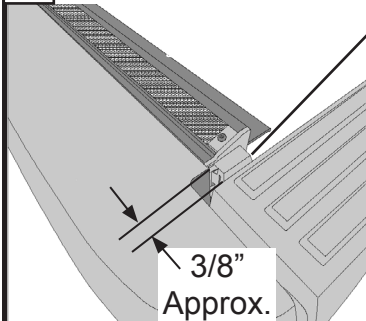

3/8" Approx.

Compress foam spacer approximately 50%.

| 0 |

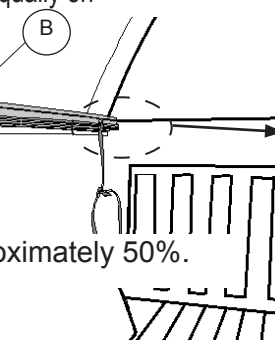

FRONT (Cab)

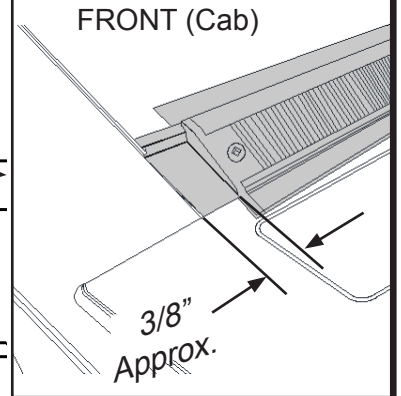

3/8" Approx.

ATTENTION: RAIL SITS ON TOP OF TRUCK'S BED RAIL.

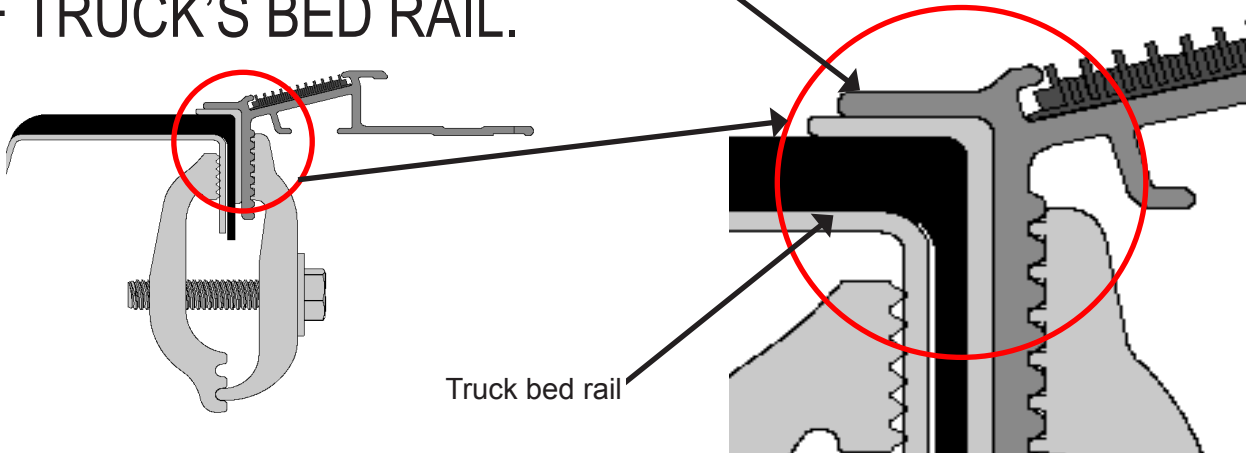

Truck bed rail

Rail Sits on Top of Bed Rail

4:

To ensure cover is square for proper operation, make sure attachment holes on the driver and passenger rails are lined up across from each other.

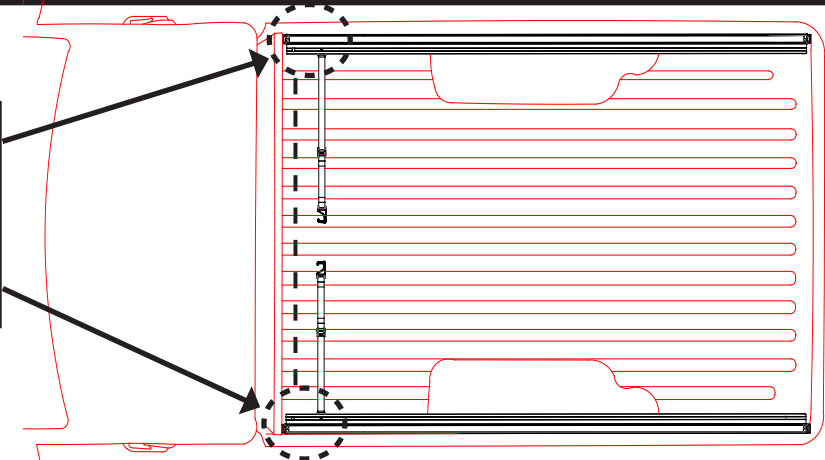



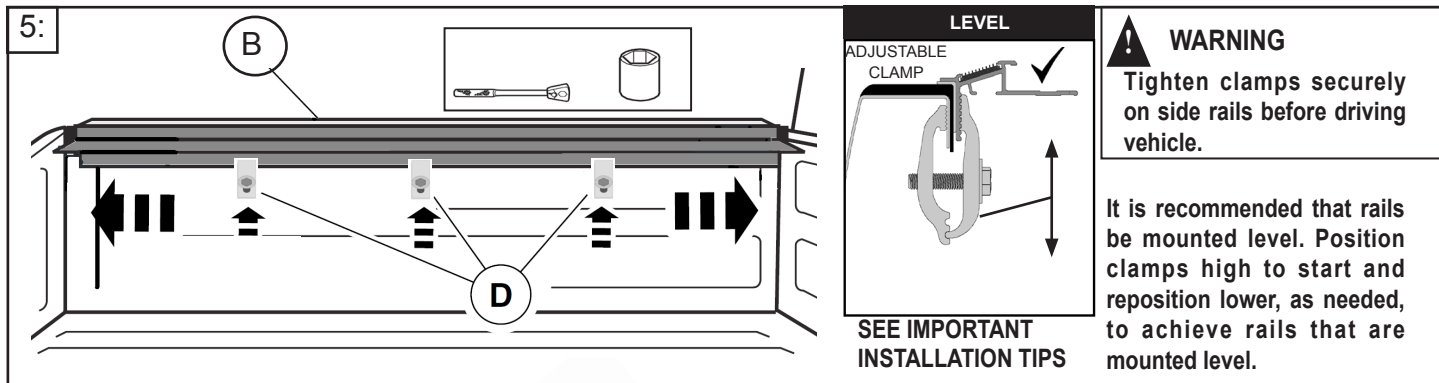

6: Repeat steps 2-5 on passenger side for item C. When finished proceed to step 7.

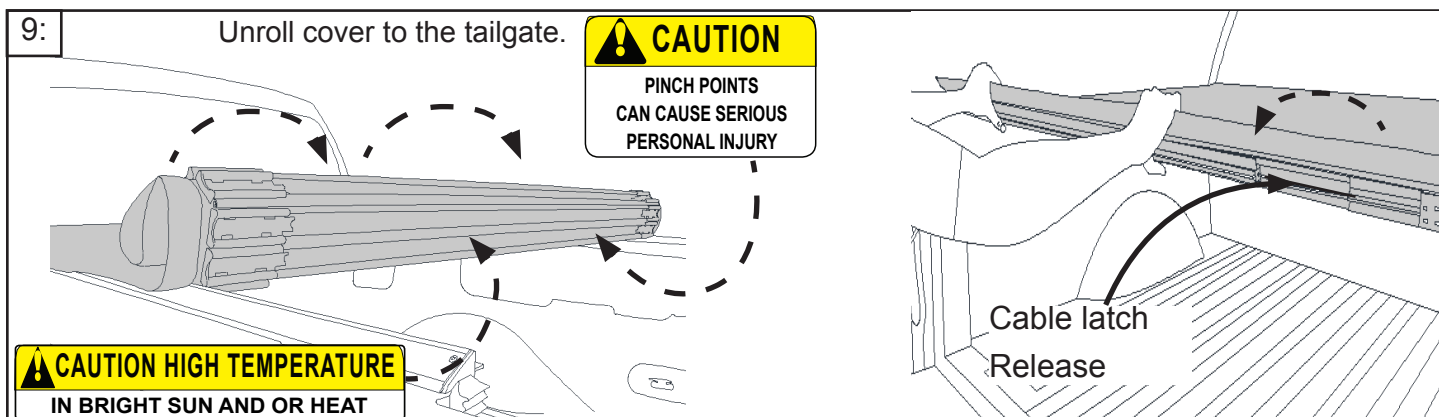
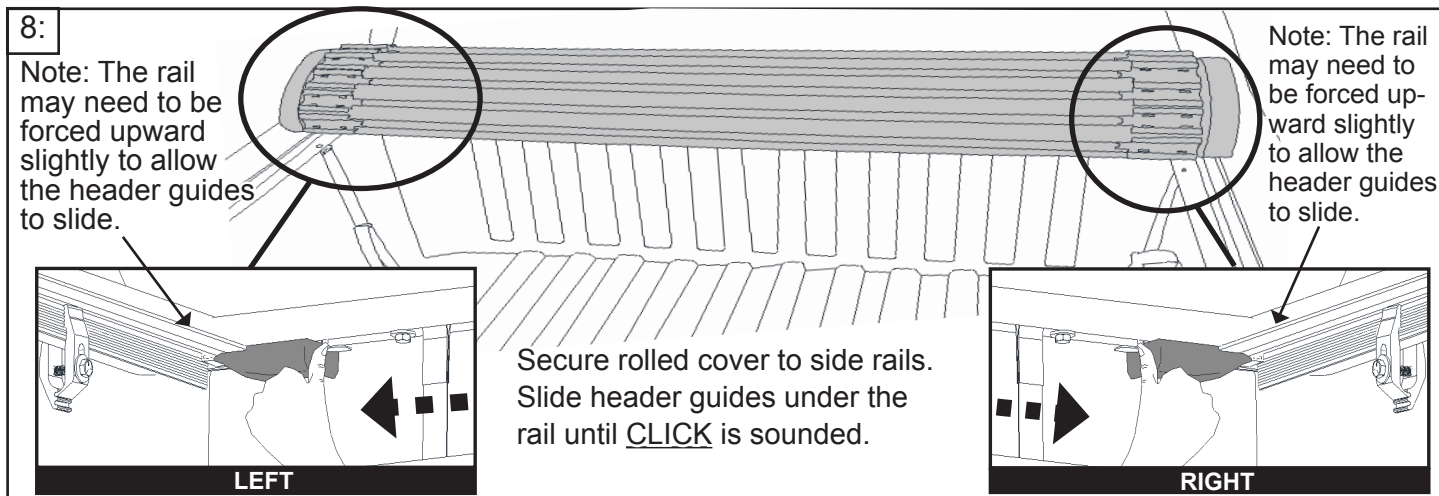
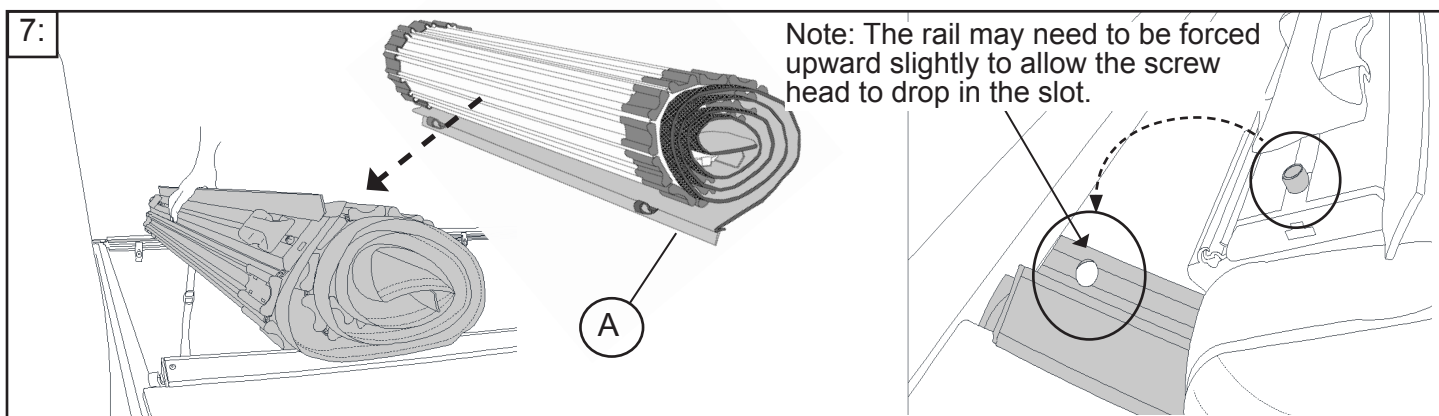

10: Latch Both Sides.

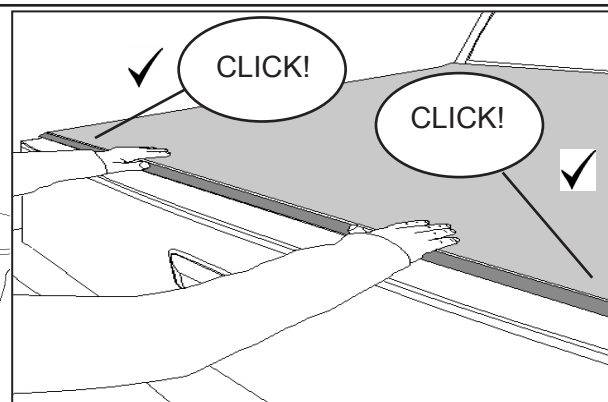
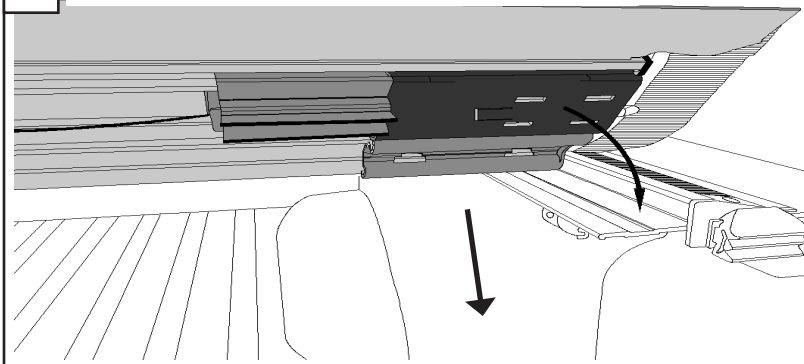

11: **PREFERRED METHOD OF CLOSURE:** Close tailgate, then close cover on top of tailgate. This method will not work with some truck applications. Use alternate method instead.

**ALTERNATIVE METHOD OF CLOSING COVER:** Close and latch cover, then close tailgate with the seal to the inside of the tailgate. Some care will need to be taken to train seal to be closed on the inside.

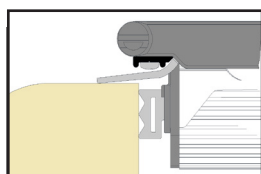

**NOTE:** If you have a key lock tailgate, truck bed cover is secured until tailgate is unlocked and opened.

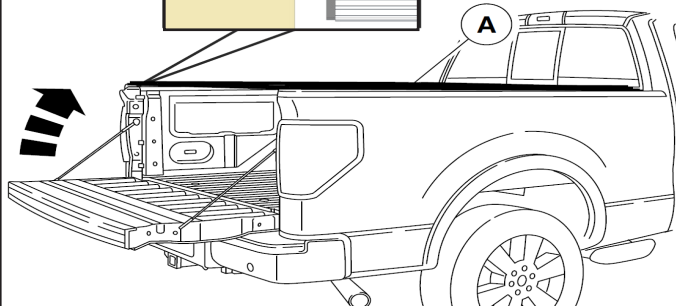

**Make sure cover is securely latched on both sides before operating vehicle.**

12: Secure Hook and Loop down both sides along entire length of cover system.

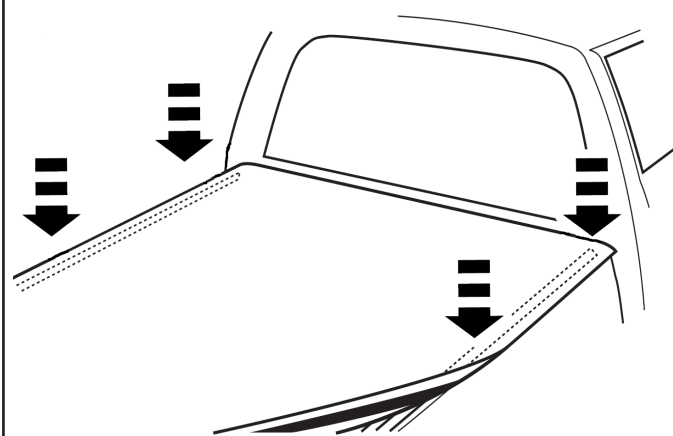

**NOTE:** Secure hook fastener and loop fastener along entire length of both side rails before driving vehicle. This will prevent wind lifting the cover and causing damage.

## ATTENTION!

After the initial installation leave cover closed and latched for a 24 hour period. This will ensure that the fabric has taken a complete set to the metal substrate.

13: To open cover, pull down on release cable and hold down. Lift and roll rear header.

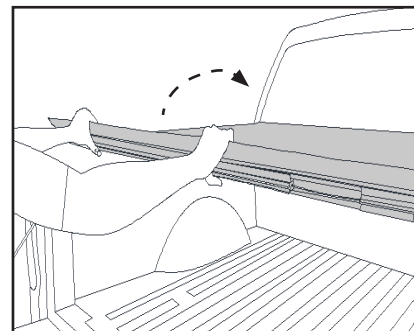
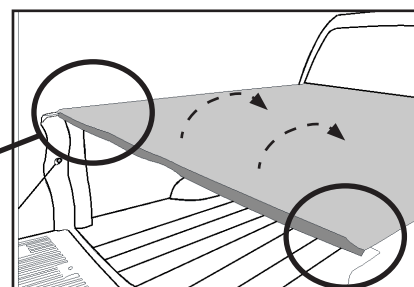
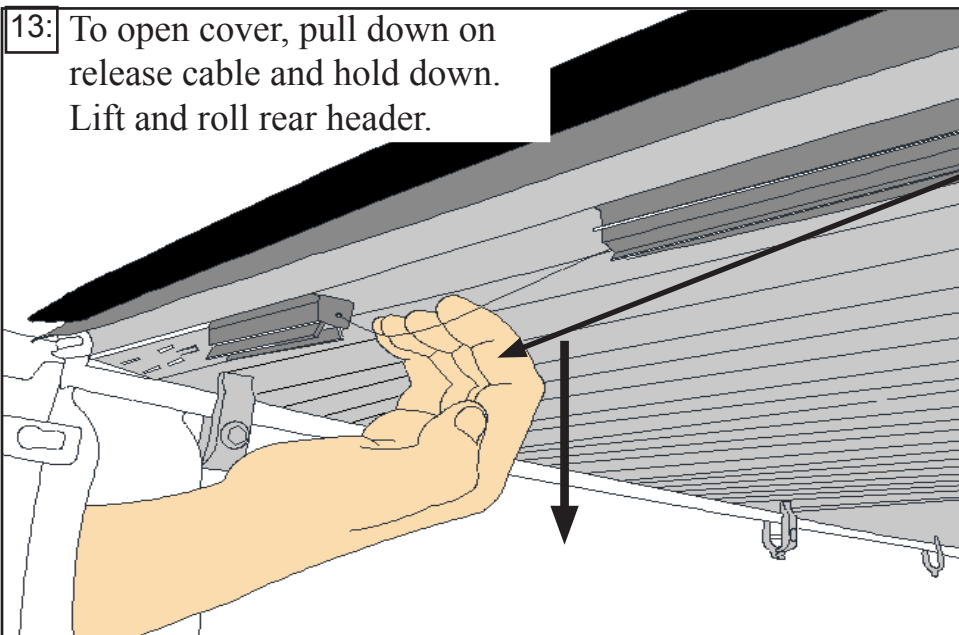

14:

## CAUTION

ROLL COVER TIGHT. SECURE THE COVER APPROPRIATELY USING BOTH RETAINER STRAPS. **DO NOT** OVERTIGHTEN. **DO NOT** STOW COVER AGAINST CAB WINDOW.

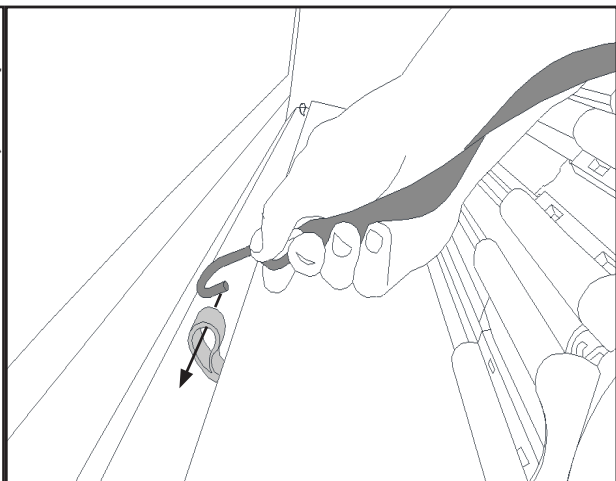
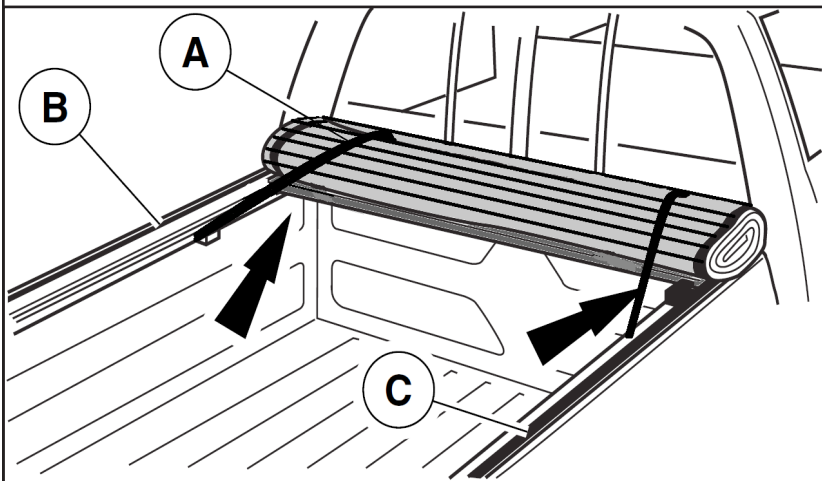

## CAUTION

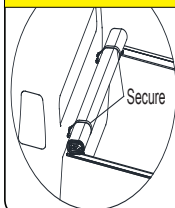

Before driving with cover open, **BOTH STRAPS MUST BE SECURED TO RETAINING LOOPS**. Failure to do so could cause accidental release of the cover, resulting in personal injury or property damage.

15: To Release Strap Push Tab Up.

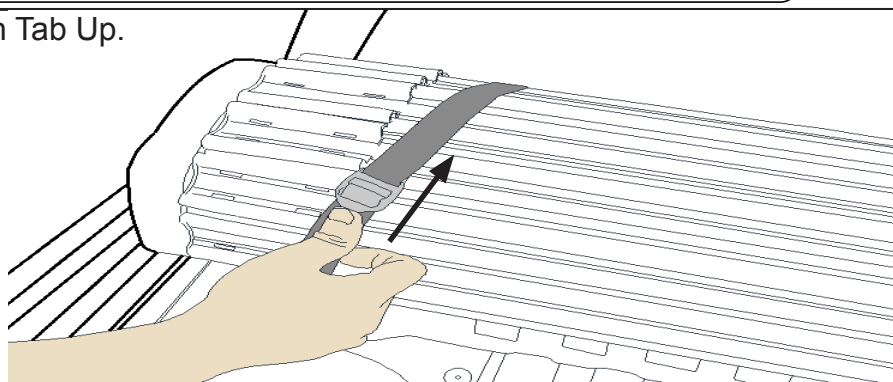

**NOTICE:** Ice buildup within hinge section can occur if cover is stowed in open position. To prevent potential damage, close cover during winter precipitation.

## TROUBLESHOOTING

### COVER ASSEMBLY WILL NOT ATTACH TO SIDE RAILS DURING INSTALLATION:

1. Check side rails to make sure they are level (See Step 5, clamp installation).
2. The rolled up cover is heavy which may be flexing the rails downward. Push front of rail up slightly to allow the screw head to fall in the slot and the header guide to slide freely into the secured location (See notes in steps 5, 6, and 7).
3. If rear header doesn't latch correctly check side rail installation Step 3.

### HEADER WILL NOT LATCH:

1. Check side rails to make sure they are level (See Step 5, clamp installation).
2. Make sure the rear header seal is not caught between side rail & rear header.
3. If rear header doesn't latch correctly check side rail installation Step 3.
4. Check to make sure side rails are both equally spaced front to rear (See steps 3 & 4).
5. Make sure both latches are functioning properly. Clean any debris that may be impeding latches, see

COVER CARE AND MAINTENANCE on page 1.

6. Close cover first then tailgate (see alternate closing method in step 11).

### COVER IS HARD TO ROLL OPEN OR CLOSED:

1. Truck bed cover **MUST** be free of foreign material including snow and ice before rolling cover.
2. Prolong cold weather will make cover fabric stiff. Move cover into sun or indoors to warm the top surface.
3. It is normal for the cover to experience light binding after being rolled up for an extended period of time. Once the cover is latched, the fabric will relax and the cover will lay flat.



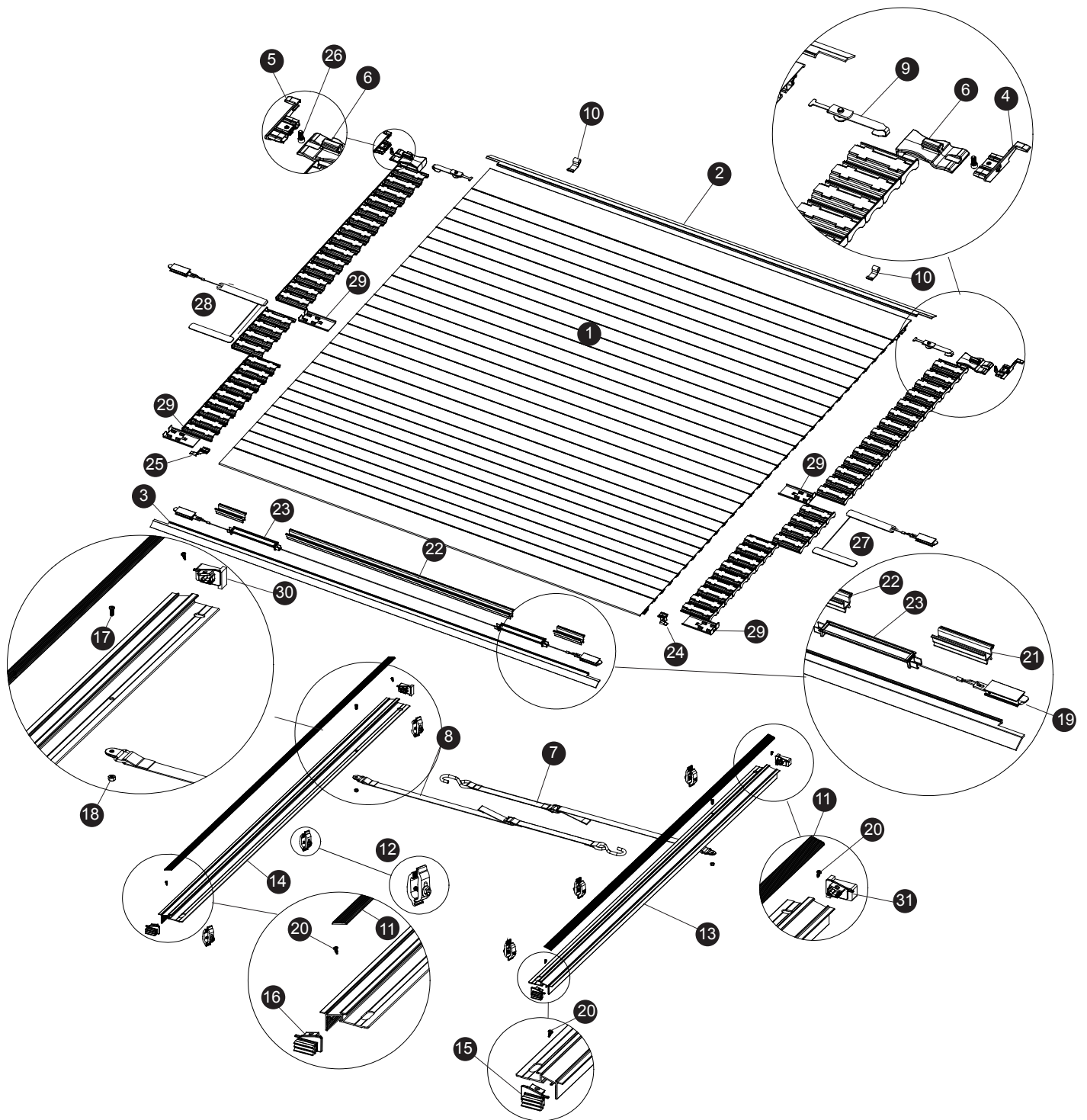

### SENTRY / SENTRY CT REPLACEMENT PARTS

1	*	Gator Replacement Cover	12	1705391	Aluminum Clamp Assembly	22	*	Cable Cover
2	*	Header Seal, Front	13	*	Side Rail, Passenger's Side	23	1115822	Cable Guard
3	*	Header Seal, Rear	14	*	Side Rail, Driver's Side	24	1705826	Rear Header End Plug (Passenger)
4	1705828	Front Header End Plug (Passenger)	15	1705851	SIDE RAIL END PLUG ASSY_RH	25	1705825	Rear Header End Plug (Driver)
5	1705829	Front Header End Plug (Driver)	16	1705852	SIDE RAIL END PLUG ASSY_LH	26	1704689	Machine Screw 1/4-20 X 9/16
6	1704707	Header Guide	17	1705415	Cap Screw 10-24 X 1/2	27	*	Passenger Security Latch Assy
7	1117892	Retainer Hook Strap (Passenger)	18	1703762	Hex Nut 10-24	28	*	Driver Security Latch Assy
8	1117893	Retainer Hook Strap (Driver)	19	*	Latch System	29	1705929	Latch Cover
9	1117594	Header Guide Retainer	20	1705629	Self Drill Screw 6-20 X 3/8	30	1118243	Side Rail End Plug_RH Foam Seal
10	1705806	Extruded Retainer Loop	21	1118225	Cable Cover 3.75"	31	1118244	Side Rail End Plug_LH Foam Seal
11	*	Hook and Loop Fasteners						

\* Please specify length or make and model of vehicle.