



## Installation Instructions

# 818191

1994-95 Chevrolet & GMC Trucks

½ or ¾ Ton LD Chassis

5.0L & 5.7L Engine 2WD/4WD

For vehicles with 2 Bolt Flange Catalytic Converter

## OUTLAW S E R I E S

Installation requires moderate mechanical skill. If this job is beyond your abilities, seek the services of a qualified technician.

If you do not understand any part of these instructions, please call Flowmaster Technical Support at (866) 464-6553 for assistance.

Apply penetrating oil generously to clamps, fasteners, pipes, and hanger rods for ease of disassembly.

### REVIEW THE INSTRUCTIONS & VERIFY THE KIT CONTENTS

Take a moment to read and understand these instructions before installing your Flowmaster exhaust kit.

ITM#	Part #	Description	Qty.
1	26976S	Inlet pipe (Long)	1
2	26977S	Inlet pipe (Short)	1
3	26978S	Extension Pipe	1
4	8430155-Z	Outlaw Muffler	1
5	26968S	Right Muffler Outlet Pipe	1
6	26970S	Right Tail Pipe	1
7	26969S	Left Muffler Outlet Pipe	1
8	26971S	Left Tail Pipe	1
9	26972S	Side Exit Pipe	1
10	ST509B	4.5" Black ceramic tip	2
11	26973S	Rear Exit Pipe	2
12	545HA	Muffler Clamp Hanger	1
13	546HA	Clamp Hanger	1
14	166HA	Tail Pipe Frame Hanger	2
15	HA168	Red Rubber Exhaust Hanger	2
16	MC300BS	3" Band Clamp	8
17	HW208	3/8-16 X 1" Hex Bolt	4
18	HW303	3/8 Flat Washer	4
19	HW309	3/8 Lock Washer	4
20	HW103	3/8-16 Nut	4
21	HW502	7/16" Push Nut	5
22	HW503	½" Push Nut	2
23	HW505	Cable Tie	1

Use the parts drawing and list to identify components and verify your kit's contents. In the unlikely event that any parts are missing, please contact Flowmaster Technical Support for replacements.

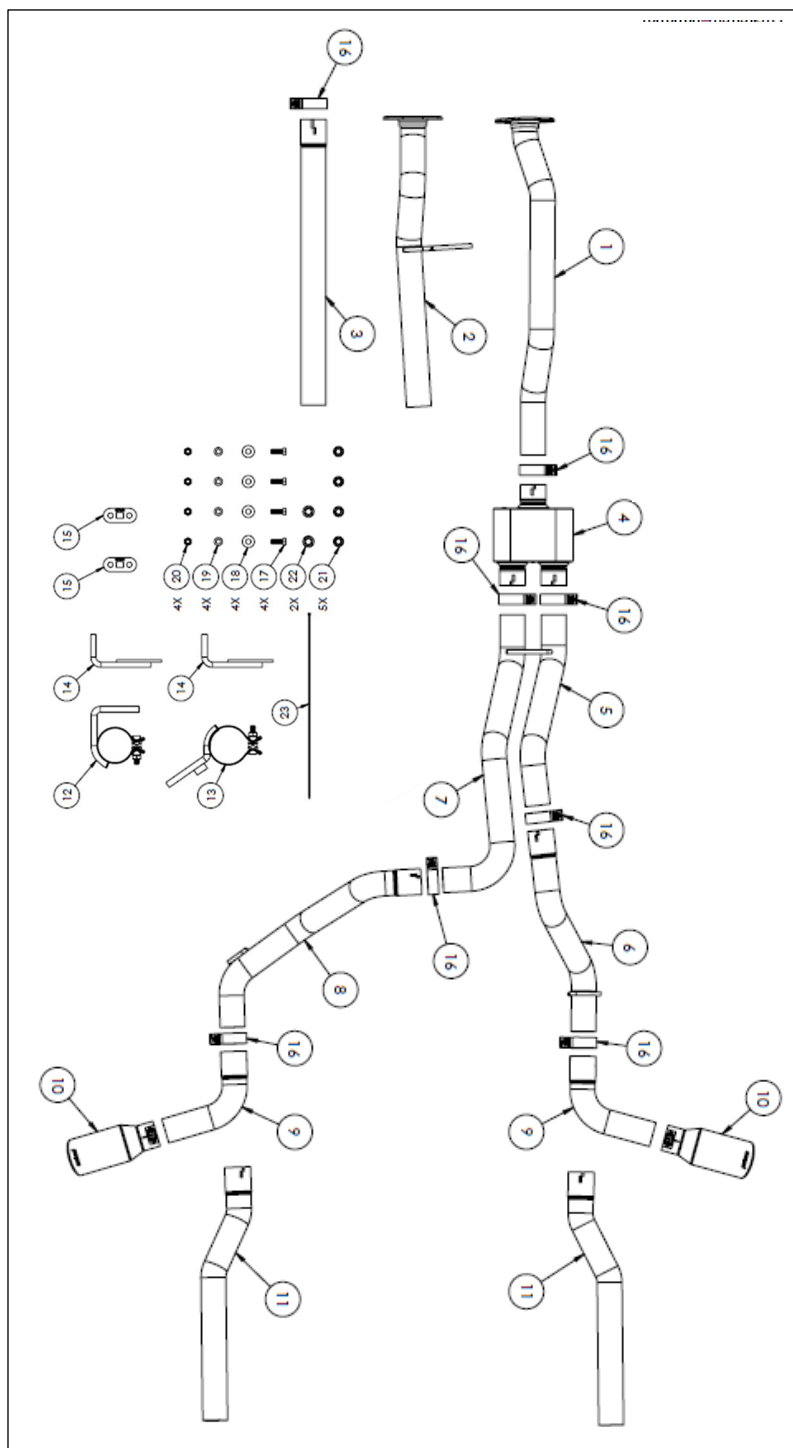

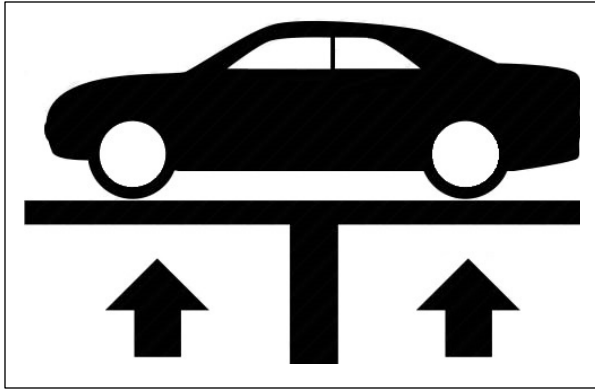

### BEFORE STARTING:

Raise the vehicle to a minimum of eighteen inches. A floor hoist is ideal. If no hoist is available, we strongly urge the use of axle stands as a safety measure. **Please read and understand these instructions and disclaimer in their entirety before attempting installation.**

## Vehicle Compatibility

Model Year: **1994-1995 (With 2 bolt flange at Catalytic Converter)**

Make: **Chevrolet/GMC**

Model: **Silverado/ Sierra 1500 / 2500 LD / 2 & 4WD**

**Single Cab Short Bed, Single Cab Long Bed**

**Ext Cab Short Bed, Ext Cab Long Bed**

Engine: **5.7L V8**

- **\* Will not work with 2500 HD CHASSIS**
- **\* Will not work with Slip Fit Catalytic Converters**
- **Tail pipe will fit up to 265/75-16 spare tire.**
- **Side exit and Rear exit tail pipe configurations included.**

**CAUTION! WORK ONLY ON A LEVEL SURFACE. USE JACKS /JACK STANDS OF SUFFICIENT CAPACITY TO LIFT AND SUPPORT YOUR VEHICLE. NEVER WORK UNDER A VEHICLE SUPPORTED BY A FLOOR OR BUMPER JACK.**

### Removing the OEM Exhaust

**NOTE: Cutting factory exhaust is necessary in some applications. Please read and follow all instructions before attempting to install this exhaust system.**

1. Apply penetrating oil to each rubber hanger on the exhaust.
2. Support the exhaust assembly before making cuts.
3. Cut the factory tail pipe(s) just after the muffler.
4. Remove tail pipe(s) from the vehicle.
5. Remove the (x2) 15mm nuts at the catalytic converter Flange . **Fig.1**
6. Remove the muffler and inlet pipe from the catalytic converter.
7. Remove the OEM tail pipe frame hanger from the frame rail behind the rear tire. It will not be used.

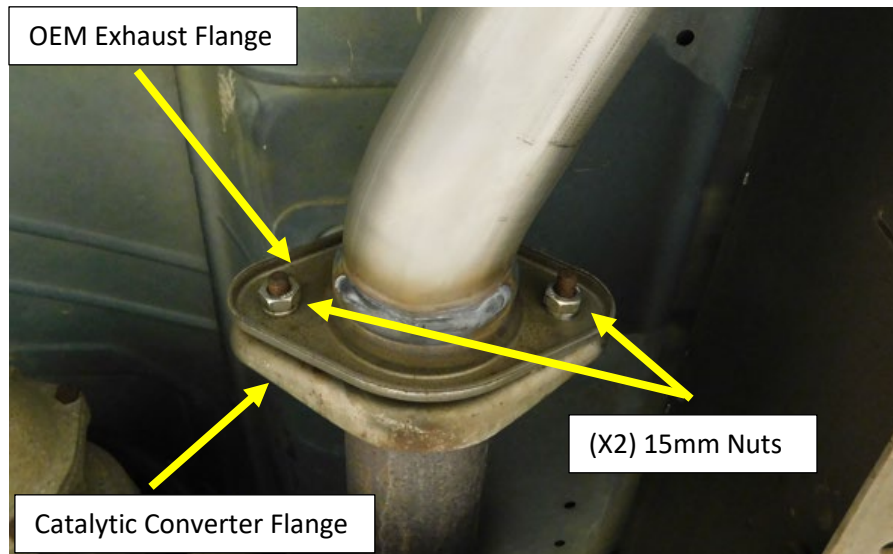

**Figure.1**

# Install your Flowmaster Exhaust System



**Before installing clamps in the following steps,** remove their nuts, apply anti-seize compound to the bolt threads, and re-install the nuts.

**Important:** If trimming Muffler extension pipe is required, Measure from the expanded and notched end of the tube . **Figure.2**

**Muffler Inlet and Extension Pipe Reference**

Wheelbase	Body Style	Bed Length	Muffler Inlet Pipe Configuration	Extension pipe length AFTER TRIMMING
117.5"	Single cab	6.5'	26977S (2) Short Inlet pipe	No Extension
131.5"	Single Cab	8'	26977S (2) Short Inlet pipe + extension	17"
141.5"	Ext Cab	6.5'	26976S (1) Long Inlet pipe + extension	20.5"
155.5"	Ext Cab	8'	26976S (1) Long Inlet pipe + extension	34.5" No trim required

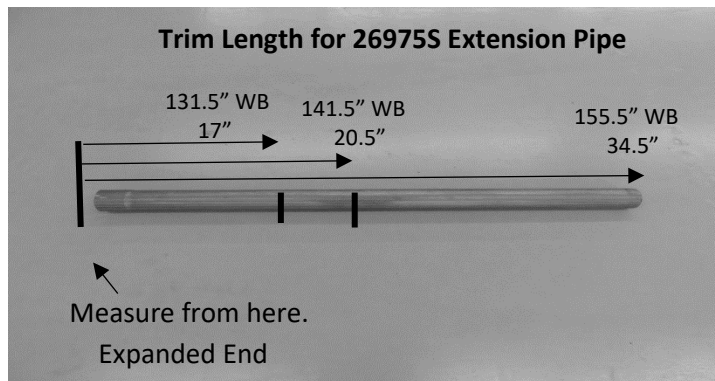
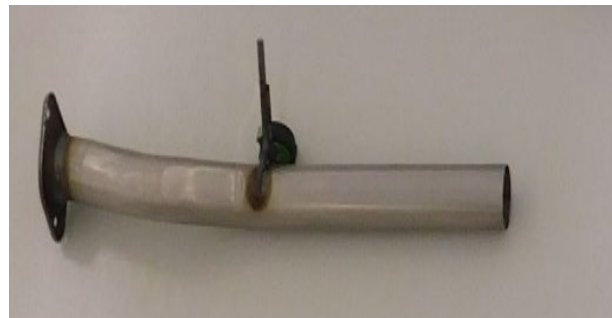

**Figure.2**

**26976S Long Muffler Inlet Pipe**



**26977S Short Muffler Inlet Pipe**



## Installation Continued

**Important:** Is your catalytic converter resting on the crossmember??

- **Recommended:** Replace the transmission mount and donut gaskets between the exhaust manifolds and down pipe with quality replacement parts prior to the installation of this exhaust. This will prevent leaks at the manifold and rattles from the catalytic converter contacting the transmission cross member due to aging and worn parts.

1. Install the correct inlet and extension pipe configuration (if require) for your application.

### Ref Parts List Page.1 and Extension pipe reference chart Page.3

- 117.5" WB-** Install the **26977S** inlet pipe on to the 2 bolt flange of the catalytic converter.  
Install the frame hanger rod into the isolator of the factory frame hanger.
- 131.5" WB-** Install the **26977S** inlet pipe on to the 2 bolt flange of the catalytic converter.  
Install the **545HA** Clamp hanger on to the muffler inlet pipe, Install the hanger rod into the factory frame hanger and leave the clamp loose.  
Install a MC300BS clamp on to the expanded end of a 17" extension pipe. Install the extension pipe on to the Muffler Inlet pipe and tighten the clamp.
- 141.5" WB-** Install the **26976S** inlet pipe on to the 2 bolt flange of the catalytic converter.  
Install the **546HA** Clamp hanger on to the muffler inlet pipe.  
Install a 20.5" Extension pipe on to the **26976S** inlet pipe  
Install the 546HA clamp hanger over the expended section of extension pipe and install the hanger rod into the factory isolator on the frame rail, tighten the clamp to allow for adjustment
- 151.5" WB-** Install the **26976S** inlet pipe on to the 2 bolt flange of the catalytic converter.  
Install the **546HA** Clamp hanger on to the muffler inlet pipe.  
Install a 34.5" Extension pipe on to the **26976S** inlet pipe  
Install the 546HA clamp hanger over the expended section of extension pipe and install the hanger rod into the factory isolator on the frame rail, tighten the clamp to allow for adjustment  
Install the **545HA** Clamp hanger on to the muffler extension pipe, Install the hanger rod into the factory frame hanger and tighten the clamp to allow for adjustment. (Some vehicles may not have this hanger)



141.5" WB shown for reference

## Installation Continued

1. Install a 3" band Clamp (16) on to each of the three muffler inlet and outlets (4).
2. Install the 8430155-z Muffler (4) on to the Muffler inlet pipe and tighten the clamp to allow for adjustment. **Fig.3**

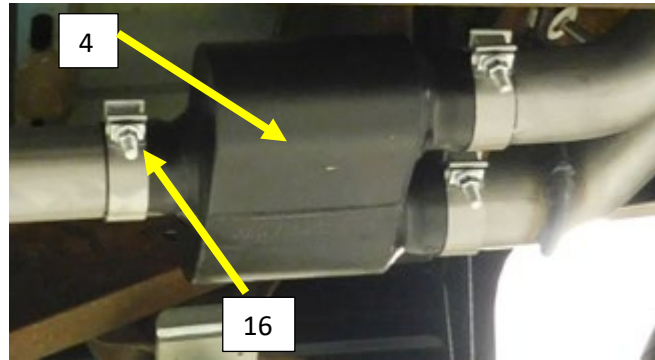

**Figure.3**

3. Install the supplied tail pipe frame hangers 166HA (14) Right and Left on to the frame rails just behind the rear tire using the existing holes in the frame, Supplied 3/8 hardware . Install the supplied red rubber Isolators (15). **Fig.4, Fig.5**

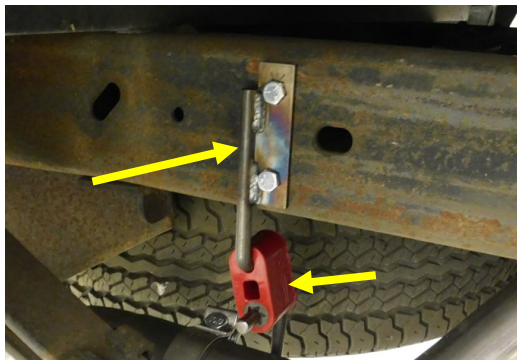

**Figure.4**



**Figure.5**



## Installation Continued

4. Insert the Right Muffler outlet pipe **(5)** into the muffler **Fig.6**.
5. Install the hanger rod into the factory isolator over the muffler. **Fig.7**
6. Tighten the clamp to allow for adjustment. Adjust the pipe for 1" to 1.5" clearance on the shock. Tighten the clamp.
7. Install the left muffler outlet pipe **(7)** into the muffler. Rotate the pipe up to within  $\frac{1}{4}$ " of the right muffler outlet pipe and tighten the clamp. **Fig.6**

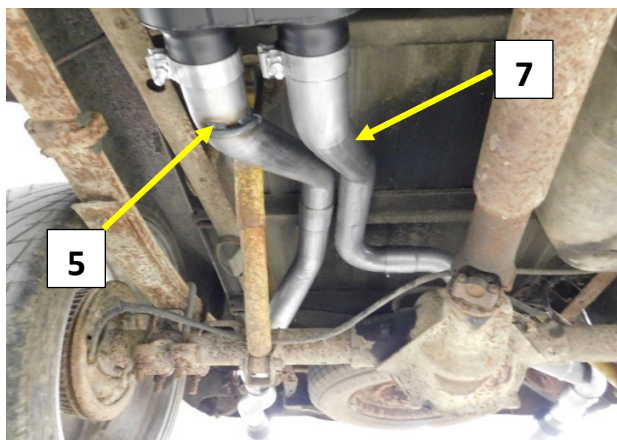

Figure. 6

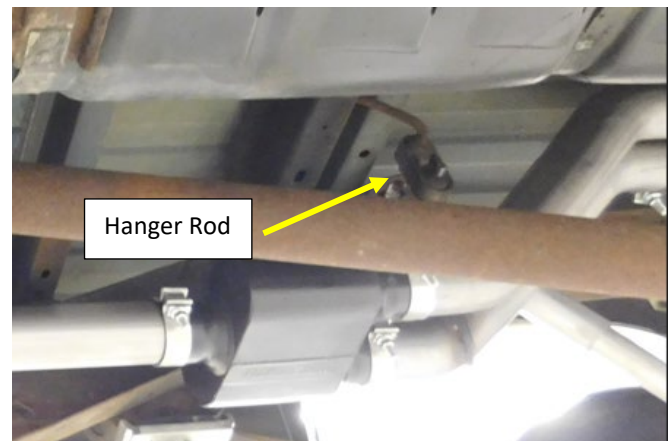
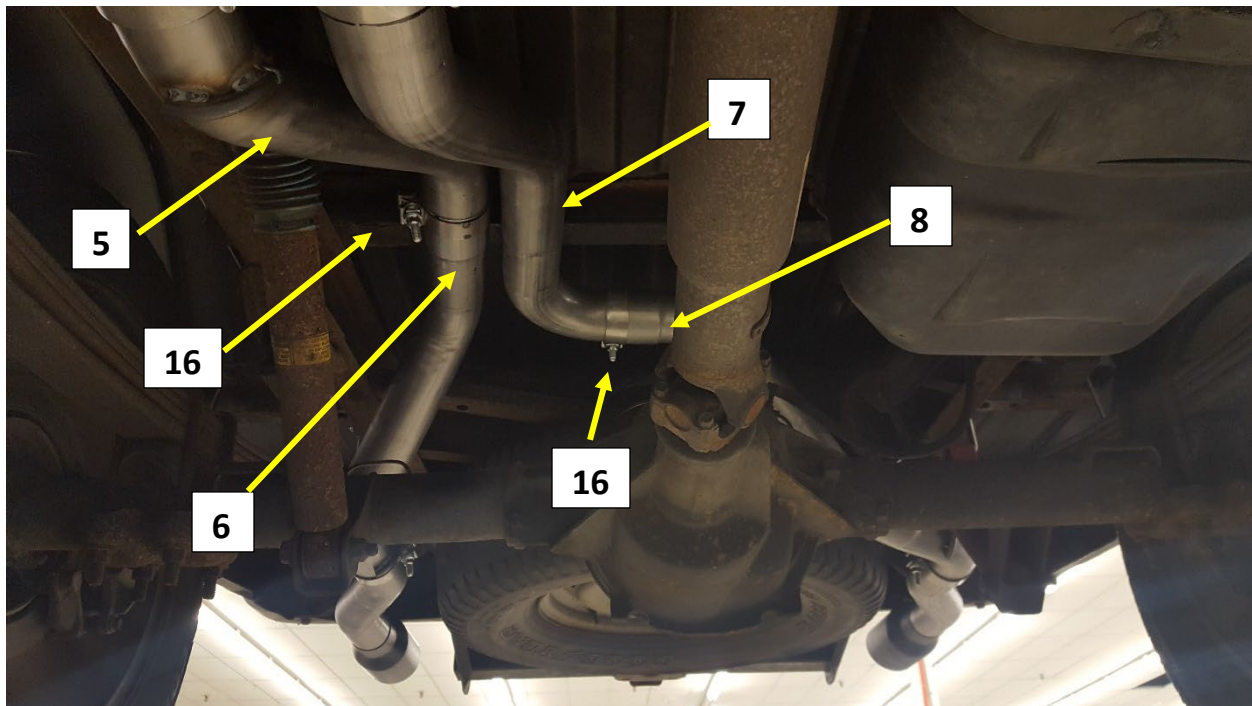

Figure. 7

## Installation Continued

8. Install a 3" band clamp (16) on to each of the right (6) and left (8) tail pipe expanded ends. **Fig.8**
9. Install the right tail pipe (6) expanded end on to the right muffler outlet pipe (5) over the axel. Insert the tail pipe hanger rod into the red hanger at the rear frame hanger. Tighten the clamp to allow for adjustment. **Fig.8**
10. Install the left tail pipe (8) on to the left muffler outlet pipe (7) directly over the differential. Insert the tail pipe hanger rod into the red hanger at the rear frame hanger. Tighten the clamp to allow for adjustment. Adjust the tail pipe for approximately 3/8" clearance at the left shock if the vehicle is on a 2-post lift with the wheels at full extension. Adjust for 1" clearance if the tires are on the ground or 4 post lift and the vehicle is at ride height. **Fig.8**



**Figure.8**

## Installation Continued

### Installing the Tail Pipe Extensions and Tips

#### PN:818191

This Flowmaster exhaust kit has been designed to have the exhaust tips exit either out under the rear bumper or exit out the side behind the rear tire. Both tail pipe extension options are supplied in this kit (See parts diagram and parts list).

**Side exit configuration-** No trimming is required.

1. Install the 26972S side exit pipes **(9)** on to the left and right tail pipes. Install a 3" band clamp **(16)** on to the pipes with the bolt at the top and the nut facing the inside. Tighten the clamp to allow for adjustment. **Fig.9**
2. Install the supplied tip and adjust to personal preference before tightening the clamps on the exit pipe and tip. **Fig.9**

**Rear exit configuration** – Requires trimming of the extension for bed length and personal preference. **Long bed** – Start with No trim / **Short bed** -Start with 8.5" trim.

1. Install a 3" Band clamp **(16)** on to the expanded end of the 26973S tail pipe extension **(11)**. Install the extension pipes on to the tail pipes and tighten the clamps to allow for adjustment.
2. Install the supplied tip and adjust to personal preference before tightening the clamps on the exit pipe and tip. **Fig.10**

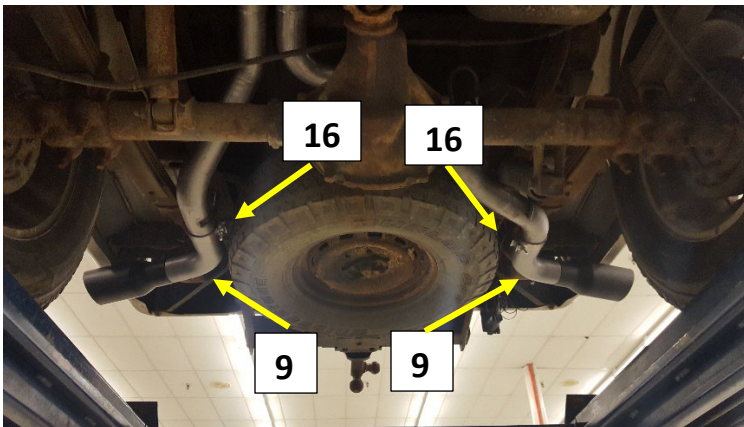

Figure.9

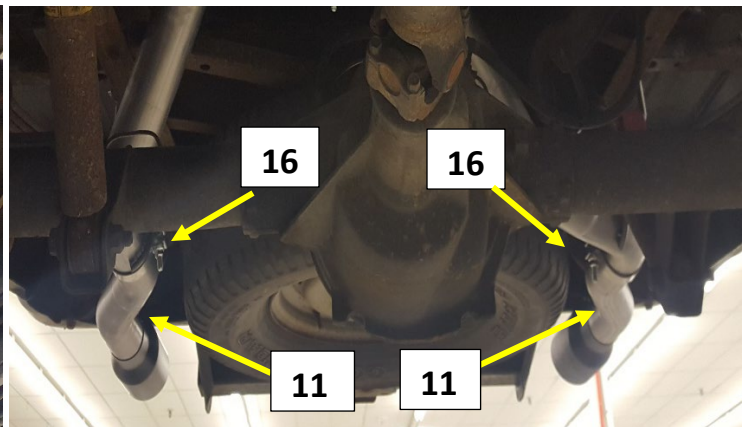

Figure.10



## Installation Continued

11. Align and adjust the system for best fit and component clearance starting at the front and working your way to the rear. Tighten the band clamps and all hardware as you go. Readjusting of components may be necessary after the first pass through the system.
12. Install the supplied push clips (21) (22) on to the hanger rods after all adjustments, this will prevent the system from moving after adjustment.



## Enjoy Your Flowmaster Exhaust!

