



Installation Instructions

718188

1996-99 GM Silverado/Sierra 1500
5.7L Engine 2WD/4WD

Installation requires moderate mechanical skill. If this job is beyond your abilities, seek the services of a qualified technician.

If you do not understand any part of these instructions, please call Flowmaster Technical Support at (866) 464-6553 for assistance.

Apply penetrating oil generously to clamps, fasteners, pipes, and hanger rods for ease of disassembly.

REVIEW THE INSTRUCTIONS & VERIFY THE KIT CONTENTS

Take a moment to read and understand these instructions before installing your Flowmaster exhaust kit.

ITM#	Part #	Description	Qty.
1	86777M	Inlet pipe	1
2	TB958M	Extension Pipe	1
3	72198-Z	Outlaw Muffler	1
4	86778M	Muffler Outlet Pipe	1
5	MC300BS	3" Band Clamp	2
6	MC250BS	2.5" Band Clamp	2
7	HA168	Red Rubber Isolator	1
8	HW208	3/8-16 X 1" Hex Bolt	2
9	HW103	3/8-16 Nut	2
10	HW303	3/8 Flat Washer	2
11	HW309	3/8 Lock Washer	2
12	HW502	7/16" Push Nut	2
13	HW503	1/2" Push Nut	1
14	GA105	Flange Gasket	1
15	539HA	Frame Hanger	1
16	540HA	3" Clamp Hanger	1

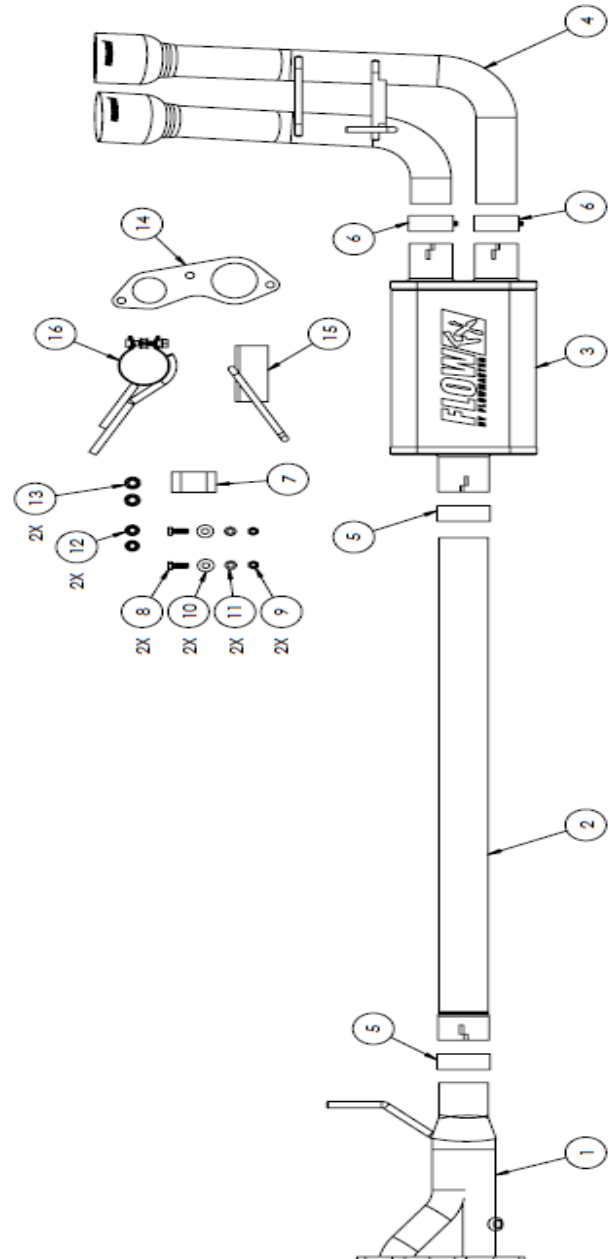

Use the parts drawing and list to identify components and verify your kit's contents. In the unlikely event that any parts are missing, please contact Flowmaster Technical Support for replacements.

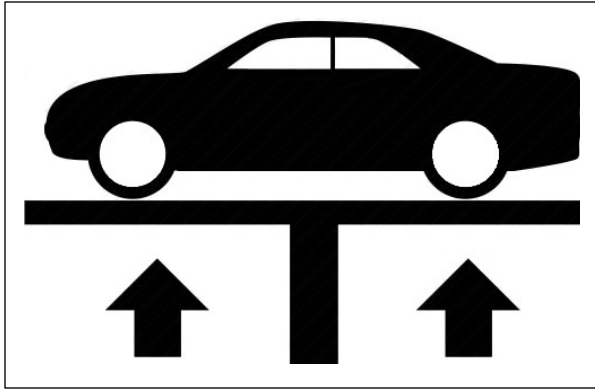

Vehicle Compatibility

Model Year: 1996-1999

Make: Chevrolet/GMC

Model: Silverado/ Sierra 1500 2WD & 4WD

Single Cab Short Bed, Single Cab Long Bed

Ext Cab Short Bed, Ext Cab Long Bed

Engine: 5.7L V8

- May interfere with some lifted truck leaf springs.

BEFORE STARTING:

Raise the vehicle to a minimum of eighteen inches. A floor hoist is ideal. If no hoist is available, we strongly urge the use of axle stands as a safety measure. **Please read and understand these instructions and disclaimer in their entirety before attempting installation.**

CAUTION! WORK ONLY ON A LEVEL SURFACE. USE JACKS /JACK STANDS OF SUFFICIENT CAPACITY TO LIFT AND SUPPORT YOUR VEHICLE. NEVER WORK UNDER A VEHICLE SUPPORTED BY A FLOOR OR BUMPER JACK.

Removing the OEM Exhaust

NOTE: Cutting factory exhaust is necessary in some applications. Please read and follow all instructions before attempting to install this exhaust system.

1. Apply penetrating oil to each rubber Hanger on the exhaust.
2. Support the Exhaust assembly before making cuts.
3. Cut the factory exhaust just after the muffler.
4. Remove the (x3) 15mm nuts at the flange just past the catalytic converter. **Figure.1**
Note: Heating the nuts with a torch may be necessary to prevent the studs from breaking. If the studs do break they can be driven out of the flange with a punch and large hammer. Replace broken studs with service parts or 3/8-16 x 1.25 Hex bolts and flanged nuts available at your local auto parts store.
5. Remove tail pipe(s) from the vehicle.
6. Remove the muffler and inlet pipe from the vehicle.
7. Remove the rear tailpipe hanger assembly from the frame rail just behind the rear tire. It will not be used.

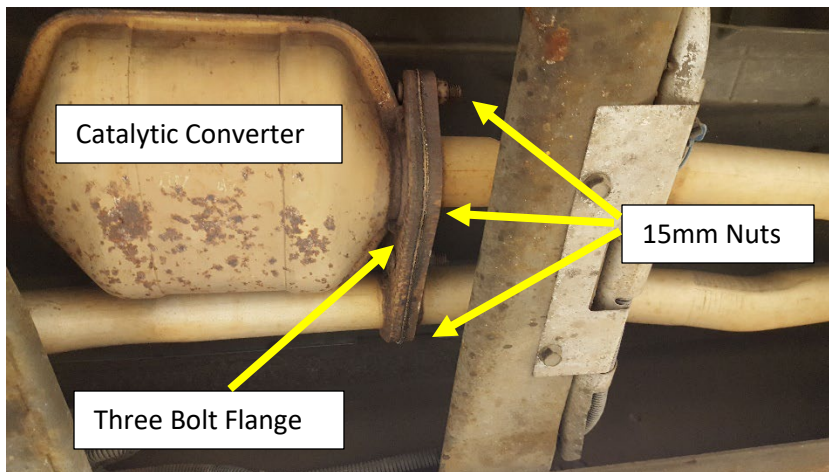

Figure.1

Install your Flowmaster Exhaust System



Before installing clamps in the following steps, remove their nuts, apply anti-seize compound to the bolt threads, and re-install the nuts.

Important: If trimming of the Muffler extension pipe is required, measure from the expanded and notched section for finished extension pipe length. **Figure.2**

Muffler Inlet Extension Pipe Reference Chart

Wheelbase	Body Style	Bed Length	Extension pipe	Trim Requirement
117.5"	Single cab	6.5'	None Required	N/A
131.5"	Single Cab	8'	YES 16 1/2"	24"
141.5"	Ext Cab	6.5'	YES 26 1/2"	14"
155.5"	Ext Cab	8'	YES 40 1/2"	NONE

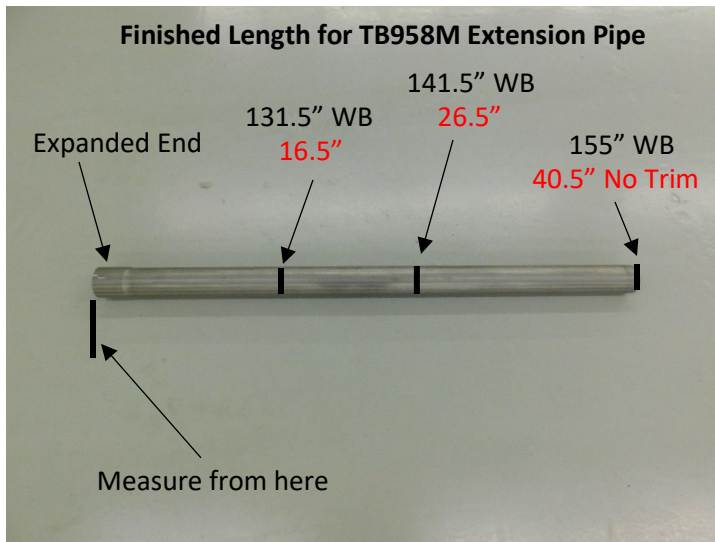

Figure.2

Installation Continued

1. Install the supplied 2-hole flange gasket **(14)** at the 3 bolt catalytic converter flange .
Note: Clean all the old gasket material from the flange. **Fig.3**
2. Install the Inlet pipe assembly **(1)** on to the 3 bolt Catalytic converter flange. Install the OEM M10 x 1.5 nuts and tighten. **Fig.3**

Attention: Only 117.5" (SC/SB) wheelbase vehicle will use the hanger rod on the inlet pipe assembly with No Extension Pipe. All other wheelbase vehicles will use the Clamp hanger assembly with an extension pipe. 117" WB vehicles muffler will install directly onto the Flowmaster Inlet pipe.

3. Install the OEM post catalyst o2 sensor into the Flowmaster Muffler Inlet pipe and connect the harness. **Note:** Apply a small amount of anti-seize to the threads.

117" WB (SC/SB) SKIP TO STEP. 8

4. Use the extension pipe reference chart to determine the correct cut length for your wheelbase vehicle (Page. 3). Trim the extension pipe as shown in **Fig.2 if used.**
5. Install a supplied 3" band clamp **(5)** on to the expanded end of the extension pipe **(2)** **Fig.3.**
6. Install the extension pipe on to the inlet pipe **(1)** and tighten the band clamp. **Fig.3**
*** Double check it is the correct length for your application.**
7. Install the supplied Clamp Hanger **(16)** on to the extension pipe **(2)** with the bolt on the top of the pipe and nut facing the drive shaft align with the frame hanger.
8. Install a 3" band clamp **(5)** on to the inlet of the muffler **(3)**.
9. Install the muffler **(3)** on to the Flowmaster inlet pipe (117' WB) or on to the extension pipe **(2)** for all other wheel base vehicles **Fig.3.** Tighten the clamp to allow for adjustment. Rotate the muffler to be level and tighten the clamp.

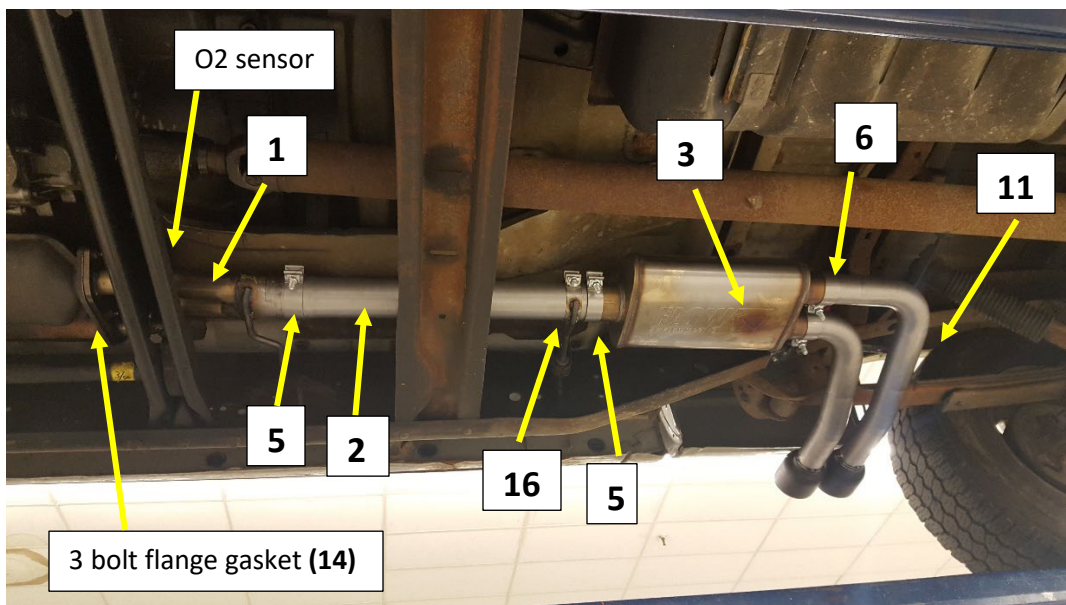

Figure.3 (Extended Cab SB Shown)

Installation Continue

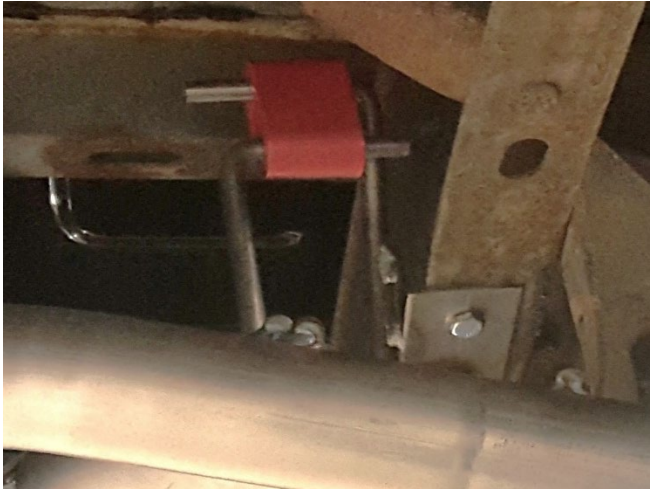

Figure.4

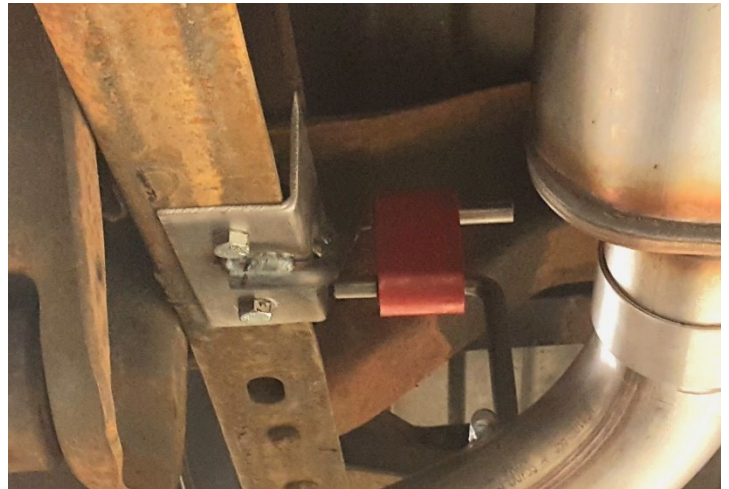

Figure.5

10. Install a 2.5" band clamp on to each of the muffler outlets **(6)**. **Fig 3**
11. Install the tail pipe assembly **(11)** into the muffler. **Fig.3**
12. Install the supplied red exhaust isolator **(7)** on to the tail pipe hanger rod. **Fig.4**
13. Install the supplied tail pipe frame hanger 539HA **(15)** on to the red rubber isolator. **Fig.4**
14. Rotate the red isolator up so that the muffler hanger rod is at the Six o'clock position and the frame hanger rod is directly above at the Twelve o'clock position. **Fig.4**
Note: The frame hanger rod should pass in front of the tail pipe hanger rod with 1" clearance.
15. Align the 2x existing bolt holes in the bottom of the frame rail and install the supplies 3/8-16 Bolts, Washers and Nuts. **Fig.4**

Note: If your vehicle is missing the holes in the frame.

- Hold the frame hanger bracket tight against the frame rail with the isolator connected to the tail pipes. Be sure the hanger rods are in the position outlined in step.14
 - Transfer the bolt holes to the frame rail using a sharpie or scribing tool.
 - Drill the holes with a 3/8" drill bit
 - Install the hardware as outlined in step.15
16. Make final adjustments to the tail pipes and muffler then tighten the clamps.
 17. Install the supplied Clip nuts to hold the hanger rods in position.



Enjoy your Flowmaster Exhaust!