



## INSTALLATION INSTRUCTIONS

FTS24210		DRAG LINK KIT
1	FT50578	DRAG LINK
1	FT50705	TIE ROD END
1	FT50649	M29-1.5 RIGHT HAND THREAD JAM NUT
1	FT50650	M33-1.5 LEFT HAND THREAD JAM NUT
1	FT50651	HARDWARE SUBASSEMBLY

FT50651		HARDWARE SUBASSEMBLY
1	FT24210i	INSTRUCTIONS
1	FT50652	STEERING KNUCKLE INSERT
1	62000005152	5/8" USS FLAT WASHER
1	62000005081	5/8" SAE WASHER
1	FTAS12	STICKER FT BLUE 10X4
1	FTAS16	DRIVER WARNING DECAL
1	FTREGCARD	REGISTRATION CARD

## 2018-2023 JEEP WRANGLER(JL)/GLADIATOR(JT)

### DRAG LINK KIT

#### FTS24210

**NOTE: REFER TO OPTIONAL KIT BOX INSTRUCTIONS PRIOR TO INSTALLATION.**

**NOTE:** TO ORDER WEARABLE REPLACEMENT COMPONENTS DO NOT USE PART NUMBERS SHOWN ON THIS INSTRUCTION SHEET. GO TO FABTECH WEBSITE AND LOOK UP WEARABLE REPLACEMENT PARTS TO FIND THE PROPER PART NUMBER TO ORDER.

Fabtech Motorsports | 12480 East End Ave. Chino, CA 91710

Tech Line: 909-597-7800 | Web: [www.fabtechmotorsports.com](http://www.fabtechmotorsports.com)

## - TOOL LIST -

### *Required Tools (Not Included)*

- Basic Hand Tools
- Floor Jack
- Jack Stands
- Torque Wrench
- Assorted Metric and S.A.E sockets, and Allen wrenches
- Die Grinder w/ Cutoff Wheel or Sawzall
- Drill
- 1" Drill Bit

## - PRE-INSTALLATION NOTES -

For technical assistance call: **909-597-7800** or e-mail: **info@fabtechmotorsports.com**

### **READ THIS BEFORE YOU BEGIN INSTALLATION -**

Check all parts to the parts list above before beginning installation. If any parts are missing contact Fabtech at 909-597-7800 and a replacement part will be sent to you immediately.

Read all instructions thoroughly from start to finish before beginning the installation. If these instructions are not properly followed severe frame, driveline and / or suspension damage may occur.

Check your local city and state laws prior to the installation of this system for legality. Do not install if not legal in your area.

Prior to the installation of this suspension system perform a front end alignment and record. Do not install this system if the vehicle alignment is not within factory specifications. Check for frame and suspension damage prior to installation.

The installation of this suspension system should be performed by two professional mechanics.

This suspension must be installed with Fabtech shock absorbers.

Use the provided thread locking compound on all hardware.

**WARNING-** Installation of this system will alter the center of gravity of the vehicle and may increase roll over as compared to stock.

Vehicles that receive oversized tires should check ball joints, uniballs, tie rods ends, pitman arm and idler arm every 2500-5000 miles for wear and replace as needed.

Verify differential fluid is at manufactures recommended level prior to kit installation. Installation of the kit will reposition the differential and the fill plug hole may be in a different position. (For example, if the manufacture recommends 3 quarts of fluid, make sure the diff has 3 quarts of fluid). Check your specific manual for correct amount of fluid.

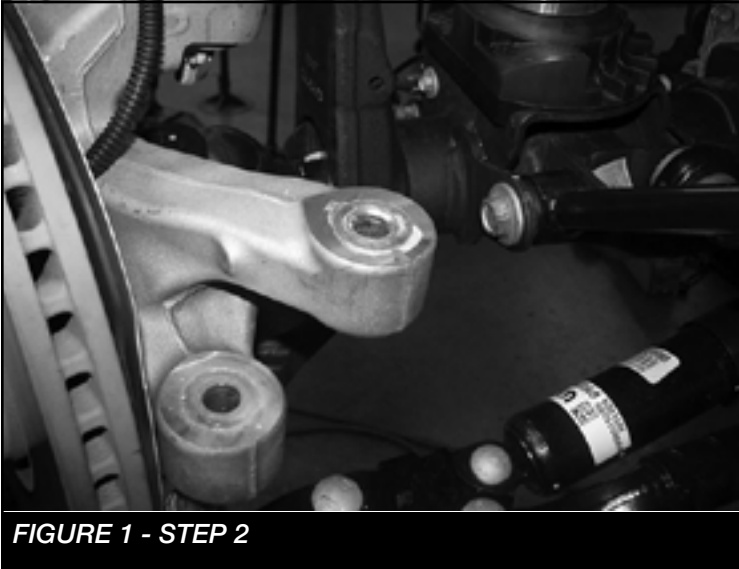
### ***FOOTNOTES -***

-

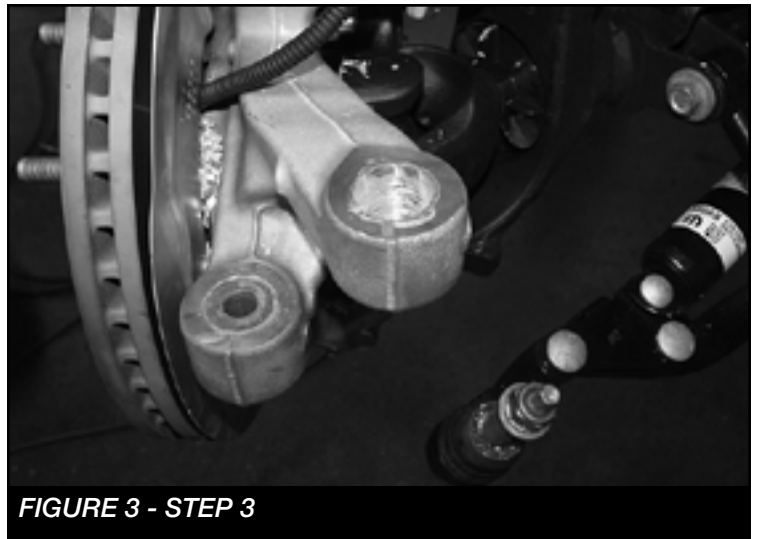
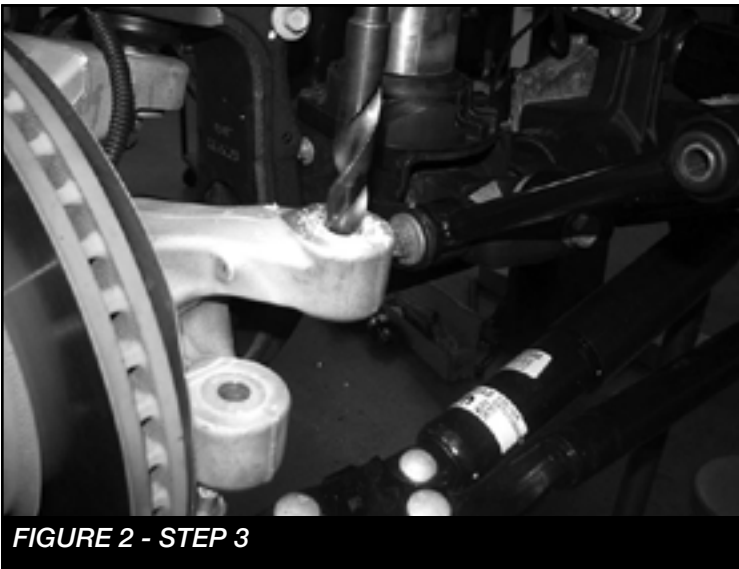
# - INSTRUCTIONS -

## FRONT SUSPENSION

1. Jack up the front end of the vehicle and support the frame rails with jack stands. **NEVER WORK UNDER AN UNSUPPORTED VEHICLE!** Remove the front tires.
2. Completely remove the factory drag link from the vehicle. Then disconnect the center link from the passenger side knuckle only. **SEE FIGURE 1**



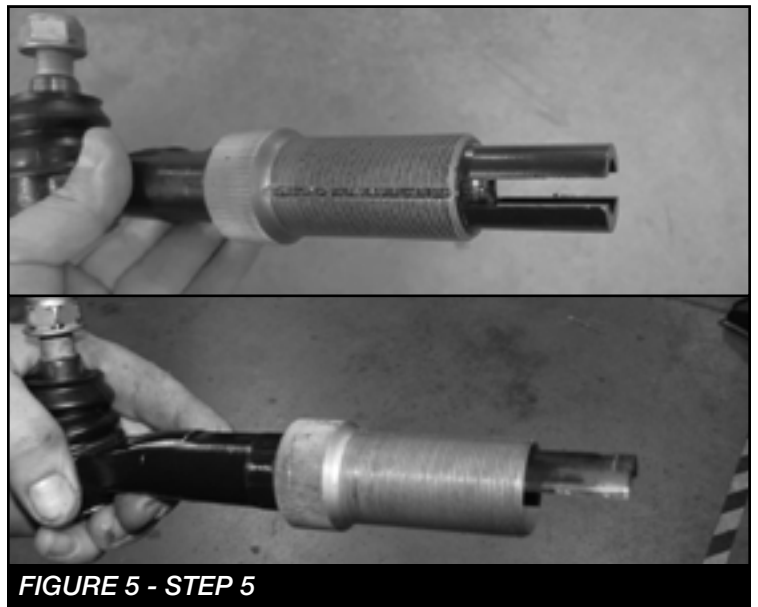
3. Using a 1" drill bit. Drill out the tapered hole on the knuckle where the factory drag link mounted. **SEE FIGURE 2-3**



4. Insert the FT50652 (Steering Knuckle Insert) into the knuckle to check it fits correctly and is flush with the bottom side. **SEE FIGURE 4**



5. Locate the factory drag link. Loosen the adjuster and remove the rod end with the collar. **NOTE: There are two variances depending of the year of the vehicle. SEE FIGURE 5**

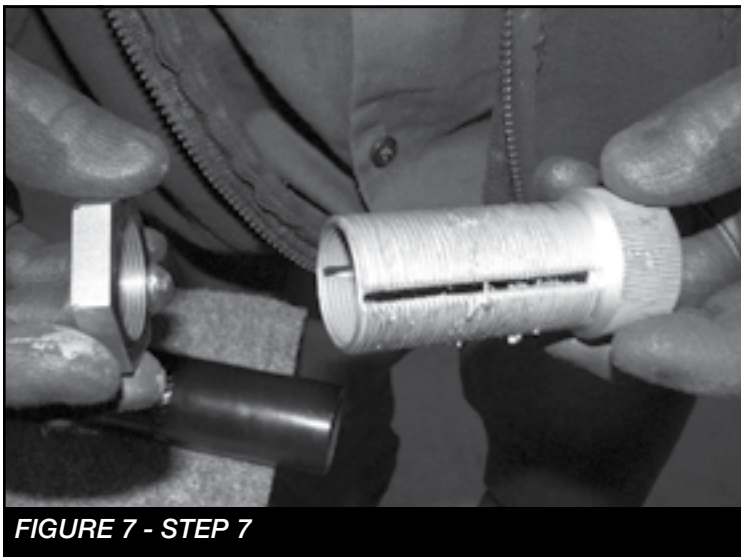


6. Remove the collar from the rod end. The ear on the threaded end will need to be cut off flush. **SEE FIGURE 6**

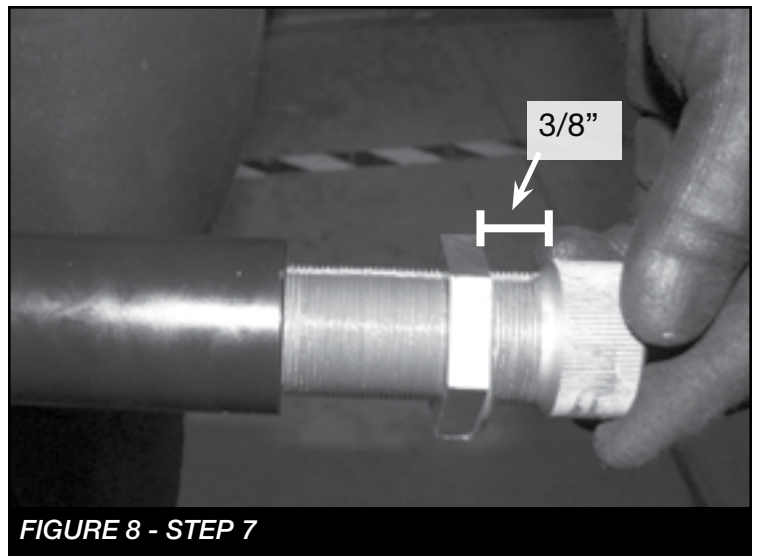


**FIGURE 6 - STEP 6**

7. Install the FT50650 (M33-1.5 Jam Nut) onto the factory adjuster. Next, install the adjuster into the FT50578 (Drag Link). **NOTE: When installing leave 3/8" space between the jam nut and the adjuster. This is a starting point, final adjustments will be made when alignment is made. SEE FIGURES 7-8**



**FIGURE 7 - STEP 7**

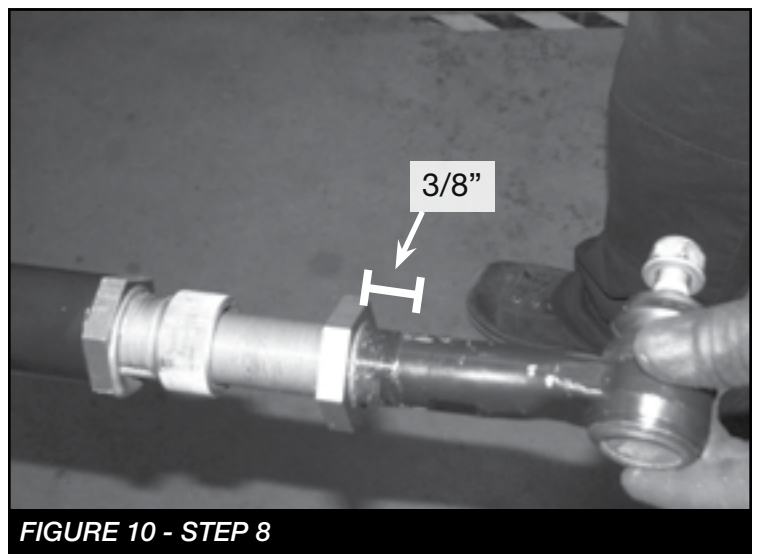


**FIGURE 8 - STEP 7**

8. Install FT50649 (M29-1.5 Jam Nut) onto the factory rod end. Next, install the rod end into the adjuster. **NOTE: When installing leave 3/8" space between the jam nut and the end of the thread on the rod end. This is a starting point, final adjustments will be made when alignment is made. SEE FIGURES 9-10 for installation and FIGURE 11 for final setup.**



**FIGURE 9 - STEP 8**



**FIGURE 10 - STEP 8**

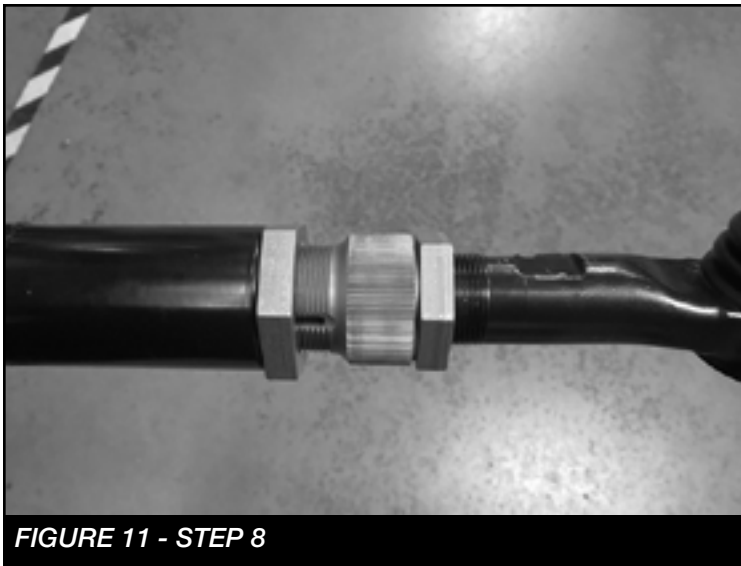


FIGURE 11 - STEP 8

9. Install the supplied Jam Nut on the FT50705 (Tie Rod End). **NOTE: When installing leave 1/2" space between the jam nut and the end of the thread on the rod end. This is a starting point, final adjustments will be made when alignment is made. SEE FIGURE 12.** Install the new rod end into the drag link.

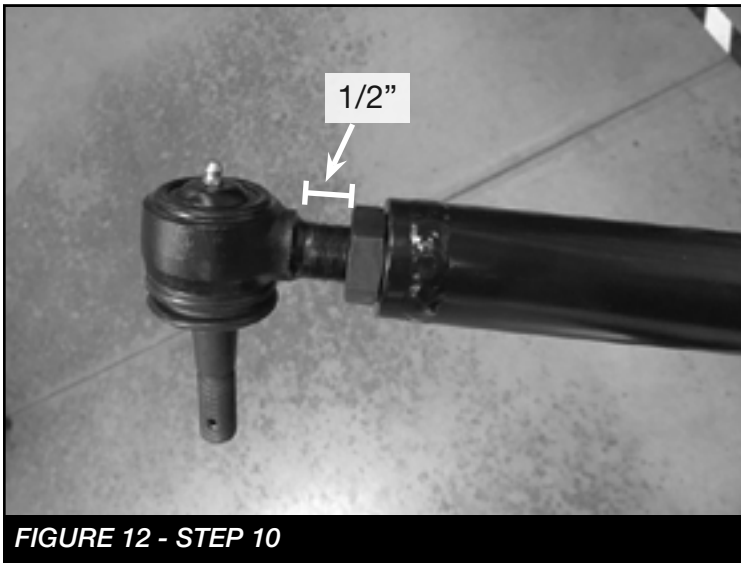


FIGURE 12 - STEP 10

10. Install the new drag link to the pitman arm and knuckle.

Torque to 43 ft-lbs. **NOTE:** The straight end with the factory rod end will attach to the pitman arm. **SEE FIGURE 14**

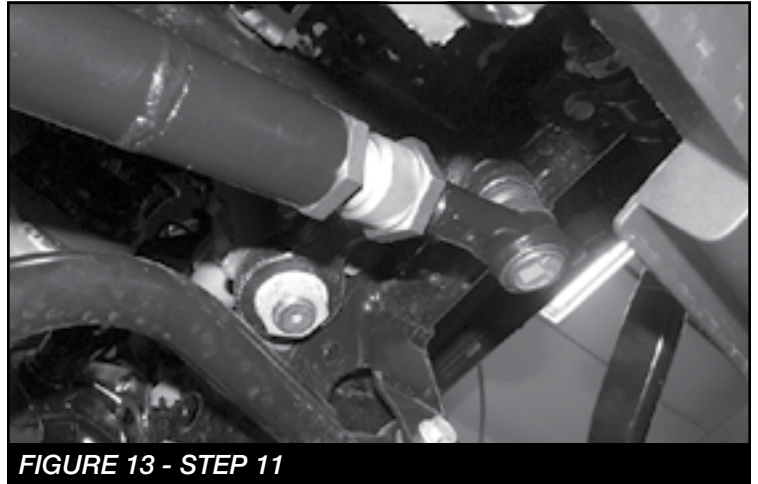


FIGURE 13 - STEP 11

11. Next, install the end with the new rod end to the knuckle like shown in **FIGURE 19** using the supplied 5/8" USS washer & 5/8" SAE washer on the bottom side. Torque to 43 ft-lbs then install cotter pin. **NOTE: Make sure the washer sits completely flush with the knuckle. Grind/sand accordingly for proper fit. SEE FIGURE 15**

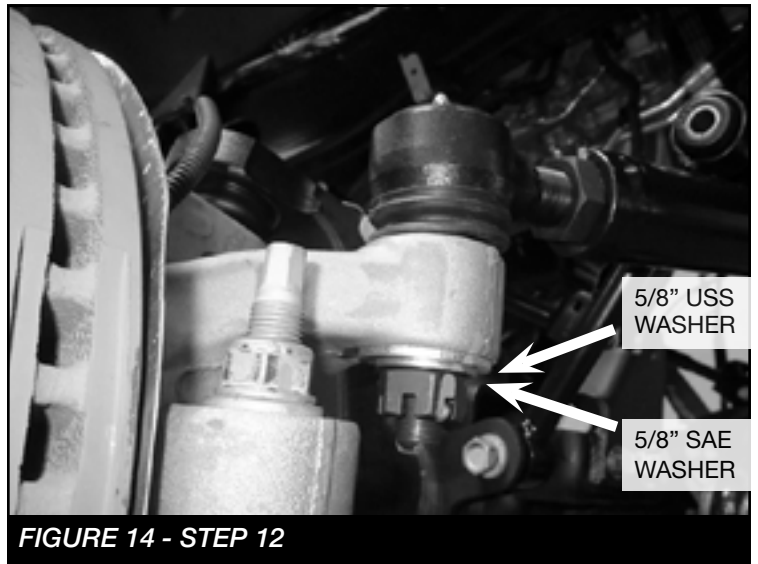


FIGURE 14 - STEP 12

12. Continue with the installation of optional kit boxes at this time.
13. Install Driver Warning Decal. Complete product registration card and mail to Fabtech in order to receive future safety and technical bulletins on this suspension.

**Vehicles that will receive oversized tires should check ball joints, uniballs and all steering components every 2500-5000 miles for wear and replace as required.**

**RETORQUE ALL NUTS, BOLTS AND LUGS AFTER 50 MILES AND PERIODICALLY THEREAFTER.**

For technical assistance call: **909-597-7800**

## - Product Warranty and Warnings -

Fabtech provides a Limited Lifetime Warranty to the original retail purchaser who owns the vehicle, on which the product was originally installed, for defects in workmanship and materials.

The Limited Lifetime Warranty excludes the following Fabtech items; bushings, bump stops, ball joints, tie rod ends, limiting straps, cross shafts, heim joints and driveshafts. These parts are subject to wear and are not considered defective when worn. They are warranted for 60 days from the date of purchase for defects in workmanship.

Dirt Logic and Performance Coilover take apart shocks are considered a serviceable shock with a one year warranty on leakage only. Service seal kits are available separately for future maintenance. All other shocks are covered under our Limited Lifetime Warranty.

Fabtech does not warrant any product for finish, alterations, modifications and/or installation contrary to Fabtech's instructions. Alterations to the finish of the parts including but not limited to painting, powder coating, plating and/or welding will void all warranties. Some finish damage may occur to parts during shipping, which is considered normal and is not covered under warranty.

Fabtech products are not designed nor intended to be installed on vehicles used in race applications or for racing purposes or for similar activities. (A "RACE" is defined as any contest between two or more vehicles, or any contest of one or more vehicle against the clock, whether or not such contest is for a prize). This warranty does not include coverage for police or taxi vehicles, race vehicles, or vehicles used for government or commercial purposes. Also excluded from this warranty are sales outside of the United States of America.

Installation of most suspension products will raise the center of gravity of the vehicle and will cause the vehicle to handle differently than stock. It may increase the vehicle's susceptibility to a rollover, on road and off road, at all speeds. Extreme care should be taken to operate the vehicle safely at all times to prevent rollover or loss of control resulting in serious injury or death. Fabtech front end Desert Guards may impair the deployment or operation of vehicles equipped with supplemental restraining systems/air bag systems and should not be installed if the vehicle is equipped as so.

Fabtech makes every effort to ensure suspension product compatibility with all vehicles listed on the website, but due to unknown auto manufacturer's production changes and/or inconsistencies by the auto manufacturer, Fabtech cannot be responsible for 100% compatibility, including the fitment of tire and wheel sizes listed. The Tire and Wheel sizes listed in Fabtech's website are only a guideline for street driving with noted fender trimming. Fabtech is not responsible for damages to the vehicle's body or tires. Fabtech is not responsible for premature wear of factory components due to the installation of oversized tires and wheels.

Fabtech's obligation under this warranty is limited to the repair or replacement, at Fabtech option, of the defective product only. All costs of removal, installation or re-installation, freight charges, incidental or consequential damages are expressly excluded from this warranty. Fabtech is not responsible for damages and/or warranty of other vehicle parts related or non related to the installed Fabtech product. This warranty is expressly in lieu of all other warranties expressed or implied. This warranty shall not apply to any product that has been subject to accident, negligence, alteration, abuse or misuse as determined by Fabtech.

Fabtech suspension components must be installed as a complete system including shocks as shown on our website. All warranties will become void if Fabtech parts are combined and/or substituted with other aftermarket suspension products. Combination and/or substitution of other aftermarket suspension parts may cause premature wear and/or product failure resulting in an accident causing injury or death. Fabtech does not warrant products not manufactured by Fabtech.

Depending on the condition of the factory suspension components retained after the installation of a Fabtech suspension not all vehicles may have the same ride stance front to rear as described in the website. The blue color of suspension components shown in all Fabtech photographs are for display purposes only. Majority of all Fabtech components will be black specifically where noted with part numbers ending in BK.

Installation of Fabtech product may void the vehicles factory warranty; it is the consumer's responsibility to check with their local vehicle's dealer for warranty disposition before the installation of the product. Some state laws may prohibit modification of suspension to a vehicle in whole or in part. It is the responsibility of the installer and consumer to consult local laws prior to the installation of any Fabtech suspension product to comply with such written laws.

It is the responsibility of the distributor and/or the retailer to review all warranties and warnings of Fabtech products with the consumer prior to purchase.

Fabtech reserves the right to super cede, discontinue, change the design, finish, part number and/or application of parts when deemed necessary without written notice. Fabtech is not responsible for misprints or typographical errors within the website or price sheet. For the most recent Product Warranty and Warnings visit our website [www.fabtechmotorsports.com](http://www.fabtechmotorsports.com)



## INSTALLATION INSTRUCTIONS

<b>FTS24224</b>		<b>LONG ARM KIT (FRONT)</b>
2	FT50640	FRONT UPPER LINK 5 TON
2	FT50641	FRONT LOWER LINK 5 TON
1	FT50636	UPPER 4-LINK MOUNT (DRIVER)
1	FT50637	UPPER 4-LINK MOUNT (PASSENGER)
1	FT50626	FRONT SKID PLATE
1	FT50627	FRONT CROSSMEMBER
1	FT50718	HARDWARE SUBASSEMBLY

<b>FT50718</b>		<b>HARDWARE SUBASSEMBLY</b>
1	FT24224i	INSTRUCTIONS
2	FT50693	CROSSMEMBER NUT TAB (REAR)
1	FT44152	CROSSMEMBER NUT TAB (DRIVER FRONT)
1	FT44153	CROSSMEMBER NUT TAB (PASS FRONT)
4	FT50414	MISALIGNMENT 7/8"
4	FT50415	MISALIGNMENT 1" - 9/16" ID
4	FT50594	MISALIGNMENT 1" - 16MM ID
2	FT50509	LINK TWIST WASHER
1	FT50719	HARDWARE KIT
1	FTAS12	STICKER FT BLUE 10X4 DIE CUT
1	FTAS16	DRIVER WARNING DECAL
1	FTREGCARD	REGISTRATION CARD

<b>FT50719 - HARDWARE KIT</b>		<b>LOCATION</b>
6	7/16-14 X 1-1/4" HEX BOLT	CROSSMEMBER POCKET
16	7/16" SAE WASHER	
8	7/16-14 C-LOCK NUT	
6	1/2-13 X 1-1/4" HEX BOLT	SKID PLATE/ XMEMBER
2	1/2-13 X 1-1/2" HEX BOLT	CROSSMEMBER
2	1/2-13 C-LOCK NUT	
10	1/2 SAE WASHER	
2	7/16-14 X 3-1/4" HEX BOLT	FRONT UPPER LINK
2	9/16-12 X 4 HEX BOLT	FRONT LOWER LINK
2	9/16-12 C-LOCK NUT	
4	9/16" SAE WASHER	
1	THREAD LOCKING COMPOUND 1 MIL	

# 2018-2023 JEEP WRANGLER JL 2020-2023 JEEP GLADIATOR JT

## CRAWLER KIT (FRONT)

**FTS24224**

Fabtech Motorsports | 12480 East End Ave. Chino, CA 91710

Tech Line: 909-597-7800 | Web: [www.fabtechmotorsports.com](http://www.fabtechmotorsports.com)

## - TOOL LIST -

### *Required Tools (Not Included)*

- |                   |                               |                                    |
|-------------------|-------------------------------|------------------------------------|
| -Basic Hand Tools | -Torque Wrench                | -Assorted Metric and S.A.E sockets |
| -Floor Jack       | -Drill w/ assorted drill bits | -Jack Stands                       |

## - PRE-INSTALLATION NOTES -

For technical assistance call: **909-597-7800** or e-mail: **info@fabtechmotorsports.com**

### ***READ THIS BEFORE YOU BEGIN INSTALLATION -***

Check all parts to the parts list above before beginning installation. If any parts are missing contact Fabtech at 909-597-7800 and a replacement part will be sent to you immediately.

Read all instructions thoroughly from start to finish before beginning the installation. If these instructions are not properly followed severe frame, driveline and / or suspension damage may occur.

Check your local city and state laws prior to the installation of this system for legality. Do not install if not legal in your area.

Prior to the installation of this suspension system perform a front end alignment and record. Do not install this system if the vehicle alignment is not within factory specifications. Check for frame and suspension damage prior to installation.

The installation of this suspension system should be performed by two professional mechanics.

This suspension must be installed with Fabtech shock absorbers.

Installation of all fasteners requires the use of provided thread locking compound with proper torque values as indicated throughout the installation. Apply thread locking compound upon the final torque of the fastener.

**WARNING-** Installation of this system will alter the center of gravity of the vehicle and may increase roll over as compared to stock.

Vehicles that receive oversized tires should check ball joints, uniballs, tie rods ends, pitman arm and idler arm every 2500-5000 miles for wear and replace as needed.

Verify differential fluid is at manufactures recommended level prior to kit installation. Installation of the kit will reposition the differential and the fill plug hole may be in a different position. (For example, if the manufacture recommends 3 quarts of fluid, make sure the diff has 3 quarts of fluid). Check your specific manual for correct amount of fluid.

Fabtech replacement driveshafts are required with this system. Due to the different shafts for the 2-door and 4-door models, the driveshafts are sold separately. See chart below for proper driveshafts for your model of Jeep.

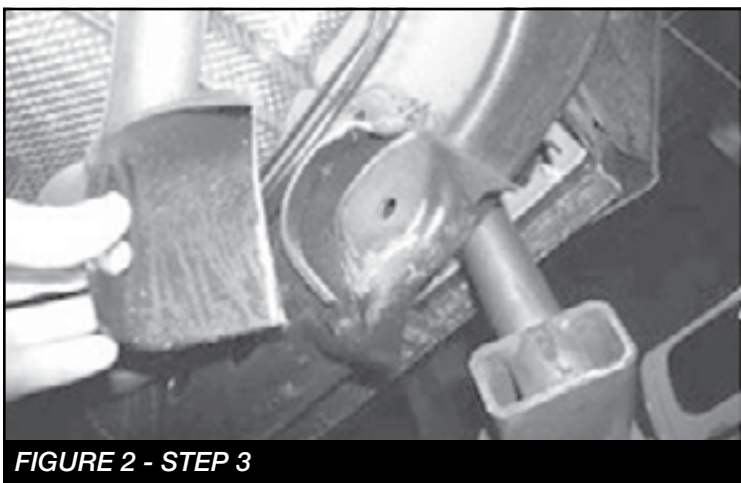
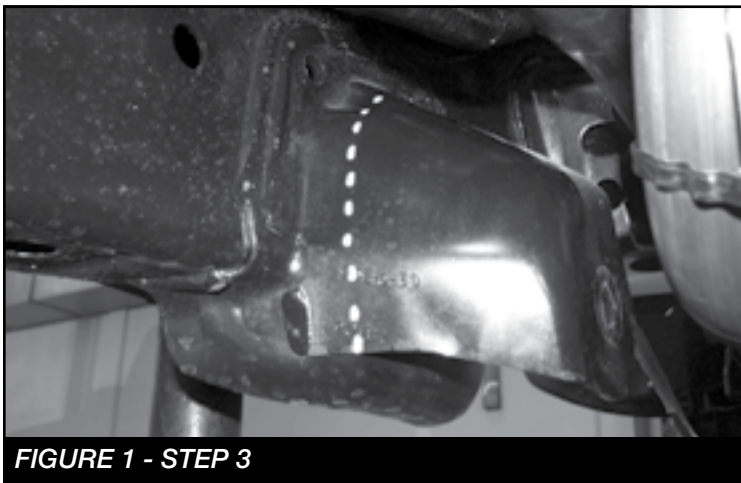
### **FOOTNOTES -**

- Fits 4-door models only
- Exhaust modification required on all Jeep Wrangler & Gladiator models order AFE # 48-48024 (Loop delete pipe)
- For heavy offroad use, front driveshaft is required. Order FTS94057
- For heavy offroad use, rear driveshaft is required. See a quality driveline supplier to order
- Fits 6 cyl. gas models only

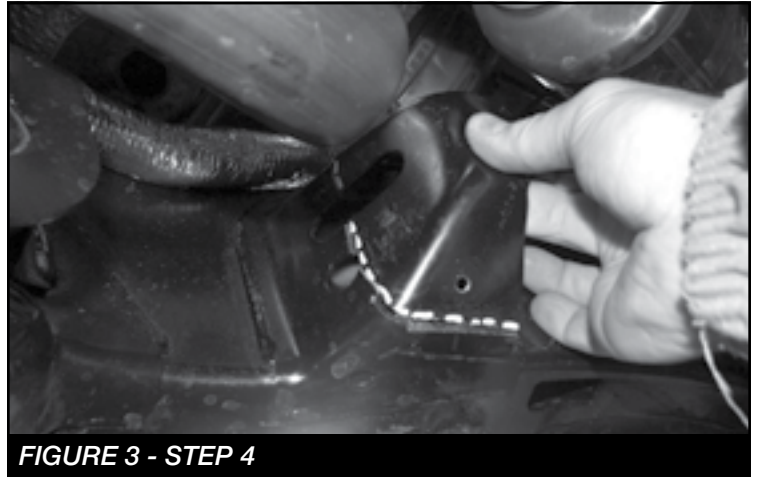
## - INSTRUCTIONS -

### **NOTE: REFER TO OPTIONAL KIT BOX INSTRUCTIONS PRIOR TO INSTALLATION.**

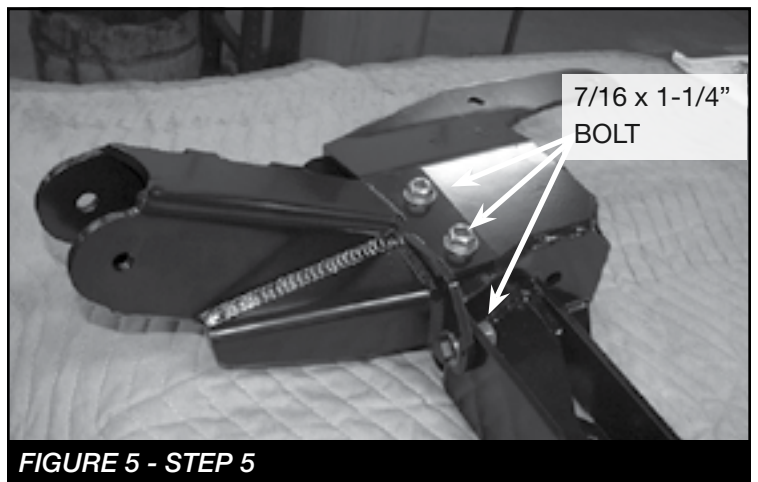
1. Disconnect the negative terminal on the battery. With the vehicle on level ground, set the emergency brake and block the rear tires. Jack up the front end of the truck and support the frame rails with jack stands. **NEVER WORK UNDER AN UNSUPPORTED VEHICLE!** Remove the front tires. Support the front axle. Do not allow to hang freely. Refer to coil spring instructions for disassembly of end links, coil springs and other components.
2. Remove factory cross member and save hardware. Next, remove the front driveshaft and upper and lower link arms.
3. Use a paint pen and mark the inside of both driver and passenger side lower link arm pockets as shown in the photos (cut flush with the outside mount, not the frame itself). Use a sawzall or die grinder with a cut off wheel and remove the inside of the pocket. Use an angle grinder with a sanding disc to sand the cut area of the pocket. Paint all bare metal areas. **SEE FIGURE 1-2**

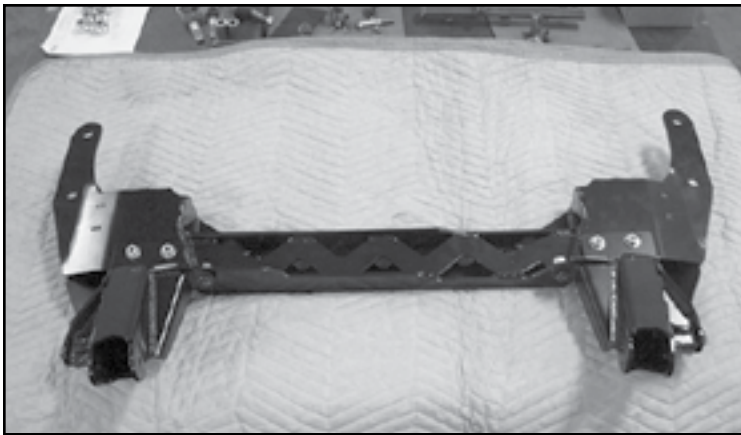


4. Next, Locate the upper link pockets on both Driver and passenger sides. Mark and cut the factory bracket off of the frame. Sand to a smooth finish and paint all raw surfaces. **SEE FIGURES 3-4**



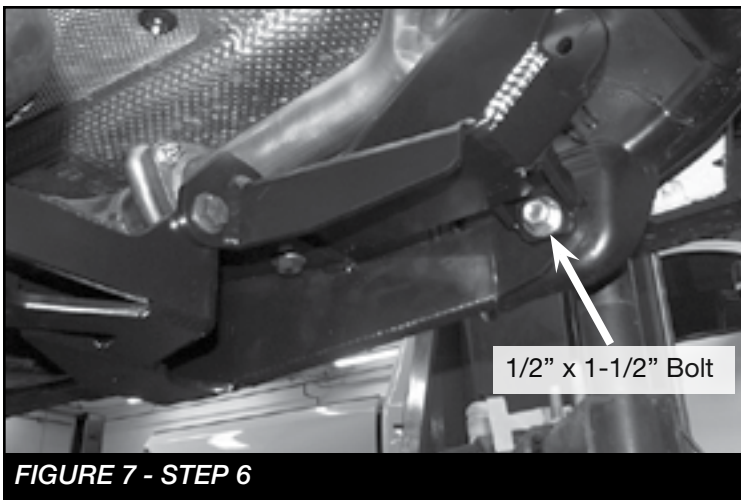
5. Install FT50636 (Driver Upper Link Mount) and FT50637 (Pass Upper Link Mount) to FT50627 (Front Crossmember) using the supplied 7/16 X 1-1/4" Bolts, nuts and washers. Torque to 83 ft-lbs **SEE FIGURE 5-6**



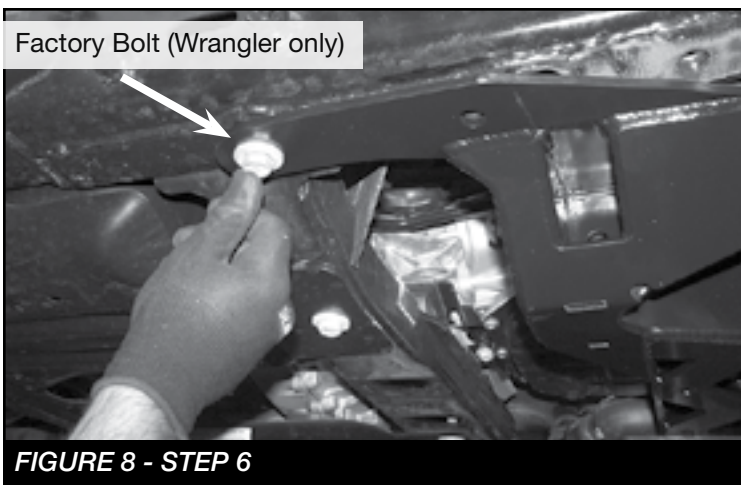


**FIGURE 6 - STEP 6**

6. Using another person, mount the new Fabtech crossmember to the vehicle using the supplied 1/2" x 1-1/2" hardware at the old lower link locations and the factory bolt for the passenger rear location. Leave loose. **NOTE: If installing on a Gladiator install FT50693 (Nut tab) at the passenger rear location by inserting the nut tab through the opening on the frame and use the supplied 1/2" x 1-1/4" hex bolt and washer. SEE FIGURES 7-8**

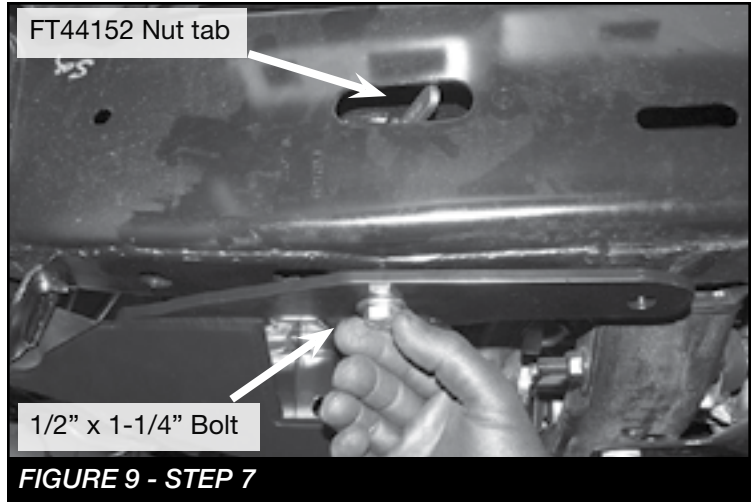


**FIGURE 7 - STEP 6**



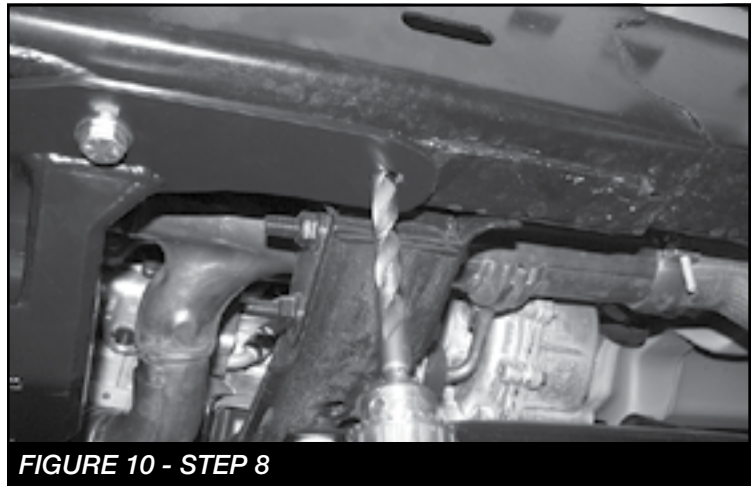
**FIGURE 8 - STEP 6**

7. **DRIVER SIDE** - Using the supplied 1/2" x 1-1/4" bolt, washer and FT44152 (Driver Nut Tab). Install the Nut tab through the factory slot on driver side of the frame. Leave loose. **SEE FIGURE 9**

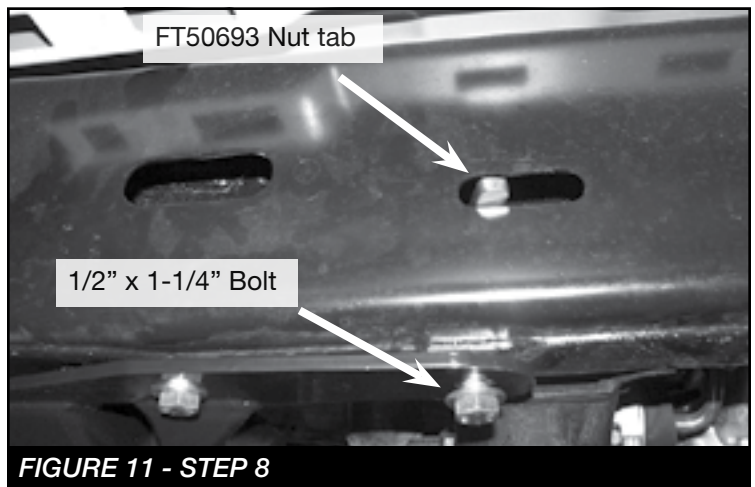


**FIGURE 9 - STEP 7**

8. **DRIVER SIDE** - Using the new crossmember rear hole as a pilot, drill a 1/2" hole into the bottom of the frame. Then insert FT50693 (Nut tab) through the factory slot and secure using the supplied 1/2" x 1-1/4" bolt and washer. Leave loose. **SEE FIGURES 10-11**

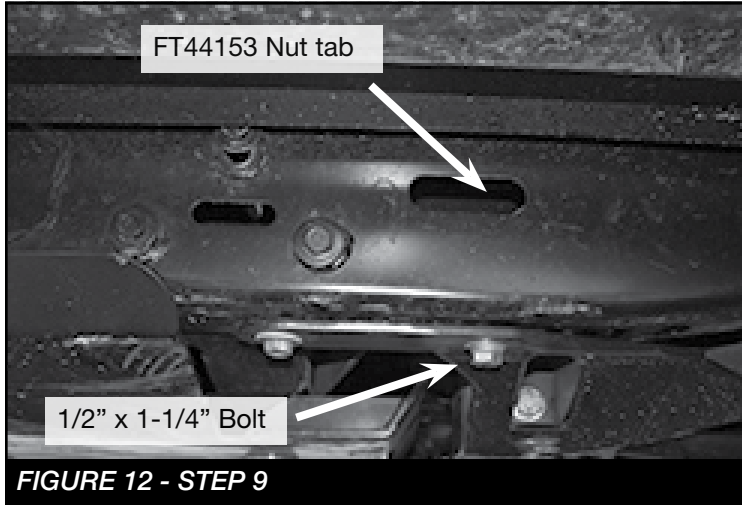


**FIGURE 10 - STEP 8**



**FIGURE 11 - STEP 8**

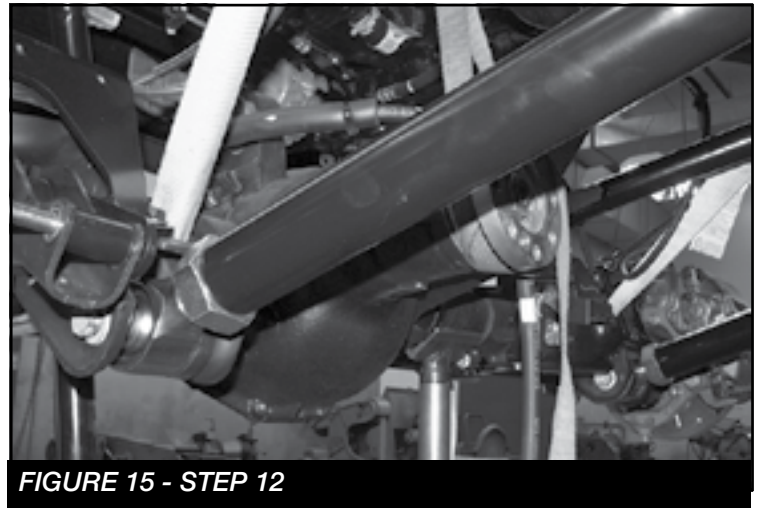
9. **PASSENGER SIDE** - Using the supplied 1/2" x 1-1/4" bolt, washer and FT44153 (Passenger Nut Tab). Install the Nut tab through the factory slot on passenger side of the frame. **SEE FIGURE 12**



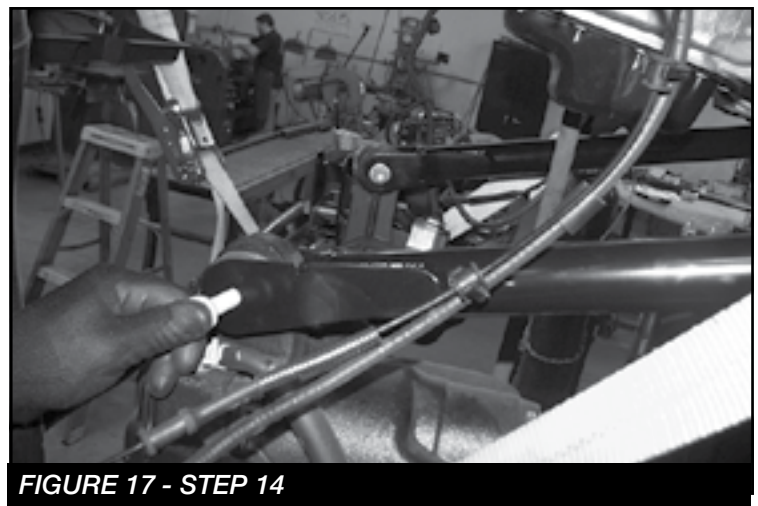
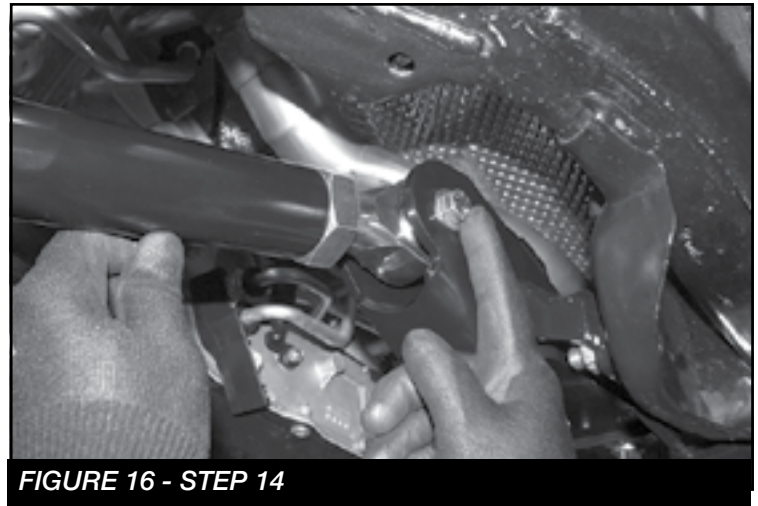
10. Once all hardware is installed, torque the six 1/2" bolts to 106 ft-lbs.
11. Locate the FT50641 (Lower Links) and install (2) FT50415 (9/16" ID, 1" OD Misalignments) into one end and (2) FT50594 (16mm ID, 1" OD Misalignments) into the other end. Next, install (1) FT50509 (Link twist washer) on the end with the FT50415 misalignments. Install the lower link end with the FT50509 (link twist washer into the new crossmember on the driver side using the supplied 9/16 x 4" bolt and hardware. **SEE FIGURE 13-14 NOTE: See diagram on page 7 for misalignment identification.**



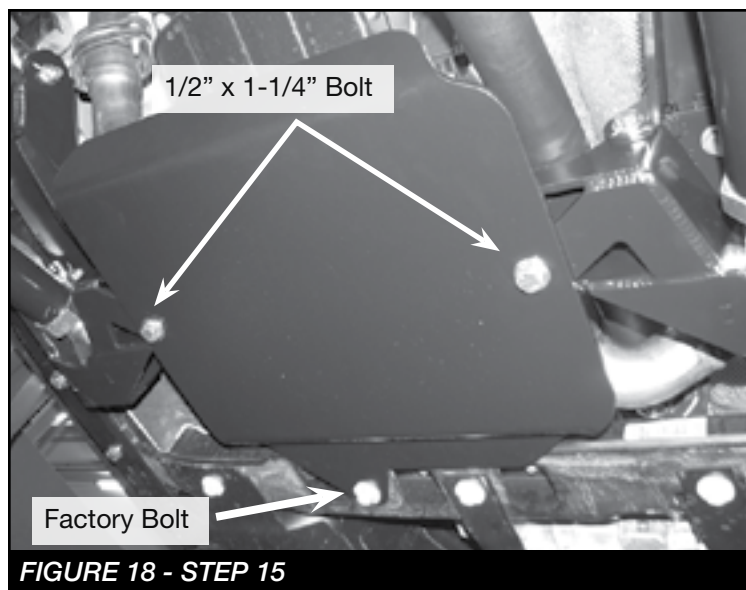
12. Install the other end of the lower link to the axle mount using the factory bolt. **SEE FIGURE 15**



13. Repeat steps 11-12 on the passenger side. Torque 9/16" hardware to 153 ft-lbs and factory hardware to 161 ft-lbs.
14. Locate FT50640 (Front upper link) and install (2) FT50414 (Misalignments) into each rod end. Next, install the upper links to the new crossmember using the supplied 7/16 x 3-1/4" bolt and hardware. Then, install the link to the axle mount using the factory hardware. Torque both the 7/16 and factory bolts to 70 ft-lbs. **SEE FIGURES 16-17**



15. Install FT50626 (Skid Plate), using the supplied (2) 1/2" x 1-1/4" bolts with flat washers, and the factory skid plate bolt. Torque the 1/2" & factory hardware on the crossmember to 106 ft-lbs. **SEE FIGURE 18**



**16. If installing other components continue with the instructions provided with those box kits.**

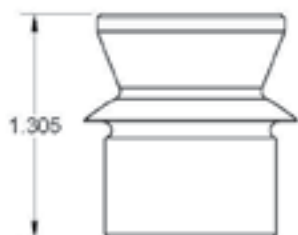
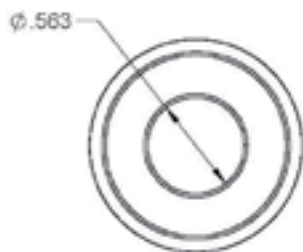
17. Install tires and wheels and torque lug nuts to wheel manufacturer's specifications. Reconnect the negative battery cable. Turn front tires left to right and check for appropriate tire clearance. **Note - Some oversized tires may require trimming of the front bumper & valance.**
18. Check front end alignment and set to factory specifications. Readjust headlights.
19. Recheck all bolts for proper torque.
20. Recheck brake hoses, ABS wires and suspension parts for proper tire clearance while turning tires fully left to right.
21. Check the fluid in the front and rear differential and fill if needed with factory specification differential oil. **Note - some differentials may expel fluid after filling and driving. This can be normal in resetting the fluid level with the new position of the differential/s.**
22. Install Driver Warning Decal. Complete product registration card and mail to Fabtech in order to receive future safety and technical bulletins on this suspension.

**Vehicles that will receive oversized tires should check ball joints, uniballs and all steering components every 2500-5000 miles for wear and replace as required.**

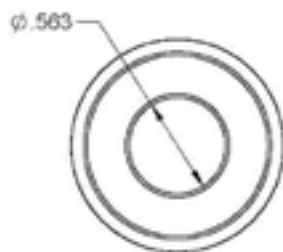
**RE-TORQUE ALL NUTS, BOLTS AND LUGS AFTER 50 MILES AND PERIODICALLY THEREAFTER.**

For technical assistance call: **909-597-7800**

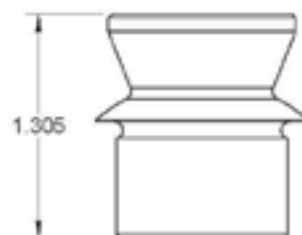
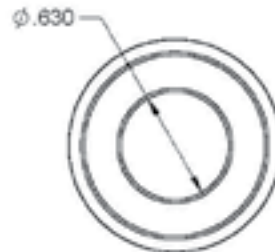
# Misalignment Diagram



FT50415



FT50567



FT50594

## - Product Warranty and Warnings -

Fabtech provides a Limited Lifetime Warranty to the original retail purchaser who owns the vehicle, on which the product was originally installed, for defects in workmanship and materials.

The Limited Lifetime Warranty excludes the following Fabtech items; bushings, bump stops, ball joints, tie rod ends, limiting straps, cross shafts, heim joints and driveshafts. These parts are subject to wear and are not considered defective when worn. They are warranted for 60 days from the date of purchase for defects in workmanship.

Dirt Logic and Performance Coilover take apart shocks are considered a serviceable shock with a one year warranty on leakage only. Service seal kits are available separately for future maintenance. All other shocks are covered under our Limited Lifetime Warranty.

Fabtech does not warrant any product for finish, alterations, modifications and/or installation contrary to Fabtech's instructions. Alterations to the finish of the parts including but not limited to painting, powder coating, plating and/or welding will void all warranties. Some finish damage may occur to parts during shipping, which is considered normal and is not covered under warranty.

Fabtech products are not designed nor intended to be installed on vehicles used in race applications or for racing purposes or for similar activities. (A "RACE" is defined as any contest between two or more vehicles, or any contest of one or more vehicle against the clock, whether or not such contest is for a prize). This warranty does not include coverage for police or taxi vehicles, race vehicles, or vehicles used for government or commercial purposes. Also excluded from this warranty are sales outside of the United States of America.

Installation of most suspension products will raise the center of gravity of the vehicle and will cause the vehicle to handle differently than stock. It may increase the vehicle's susceptibility to a rollover, on road and off road, at all speeds. Extreme care should be taken to operate the vehicle safely at all times to prevent rollover or loss of control resulting in serious injury or death. Fabtech front end Desert Guards may impair the deployment or operation of vehicles equipped with supplemental restraining systems/air bag systems and should not be installed if the vehicle is equipped as so.

Fabtech makes every effort to ensure suspension product compatibility with all vehicles listed on the website, but due to unknown auto manufacturer's production changes and/or inconsistencies by the auto manufacturer, Fabtech cannot be responsible for 100% compatibility, including the fitment of tire and wheel sizes listed. The Tire and Wheel sizes listed in Fabtech's website are only a guideline for street driving with noted fender trimming. Fabtech is not responsible for damages to the vehicle's body or tires. Fabtech is not responsible for premature wear of factory components due to the installation of oversized tires and wheels.

Fabtech's obligation under this warranty is limited to the repair or replacement, at Fabtech option, of the defective product only. All costs of removal, installation or re-installation, freight charges, incidental or consequential damages are expressly excluded from this warranty. Fabtech is not responsible for damages and/or warranty of other vehicle parts related or non related to the installed Fabtech product. This warranty is expressly in lieu of all other warranties expressed or implied. This warranty shall not apply to any product that has been subject to accident, negligence, alteration, abuse or misuse as determined by Fabtech.

Fabtech suspension components must be installed as a complete system including shocks as shown on our website. All warranties will become void if Fabtech parts are combined and/or substituted with other aftermarket suspension products. Combination and/or substitution of other aftermarket suspension parts may cause premature wear and/or product failure resulting in an accident causing injury or death. Fabtech does not warrant products not manufactured by Fabtech.

Depending on the condition of the factory suspension components retained after the installation of a Fabtech suspension not all vehicles may have the same ride stance front to rear as described in the website. The blue color of suspension components shown in all Fabtech photographs are for display purposes only. Majority of all Fabtech components will be black specifically where noted with part numbers ending in BK.

Installation of Fabtech product may void the vehicles factory warranty; it is the consumer's responsibility to check with their local vehicle's dealer for warranty disposition before the installation of the product. Some state laws may prohibit modification of suspension to a vehicle in whole or in part. It is the responsibility of the installer and consumer to consult local laws prior to the installation of any Fabtech suspension product to comply with such written laws.

It is the responsibility of the distributor and/or the retailer to review all warranties and warnings of Fabtech products with the consumer prior to purchase.

Fabtech reserves the right to super cede, discontinue, change the design, finish, part number and/or application of parts when deemed necessary without written notice. Fabtech is not responsible for misprints or typographical errors within the website or price sheet. For the most recent Product Warranty and Warnings visit our website [www.fabtechmotorsports.com](http://www.fabtechmotorsports.com)



## **INSTALLATION INSTRUCTIONS**

### **2020 JEEP GLADIATOR 4WD 3" LONG ARM COILOVER BOX KIT**

**FTS24251**

**NOTE:** TO ORDER WEARABLE REPLACEMENT COMPONENTS DO NOT USE PART NUMBERS SHOWN ON THIS INSTRUCTION SHEET. GO TO FABTECH WEBSITE AND LOOK UP WEARABLE REPLACEMENT PARTS TO FIND THE PROPER PART NUMBER TO ORDER.

**Fabtech Motorsports** | 4331 Eucalyptus Ave. Chino, CA 91710

**Tech Line:** 909-597-7800 | **Fax:** 909-597-7185 | **Web:** [www.fabtechmotorsports.com](http://www.fabtechmotorsports.com)

<b>FTS24251 3" LONG ARM COILOVER BOX KIT</b>		
2	FT1599-2-4	SWAY BAR ENDLINK (REAR) 12.93"
2	FT50026BK	SWAY BAR ENDLINKS (FRONT) 10.34"
1	FT50617	FRONT TRACK BAR BRACKET WELD ON
2	FT50644	FRONT BUMPSTOP SPACER
2	FT50770	REAR BUMPSTOP SPACER
1	FT50806	REAR TRACK BAR BRACKET WELD ON
1	FT50808	HARDWARE SUBASSEMBLY
1	FT50804	HARDWARE KIT

<b>FT50808 HARDWARE SUBASSEMBLY</b>		
8	FT1004	SWAY BAR LINK HALF BUSHINGS
1	FT24251i	INSTRUCTIONS
8	FT404739	SLEEVE 12MM
1	FT50048	5/8 HOURGLASS BUSHING
2	FT50060	FRONT BUMPSTOP NUT TAB
2	FT50592	SLEEVE 1.000 X .563 X 1.400 (TRACK BAR)
1	FTAS12	STICKER FT BLUE 10X4
1	FTAS16	DRIVER WARNING DECAL
1	FTLUBE	URETHANE LUBE PACKET
1	FTREGCARD	REGISTRATION CARD

<b>FT50804 - HARDWARE KIT</b>		<b>LOCATION</b>
6	M12-1.50 X 70MM HEX BOLT	SWAY BAR LINKS
4	12MM USS WASHER	
6	12MM WASHER	
4	M12-1.50 C-LOCK NUT	
2	1/2-13 X 4" HEX BOLT	FRONT BUMPSTOP
2	1/2" SPLIT LOCK WASHER	
2	9/16-12 X 3" HEX HEAD	FRT/REAR TRACK BAR
4	9/16 SAE WASHER	
2	C-LOCK NUT 9/16"-12	
4	5/16-18 X 1" HEX BOLT	REAR BUMPSTOP
8	5/16 SAE WASHER	
4	5/16-18 C-LOCK NUT	
2	5/16-18 X 3/4" SELF TAP BOLT	REAR BRAKE LINE
1	THREAD LOCKING COMPOUND 1 MIL	

**NOTE: REFER TO OPTIONAL KIT BOX INSTRUCTIONS PRIOR TO INSTALLATION.**

## - TOOL LIST -

### **Required Tools (Not Included)**

- Basic Hand Tools
- Floor Jack
- Jack Stands
- Drill w/ Assorted drill bits
- Assorted Metric and S.A.E sockets, and Allen wrenches
- Torque Wrench
- Die Grinder w/ Cutoff Wheel or Sawzall
- Welder

**THE INSTALLATION OF THIS KIT REQUIRES WELDING, AND SHOULD BE PERFORMED BY A CERTIFIED WELDER**

## - PRE-INSTALLATION NOTES -

For technical assistance call: **909-597-7800** or e-mail: **info@fabtechmotorsports.com**

### **READ THIS BEFORE YOU BEGIN INSTALLATION -**

Check all parts to the parts list above before beginning installation. If any parts are missing contact Fabtech at 909-597-7800 and a replacement part will be sent to you immediately.

Read all instructions thoroughly from start to finish before beginning the installation. If these instructions are not properly followed severe frame, driveline and / or suspension damage may occur.

Check your local city and state laws prior to the installation of this system for legality. Do not install if not legal in your area.

Prior to the installation of this suspension system perform a front end alignment and record. Do not install this system if the vehicle alignment is not within factory specifications. Check for frame and suspension damage prior to installation.

The installation of this suspension system should be performed by two professional mechanics.

This suspension must be installed with Fabtech shock absorbers.

Installation of all fasteners requires the use of provided thread locking compound with proper torque values as indicated throughout the installation. Apply thread locking compound upon the final torque of the fastener.

**WARNING-** Installation of this system will alter the center of gravity of the vehicle and may increase roll over as compared to stock.

Vehicles that receive oversized tires should check ball joints, uniballs, tie rods ends, pitman arm and idler arm every 2500-5000 miles for wear and replace as needed.

Verify differential fluid is at manufactures recommended level prior to kit installation. Installation of the kit will reposition the differential and the fill plug hole may be in a different position. (For example, if the manufacture recommends 3 quarts of fluid, make sure the diff has 3 quarts of fluid). Check your specific manual for correct amount of fluid.

### **FOOTNOTES -**

- Installation requires welding.
- Exhaust modification required or order AFE P/N 48-48024 (Loop Delete Pipe)
- Fits 6 CYL. models only
- For heavy offroad use, front driveshaft is required. Order FTS94057
- For heavy offroad use, rear driveshaft is required. See a quality driveline supplier to order

## - INSTRUCTIONS -

### FRONT SUSPENSION

**NOTE: REFER TO OPTIONAL KIT BOX INSTRUCTIONS PRIOR TO INSTALLATION.**

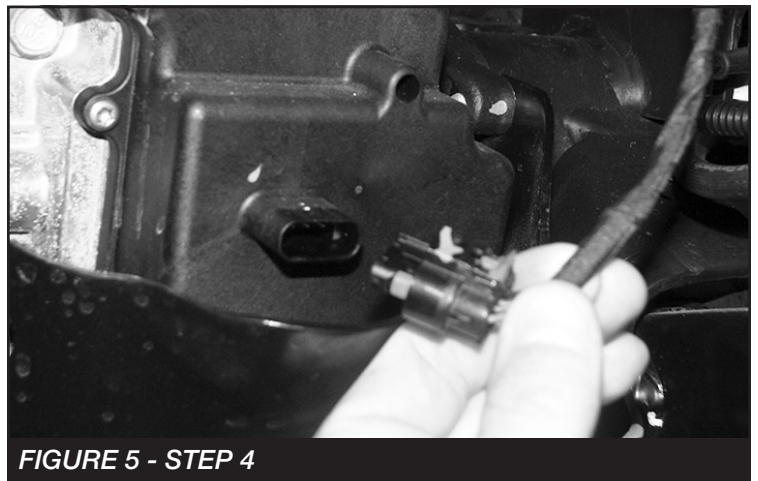
1. Disconnect the negative terminal on the battery. Jack up the front end of the vehicle and support the frame rails with jack stands. **NEVER WORK UNDER AN UNSUPPORTED VEHICLE!** Remove the front tires.
2. On both the Driver and Passenger side, unbolt the front brake line brackets from the frame and the link arm. Save all hardware. **SEE FIGURES 1-2** On the driver side unclip the differential breather hose from the upper coil spring mount. **SEE FIGURE 3**



3. Unbolt and remove both driver and passenger side brake line brackets from the axle spring perch. **SEE FIGURE 4**



4. Unplug the front diff locker harnesses from the axle **(RUBICON MODELS ONLY)** **SEE FIGURES 5-6**



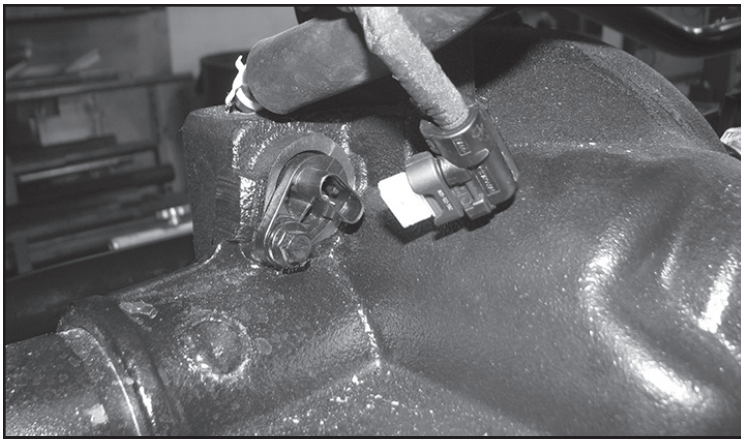


FIGURE 6 - STEP 4

5. Remove and discard the factory sway bar end links, save the hardware.
6. With the axle supported, remove the factory shocks. Save all hardware. Lower the front axle and remove the factory coil springs. Retain coil spring isolators.
- 7. At this time install the FTS24224 (Long arm kit) with the instructions provided in the kit box.**
8. Disconnect the front track bar at the axle. Save hardware.
9. Install FT50617 (Front track bar bracket) to the factory mount using stock bolt. **SEE FIGURE 7.** Mark the front hole to drill using the new bracket as a guide. Remove and drill the hole to 3/8". Sand the factory bracket down to bare metal. **SEE FIGURE 8**

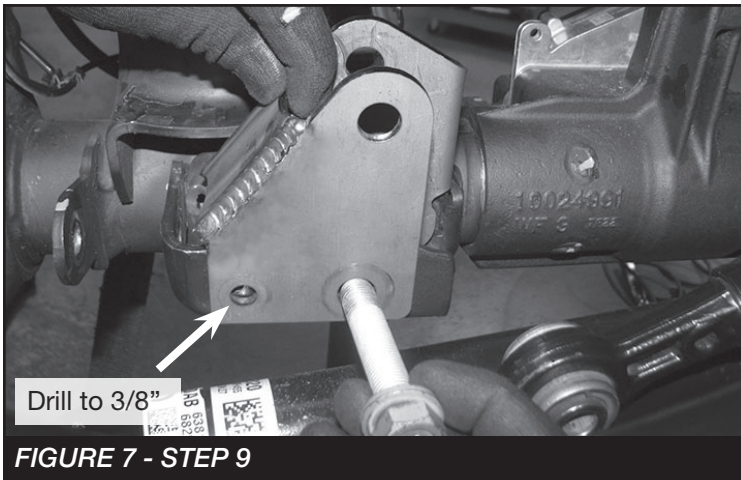


FIGURE 7 - STEP 9

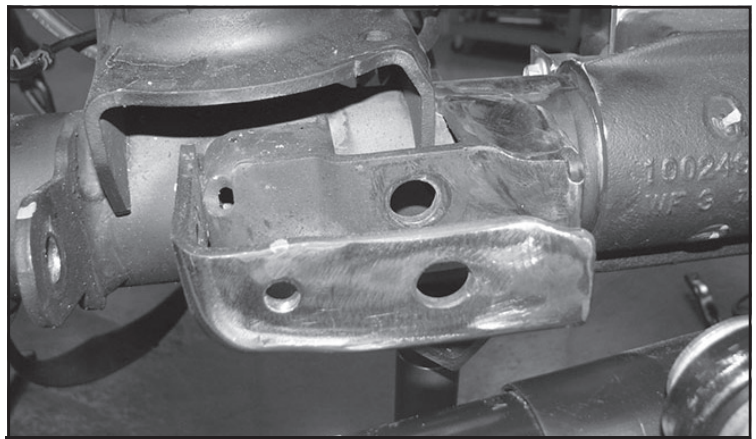


FIGURE 8 - STEP 9

10. Reinstall the bracket using the factory bolt and supplied 3/8" x 1-1/4" bolt, washer and nut. **NOTE: Install the FT50592 (Sleeve) with the factory bolt inside the new track bar bracket.** Torque factory hardware 148 ft-lbs and the 3/8 hardware to 44 ft-lbs. **SEE FIGURE 9**

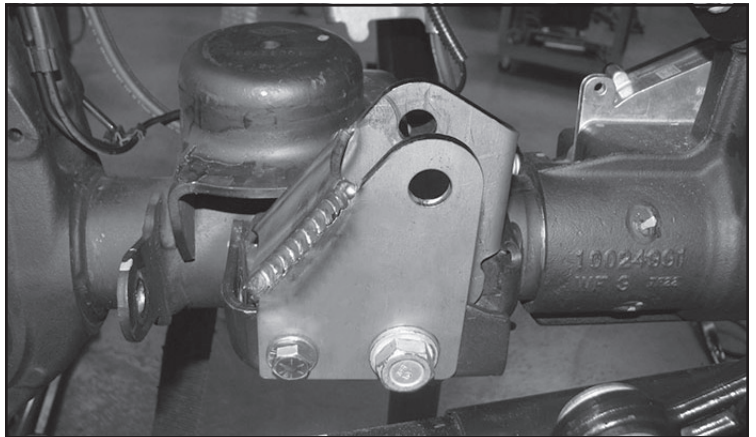
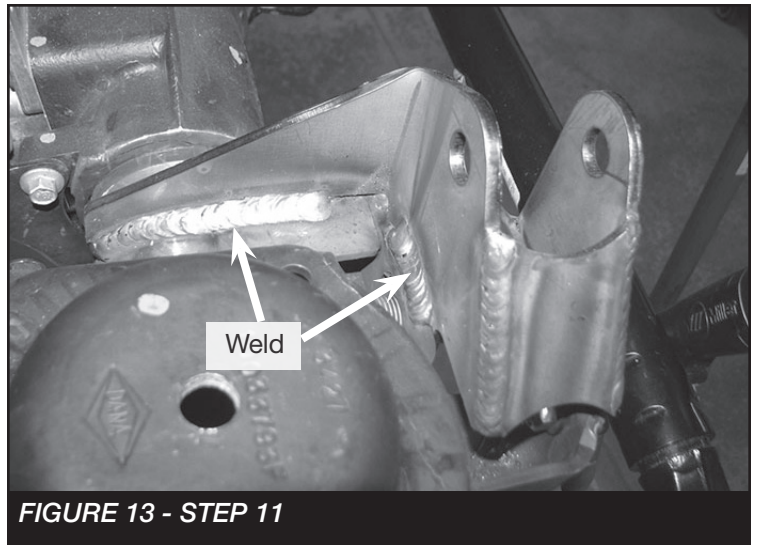
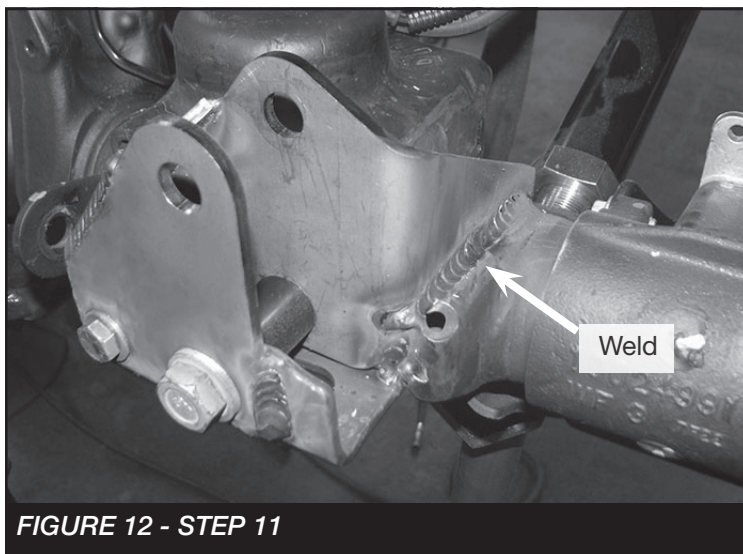
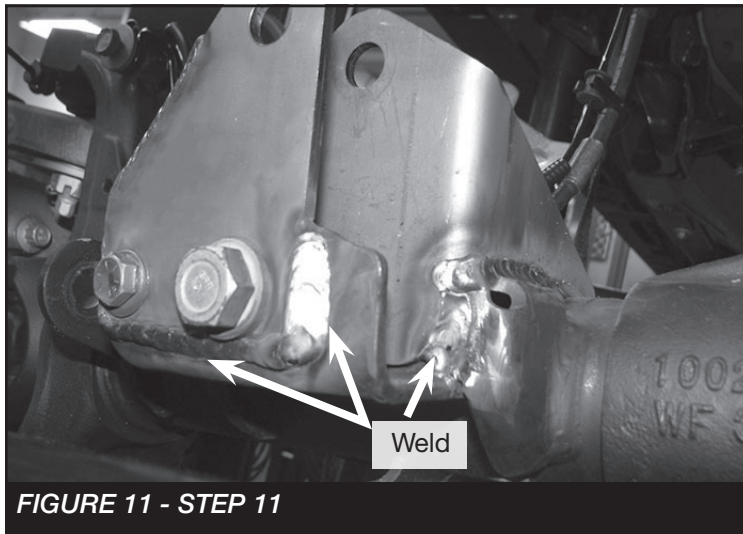
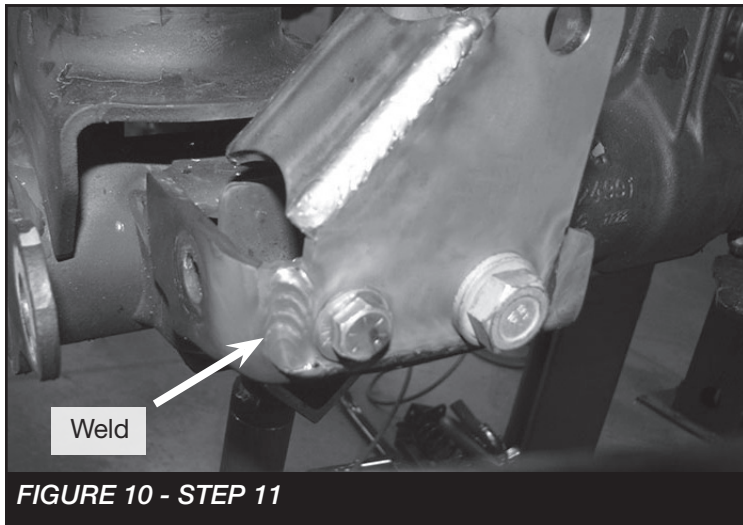


FIGURE 9 - STEP 10

11. Weld the new track bar bracket to the factory bracket like shown in **FIGURES 10-13**

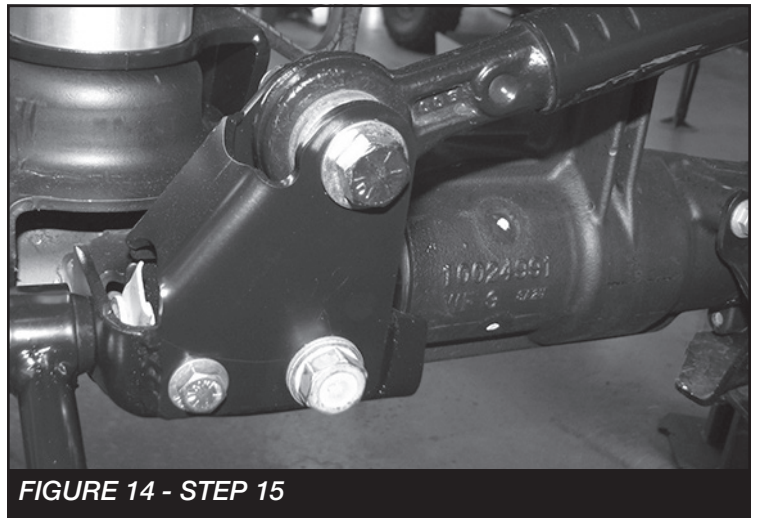


12. Once cooled, paint all bare areas.

13. If installing FTS24210 Drag Link Kit, do so now with the instructions provided in the kit box.

14. Refer to FTS24268 (Coilover Mount Kit) instructions at this time.

15. Re-install the track bar using the supplied 9/16" X 3" bolt, nut and washers. Torque to 153 ft-lbs. **SEE FIGURE 14**



16. Install FT50048 (Bushings) and FT404739 (Sleeves) into FT50026BK (Sway bar links). Then, install the links to the axle mount and sway bar using the supplied M12 x 70mm hardware for the upper location and the factory for the lower. Torque to 65 ft-lbs. **SEE FIGURE 15**

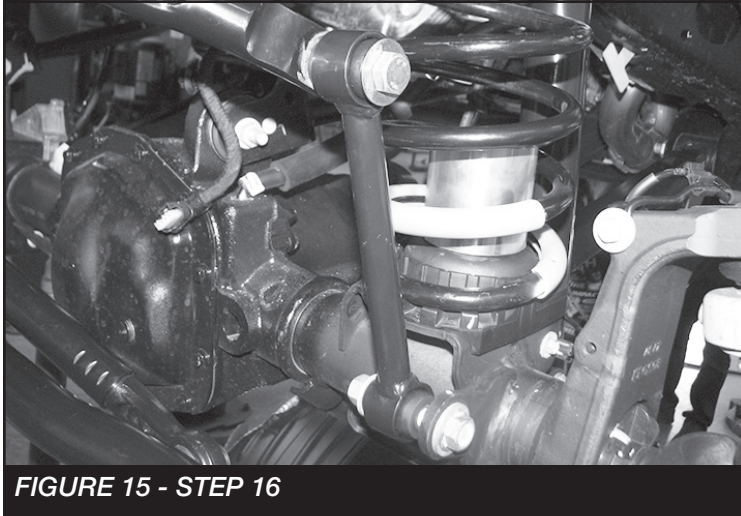


FIGURE 15 - STEP 16

17. Locate the factory brake line bracket on the front hydraulic brake line. This will need to be removed. Do so by cutting a small relief, then bend open. **NOTE: Use caution not to cut the brake line!** **SEE FIGURES 16-17**

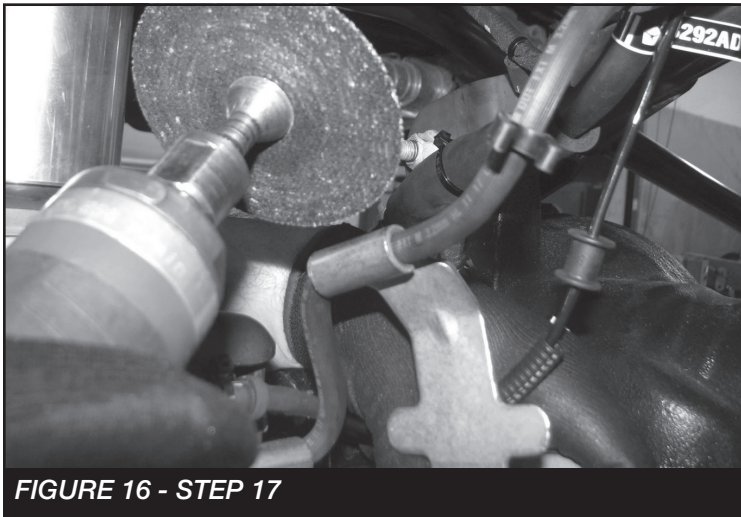


FIGURE 16 - STEP 17

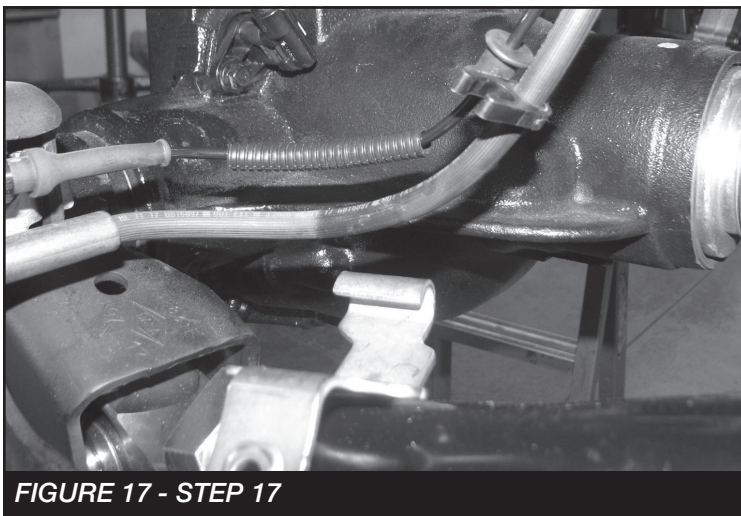


FIGURE 17 - STEP 17

18. Reinstall the diff breather hose by moving the metal clip up the hose 2" **SEE FIGURE 18** and the christmas tree fastener into the next hole down. **SEE FIGURE 19.**

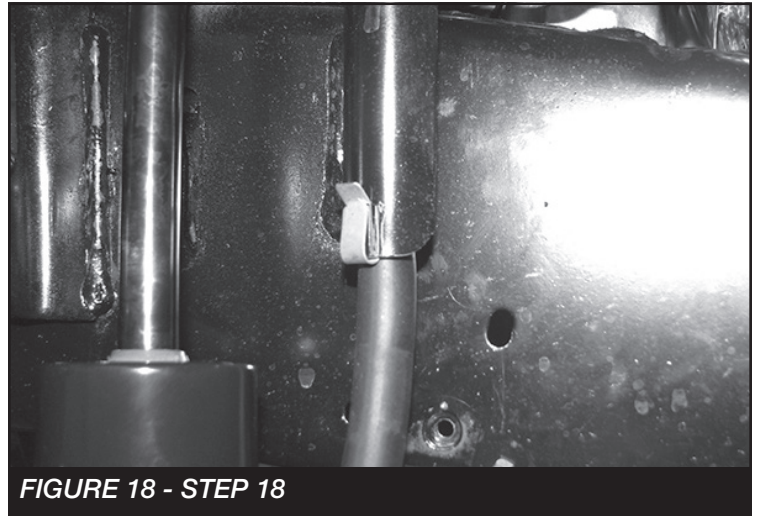


FIGURE 18 - STEP 18

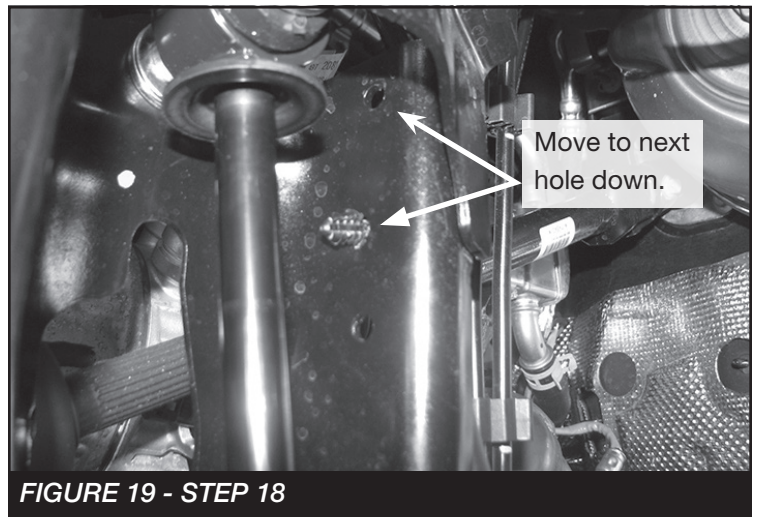


FIGURE 19 - STEP 18

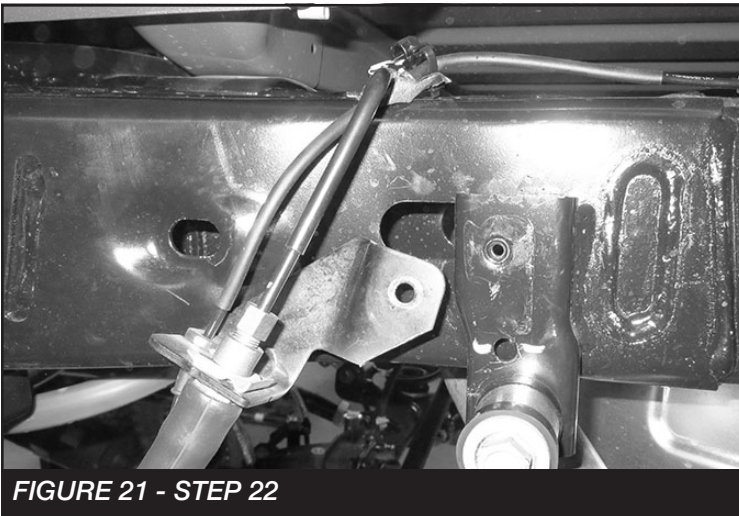
19. **RUBICON MODELS ONLY:** Reinstall the electrical connectors at the diff.

## **- REAR SUSPENSION -**

20. Jack up the rear end of the vehicle and support the frame rails with jack stands. **NEVER WORK UNDER AN UNSUPPORTED VEHICLE!** Remove the rear tires. Support the rear axle; do not allow axle to hang freely.
21. Remove the rear sway bar end links then remove the rear shocks and coil springs. Mark the driver and passenger coil springs for reinstallation. Save hardware. Disconnect the rear track bar from the axle bracket. Save hardware.
22. Disconnect the brake line bracket from the frame. Mark and cut off the locator tab and corner of the bracket like shown in **FIGURES 20-21**

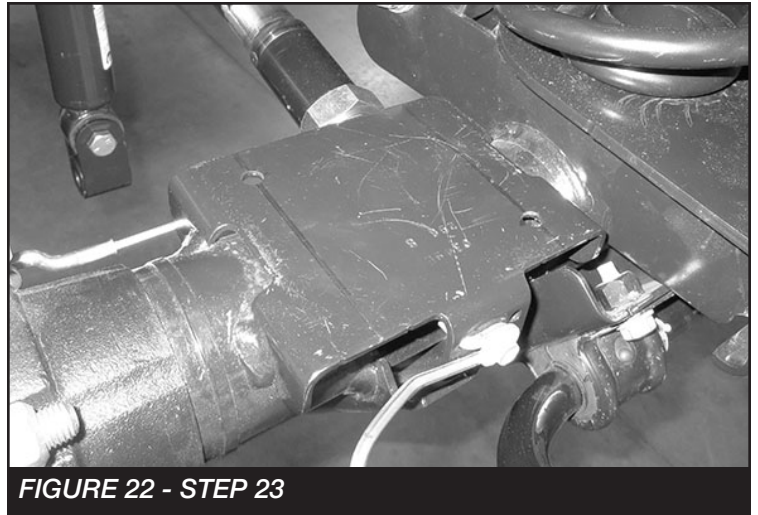


**FIGURE 20 - STEP 22**

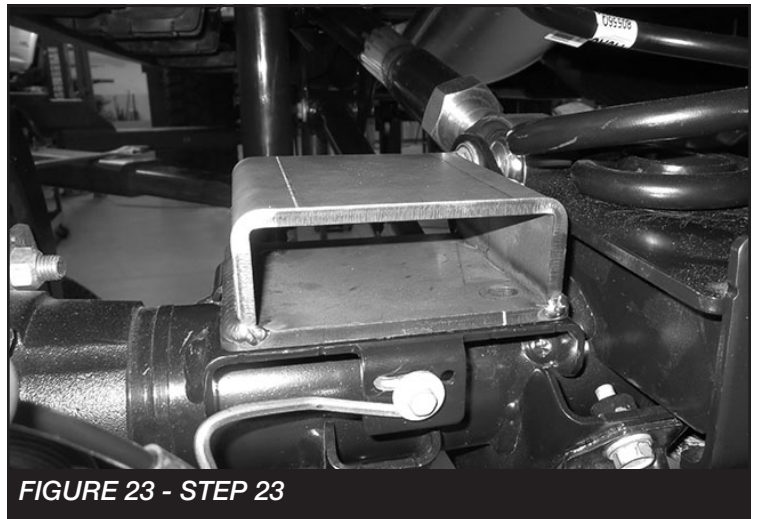


**FIGURE 21 - STEP 22**

23. Install the FT50770 (rear bumpstop brackets) using the supplied 5/16" x 1" hardware and the factory holes on the bumpstop pad. Torque to 17 ft-lbs. **SEE FIGURES 22-23**



**FIGURE 22 - STEP 23**



**FIGURE 23 - STEP 23**

24. Continue with the installation of the rear link arms at this time using the supplied instructions with that kit.

25. Locate the factory rear track bar bracket. Mark a straight line on the front and back before the 90 degree bend. Remove the track bar from the axle bracket and cut the top section off. **SEE FIGURES 24-25**



FIGURE 24 - STEP 25



FIGURE 25 - STEP 25

26. Install the FT50794 (Rear track bar bracket) onto the factory bracket using the supplied 9/16" x 3" bolt, washers, nut and FT50592 (Sleeve). Tack weld in place then completely weld onto the factory mount. **SEE FIGURES 26-27** Allow to cool then paint.

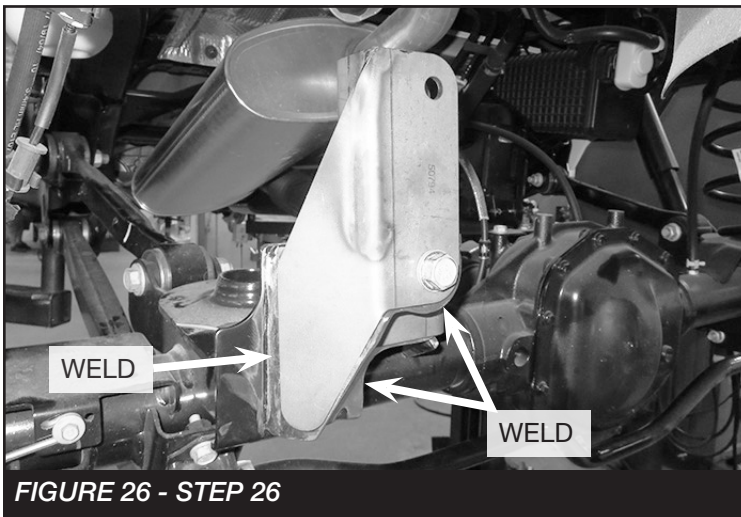


FIGURE 26 - STEP 26

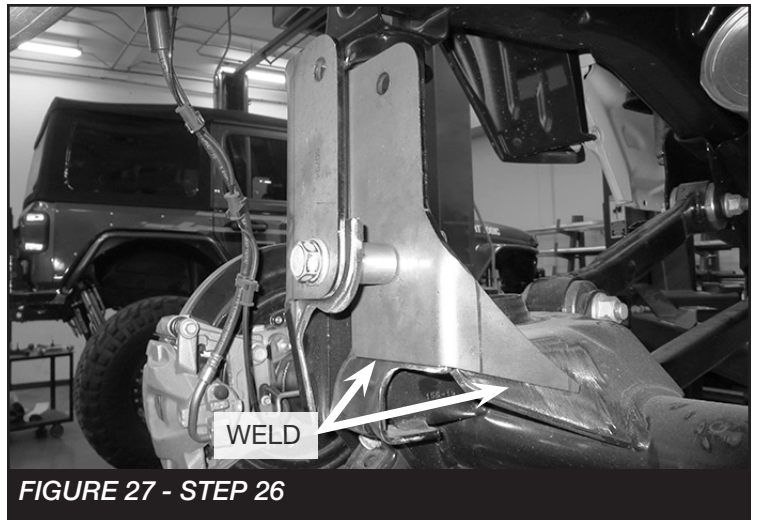


FIGURE 27 - STEP 26

27. **INSTALL THE REAR COILS USING THE INSTRUCTIONS PROVIDED IN THAT BOX KIT.**
28. Install FTS6333 (Stealth shocks) using the factory hardware. **NOTE: If installing Dirt Logic shocks do so with the provided instructions.** Torque to 100 ft-lbs.
29. Install the FT1004 (Half bushings) and FT404739 (Sleeves) into FT1599-2-4 (Rear sway bar links). Then, install the new links to the sway bar and sway bar mount on the frame using supplied M12 x 70mm bolt and large O.D. washer for the upper location and M12 x 70mm bolt regular washer, large O.D. washer and nut for the lower. Use the larger washer on the nut side. **NOTE: The new end link will need to be installed on the inside of the sway bar and axle mount.** Torque to 65 ft-lbs **SEE FIGURE 28**



FIGURE 28 - STEP 29

30. Reinstall the track bar to the new track bar bracket using the factory hardware. Torque to 148 ft-lbs.

31. Using the brake line bracket as a template pull down 1" from where the factory location. Mark and drill using a 9/32" drill bit. **NOTE: Drill through the mount as well as the frame.** Then, install the bracket using the supplied 5/16" self tapping bolt. **SEE FIGURES 29-30**



FIGURE 29 - STEP 31



FIGURE 30 - STEP 31

32. Install tires and wheels and torque lug nuts to wheel manufacturer's specifications. Turn front tires left to right and check for appropriate tire clearance. **Note - Some oversized tires may require trimming of the front bumper & valance.**

33. Check front end alignment and set to factory specifications. Readjust headlights.
34. Recheck all bolts for proper torque.
35. Recheck brake hoses, ABS wires and suspension parts for proper tire clearance while turning tires fully left to right.
36. Check the fluid in the front and rear differential and fill if needed with factory specification differential oil. **Note - some differentials may expel fluid after filling and driving. This can be normal in resetting the fluid level with the new position of the differential/s.**
37. Install Driver Warning Decal. Complete product registration card and mail to Fabtech in order to receive future safety and technical bulletins on this suspension.

**Vehicles that will receive oversized tires should check ball joints, uniballs and all steering components every 2500-5000 miles for wear and replace as required.**

**RE-TORQUE ALL NUTS, BOLTS AND LUGS AFTER 50 MILES AND PERIODICALLY THEREAFTER.**

For technical assistance call: **909-597-7800**

## - Product Warranty and Warnings -

Fabtech provides a Limited Lifetime Warranty to the original retail purchaser who owns the vehicle, on which the product was originally installed, for defects in workmanship and materials.

The Limited Lifetime Warranty excludes the following Fabtech items; bushings, bump stops, ball joints, tie rod ends, limiting straps, cross shafts, heim joints and driveshafts. These parts are subject to wear and are not considered defective when worn. They are warranted for 60 days from the date of purchase for defects in workmanship.

Dirt Logic and Performance Coilover take apart shocks are considered a serviceable shock with a one year warranty on leakage only. Service seal kits are available separately for future maintenance. All other shocks are covered under our Limited Lifetime Warranty.

Fabtech does not warrant any product for finish, alterations, modifications and/or installation contrary to Fabtech's instructions. Alterations to the finish of the parts including but not limited to painting, powder coating, plating and/or welding will void all warranties. Some finish damage may occur to parts during shipping, which is considered normal and is not covered under warranty.

Fabtech products are not designed nor intended to be installed on vehicles used in race applications or for racing purposes or for similar activities. (A "RACE" is defined as any contest between two or more vehicles, or any contest of one or more vehicle against the clock, whether or not such contest is for a prize). This warranty does not include coverage for police or taxi vehicles, race vehicles, or vehicles used for government or commercial purposes. Also excluded from this warranty are sales outside of the United States of America.

Installation of most suspension products will raise the center of gravity of the vehicle and will cause the vehicle to handle differently than stock. It may increase the vehicle's susceptibility to a rollover, on road and off road, at all speeds. Extreme care should be taken to operate the vehicle safely at all times to prevent rollover or loss of control resulting in serious injury or death. Fabtech front end Desert Guards may impair the deployment or operation of vehicles equipped with supplemental restraining systems/air bag systems and should not be installed if the vehicle is equipped as so.

Fabtech makes every effort to ensure suspension product compatibility with all vehicles listed on the website, but due to unknown auto manufacturer's production changes and/or inconsistencies by the auto manufacturer, Fabtech cannot be responsible for 100% compatibility, including the fitment of tire and wheel sizes listed. The Tire and Wheel sizes listed in Fabtech's website are only a guideline for street driving with noted fender trimming. Fabtech is not responsible for damages to the vehicle's body or tires. Fabtech is not responsible for premature wear of factory components due to the installation of oversized tires and wheels.

Fabtech's obligation under this warranty is limited to the repair or replacement, at Fabtech option, of the defective product only. All costs of removal, installation or re-installation, freight charges, incidental or consequential damages are expressly excluded from this warranty. Fabtech is not responsible for damages and/or warranty of other vehicle parts related or non related to the installed Fabtech product. This warranty is expressly in lieu of all other warranties expressed or implied. This warranty shall not apply to any product that has been subject to accident, negligence, alteration, abuse or misuse as determined by Fabtech.

Fabtech suspension components must be installed as a complete system including shocks as shown on our website. All warranties will become void if Fabtech parts are combined and/or substituted with other aftermarket suspension products. Combination and/or substitution of other aftermarket suspension parts may cause premature wear and/or product failure resulting in an accident causing injury or death. Fabtech does not warrant products not manufactured by Fabtech.

Depending on the condition of the factory suspension components retained after the installation of a Fabtech suspension not all vehicles may have the same ride stance front to rear as described in the website. The blue color of suspension components shown in all Fabtech photographs are for display purposes only. Majority of all Fabtech components will be black specifically where noted with part numbers ending in BK.

Installation of Fabtech product may void the vehicles factory warranty; it is the consumer's responsibility to check with their local vehicle's dealer for warranty disposition before the installation of the product. Some state laws may prohibit modification of suspension to a vehicle in whole or in part. It is the responsibility of the installer and consumer to consult local laws prior to the installation of any Fabtech suspension product to comply with such written laws.

It is the responsibility of the distributor and/or the retailer to review all warranties and warnings of Fabtech products with the consumer prior to purchase.

Fabtech reserves the right to super cede, discontinue, change the design, finish, part number and/or application of parts when deemed necessary without written notice. Fabtech is not responsible for misprints or typographical errors within the website or price sheet. For the most recent Product Warranty and Warnings visit our website [www.fabtechmotorsports.com](http://www.fabtechmotorsports.com)



## INSTALLATION INSTRUCTIONS

<b>FTS24252</b>		<b>REAR LONG ARM LINK KIT</b>
2	FT50771	REAR LINK (LOWER)
2	FT50772	REAR LINK (UPPER)
1	FT50800	HARDWARE SUBASSEMBLY

<b>FT50800</b>		<b>HARDWARE SUBASSEMBLY</b>
8	FT1007	HALF BUSHING
1	FT24252i	INSTRUCTIONS
8	FT50594	MISALIGNMENT 1" BEARING
4	FT615	SLEEVE 1.000 X .630 X .2.645
4	FT84	GREASE FITTING 1/4-28
1	FTAS12	STICKER FT BLUE 10X4 DIE CUT
1	FTAS16	DRIVER WARNING DECAL
1	FTLUBE	URETHANE LUBE
1	FTREGCARD	REGISTRATION CARD

## 2020-2023 JEEP GLADIATOR 4WD REAR LONG ARM KIT FTS24252

**NOTE:** TO ORDER WEARABLE REPLACEMENT COMPONENTS DO NOT USE PART NUMBERS SHOWN ON THIS INSTRUCTION SHEET. GO TO FABTECH WEBSITE AND LOOK UP WEARABLE REPLACEMENT PARTS TO FIND THE PROPER PART NUMBER TO ORDER.

Fabtech Motorsports | 2213 Industrial Park Rd. Lancaster, SC 29720

Tech Line: 909-597-7800 | Web: [www.fabtechmotorsports.com](http://www.fabtechmotorsports.com)

## - TOOL LIST -

### Required Tools (Not Included)

Basic Hand Tools  
Floor Jack  
Jack Stands  
Assorted Metric and S.A.E sockets, and Allen wrenches  
Torque Wrench

### FOOTNOTES -

- Fits 6 cyl. gas models only  
- For heavy offroad use, front driveshaft is required.  
Order FTS94057  
- For heavy offroad use, rear driveshaft is required. See a  
quality driveline supplier to order

## - PRE-INSTALLATION NOTES -

### ***NOTE: REFER TO OPTIONAL KIT BOX INSTRUCTIONS PRIOR TO INSTALLATION.***

For technical assistance call: **909-597-7800** or e-mail: **info@fabtechmotorsports.com**

### **READ THIS BEFORE YOU BEGIN INSTALLATION -**

Check all parts to the parts list above before beginning installation. If any parts are missing contact Fabtech at 909-597-7800 and a replacement part will be sent to you immediately.

Read all instructions thoroughly from start to finish before beginning the installation. If these instructions are not properly followed severe frame, driveline and / or suspension damage may occur.

Check your local city and state laws prior to the installation of this system for legality. Do not install if not legal in your area.

Prior to the installation of this suspension system perform a front end alignment and record. Do not install this system if the vehicle alignment is not within factory specifications. Check for frame and suspension damage prior to installation.

The installation of this suspension system should be performed by two professional mechanics.

This suspension must be installed with Fabtech shock absorbers.

Installation of all fasteners requires the use of provided thread locking compound with proper torque values as indicated throughout the installation. Apply thread locking compound upon the final torque of the fastener.

**WARNING-** Installation of this system will alter the center of gravity of the vehicle and may increase roll over as compared to stock.

Vehicles that receive oversized tires should check ball joints, uniballs, tie rods ends, pitman arm and idler arm every 2500-5000 miles for wear and replace as needed.

Verify differential fluid is at manufactures recommended level prior to kit installation. Installation of the kit will reposition the differential and the fill plug hole may be in a different position. (For example, if the manufacture recommends 3 quarts of fluid, make sure the diff has 3 quarts of fluid). Check your specific manual for correct amount of fluid.

Periodically grease the bushings using a urethane compatible grease.

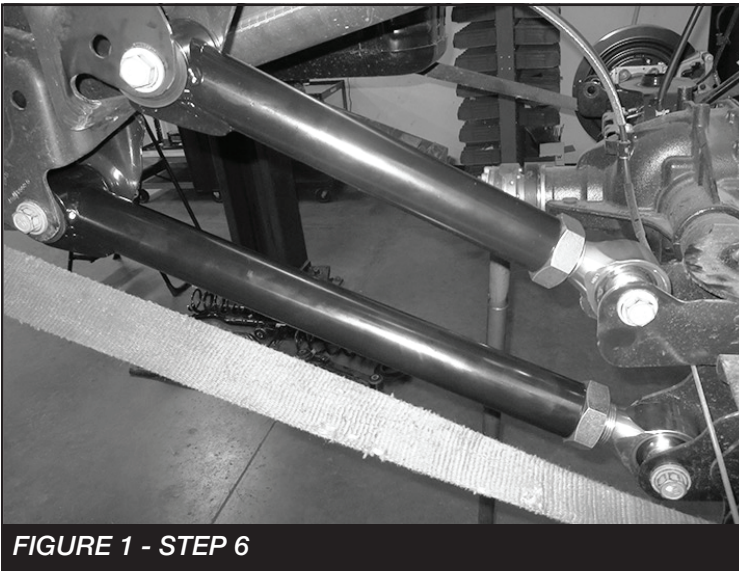
#### **NOTICE SPRING BOW MAY OCCUR**

Some Jeeps may have a pronounced bow in the stock front coil springs and /or after the installation of Fabtech coil springs. This is an inherent trait of the Jeep JL & JT front suspension. Many Jeeps come from the factory with bowed front springs while other Jeeps do not have a bow. There is a variance in the angles of the upper coil spring bucket and the lower coil spring axle mount. Depending on these variances it may cause springs to bow. Fabtech offers a coil correction kit as an option to help straighten the front coil springs should there be interference with other suspension parts as it cycles. Order FTS24280 Coil Correction Kit.

## - INSTRUCTIONS -

### REAR SUSPENSION-

1. Jack up the rear end of the vehicle and support the frame rails with jack stands. **NEVER WORK UNDER AN UNSUPPORTED VEHICLE!** Remove the rear tires.
2. Using the supplied grease, grease and install two FT1007 (Bushings), a FT615 (Sleeve) and a zerk fitting into the end of each link arm.
3. With the axle supported, remove the driver side lower link and save hardware.
4. Install FT50771 (Lower Link) into the factory mounts using two FT50594 (Misalignments) and the factory hardware. Torque to 160 ft-lbs. **NOTE: The rod end will be installed at the axle side and the grease fitting should be facing upwards on the frame side.**
5. Remove the driver side upper link and save hardware.
6. Install FT50772 (Upper Link) into the factory mounts using two FT50594 (Misalignments) and the factory hardware. Torque to 160 ft-lbs. **NOTE: The rod end will be installed at the axle side and the grease fitting should be facing upwards on the frame side. SEE FIGURE 1**



7. Repeat steps on the passenger side.

8. Install tires and wheels and torque lug nuts to wheel manufacturer's specifications.
9. Recheck all bolts for proper torque.
10. Install Driver Warning Decal. Complete product registration card and mail to Fabtech in order to receive future safety and technical bulletins on this suspension.

**Vehicles that will receive oversized tires should check ball joints, uniballs and all steering components every 2500-5000 miles for wear and replace as required.**

**RETORQUE ALL NUTS, BOLTS AND LUGS AFTER 50 MILES AND PERIODICALLY THEREAFTER.**

For technical assistance call: **909-597-7800**

## - Product Warranty and Warnings -

Fabtech provides a Limited Lifetime Warranty to the original retail purchaser who owns the vehicle, on which the product was originally installed, for defects in workmanship and materials.

The Limited Lifetime Warranty excludes the following Fabtech items; bushings, bump stops, ball joints, tie rod ends, limiting straps, cross shafts, heim joints and driveshafts. These parts are subject to wear and are not considered defective when worn. They are warranted for 60 days from the date of purchase for defects in workmanship.

Dirt Logic and Performance Coilover take apart shocks are considered a serviceable shock with a one year warranty on leakage only. Service seal kits are available separately for future maintenance. All other shocks are covered under our Limited Lifetime Warranty.

Fabtech does not warrant any product for finish, alterations, modifications and/or installation contrary to Fabtech's instructions. Alterations to the finish of the parts including but not limited to painting, powder coating, plating and/or welding will void all warranties. Some finish damage may occur to parts during shipping, which is considered normal and is not covered under warranty.

Fabtech products are not designed nor intended to be installed on vehicles used in race applications or for racing purposes or for similar activities. (A "RACE" is defined as any contest between two or more vehicles, or any contest of one or more vehicle against the clock, whether or not such contest is for a prize). This warranty does not include coverage for police or taxi vehicles, race vehicles, or vehicles used for government or commercial purposes. Also excluded from this warranty are sales outside of the United States of America.

Installation of most suspension products will raise the center of gravity of the vehicle and will cause the vehicle to handle differently than stock. It may increase the vehicle's susceptibility to a rollover, on road and off road, at all speeds. Extreme care should be taken to operate the vehicle safely at all times to prevent rollover or loss of control resulting in serious injury or death. Fabtech front end Desert Guards may impair the deployment or operation of vehicles equipped with supplemental restraining systems/air bag systems and should not be installed if the vehicle is equipped as so.

Fabtech makes every effort to ensure suspension product compatibility with all vehicles listed on the website, but due to unknown auto manufacturer's production changes and/or inconsistencies by the auto manufacturer, Fabtech cannot be responsible for 100% compatibility, including the fitment of tire and wheel sizes listed. The Tire and Wheel sizes listed in Fabtech's website are only a guideline for street driving with noted fender trimming. Fabtech is not responsible for damages to the vehicle's body or tires. Fabtech is not responsible for premature wear of factory components due to the installation of oversized tires and wheels.

Fabtech's obligation under this warranty is limited to the repair or replacement, at Fabtech option, of the defective product only. All costs of removal, installation or re-installation, freight charges, incidental or consequential damages are expressly excluded from this warranty. Fabtech is not responsible for damages and/or warranty of other vehicle parts related or non related to the installed Fabtech product. This warranty is expressly in lieu of all other warranties expressed or implied. This warranty shall not apply to any product that has been subject to accident, negligence, alteration, abuse or misuse as determined by Fabtech.

Fabtech suspension components must be installed as a complete system including shocks as shown on our website. All warranties will become void if Fabtech parts are combined and/or substituted with other aftermarket suspension products. Combination and/or substitution of other aftermarket suspension parts may cause premature wear and/or product failure resulting in an accident causing injury or death. Fabtech does not warrant products not manufactured by Fabtech.

Depending on the condition of the factory suspension components retained after the installation of a Fabtech suspension not all vehicles may have the same ride stance front to rear as described in the website. The blue color of suspension components shown in all Fabtech photographs are for display purposes only. Majority of all Fabtech components will be black specifically where noted with part numbers ending in BK.

Installation of Fabtech product may void the vehicles factory warranty; it is the consumer's responsibility to check with their local vehicle's dealer for warranty disposition before the installation of the product. Some state laws may prohibit modification of suspension to a vehicle in whole or in part. It is the responsibility of the installer and consumer to consult local laws prior to the installation of any Fabtech suspension product to comply with such written laws.

It is the responsibility of the distributor and/or the retailer to review all warranties and warnings of Fabtech products with the consumer prior to purchase.

Fabtech reserves the right to super cede, discontinue, change the design, finish, part number and/or application of parts when deemed necessary without written notice. Fabtech is not responsible for misprints or typographical errors within the website or price sheet. For the most recent Product Warranty and Warnings visit our website [www.fabtechmotorsports.com](http://www.fabtechmotorsports.com)



## INSTALLATION INSTRUCTIONS

<b>FTS24260</b>		<b>3" COIL KIT 4-DOOR GLADIATOR</b>
1	FT50752	3" DUAL RATE COIL (DRIVER REAR)
1	FT50753	3" DUAL RATE COIL (PASS REAR)
1	FT50830	HARDWARE SUBASSEMBLY

<b>FT50830</b>		<b>HARDWARE SUBASSEMBLY</b>
1	FT24260i	INSTRUCTIONS
1	FTAS12	STICKER FT BLUE 10X4
1	FTAS16	DRIVER WARNING DECAL
1	FTREGCARD	REGISTRATION CARD

# 2020-2023 JEEP GLADIATOR (JT)

## 3" REAR COIL KITS

**FT24260i**

**Fabtech Motorsports** | 4331 Eucalyptus Ave. Chino, CA 91710

**Tech Line:** 909-597-7800 | **Fax:** 909-597-7185 | **Web:** [www.fabtechmotorsports.com](http://www.fabtechmotorsports.com)

## - TOOL LIST -

### *Required Tools (Not Included)*

Basic Hand Tools  
Floor Jack  
Jack Stands  
Assorted Metric and S.A.E sockets, and Allen wrenches  
Torque Wrench

## - PRE-INSTALLATION NOTES -

For technical assistance call: **909-597-7800** or e-mail: **info@fabtechmotorsports.com**

### *READ THIS BEFORE YOU BEGIN INSTALLATION -*

Check all parts to the parts list above before beginning installation. If any parts are missing contact Fabtech at 909-597-7800 and a replacement part will be sent to you immediately.

Read all instructions thoroughly from start to finish before beginning the installation. If these instructions are not properly followed severe frame, driveline and / or suspension damage may occur.

Check your local city and state laws prior to the installation of this system for legality. Do not install if not legal in your area.

Prior to the installation of this suspension system perform a front end alignment and record. Do not install this system if the vehicle alignment is not within factory specifications. Check for frame and suspension damage prior to installation.

The installation of this suspension system should be performed by two professional mechanics.

This suspension must be installed with Fabtech shock absorbers.

Use the provided thread locking compound on all hardware.

**WARNING-** Installation of this system will alter the center of gravity of the vehicle and may increase roll over as compared to stock.

Vehicles that receive oversized tires should check ball joints, uniballs, tie rods ends, pitman arm and idler arm every 2500-5000 miles for wear and replace as needed.

Verify differential fluid is at manufactures recommended level prior to kit installation. Installation of the kit will reposition the differential and the fill plug hole may be in a different position. (For example, if the manufacture recommends 3 quarts of fluid, make sure the diff has 3 quarts of fluid). Check your specific manual for correct amount of fluid.

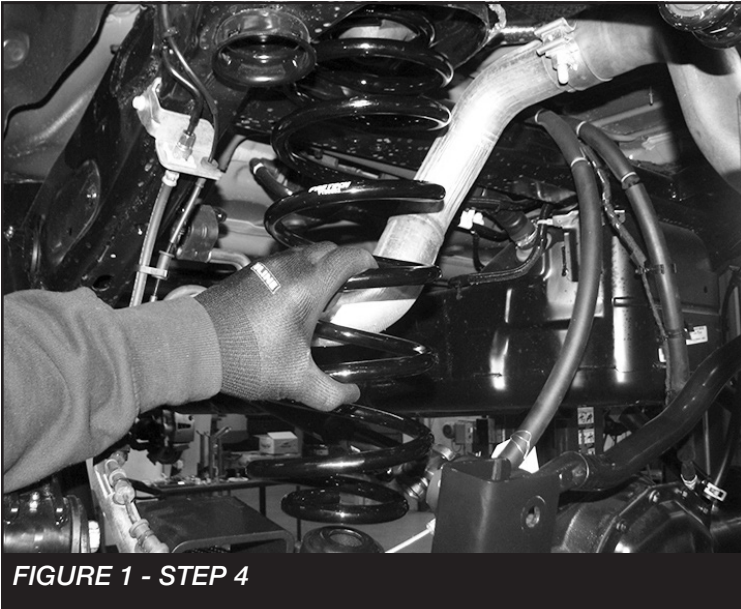
### *FOOTNOTES -*

***NOTE: REFER TO OPTIONAL KIT BOX INSTRUCTIONS PRIOR TO INSTALLATION.***

# - INSTRUCTIONS -

## REAR SUSPENSION

1. Supporting the rear axle. Disconnect the brake lines from the frame and save hardware, Next, Disconnect the sway bar end links from the rear axle.
2. Remove the factory shocks and save hardware.
3. Carefully lower the axle and remove the factory springs. Save the rubber spring isolators.
4. Install the new Fabtech rear coil springs FT50752 (Driver Rear) & FT50753 (Pass Rear) using the factory rubber isolators. **SEE FIGURE 1**



5. Refer to the main box kit instructions for shock installation.
6. Install tires and wheels and torque lug nuts to wheel manufacturer's specifications. Turn front tires left to right and check for appropriate tire clearance. **Note - Some oversized tires may require trimming of the front bumper & valance.**
7. Check front end alignment and set to factory specifications. Readjust headlights.
8. Recheck all bolts for proper torque.
9. Recheck brake hoses, ABS wires and suspension parts for proper tire clearance while turning tires fully left to right.

10. Check the fluid in the front and rear differential and fill if needed with factory specification differential oil. **Note - some differentials may expel fluid after filling and driving. This can be normal in resetting the fluid level with the new position of the differential/s.**
11. Install Driver Warning Decal. Complete product registration card and mail to Fabtech in order to receive future safety and technical bulletins on this suspension.

**Vehicles that will receive oversized tires should check ball joints, uniballs and all steering components every 2500-5000 miles for wear and replace as required.**

**RE-TORQUE ALL NUTS, BOLTS AND LUGS AFTER 50 MILES AND PERIODICALLY THEREAFTER.**

For technical assistance call: **909-597-7800**

## - Product Warranty and Warnings -

Fabtech provides a Limited Lifetime Warranty to the original retail purchaser who owns the vehicle, on which the product was originally installed, for defects in workmanship and materials.

The Limited Lifetime Warranty excludes the following Fabtech items; bushings, bump stops, ball joints, tie rod ends, limiting straps, cross shafts, heim joints and driveshafts. These parts are subject to wear and are not considered defective when worn. They are warranted for 60 days from the date of purchase for defects in workmanship.

Dirt Logic and Performance Coilover take apart shocks are considered a serviceable shock with a one year warranty on leakage only. Service seal kits are available separately for future maintenance. All other shocks are covered under our Limited Lifetime Warranty.

Fabtech does not warrant any product for finish, alterations, modifications and/or installation contrary to Fabtech's instructions. Alterations to the finish of the parts including but not limited to painting, powder coating, plating and/or welding will void all warranties. Some finish damage may occur to parts during shipping, which is considered normal and is not covered under warranty.

Fabtech products are not designed nor intended to be installed on vehicles used in race applications or for racing purposes or for similar activities. (A "RACE" is defined as any contest between two or more vehicles, or any contest of one or more vehicle against the clock, whether or not such contest is for a prize). This warranty does not include coverage for police or taxi vehicles, race vehicles, or vehicles used for government or commercial purposes. Also excluded from this warranty are sales outside of the United States of America.

Installation of most suspension products will raise the center of gravity of the vehicle and will cause the vehicle to handle differently than stock. It may increase the vehicle's susceptibility to a rollover, on road and off road, at all speeds. Extreme care should be taken to operate the vehicle safely at all times to prevent rollover or loss of control resulting in serious injury or death. Fabtech front end Desert Guards may impair the deployment or operation of vehicles equipped with supplemental restraining systems/air bag systems and should not be installed if the vehicle is equipped as so.

Fabtech makes every effort to ensure suspension product compatibility with all vehicles listed on the website, but due to unknown auto manufacturer's production changes and/or inconsistencies by the auto manufacturer, Fabtech cannot be responsible for 100% compatibility, including the fitment of tire and wheel sizes listed. The Tire and Wheel sizes listed in Fabtech's website are only a guideline for street driving with noted fender trimming. Fabtech is not responsible for damages to the vehicle's body or tires. Fabtech is not responsible for premature wear of factory components due to the installation of oversized tires and wheels.

Fabtech's obligation under this warranty is limited to the repair or replacement, at Fabtech option, of the defective product only. All costs of removal, installation or re-installation, freight charges, incidental or consequential damages are expressly excluded from this warranty. Fabtech is not responsible for damages and/or warranty of other vehicle parts related or non related to the installed Fabtech product. This warranty is expressly in lieu of all other warranties expressed or implied. This warranty shall not apply to any product that has been subject to accident, negligence, alteration, abuse or misuse as determined by Fabtech.

Fabtech suspension components must be installed as a complete system including shocks as shown on our website. All warranties will become void if Fabtech parts are combined and/or substituted with other aftermarket suspension products. Combination and/or substitution of other aftermarket suspension parts may cause premature wear and/or product failure resulting in an accident causing injury or death. Fabtech does not warrant products not manufactured by Fabtech.

Depending on the condition of the factory suspension components retained after the installation of a Fabtech suspension not all vehicles may have the same ride stance front to rear as described in the website. The blue color of suspension components shown in all Fabtech photographs are for display purposes only. Majority of all Fabtech components will be black specifically where noted with part numbers ending in BK.

Installation of Fabtech product may void the vehicles factory warranty; it is the consumer's responsibility to check with their local vehicle's dealer for warranty disposition before the installation of the product. Some state laws may prohibit modification of suspension to a vehicle in whole or in part. It is the responsibility of the installer and consumer to consult local laws prior to the installation of any Fabtech suspension product to comply with such written laws.

It is the responsibility of the distributor and/or the retailer to review all warranties and warnings of Fabtech products with the consumer prior to purchase.

Fabtech reserves the right to super cede, discontinue, change the design, finish, part number and/or application of parts when deemed necessary without written notice. Fabtech is not responsible for misprints or typographical errors within the website or price sheet. For the most recent Product Warranty and Warnings visit our website [www.fabtechmotorsports.com](http://www.fabtechmotorsports.com)



# INSTALLATION INSTRUCTIONS

FTS24268		COILOVER MOUNT KIT
1	FT50681	UPPER COILOVER MOUNT (DRIVER)
1	FT50682	UPPER COILOVER MOUNT (PASS)
2	FT50698	UPPER MOUNT SPACER
1	FT50832	SUPPORT TUBE (DRIVER)
1	FT50833	SUPPORT TUBE (PASS)
1	FT50714	LOWER COILOVER MOUNT (DRIVER)
1	FT50715	LOWER COILOVER MOUNT (PASS)
1	FT50834	HARDWARE SUBASSEMBLY

FT50834		HARDWARE SUBASSEMBLY
2	FT157	LOWER MOUNT SLEEVE
1	FT24268i	INSTRUCTIONS
2	FT50691	NUT TAB LONG
2	FT50308	NUT TAB
2	FT50692	NUT TAB SHORT
1	FT50741	HARDWARE KIT
1	FTAS12	STICKER FT BLUE 10X4 DIE CUT
1	FTAS16	DRIVER WARNING DECAL
1	FTREGCARD	REGISTRATION CARD

FT50741 - HARDWARE KIT		LOCATION
8	1/2-13 X 1-1/4" HEX BOLT	C/O TO FRAME
10	1/2" SAE WASHER	
6	1/2" SPLIT LOCK WASHER	
6	3/8-16 X 1-1/4" HEX BOLT	C/O TO COIL BUCKET
10	3/8" SAE WASHER	
2	3/8" USS WASHER	
6	3/8-16 C-LOCK NUT	
2	M12 FLAT WASHER	SUPPORT TUBE
2	M12-1.75 NYLOCK NUT	
4	1/4-20 X 1" HEX BOLT G5 ZINC	BRAKE LINE
8	1/4 SAE WASHER	
4	1/4-20 C-LOCK NUT	
4	7/16-14 X 1 1/4 HEX HD	LOWER C/O MOUNT
8	7/16 SAE WASHER G8 ZINC	
4	7/16-14 C-LOCK NUT ZINC	
2	1/2-13 X 3" HEX BOLT	UPPER C/O
2	1/2-13 X 4-3/4" HEX BOLT	LOWER C/O
8	1/2" SAE WASHER	
6	1/2-13 C-LOCK NUT	
4	#10 X 1" TEK SCREW	
4	CLAMP 3/8X1/2W .26THK NEOPRENE	
6	7.5" STANDARD CABLE TIE BLACK	
1	THREAD LOCKING COMPOUND 1 MIL	

## 2020-2023 JEEP GLADIATOR (JT) 4WD

### FRONT COILOVER CONVERSION KIT

**FT24268i**

**NOTE:** TO ORDER WEARABLE REPLACEMENT COMPONENTS DO NOT USE PART NUMBERS SHOWN ON THIS INSTRUCTION SHEET. GO TO FABTECH WEBSITE AND LOOK UP WEARABLE REPLACEMENT PARTS TO FIND THE PROPER PART NUMBER TO ORDER.

Fabtech Motorsports | 4331 Eucalyptus Ave. Chino, CA 91710

Tech Line: 909-597-7800 | Fax: 909-597-7185 | Web: [www.fabtechmotorsports.com](http://www.fabtechmotorsports.com)

## - TOOL LIST -

### **Required Tools (Not Included)**

- Basic Hand Tools
- Floor Jack
- Jack Stands
- Assorted Metric and S.A.E sockets, and Allen wrenches
- Torque Wrench
- Die Grinder w/ Cutoff Wheel or Sawzall
- Vise Grip Clamp
- Drill w/ assorted drill bits

## - PRE-INSTALLATION NOTES -

For technical assistance call: **909-597-7800** or e-mail: **info@fabtechmotorsports.com**

### **READ THIS BEFORE YOU BEGIN INSTALLATION -**

Check all parts to the parts list above before beginning installation. If any parts are missing contact Fabtech at 909-597-7800 and a replacement part will be sent to you immediately.

Read all instructions thoroughly from start to finish before beginning the installation. If these instructions are not properly followed severe frame, driveline and / or suspension damage may occur.

Check your local city and state laws prior to the installation of this system for legality. Do not install if not legal in your area.

Prior to the installation of this suspension system perform a front end alignment and record. Do not install this system if the vehicle alignment is not within factory specifications. Check for frame and suspension damage prior to installation.

The installation of this suspension system should be performed by two professional mechanics.

This suspension must be installed with Fabtech shock absorbers.

Use the provided thread locking compound on all hardware.

For use with Fabtech suspension only.

**WARNING-** Installation of this system will alter the center of gravity of the vehicle and may increase roll over as compared to stock.

Vehicles that receive oversized tires should check ball joints, uniballs, tie rods ends, pitman arm and idler arm every 2500-5000 miles for wear and replace as needed.

Verify differential fluid is at manufactures recommended level prior to kit installation. Installation of the kit will reposition the differential and the fill plug hole may be in a different position. (For example, if the manufacture recommends 3 quarts of fluid, make sure the diff has 3 quarts of fluid). Check your specific manual for correct amount of fluid.

### **FOOTNOTES -**

- Fits 4-door models only
- For heavy offroad use, front driveshaft is required. Order FTS94057
- For heavy offroad use, rear driveshaft is required. See a quality driveline supplier to order

## - INSTRUCTIONS -

1. Take accurate measurements of the front suspension height. This measurement will need to be taken from the center of the front wheel hub to the center most part of the wheel well. This measurement will be needed to correctly set the height for the new Coilover shocks. DO NOT exceed 3" or 5" over stock height. If you are adding this kit to a Jeep that is already lifted, then match the current height. Record your measurements below.

Right \_\_\_\_\_ Left \_\_\_\_\_

2. Disconnect the negative terminal on the battery. Jack up the front end of the truck and support the frame rails with jack stands. **NEVER WORK UNDER AN UNSUPPORTED VEHICLE!** Remove the front tires.
3. Remove the factory inner fender liners. Save all hardware.
4. On the Driver side, locate the bracket that supports the washer fluid reservoir and other components. The excess bolt threads and bent lip will need to be cut off. **SEE FIGURES 1-2**



FIGURE 1 - STEP 4

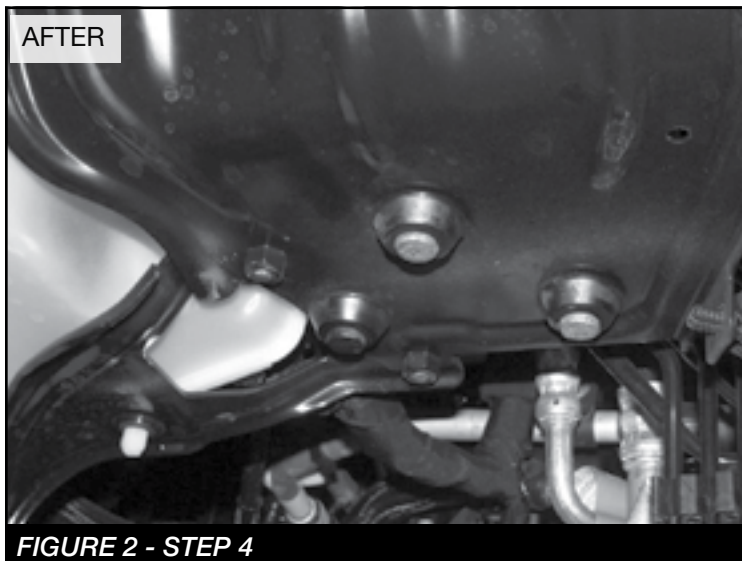


FIGURE 2 - STEP 4

5. Passenger side, locate the bracket underneath the battery holder. Refer to the figure below for the area that needs to be cut off, as well as the location of the bolt threads to be removed. **SEE FIGURES 3-4.** Paint all bare areas.

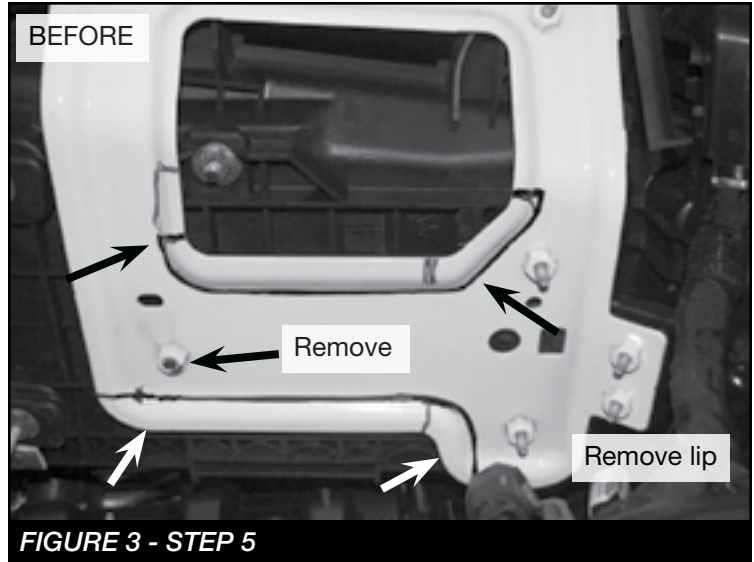


FIGURE 3 - STEP 5



6. **Driver side upper shock mount:** Using a paint pen. Mark the factory welds that attach the shock tower mount to the frame. **SEE FIGURE 5**

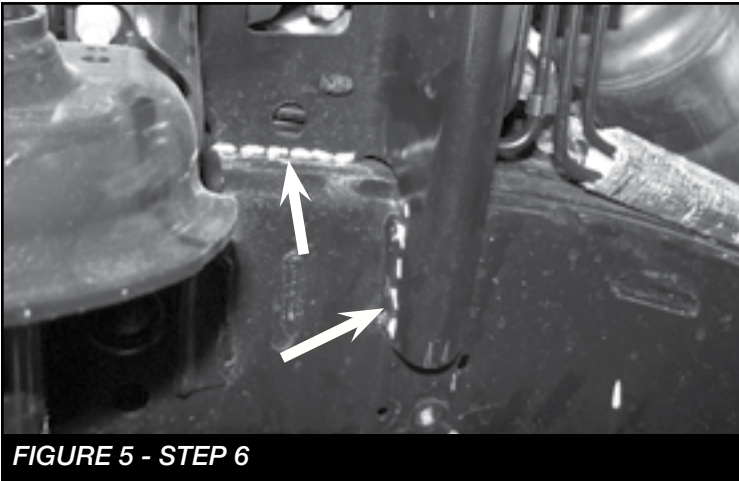


FIGURE 5 - STEP 6

7. Mark 90 degrees on the inside of the shock tower only, not the coil bucket. **SEE FIGURE 6**

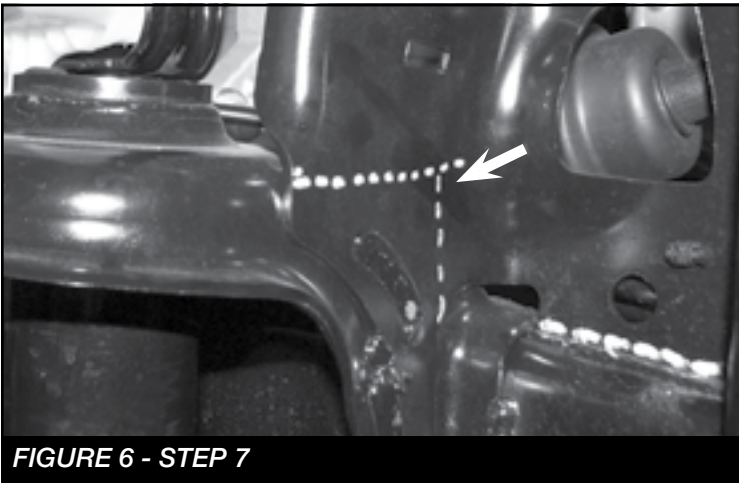


FIGURE 6 - STEP 7

8. Using a cut off wheel and/or saw zaw. Cut the tower bracket off, then sand the frame to a smooth finish. **SEE FIGURE 7**

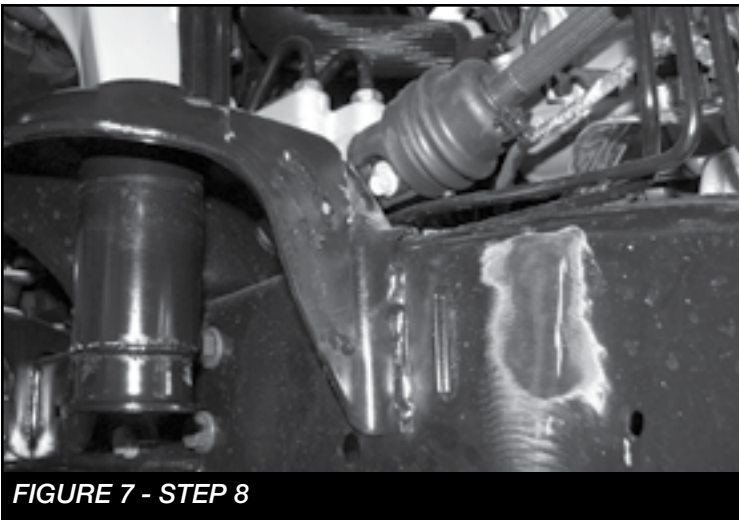


FIGURE 7 - STEP 8

9. Measure 1" from the outside edge of the inner coil bucket lip. Mark a line. **Note: Everything past the 1" mark will need to be removed.** Using a cut off wheel or saw zaw cut the part off of the bucket. Sand to a smooth finish. Paint all bare areas. **SEE FIGURES 8-10**

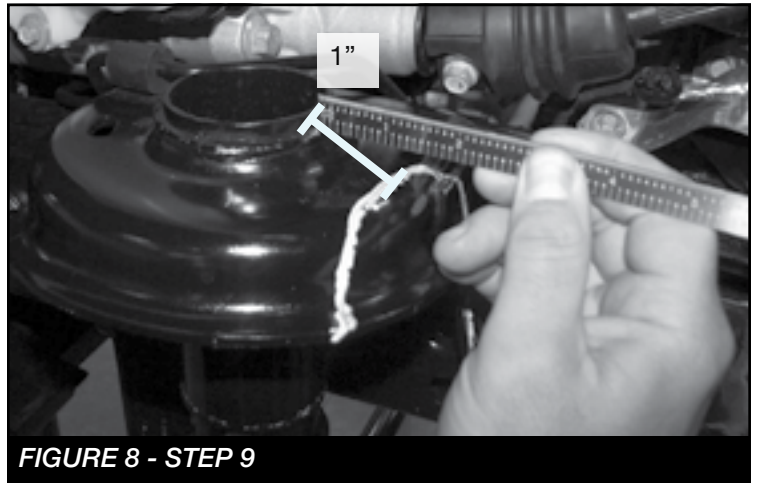


FIGURE 8 - STEP 9



FIGURE 9 - STEP 9

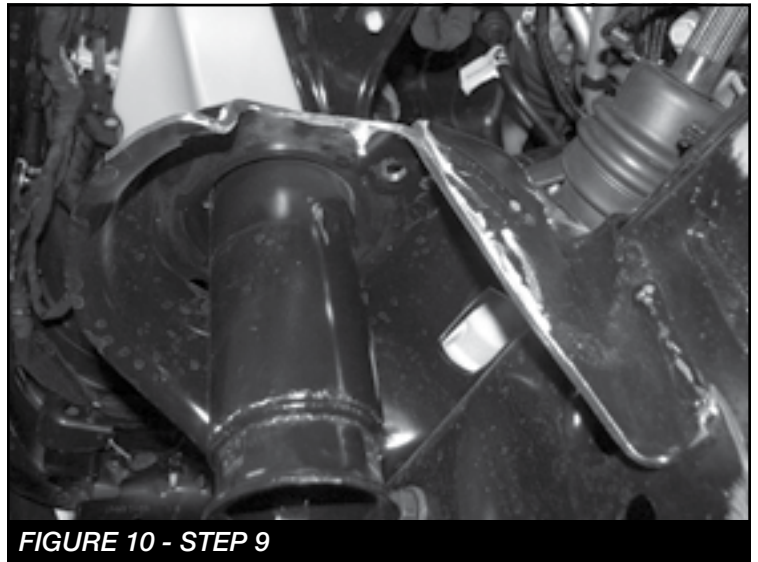
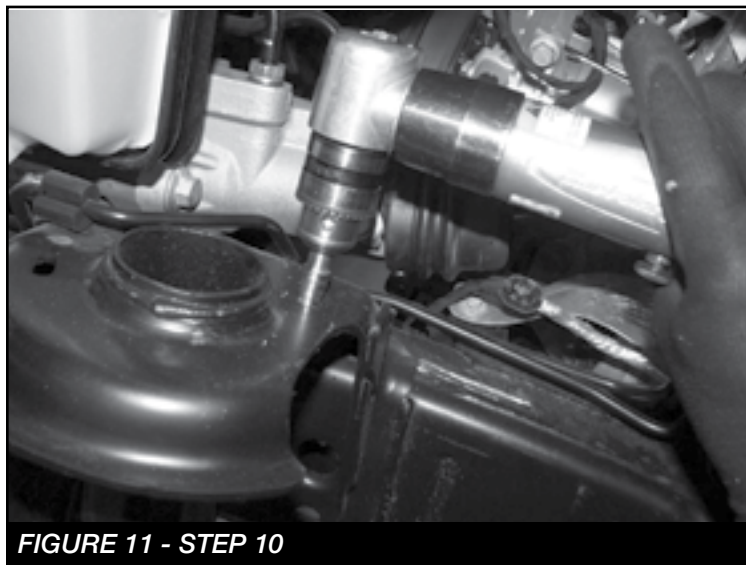


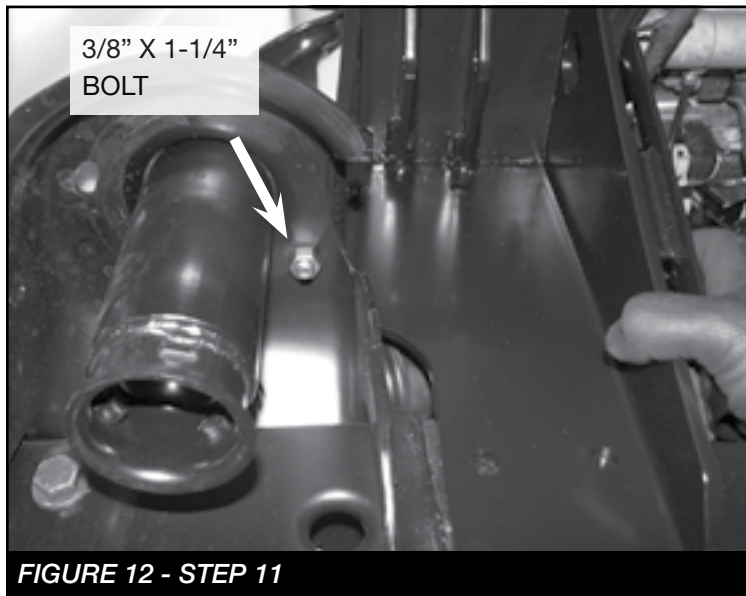
FIGURE 10 - STEP 9

10. Using a drill and 3/8" bit. Drill out the existing hole on the coil bucket. **SEE FIGURE 11**

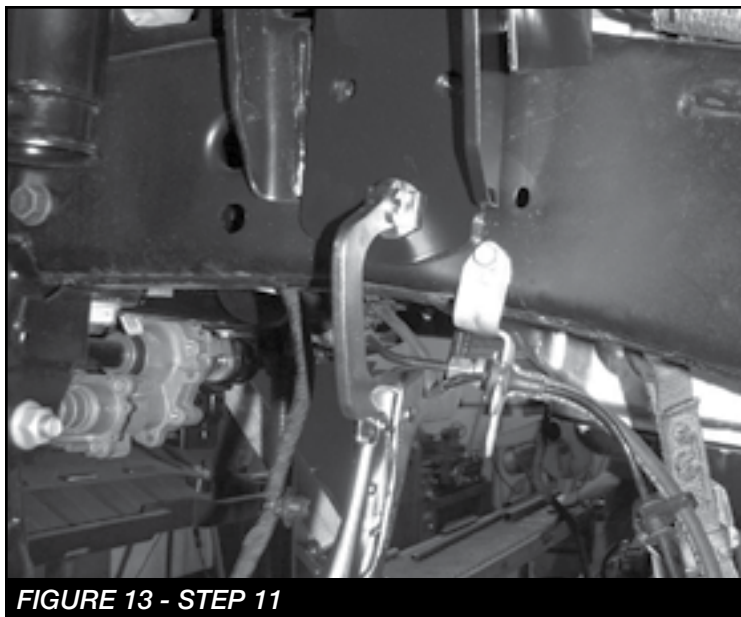


**FIGURE 11 - STEP 10**

11. Install FT50681 (Driver Coilover Tower) to the factory coil bucket using a supplied 3/8" x 1-1/4" bolt and nut. Then, using a vise grip or clamp. Position the new tower so it is setting flush on the frame then clamp together. **SEE FIGURES 12-13**

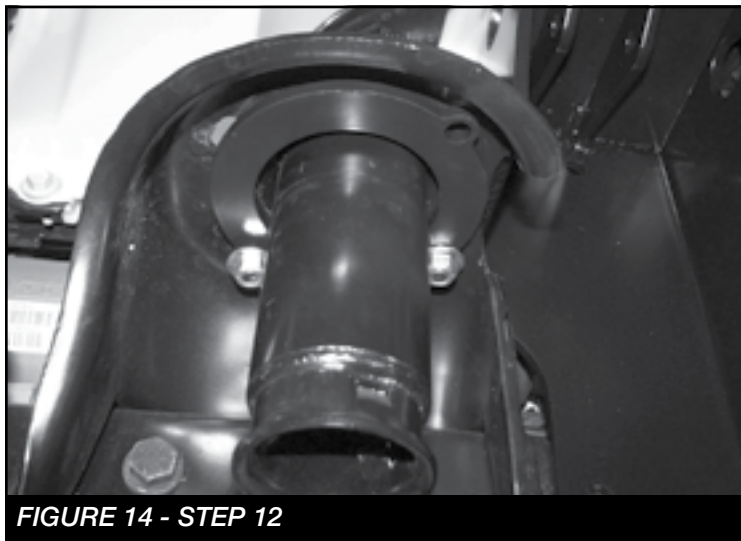


**FIGURE 12 - STEP 11**



**FIGURE 13 - STEP 11**

12. Remove the 3/8" nut from the bottom of the coil bucket and install the FT50698 (Spacer) on the bottom side of the factory coil bucket using the 3/8" nut you just removed and another 3/8" x 1-1/4" bolt and hardware on the rear factory hole. **NOTE: Use one 3/8" USS washer on the top due to the factory hole diameter. SEE FIGURE 14**



**FIGURE 14 - STEP 12**

13. Mark and drill the last hole to 3/8" using the new tower/  
bottom spacer as a template. Then, install a 3/8" x 1-1/4"  
bolt and hardware. Hand tighten. **SEE FIGURES 15-17**



FIGURE 15 - STEP 13

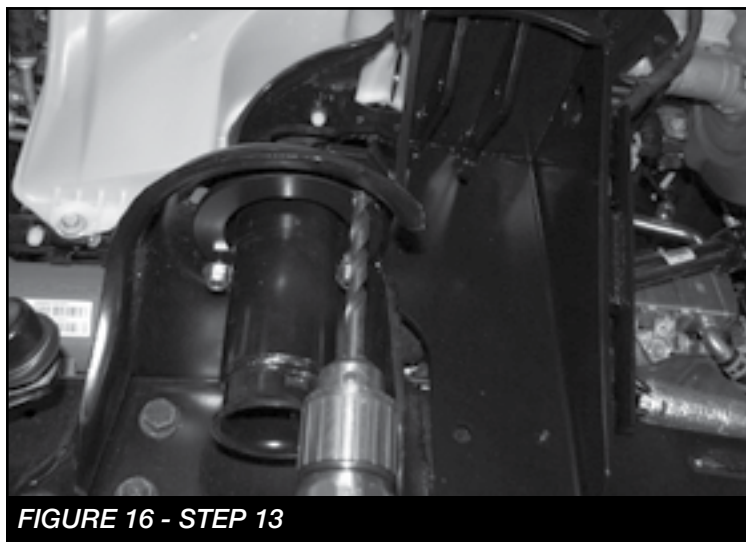


FIGURE 16 - STEP 13

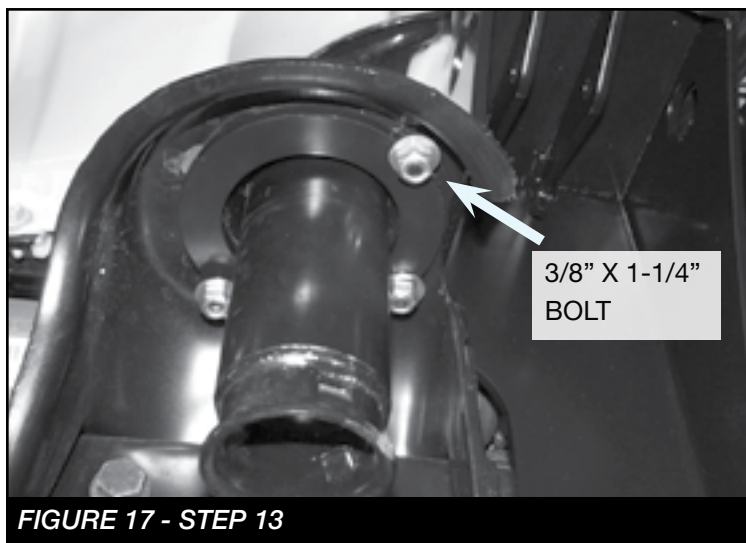


FIGURE 17 - STEP 13

14. Remove the clamp. Using a punch, mark and drill the 3  
holes in the side of the frame using the new bracket as a  
guide. Use a 1/2" drill bit. **SEE FIGURES 18-19**



FIGURE 18 - STEP 14

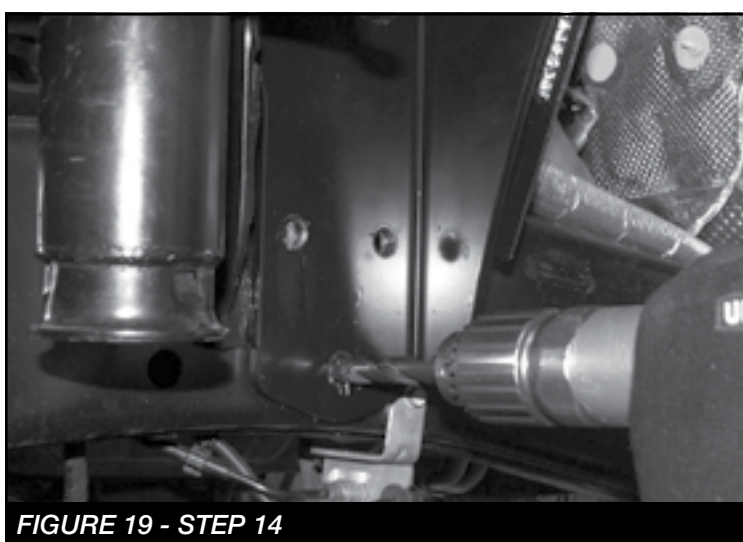


FIGURE 19 - STEP 14

15. Locate the motor mount just underneath the A/C compressor. Remove the factory bolt and save. Install FT50832 (Driver support bracket) to the motor mount bolt using the factory bolt. Then, mount the other end to the back side of the new coilover tower using the supplied 1/2-13 x 1-1/4 bolt, washers and nut. Through the front. Leave loose. **NOTE: The radius on the bracket will fit around the steering shaft. SEE FIGURES 20-22**

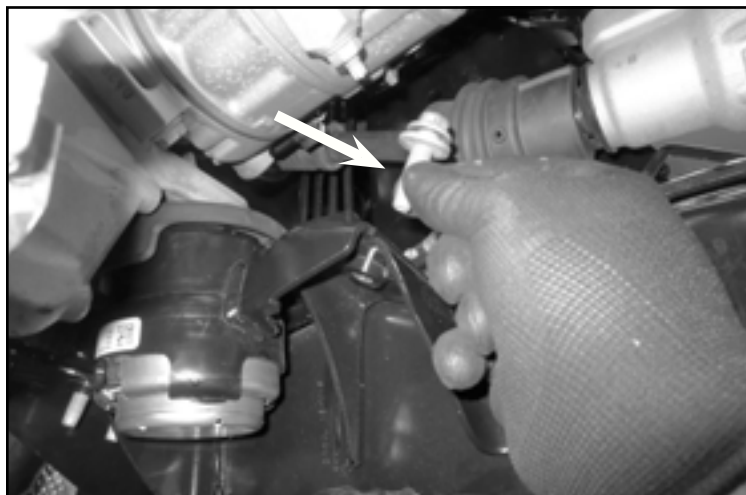


FIGURE 20 - STEP 15

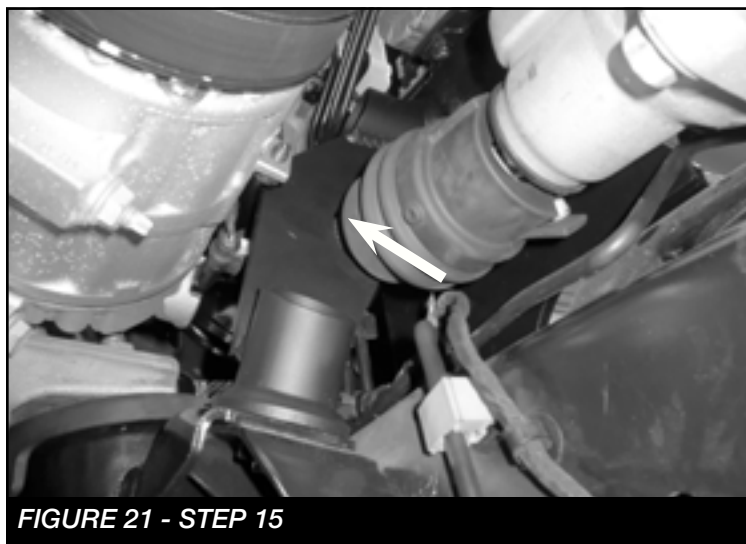


FIGURE 21 - STEP 15

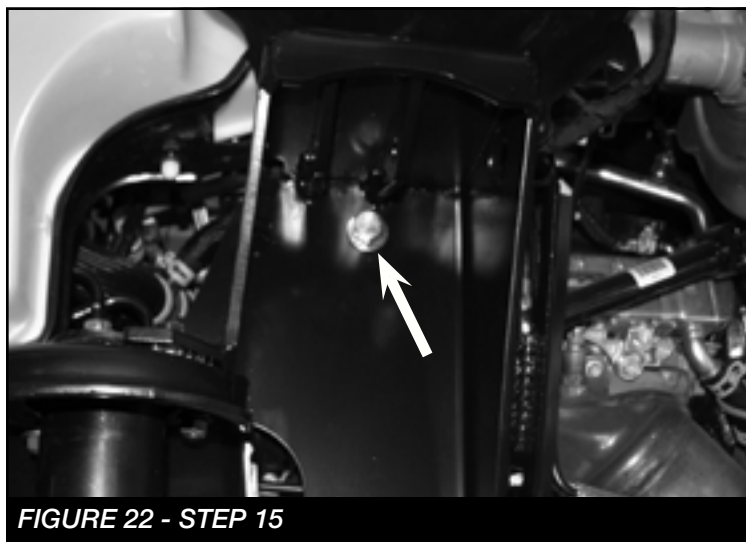


FIGURE 22 - STEP 15

16. Install FT50692 (Short Nut tab) through the factory hole just left of the new coilover tower using the supplied 1/2-13 x 1-1/4" bolt, flat and split washers. Leave loose. **SEE FIGURES 23-24**

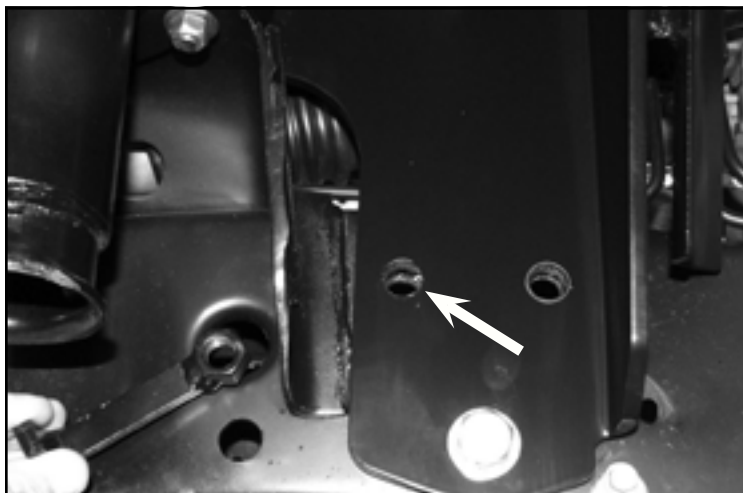


FIGURE 23 - STEP 16

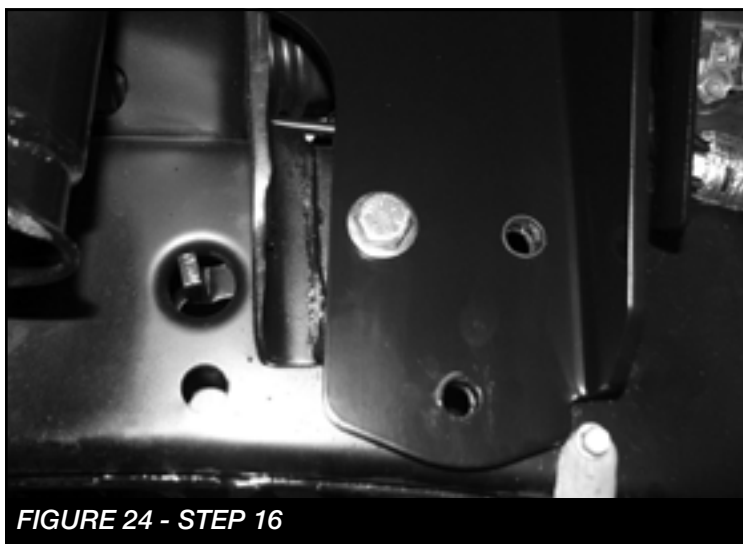
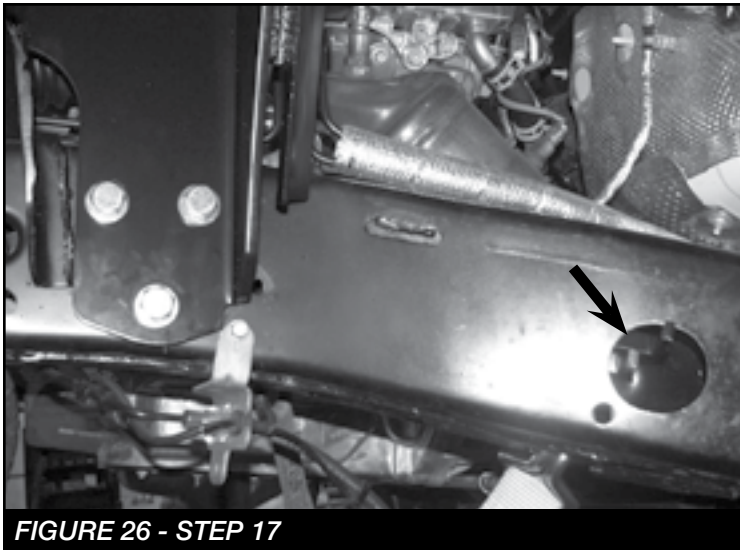
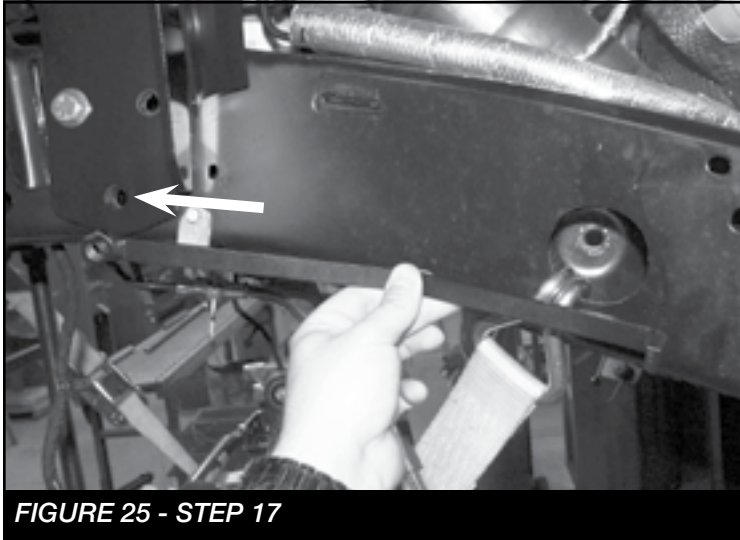
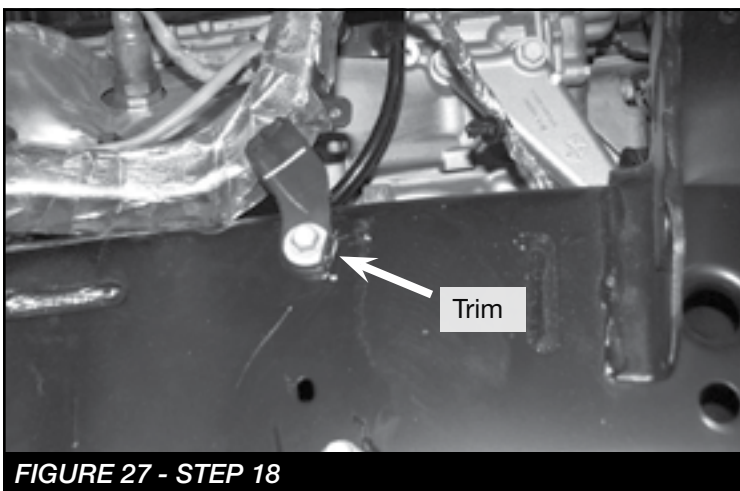


FIGURE 24 - STEP 16

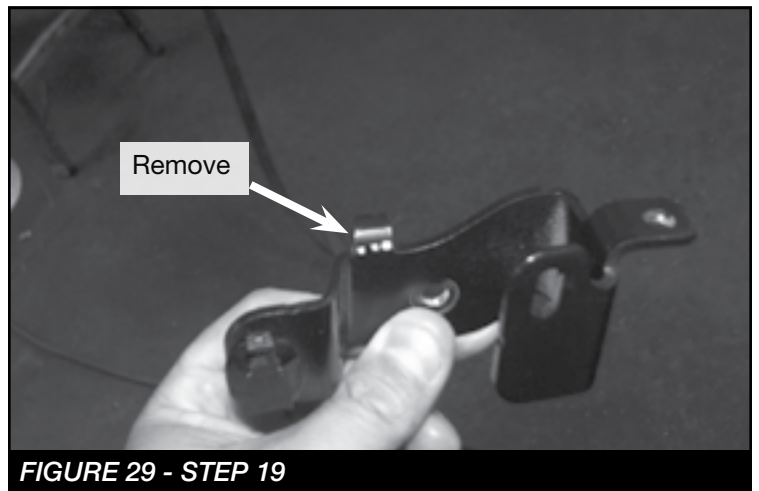
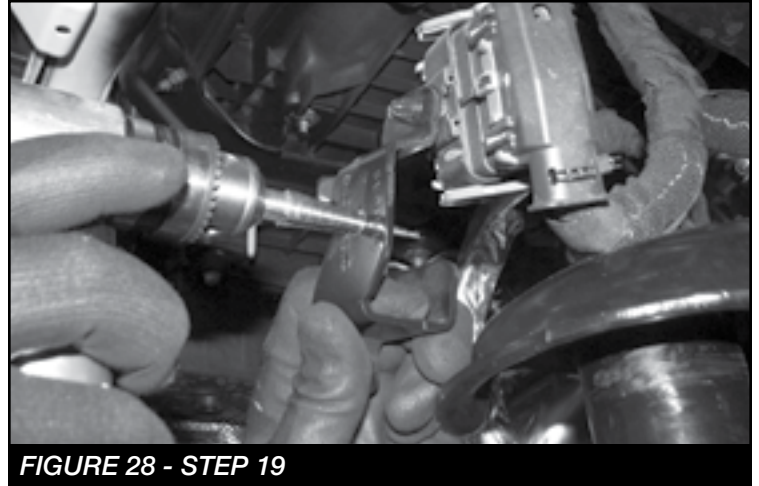
17. Install (2) of FT50691 (Long Nut tab) through the large factory hole on the frame to the right of the tower. Attach using the supplied 1/2-13 x 1-1/4" bolt, flat and split washers. Torque the 3 tower bolts as well as the support tube hardware to 106 ft-lbs and the 3/8" hardware to 44 ft-lbs. **SEE FIGURES 25-26**



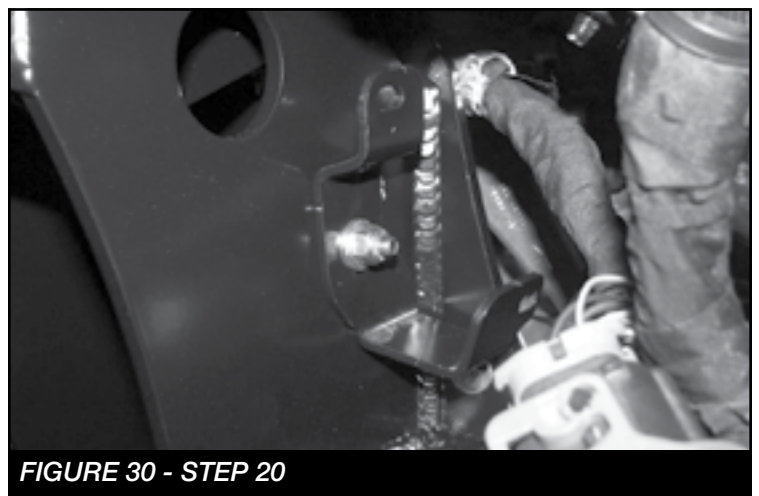
18. Repeat Steps 6-17 on the passenger side. **NOTE: The wire harness plastic bracket mounted to the frame will need to be trimmed to allow the fitment of the passenger coilover tower. SEE FIGURE 27**



19. Remove the bracket that attaches the main harness to the frame/coil bucket. Drill a 1/4" hole into the side of the bracket. Then cut the small bent ear off the side. **SEE FIGURES 28-29**



20. Install the bracket on the front side of the new coilover mount using the supplied 1/4" hardware. Torque to 12 ft-lbs. Then, reinstall the harness plug to the bracket. **SEE FIGURES 30-31**



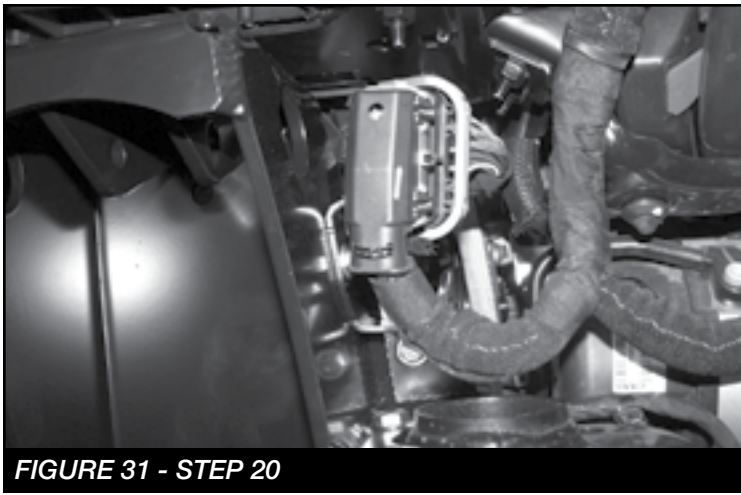


FIGURE 31 - STEP 20

21. Locate the driver side lower coil/shock mount. Mark and cut a straight line across the mount a 1/4" from the base of the round coil retainer. Also, drill out the factory hole on the top of the coil spring perch to 1/2". **SEE FIGURES 32-33**

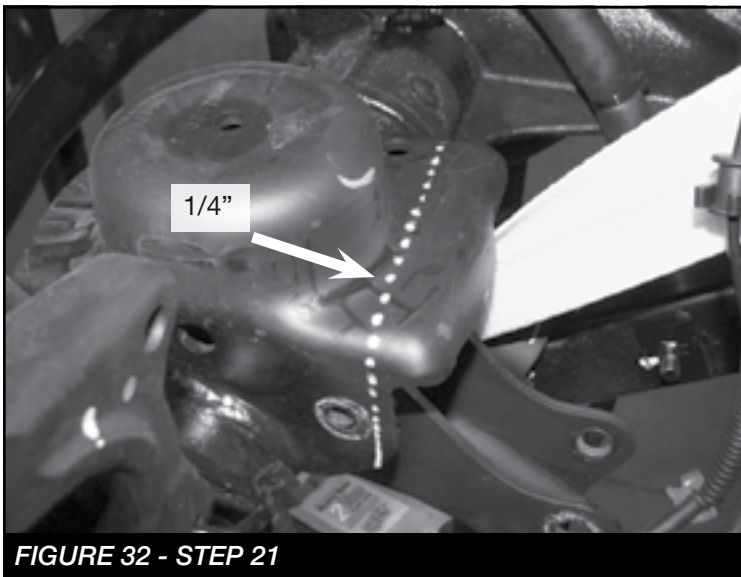


FIGURE 32 - STEP 21

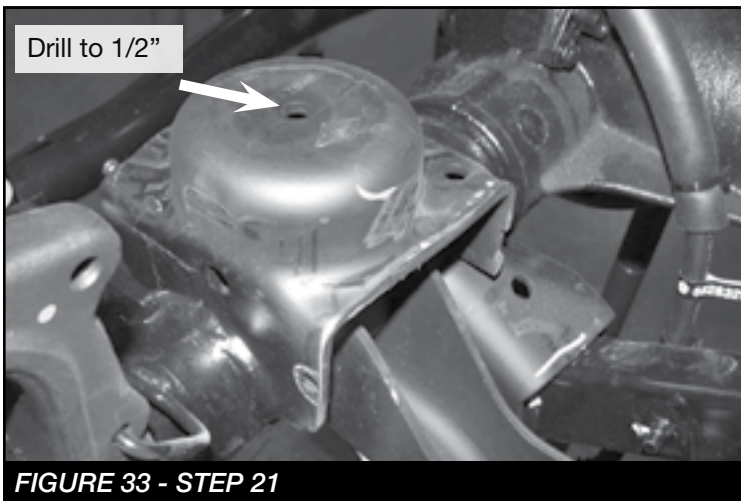


FIGURE 33 - STEP 21

22. Install FT50714 (Driver lower coilover mount) with the supplied 7/16" X 1-1/4" hardware x2 using the factory holes. Leave loose. **SEE FIGURES 34-36**

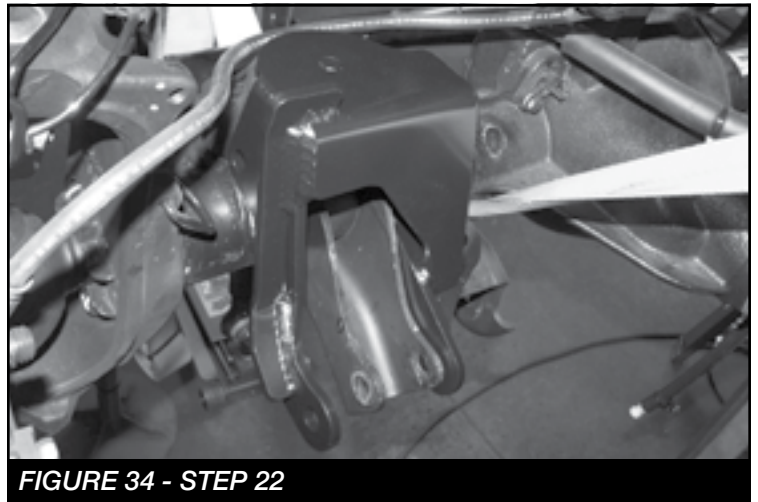


FIGURE 34 - STEP 22

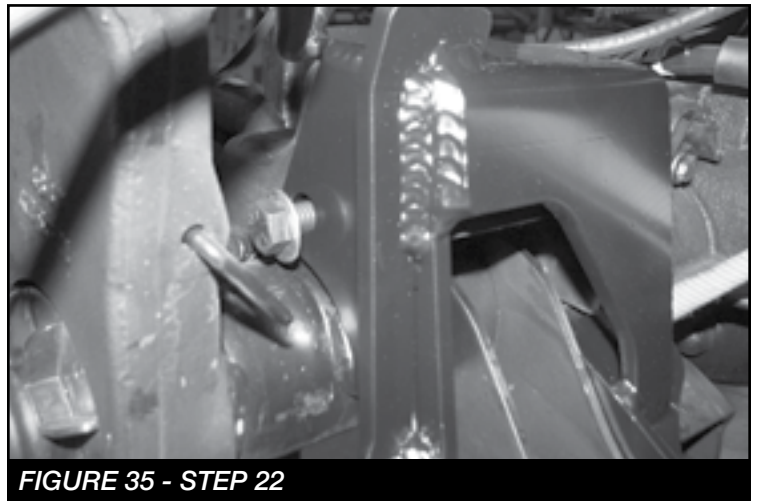


FIGURE 35 - STEP 22

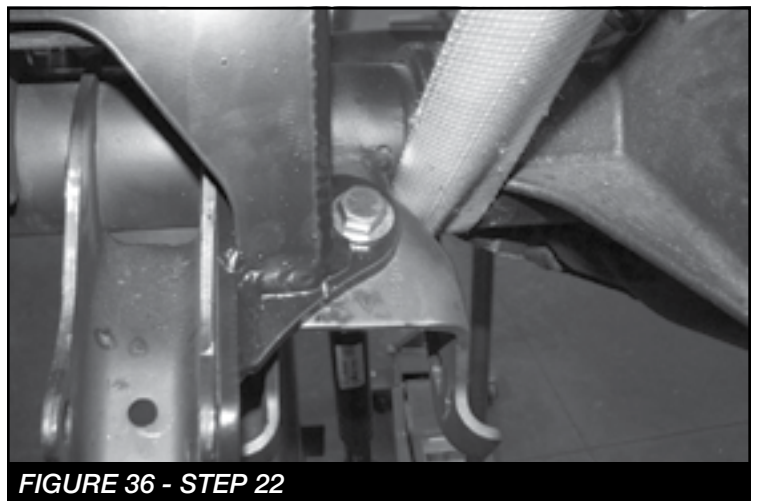
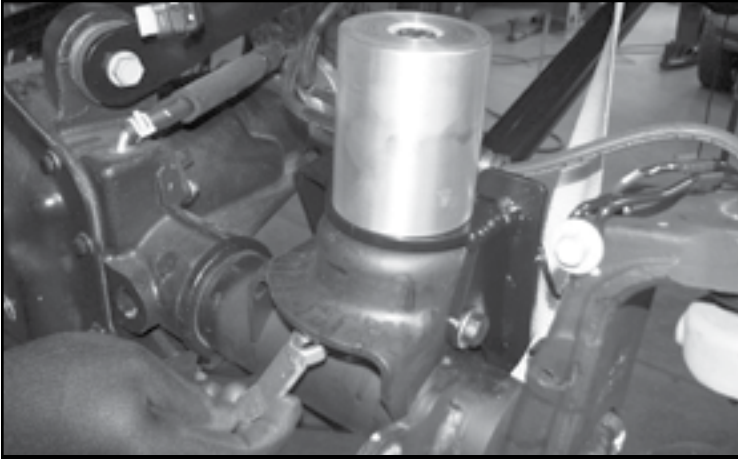


FIGURE 36 - STEP 22

23. Install FT50644 (Bump stop spacer) using the supplied FT50060 (Nut tab) and 1/2" bolt, all from FTS24251 or FTS24259 component box kit. **SEE FIGURE 37**

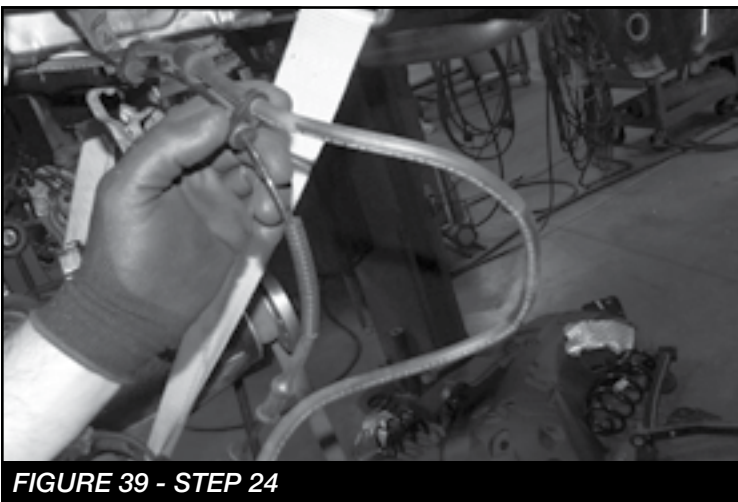


**FIGURE 37 - STEP 23**

24. Remove the factory brake line bracket from the rubber brake line hose as well as the plastic clips from the speed sensor cable. **SEE FIGURES 38-39**



**FIGURE 38 - STEP 24**



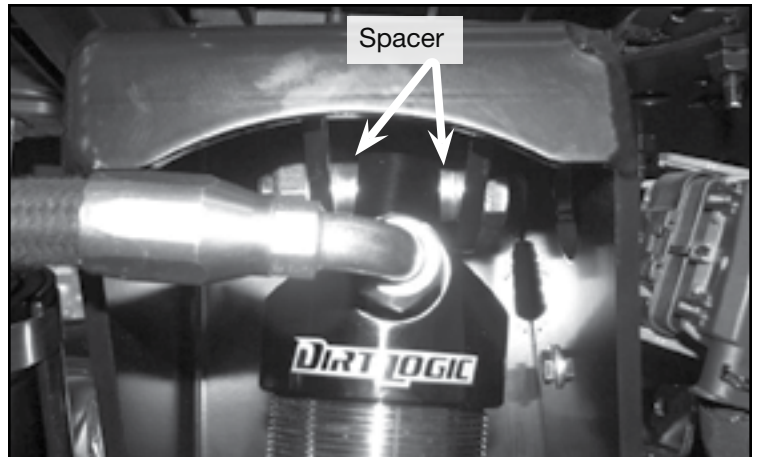
**FIGURE 39 - STEP 24**

25. Route the brake line hose and speed sensor cable together and mount them to the lower mount using the supplied rubber clamps and self tapping screws. **SEE FIGURE 40**

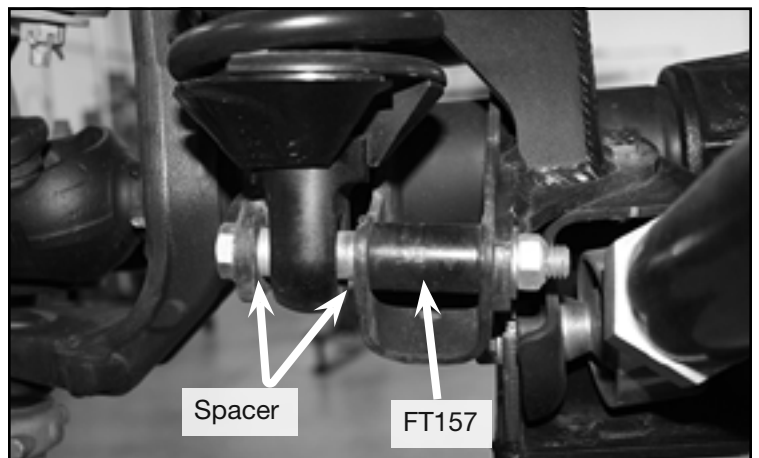


**FIGURE 40 - STEP 25**

26. Install the new Dirt Logic coilovers using the supplied misalignment spacers and 1/2" x 3" bolt and hardware for the upper mount. Then, install to the lower mount using the misalignment spacers, 1/2" x 4-3/4" bolt, hardware as well as FT157 (sleeve) at the lower factory shock mount location. **SEE FIGURES 41-42**



**FIGURE 41 - STEP 26**



**FIGURE 42 - STEP 26**

27. Install the Resi to the upper coilover mount/ Resi mount using the supplied clamps. **SEE FIGURE 43 FOR REFERENCE.**



**FIGURE 43 - STEP 27**

28. Install tires and wheels and torque lug nuts to wheel manufacturer's specifications. Reconnect the negative battery cable. Turn front tires left to right and check for appropriate tire clearance. **Note - Some oversized tires may require trimming of the front bumper & valance.**
29. Check front end alignment and set to factory specifications. Readjust headlights.
30. Recheck all bolts for proper torque.
31. Recheck brake hoses, ABS wires and suspension parts for proper tire clearance while turning tires fully left to right.
32. Check the fluid in the front and rear differential and fill if needed with factory specification differential oil. **Note - some differentials may expel fluid after filling and driving. This can be normal in resetting the fluid level with the new position of the differential/s.**
33. Install Driver Warning Decal. Complete product registration card and mail to Fabtech in order to receive future safety and technical bulletins on this suspension.

**Vehicles that will receive oversized tires should check ball joints, uniballs and all steering components every 2500-5000 miles for wear and replace as required.**

**RETORQUE ALL NUTS, BOLTS AND LUGS AFTER 50 MILES AND PERIODICALLY THEREAFTER.**

For technical assistance call: **909-597-7800**

## - Product Warranty and Warnings -

Fabtech provides a Limited Lifetime Warranty to the original retail purchaser who owns the vehicle, on which the product was originally installed, for defects in workmanship and materials.

The Limited Lifetime Warranty excludes the following Fabtech items; bushings, bump stops, ball joints, tie rod ends, limiting straps, cross shafts, heim joints and driveshafts. These parts are subject to wear and are not considered defective when worn. They are warranted for 60 days from the date of purchase for defects in workmanship.

Dirt Logic and Performance Coilover take apart shocks are considered a serviceable shock with a one year warranty on leakage only. Service seal kits are available separately for future maintenance. All other shocks are covered under our Limited Lifetime Warranty.

Fabtech does not warrant any product for finish, alterations, modifications and/or installation contrary to Fabtech's instructions. Alterations to the finish of the parts including but not limited to painting, powder coating, plating and/or welding will void all warranties. Some finish damage may occur to parts during shipping, which is considered normal and is not covered under warranty.

Fabtech products are not designed nor intended to be installed on vehicles used in race applications or for racing purposes or for similar activities. (A "RACE" is defined as any contest between two or more vehicles, or any contest of one or more vehicle against the clock, whether or not such contest is for a prize). This warranty does not include coverage for police or taxi vehicles, race vehicles, or vehicles used for government or commercial purposes. Also excluded from this warranty are sales outside of the United States of America.

Installation of most suspension products will raise the center of gravity of the vehicle and will cause the vehicle to handle differently than stock. It may increase the vehicle's susceptibility to a rollover, on road and off road, at all speeds. Extreme care should be taken to operate the vehicle safely at all times to prevent rollover or loss of control resulting in serious injury or death. Fabtech front end Desert Guards may impair the deployment or operation of vehicles equipped with supplemental restraining systems/air bag systems and should not be installed if the vehicle is equipped as so.

Fabtech makes every effort to ensure suspension product compatibility with all vehicles listed on the website, but due to unknown auto manufacturer's production changes and/or inconsistencies by the auto manufacturer, Fabtech cannot be responsible for 100% compatibility, including the fitment of tire and wheel sizes listed. The Tire and Wheel sizes listed in Fabtech's website are only a guideline for street driving with noted fender trimming. Fabtech is not responsible for damages to the vehicle's body or tires. Fabtech is not responsible for premature wear of factory components due to the installation of oversized tires and wheels.

Fabtech's obligation under this warranty is limited to the repair or replacement, at Fabtech option, of the defective product only. All costs of removal, installation or re-installation, freight charges, incidental or consequential damages are expressly excluded from this warranty. Fabtech is not responsible for damages and/or warranty of other vehicle parts related or non related to the installed Fabtech product. This warranty is expressly in lieu of all other warranties expressed or implied. This warranty shall not apply to any product that has been subject to accident, negligence, alteration, abuse or misuse as determined by Fabtech.

Fabtech suspension components must be installed as a complete system including shocks as shown on our website. All warranties will become void if Fabtech parts are combined and/or substituted with other aftermarket suspension products. Combination and/or substitution of other aftermarket suspension parts may cause premature wear and/or product failure resulting in an accident causing injury or death. Fabtech does not warrant products not manufactured by Fabtech.

Depending on the condition of the factory suspension components retained after the installation of a Fabtech suspension not all vehicles may have the same ride stance front to rear as described in the website. The blue color of suspension components shown in all Fabtech photographs are for display purposes only. Majority of all Fabtech components will be black specifically where noted with part numbers ending in BK.

Installation of Fabtech product may void the vehicles factory warranty; it is the consumer's responsibility to check with their local vehicle's dealer for warranty disposition before the installation of the product. Some state laws may prohibit modification of suspension to a vehicle in whole or in part. It is the responsibility of the installer and consumer to consult local laws prior to the installation of any Fabtech suspension product to comply with such written laws.

It is the responsibility of the distributor and/or the retailer to review all warranties and warnings of Fabtech products with the consumer prior to purchase.

Fabtech reserves the right to super cede, discontinue, change the design, finish, part number and/or application of parts when deemed necessary without written notice. Fabtech is not responsible for misprints or typographical errors within the website or price sheet. For the most recent Product Warranty and Warnings visit our website [www.fabtechmotorsports.com](http://www.fabtechmotorsports.com)