

DECKED TOOL BOX INSTALLATION

**TOOLS
NEEDED:**

- 3/8" socket
- Ratchet

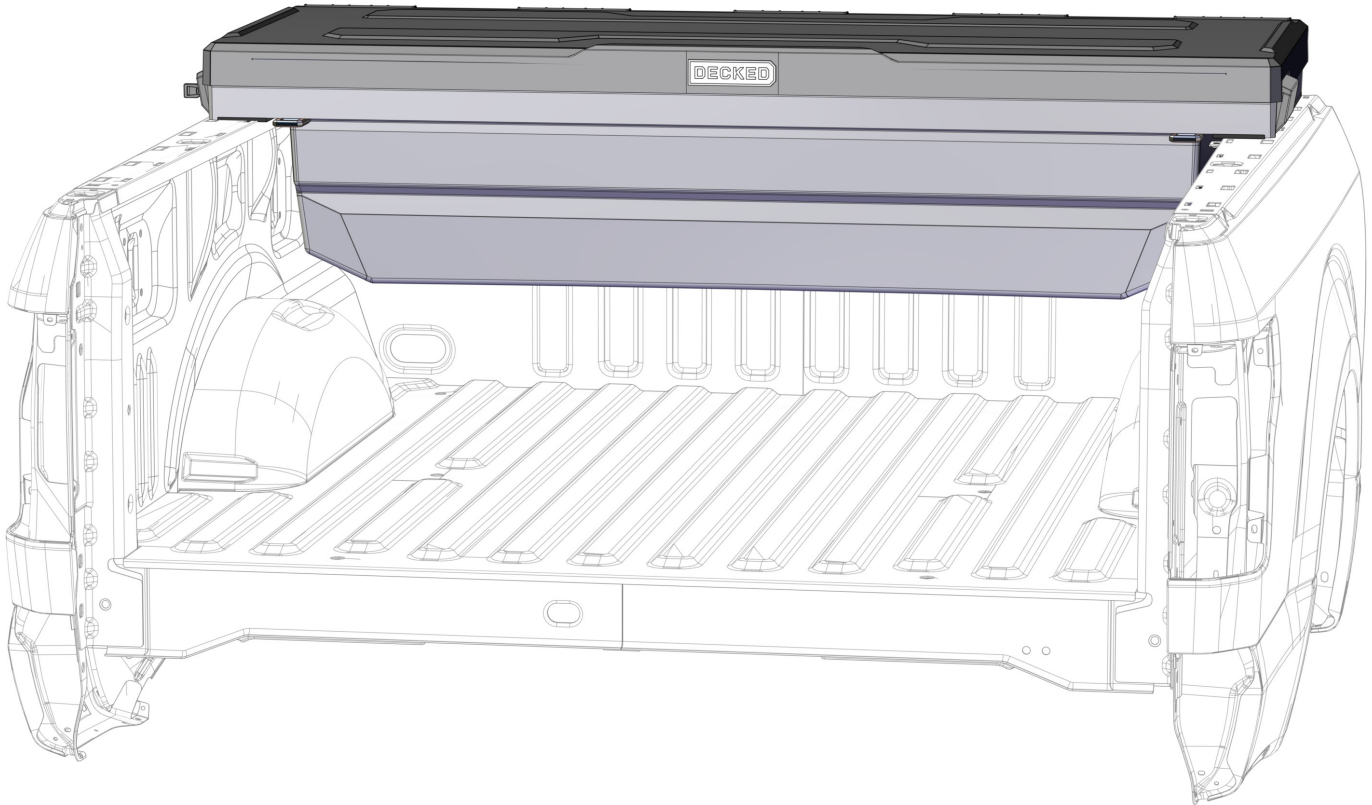

**FITS ALL FULL-SIZE TRUCKS
SOLD IN THE USA***

***Not compatible with:**

- Stepside or flareside trucks
- Service Bodies
- RAM with Rambox
- GM Carbon Pro bed
- 2003-2004 Ford Heritage edition
- 2000 and earlier trucks - call us for fitment
 - 2022 to current Toyota Tundras require a special bracket - call us if you need them



IMPORTANT INSTALLATION INFORMATION AND **WARNINGS:**

- Do not put fuels, flammables, explosives or hazardous materials inside any DECKED product.
 - Any modification or unintended use of this product shall immediately void all manufacturer's warranties.
 - TAILGATE MUST BE CLOSED AND LATCHED DURING TRANSIT.
 - The maximum load capacity is 800lbs. for the DECKED Tool Box. Please reference the vehicle owner's manual for maximum payload capacity.
 - Failure to read and follow the instructions for DECKED Tool Box installation and usage may result in personal injury or cause damage to the vehicle.
 - Verify all mounting bolts and clamps are secure. Check frequently.
 - Failure to follow these warnings or modification or other uses of these products could result in death, serious injury or property damage.
-

High-tech link to video here or you can visit decked.com/installvideo



SCAN FOR
INSTRUCTION VIDEOS

TOOLS NEEDED:

- 3/8" deep well socket (or use extender)
- Ratchet

DECKED TOOL BOX INSTALLATION

STEP 1:

Insert the triangular foam pieces from below the Tool Box lip on both sides and push into place.

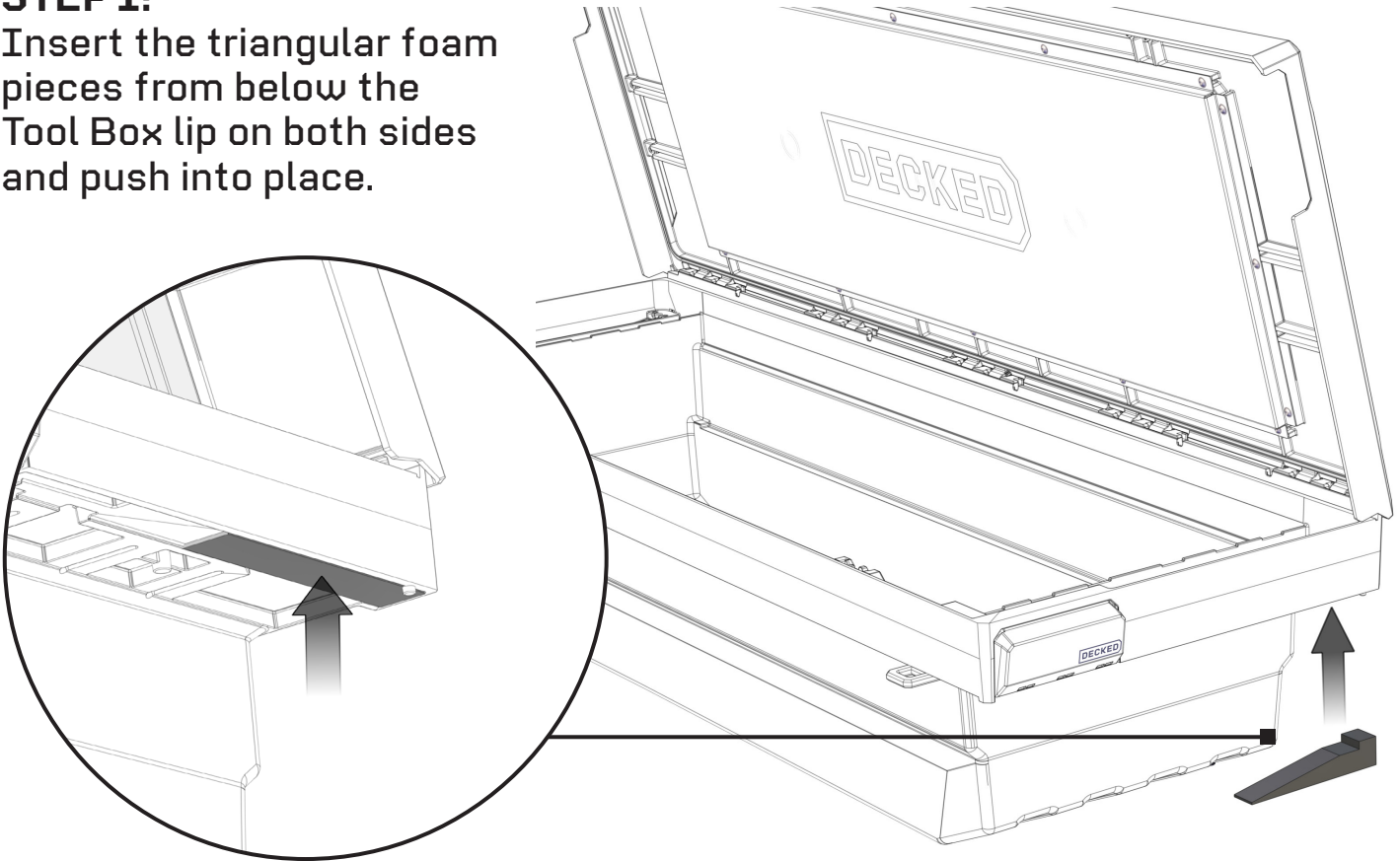

STEP 2:

Align and press a rubber bed rail pad up into the recessed areas under the overhang on both sides of the Tool Box.

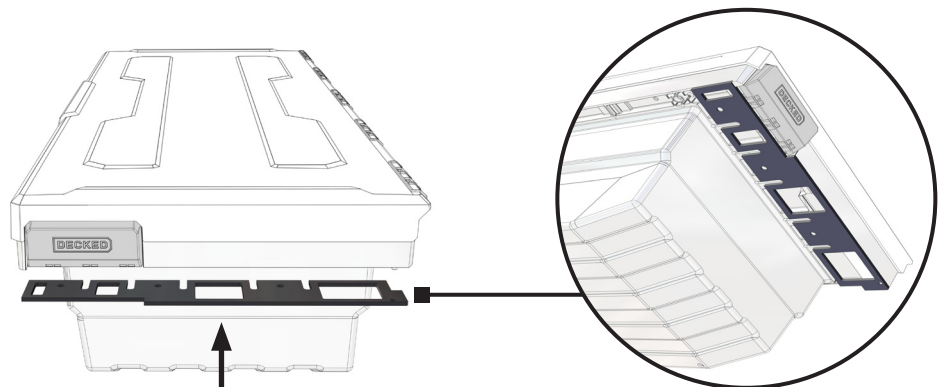

DECKED TOOL BOX INSTALLATION

STEP 3:

Unless you've experienced radiation exposure (allowing you to mutate into The Hulk) grab a friend to help you lift the Tool Box and place on top of the bed rails.

Center the Tool Box L-R between the bed rails keeping the rubber pads in place.

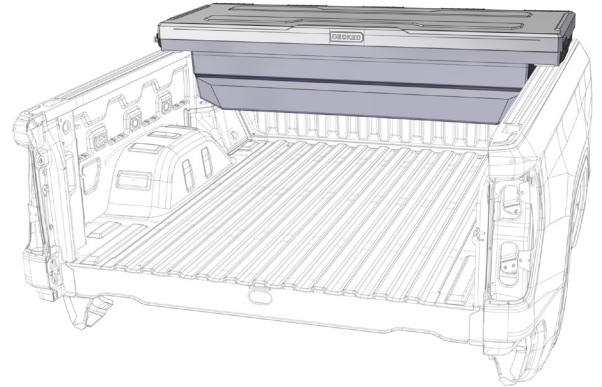
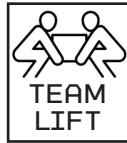

STEP 4:

Open the lid to make sure there is adequate distance (at least 2") between the Tool Box lid and any cab mounted cameras, lights or other important bits.

Shift the Tool Box toward the tailgate as needed to ensure correct positioning.

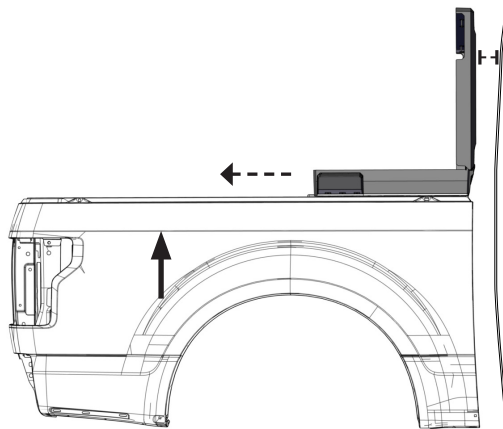

← WARNING
PROTECT YOUR TECH! KEEP AT LEAST A DISTANCE OF 2" BETWEEN TOOL BOX LID AND BACKUP CAMERA/LIGHTS

STEP 5:

Remove the rubber tool tray mats to expose the mounting locations.

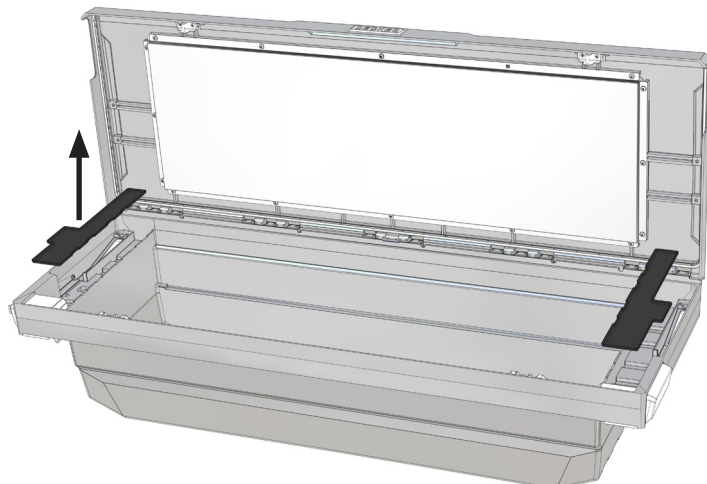

STEP 6:

There are five installation locations on each side of the Tool Box. Install (2) bed rail clamps on each side of the Tool Box using one location as close to the tailgate as possible and one location as close to the cab as possible.

NOTE: Outermost clamp locations vary per vehicle depending on the topology of the bed rails.

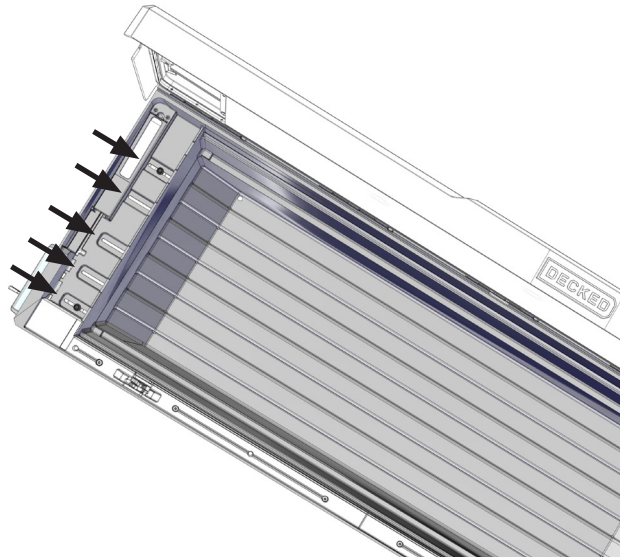

STEP 7:

Secure clamps under the bed rail with bolts and washers from inside the Tool Box. Tighten all four bolts to 60 in-lb.

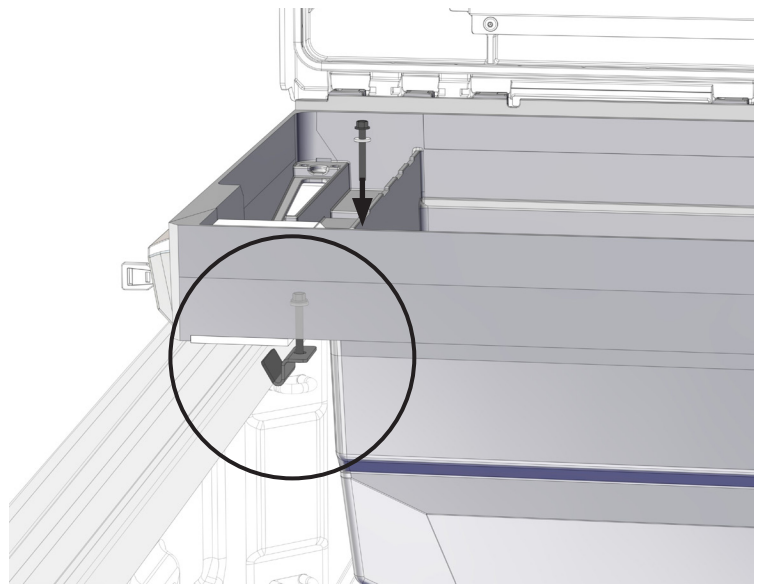

STEP 8:

Open the Tool box lid.

From inside the tub, push a rubber plug through each drain hole.

STEP 9:

Test tightness by closing Tool Box lid and trying to shift the Tool Box L-R and front to back. Check mounting brackets and bolts often to ensure they are secure.

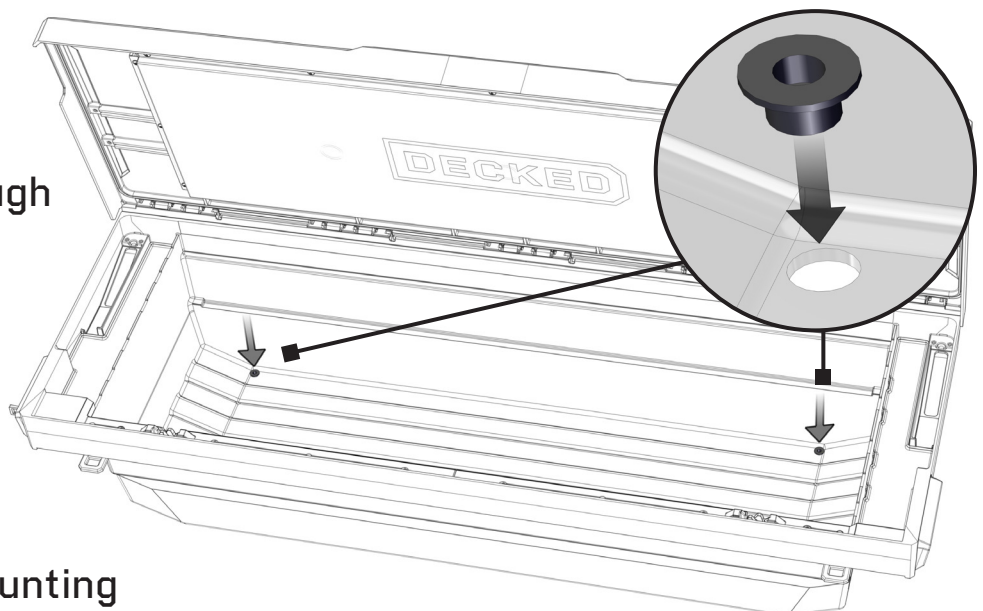

DECKED D-RING CARGO TIE DOWNS

TOOLS NEEDED:

- 3/16" hex key
- 5/32" hex key

There are four D-Ring Cargo Tie Down positions available. We included two D-Ring Cargo Tie Downs and hardware. Additional D-Rings are available on our website.

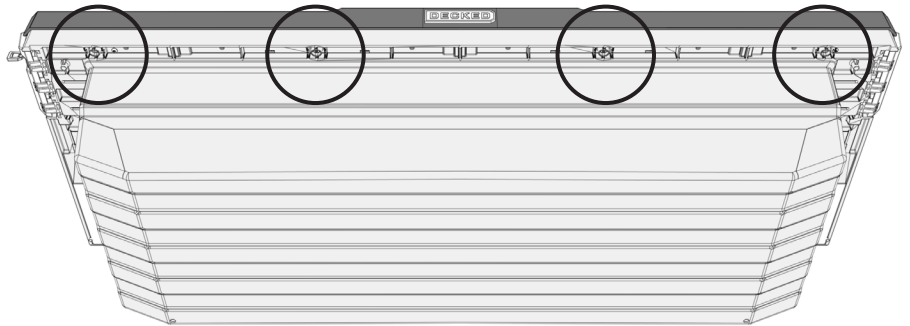

STEP 1:

Use a 5/32" hex key to remove the existing bolt in the desired D-Ring Cargo Tie Down install location. This bolt will not be reused.

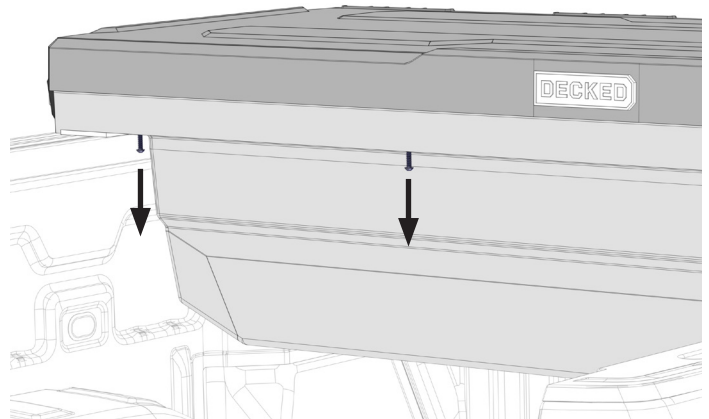

STEP 2:

Use a 3/16" hex key to install the longer bolt (included with the D-Ring Cargo Tie Down kit) and D-Ring Cargo Tie Downs. Tighten until snug.

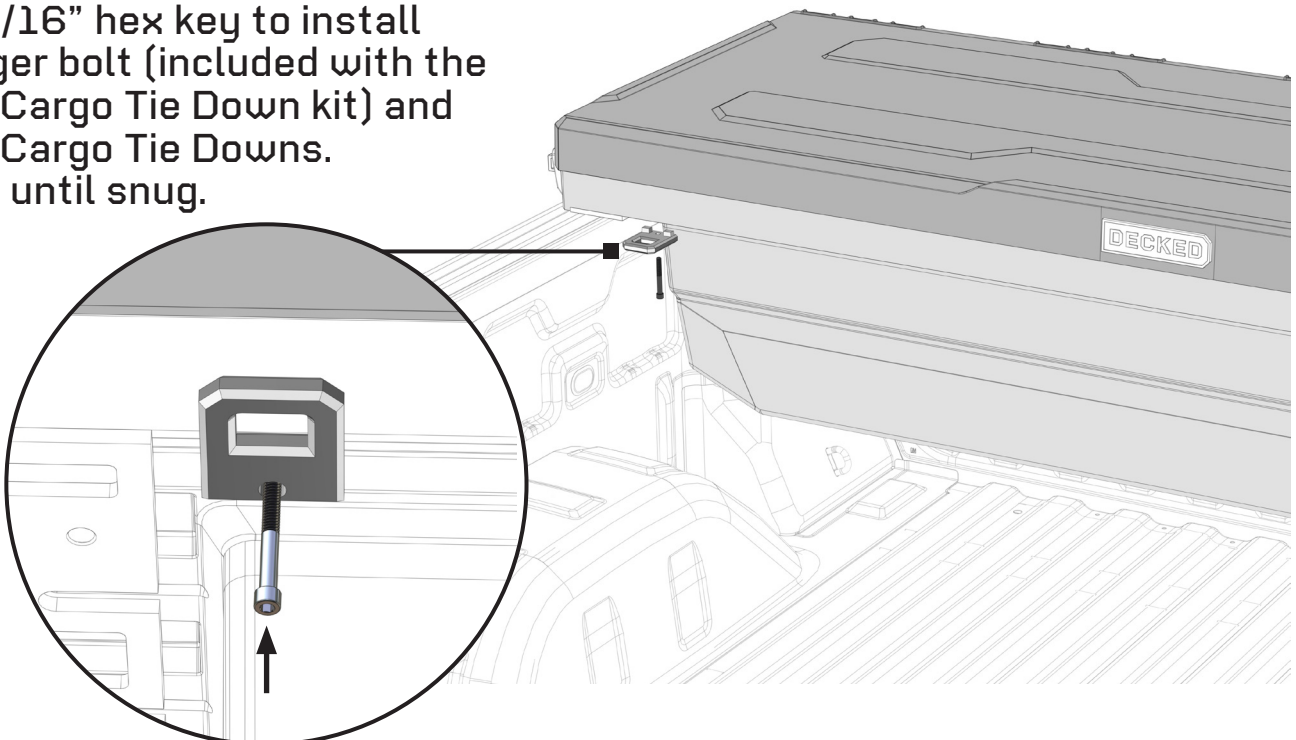

LEVEL UP YOUR BUILD WITH TOOL BOX ACCESSORIES

We included two D-Ring
Cargo Tie Downs with
your new Tool Box.

You can purchase two
more on our website.

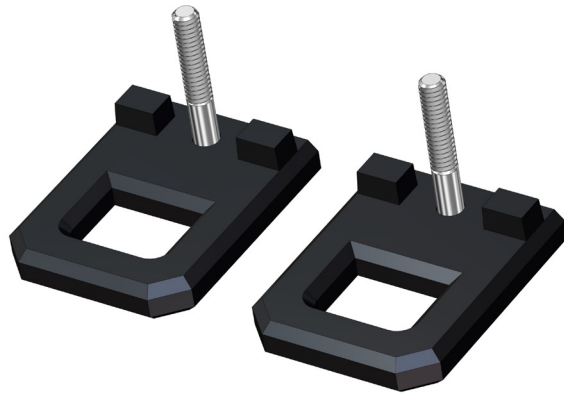

Complete your build!

Tool Hangers keep your
tools handy and are
available for purchase
on our website.

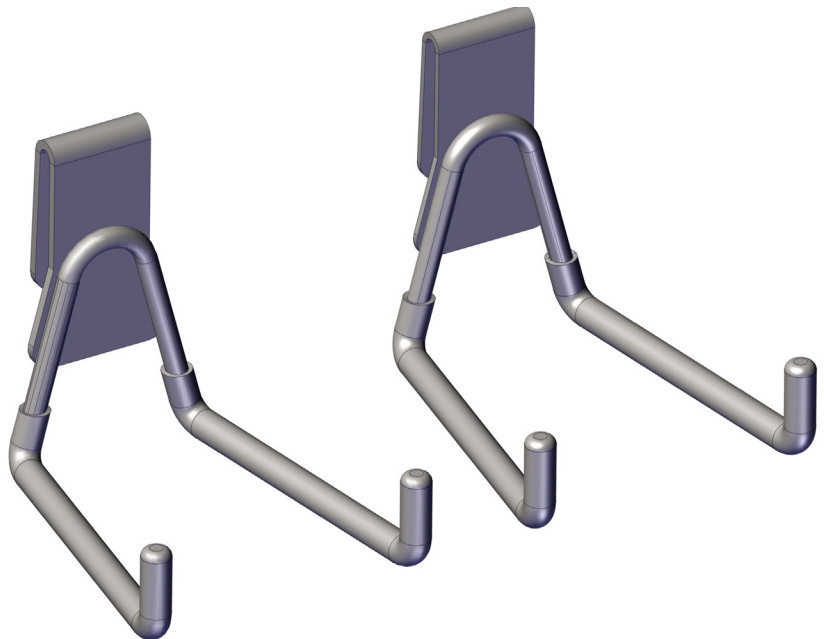

CONGRATS, GAME CHANGER! YOU DID IT.

Crack open a cold one of your liking, sit back
and admire your work. Now get busy organizin'!

DECKED LIMITED LIFETIME WARRANTY:

DECKED LLC warrants to the original purchaser of this product that the product will be free from defects in material and workmanship from the date of purchase and continuing for the expected lifetime of the DECKED product. The DECKED Product must be registered by the original purchaser with DECKED, LLC via its website at DECKED.COM/REGISTER, and a copy of the original sales receipt must be supplied to the Manufacturer at the time a warranty claim is made. The warranty terminates if the original purchaser transfers the DECKED product to any other person or vehicle. The original purchaser must contact the DECKED LLC customer service team and provide a description of the defective part, including digital pictures if requested, with the original purchase documentation as validation of warranty coverage or have previously activated their warranty online.

This warranty DOES NOT cover or apply to:

- Damage to the product due to misuse, mishandling and abuse.
- Products not used in accordance with the manufacturer's instructions or recommendations.
- Product not assembled or installed according to manufacturer's instructions.
- Normal wear and tear.
- Undeclared damage to the system during shipping, acts of God.
In addition, consequential damage and incidental damages (including lost time) such as damage to persons or property are not covered under this warranty.

Covered by one or more patents: www.decked.com/pages/patents



SCAN ME

REGISTER YOUR DECKED
GEAR:
DECKED.COM/REGISTER