



B & V PRODUCTS 2015-20 FORD F150/ 2014-20 RAPTOR/
 2017-20 F250/ F350 SUPERDUTY CONSOLE SAFE HALF OPEN
 SECTION w/ TRAY
 PART # 7045-1000-17
www.bvnproducts.com



MADE IN THE USA

 **TOOLS REQUIRED** 11mm, 10mm & 7mm sockets and ratchet, cordless drill, 1/4" & 3/8" drillbits and a large pry bar. 10.2.23

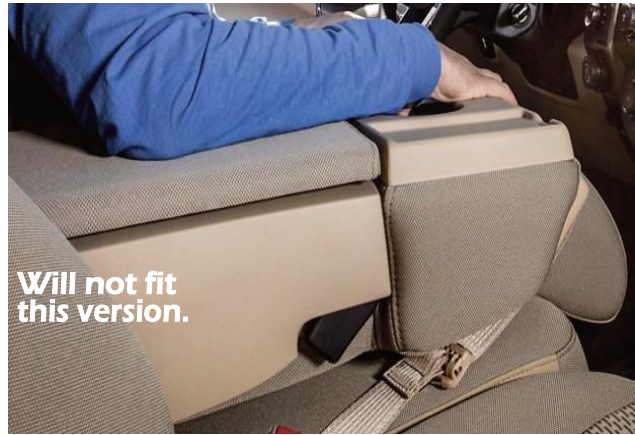

Will not fit this version.

Notes to the Technician/Installer:
 Do not attempt the installation of any B&V product without first reading the detailed instructions. **B&V will not warrant damaged parts or the vehicle due to altered installation procedures. Will not fit 2021 F-150.**

← Important:
 This console safe will not fit models without the factory "full length" center console.



1. Cover the seats with a protective cover prior to beginning the console installation. Lift straight up on the center console rear cup holder section to remove it.

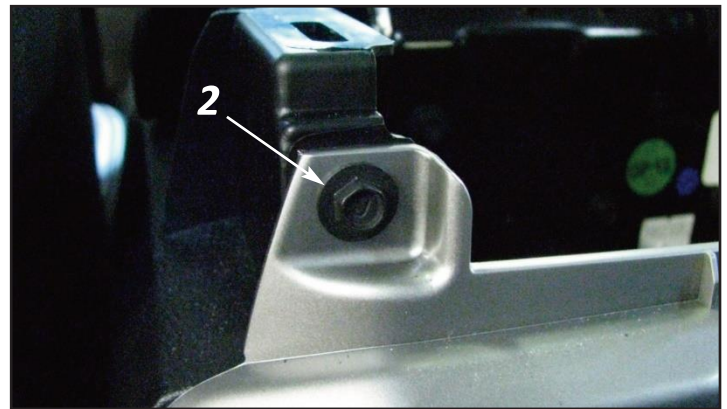

2. Once the cup holder section is out of the way, remove the two upper 7mm hex head screws (one each side) retaining the rear portion of the console.



3. Pull the panel straight back to release the side retaining clips.

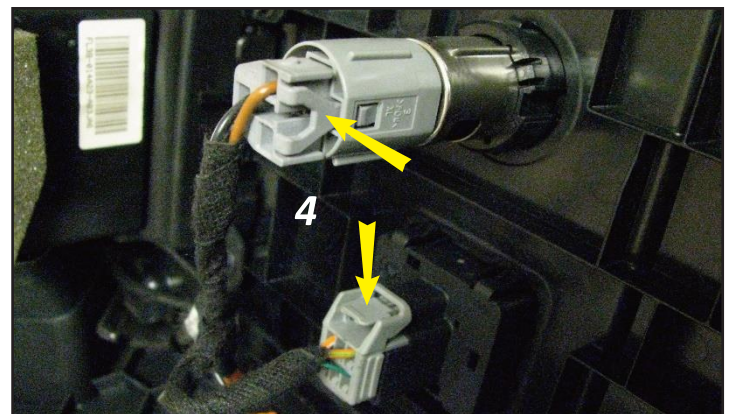

4. Disconnect the electrical connectors by pressing in on the release tabs (see yellow arrows) and place the rear panel in a safe place where it will not get damaged.

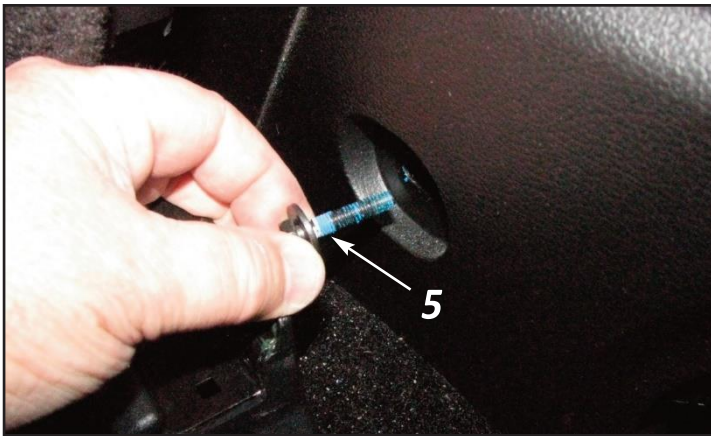

5. Move the front seats forward to expose the console lower rear mounting bolts (one each side). Use a 10mm socket to remove the mounting bolts. These bolts are removed to allow the console to be lifted in **Step 12**.

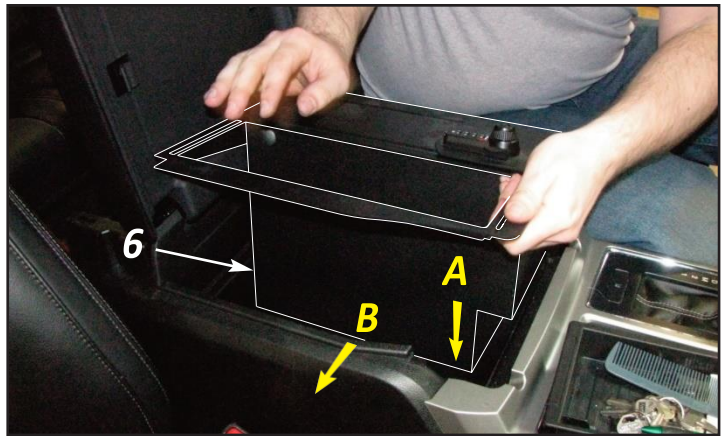

6. Make sure the console is empty and the lower liner has been removed. Carefully align the console safe into the console opening, tilting the front of the vault slightly down **(A)** and the bottom **(B)** towards the passenger side of the vehicle.



7. Finish rotating the console safe down into position until the top of the vault is resting against the inner ledge.



8. Once the console safe is in position, open the door to access the lower mounting holes for the following hole drilling procedure.



9. Locate the existing holes in the bottom of the console safe.

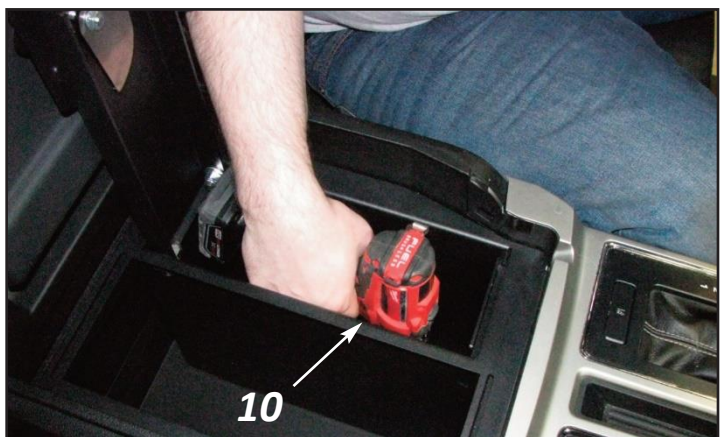

10. Use a 1/4" drill bit to drill through the exact centers of the holes in the bottom of the safe and through the plastic bottom of the factory console well. Drill slowly and carefully and do not let the drill bit pull the drill down into the console too far, allowing the bit to strike the floor beneath.

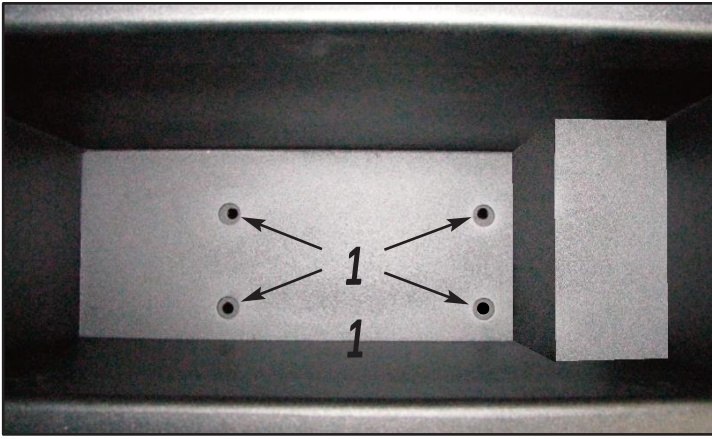

11. Enlarge the mounting holes to 3/8".

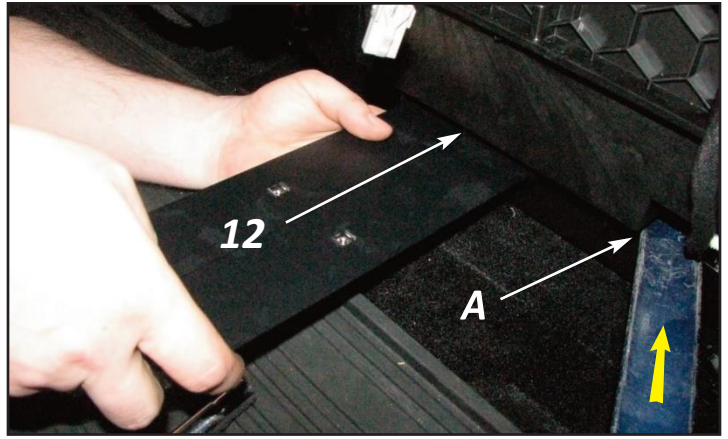

12. Insert a large pry bar (**A**) and lift the right side rear portion of the factory console away from the lower mounting bracket and insert the supplied retaining bracket (the bent legs of the mounting bracket face up, large leg at the back) between the bracket and the factory console well on the left side. Have an assistant hold the plate against the bottom of the console to aid installation.



13. Once the stainless steel cage nuts on the lower mounting bracket align with the holes enlarged in **Step 11**, install the supplied 1/4-20 x 1-3/4" bolts, 1/4" lock washers and 1/4" flat washers and tighten until the lower mounting bracket secures the console safe to the bottom of the factory console well. Remove any plastic shavings and install the supplied carpet insert into the bottom of the safe.



14. Place the factory console tray into the opening as shown. Reverse the disassembly procedure to finish the installation. **Prototype combination lock shown. Production combination locks are silver.**
For the owner: Follow the supplied detailed instructions on the following page and choose your lock combination.

Part #7045-1000 -17

Quantity:	Description:	Part Number:
1	Console Safe Complete	7045-1100-17
1	Mounting Plate	7045-1050-15
4	Preinstalled Cage Nuts	1999-6691-00
1	Installation Hardware Kit	7045-1902-17
4	1/4-20 x 1-3/4" Bolts	1999-1938-00
4	1/4" Flat Washers	1999-1951-00
4	1/4" Lock Washers	1999-1950-00
1	Carpet Insert	7045-0121-17

Warranty. B & V products (Manufactured by Fralo Industries) are warranted against defects in workmanship for a period of one (1) year from the date of purchase. Fralo's liability under this warranty is limited to the repair or replacement, at the option of Fralo, of the products or parts thereof covered by this Warranty, provided that Buyer provides all necessary materials. Fralo's obligation under this warranty shall not arise unless written notice of a warranty claim is made to Fralo. Fralo may require that the product in question be delivered for inspection, freight prepaid, at Fralo's office in Erie, Pennsylvania, or some other location designated by Fralo. THE REPAIR OR REPLACEMENT WARRANTY HEREIN SET FORTH IS THE EXCLUSIVE WARRANTY GIVEN BY FRALO FOR ITS GOODS. THIS WARRANTY IS GIVEN IN LIEU OF ANY OTHER WARRANTIES, WHETHER WRITTEN OR ORAL, EXPRESS OR IMPLIED. ANY AND ALL IMPLIED WARRANTIES OF MERCHANTABILITY OR FITNESS FOR ANY PARTICULAR PURPOSE ARE HEREBY EXPRESSLY EXCLUDED BY FRALO. FRALO NEITHER ASSUMES, NOR DOES IT AUTHORIZE ANY OTHER PERSON TO ASSUME ON ITS BEHALF, ANY OTHER LIABILITY IN CONNECTION WITH THE SALE OF ITS GOODS

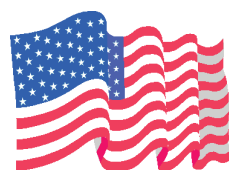

MADE IN AMERICA

Setting your own combination:

The opening combination code is preset to 0-0-0

1. Combination must be set to the opening combination code prior to resetting.
2. Set knob to the lock position.
3. The code reset button is located on the side of the lock. Press and hold the reset button.
4. Set your personal combination by turning the dials to the desired combination.
5. Release the reset button and the new opening combination code is set.
6. To lock, rotate one or more dials after the dial is turned to the lock position.
7. To open the lock, turn the dials to your personal combination.

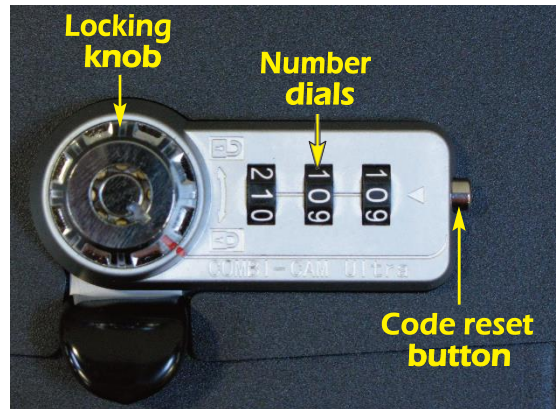

Discovering an unknown combination using the key:

1. Insert the key and turn it counter clockwise to unlock and open the safe.
Note: The knob will remain in the lock position.
2. With the key in the unlock position, turn each dial until it stops.
3. Once all the dials have stopped, the current opening combination code has been discovered and can now be reset.