

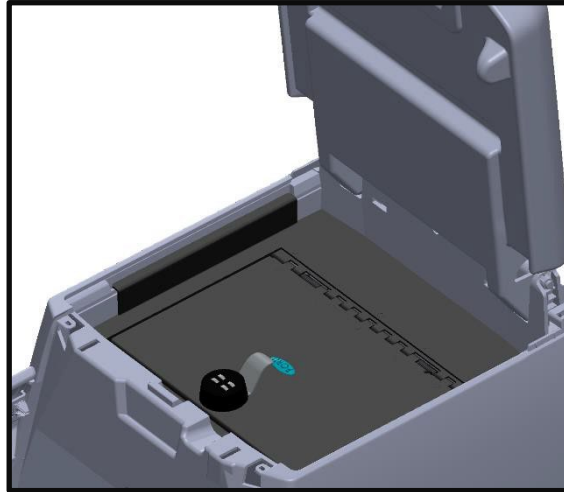

TEL: 1-866-XANATOS

## Installation Instructions for ASFS23:



1. If applicable, reset the combination lock before beginning installation.
2. Remove all contents from the center console, only leaving the rubber pad at the bottom.
3. With the door in the open position, carefully slide in the safe body with the lock facing towards the front of the vehicle figure (1). Be sure that the safe hangers are sitting directly on the file hanger features so the safe is fully seated in the console.
4. Hand-thread one of the front two fasteners until hand-tight, then use a 7/16" socket to fasten it.
5. Repeat Step 4 in the order shown in figure (2).
6. The installation is now complete.

