

advanced FLOW engineering Super Stock Air Intake System

Instruction Manual P/N: 55-10020R / 55-10020D

Make: Toyota

Model: Tacoma

Year: 2005-2023

Engine: L4-2.7L



- Please read the entire instruction manual before proceeding.
- Ensure all components listed are present.
- For technical support please call 951-493-7185.
- Ensure you have all necessary tools before proceeding.
- Do not attempt to work on your vehicle when the engine is hot.
- Retain factory parts for future use.

Label	Qty.	Description	Part Number
A1	1	Air Filter (Pro 5R)	30-10123
A2	1	Air Filter (Pro DRY S)	31-10123
B	1	Tube	05-5510020B1
C	1	Coupling, Silicone Elbow, 60deg	05-60660
D	1	Coupling, Silicone Bellows	05-01599
E	4	Clamp, 048(2-9/16" – 3-1/2")	03-50007
F	2	Screw, Hex Hd: M6x1x12	03-50032
G	2	Washer, Flat: M6	03-50070
H	1	Hose, Vacuum: 5/32"ID	05-00122
J	1	Nipple, Brs Hose: 3/16ID x 1/8NPT	03-50191

Installation will require the following tools:

Panel clip remover, Pliers, 8mm & 10mm nut drivers, 1/2" Wrench

Warranty Information available at <https://afepower.com/contact#warranty>

Emissions Disclaimer: This product is not currently CARB exempt and is not available for purchase in California or for use on any vehicle registered with the California Department of Motor Vehicles.

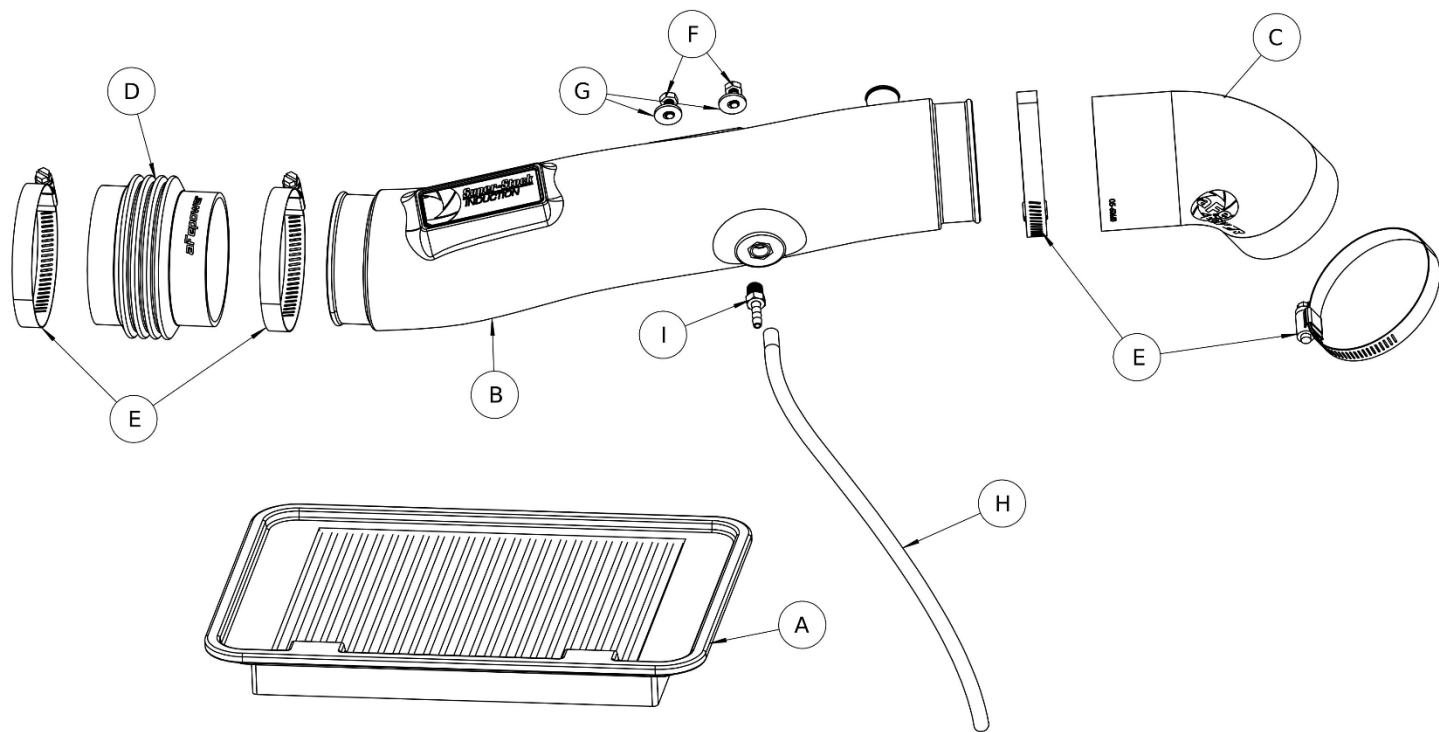



Refer to Figure A for Steps 1-2

Step 1: Using a clip remover, detach the wire harness clips (1) attached to the factory intake tube.

Step 2: Using the 10mm nut driver, remove the three screws (2) holding the factory intake tube.

**Figure B****Refer to Figure B for Steps 3-5**

Step 3: Using the pliers, disconnect the PCV hose (3) from the factory intake tube.

Step 4: Disconnect the MAP sensor connector and the base of the ASV line (4).

Step 5: Disconnect the fuel pressure line (5).

**Figure C****Refer to Figure C for Step 6**

Step 6: Using the 10mm nut driver, loosen the two hose clamps ⑥ on either end of the factory intake tube and remove the entire tube assembly.



Figure D

Refer to Figure D for Step 7

Step 7: Disengage the two clips ⑦ on the front of the factory airbox and lift the lid.



Refer to Figure E for Steps 8-9

Step 8: Remove the factory engine air filter and replace it with the aFe POWER Magnum FLOW air filter.

Step 9: Replace the top of the factory airbox and re-engage the clips.

**Figure F****Refer to Figure F for Step 10**

Step 10: Using the 10mm nut driver, remove the two screws holding the MAP Sensor (8). Leave the ASV line attached to the MAP sensor.

Figure G

Refer to Figure G for Steps 11-13

Step 11: Transfer the MAP sensor (9) to the aFe Power Super Stock tube. Secure using the provided M6 screws and washers.

Step 12: Secure the brass hose fitting (10) to the tube using the ½" wrench.

Step 13: Install the supplied bellows coupler, (11) elbow coupler (12), and hose clamps #048 (13) as shown above. Leave the hose clamps loose.

**Figure H****Refer to Figure H for Step 14**

Step 14: Install the aFe POWER intake tube by connecting it to the throttle body at the elbow coupler (14). Then, secure the bellows coupler (15) to the factory airbox. Ensure that the PCV hose port is properly aligned with the PCV hose. Use the hose clamps #048 to secure both couplers to the throttle body and factory airbox. Finally, tighten all four hose clamps using an 8mm nut driver.

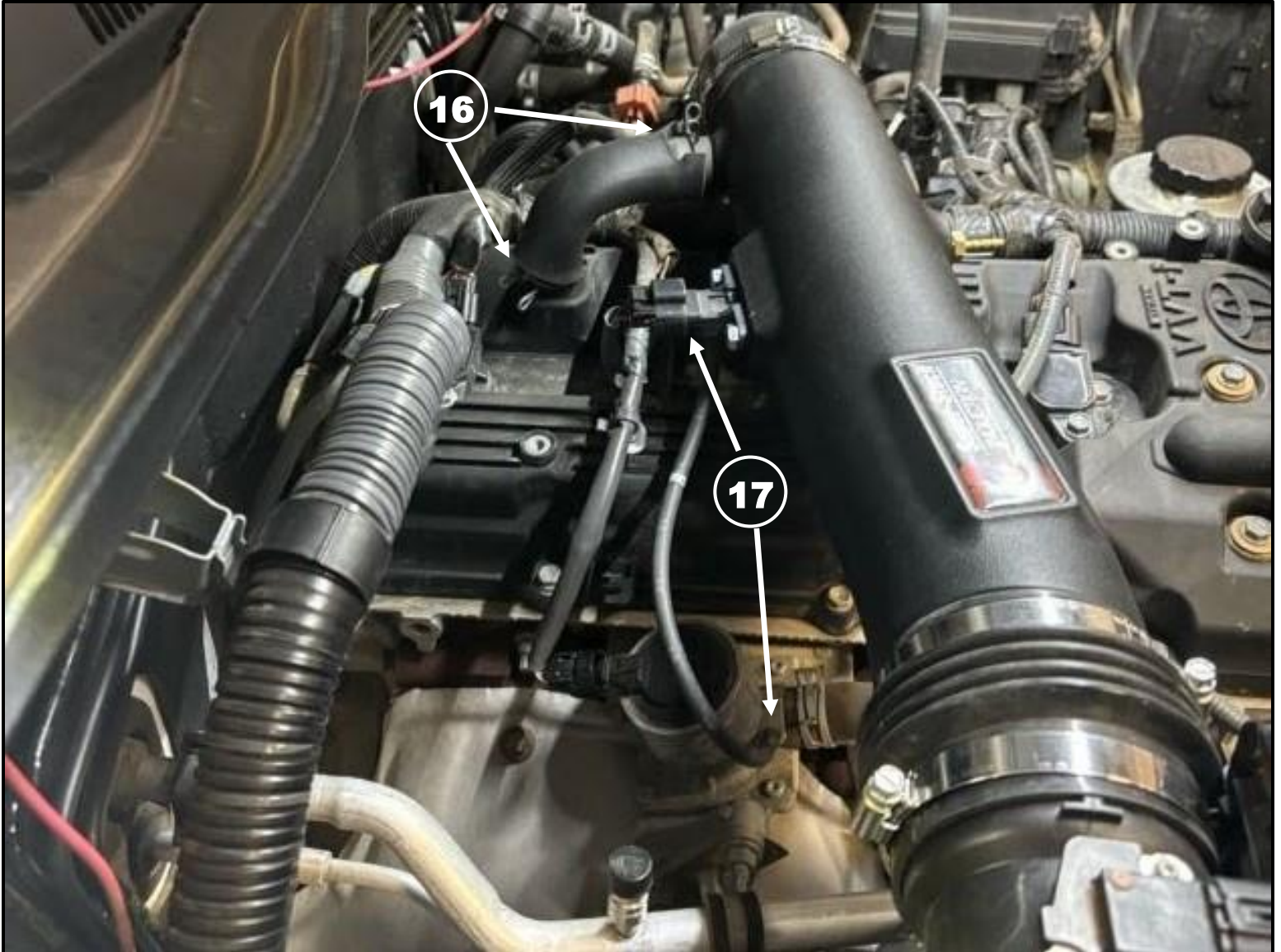

Refer to Figure I for Steps 15-16

INSTALL

Step 15: Secure the PCV hose (16). Be sure both ends of the PCV hose are secure.

Step 16: Reconnect the MAP sensor connector (17) and the ASV line.



Refer to Figure J for Step 17

INSTALL

Step 17: Install the provided vacuum hose (18) from the brass fitting to the fuel pressure regulator.

**Figure K****Refer to Figure K for Step 18**

Step 18: Check all the components are tight and secure. Your installation is now complete. Thank you for choosing aFe POWER!

NOTE: Check all bolts, clamps, and connectors after 100-200 miles.



Page left blank intentionally

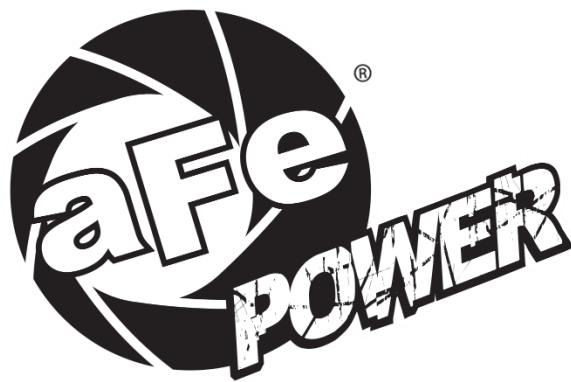

advanced FLOW engineering, inc.

Corona, CA 92879

<https://afepower.com/contact>