

advanced FLOW engineering

Cold Air Intake System

Instruction Manual P/N: 53-10034D

Make: FORD

Model: F-150

Year: 2015-2020

Engine: V8-5.0L



- Please read the entire instruction manual before proceeding.
- Ensure all components listed are present.
- If you are missing any of the components, call customer support at 951-493-7185.
- Ensure you have all necessary tools before proceeding.
- Do not attempt to work on your vehicle when the engine is hot.
- Retain factory parts for future use.

Label	Qty.	Description	Part Number
A	1	Air Filter (Pro DRY S)	21-90105
B	1	Tube, Rotomold	05-5310010B1
C	1	Housing, Rotomold	05-53112B2
D	1	Coupling, Silicone Elbow	05-01344
E	1	Coupling, Silicone Bellow	05-01456
F	2	Clamp, 080	03-50011
G	1	Clamp, 064	03-50006
H	1	Clamp, 056	03-50009
J	1	Fitting, Aluminum: Large	05-01339
K	1	Fitting, Aluminum: Small	05-01338
M	1	Plug, Housing	05-00937
N	1	Scoop, Rotomold	05-5210010B3
P	1	Screw, Hex Hd: M6	03-50057
Q	1	Washer, Flat: M6	03-50070
R	2	Retainer Clip, Christmas Tree Style	03-50773

Installation will require the following tools:

8mm, 13mm nut driver or socket and extension, Flat screwdriver #2 Phillips screwdriver, pliers.

Warranty Information available at: <https://afepower.com/contact#warranty>

Emissions Disclaimer: This product is not currently CARB exempt and is not available for purchase in California or for use on any vehicle registered with the California Department of Motor Vehicles.

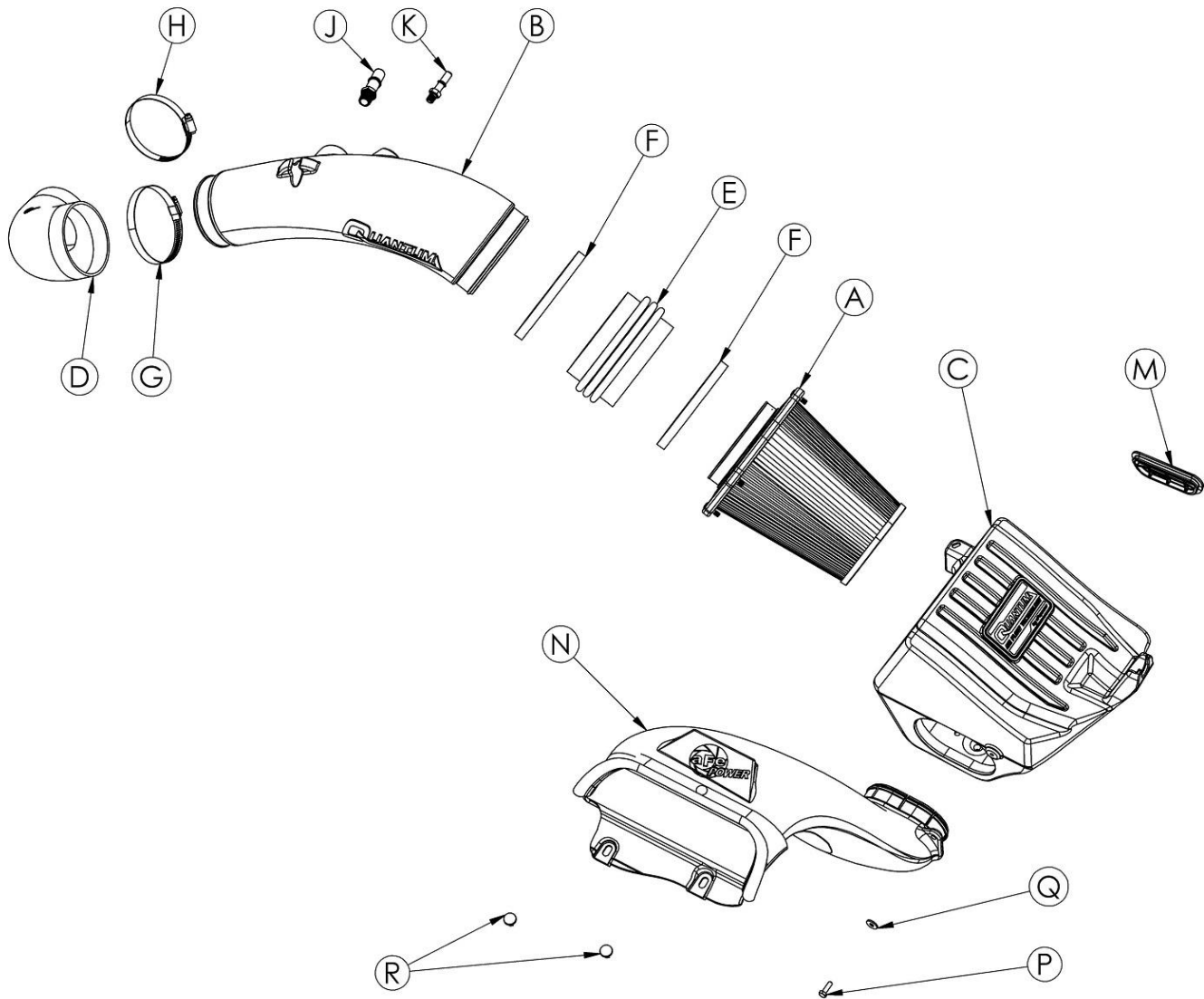

**Figure A****Refer to Figure A for Steps 1-5**

Step 1: Pull the coolant hose from the tube.

Step 2: Disconnect the two crankcase breather lines from the tube.

Step 3: Loosen the two clamps on the air intake tube. Pull the tube out of the truck.

Step 4: Remove the screw and the two plastic rivets securing the housing, then pull the factory airbox out of the truck.

Step 5: Unclip the harness attached to the airbox if present.



Figure B

Refer to Figure B for Steps 6-7

Step 6: Install the aFe POWER scoop into the housing and secure it with the provided screw and washer.

Step 7: Transfer the grommet and sleeve from the factory housing to the Quantum housing.

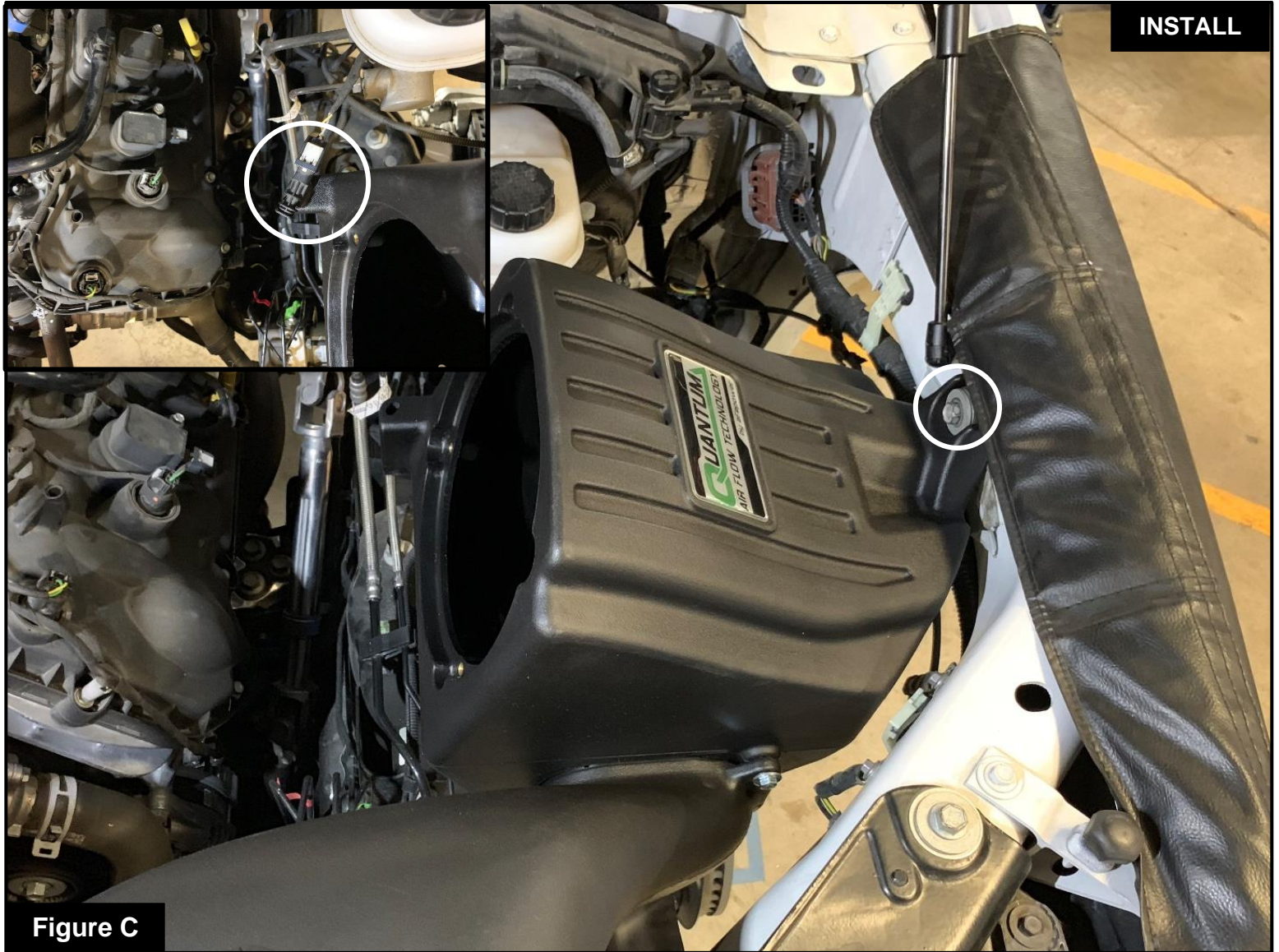

Figure C

Refer to Figure C for Steps 8-9

Step 8: Install the Quantum housing into the vehicle by pushing it into the factory grommet, and attach the factory harness to the housing if your vehicle is equipped with one.

Step 9: Secure the housing to the fender using the factory screw removed at Step 4.

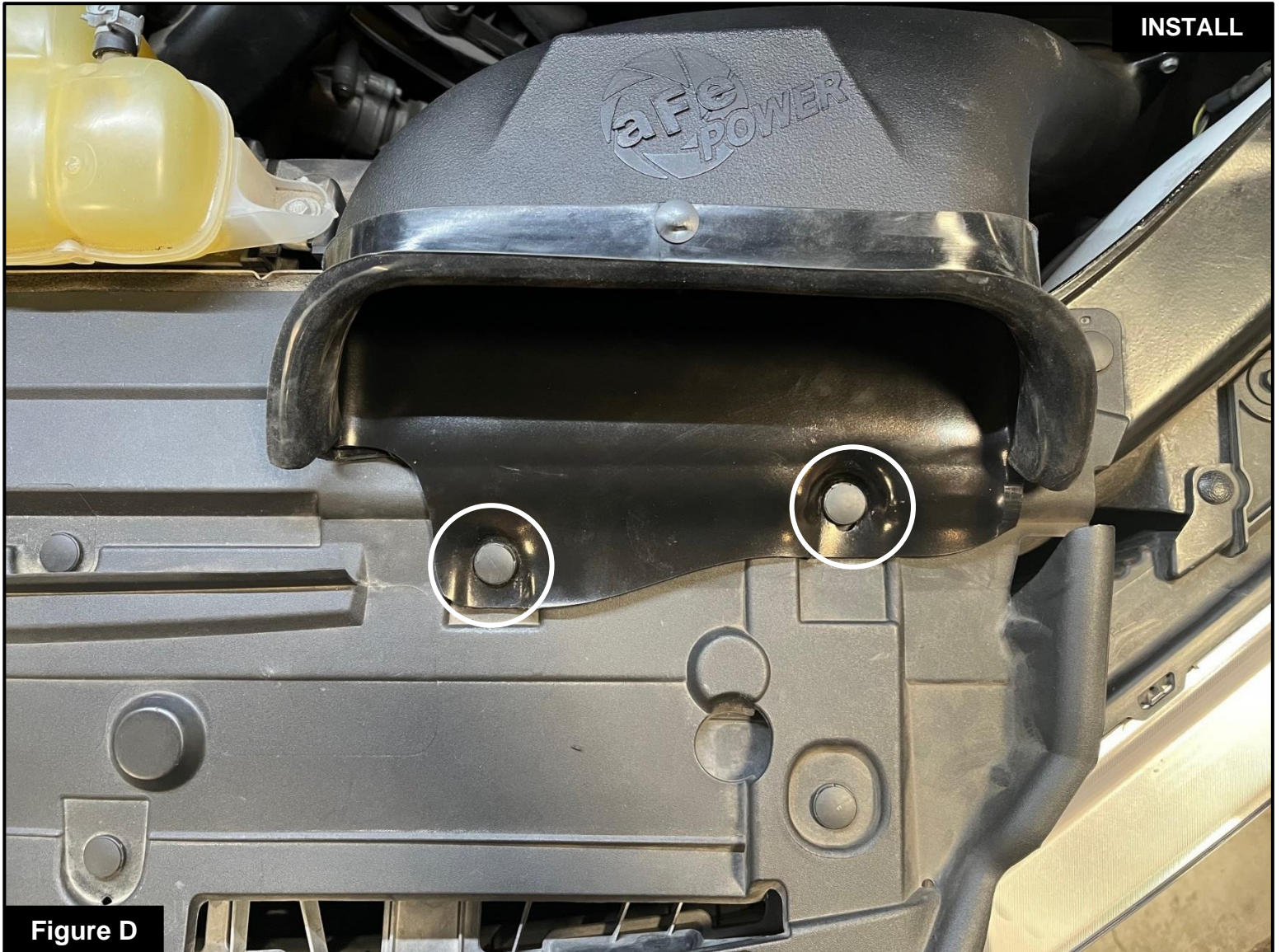

Figure D

Refer to Figure D for Step 10

Step 10: Secure the aFe POWER scoop with the provided plastic retainer clips.



Figure E

Refer to Figure E for Step 11-12

Step 12: Slide the Quantum air filter into the housing. Secure it by tightening the four screws with a #2 Phillips screwdriver.

Step 13: Install couplings and clamps onto throttle body and air filter. Do not tighten clamps yet



Figure F

Refer to Figure F for Step 14

Step 14: Screw the two provided vent fittings into the Quantum tube as shown. This is an NPT fitting. The small gap between the tube and the hex is normal, do not overtighten.

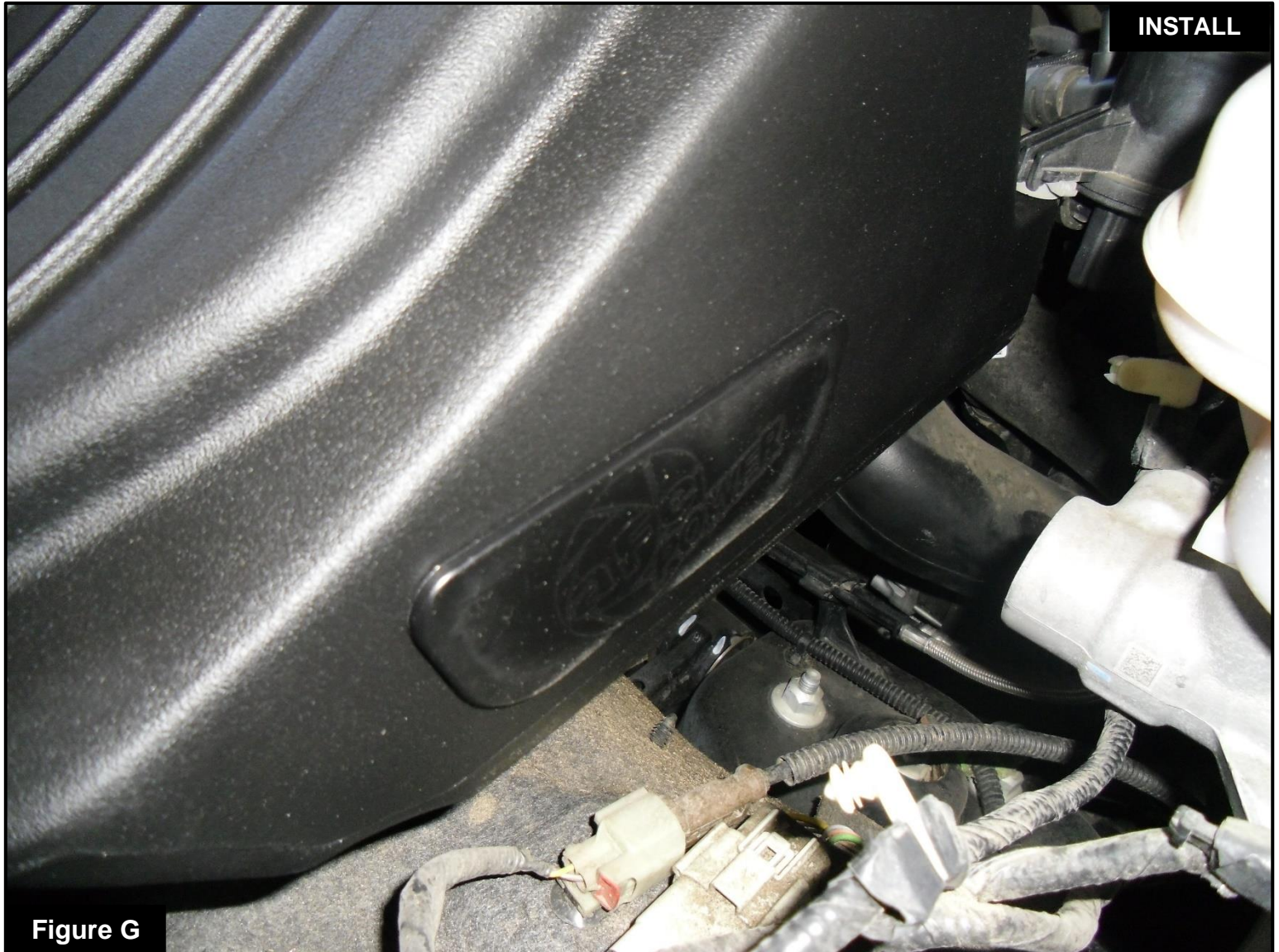

Figure G

Refer to Figure G for Step 15

Step 15: The kit includes an optional plug to close off the back auxiliary air inlet. Install the plug if you wish to close off the back auxiliary air inlet and only capture cold air from the front of the vehicle.

- Without the plug installed, the aFe POWER intake will capture the maximum air available. More airflow offers more power. Yet some of this air is picked up from inside the engine compartment and could be warmer air. Warmer air will affect the performance of the vehicle.
- The plug installed on the housing will block off any hot engine air entering the housing and make sure the coolest air available is directed into the engine. It will also reduce the noise of the intake.



Figure H

Refer to Figure H for Steps 16-19

Step 16: Install the Quantum tube in the truck by sliding the tube into the coupling in the throttle body then into the coupling on the air filter.

Step 17: Align tube correctly then tighten all clamps.

Step 18: Reconnect the crankcase breather lines and secure coolant hose on tube.

Step 19: Verify all connections are secured. The installation is now complete, enjoy your Quantum air intake system.



advanced FLOW engineering, Inc.

Corona, CA 92879

<https://afepower.com/contact>