

Intake Kit Installation Instructions: 2010 Chevrolet Camaro SS V8-6.2L



UXj UbvW'X: @CK `Yb[bYYf]b[™
 P.O. Box 1719
 Corona, CA 92878
 Support: 951-493-7100
 aFepower.com

Kit Part #	51/54-11762 Stage 2	Tools Required:	Part List:	
Make:	Chevrolet	5/16" nut driver or slotted screwdriver	1 Air filter Dfc! F™ 24-91040 or	1 Nut, 1/4-20x1
Model	Year	4mm Allen Wrench	Dfc! 8fmG™ 21-90053	1 Coupling, straight (05-01460)
Camaro SS	2010	T20 Torx Bit	1 Air filter adapter	1 Coupling, hump (05-01462)
	Engine		3 M6x10 button head screws	4 Clamps #064
	V8-6.2L		1 Tube	1 Gasket
			1 Housing	1 Torx Bit
			1 Trim seal 25"	1 Plastic Spacer
			1 Screw, 1/4-20x1	
			2 Screws, M4 x .7 x 16mm 18-8 S/S	



Complete stock intake system.



Remove nut from right side of air filter housing.



Remove nut from rear of air filter housing.



Loosen air intake tube clamp at throttle body inlet.

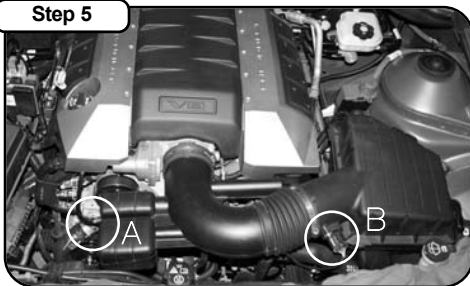

Firmly pull breather line out from air intake tube location shown in figure A.

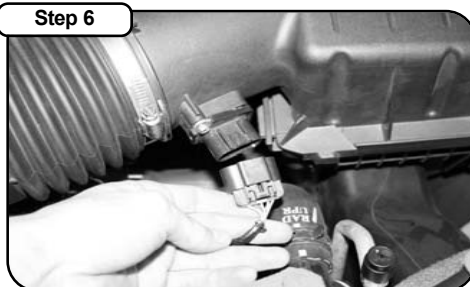

Unplug electrical harness from MAF sensor, location shown in figure B on step 5.



Disconnect air intake tube from throttle body.



Remove complete factory intake system assembly from vehicle.

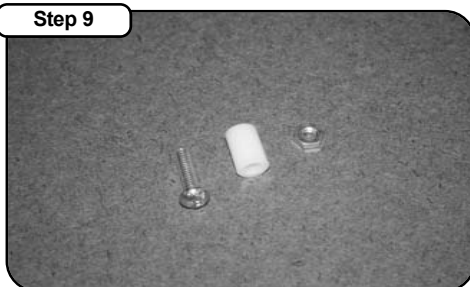

View of lower housing mount parts (screw, nylon spacer, nut).

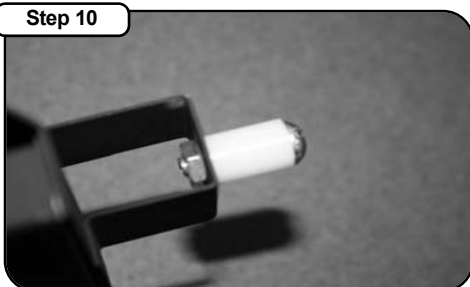

View of mount installed in housing.



Remove MAF sensor from stock air intake tube.



Remove white backing material and attach supplied gasket to aFe air intake tube.

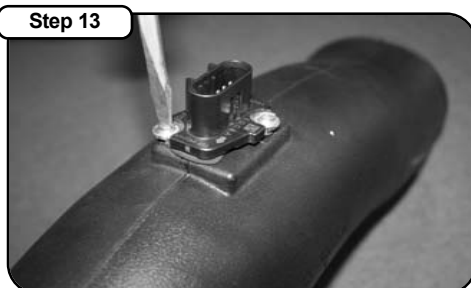

Install MAF sensor in aFe air intake tube using supplied M4 screws.



Install air filter adapter on aFe housing.

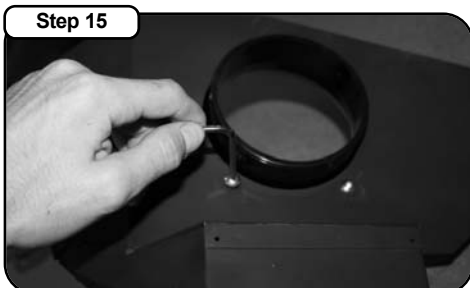

Secure air filter adapter to housing using supplied button-head screws.

Note: Filter Cleaning and Re-oiling: When cleaning your aFe filter, be sure to use only aFe's "Restore Kit" (aFe P/N: 90-50001 blue oil aerosol, aFe P/N: 90-50501 blue squeeze bottle oil, or aFe P/N: 90-59999 Pro-Dry S Cleaner)
 Filter Replacement: P/N: **Dfc!** F™ #24-91040 (black w/blue media) or **Dfc!** 8fmG™ #21-90053 (black w/white media)

Intake Kit Installation Instructions: 2010 Chevrolet Camaro SS V8-6.2L



UXj UbvWX: @CK Yb[bYYf]b[™
 P.O. Box 1719
 Corona, CA 92878
 Support: 951-493-7100
 aFepower.com

Accessories Available:



Restore Kits

90-50001 Blue Aerosol
 90-50501 Blue Squeeze
 90-59999 Pro Dry S™ Cleaner

Replacement Air Filter:



Dfc!) F™ 24-91040
 61 Y'AYXU''



Dfc'8fmG™ 21-90053
 K \JY'AYXU''

Note: Filter Cleaning and Re-oiling: When cleaning your aFe filter, be sure to use only aFe's "Restore Kit" (aFe P/N: 90-50001 blue oil aerosol, aFe P/N: 90-50501 blue squeeze bottle oil, aFe P/N: 90-59999 Dfc'8fmG™ cleaner only.) Dfc'8fmG™ cleaning: see cleaning instruction sheet 06-00074. For replacement part(s) or "Restore Kit" please call aFe sales/tech support @ 951-493-7100

Step 16



Install supplied trim seal on housing

Step 17

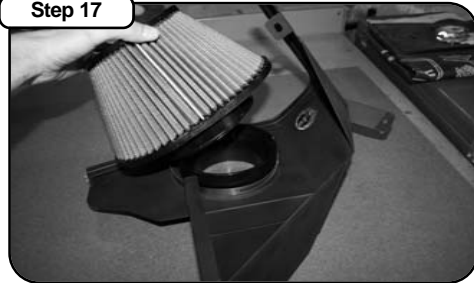

Install air filter on adapter.

Step 18

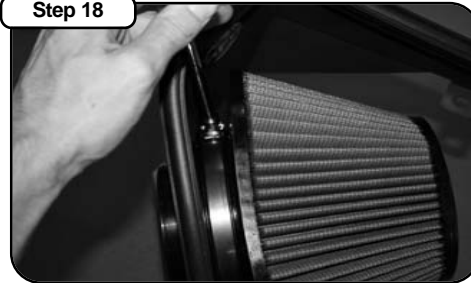

Tighten clamp to secure air filter to adapter.

Step 19



Remove air inlet duct from factory housing.

Step 20



Insert factory air inlet duct into aFe housing.

Step 21



Install aFe housing into vehicle.

Step 22

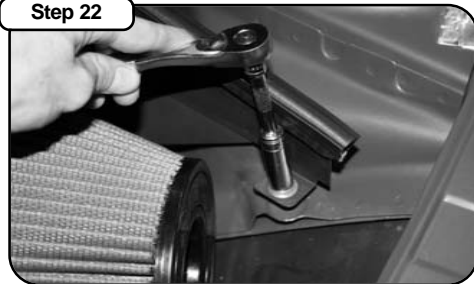

Install nuts removed in steps 2 and 3 in factory mounting locations.

Step 23

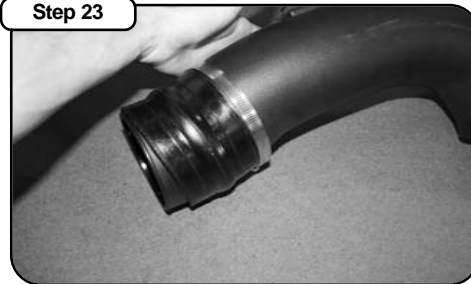

Slip on the supplied hump coupling onto the air intake tube and position clamps (2), do not tighten.

Step 24



Install straight coupling and clamps (2) on throttle body inlet. Tighten clamp over throttle body.

Step 25



Connect aFe air intake tube to throttle body coupling.

Step 26



Tighten throttle body coupling clamps.

Step 27



Connect aFe air intake tube to air filter adapter by sliding the loose coupling over to the right and tighten clamps.

Step 28



Insert breather line into aFe air intake tube.

Step 29



Plug electrical harness into MAF sensor.

Step 28



Installation complete