

advanced FLOW engineering

Momentum GT Air Intake System

Instruction Manual P/N: 50-70127DN

Make: TOYOTA	Model: LAND CRUISER (J250)	Year: 2024-2025	Engine: L4-2.4L(t)
Make: TOYOTA	Model: LAND CRUISER Prado (J250)	Year: 2024-2025	Engine: L4-2.4L(t)



- Please read the entire instruction manual before proceeding.
- Ensure all components listed are present.
- If you are missing any of the components, call customer support at 951-493-7185.
- Ensure you have all necessary tools before proceeding.
- Do not attempt to work on your vehicle when the engine is hot.
- Retain factory parts for future use.

Label	Qty.	Description	Part Number
A	1	Air Filter, PDS	21-91153
B	1	Tube With MAF Sensor Pad (Orange)	05-5070119N1
C	1	Housing With Clear Sight Window (Orange)	05-5070127N2
D	1	Coupler, Silicone Bellow: (2-3/4" x 3"ID) x 3"L	05-01528
E	1	Clamp, 048 (2-9/16" - 3-1/2")	03-50007
F	1	Clamp, 044 (2-5/16" - 3-1/4")	03-50019
G	5	Push-in Rivet, Christmas Tree Style	03-50616
H	1	Gasket, Inlet Fender	05-01762
J	1	Alcohol Wipes	05-01716
K	2	Screw, Torx: M4 x .7 x 10mm	03-50490
M	1	Cable tie	05-60167

Installation will require the following tools: T20 Torx bit, small flat head screwdriver, Phillips screwdriver, Pry tool, 8mm socket or nut driver, 10mm socket or nut driver.

Warranty Information available at <https://afepower.com/contact#warranty>

Emissions Disclaimer: This product is not currently CARB exempt and is not available for purchase in California or for use on any vehicle registered with the California Department of Motor Vehicles.

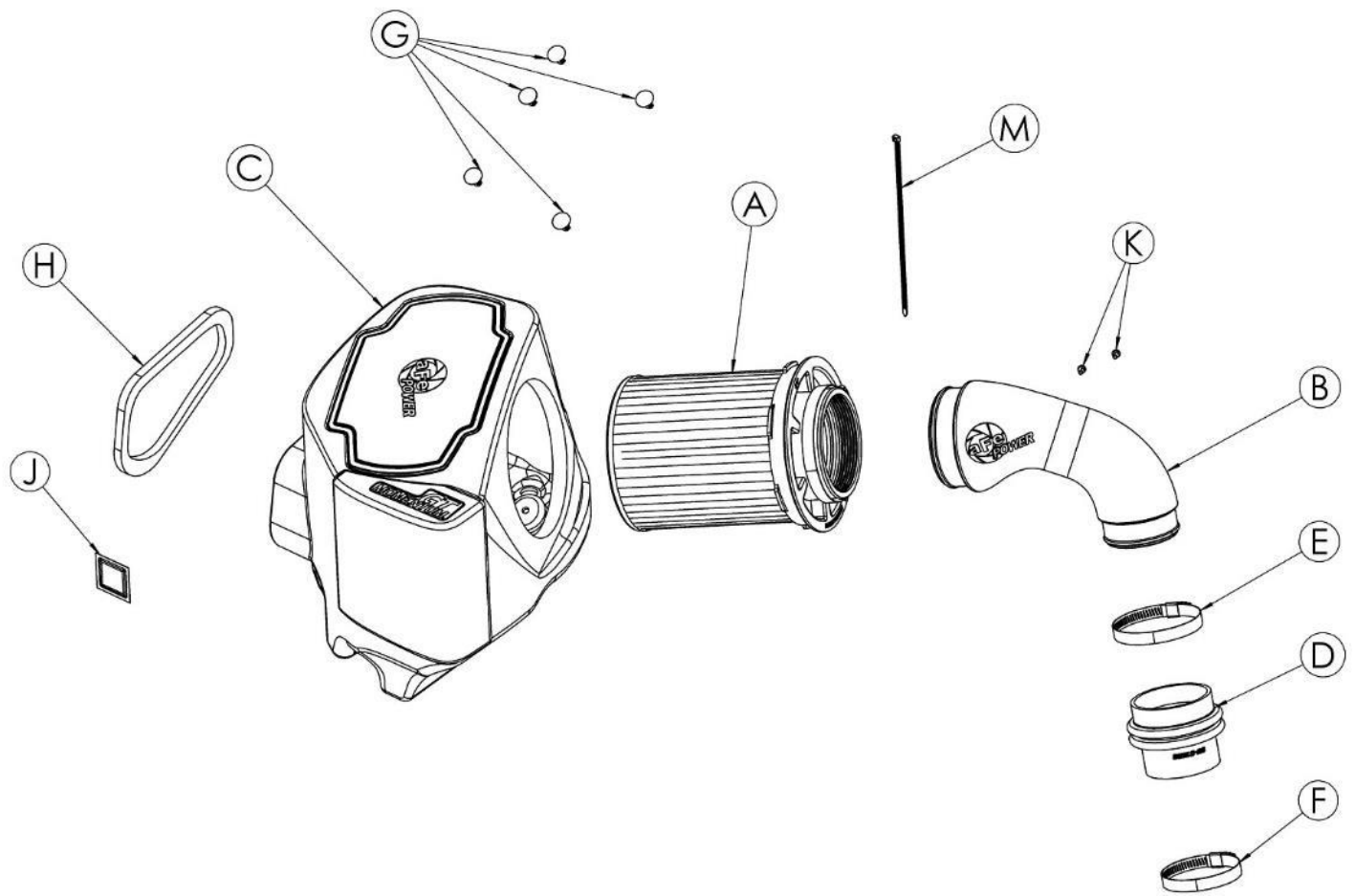

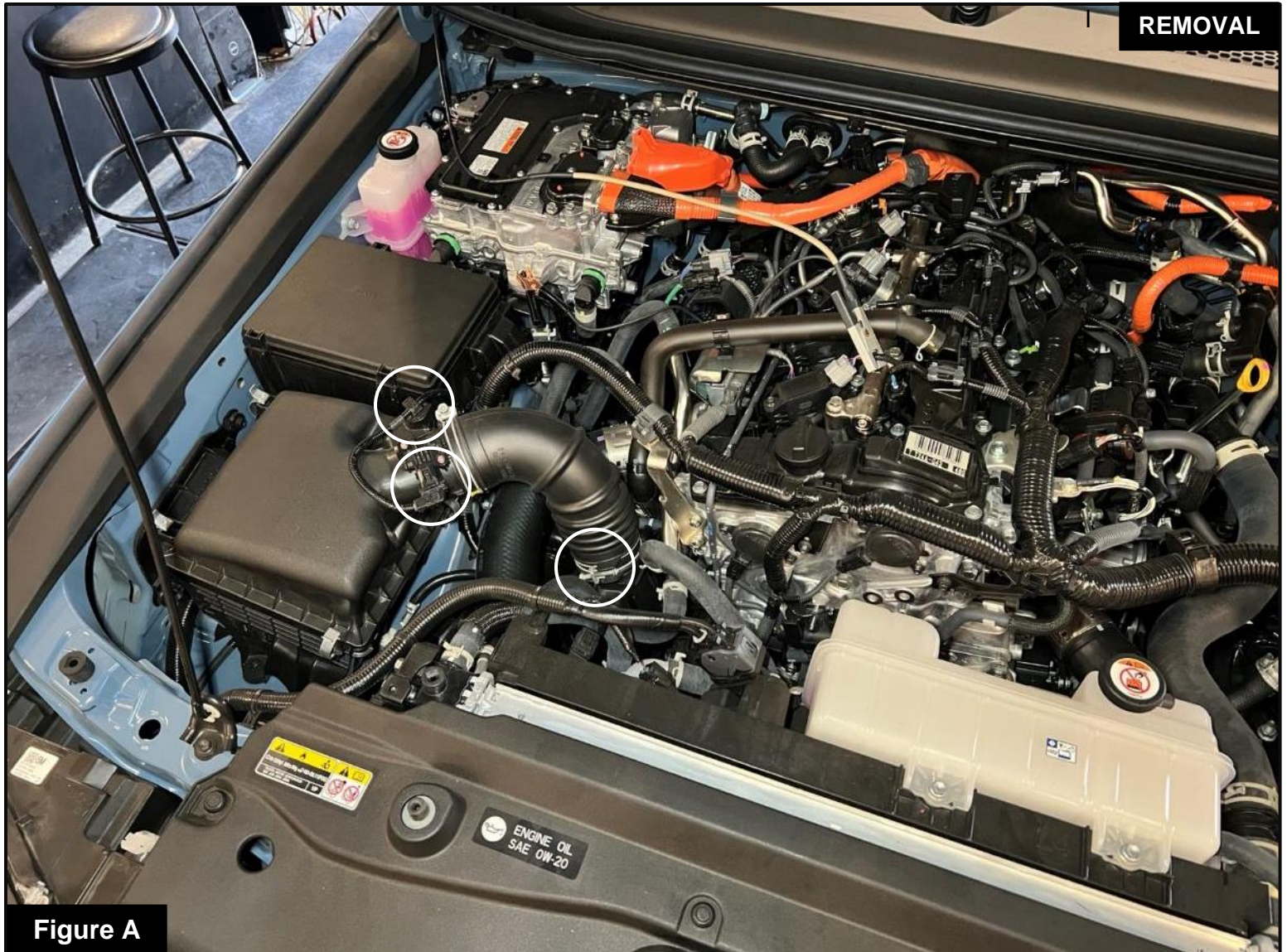

Figure A

Refer to Figure A for Steps 1-3

Step 1: Disconnect the harness from the Mass Air Flow (MAF) sensor and unclip the factory MAF harness from the factory airbox.

Step 2: Using a 10mm nut driver, loosen the clamp connecting the factory inlet to the turbo inlet.

Step 3: Lift the factory air intake assembly from the vehicle by firmly pulling on it to get the grommets out of the mounts.



Figure B

Refer to Figure B for Step 4

Step 4: Using a 10mm socket, loosen the (2) two bolts securing the fender inlet scoop and remove it out of the vehicle.

**Figure C****Refer to Figure C for Step 5**

Step 5: Using a phillips screwdriver, remove the Mass Air Flow (MAF) sensor from the factory airbox.

**Figure D****Refer to Figure D for Step 6**

Step 6: Transfer the MAF sensor from the factory airbox to the aFe POWER intake tube and secure it using the provided T20 Torx M4 screws.



Refer to Figure E for Step 7

Step 7: Remove the (3) three grommets from the bottom of the factory airbox.

**Figure F****Refer to Figure F for Step 8**

Step 8: Unlatch the (4) four clips securing the top of the factory airbox, and then remove the top portion of the airbox.



Figure G

Refer to Figure G for Step 9

Step 9: Using a pry tool, remove the (5) five clips holding down the charcoal pouch.

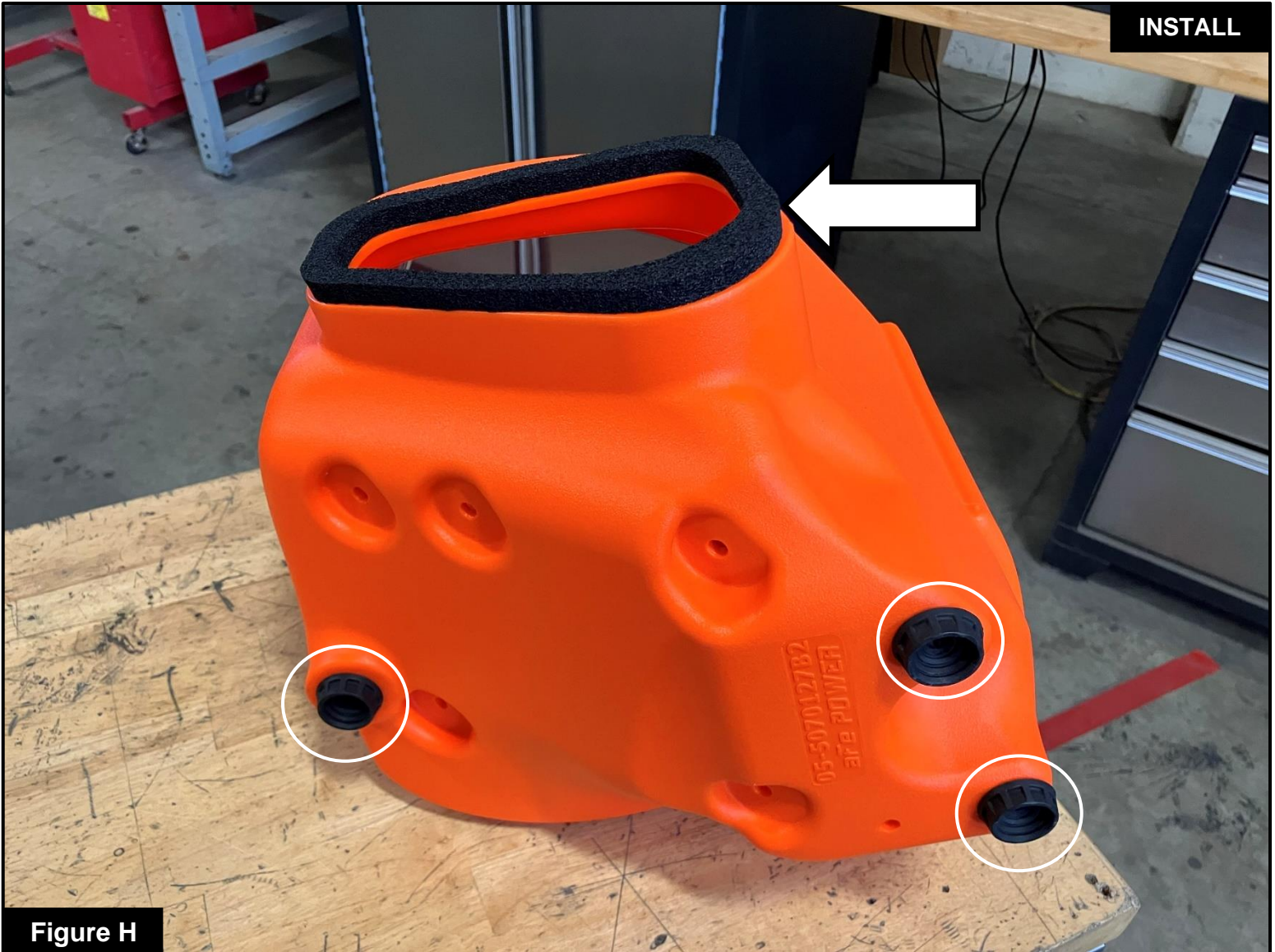
**Figure H****Refer to Figure H for Steps 11-12**

Step 11: Transfer the factory grommets onto the bottom of the aFe POWER airbox.

Step 12: Wipe the non-textured surface of the side air inlet of the aFe POWER housing with the provided cleaning wipe to remove any residual mold release. Wait for the alcohol to evaporate, then apply the foam gasket onto the surface of the fender inlet opening.

**Figure I****Refer to Figure I for Step 13**

Step 13: Install the (5) five provided push clips to secure the charcoal pouch onto the inside of the aFe POWER airbox.

**Figure J****Refer to Figure J for Step 14**

Step 14: Install the aFe POWER air filter into the housing by firmly pushing it into the housing until the filter tabs lock it into place. Install the clamp onto the filter, but do not tighten at this time.



Figure K

Refer to Figure K for Steps 15-16

Step 15: Install the aFe POWER air box into the vehicle. Make sure the housing is secured onto the 3 mounting pegs.

Step 16: Loosely install the clamps onto the aFe POWER coupler, and then install the coupler onto the turbo inlet as shown. Do not tighten the clamps at this time.

**Figure L****Refer to Figure L for Steps 17-18**

Step 17: Install the aFe POWER intake tube between the coupler and filter. Align the tube and coupler, then tighten all clamps.

Step 18: Reconnect the MAF sensor harness to the MAF sensor and secure the harness with the provided cable tie.

Your installation is now complete. Verify that all connections and screws are secured.

Thank you for choosing aFe POWER!



advanced FLOW engineering, Inc.

Corona, CA 92879

<https://afepower.com/contact>