

MOMENTUM *GT*

advanced FLOW engineering Momentum GT Cold Air Intake System

Instruction Manual P/N: 50-70055D / 50-70055R

Make: Chevrolet Model: Silverado 2500HD/3500HD Year: 2020-2021 Engine: V8-6.6L (L8T)
Make: GMC Model: Sierra 2500HD/3500HD Year: 2020-2021 Engine: V8-6.6L (L8T)



- Please read the entire instruction manual before proceeding.
- Ensure all components listed are present.
- For technical support please call 951-493-7185.
- Ensure you have all necessary tools before proceeding.
- Do not attempt to work on your vehicle when the engine is hot.
- Retain factory parts for future use.

Label	Qty.	Description	Part Number
A1	1	Air Filter (Pro 5R)	24-91147
A2	1	Air Filter (Pro DRY S)	21-91147
B	1	Tube	05-5070055B1
C	1	Housing	05-5070055B2
D	1	Coupling, Silicone Bellows	05-01536
E	2	Clamp, T-bolt (3-13/16" - 4-1/8")	03-50265
F	1	Fitting, Vent Tube	05-01339
G	1	Fixing Clamp, 3/4"ID	03-50234
H	1	Clamp, T-bolt (8-5/16" - 8-5/8")	03-50267
I	1	Plug, Silicone	05-01429
J	2	Screw, Torx: M4x10mm	03-50490
K	2	Screw, Hex Hd: M6x1x20mm	03-50057
L	2	Washer, Flat: M6	03-50070

Installation will require the following tools:

Panel clip remover, T20 Torx driver, 8mm & 10mm nut drivers, 10mm & 20mm wrenches, 10mm & 11mm deep socket and driver

Emissions Disclaimer: This product is not currently CARB exempt and is not available for purchase in California or for use on any vehicle registered with the California Department of Motor Vehicles.

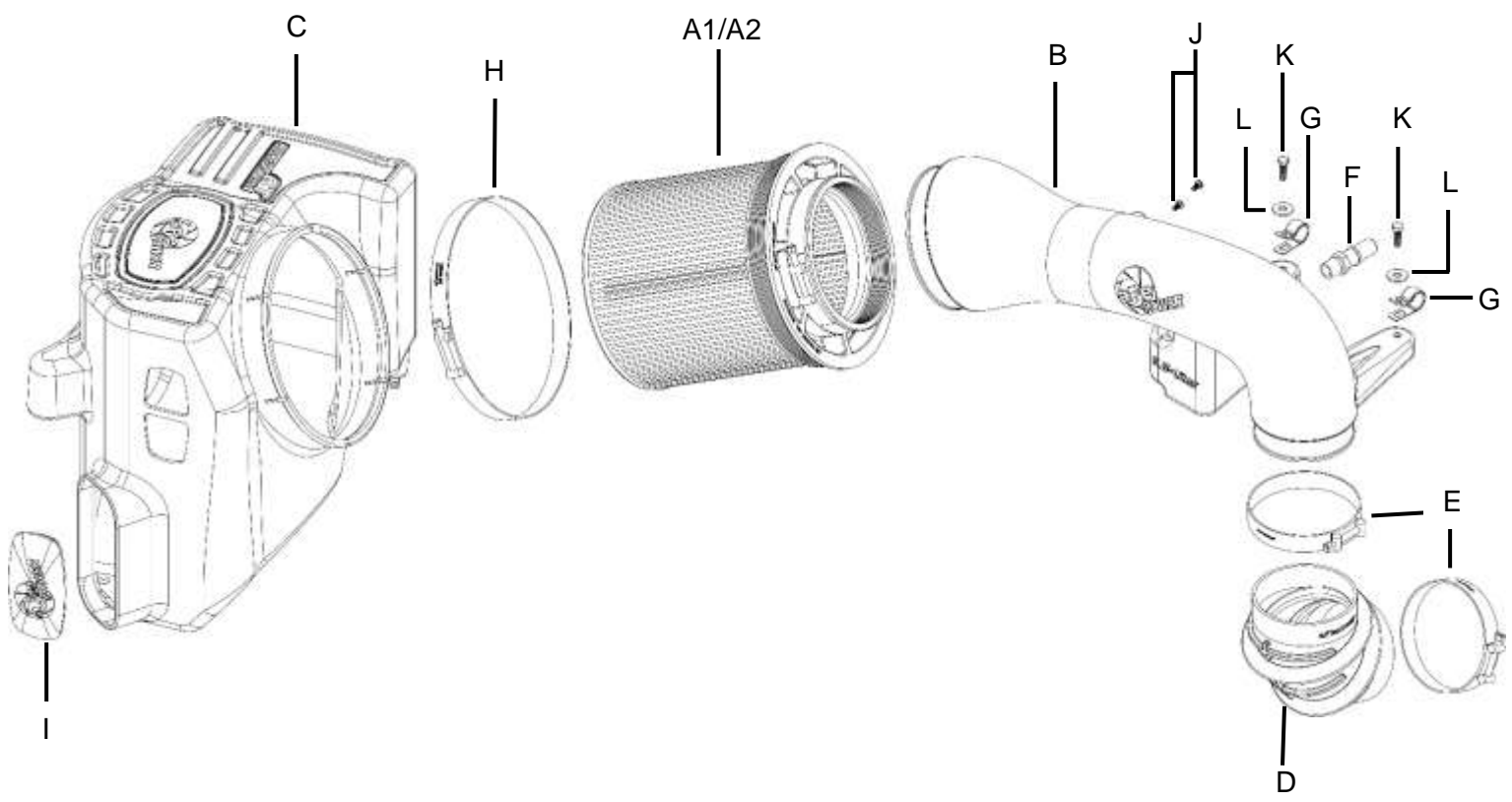

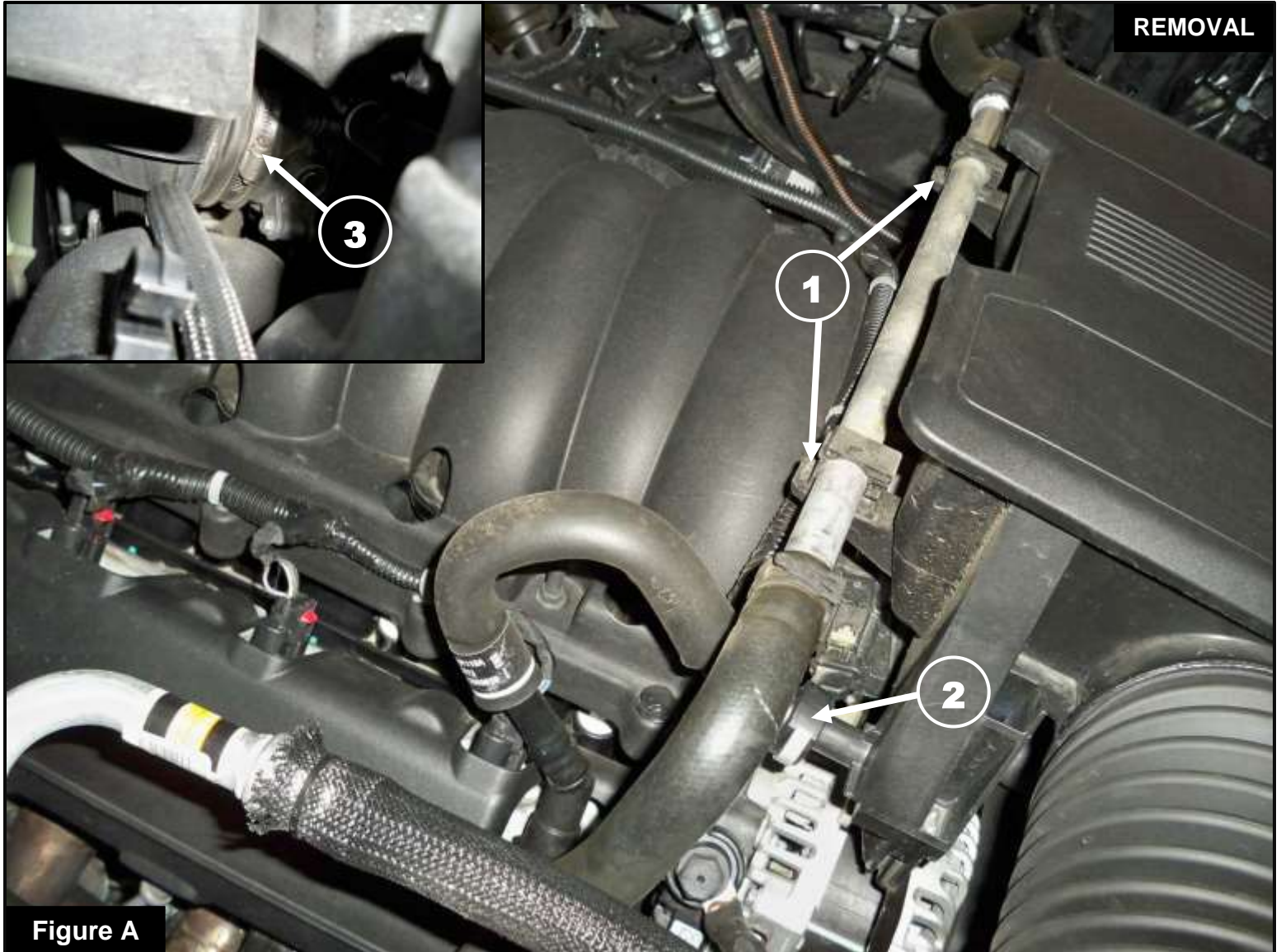

Refer to Figure A for Steps 1-3

Step 1: Using a panel clip remover, remove the retaining plastic clips ① holding the coolant line on top of the factory intake tube assembly.

Step 2: Disconnect the crankcase breather hose ②.

Step 3: Using an 8mm nut driver, loosen the hose clamp ③ at the throttle body.

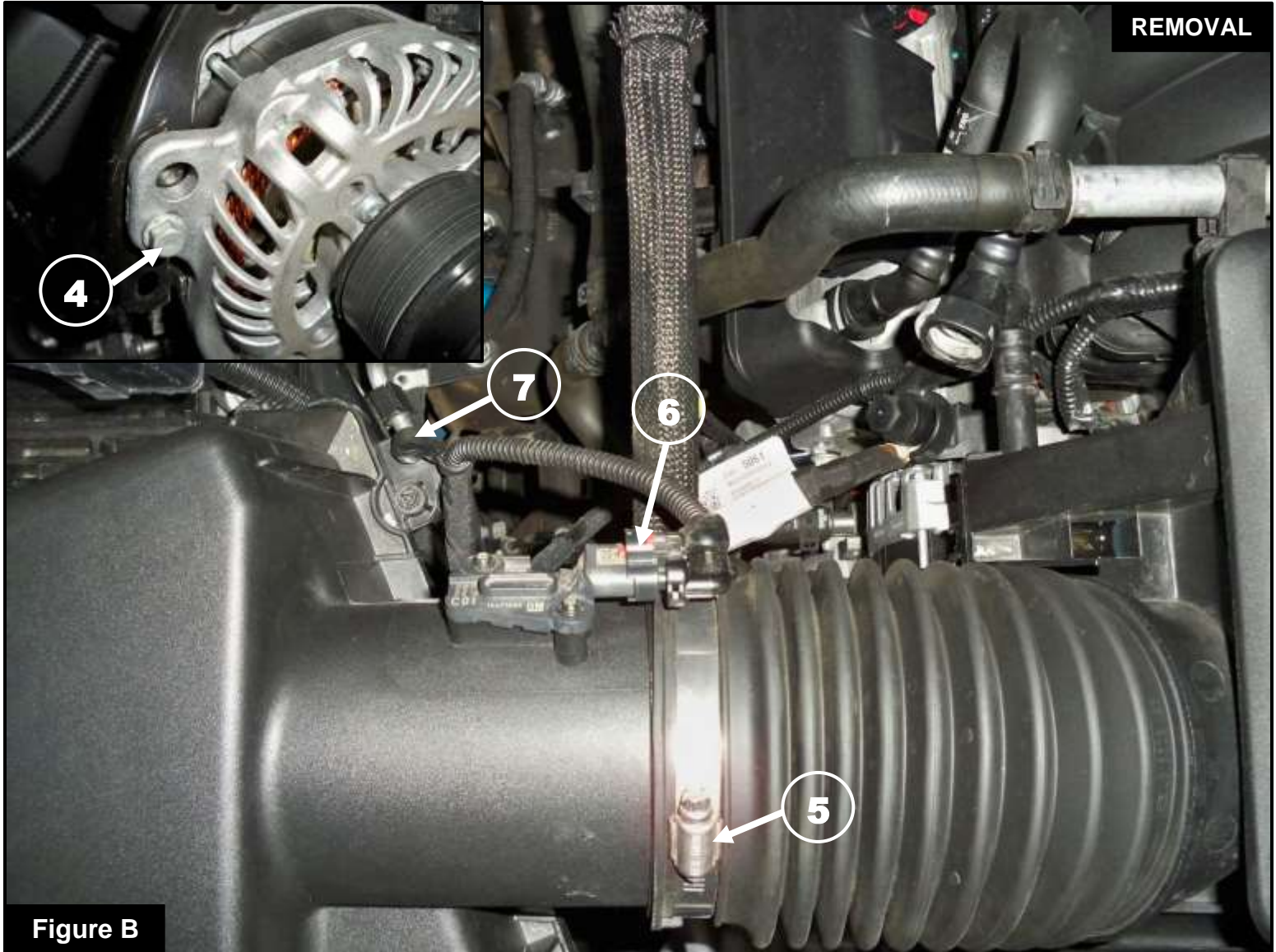

Refer to Figure B for Steps 4-7

- Step 4: Using a 10mm socket and driver, remove the screw (4) attaching the intake tube bracket to the alternator. Also remove any wiring harnesses if attached to the bracket.
- Step 5: Using an 8mm nut driver, loosen the hose clamp (5) at the factory airbox.
- Step 6: Disconnect the MAF sensor (6) and the clip (7) holding the harness.
- Step 7: Remove the factory intake tube assembly and put aside.



Refer to Figure C for Steps 8-9

Step 8: Using a 10mm deep socket and driver, remove the nut (8) holding the factory airbox to the fender and set the nut aside for later use.

Step 9: Remove the factory airbox by pulling it straight up from its mounting grommets. If the grommets (9) are pulled out with the factory airbox, remove them and put them back on the bracket holes.



Figure D

Refer to Figure D for Step 10

Step 10: Remove the metal insert and grommet (10) from the factory airbox and install them into the aFe POWER housing.



Refer to Figure E for Steps 11-13

Step 11: Install the aFe POWER housing on to vehicle. Make sure the mounting pins are fully seated in the mounting grommets.

Step 12: From the inside of the aFe POWER housing, use a 10mm wrench to reinstall and tighten the nut ⑪ removed in Step 8.

Step 13: Make sure the air inlet scoop ⑫ is inside the front opening of the aFe POWER housing.



Figure F

Refer to Figure F for Steps 14-15

Step 14: Slide the large T-Bolt clamp (10) over the air filter opening on the aFe POWER housing.

Step 15: Slide the aFe POWER filter with clamp into the housing. Do not tighten the clamps.

**Figure G****Refer to Figure G for Steps 16-17**

Step 16: Place the supplied aFe POWER coupling (14) and one of the T-Bolt clamps (15) over the throttle body. Do not tighten.

Step 17: Place the other T-Bolt clamp (16) on the installed coupling. Do not tighten.



Figure H

Refer to Figure H for Steps 18-19

Step 18: Using a T20 Torx driver, remove the MAF sensor (17) from the factory housing and install it on the aFe POWER intake tube using the supplied M4 screws.

Step 19: Using a 20mm wrench, install the supplied aluminum vent fitting (18) into the aFe POWER intake tube.

**Figure I**

Refer to Figure I for Steps 20-21

Step 20: Install the aFe POWER intake tube into the vehicle. Slide the tube into the throttle body coupling first, then into the air filter.

Step 21: Align the coupler, intake tube and clamps correctly, then using a 11mm deep socket and driver tighten all the clamps (19).



Figure J

Refer to Figure J for Steps 22-23

Step 22: Reconnect the crankcase breather hose (20).

Step 23: Reconnect the MAF sensor (21).



Figure K

Refer to Figure K for Step 24

Step 24: Use the provided plug (22) to close the additional air inlet if you want to completely seal the airbox.

Best performance gain is obtained by having more air flow (no plug).

**Figure L****Refer to Figure L for Steps 25-26**

Step 25: Secure the coolant hose to the aFe POWER intake tube with the provided fixing clamps, 6mm screws and washers⁽²³⁾. Using a 10mm nut driver, tighten the screws.

Step 26: Your installation is now complete. Thank you for choosing aFe POWER!

NOTE: Check all bolts, clamps, and connectors after 100-200 miles.



Page left blank intentionally



Page left blank intentionally



Pro DRY S Air Filter



P/N: 21-91147

Pro 5R Air Filter



P/N: 24-91147

Pro DRY S Restore Kit



P/N: 90-59999

Blue Squeeze Restore Kit



P/N: 90-50501

Pre-Filter



P/N: 28-10273

aFe Fender Cover



P/N: 40-10230

Sprint Booster V3



P/N: 77-14009

Differential Cover



P/N: 46-71260B

Twisted Steel Headers



P/N: 48-34145

Twisted Steel Y-Pipe



P/N: 48-34147-RC

Long Tube Headers & Y-Pipe

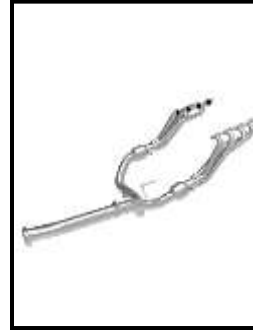

P/N: 48-34146-YC

Apollo GT Exhaust System



P/N: 49-44123-B (Blk. Tips)
49-44123-P (Pol. Tips)

To purchase any of the items above, view airflow charts, dyno graphs, photos, and video; please go to aFepower.com.



Warranty

General Terms:

- aFe warrants their products to be free from manufacturer's defects due to workmanship and material.
- This warranty applies only to the original purchaser of the product and is non-transferrable.
- Proof of purchase of the aFe product is required for all warranty claims.
- Warranty is valid provided aFe instructions for installation and/or cleaning were properly followed.
- Proper maintenance with regular inspections of product is required to insure warranty coverage.
- Damage due to improper installation, abuse, unauthorized repair or alteration is not warranted.
- Incidental or consequential damages or cost, including installation and removal of part, incurred due to failure of aFe product is not covered under this warranty.
- All warranty is limited to the repair and/or replacement of the aFe part. To request Return Goods Authorization ("RGA"), email RGA@afepower.com or call (951)493-7100. Upon receipt of the RGA, you must return the product to the address provided in the RGA, freight prepaid and accompanied with a dated proof of purchase and the RGA. Upon receipt of the defective product and upon verification of proof of purchase, aFe will either repair or replace the defective product within a reasonable time, not to exceed thirty days.

Product Category	P/N Prefix	Warranty duration
Direct OE Replacement Filters	10, 11, 30, 31, 71, 73	Life of the vehicle
Racing Filters	18	1 year
Universal	20, 21, 23, 24, 72, TF	2 years
Air Intake Systems	50, 51, 53, 54, 55, 56, 57, 58, 75, TR, TA, TL, TM	2 years
Exhaust Systems	49	2 years
Intercoolers & Intercooler Tubes	46-2	2 years
Intake Manifolds	46-1	2 years
Differential Cover	46-7	Life of the vehicle
Exhaust Manifolds	46	2 years
Throttle Body Spacers	46-3	2 years
Turbochargers	46-6	2 years*
Fluid Filters	44	90 days
Pre-Filters	28	2 years
Heavy Duty OE Replacement	70	2 years
PowerSports OE Replacement	81, 87	2 years
PowerSports Intake Systems	85	2 years

No other warranty expressed or implied applies nor is any person or advanced FLOW engineering authorized to assume any other warranty. Some States do not allow the exclusion or limitation of incidental or consequential damages or do not allow limitations on how long an implied warranty lasts, so the above limitations or exclusions may not apply to you. This warranty gives you specific legal rights, and you may also have other rights which vary from State to State.

*See turbocharger warranty for more info



advanced FLOW engineering, inc.

252 Granite Street Corona, CA 92879
TEL: 951.493.7100 • TECH: 951.493.7134
E-Mail: Tech@aFepower.com

P/N: 06-81341