



INSTALLATION INSTRUCTIONS

Cat/Axle/Turbo-Back Exhaust

MAKE: Toyota
MODEL: Tacoma
YEAR: 16-22
ENGINE: L4-2.7L, V6-3.5L

49-46063-B
49-46063-P

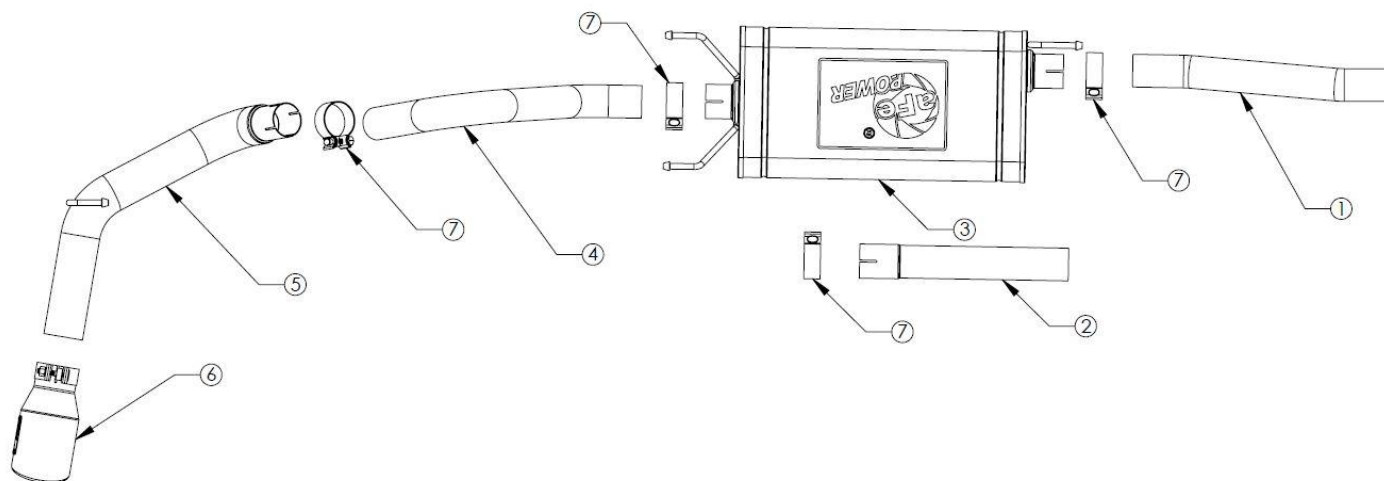

Item	Description	Part Number	Quantity
1	Front Pipe	05-244355	1
2	Extension Pipe	05-144230	1
3	Muffler Assembly	05-244356	1
4	Over-Axle	05-244357	1
5	Tail Pipe Assembly	05-244358	1
6	EXH Tip 3 In x 4-1/2 Out x 9L Black	49T30451-B09	1
6	EXH Tip 3 In x 4-1/2 Out x 9L Polished	49T30451-P09	1
7	Clamp, Band: 2-1/2"	05-41061	4

aFe POWER recommends professional installation on this product. Thoroughly inspect the aFe POWER exhaust system to make sure there is no damage from shipping (if damage is noted, immediately contact aFe POWER customer service). Allow time for your vehicle to cool down prior to installation. When working on your vehicle proceed with caution. Wear protective safety equipment; eye goggles and gloves to ensure a safe installation.

Install band clamps to proper torque specifications of 40-45 ft-lb.

Install V-band clamps with anti-seize lubricant and hand tighten only to torque specifications of 10-15 ft-lb.



INSTALLATION INSTRUCTIONS

Cat/Axle/Turbo-Back Exhaust

MAKE: Toyota
MODEL: Tacoma
YEAR: 16-22
ENGINE: L4-2.7L, V6-3.5L

49-46063-B

49-46063-P

1. **(Read instructions prior to installation.)** It is recommended to not fully tighten the exhaust until it has been fully installed. Leave loose for adjustability.
2. Secure vehicle on jack stands (refer to your manual for specified jack stand positions).
3. For faster installation, spread out the parts of the exhaust alongside your vehicle as shown in the diagram above.
4. Secure the stock exhaust with jack/stands.
5. Remove the OE Exhaust from the isolation mounts.
6. Remove the nuts and bolts securing the front of the OE exhaust system and remove it from the vehicle.
7. Install the aFe POWER front pipe using the OE hardware and gasket.
8. Determine your truck's wheelbase. For 127.8" wheelbase trucks, no extension pipe is needed. For 140.6" wheelbase trucks, install the extension pipe with the 2.5" band clamp.
9. Install the Muffler assembly using the provided 2.5" band clamp and insert the hangers into the OE isolators.
10. Install the Over-Axle onto the muffler assembly using the provided 2.5" band clamp.
11. Install the Tail Pipe onto the Over-Axle using the provided 2.5" band clamp and insert the hanger into the OE isolator.
12. Install the exhaust tip.
13. Ensure that all the components of the aFe POWER exhaust system are aligned and are at a safe clearance from all wires, hoses, brake lines, body parts, and tires.
14. Start from the front of the aFe exhaust system and evenly tighten all clamps and fasteners.
15. Start the vehicle and check for any leaks. If any leaks are found, determine cause and repair as necessary.
16. Remove vehicle from jacks stands.
17. It is recommended to re-tighten all clamps and hardware after 50-100 miles.