

# Rugged Ridge Roof Rack Basket, JL & JT

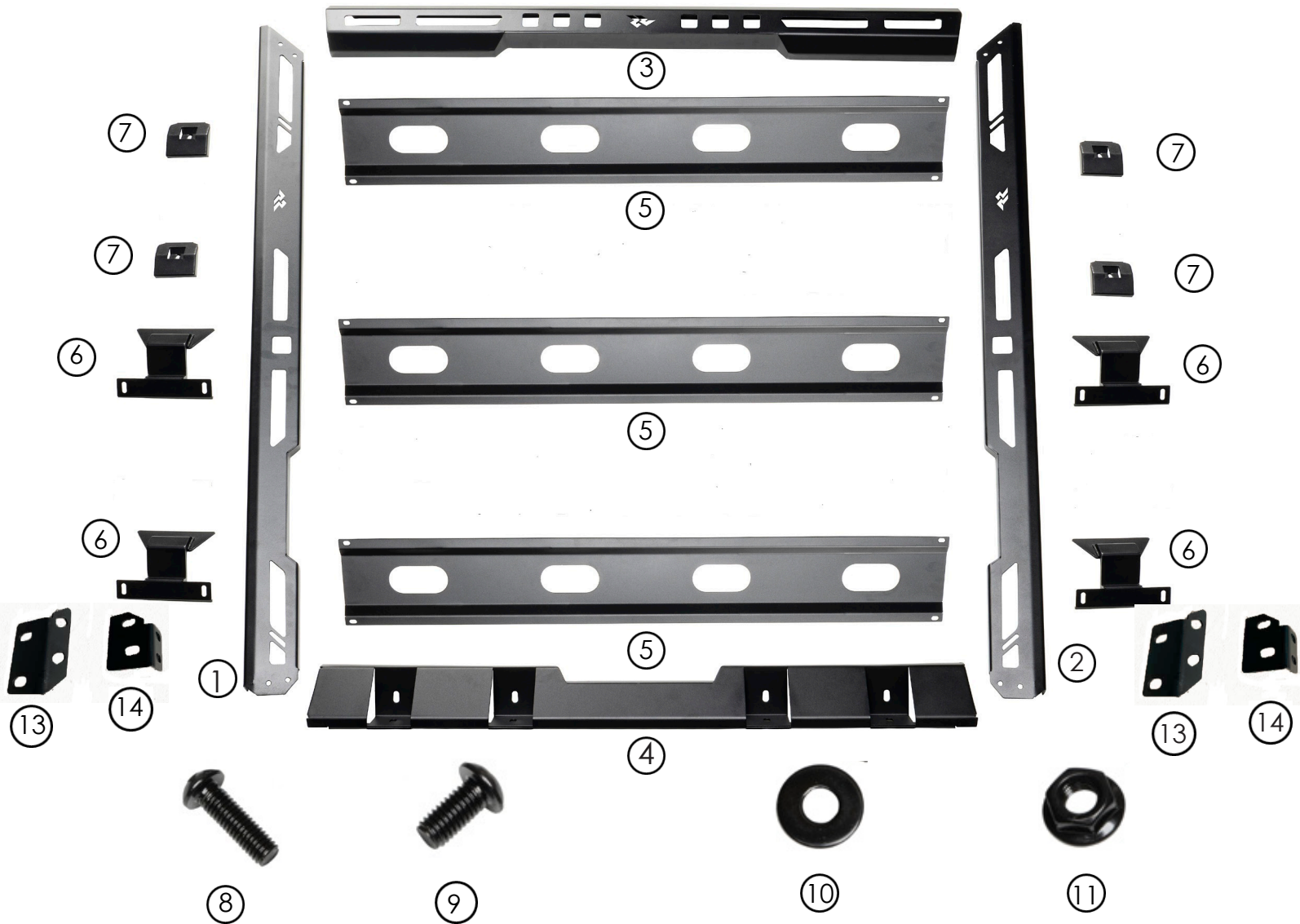

## Components

1. Side Rail, Driver Side .....	1	9. M8 X 20mm Button Head Allen Bolt (Shorter Bolt).....	16
2. Side Rail, Passenger Side .....	1	10. Flat Washer .....	60
3. Rear Panel.....	1	11. Nyloc Nut .....	18
4. Front Panel .....	1	12. AllenKey.....	1
5. Center Brace .....	3	13. Front Corner Braces.....	2
6. Roof Bracket .....	4	14. Rear Corner Braces.....	2
7. Clamp for Roof Bracket .....	4		
8. M8 X 25mm Button Head Allen Bolt (Longer Bolt) .....	16		

### OMIX-ADA® TECHNICAL SUPPORT

PHONE: M-F 8am - 5pm EST 1-800-449-6649

FOR WARRANTY OR TECH CONCERNS EMAIL: [webmaster@omixsupport.com](mailto:webmaster@omixsupport.com)

**ATTN: STATE OF CALIFORNIA CONSUMERS**  
**WARNING: Cancer and Reproductive Harm - [www.P65Warnings.ca.gov](http://www.P65Warnings.ca.gov).**

## Rugged Ridge Roof Rack Basket, JL & JT

1. Start by attaching the rear section of the rack to the side rails using the Corner Braces. The Corner Braces will install from the inside. Use the smaller button head with 2 washers and Nyloc nut. Snug but don't fully tighten at this time.



2. Slide the 3 center braces into place and attach with hardware. Use the longer button head bolts with 2 washers and Nyloc nut. Snug all the hardware but don't fully tighten at this time. With it only snug, it allows you to adjust the roof bracket when placing it on the Jeep later.

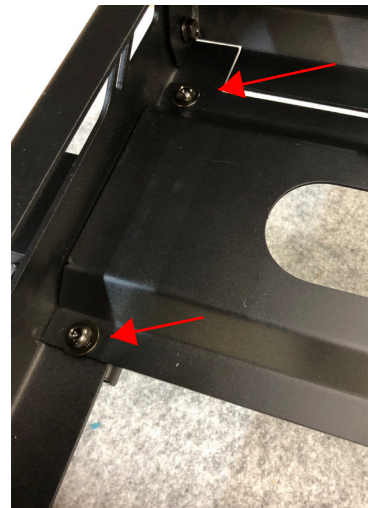

3. Attach the front panel to the rack using the Corner Braces. The Corner Braces will install from the inside. Use the short button head with 2 washers and Nyloc nut. With the rack assembled, fully tighten all the hardware except the hardware holding the roof brackets. These feet need to stay flexible to adjust to fit to the roof. **NOTE:** At this time attach LED cubes to the front panel if you choose.





## Rugged Ridge Roof Rack Basket, JL & JT

4. Place the rack on the Jeep roof. This must be done with two or more people. The rack weighs more than 100lbs so please use caution before lifting. We also suggest placing a blanket on the roof to avoid any scratching.



5. With the rack placed on the roof, slide the brackets to fit in the channel. Adjust as needed and measure to assure the rack is centered and square to the Jeep.

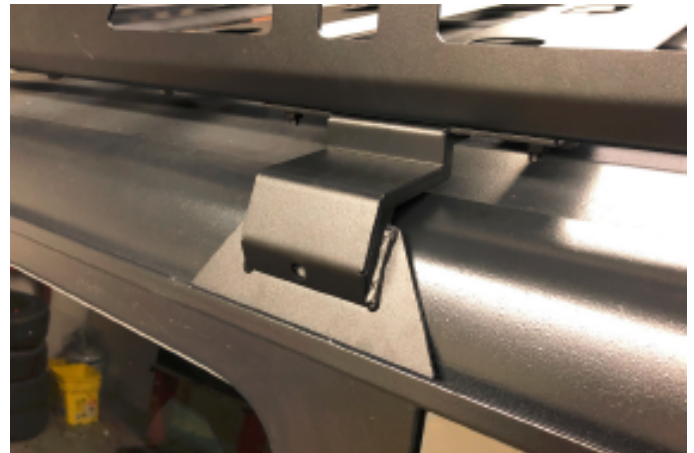

6. Install outer clamp to the roof bracket. Attach with 4 longer button head bolt and washer.



## Rugged Ridge Roof Rack Basket, JL & JT

7. To complete the install, fully tighten the roof bracket hardware.

We recommend checking the bolts periodically for tightness. Please keep provided Allen Key.

