



THE AUTOMOTIVE LIGHTING BENCHMARK

2011-16 SUPER DUTY XB LED HEADLIGHTS INSTALL GUIDE

WARNING: By reading this document, you agree it is only to be used as an educational guide. Morimoto Lighting nor its dealers make guarantees on any finished results, nor are they to be held responsible for any damage, misuse, or personal injuries. If you are unable to clearly understand and adapt the information below, professional installation is recommended.

NOTE: Unknown circumstances related to the BCM can cause the passengers side turn signal to lock-up. See page 7 for recommended fix. Note: this fix requires a OHP ELMconfig OBD2 scanner to be purchased.

PACKAGE CONTENTS



2X HEADLIGHT ASSEMBLIES



1X FUSE TAP / DRL HARNESS

IMPORTANT: If your vehicle is equipped with anything but OEM turn signals (full assemblies, LED bulbs, or otherwise) in the tail lights or elsewhere: You may experience a hyper flash and/or problem with the sequential signal setting on these headlights. This is not a defect in the headlight, and caused by un-matched impedance with your original vehicle settings.

INSTALLATION PROCESS

1. Remove the four 10mm screws along the top of the grille assembly.

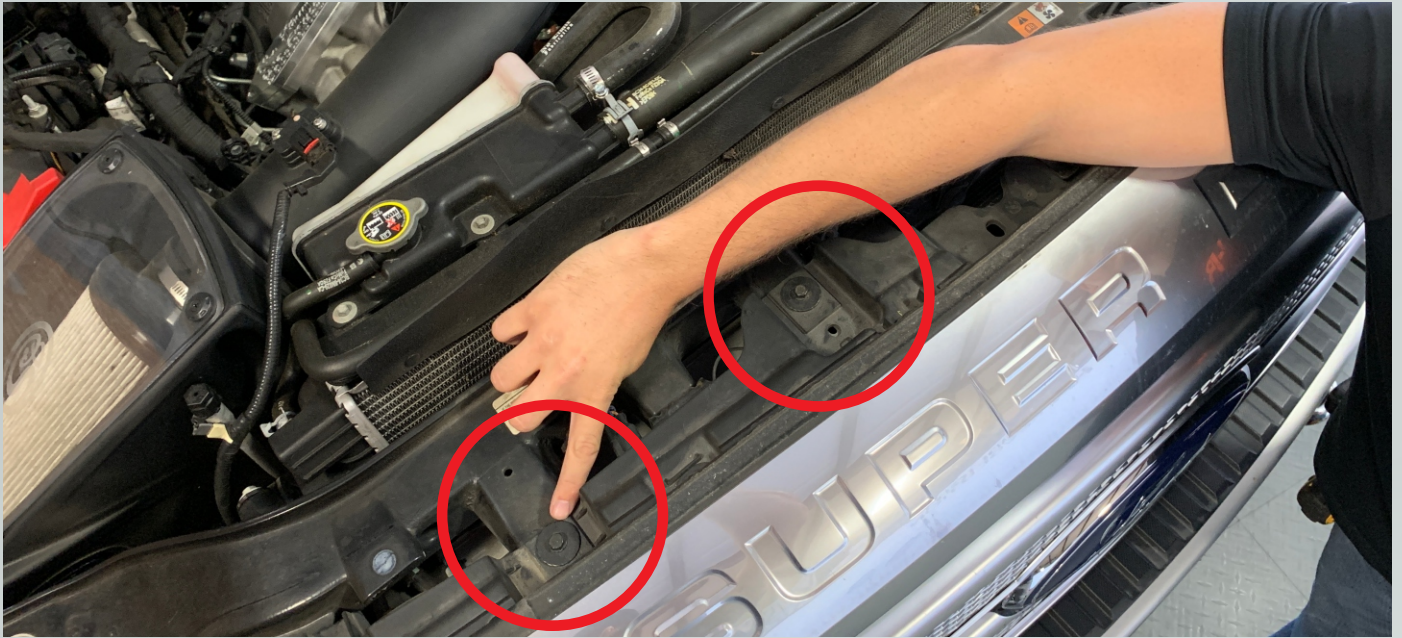

2. Use a long flat-head screwdriver to depress the five clips at the bottom of the grille shell to release it.





3. Remove the four 10mm screws that secure each headlight to the truck.



4. Remove the headlight and unplug the factory bulbs from each socket.

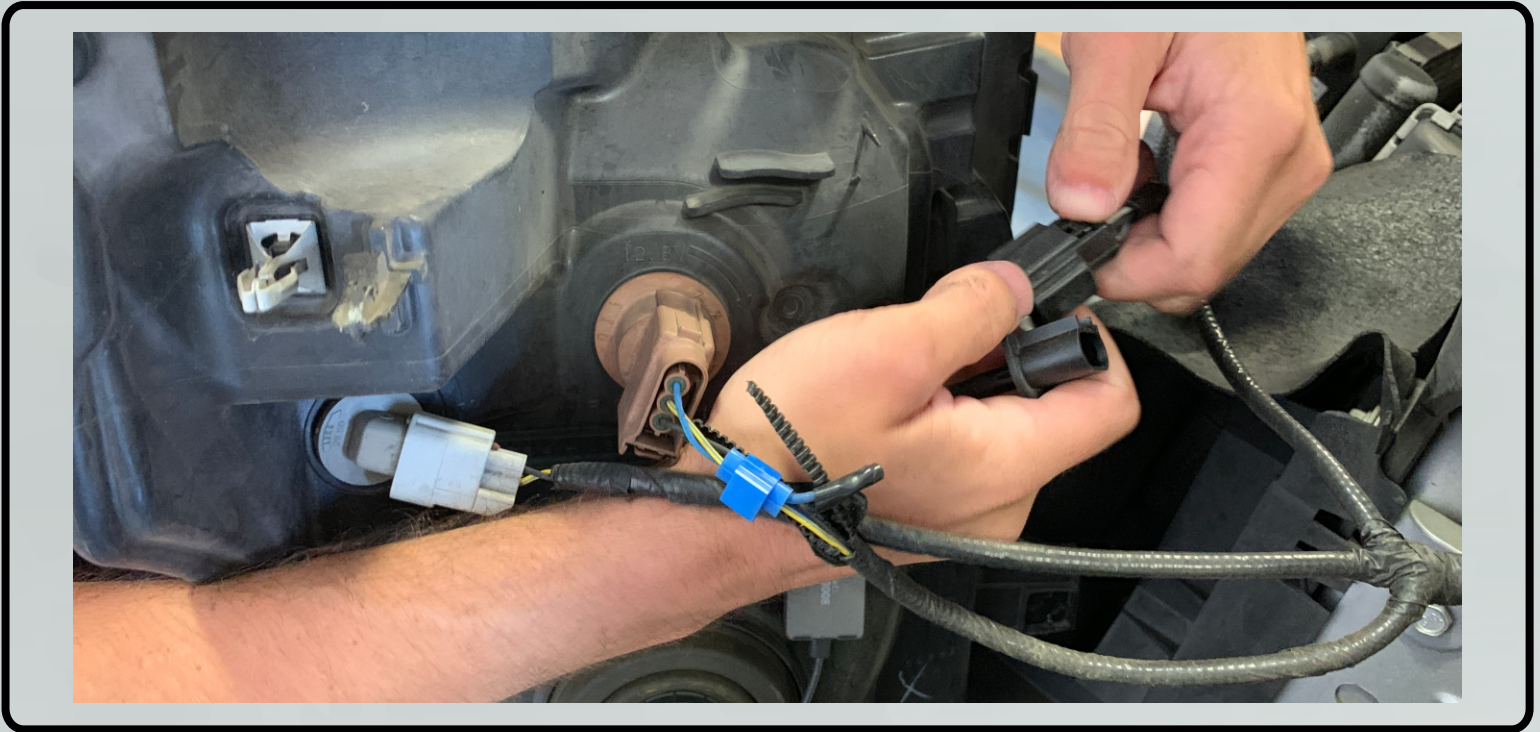

5. Route the DRL fuse tap harness across the radiator support panel.

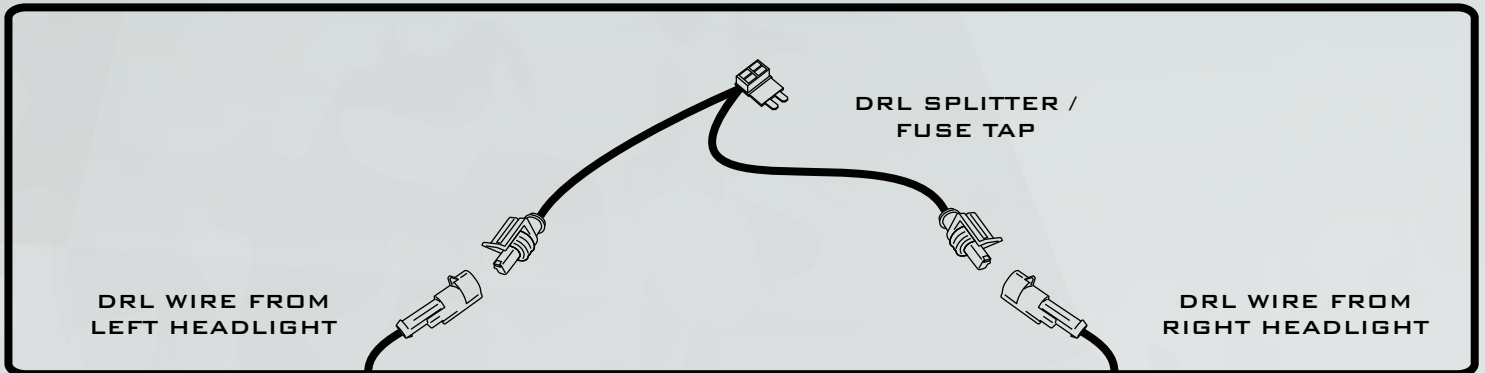

6. Connect fuse tap to the power mirror fuse (#50) indicated below:

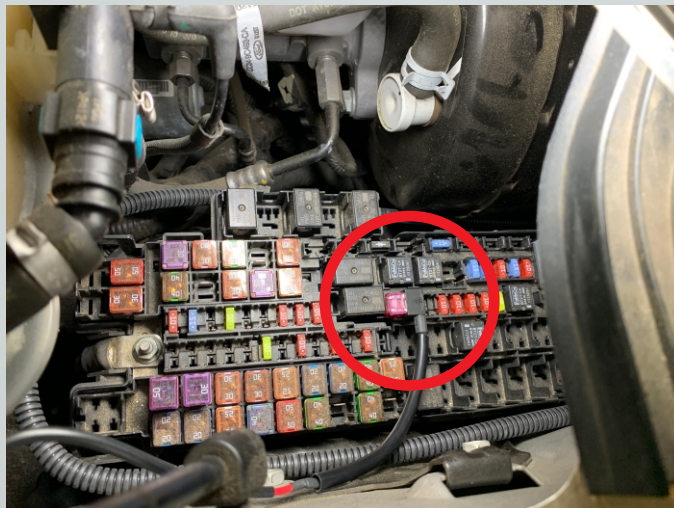

7. Connect XB LED headlight to factory headlight connectors.

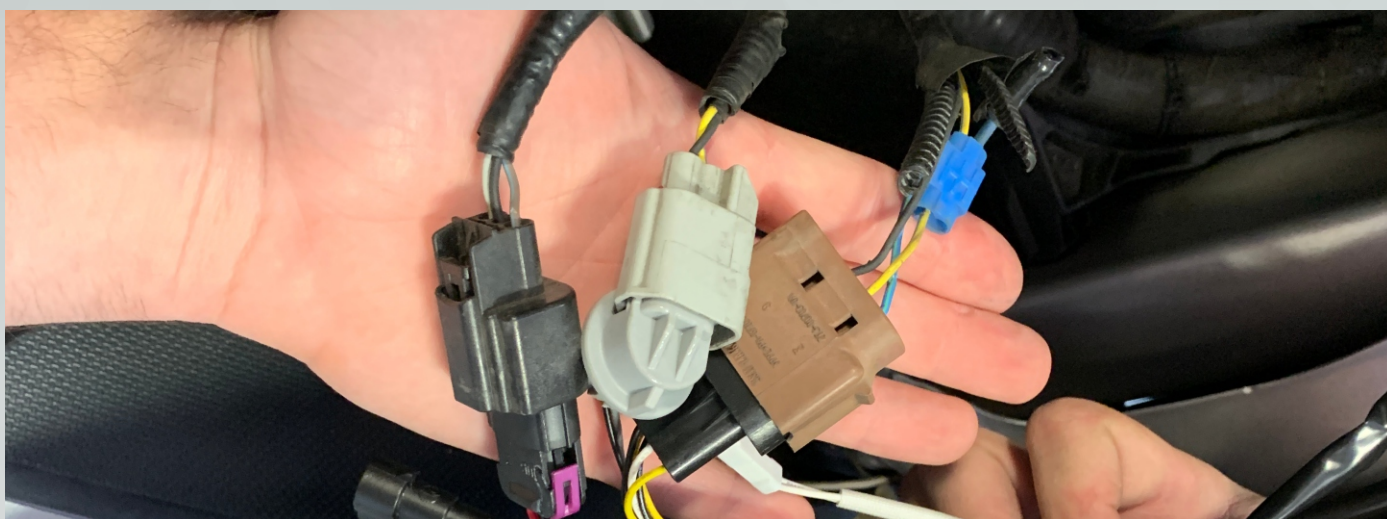

8. Configure turn signal function to your preference.

SEQUENTIAL TURN SIGNAL TOGGLE



SEQUENTIAL TURN SIGNAL OPERATION



STANDARD (BLINKING) TURN SIGNAL OPERATION

9. Installation of XB LED headlights is reverse of removal.

The vertical adjuster can be accessed from the top with the headlight installed.

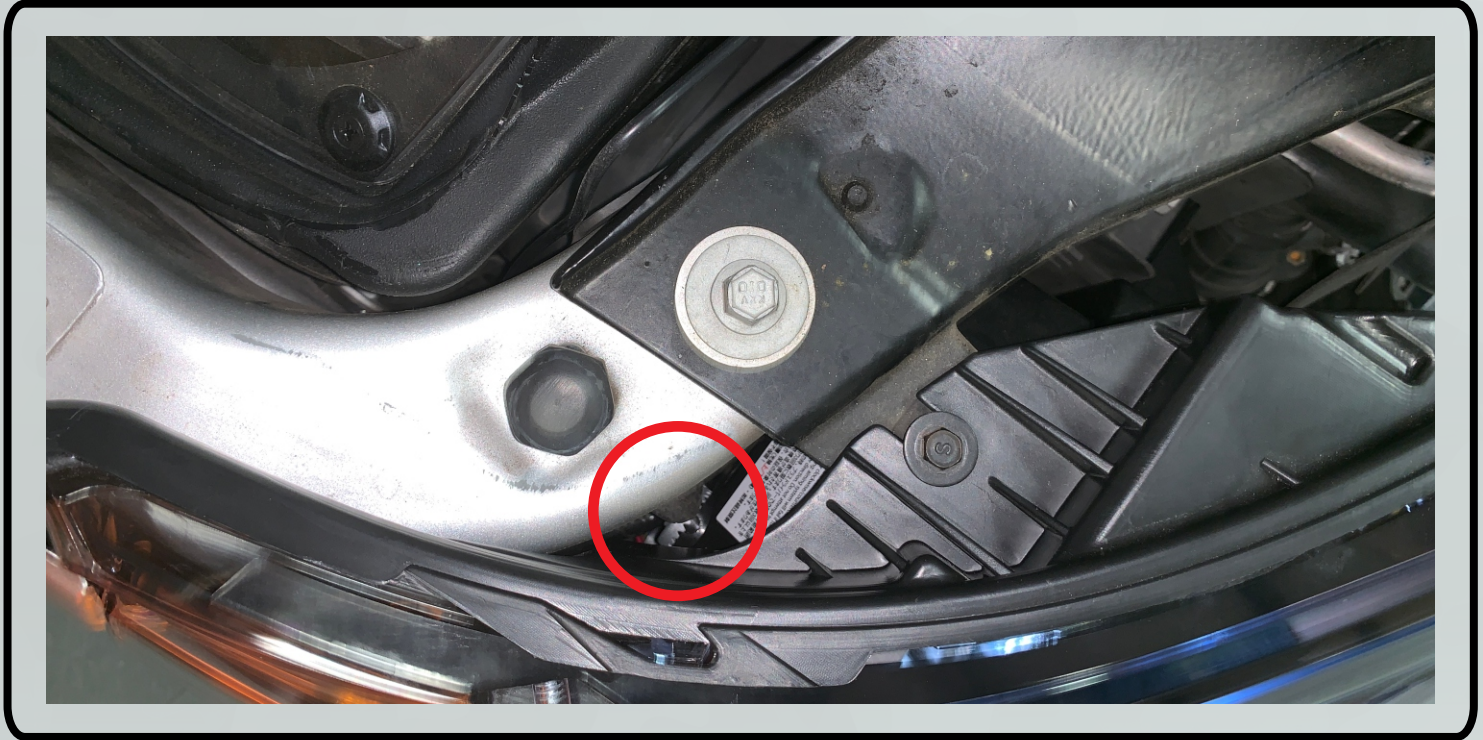

10. Refer to the aiming standards below when adjusting your lights.

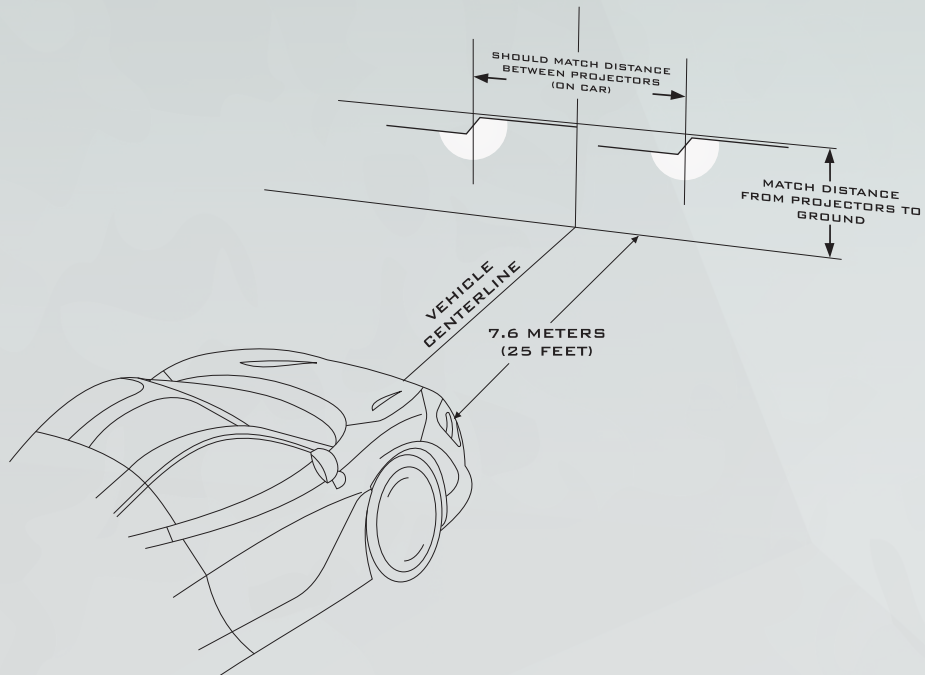

2011-16 FORD SUPERDUTY XB LED HEADLIGHTS TURN SIGNAL FIX

WARNING: By reading this document, you agree it is only to be used as an educational guide. Morimoto Lighting nor its dealers make guarantees on any finished results, nor are they to be held responsible for any damage, misuse, or personal injuries. If you are unable to clearly understand and adapt the information below, professional installation is recommended.

REQUIRED TOOLS

- OHP ELMconfig OBD2 scanner

INSTALLATION PROCESS

1. Remove the passenger headlight following our install guide.
2. Locate the turn signal(#1) and DRL(#2) connectors coming out of the back of the XB headlight.

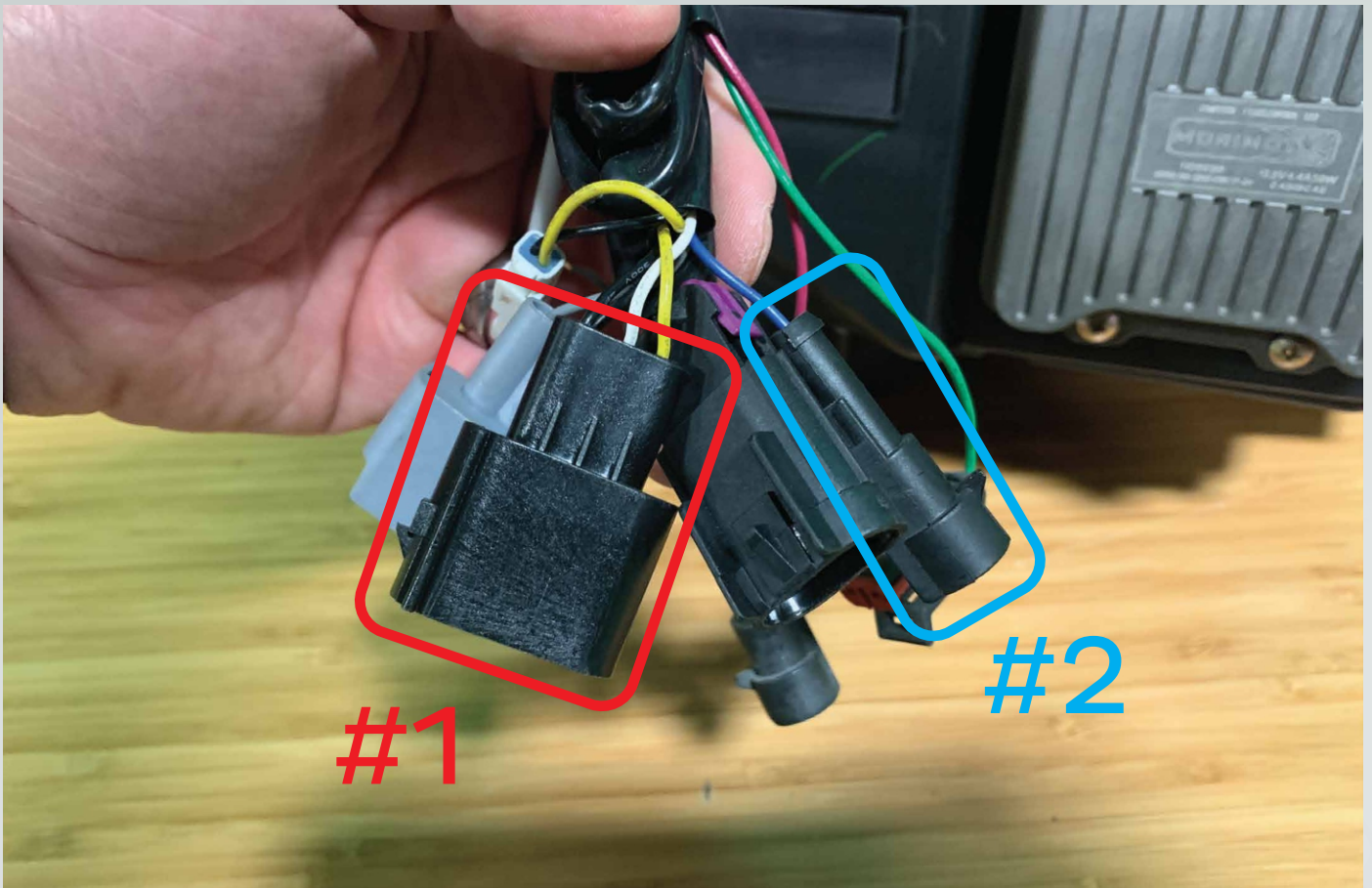

3. Get the supplied adaptor harness and plug in these 2 connectors into the harness on the back of your XB headlight.

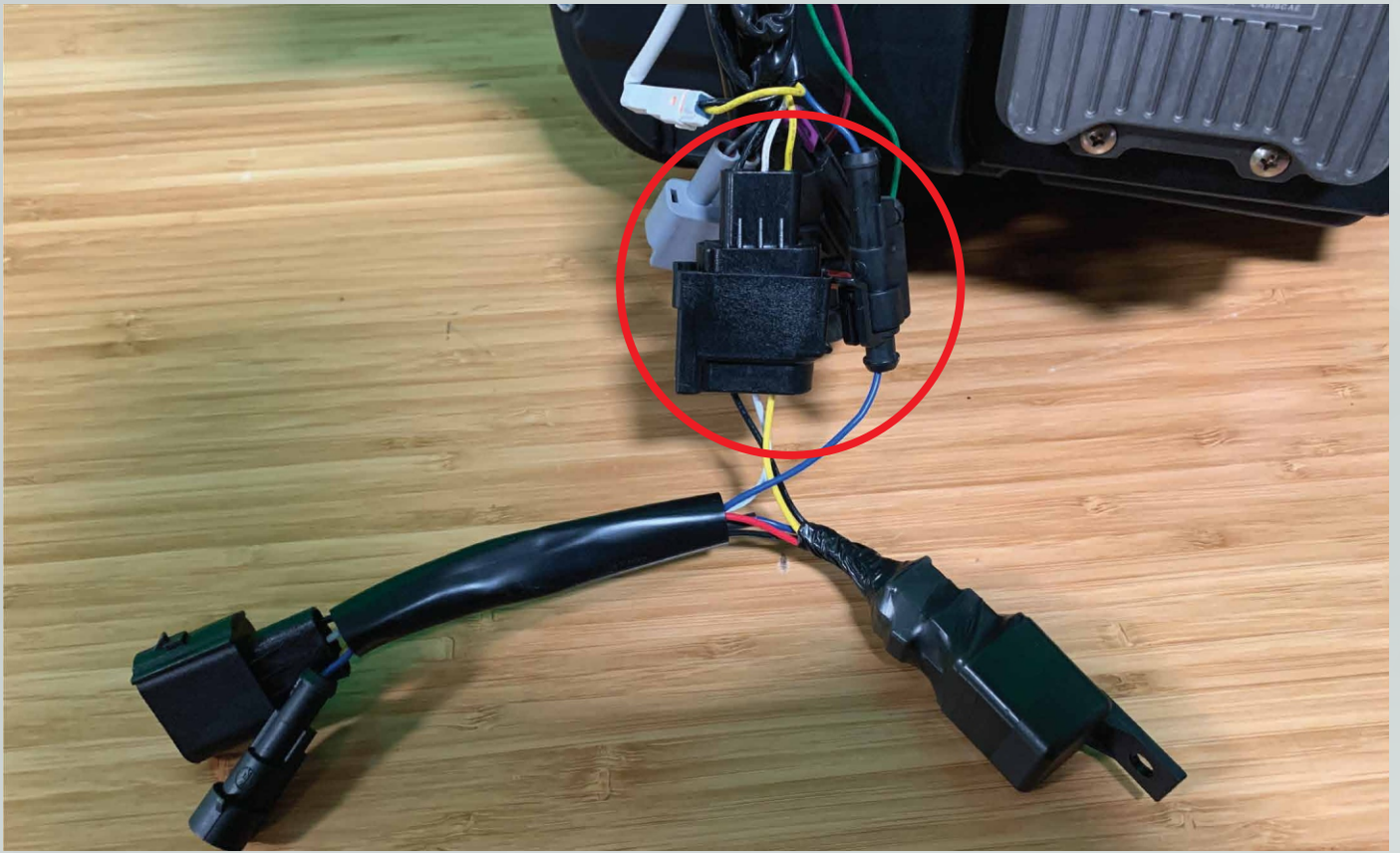

3. Plug these connectors (#1) into the truck harness and mount the relay (#2) to secure it.

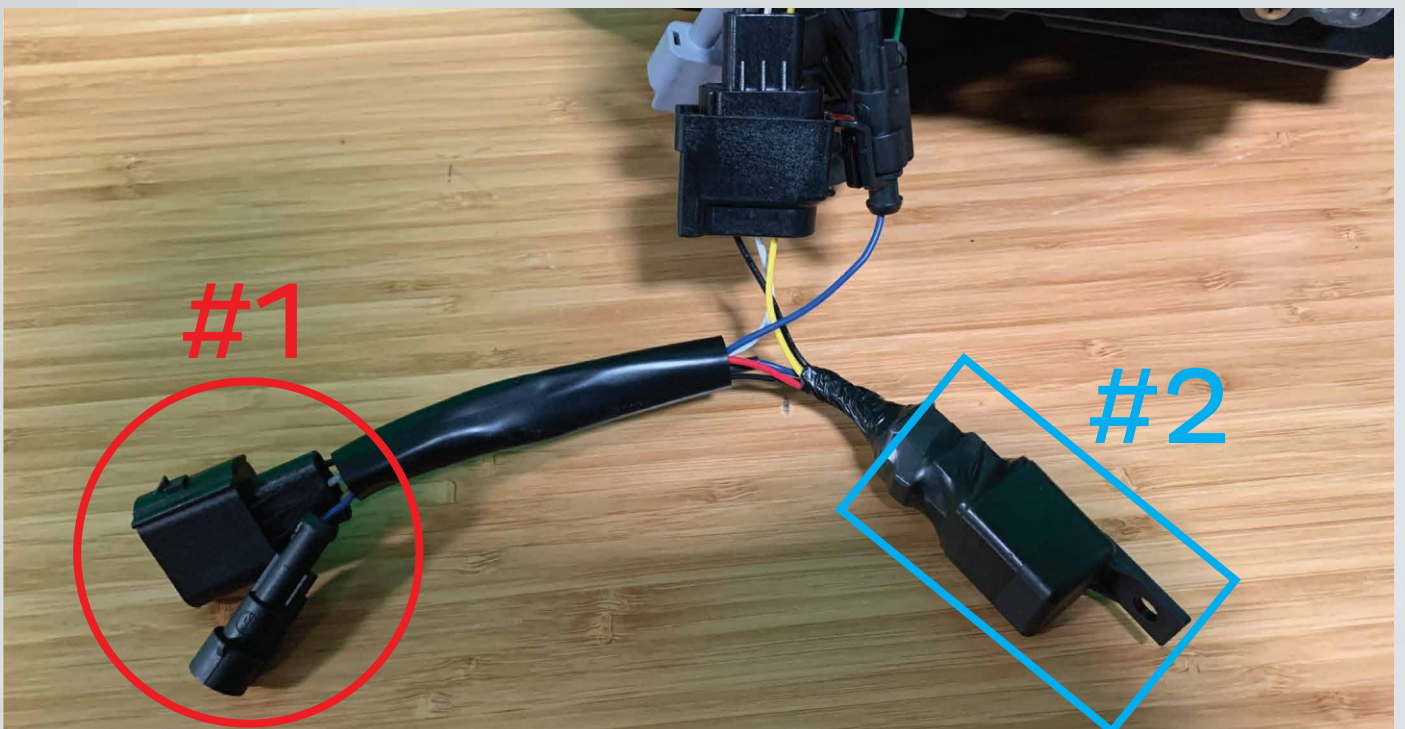

4. Plug in the OHP scanner into your OBD2 port, put your key in the ignition and turn to position 2. Also open the FORScan Lite app on your tablet.



5. Make sure the switch on the OHP scanner is set to HS-CAN (#1). In the app press the plug icon (#2).



6. Wait for the app to scan your truck.

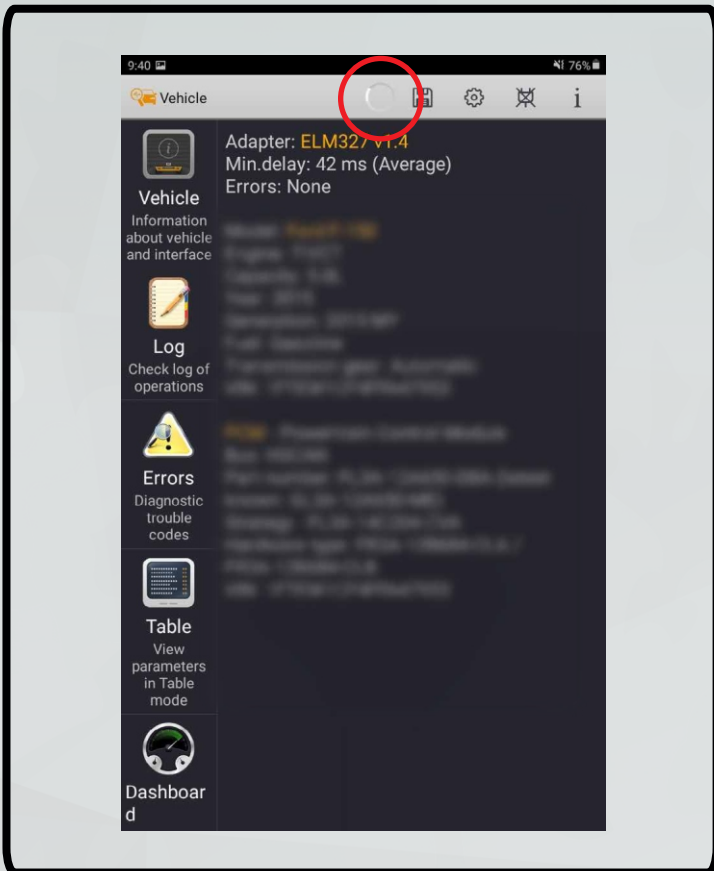

7. Once you get this screen, flip the switch on the OHP to MS-CAN (#1) and click ok on the app (#2).

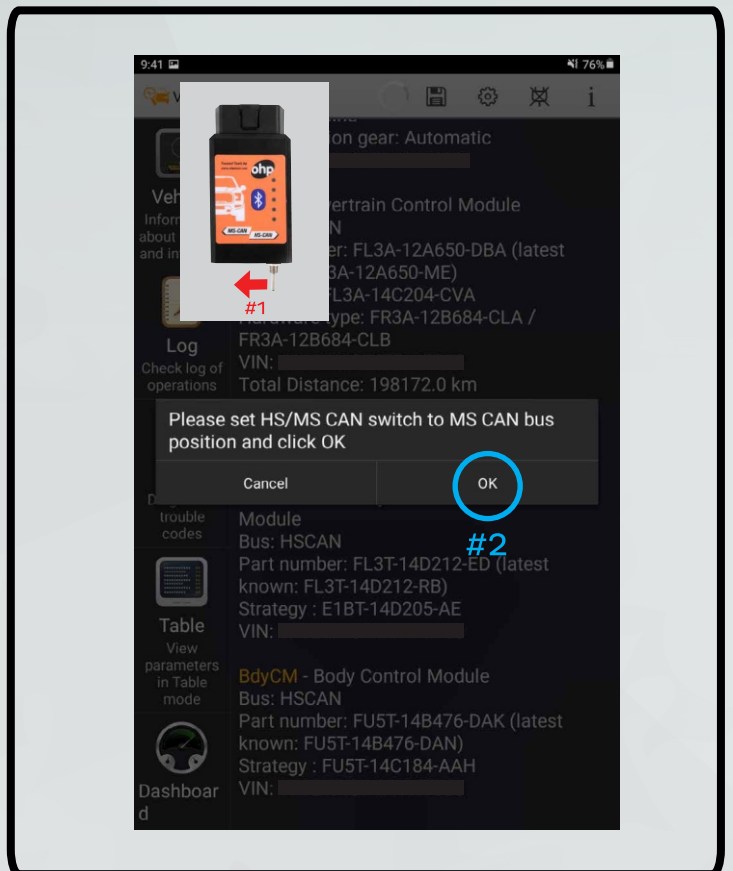

8. Once the app is done scanning, click the Errors tab.

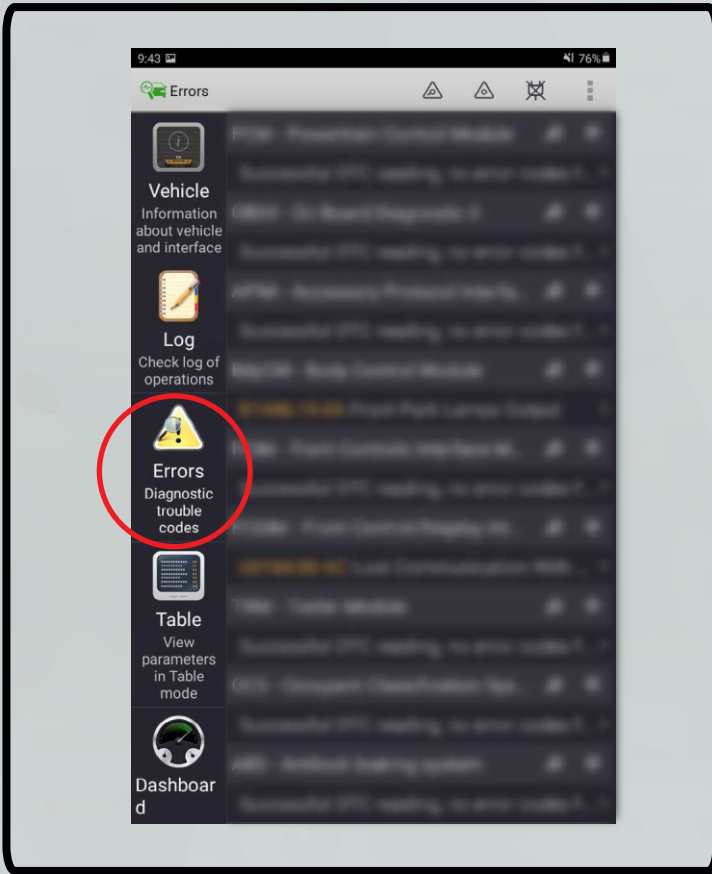

9. Scroll down and find the Body Control Module and click the refresh icon.

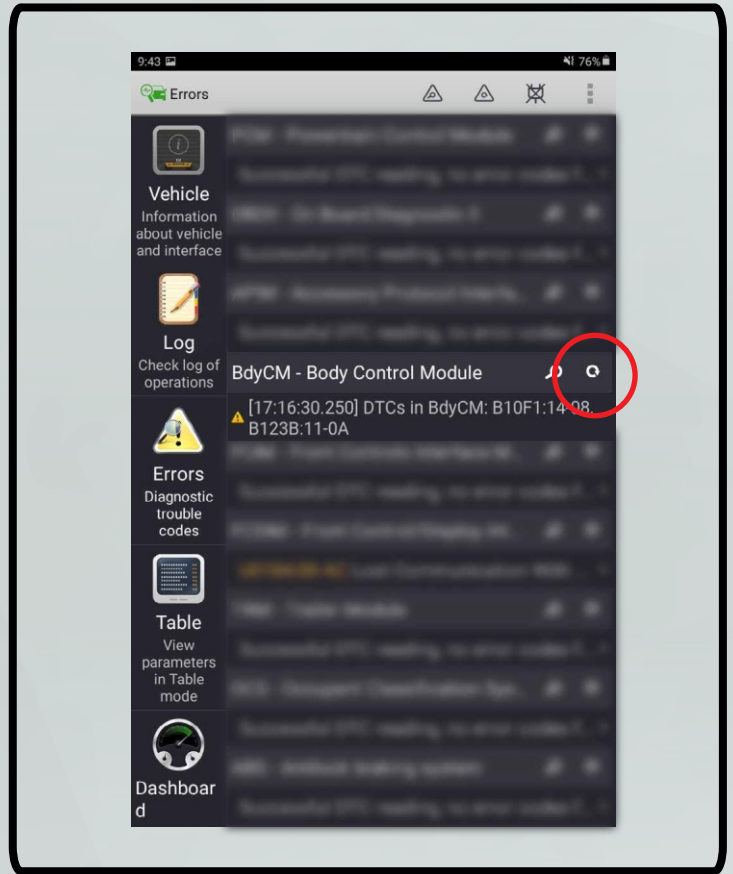

10. Immediately you get this window, click Yes.

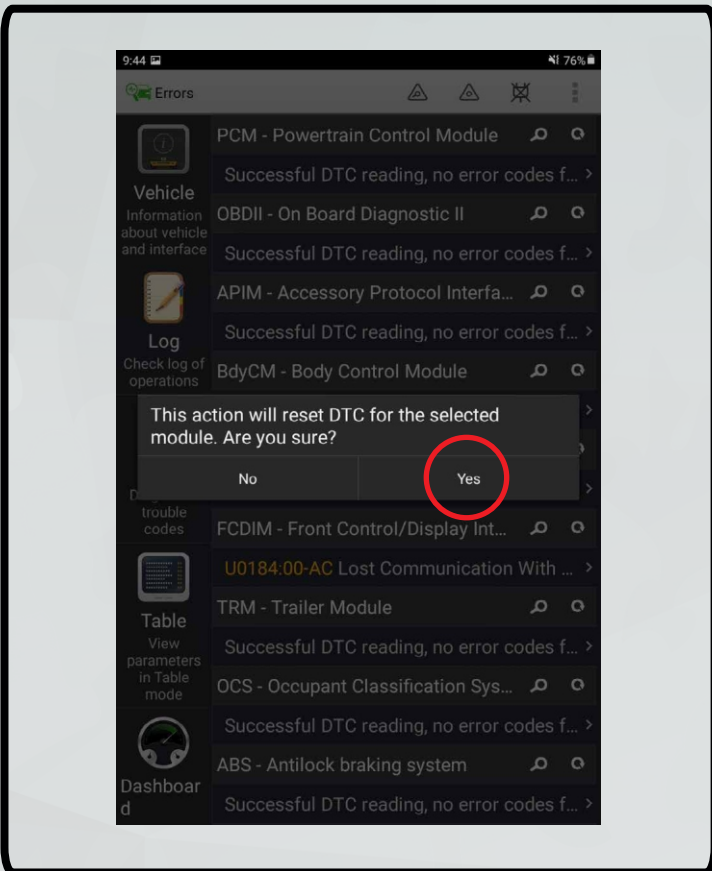

11. The app will now rescan the truck for faults. Set switch on the OHP to HS-CAN(#1) and click OK(#2).

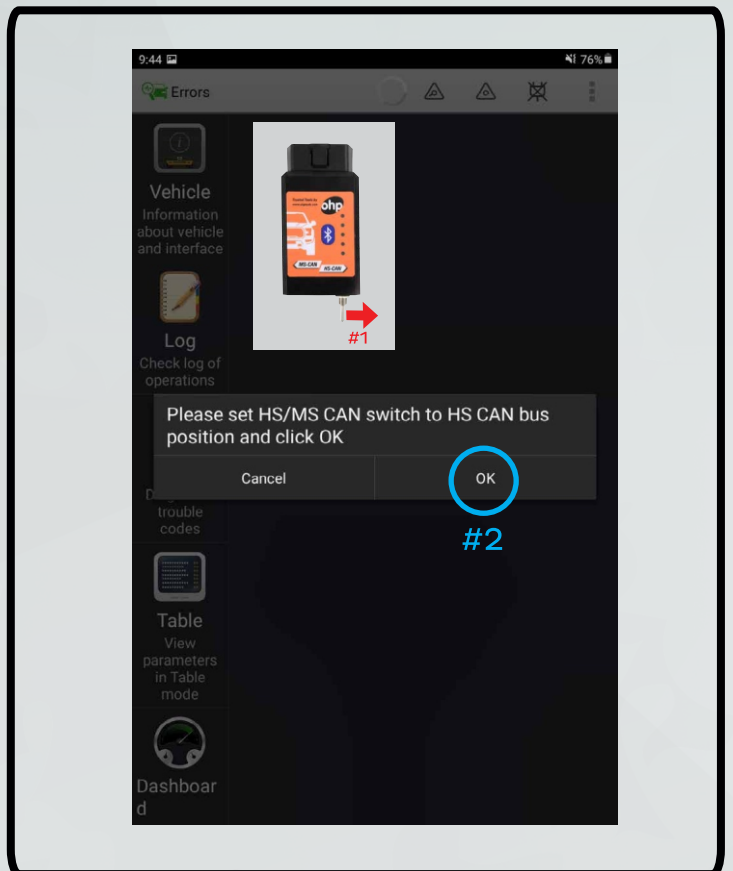

12. Once you get this window, turn your key Off then back On to Position 2 and click OK.

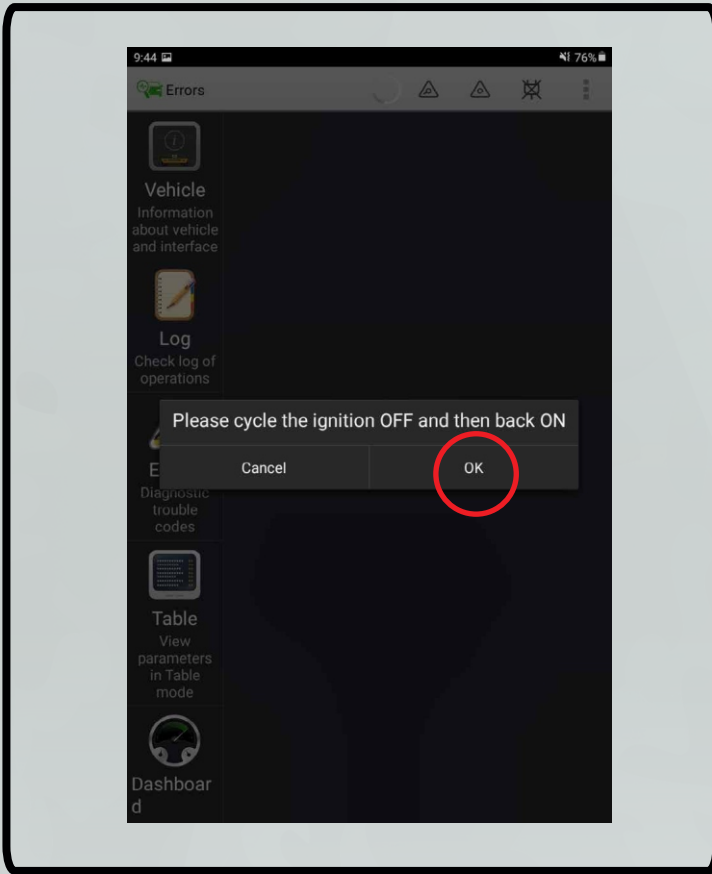

13. Once you get this window, flip the switch on the OHP to MS-CAN (#1) and click OK (#2).

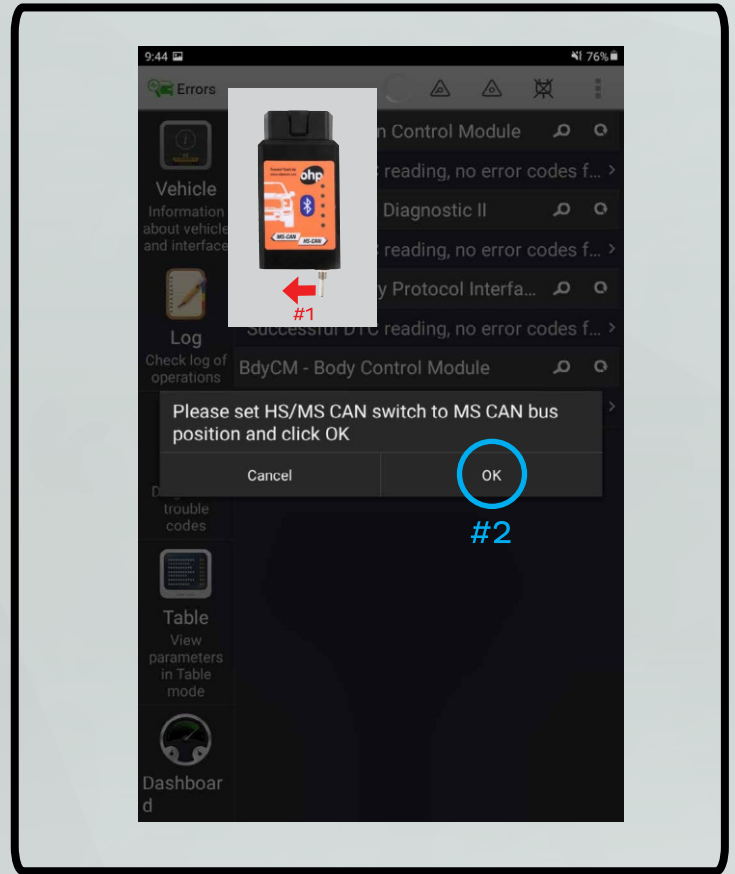

14. Once the app is finished scanning the code in the Body Control module should be gone and you are finished.

15. Unplug the OHP scanner and reassemble the truck.

ENJOY YOUR MORIMOTO XB HEADLIGHTS!