

Installation Instructions

I - Sheet Number INS-HS150 Rev.-



Hood Shield

**For proper installation and best possible fit, please read all instructions BEFORE you begin.
For technical assistance or to obtain missing parts, please call Customer Relations at 1-800-344-8759.**

Important Safety Information



- CAUTION - Before driving, ensure that the hood shield is properly secured to vehicle.
- Do not use automatic "brush-style" car washes.
- Do not use cleaning solvents of any kind.
- Periodically check all components for tightness.

Contents

NOTE: Actual product may vary from illustration.



Hood shield



Bump On x4



Alcohol Pad
x2 Pair



Surface Prep x1

Tools Required



Car Wash Supplies



Clean Towel



Masking Tape

Preparation Before Painting / Installation

- A trial fit is recommended to ensure proper positioning and fit.
- Check fit of parts before painting as we will not accept the return of modified or painted parts.
- Wash and dry your vehicle to remove any debris and/or dirt from the installation area.

Installation Steps

NOTE: Actual application may vary slightly from illustrations.



Clean painted surface of hood with alcohol pad.
Allow hood to dry.

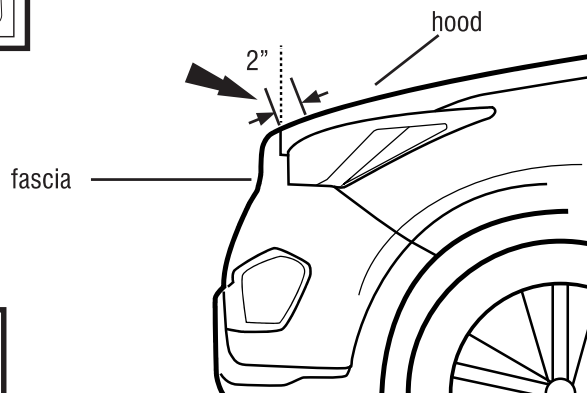

1

Peel back 1" of tape liner from each end of bottom flange.
NOTE: Number of flanges may vary based on application.

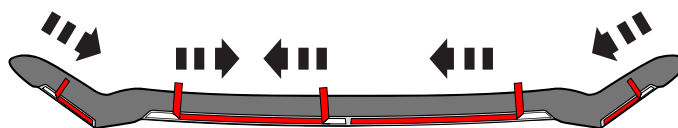

2

Installation Steps

NOTE: Actual application may vary slightly from illustrations.



LOOSELY attach hood shield to HOOD.
Apply masking tape to areas BEHIND mounting flanges.

3

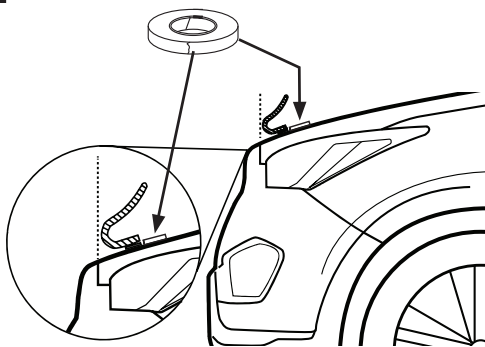

After masking tape has been applied to hood, carefully remove hood shield.

4

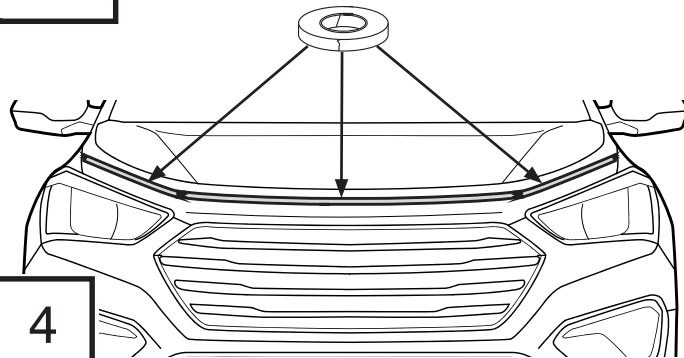

Apply (1) coat of surface prep in front of masking tape, where tape is present on hood shield. Allow surface prep to dry.

5

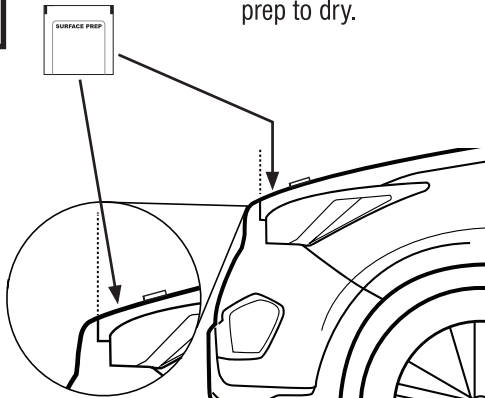

Align hood deflector with front edge of hood. Once positioned correctly, pull tape liners. Press **firmly** to adhere exposed tape.

6

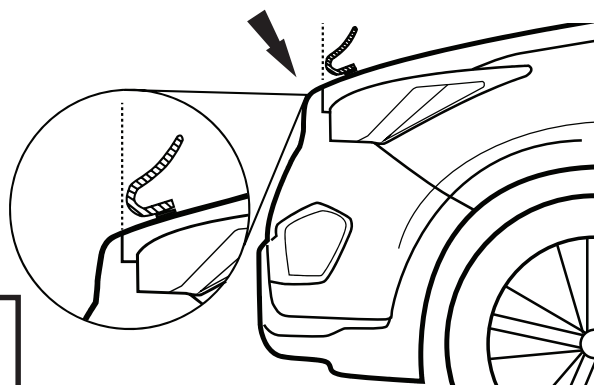

Remove remainder of tape by pulling on free ends.

7

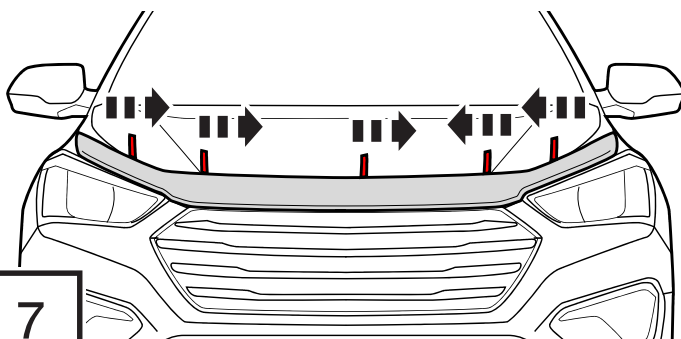

Apply **FIRM** pressure to all tape flanges to ensure proper adhesion.
Remove masking tape.

8

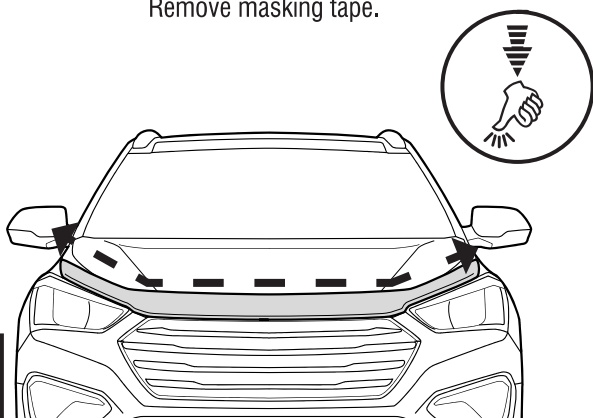

Apply (4) bump ons to surface of hood.

9

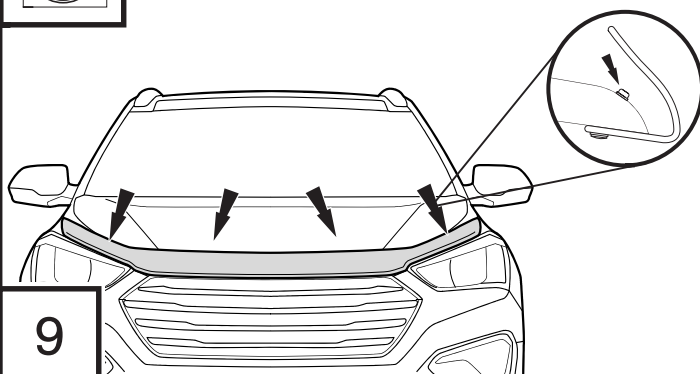

Care and Cleaning

- Wash only with mild soap & dry with a clean cloth.
- Excess surface prep may be removed with 70-90% alcohol if necessary.



The material that your product is made from can be recycled. Please also consider recycling the packaging that your product came in.



Congratulations!

You have purchased one of the many quality Husky® branded products. We take the utmost pride in our products and want you to enjoy years of satisfaction from your investment. We have made every effort to ensure that your product is top quality in terms of fit, durability, finish and ease of installation.



1-800-344-8759 • Visit us at [huskyliners.com](https://www.huskyliners.com)

© 2024 Husky Liners, Inc. All rights reserved.

Husky® and the Husky® logo are trademarks of Husky Liners, Inc.