

# Installation Instructions for IB20EAD0

by APS Auto Parts Specialist Inc.

Application: For 2007-2017 Toyota Tundra Regular Cab  
Estimated Time: 1 to 2 hours



Disclaimer: Instructions intended for persons aged 18+ please do not attempt without adult supervision. Instructions are not intended to replace professional installation. Damage from improper installation, misuse or modification to the product voids the manufacturer's warranty.

**PARTS LIST:**

Item	QTY	Description	Item	QTY	Description
#1	2	Running Board(use for left or right)	#7	8	M8 Lock Washers
#2	1	Driver/Left Front Mounting Bracket(DFM)	#8	8	8mm x 24mm OD x 2mm Flat Washers
#3	1	Passenger/Right Front Mounting Bracket(PFM)	#9	16	M6X1.0-20mm T-Bolts
#4	1	Driver/Left Rear Mounting Bracket(DRM)	#10	16	6mm x 22mm OD x 2mm Flat Washers
#5	1	Passenger/Right Rear Mounting Bracket(PRM)	#11	16	M6 Nylon Lock Nuts
#6	8	M8X1.25-20mm Hex Bolts			

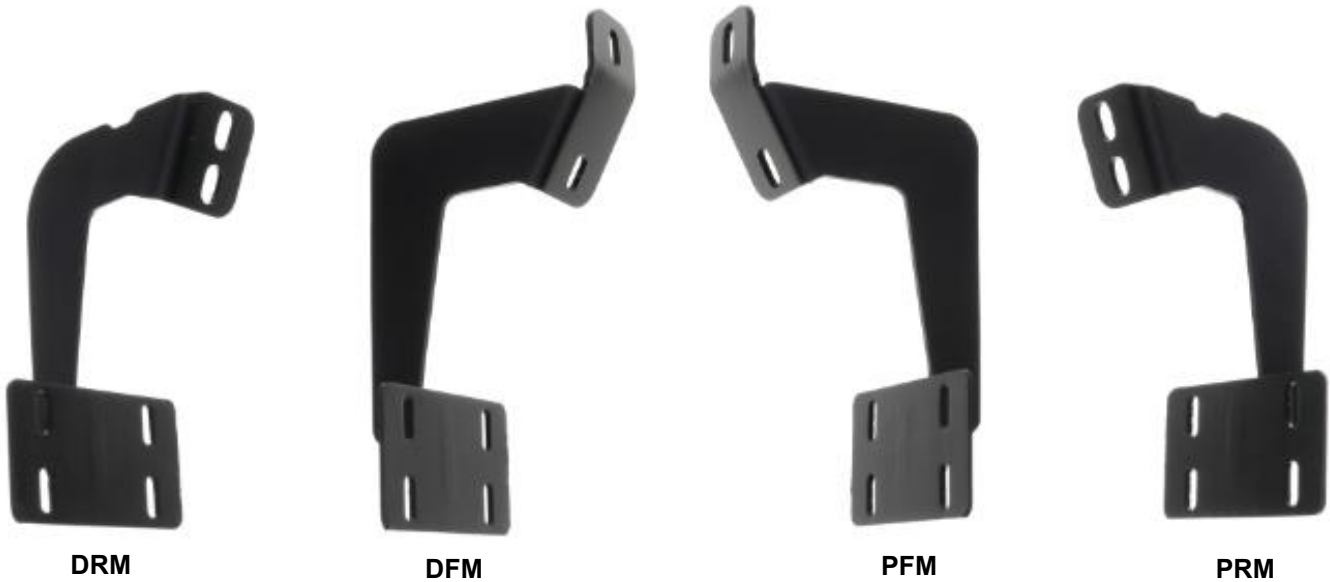

- 1. REMOVE CONTENTS FROM BOX. VERIFY ALL PARTS ARE PRESENT. READ INSTRUCTIONS CAREFULLY. ASSISTANCE IS RECOMMENDED.**
- Starting on the driver side front of the vehicle, remove the existing (2) factory bolts, (or plastic plugs), on the side panel located by the front tire opening, **(Figure 1)**. This will be the mounting location for the driver side front Mounting Bracket.
- Select the driver side Front Bracket, **(Figure 2)**. Attach the Bracket to the vehicle using the included (2) M8 x 30mm Hex Bolts, (2)M8 Lock Washers and (2) M8 Flat Washers, **(Figure 3)**. Do not tighten hardware at this time.
- Next, move to the last mounting location at the back of the cab. Select the driver side Rear Bracket,. Repeat **Steps 2 & 3** to install the rear Bracket, **(Figure 4)**.
- Select the Running Board. Slip (8)M6 T-Bolts into each bottom channel **(Figure 5)** Carefully position the Running Board onto the (2)Mounting Brackets. **IMPORTANT:** Do not slide the Running Board on the Brackets or damage to the finish may result. Attach the Running Board to the Mounting Brackets with (4) M6 T-bolts,(4) M6 flat washers and (4) M6 nylon lock nuts **(Figure 6)**. Do not tighten hardware.
- Level and adjust the Running Board properly and tighten all hardware.
- Repeat **Steps 2—6** for passenger side installation.
- Do periodic inspections to the installation to make sure that all hardware is secure and tight.

**To protect your investment,** wax this product after installing. Regular waxing is recommended to add a protective layer over the finish. Do not use any type of polish or wax that may contain abrasives that could damage the finish.

**For Polished Finishes:** Aluminum polish may be used to polish small scratches and scuffs on the finish. Mild soap may be used also to clean the Running Board.

**For black finishes:** Mild soap may be used to clean the Running Board.

### Driver Side Installation Pictured

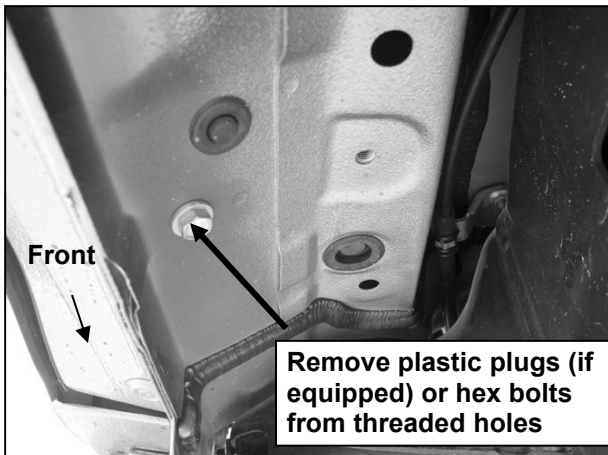

(Fig 1) Driver/Left Front Mounting Location Pictured

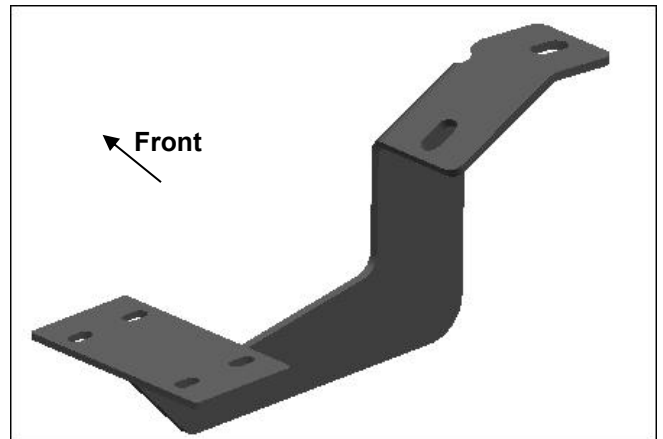

(Fig 2) Driver/Left Front Mounting Bracket



(Fig 3) Driver/Left Front Mounting Location Pictured



(Fig 4) Driver/Left Rear Bracket Pictured



- (4) M6 T-bolts
- (4) M6 Flat Washers
- (4) M6 Nylon Lock nuts

