



SPYDER

WWW.SPYDERAUTO.COM

INSTALLATION GUIDE:

ALT-YD-CD00-LED-(ALL COLORS)

Tools Required

Phillips Screwdriver



Please Note

If you are unfamiliar with the installation processes, professional installation is highly recommended.



1) Open the tailgate.

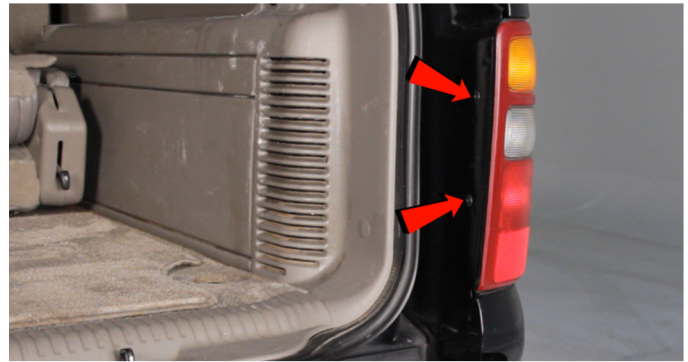

2) Remove [2x] Phillips Bolts securing the tail light.



3) Unseat the tail light.

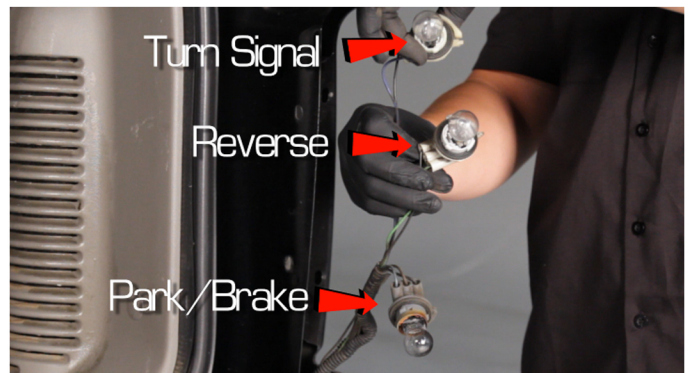

4) Remove the turn signal, reverse lamp and brake lamp bulb sockets from the OEM tail light. Never touch exposed bulbs with bare hands.



5) Remove the turn signal bulb from its socket. Never touch exposed bulbs with bare hands.



6) Remove the brake lamp bulb from its socket. Never touch exposed bulbs with bare hands.

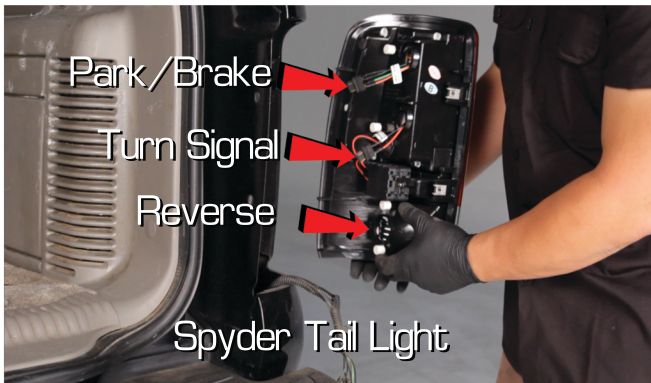

7) Install the reverse lamp socket into the Spyder tail light.



8) Connect the turn signal socket to the center socket insert of the Spyder tail light. Align the black wire side of the socket with the black wire side of the insert to ensure correct polarity. Reinstall the socket.



9) Connect the brake lamp socket to the upper socket insert of the Spyder tail light. Align the black wire side of the socket with the black wire side of the insert to ensure correct polarity. Reinstall the socket. Your Spyder LED tail light is now ready to install.



10) Seat the Spyder tail light.



11) Reinstall the two phillips screws to secure the tail light.



12) Close the tailgate and enjoy your new Spyder LED tail lights.



SPYDER
WWW.SPYDERAUTO.COM

For further help with installation, please watch our installation video. Follow the direct link below to our YouTube channel for more information.

http://youtu.be/Yp_GuqZXb6M

Disclaimer

Spyder Auto Installation Guide is not liable for damages, injuries, and death while installing the product. This is a guide only, designed to save you time during the installation process. We take no responsibility and cannot be held liable for improper installation. If you do not know how to install your product or are not comfortable doing it yourself, please seek professional installation.