

# S5081

2009-2018 CHEV/GM 1500 SERIES, 4.3 & 5.3L PRE-AXLE DUAL SIDE EXIT, ONE-PIECE DRIVESHAFT ONLY  
2019 CHEV/GM 1500 SERIES LIMITED (LD), 4.3 & 5.3L PRE-AXLE DUAL SIDE EXIT, ONE-PIECE DRIVESHAFT ONLY

**MBRP**  
INC.  
PERFORMANCE EXHAUST

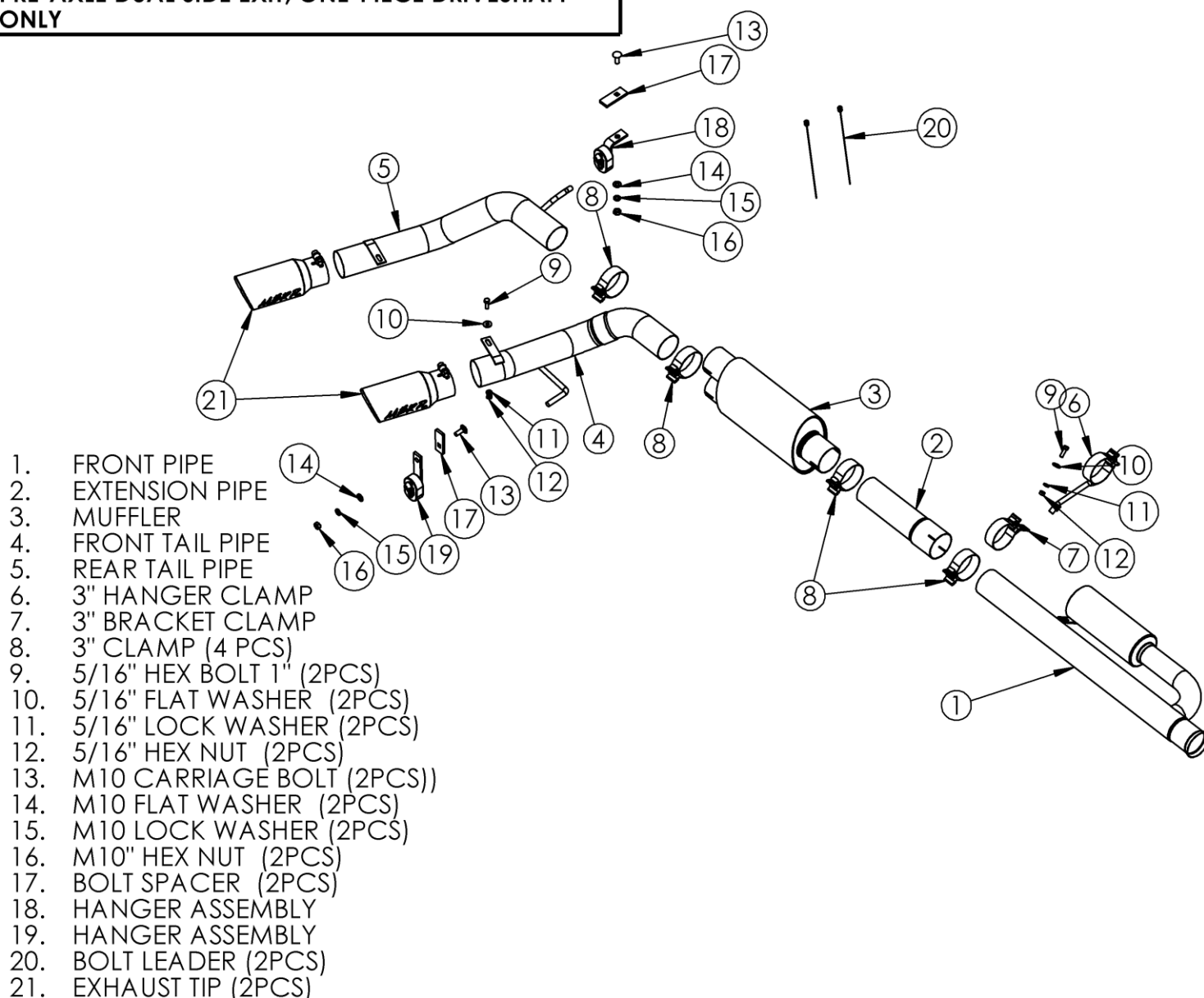

## PLEASE READ BEFORE STARTING INSTALLATION

**While MBRP Inc. has made every effort to ensure that all components of this system are of superior quality and properly packaged, it is the installer's responsibility to ensure the following before removal of the factory exhaust:**

- that ALL components shown above are present.
- that ALL mating components fit together.
- that there are no damaged components.
- that the system you have purchased is appropriate for your vehicle year, model and configuration.
- that the system will not interfere with any modifications previously installed or planned.
- that you have read and understand these instructions.

If you have any questions or are uncertain about any aspect of the installation of this system to your vehicle please contact your dealer before commencing installation.

## Removal of Stock System



**Figure 1**

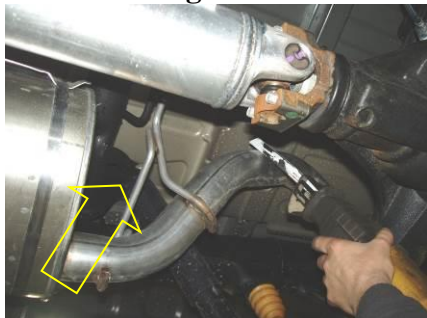

**Figure 2**



**Figure 3**

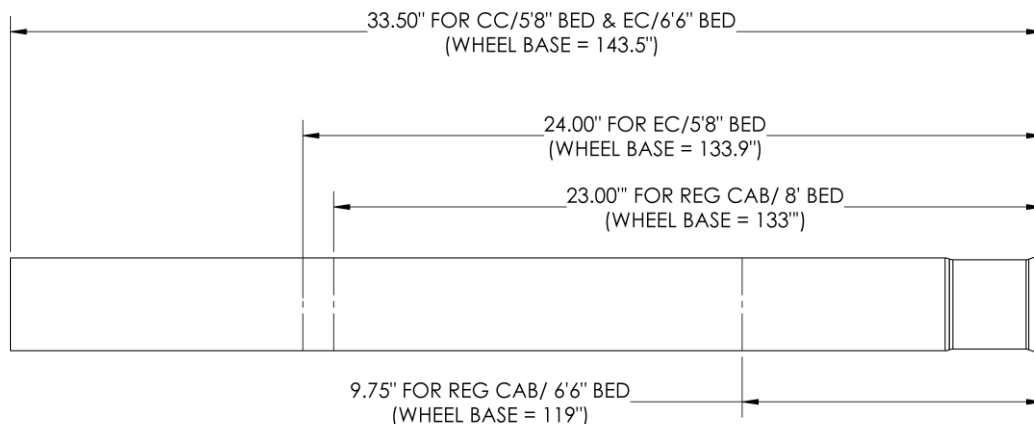

**Figure 5**

1. Apply a penetrating lubricant liberally to all exhaust fasteners, hangers and rubber insulators.
2. Remove the clamp after the catalytic converter and save the clamp for the installation. **Refer to Figure 1.**
3. Remove the hangers from the rubber insulators and remove the exhaust from the vehicle. The tail pipe can be cut to ease clearing the rear axle. **Refer to Figure 2.**
4. Remove the exhaust from the vehicle.

## Installation of MBRP Inc. Performance Exhaust:

1. Install the **Front Pipe** to the existing flange using the clamp removed earlier. Leave the hardware loose enough for some adjustment. **Refer to Figure 3.** The **Front Pipe** will not need cutting for the Crew Cab short bed or the Extended Cab long bed. The **Extension Pipe** is only required for the Extended Cab Long box. Refer to **Figure 4** for cut lengths.



**Figure 4**

2. Slide the **Hanger Clamp** onto the rear of the **Front Pipe** and into the existing rubber insulator. **Refer to Figure 5.** Also loosely install the **3" Bracket Clamp**. **Refer to Fig 5.**  
Note for the Reg cab 6'6" bed the **3" Bracket Clamp** will mount behind the **Muffler**.



**Figure 6**



**Figure 7**



**Figure 8**

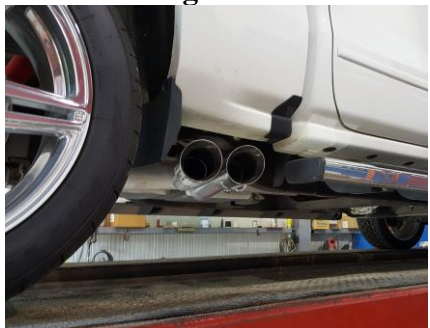

**Figure 9**

4. Using the **3" Clamp**, loosely install the **Muffler** onto the **Front Pipe** or **Extension Pipe** if used at approximately a 90 degree angle.

5. Slide **Bolt Spacer** onto the **Bolt Leader** and then thread **M10 Carriage Bolt** onto it. Fish the **Bolt Spacer** and **M10 Carriage Bolt** through the frame. Refer to **Figures 6 & 8**.

6. Repeat step 5. Refer to **Figure 7**.

Note: For extended cab models a hole may need to be drilled

7. Using a **3" Clamp**, install the **Front Tail Pipe** into the **Muffler** and into the rubber isolator shown in **Fig 7**.

8. Using a **3" Clamp**, install the **Rear Tail Pipe** into the **Muffler**, keeping the mounting tab below the **Front Tail Pipe** mounting tab and attaching with the supplied **5/16" Bolt**, **5/16 Lock & Flat Washer** and **5/16 Nut**. Refer to **Figure 7** and **Page 1**.

8. Install the **Exhaust Tips** and adjust to your liking. Refer to **Figure 9**.

9. Align all the components to ensure the **Exhaust Tips** are level and parallel, and there is clearance around the body and frame. Once everything is aligned, completely tighten all **Clamps** and **Hardware**.

10. Check along the whole length of the exhaust system to ensure that there is adequate clearance around the frame, body, running boards, fuel and brake lines or any wiring. If any interference is detected, relocate or adjust.



**Congratulations!** You are ready to begin experiencing the improved power, sound and driving experience of your **MBRP Inc.** performance exhaust system. We know you will enjoy your purchase.