

Installation Instructions

Rear Cargo Area Partition Part # 5713FW, FWA & FEM 2015-2016 Chevrolet Tahoe PPV

Do not attempt to install this product on any vehicle other than the one it is designed for and listed above!

Parts List

Item	Qty.	Part #	Description	Torque
1	1		Window Assembly & Headliner Panel (assembled)	
2	2	5713F4AA	Roof Strut	
3	1	5713F5BA	Upper Filler Panel (passenger)	
4	1	5713F5AA	Upper Filler panel (driver)	
5	1	5713F1AA	Main Panel	
6	1	5713F3BA	Close out Panel & Panel Cover (assembled)	
7	4		1/4" x 5/8" Flanged Button Head Socket Screw	10 Ft. lbs
8	7		1/4" x 3/4" Flanged Button Head Socket Screw	10 Ft. lbs
9	11		1/4" Serrated Hex Nut	
10	10		M8 x 25mm Button Head Socket Screw	17 Ft. Lbs
11	2		M8 x 35mm Button Head Socket Screw	35 Ft. Lbs
12	2		M8 Serrated Hex Nuts	
13	10		5/16" Flat Washer	
14	2		M10 x 50mm Button Head Socket Screw	
15	2		M10 Serrated Hex Nut	
16	4		3/8" Flat Washers	
17	4		#10 x 3/4" Self Drilling Screws	
18	2		Spacer Tube	

Tool Required:

Metric Sockets & Wrenches
Standard Sockets & Wrenches
Ratchet & Ratchet Extension
Standard and Metric Hex Key Set

Approximate installation time: 90 min

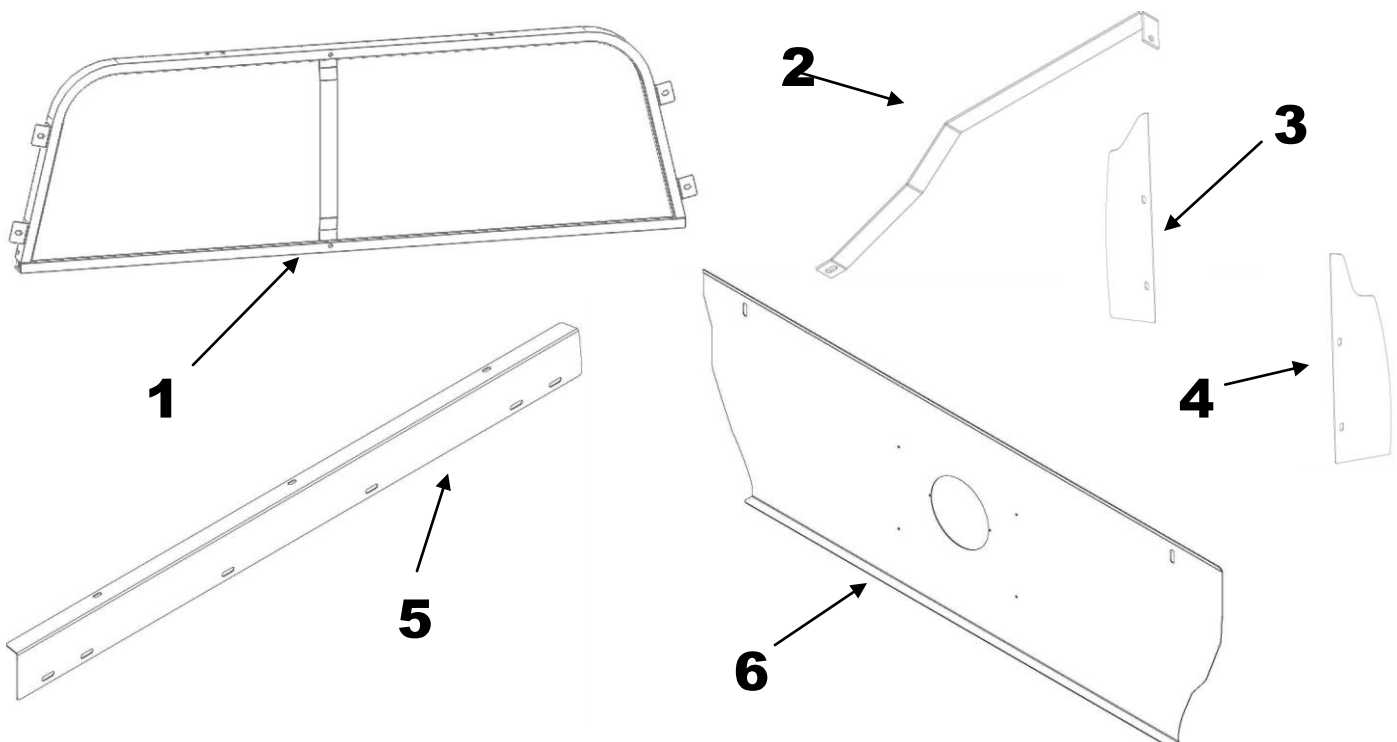

Read the assembly and installation instructions completely and verify that all of the parts listed are accounted for. If you have defective, missing or damaged parts or need assistance, please contact Go Rhino Products for fast, friendly customer service at: Phone Number / 714-257-7392 / Fax Number / 714-672-0278 / email: warranty@gorhino.com

Note: This rear partition can only be installed in conjunction with an Aedec rear seat.

Installation

Step-1 Remove the existing rear seats. Fold the seats forward, remove the carpet or mat exposing the 8 factory studs and nuts (4 per seat) securing the seats to the vehicle floor. Remove the nuts from the studs, keeping all factory hardware; remove seats from vehicle.

Step-2 Reference the installation instructions included with the Aedec seat and proceed with steps 2 through 8 of the Adece instruction sheet for installing the seat in the vehicle.

Step-3 Attach the close out panel to the tabs on the rear of the Aedec seat brace using (2) M8 x 25mm button head bolts, (2) 5/16" flat washers and (4) #10 x 3/4" self drilling screws, (Photo 1).

Step-4 Position the main panel against the back of the Aedec seat brace and using just the two lower middle holes attach the main panel to the Aedec seat brace using (2) M8 x 25mm button head bolts and (2) 5/16" flat washers. Note: The main panel upper flange should be directed toward the rear of the vehicle. Attach the driver side strut to the Aedec seat brace using (2) M8 x 25mm button head bolts and (2) 5/16" flat washers, (Photo 2). Leave the bolts loose for final adjustment.

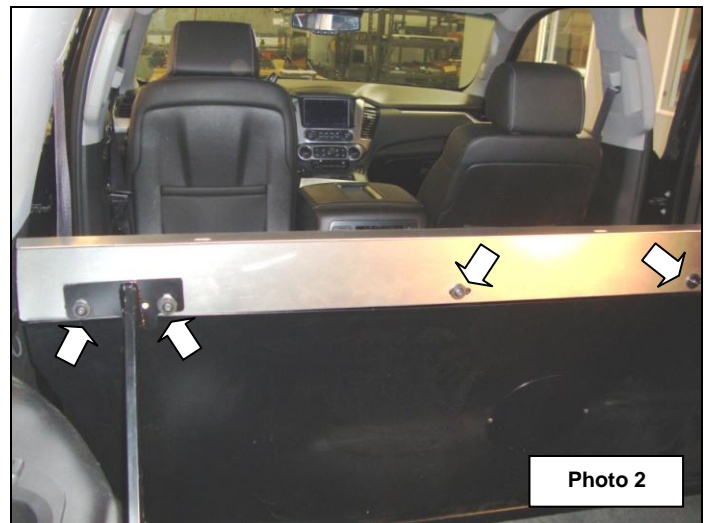
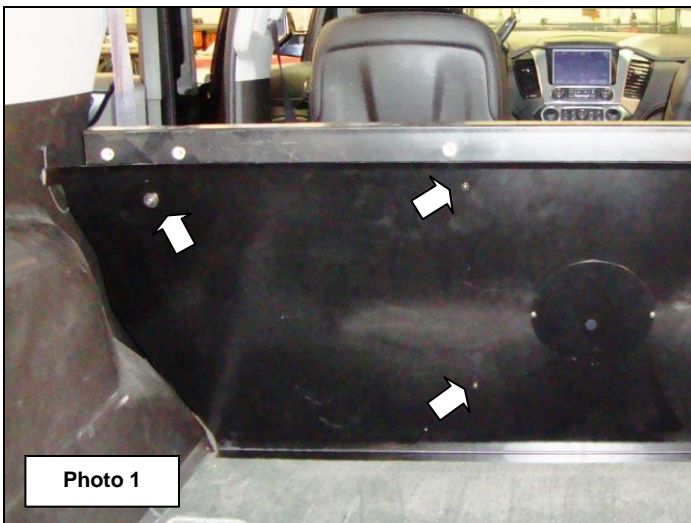

Step-5 Position the other end of the floor strut over the hole in the floor of the vehicle, and attach the strut to the floor using (1) M10 x 50mm button head bolt, (2) M8 flat washers with a washer on each side and (1) M10 serrated hex nut, (Photo 3 & 4). **Note:** The hole is not threaded so the bolt will slide through the hole and extend out the bottom of the floor pan above the rear shock absorber. This process may take two people to complete. Repeat this step for the passenger side. **Note:** when positioning the strut over the hole in the floor of the vehicle it may be necessary to use a significant amount of force to push it over the hole. With both struts fastened, tighten all bolts securely.

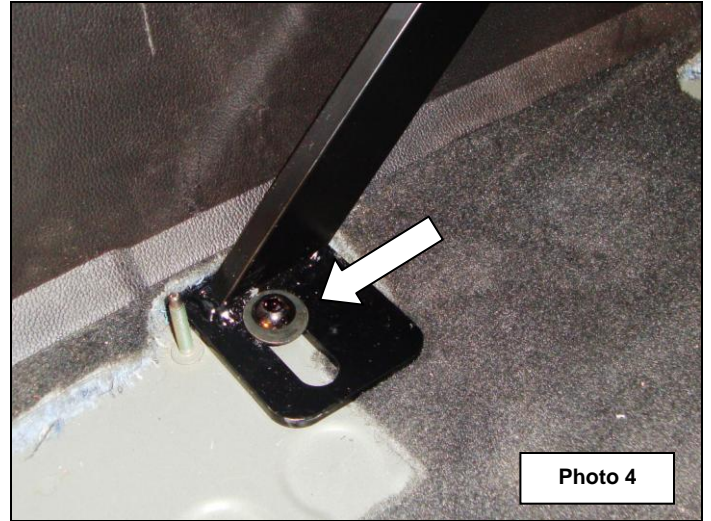

Step-6 With assistance move the window assembly with the attached headliner filler panel into the vehicle. Position the window frame bottom rail on top of the main panel flange and align the (3) attachment holes in the window frame rail with the holes in the main panel. Attach the window frame rail to the main panel using (3) 1/4" x 3/4" button head screws and (3) 1/4" serrated hex nuts, (Photo 5). Leave the screws and nuts loose for final adjustment.

Step-7 Next install roof braces. To do this, first remove the plastic trim piece at the top back of the vehicle, (Photo 6).

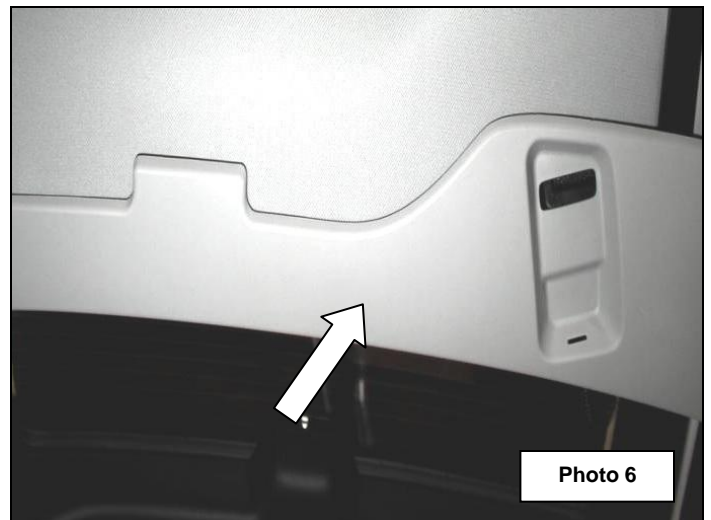

Step-8 Turn the plastic trim piece over to expose the side that attaches to the vehicle. Remove the red retainer clip from the outside tower and move it to the inside tower, (Photo 7). Next grind or cut the outside tower off of the part. Be careful not to cut or grind through the part. Just make it flush with the inside of the trim piece.

Step-9 Remove the red retainer clips from the two outside towers and move them to the inside towers, (Photo 8). Next grind or cut the outside towers off of the part. Be careful not to cut or grind through the part. Just make them flush with the inside of the trim piece. Set the trim piece aside until finished attaching the roof struts.

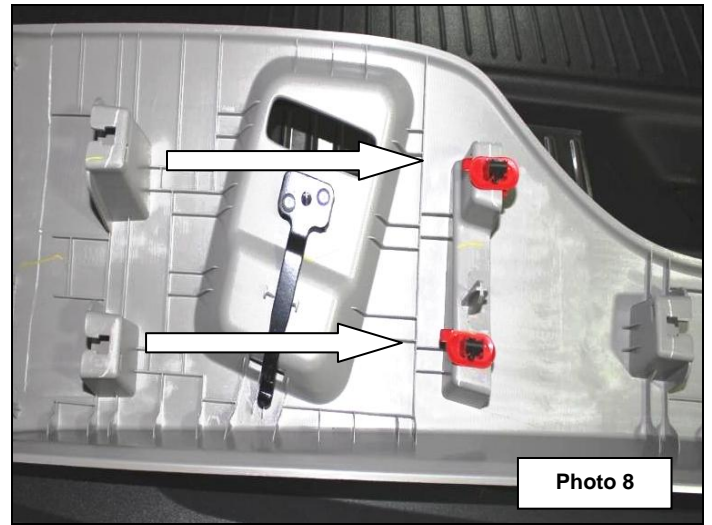
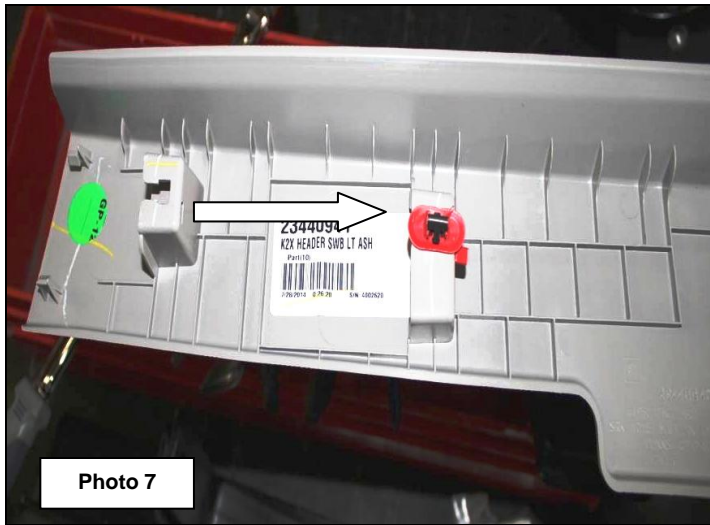

Step-10 Attach one of the roof struts to the partition headliner panel using (1) M8 x 25mm button head bolt and (1) 5/16" flat washer, (Photo 9). Leave the bolt loose for final adjustment.

Step-11 Assemble one of the M8 x 35mm button head bolts and 5/16" flat washers. Position the bolt through the hole in opposite end of the roof strut, then slide (1) spacer over the bolt, (Photo 10).

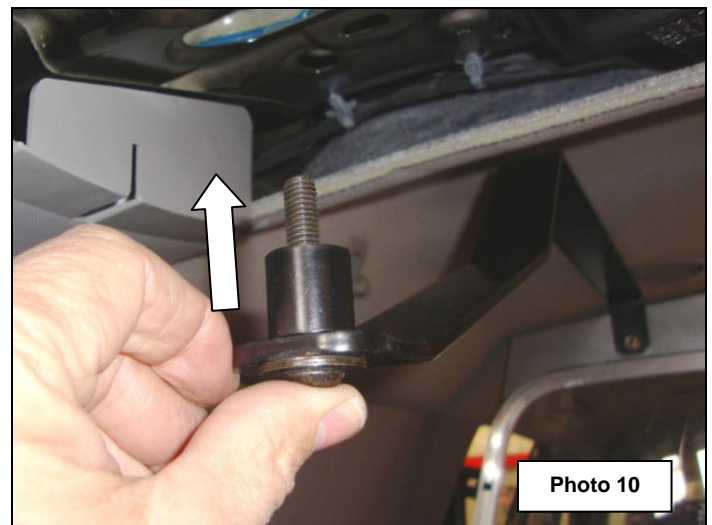
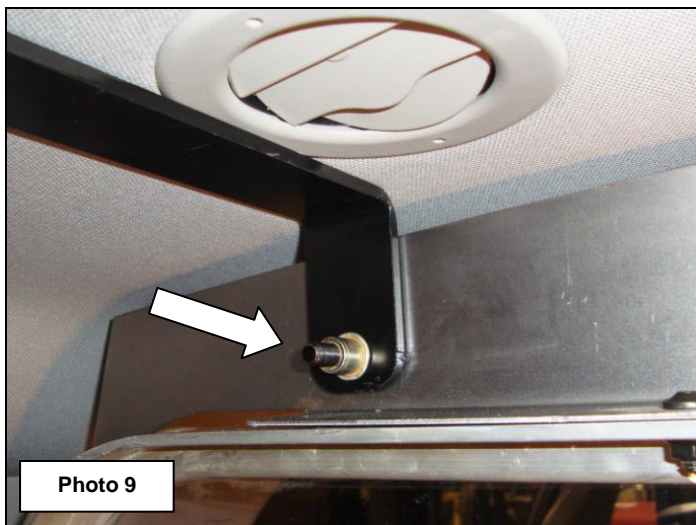

Step-12 Position the bolt through the small hole in the back of the roof of the vehicle, and install (1) 8mm serrated hex nut onto the bolt to secure the assembly, then tighten all nuts and bolts, (Photo 11 & 12). Repeat steps 10-12 for the other side.

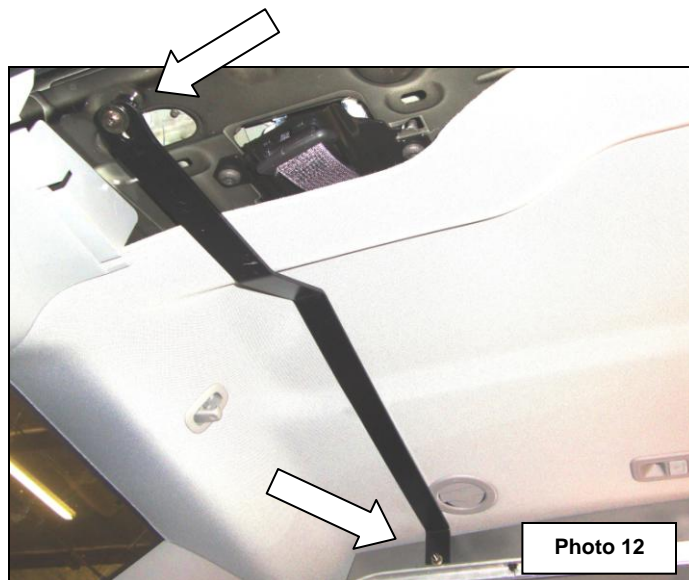
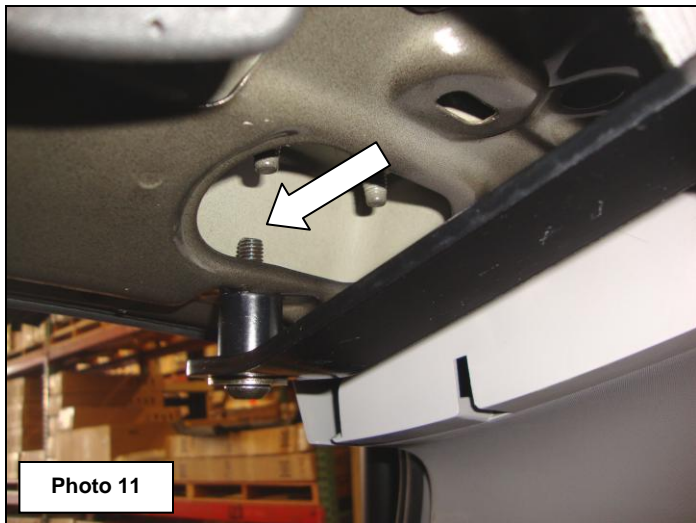

Step-13 Reinstall the plastic trim in the back of the vehicle.

Step-14 Align the attachment holes in the driver side upper filler panel with the holes in the mounting tabs and secure the upper filler panel to each tab using (1) 1/4" x 5/8" button head screw and (1) 1/4" serrated hex nut,(Photo 13). Repeat to install the passenger side upper filler panel.

Step-15 Tighten all nuts and bolts securing the partition assembly.

Step-16 Reference the installation instructions included with the Aedec seat to complete the seat installation.

