

Installation Instructions

Rear Cargo Area Partition Part # 5712FW, FWA & FEM 2013-2016 Ford Interceptor Utility

Do not attempt to install this product on any vehicle other than the one it is designed for and listed above!

Parts List

Item	Qty.	Part #	Description	Torque
1	1		Window Assembly	
2	2	5702F2BA	Upper Bracket	
3	1	5702F52	Upper Filler Panel (passenger)	
4	1	5702F51	Upper Filler panel (driver)	
5	1	5712F6AA	Main Panel	
6	1	5712F6BA	Closeout Panel & Panel Cover (assembled)	
8	4		1/4" x 3/4" Hex Head Bolt	8
9	4		1/4" x 5/8" Flanged Button Head Socket Screw	9
10	3		1/4" x 3/4" Flanged Button Head Socket Screw	10
11	2		1/4" x 1 1/4" Button Head Socket Screw	11
12	2		1/4" Flat Washer	12
13	13		1/4" Serrated Hex Nut	13
14	2		1/4" Rubber Washer	14
15	5		M8 x 25mm Button Head Socket Screw	15
16	5		5/16" Flat Washer	16
17	4		#10 x 3/4" Self Drilling Screws	17

Tool Required:

Metric Sockets & Wrenches
Standard Sockets & Wrenches
Ratchet & Ratchet Extension
Standard Hex Key Set
Drill Motor
9/32" Drill Bit
Spring Clamps

Approximate installation time: 60 min

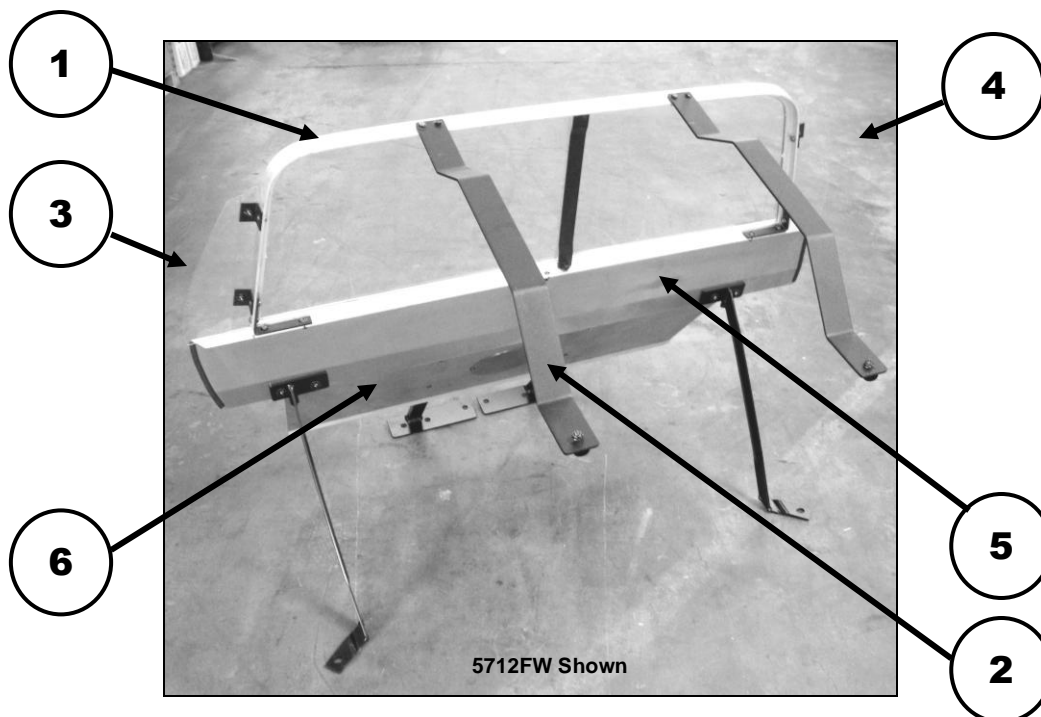

Read the assembly and installation instructions completely and verify that all of the parts listed are accounted for. If you have defective, missing or damaged parts or need assistance, please contact *Go Rhino Products* for fast, friendly customer service at: Phone Number / 714-257-7392 / Fax Number / 714-672-0278 / email: warranty@gorhino.com

Note: This rear partition can only be installed in conjunction with an aedec rear seat.

Installation

Reference the installation instructions included with the aedec seat and proceed with installing the seat in the vehicle. Note: Do not fully tighten the bolts securing the seat strut brackets to the vehicle or to the seat rear crossbar.

Step-1 Remove the Screws (2) per side securing the aedec seat strut bracket to the seat crossbar.

Step-2 With assistance, move the partition main panel into the vehicle. Note: The main panel upper flange should be directed toward the rear of the vehicle.

Step-3 Position the partition main panel bottom flange between the strut brackets and the seat crossbar, align the holes and secure the strut brackets and partition main panel to the seat crossbar using the (5) M8 x 25mm button head screws and (5) 5/16" flat washers supplied with the partition, (Photo 1). Leave the screws loose for final adjust.

Step-4 Position the upper brackets on the topside of the window frame, align the attachment holes in the upper bracket with the holes in the window frame and secure each upper bracket using (2) 1/4" x 3/4" hex bolts and (2) 1/4" serrated hex nuts, (Photo 2). Leave the bolts and nuts loose for final adjustment.

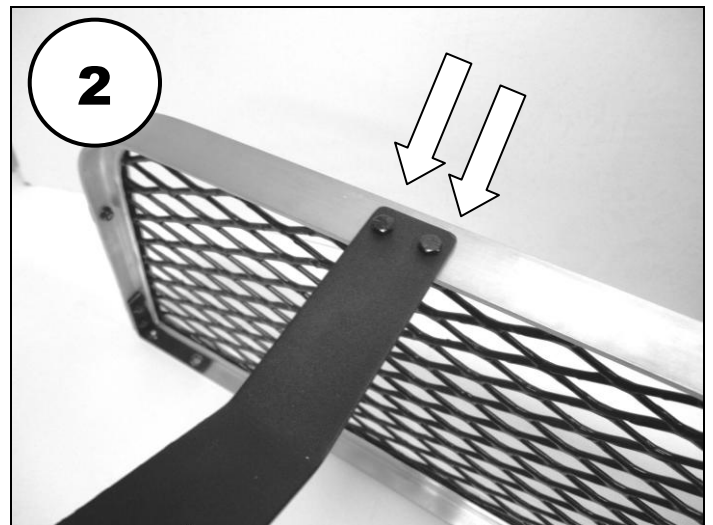
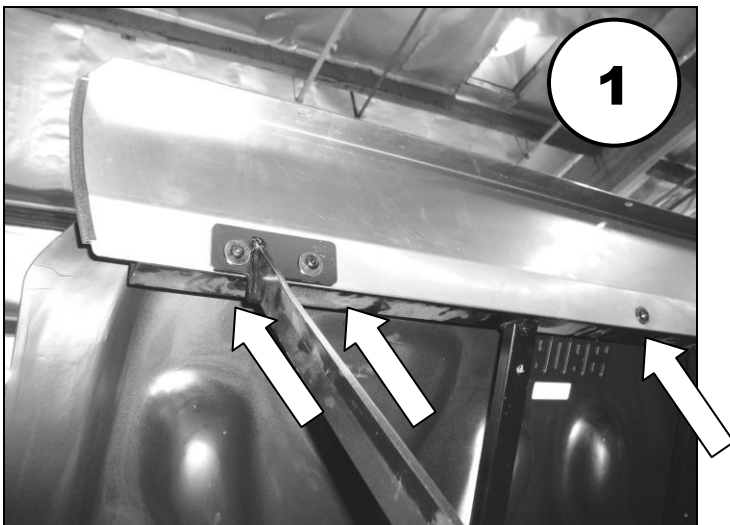

Step-5 With assistance move the window assembly with the attached upper brackets into the vehicle. Position the window frame bottom rail on top of the main panel flange and align the (3) attachment holes in the window frame rail with the holes in the main panel. Secure the window frame rail to the main panel using (3) 1/4" x 3/4" button head screws and (3) 1/4" serrated hex nuts, (Photo3). Leave the screws and nuts loose for final adjustment.

Step-6 Align the end of one of the upper brackets with the hatch opening at the back of the vehicle. Make sure the bracket is straight and clamp it in place. Use the hole in the upper bracket as a guide and drill a 9/32" hole through the head liner and hatch opening, (Photo 4). Secure the upper bracket using (1) 1/4" x 1 1/4" button head screw, (1) 1/4" flat washer, (1) 1/4" rubber washer (place the rubber washer on the outside) and (1) 1/4" serrated hex nut. Tighten the nut and screw and repeat for the other side

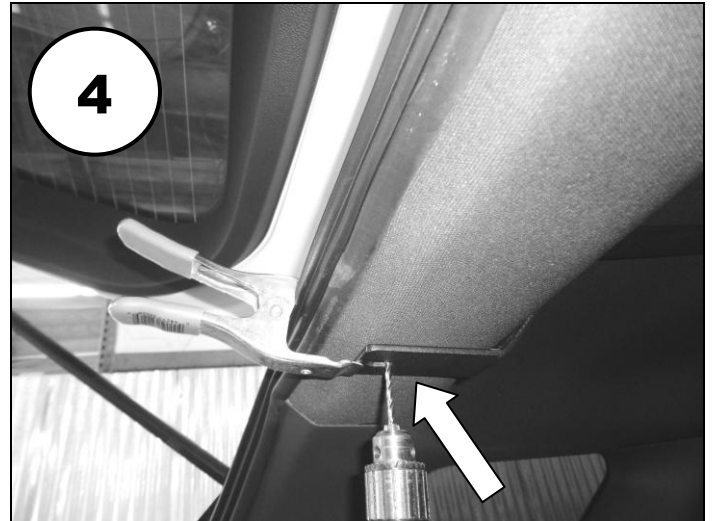
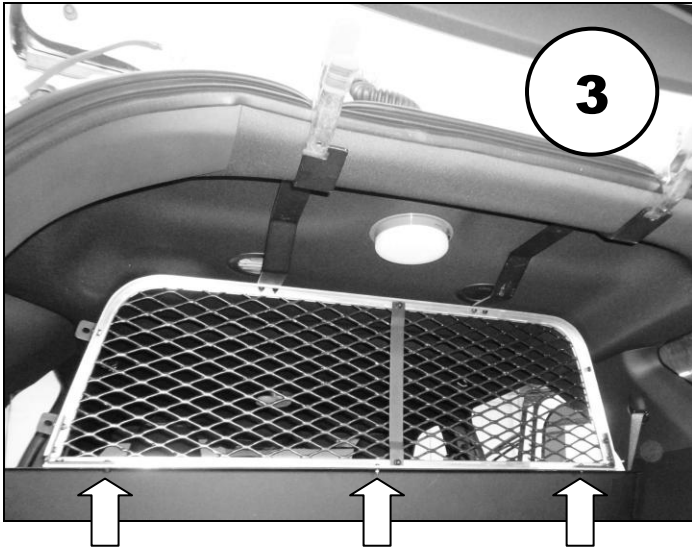

Step-7 Align the attachment holes in the passenger side upper filler panel with the holes in the mounting tabs and secure the panel to each tab using (1) 1/4" x 5/8" button head screw and (1) 1/4" serrated hex nut,(Photo 5). Repeat to install the driver side upper filler panel.

Step-8 Install the rear closeout panel. Position the closeout panel against the rear of the seat crossbar, check the alignment and secure the closeout panel to the crossbar using (4) #10 self drilling screws.

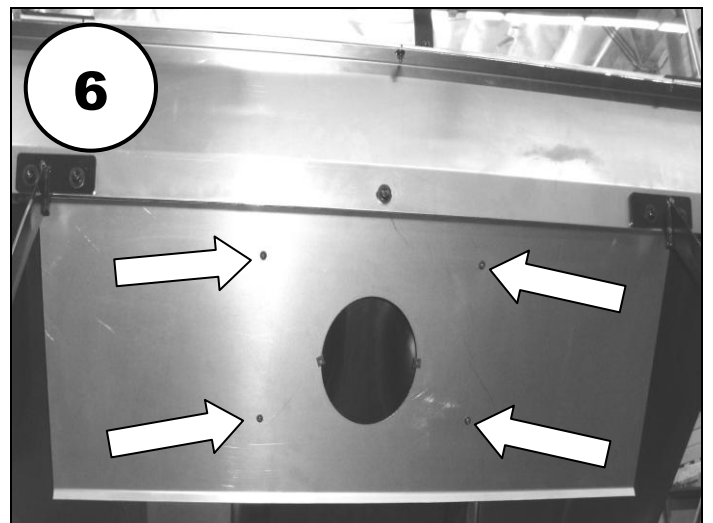
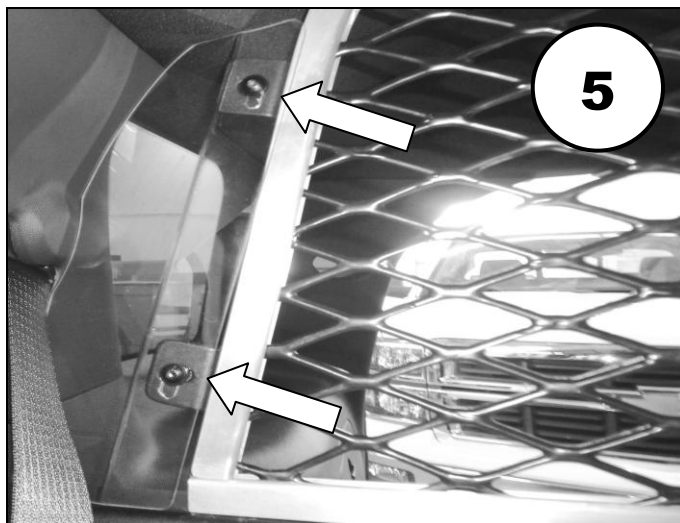

Step-8 Tighten all supplied and factory nuts, screws and bolts.