

**PARTS LIST** \* may require drilling

QTY	PARTS	QTY	PARTS	QTY	PARTS
16	8mmx25mm Bolts	8	5/16" Carriage Bolts	4	Brackets Driver
16	5/16" Flat Washers	8	5/16" Flange Nuts	4	Brackets Passenger
16	5/16" Lock Washers	8	Bracket Clamps		

(866) 476-6276 / (866) IRONCROSS

[www.ironcrossautomotive.com](http://www.ironcrossautomotive.com)

4942 E. 66th Street North

Tulsa, OK 74117

IRON CROSS AUTOMOTIVE INC. 2007

**STEP 1** Remove contents from box and check for missing or damaged parts. Verify all parts are present, making sure to read and understand instructions before beginning installation.

**STEP 2** Mount brackets to pinch weld and body panel.

- 1) Locate factory threaded holes on rocker panel and pinch weld that line up with bracket slots.
- 2) Remove black plastic plugs.
- 3) Install bracket using 8mm bolt and 5/16 flat washers and lock washers.
- 4) Thread a 8mm x 25mm hex bolt and 5/16" flat washer through top bracket slot into threaded hole.

**DRIVER SIDE BRACKET****PASSANGER SIDE BRACKET****BEND IN BRACKET SHOULD FACE REAR OF TRUCK.**

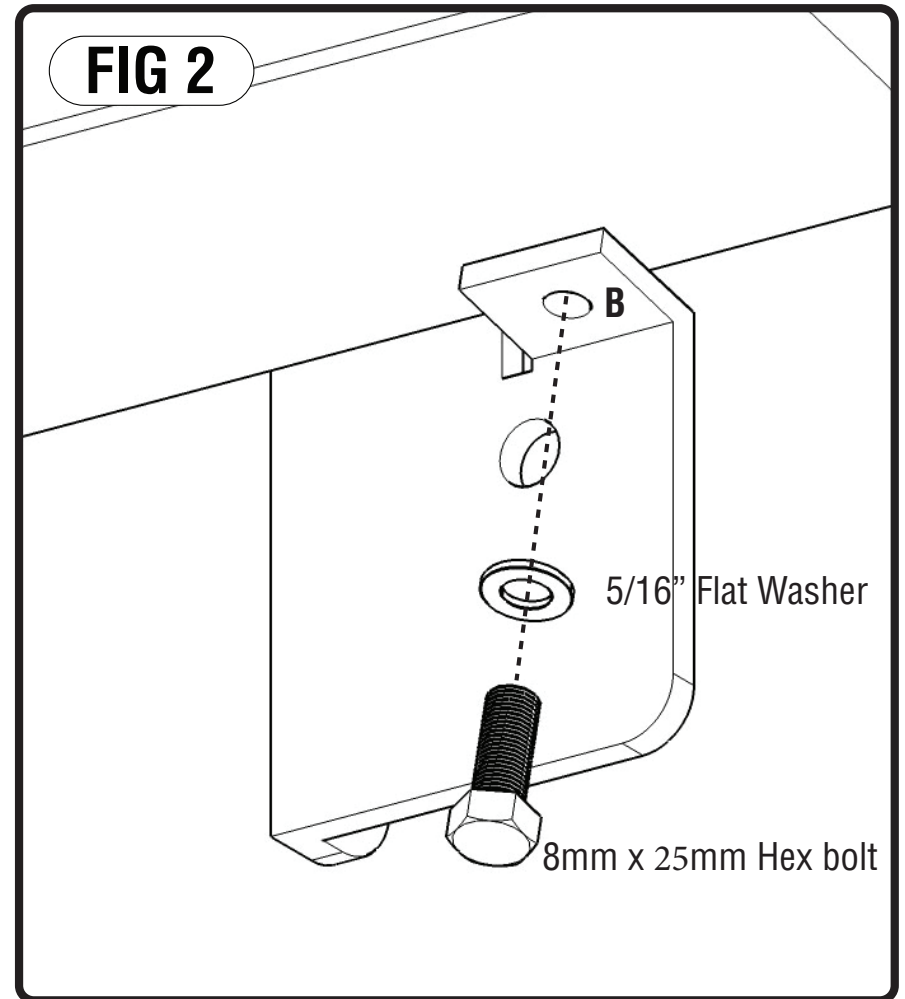
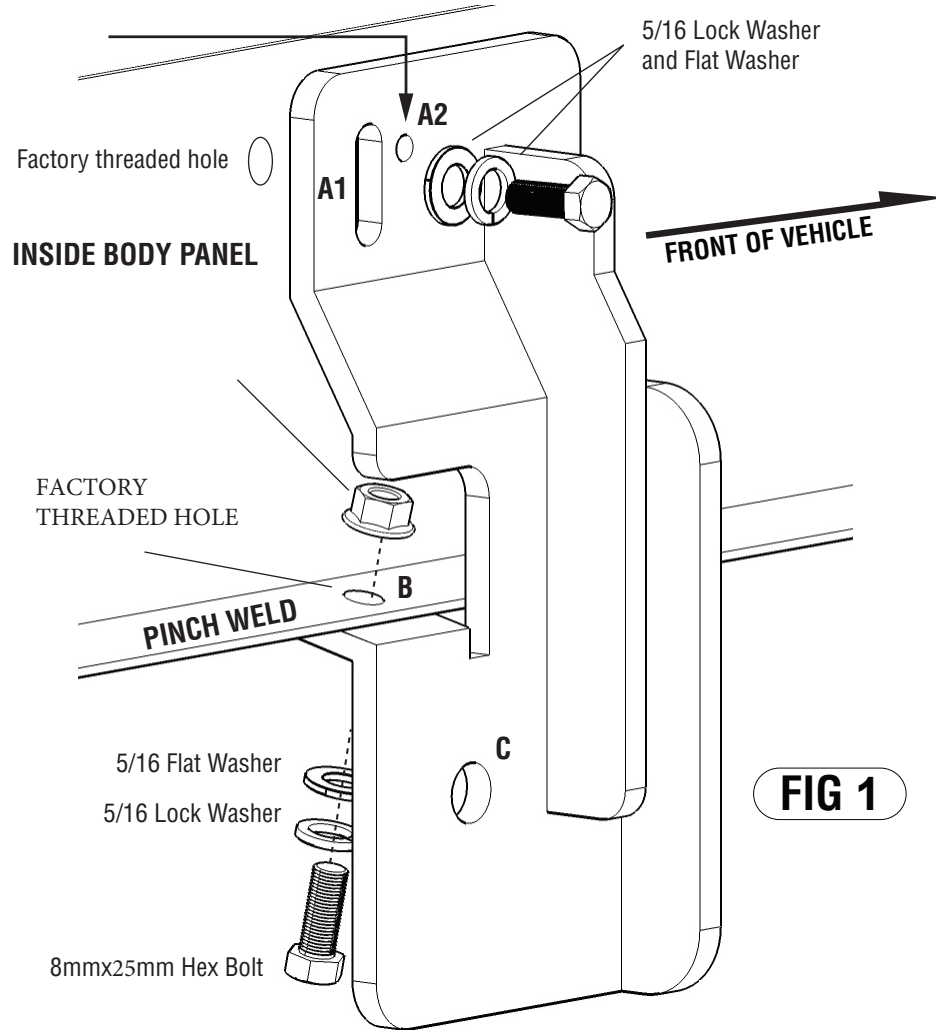

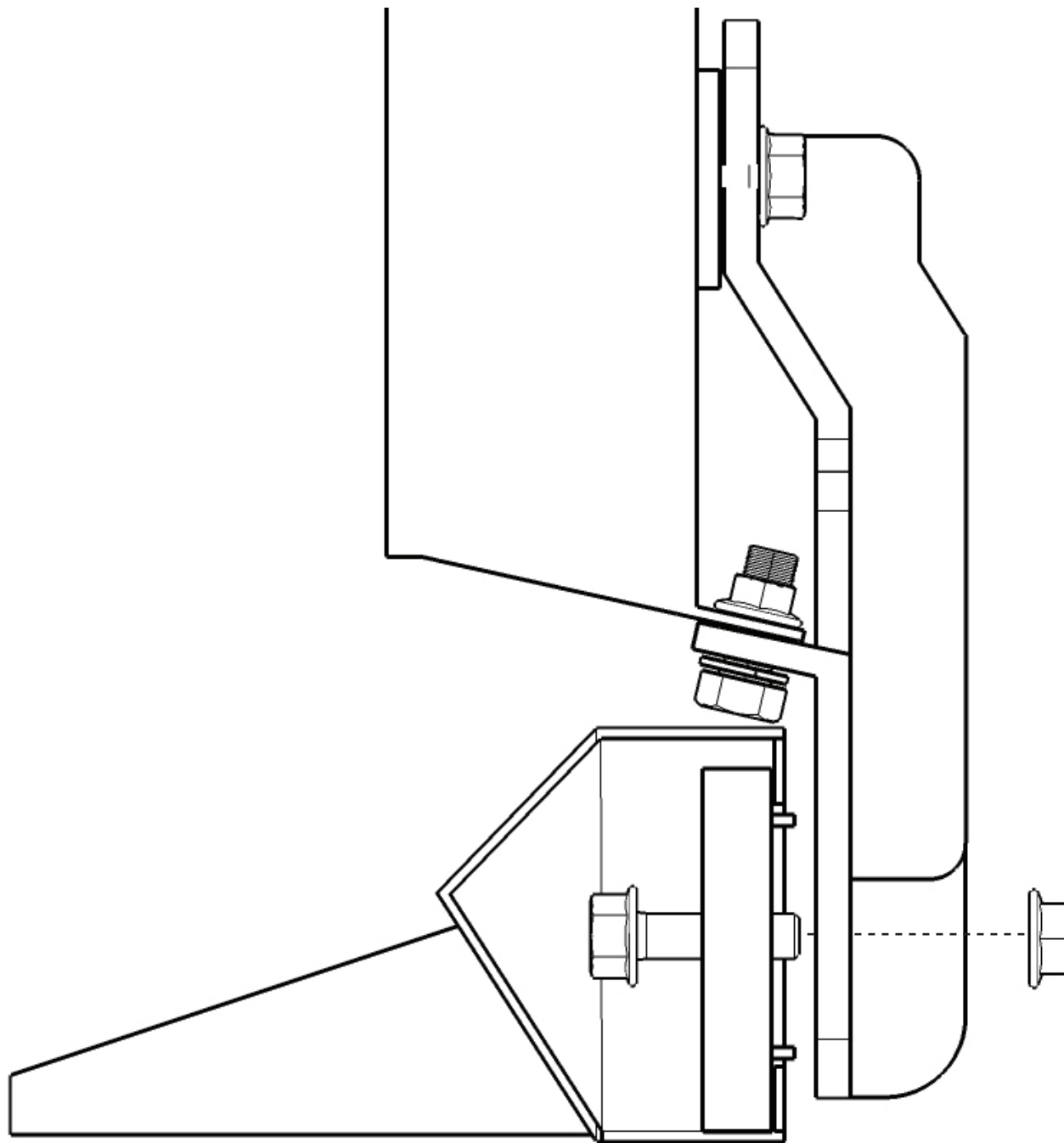

## HD STEP INSTALL

1. Install 5/16" hardware and "bracket clamp" to each bracket through hole "C. Having a second person or jack stands will be helpfull on install.
2. CAREFULLY place HD STEP over bracket clamps and align so that clamp tabs are in between step channel. Begin to hand tighten 5/16" flange nuts while making sure bracket clamp tabs are aligning to the bracket holes.
3. Once you have all clamps hand tightned to brackets, this should allow the HD STEP to slide forward and back to allow for final alignment to vehicle.
4. Once satisfied with alignment, tighten all 5/16" flange nuts for final install.