



INSTALLATION INSTRUCTIONS

MAKE: GM
MODEL: Silverado HD/Sierra HD
YEAR: 2015.5
ENGINE: V8-6.6L (td) LML
WHEELBASE: All except Cab & Chassis

4" DP-Back Aluminized
49-04052 (No Tips)
4" DP-Back Stainless Steel
49-44052-P (Polished Tips)
49-44052-B (Black Tips)



THIS PART DOES NOT HAVE CARB EO EXEMPTION

This is a "Race Only" Product in California and all other states that follow CARB regulations. Any use on street and highway could be in violation of local and state laws in these states. Call aFe Power for current EO exemption status.

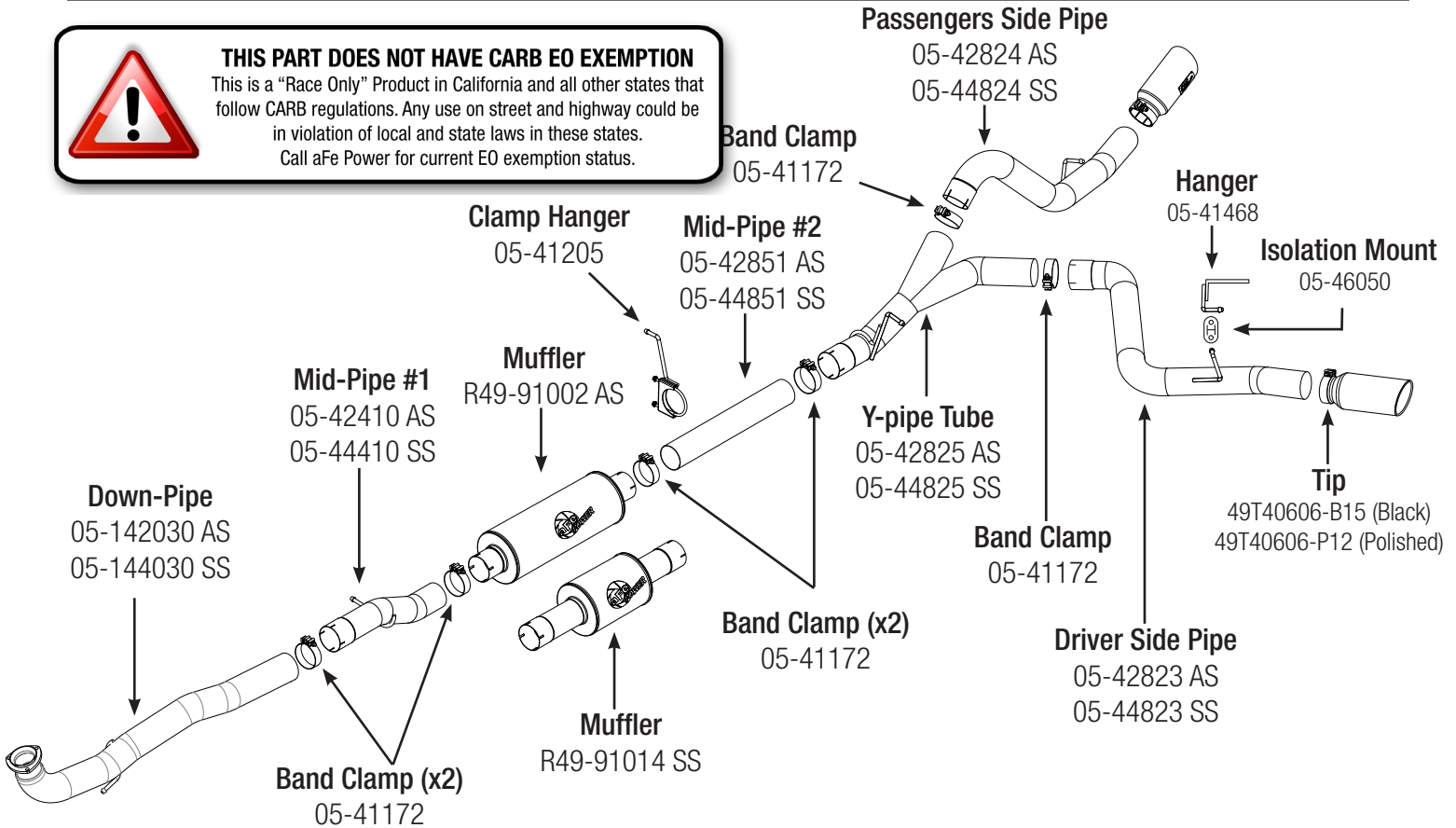

Professional installation is highly recommended. (Read instructions prior to installation) This system requires an aftermarket electronic module to work properly with the vehicle.

- Step 1:** First start by disconnecting all sensors attached to the entire exhaust system. Take caution not to damage any sensors or factory isolation mounts. Make sure to have a stand or jack under the exhaust system to support it before it's all disconnected. Removal of isolation mounts may require using a spray lubricant such as WD40 and a pry bar.
- Step 2:** Unbolt the four (4) OE bolts connecting your DPF to your catalytic converter. Save the bolts. Unhinge the isolation mounts from the exhaust. Remove the DPF and tailpipe from your vehicle. Please note the DPF and tailpipe are one piece. To remove the entire section without cutting you will need to have your vehicle on a lift in order to remove it in one piece. If not, you may choose to cut the exhaust in two sections (not recommended).
- Step 3:** Removal of your factory turbo down pipe and catalytic converter. This will require you to support your transmission with an adjustable jack stand or high-position hoist stand for a vehicle lift. You will need to remove the two transmission mounts from the cross member using and 18mm deep socket wrench. Once removed lift your transmission approx. 1" higher so the bolts separate from the cross member.
- Step 4:** With the transmission supported you will need to remove the cross member from the frame. Using a 21mm deep socket and 21mm socket or wrench loosen and remove all four (4) bolts. You can then safely remove your cross member.
- Step 5:** Next remove the hanger support bracket attached to the transmission. Now you can remove and install your down pipe in 1 pc. by sliding it to the rear and pulling it downward in between the transmission and cross member frame support. Secure the pipe to the turbo down pipe and transmission support bracket. Do not completely tighten yet.

NOTES: aFe recommends that the tail-pipe be at least 1/2"-1" away from any body panels to avoid heat related body damage. **Tighten and secure.**

Caution: Allow time for your vehicle to cool down prior to installation. When working on or under your vehicle proceed with caution. Exhaust systems reach high temperatures and may cause serious burns. Wear protective safety equipment; eye goggles and gloves to ensure a safe installation. **aFe recommends professional installation on our products.**

(Continue From Page 1)

- Step 6:** Follow these instructions to install your exhaust and secure your transmission.
- Step 7:** For faster installation have your exhaust components alongside your vehicle according to the diagram above.
- Step 8:** Install your mid-pipe and muffler along with the necessary band clamps required to secure them into place. Do not completely tighten yet.
- Step 9:** Install the passenger side tailpipe utilizing the factory isolation mounts.
- Step 10:** Install the "Y-pipe" tube onto the passenger tailpipe. Use the factory isolation mount to hang the Y-pipe in position.
- Step 11:** Install the passenger side tailpipe utilizing the factory isolation mounts.
- Step 12:** Install the "Y-pipe" tube onto the passenger tailpipe. Use the factory isolation mount to hang the Y-pipe in position.
- Step 13: Requires Cutting** Depending on your wheelbase the straight pipe may need to be trimmed to length. With the tailpipe and Y-pipe in position measure the distance from the end of the DPF to the inlet of the Y-pipe. You will need to add 6" inches to the length of the straight-pipe so it can slip into the Y-pipe. **(Measure twice cut-once).**
- Step 14:** Push back the tailpipe and install the straight pipe. Slip the tailpipe on and slightly secure the pieces together using band clamps. Do not completely tighten.
- Step 15:** Mount the driver side tailpipe hanger bracket. Use the two factory mounts on the frame that secure the trailer hitch. Loosen the bolts and install bracket. Re-tighten the bolt when completed. (See figure A).
- Step 16:** Install the driver side tailpipe, slip the tailpipe onto the Y-pipe and hang it on the isolation mount. Slightly secure the tailpipe into position.
- Step 17: Spare tire clearance** Included in the kit is a **ratcheting strap**. Slightly loosen the spare tire so it hangs from the bed. Attach the strap to the inner frame and wrap it around the spare tire securing it to the opposite inner frame. Position the spare tire in the center of the two tailpipe. Tighten the strap so it pulls the spare tire to the rear of the bed or against hitch. Tighten the spare tire into position locking it place. **(See figure C).**
- Step 18: Parking & brake line clearance** For additional clearance remove the brake line bracket attached to the rear differential cover. Position the emergency brake line behind the bracket. Re-attach the brake line bracket to the housing. Bend the brake line bracket back so it changes the angle of the hoses. This will create additional clearance from the exhaust. (See figure B).



(figure A)



(figure B)



(figure C)



(figure D)

NOTES: aFe recommends that the tail-pipe be at least 1/2"-1" away from any body panels to avoid heat related body damage. **Tighten and secure.**

Caution: Allow time for your vehicle to cool down prior to installation. When working on or under your vehicle proceed with caution. Exhaust systems reach high temperatures and may cause serious burns. Wear protective safety equipment; eye goggles and gloves to ensure a safe installation. **aFe recommends professional installation on our products.**