



**LOADHANDLER PRODUCTS CORPORATION**

342 Fourth Street, Libertyville, IL 60048

Phone: (800) 580-0791 / (847) 362-1031 FAX: (847) 932-4044

**[www.loadhandler.com](http://www.loadhandler.com)**

## **LOADHANDLER® MODELS**

# **LH2200 (full-size) LH2200M (mid-size)**

## **INSTRUCTION MANUAL**

**PLEASE READ THE ENTIRE MANUAL!** Although the Loadhandler® is a simple tool, unloading heavy or bulky loads from your truck can create unusual conditions. Please read all documents to ensure the proper assembly and operation of your Loadhandler®.

**NEVER OVERLOAD YOUR VEHICLE. IT IS DANGEROUS!**

U.S. Patent Numbers 5,340,266 and 5,915,911

Canada Patent Number 2,183,964

Other U.S. and foreign patents pending

## PARTS LIST

Note:            DS = Driver Side                      PS = Passenger Side

- 3        Roller Bar sections (DS & PS sections have Red End Caps)
  - A. DS with slot for handle insertion
  - B. Middle section (both ends open for "slug" insertion)
  - C. PS
- 2        Roller "Slugs" for attaching Roller Bar sections
- 1        Dragsheet
- 1        Duct Tape Roll for attaching Dragsheet to Roller
- 2        Velcro Travel Straps to hold Dragsheet in rolled up position
- 2        Bearing Brackets with short straps & buckles
- 1        DS outside Bracket w/ long strap, warning label & buckle for Bumper Tie-Down
- 1        PS outside Bracket w/ long strap
- 1        Bumper Tie-Down for use when tailgate down & ready to crank handle
- 4        Shaft Collars
- 1        Crank Bar
- 1        Hex Bolt w/ 2 Nuts and plastic sleeve for handle grip
- 1        Bag of Fasteners - contains 2 Bolts 3/8" x 1 1/2", 4 Washers 3/8", 2 Nuts 3/8", 4 Round Head Screws #8 1" and 4 Square Nuts #8

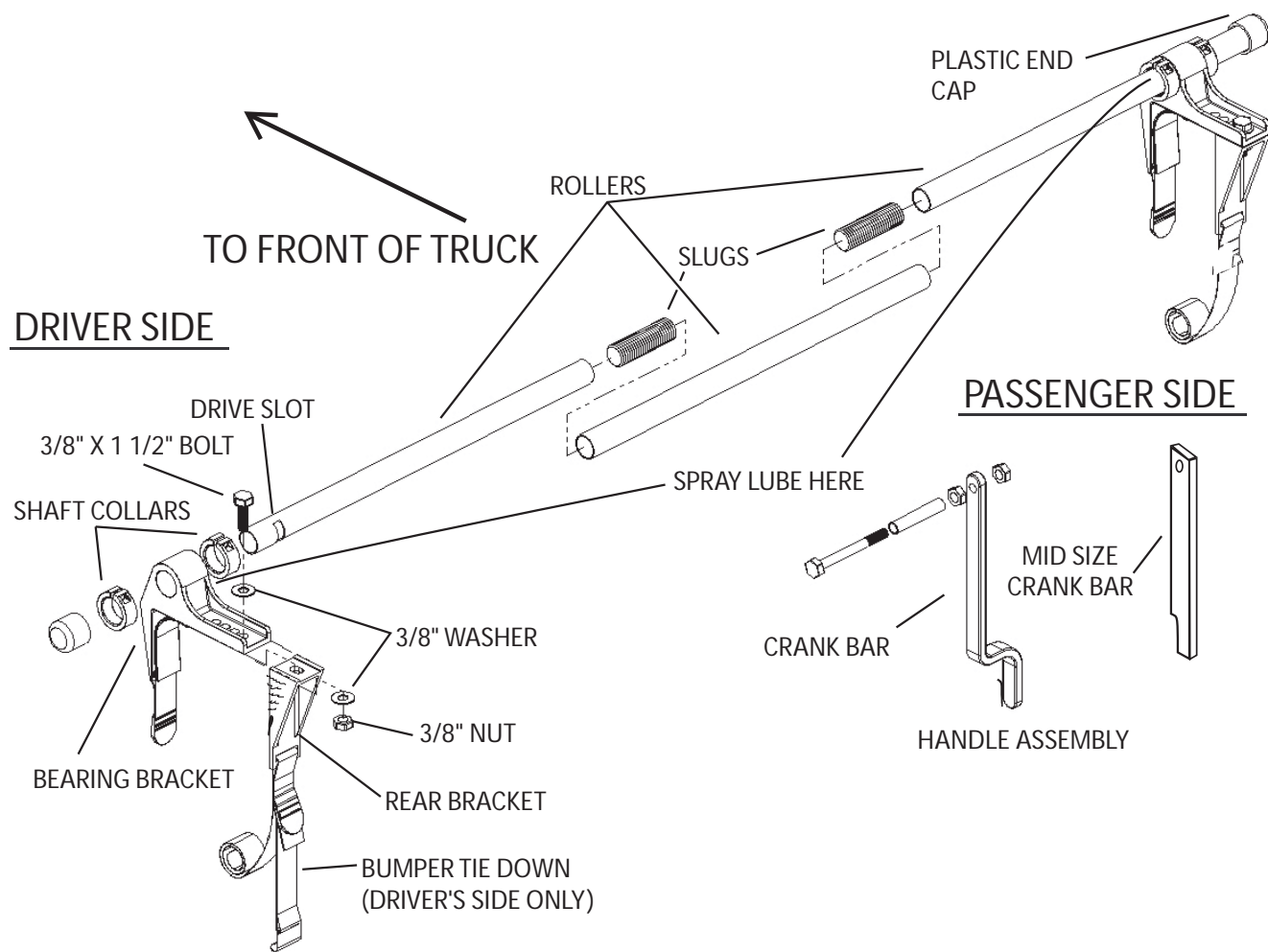
DRIVER SIDE

**DOUBL-MAT®**  
by Loadhandler Products



Call for assistance  
800-580-0791

**DOUBL-MAT® FITS ALL FULL-SIZE TRUCKS & TRIMS TO FIT  
ALL MID-SIZE OR COMPACT TRUCKS**

Dimensions: 4' X 8', 1/4" thick Weight: 32 lbs.

The **Doubl-Mat®** is the number one solution to bed lining and the only reversible bed-mat on the market. Loadhandler's **Doubl-Mat®** combines a ribbed rubber surface to reduce load shifting with a high density **polyethylene (HDPE)** surface for easier loading and unloading. Unlike rubber bed mats that must be removed when loading and unloading heavy cargo, the **Doubl-Mat® HDPE surface** allows you to slide your load, providing **crucial bed protection** when damage is most likely to occur.

**Important:**

If your pickup bed is rusty, or has a non-slip spray-in liner, you must have the Doubl-Mat® (or similar slip-liner) in order to use the Loadhandler®. If your pickup bed is in good shape or you have a plastic liner, you do not need the Doubl-Mat® in order to use the Loadhandler®.

**Benefits of the Doubl-Mat®**

- The rubber side provides a non-slip surface to stabilize cargo.
- The HDPE side provides a low friction surface that reduces the effort required to load or unload cargo.
- The Doubl-Mat® is ideal for use with all Loadhandler® pickup truck unloaders. The Doubl-Mat® HDPE surface reduces the Loadhandler® crank force and is ideal for any truck, especially those with damaged beds.

## MAIN ASSEMBLY

1. Assemble the Roller Bar. Screw in Slugs as far as they will go into either end of the Middle Roller Bar section. Screw in DS & PS Roller sections as far as they will go. The Roller sections will meet in the middle of each Slug.

NOTE: It is not necessary to overly tighten the Roller sections.

The first time you unload with the Loadhandler®, the torque will tighten them the rest of the way.

Also note that DS of Roller has slot for handle. Have the DS of Roller to your left for rest of assembly, as if you were approaching rear of truck to install the Loadhandler®. A lowered truck tailgate makes a good assembly tabletop.

2. Unfold Dragsheet and attach to Roller with Duct Tape. Align the edge of the 15' length of Dragsheet to marker on DS of Roller. Apply tape in horizontal line across 50" width of Dragsheet (42" width on Mid-Size unit) and affix to Roller.
3. Roll Dragsheet onto Roller. The direction of the roll is clockwise when facing DS Roller end from driver side. When roll-up is complete, Dragsheet unfurls counter-clockwise from top of Roller to unroll, and rolls clockwise back over the top of Roller when rewinding (un-loading).
4. Remove Red End Caps from each end of the Roller.
5. Slide one Shaft Collar onto each end of the Roller.
6. Slide a Bearing Bracket onto each end. The strap side of the Bracket goes on inside of tailgate (towards front of truck), and the rubber side makes contact with the inside of the tailgate.
7. Slide a second Shaft Collar on each end of Roller. Insert 1" Screws and Square Nuts but do not tighten all the way yet.
8. Put Red End Caps back on each end of Roller.
9. Slide the DS Rear Bracket onto DS Bearing Bracket and loosely affix Bolts, Washers and Nuts as shown. (The DS Rear Bracket has Warning Label and extra buckle to accommodate the Bumper Tie-Down.) Tailgate thickness will dictate which of 4 holes is best fit for your truck. Do not tighten yet.
10. Attach PS Rear Bracket same way as above.
11. Put together Handle Assembly as in diagram.

## INSTALLATION

1. With handle Drive Slot on left side (DS), lower Loadhandler® onto upraised tailgate so that tailgate is between the rubber pads on the brackets.
2. Slide the DS Bearing Bracket along Roller until near end of tailgate, just clear of inside wall of truck bed. Slide the PS Bearing Bracket along Roller until near end of PS tailgate (or near Red End Cap). Position unit so dragsheet is approximately centered between wheel wells. (On step-side pickups, it is best to have Dragsheet closest to DS of tailgate.)
3. Position Shaft Collars to 1/4" on either side of each Bearing Bracket. Tighten Collar screws. Collars hold the Brackets in desired position.
4. Choose best adjustment hole for each Rear Bracket. Slide each Rear Bracket toward tailgate until Brackets make snug contact inside and outside of tailgate. Tighten nuts & bolts.
5. Drop the tailgate and insert handle in DS slot. Turn handle thru full circle to make sure it clears truck. If more clearance is needed, loosen Collars and slide Roller further to DS, and then re-tighten Collars. (In rare cases, when still more clearance is needed, the Dragsheet itself may need to be moved closer to PS so more of Roller Bar is available on DS. Unfurl Dragsheet to end, remove and then re-tape an inch or two closer to PS.)
6. Spray-lubricate Roller where it passes thru each Bearing Bracket.
7. With tailgate down, feed long rear straps thru hinge gap between tailgate and truck and attach to front strap buckle as shown. Tighten straps by pulling thru buckle toward front of truck.
8. Close tailgate. Thread the Bumper Tie-Down strap upward thru DS outside buckle and back down. Hook Bumper Tie-Down metal clip to bottom of tailgate (to hold Tie-Down in place while driving). The Bumper Tie-Down is utilized only when unloading. It holds tailgate down while handle is cranked.
9. The Loadhandler® is now installed and you are ready to get load.

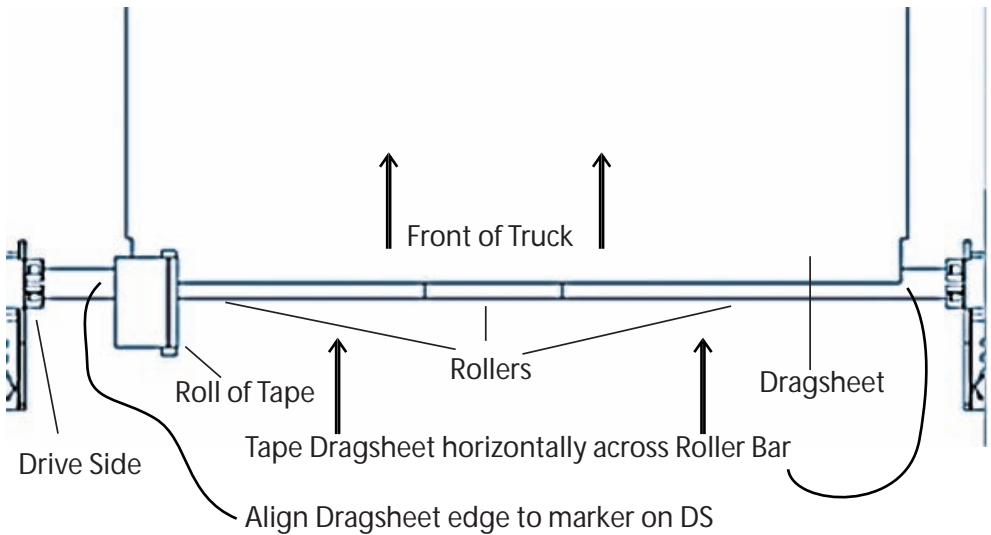
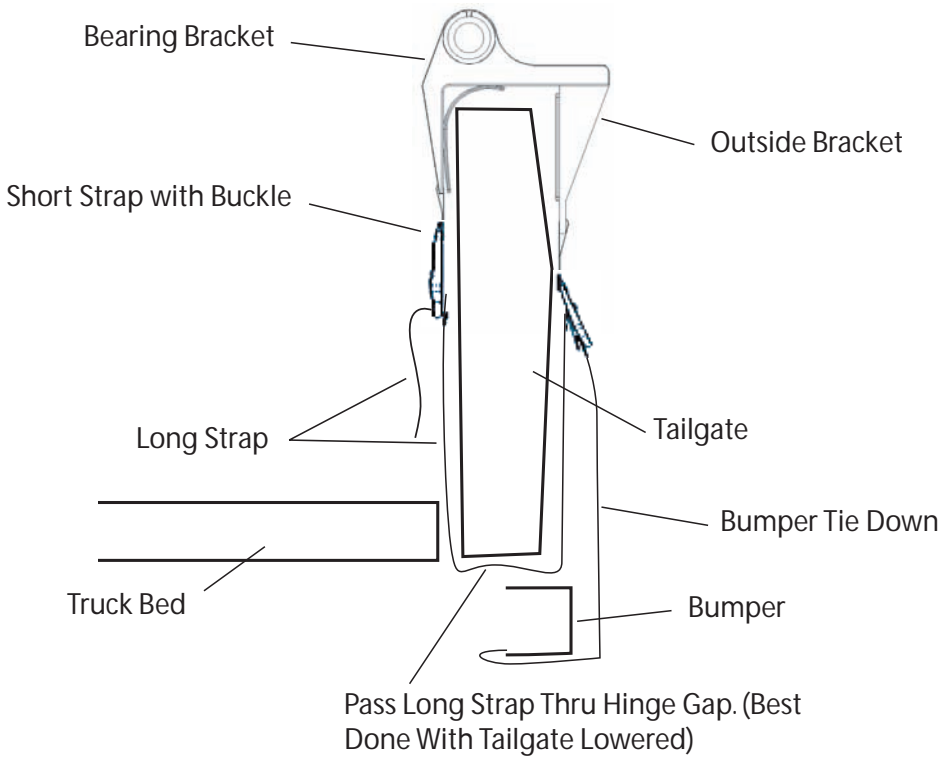

## To Load

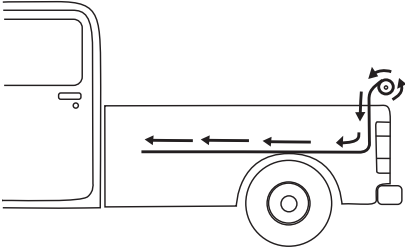

Untie Travel Straps.

Pull Dragsheet from Roller and lay on Bed Floor.

Always leave 3-4 wraps on the roller.

Load truck.

## To Unload

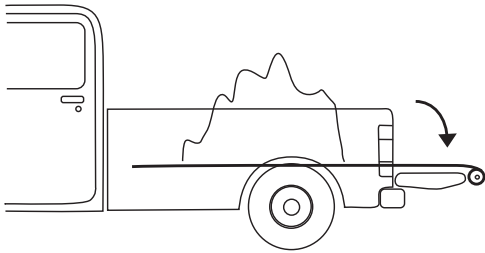

Open tailgate and spray lubricate the Bearings.

Clip Bumper Tie-Down Strap to bumper and tighten.

Insert Crank Handle into Drive Slot on Roller.

Start cranking clockwise to roll up Dragsheet and unload Truck.  
(If handle is too close to the truck, readjust roller position until handle just clears the truck.)

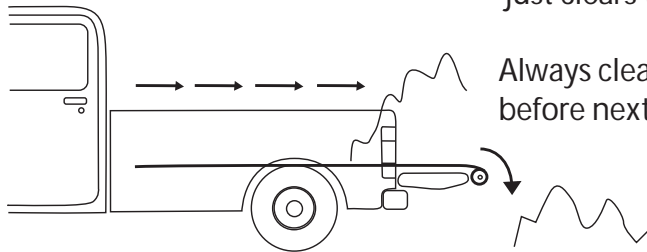

Always clean Bed of all materials before next load.

## To Remove LH2200

Loosen the two long straps and unhook the bumper strap.

Remove LOADHANDLER®.



## **TO STOP ROLLER TURNING WHILE DRIVING WITH A LOAD**

1. Press the Velcro straps together to make one long strap.
2. Feed one end of this long strap through the drive slot.
3. Wrap the strap around the bearing bracket projecting from the rear of the tailgate.
4. Pull the strap and tight press the ends of the strap together to secure them in place.

This will keep the roller from turning while you are driving with a high load and stop the dragsheet from billowing behind the truck.

It is also a good place to keep the straps when you are loaded. You'll know where they are!

## **IF YOUR LOAD DOESN'T MOVE, STOP!**

Check to see if the load is "LOCKED" around the wheel wells. Call a product specialist at (800) 580-0791 for assistance if desired.

## IMPORTANT NOTICE

If your load is stuck and will not move, please STOP! Do not force the load as you may break or permanently damage the Loadhandler® or your truck.

Here are some examples of what may be causing the problem:

1. Overloading or improper installation. Make sure load is 2200 lbs or less and that Loadhandler® is installed properly.
2. Non-slip spray-in liner, rubber mat or pitted rusty truck bed - these all cause too much friction for the dragsheet to slide properly. These non-slip surfaces must be covered with a hard, smooth surface. A sheet of hard plastic, masonite, linoleum, wood paneling, etc., all work well. Or consider purchasing the Doubl-Mat® by Loadhandler Products, a reversible mat that is both a "slip-liner" on one side and a protective, non-slip mat on the other side (4' x 8'). See later pages for more details on Doubl-Mat®.
3. "Locked Load" - there are several situations which may cause a load to lock. Lock-up usually occurs behind wheel wells.
  - Gravel, rock, soil, etc., may "cake up" and lock the load.
  - Items such as firewood, shingles, tiles, trash, furniture, etc.,
  - may hit The wheel well (or truck rear wall on either side of tailgate) and lock the load.
  - Organic materials such as grass clippings, compost, turf, etc.,
  - if left for several hours, can "cake up" or even stick to the dragsheet.

To solve the Locked Load problem, free or loosen the materials in front of and behind the wheel wells.

## **Dos and Don'ts**     If questions, call Loadhandler at 1-800-580-0791

- Keep Bearing Brackets lubricated where Roller comes through. Silicone spray works best (does not attract dirt).
- For stubborn heavy loads (rock, gravel, soil, etc.), lubricate truck bed (or plastic bedliner) as well. Silicone spray and Armor All work great.
- Keep truck bed free of debris. A sharp object under Dragsheet will tear it (patchable with Duct Tape). Also Dragsheet glides much easier on clean surface.
- Keep Dragsheet clean with hose or broom. Grit accumulating on Dragsheet causes extra drag or friction.
- If Dragsheet ends begin to fray, snip off strands and carefully singe ends with cigarette lighter to retard future fraying.
- Dragsheet slits may be repaired with Duct Tape. Best to apply tape on side that meets the payload rather than the side that contacts the truck bed.
- Best to keep crank handle in truck cab. The handle is designed to fall out of roller slot when not in use.
- To more easily remove final residue from truck bed, it is best to disengage the Loadhandler® first.
- Do not use the Loadhandler® as a step into or out of truck bed.

# LH2200 & LH2200M AFTER ASSEMBLY

DRIVER SIDE

PASSENGER SIDE

Leave 1/4" Between Collars and Bearings

Front of Truck

Drive Slot on Driver Side  
(Outside Edge of Tailgate)

Spray Lubricant Here

Adjustment Holes

Tailgate

Straps Omitted for Clarity

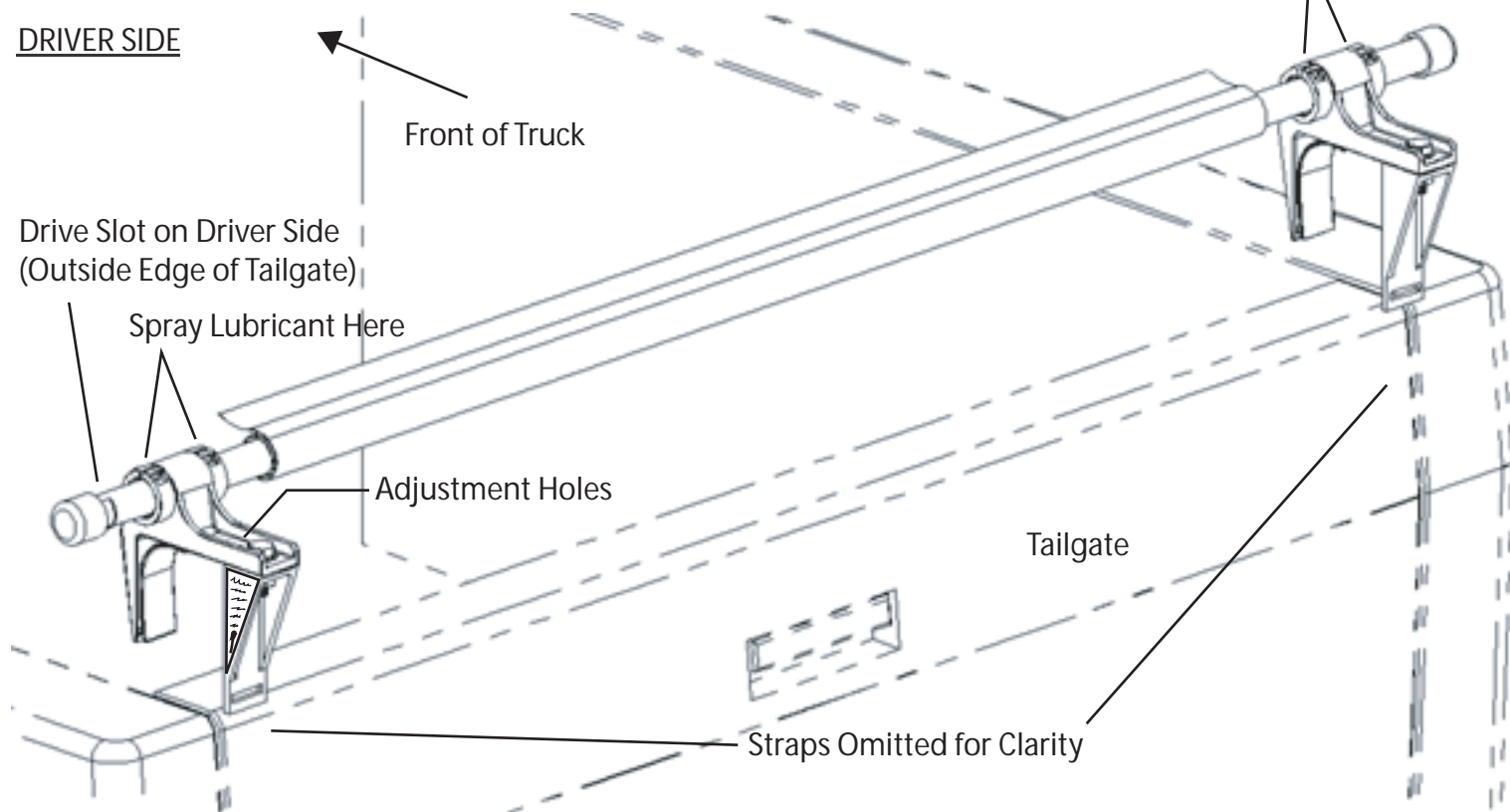

### 12-MONTH LIMITED WARRANTY

LOADHANDLER PRODUCTS CORPORATION warrants to the original retail purchaser that should this product or any part thereof, under normal use and conditions, be proven defective in material or workmanship within 12 months from date of original purchase, such defect(s) will be replaced.

To obtain the replacement within the terms of this warranty, return the item (shipping prepaid) to LOADHANDLER PRODUCTS CORPORATION, 342 N. FOURTH ST., LIBERTYVILLE, IL 60048 together with proof of warranty coverage (e.g., dated bill of sale) and a new part(s) will be shipped to you. **LOADHANDLER PRODUCTS CORPORATION will pay the packaging, shipping and handling cost** to ship the replacement part(s) to you.

The warranty does not apply to any product or part thereof which in the opinion of the Company has been damaged through alteration, improper installation, mishandling, misuse (including overloading), neglect or accident. THE EXTENT OF THE COMPANY'S LIABILITY UNDER THIS WARRANTY IS LIMITED TO THE REPLACEMENT PROVIDED ABOVE AND, IN NO EVENT, SHALL THE COMPANY'S LIABILITY EXCEED THE PURCHASE PRICE PAID BY THE PURCHASER FOR THE PRODUCT.

This warranty is in lieu of all other expressed warranties or liabilities. ANY IMPLIED WARRANTIES, INCLUDING ANY IMPLIED WARRANTY OF MERCHANT ABILITY, SHALL BE LIMITED TO THE DURATION OF THIS WRITTEN WARRANTY, ANY ABILITY FOR BREACH OF ANY WARRANTY HEREUNDER INCLUDING ANY IMPLIED WARRANTY OF MERCHANT. ABILITY MUST BE BROUGHT WITHIN A PERIOD OF 12 MONTHS FROM DATE OF ORIGINAL PURCHASE. IN NO CASE SHALL THE COMPANY BE LIABLE FOR ANY CONSEQUENTIAL OR INCIDENTAL DAMAGES FOR BREACH OF THIS OR ANY OTHER WARRANTY, EXPRESSED OR IMPLIED, WHATSOEVER.

Some states do not allow limitations on how long an implied warranty lasts or the exclusion or limitation of incidental or consequential damage so the above limitations or exclusions may not apply to you. This warranty gives you specific legal rights and you may also have other rights that vary from state to state.



## WARRANTY CARD

Loadhandler Model (please circle):                      LH2200                      LH2200M

Date Purchased: \_\_\_\_\_

Where did you purchase:

☐ Direct (800)      ☐ Retail Store      ☐ Catalog      ☐ Website

☐ Other \_\_\_\_\_

Name: \_\_\_\_\_

Address: \_\_\_\_\_

City: \_\_\_\_\_ State/Province: \_\_\_\_\_

Zip: \_\_\_\_\_

Comments: \_\_\_\_\_

\_\_\_\_\_  
\_\_\_\_\_

You can mail to Loadhandler or fax to 847-932-4044

It is highly recommended that the Loadhandler be removed from your vehicle when not in use to avoid any dulling of the finish caused by dust or dirt. Do not let dust, dirt, unloaded materials, etc., accumulate under the protective rubber pads on the brackets. Check brackets between loads.

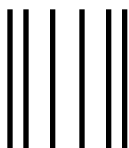

PLACE  
STAMP  
HERE

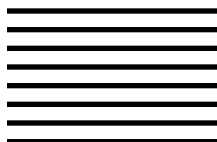

SEND TO:

LOADHANDLER PRODUCTS CORPORATION  
342 N. FOURTH ST.  
LIBERTYVILLE IL 60048