

INSTALLATION INSTRUCTIONS

08-11 FORD ESCAPE, MEGA AND O-MEGA BRACKETS, 570826

PLEASE READ INSTRUCTIONS BEFORE INSTALLING

1. MOUNT THE REAR BRACKET TO THE BOTTOM OF TRUCKS FRAME BY PLACING THE T-BOLT (ITEM #4) UP AND THROUGH THE BIGGER ROUND HOLE NEXT TO THE MOUNTING HOLES ON THE UNDERSIDE OF FRAME RAIL.SEE FIG 2.
2. ONCE THE T-BOLT HAS BEEN INSTALLED PLACE REAR BRACKET (ITEM #3) UP TO THE BOTTOM OF FRAME RAIL SO THAT THE BOLT AND NUT OF THE T-BOLT LINE UP WITH THE HOLE PATTERN ON THE BRACKET PLACE ON FASTENERS (ITEMS # 7,8,9&10).TIGHTEN FASTENERS.
3. REMOVE THE (2) FACTORY BOLTS (THESE WILL BE REUSE) ON THE FRONT OF THE FRAME RAIL. SEE FIG 1.
4. PLACE FRONT BRACKET (ITEM #2) UP TO FRAME RAIL LINING UP HOLE PATTERN WITH THE HOLE PATTERN OF THE TRUCK. REPLACE FACTORY BOLTS. TIGHTEN ALL FASTENERS.
5. REMOVE THE PLASTIC SIDE PANEL LOCATED BY THE DOOR SILL OPENING BY REMOVING (2) PLASTIC PUSH PLUGS, LIFT CARPET UP AND PUSH RUBBER BODY PLUG OUT THROUGH BOTTOM OF THE FLOOR PAN.
6. PLACE A WASHER (ITEM #7) AND BOLT (ITEM #9) DOWN THROUGH FLOOR PAN.
7. FROM UNDER THE VEHICLE, PLACE BRACKET (ITEM #15) OVER BOLT AND PLACE ON NUT (ITEM #14).
8. ATTACH THE 2 BRACKETS TOGETHER WITH SCREW, WASHER AND NUT (ITEMS #13, 12, AND 11) AND TIGHTEN.
9. TIGHTEN ALL FASTENERS AND REPLACE CARPET AND PLASTIC COVER.
10. ATTACH THE STEP (ITEM #1) TO THE MOUNTING BRACKETS.
 - a. INSERT (2) 5/16" SQUARE HEAD SCREWS (ITEM #5) IN THE CENTER SLOT ON THE UNDER SIDE OF THE STEP.
 - b. POSITION THE STEP ON THE MOUNTING BRACKETS SO THAT THE SQUARE HEAD SCREWS ARE LOCATED IN THE SLOTS OF THE MOUNTING BRACKETS AND THE STEP IS CENTERED, FRONT TO REAR, ON THE VEHICLE.
 - c. LOCATE THE STEP, IN AND OUT, AS DESIRED, INSTALL 5/16" SERRATED FLANGE NUTS (ITEM #6) ON THE SQUARE HEAD SCREWS AND TIGHTEN TO 19 LB FT.



(A LIVERNE Company)

1200 E. Birch St.

Brandon, SD 57005

REV LEVEL A 16JUN11
551920 SHEET 1 OF 3 04NOV10

PARTS LIST

ITEM	PART NO.	QTY	DESCRIPTION
1	575060	2	MEGA STEP BOARD
1	585060	2	O-MEGA STEP,BOARD,SATIN
2	551914	1	BRACKET-MTG,FRONT,LH,570826
3	551916	1	BRACKET-MTG,REAR,LH,570826
2	551915	1	BRACKET-MTG,FRONT,RH,570826
3	551917	1	BRACKET-MTG,REAR,RH,570826
4	551922	2	T-BOLT,WELDMENT,ZP
5	106880	4	SCREW- SQUARE HEAD, 5/16-18 UNC
6	102680	4	NUT- SERRATED FLANGE, HEX, SST, 5/16-18 UNC
7	105909	4	WASHER-FL, 2.00 X .509 X .179,ZP
8	100123	2	NUT-HEX FLG,1/2-13,ZP
9	100069	4	SCR-HEX HD,7/16-14 X 1 1/4,ZP
10	100078	2	WASHER-LOCK,7/16,ZP
11	100181	2	NUT-HEX FLG, 3/8-16, ZP
12	100062	4	WSHR-FL, 3/8, ZP
13	100040	2	SCR-HEX HD, 3/8-16 X 1.00, ZP
14	103737	2	NUT-HEX FLG, 7/16-14, ZP
15	201760	2	BRKT-MTG, URT, 4 X 2, C0300THD



(A LIVERNE Company)

1200 E. Birch St.

Brandon, SD 57005

REV LEVEL A 16JUN11
551920 SHEET 2 OF 3 04NOV10

SERVICE PARTS LIST

MODEL NO. - 570826

LUVERNE LOGO SHOULD BE TOWARD REAR OF VEHICLE

1 RIGHT HAND STEP
LEFT HAND STEP

SQUARE HEAD SCREWS MUST BE INSTALLED IN CENTER AND FRONT SLOTS FROM END OF STEP

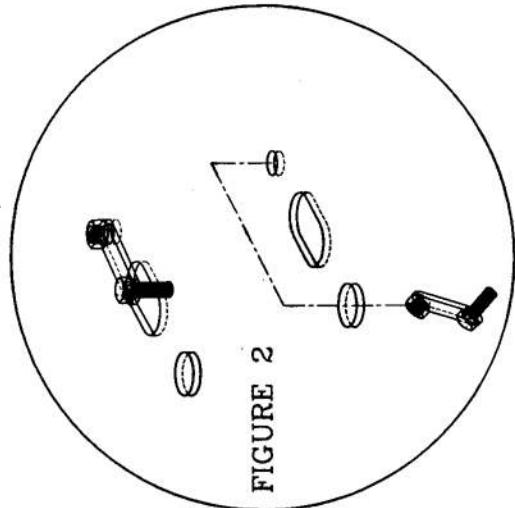

LEFT (DRIVER) SIDE SHOWN
RIGHT (PASSENGER) SIDE OPPOSITE

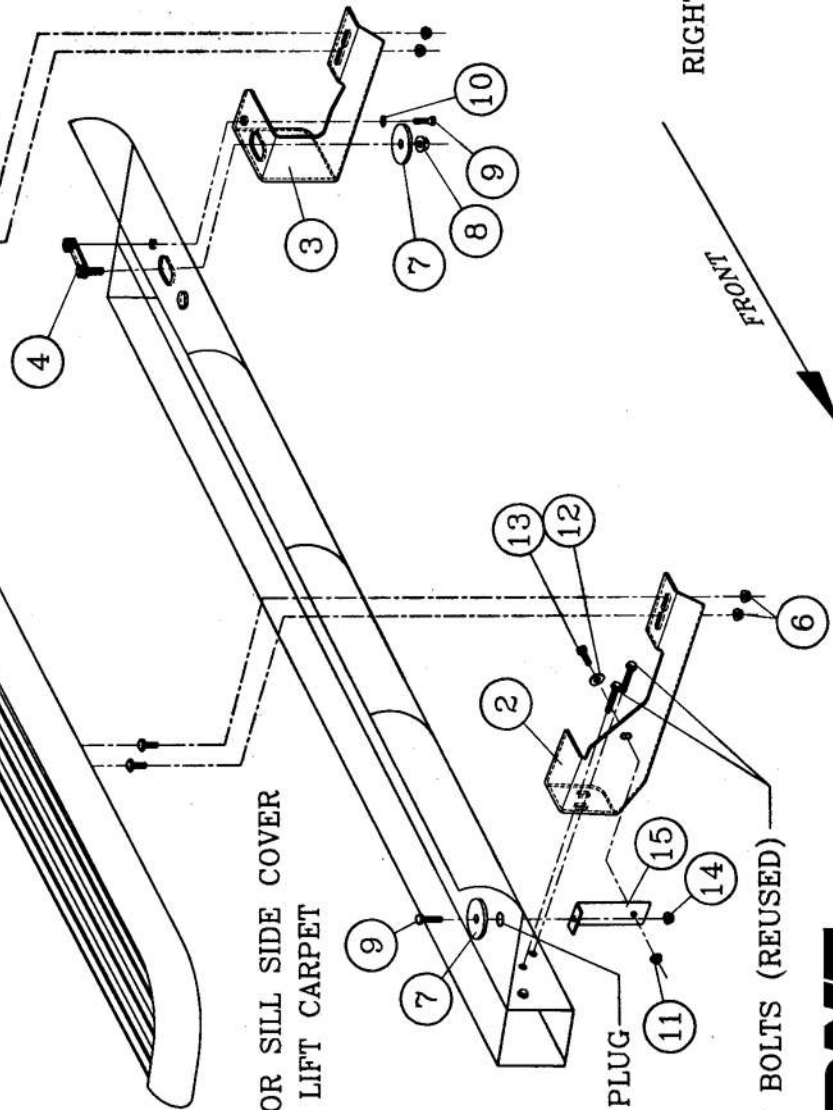

REMOVE DOOR SILL SIDE COVER AND LIFT CARPET

REMOVE BODY PLUG

FACTORY BOLTS (REUSED)

LUVERNE
TRUCK EQUIPMENT
(A LUVERNE Company)

1200 E. Birch St.
Brandon, SD 57805

REVISION LEVEL A 16JUN11
551920 SHEET 2 OF 2 04NOV10