

INSTALLATION INSTRUCTIONS AND PARTS LIST

MODEL# 431419 BLACK W2W BAJA STEP BARS:
2014 GM CREW CAB PICKUPS



NO DRILL INSTALLATION

1. READ INSTRUCTIONS COMPLETELY AND CHECK TO MAKE SURE THAT ALL REQUIRED PARTS (LISTED ON SERVICE PARTS LIST) ARE ON HAND BEFORE STARTING THE INSTALLATION.
2. ASSEMBLE THE BAJA STEP TUBES AND MOUNTING BRACKETS AS FOLLOWS.
NOTE: THE 1" X 3" SERIAL NUMBER DECAL IS LOCATED ON THE FRONT LEG OF THE LEFT (DRIVERS SIDE) BAJA STEP ASSEMBLY.
 - 2.1 LAY THE BJA STEP ASSEMBLIES (ITEM #1 & 2) ON A FLAT SURFACE. (LEFT & RIGHT HAND ASSEMBLIES SHOULD BE MIRROR IMAGES OF ONE ANOTHER).
 - 2.2 ATTACH THE FRONT (5-1/4" TALL) BRACKET (ITEM #3) AND REAR (7-5/8" TALL) BRACKET (ITEM #4) TO THE NERF BAR AS SHOWN. USE 1/2-13 X 2" LONG HEX HEAD BOLTS (ITEM #5). TORQUE THESE BOLTS TO 65 LB. FT.

NOTE:

DUE TO EXCESSIVE THREAD LOCKER IN THE BODY MOUNT BOLT AREA ON THE GM SILVERADO/SIERRA, PLEASE USE CAUTION WHEN REMOVING THESE BODY MOUNT BOLTS IN ORDER TO REDUCE THE RISK OF CAUSING DAMAGE TO THE THREADED INSERTS INSIDE THE VEHICLE.

- 3 REMOVE THE FOUR (4) APPLICABLE FACTORY BODY MOUNT BOLTS FROM THE VEHICLE.
 - 3.1 THESE FOUR (4) BOLTS ARE REUSED IN THIS INSTALLATION.
 - 3.2 THE BODY MOUNT STEEL WASHER PLATES WITH RUBBER CUSHIONS ARE REUSED BETWEEN THE BODY MOUNT AND THE BAJA STEP MOUNTING BRACKET.
- 4 POSITION THE BAJA STEP ASSEMBLY UP UNDER THE VEHICLE AND ATTACH THE FRONT AND REAR BRACKETS TO THE BODY MOUNTS WITH FACTORY BODY MOUNT BOLTS AS SHOWN.
 - 4.1 USE THE EXISTING M14-2.00 X 120mm (4-3/4") LONG FACTORY BODY MOUNT BOLT, TORQUE ALL BODY MOUNT BOLTS TO 65 LB. FT.

SERVICE PARTS LIST

ITEM	PART NO.	QTY	DESCRIPTION
1	552240	1	BAJA STEP WLDMT, LH, SST, BLK, 430719
2	552241	1	BAJA STEP WLDMT, RH, SST, BLK, 430719
3	552339	2	BRKT- MTG, NB, LH/RH, FRT,
4	552340	2	BRKT- MTG, NB, LH/RH, REAR
5	104249	4	BOLT-HEX HD CAP, SERRFLG, 1/2 X 2.00" LG,ZP



(A LIVERNE Company)

1200 E. Birch St.

Brandon, SD 57005

552353 SHEET 1 OF 2 27JUN13

INSTALLATION INSTRUCTION
AND PARTS LIST

MODEL NO.- 431419

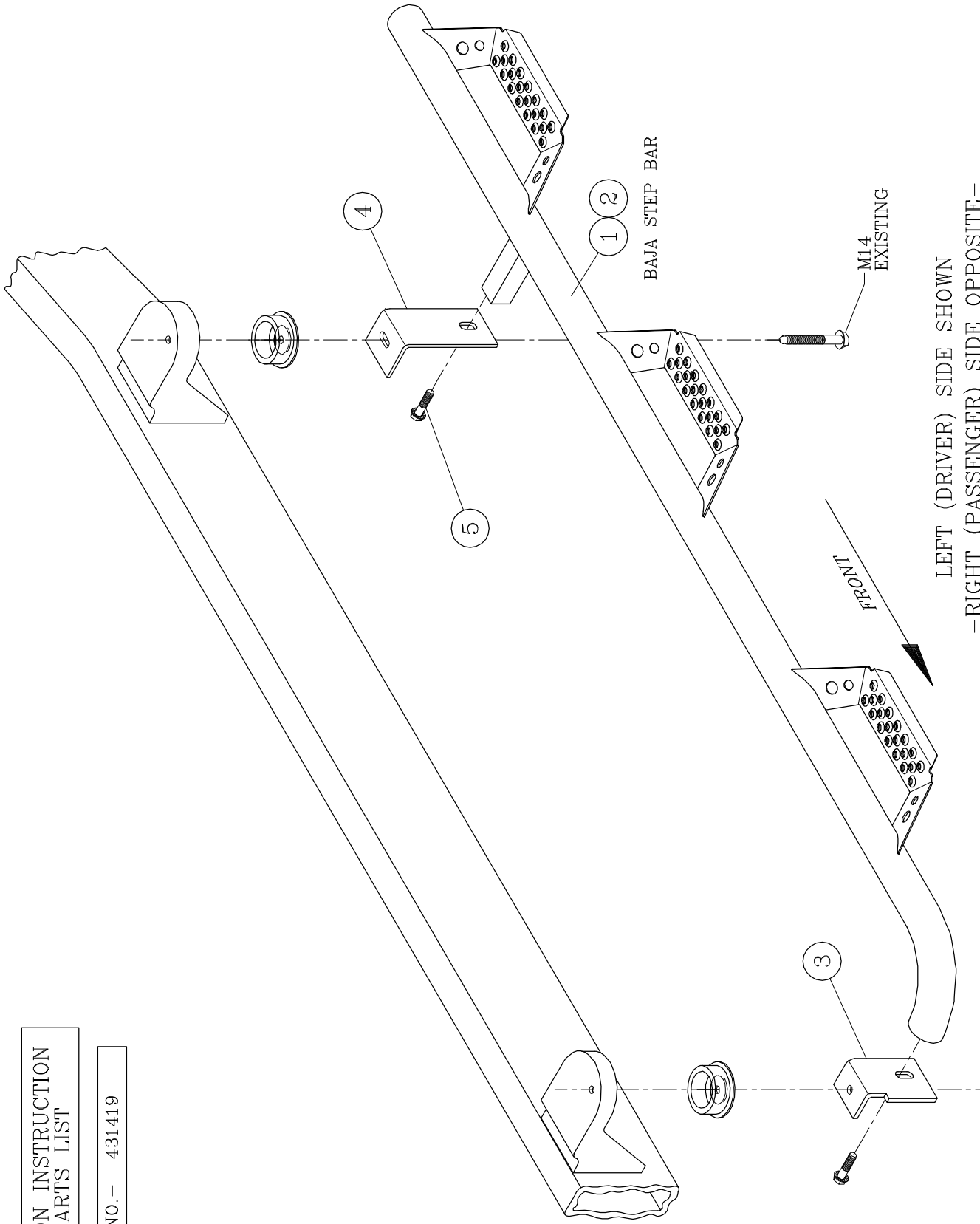

LEFT (DRIVER) SIDE SHOWN
-RIGHT (PASSENGER) SIDE OPPOSITE-

LIVERNE
TRUCK EQUIPMENT
(A LIVERNE Company)

1200 E. Birch St
Plymouth, SD 57005