

**639211**  
2015 GMC Sierra  
2500/3500 HD



**639211**  
2015 GMC Sierra  
2500/3500 HD

## 2015 GMC Sierra 2500/ 3500 HD Torch Series LED Bumper Insert

### TOOLS REQUIRED:

Flat Head Screwdriver  
10mm Socket  
19mm Socket

### PARTS LIST

2- M8x1.25mm Hex Nuts  
2- M8 1" Bolts  
4- 1 3/8x1/2 flat washer zinc  
2- 5/16 flat washer zinc  
2- M8 1/2" Bolts

### NOTE:

- We recommend painting all areas exposed behind grille black prior to installing for best results.

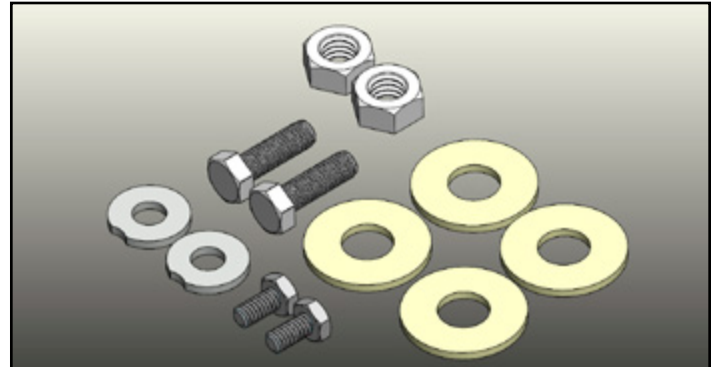

**PLEASE READ AND UNDERSTAND ALL INSTRUCTIONS BEFORE INSTALLATION.** Auto makers offer varied models to each vehicle and occasionally manufacture more than one body style of the same model. To assure your part is correct; our tech department can be contacted at [tech@trexbillet.com](mailto:tech@trexbillet.com) to verify fitment or assist with tech questions. All other inquiries can be directed to [info@trexbillet.com](mailto:info@trexbillet.com). In the event you do not have internet access please call 1-800-287-5900.

### Step 1

Open hood and remove the 12 plastic push clips securing the plastic radiator shroud to the radiator core. Carefully use a flat head screwdriver to release the clip up, you can now remove the clips. Once all clips have been removed the plastic radiator shroud can be removed. (Fig 1)



### Step 2

Using your 10mm socket and ratchet remove the four (4) 10mm bolts securing the upper grille assembly to the radiator support. (Fig 2)



**639211**  
2015 GMC Sierra  
2500/3500 HD



**639211**  
2015 GMC Sierra  
2500/3500 HD

**Step 3**

Gently lift the top of grille assembly up while pulling back at the same time. Depress the four (4) release tabs located on the inside of the factory grille assembly with your flat head screwdriver. Firmly grasp the grille pulling away from the vehicle to remove it. (Fig 3)



**Step 4**

Attach brackets to the lower grille/ bumper support. The tabs will extend into the lower bumper opening. (Fig 4)



**Step 5**

Secure brackets with included bolts and washers. (Fig 5)



**639211**  
2015 GMC Sierra  
2500/3500 HD



**639211**  
2015 GMC Sierra  
2500/3500 HD

### **Step 6**

Insert LED light and secure with included bolts and washers to the bracket tabs. (Fig 6)



**Fig 6**

### **Step 7**

Your installation is now complete. Reattach the grille/ bumper assembly back to the vehicle in reverse order of removal. Make sure you reconnect all disconnected wiring harness and reattach all clips and screws. Wire the LED Light Bar via our optional wiring harness kit (part# 639HAR1) or custom wiring harness. Light bars are installed flush with the grille from the factory. This may or may not be ideal for each light depending on the configuration of your vehicle and its options and or modifications. To adjust the angle of your Light Bar, rotate the Light Bar to adjust the angle, then tighten the hardware once the desired angle is achieved (please be careful not to over tighten the mounting hardware or scratch the finish of the grille). It is best to adjust the angle with the vehicle on level ground with lights facing a wall, garage door or other solid barrier. We recommend checking from a distance of 25'. (Fig 7)



**Fig 7**